

PROSPECTING, ASSAY AND ANALYSIS

REPORT ON THE
QUARTZ LAKE PROPERTY
FRIPP TOWNSHIP
PORCUPINE MINING DIVISION
FOR
DAVID M LEFORT

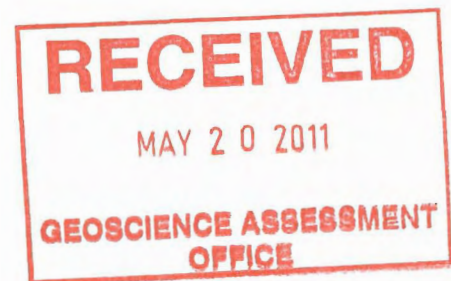

Date of completion may 14 2011

Submitted by: David M Lefort

Hard Rock Exploration

2.48492

INTRODUCTION/WORK PERFORMED

On Oct 17 2010 prospecting was done on claim 4243964 and 4243969, The purpose of the work done was to investigate two trenches, one was discovered during the initial staking of the property as it is on the border of the two claims mentioned above, the other was noted previously during a canoe search of the shore line .Access was gained by 4x4 truck via pine street south, travel 20 km south of timmins on pine south and then 7km west on a series of logging roads, from the truck approximately 150 m was walked down a trail through the bush to get to the lake.The most western of the two trenches was examined first, Az and dip was noted at approx Az 280 and dip 80N, the trench was measured and sample 16256 was taken , the second of the two was then examined,Az and dip were approx the same as first trench visited, plus or minus 10 degrees.The second trench was measured and sample 16257 was taken. Both samples were sent for assay, copies of both are attached to this report. It was very apparent that both these trenches were on the same vein, spot checking done between the two trenches with a pick hammer confirmed this. The vein at the first trench examined was approx 1m wide and the second trench approx 80 cm, vein material consisted of Quartz and visual mineralization, mainly chalcopyrite.

CONCLUSIONS/RECOMENDATIONS

It is concluded by this report that the vein where assayed in the two trench locations described in this report and clearly Identified on map attached to this report, is well mineralized and could prove to be economical should base metal prices continue to rise. Gold is also often is associated with quartz veining and also with chalcopyrite. However no gold was detected from the assay beyond small background traces of less than 0.005 ppm

It is recommended that prospecting be done to both the east and west of these trenches to locate and identify any extension of this vein if any. There is an 8x8 shaft on the property(claim 4243964) approximately 350m south of these trenches sank on a Quartz Vein approximately 2m wide,Az and dip are approx the same as these two trenches and is believed to be the same vein as the shaft is located on the same shore line almost due east to the trenches described in this report.A sample of the shaft vein ran for assay previously returned results similar to these trenches. David M Lefort will attempt to prove this theory in future work and extend the known strike from approx 50m to 450m.

Access and Location

Access to the claim group is gained by 4x4 truck via Pine st south ,travel 20 km south of Timmins and then 7 km west through a series of logging roads,from the truck approx 150m traverse down a trail to the lake. Travel by boat to the east end of east arm of Quartz lake where the shaft is a few meters inland from the south shore.

The claim group is located in the north central portion of Fripp Twp, Porcupine mining division, district of Cochrane. The claim group is 36 contiguous unpatented mining claims and covers nearly all of Quartz Lake and some of the surrounding area .

GENERAL GEOLOGY The claim group is underlain by early to late pre-cambrian age meta-sediments and meta-volcanics interrupted by diabase dikes and by granite with accompanying red aplite dikes, as interpreted from Map 2205 Timmins Kirkland Lake Geological Compilation Series.

<u>CLAIMS GROUP</u>	<u>CLAIM #</u>	<u># OF UNITS</u>	<u>TOWNSHIP</u>	<u>RECORDED HOLDER</u>
	4243962	12	Fripp	50% Shay B Simon , 50% David M Lefort
	4243963	2	Fripp	100% David M Lefort
	4243964	1	Fripp	100% David M Lefort
	4243965	2	Fripp	100% David M Lefort
	4243966	3	Fripp	100% David M Lefort
	4243969	16	Fripp	100% David M Lefort

PERSONNEL

The people directly involved with the work described in this report are

David M Lefort (Hard Rock Exploration)

Gord Hendriksen (knick Exploration)

PREVIOUS WORK

The following is a brief description of previous assessment work filed on the Quartz Lake property.

1927-28 Quarts Lake Mines Ltd

Adit driven into vein on southwest shore of canyon lake, shaft sunk on vein just off the shore near the most eastern part of the east arm of Quartz Lake, diamond drilling, small pit, trenching

1964 O'leary Malartic

Self potential survey, 7 diamond drill holes

1988 Renauld Garneau

Airborne magnetometer and VLF

1992 Dan Tichinoff

Magnetometer survey, VLF-EM survey, I.P survey, Diamond Drill (FRI-92)

2009-10 David M Lefort - manual overburden stripping, assay and analyses

CERTIFICATION

I David M Lefort of timmins on hereby certify that:

1. I am owner/operator of Hard Rock Exploration and have been in the exploration business since 2009
2. I am a narrow vein stope miner
3. I have been employed directly with, Kirkland Lake Gold inc, Dumas Mining Contracting and Engineering, Trewlaney Mining and Exploration and Hard Rock Exploration
4. I have based conclusions and recommendations based on results of the field work performed as described in this report, and knowledge of the area.
5. I was present for and supervised all work preformed as described in this report.
6. That all costs listed in the schedule of costs attached to this report are accurate and put towards the work performed in this report. All receipts,invoiced are located at the residence/office of David M Lefort/Hard Rock Exploration located at 573 Spooner dr Timmins On
7. All assay records , are accurate as described and located at the residence/office of David M Lefort/Hard Rock Exploration located at 573 Spooner dr Timmins On
8. I am the author of this report

Dated may 14 at Timmins On





△N Declination
11° west
Scale
1:500
Fripp Twp

Quartz Lake East arm

South Shore of East arm
↓

Claim #
4243969

Claim #
4243961

Trench
3m x 5m
Sample # 16256

Trench
3m x 3m
Sample #
16257

LP #4
Trench
3m x 3m
not assayed

Legend

- ⊕ Sample
- ~ water
- ▨ Trench
- - - claim border

L.P. Location Post

W.P. Witness Post

o o o } traverses

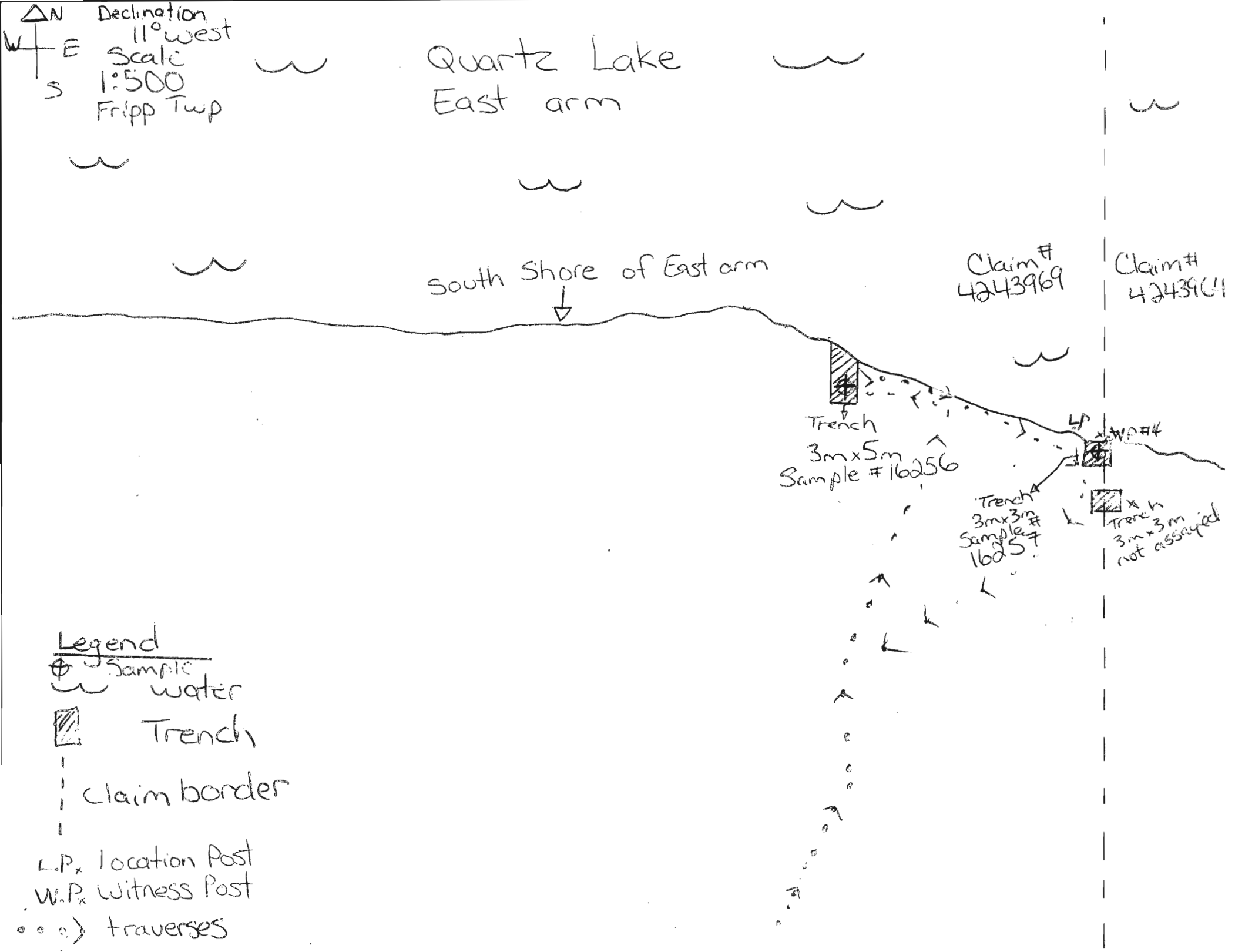

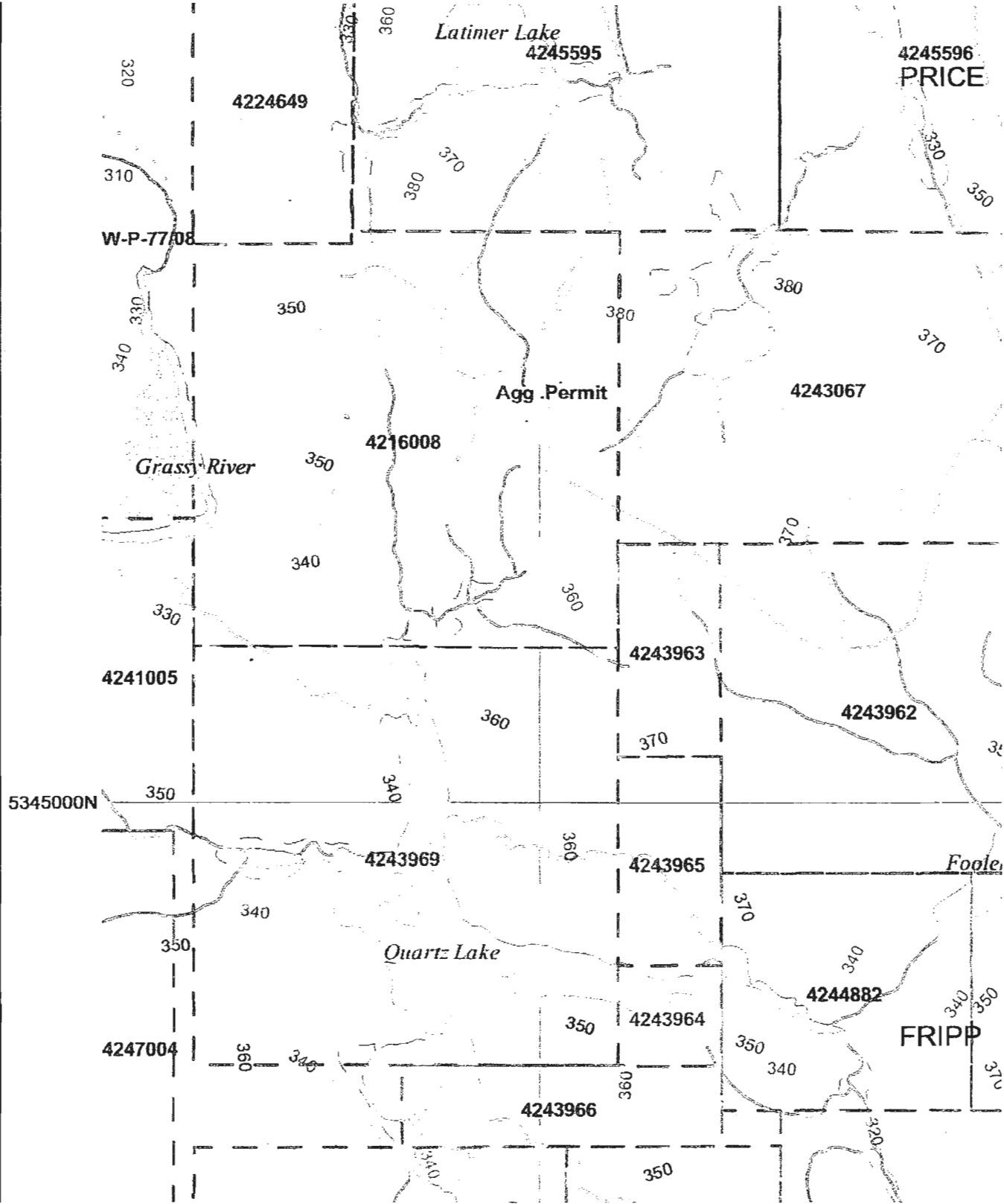

SCHEDULE/DECLARATION OF COSTS

\$300 2 men @ \$150 per day (oct 17 2010) David M Lefort, Gord Hendriksen

\$40 gas for 4x4 vehicle

\$40 food, 2 men (oct 17 2010)

\$80 52 element assay

\$100 report, 1 day

Total

\$ 560

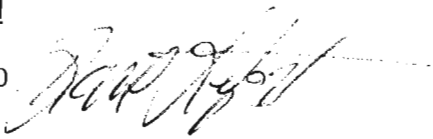

VO10167853 - Finalized

CLIENT : KNIEXP - Knick Exploration inc.

of SAMPLES : 2

DATE RECEIVED : 2010-11-11

PROJECT : QUARTZ LAKE

CERTIFICATE COMMENTS : ME-MS41:Gold determinations by this method are semi-quantitative due to PO NUMBER :

	Au-AA23	ME-MS41	ME-MS41	ME-MS41	ME-MS41	ME-MS41	ME-MS41	ME-MS41
SAMPLE	Au	Ag	Al	As	Au	B	Ba	Be
DESCRIPTIC	ppm	ppm	%	ppm	ppm	ppm	ppm	ppm
16256	-0.005	3.26	0.8	0.2	-0.2	-10	-10	0.19
16257	-0.005	0.7	1.49	0.1	-0.2	-10	10	0.31

the small sample weight used (0.5g).

ME-MS41	ME-MS41	ME-MS41	ME-MS41	ME-MS41	ME-MS41	ME-MS41	ME-MS41	ME-MS41
Bi	Ca	Cd	Ce	Co	Cr	Cs	Cu	Fe
ppm	%	ppm	ppm	ppm	ppm	ppm	ppm	%
26.8	1.77	0.06	2.5	7.1	19	0.05	8100	2.59
6.13	1.73	0.2	12.1	13.1	68	0.62	2020	3.14

ME-MS41	ME-MS41	ME-MS41	ME-MS41	ME-MS41	ME-MS41	ME-MS41	ME-MS41	ME-MS41
Ga	Ge	Hf	Hg	In	K	La	Li	Mg
ppm	ppm	ppm	ppm	ppm	%	ppm	ppm	%
3.18	0.06	0.05	-0.01	0.047	-0.01	0.9	5.4	0.25
6.12	0.06	0.04	-0.01	0.032	0.03	4.5	19.5	0.65

ME-MS41	ME-MS41	ME-MS41	ME-MS41	ME-MS41	ME-MS41	ME-MS41	ME-MS41	ME-MS41
Mn	Mo	Na	Nb	Ni	P	Pb	Rb	Re
ppm	ppm	%	ppm	ppm	ppm	ppm	ppm	ppm
342	3.14	-0.01	0.09	18	110	39.9	0.2	-0.001
592	1.61	0.01	0.08	43.9	420	89.3	2.1	-0.001

ME-MS41	ME-MS41	ME-MS41	ME-MS41	ME-MS41	ME-MS41	ME-MS41	ME-MS41	ME-MS41
S	Sb	Sc	Se	Sn	Sr	Ta	Te	Th
%	ppm	ppm	ppm	ppm	ppm	ppm	ppm	ppm
0.68	-0.05	1.8	2.1	-0.2	14.1	-0.01	0.09	0.6
0.12	-0.05	7.6	0.4	0.2	10.5	-0.01	0.01	1.2

ME-MS41	ME-MS41	ME-MS41	ME-MS41	ME-MS41	ME-MS41	ME-MS41	ME-MS41
Ti	Tl	U	V	W	Y	Zn	Zr
%	ppm	ppm	ppm	ppm	ppm	ppm	ppm
0.011	-0.02	0.08	14	0.07	2.81	52	1.5
0.006	-0.02	0.17	53	0.1	7.37	113	1.1

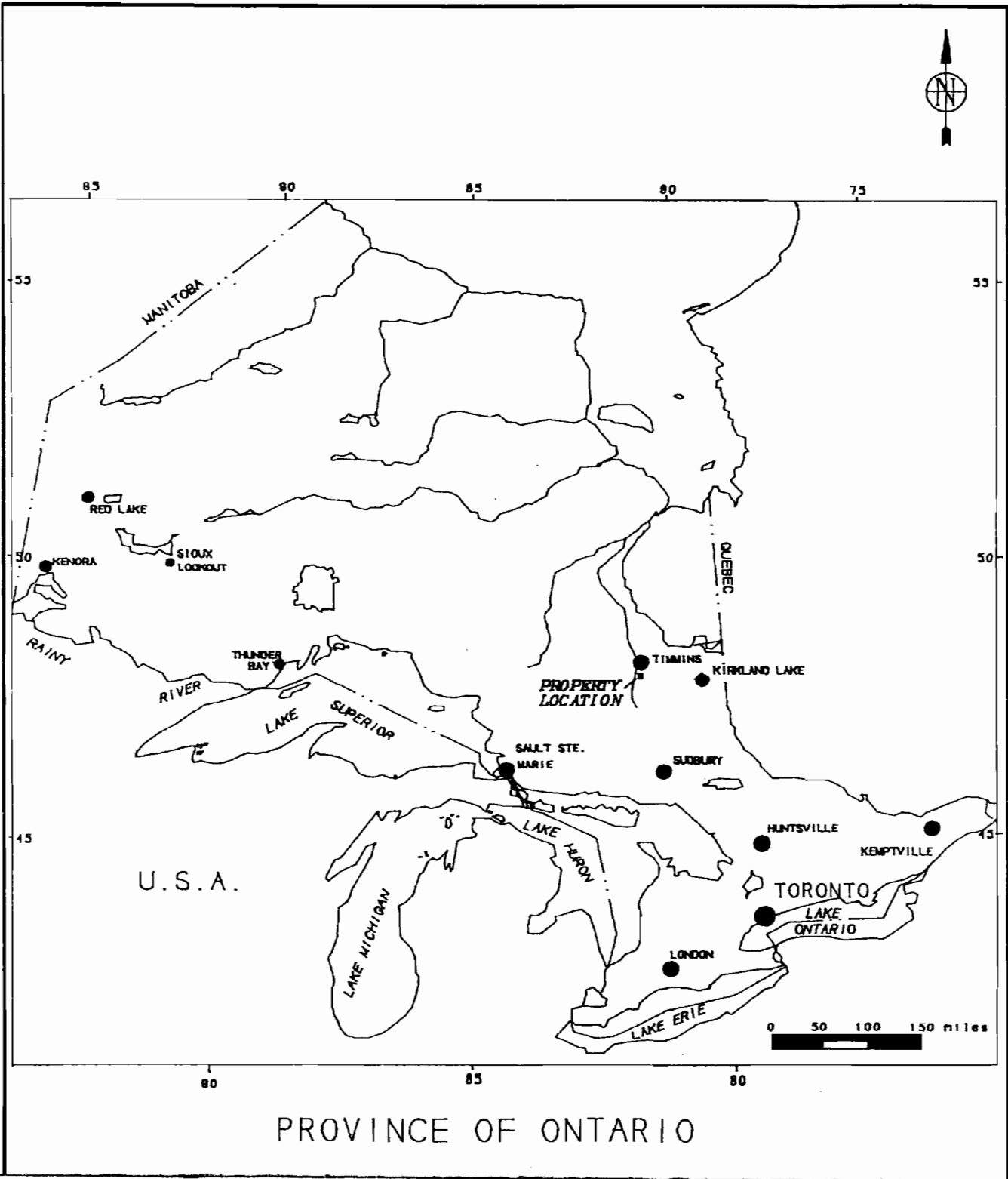

PROVINCE OF ONTARIO