

manual overburden Stripping

WORK REPORT ON THE  
QUARTZ LAKE PROPERTY  
FRIPP TOWNSHIP  
PORCUPINE MINING DIVISION  
FOR  
DAVID M LEFORT

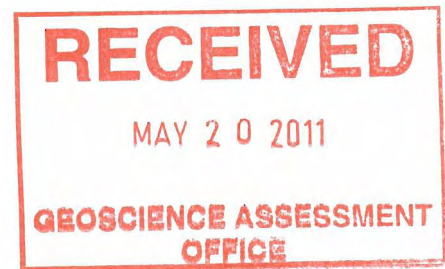

Date of completion may 10 2011

Submitted by: David M Lefort

Hard Rock Exploration

2 48493

## **Table of Contents**

- p.1 introduction/work performed , recommendations/conclusions
- p.2 access and location , general geography, claim group, personnel
- p.3 previous work , certification
- p.4 certification cont.
- p.5 schedule/declaration of costs
- p.6 claim map
- p.7 detailed map
- p.8 certification (Shay B Simon)

## **INTRODUCTION/WORK PERFORMED**

On July 29 2009 work was performed on claim 424 3969, overburden was manually stripped with a grub hoe and shovels. The purpose of this work was to trace vein of shaft which had been previously sampled and assayed. Overburden was manually stripped to a width of approx 1m, and an average depth of 0.5-0.75m for an overall length of 55m. A high pressure pump was then used to wash off remaining debris to visually inspect the vein. The vein ran the entire length of the stripped area and did not stop, trench was stopped at the border of the claim. The vein is 2m at the shaft and gradually narrows to approx 0.5m at the east end of the trench.

July 29 2009 brush tagalders in area to be worked with machetes and axes, manually remove overburden ( moss,roots,sand/soil)

July 30 2009 manually strip overburden (moss,roots,sand/soil)

July 31 2009 manually strip overburden (moss,roots,sand/soil)

Aug 2 2009 wash down with high pressure pump for visual examination, demobilize, take sample #002, not sent for assay as shaft was previously assayed, similar mineralization, mainly Quartz and chalcopyrite

## **RECOMENDATIONS/CONCLUSIONS**

It is concluded that the vein the shaft is sunk on continues to the east, and that the vein is well mineralized. It is recommended that channel sampling be done on the stripped vein. Prospecting to the east is no longer recommended as the claim border has been reached. Prospecting to the west is recommended because the vein on the west side of the shaft goes into the lake. Prospecting on this shoreline where the vein goes into lake recommended .

**Access and Location**

Access to the claim group is gained by 4x4 truck via Pine st south ,travel 20 km south of Timmins and then 7 km west through a series of logging roads,from the truck approx 150m traverse down a trail to the lake. A boat was used to travel to the east end of the east arm of Quartz Lake where the shaft is just off the south shore

The claim group is located in the north central portion of Fripp Twp, Porcupine mining division, district of Cochrane. The claim group is 36 contiguous unpatented mining claims and covers nearly all of Quartz Lake and some of the surrounding area .

**GENERAL GEOLOGY** The claim group is underlain by early to late pre-cambrian age meta-sediments and meta-volcanics interrupted by diabase dikes and by granite with accompanying red aplite dikes, as interpreted from Map 2205 Timmins Kirkland Lake Geological Compilation Series.

<b><u>CLAIMS GROUP</u></b>	<b><u>CLAIM #</u></b>	<b><u># OF UNITS</u></b>	<b><u>TOWNSHIP</u></b>	<b><u>RECORDED HOLDER</u></b>
	4243962	12	Fripp	50% Shay B Simon , 50% David M Lefort
	4243963	2	Fripp	100% David M Lefort
	4243964	1	Fripp	100% David M Lefort
	4243965	2	Fripp	100% David M Lefort
	4243966	3	Fripp	100% David M Lefort
	4243969	16	Fripp	100% David M Lefort

**PERSONNEL**

The people directly involved with the work described in this report are

David M Lefort (Hard Rock Exploration)

Shay B Simon (Hard Rock Exploration)

## **PREVIOUS WORK**

The following is a brief description of previous assessment work filed on the Quartz Lake property.

1927-28 Quarts Lake Mines Ltd

Adit driven into vein on southwest shore of canyon lake, shaft sunk on vein just off the shore near the most eastern part of the east arm of Quartz Lake, diamond drilling, small pit, trenching

1964 O'leary Malartic

Self potential survey, 7 diamond drill holes

1988 Renauld Garneau

Airborne magnetometer and VLF

1992 Dan Tichinoff

Magnetometer survey, VLF-EM survey, I.P survey, Diamond Drill (FRI-92)

2009 David M Lefort (Hard Rock Exploration)

assay and analysis

## **CERTIFICATION**

I David M Lefort of timmins on hereby certify that:

1. I am owner/operator of Hard Rock Exploration and have been in the exploration business since 2009
2. I am a narrow vein stope miner
3. I have been employed directly with, Kirkland Lake Gold inc, Dumas Mining Contracting and Engineering, Trewlaney Mining and Exploration and Hard Rock Exploration
4. I have based conclusions and recommendations based on results of the field work performed as described in this report, and knowledge of the area.

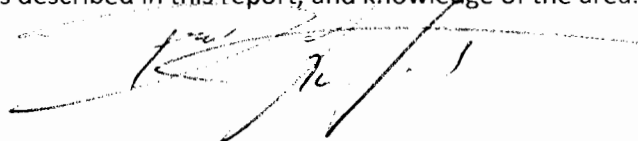

5. I was present for and supervised all work performed as described in this report.
6. That all costs listed in the schedule of costs attached to this report are accurate and put towards the work performed in this report. All receipts, invoiced are located at the residence/office of David M Lefort/Hard Rock Exploration located at 573 Spooner dr Timmins On
7. All assay records, field samples, are accurate as described and located at the residence/office of David M Lefort/Hard Rock Exploration located at 573 Spooner dr Timmins On
8. I am the author of this report

Dated may 10 at Timmins On

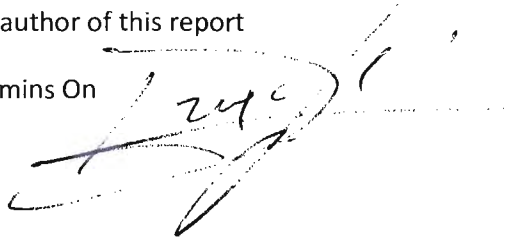
A handwritten signature in black ink, appearing to read 'D. M. Lefort', is written over a horizontal dotted line. The signature is stylized and cursive.

**SCHEDULE/DECLARATION OF COSTS**

\$1200 2 men@\$150 per day x 4 days

\$160 food,2 men , 4 days

\$ 120 fuel, 4 days , from timmins to claim

\$ 73.30 pump rental

\$75 report ½ day

**Total**

\$1628.30

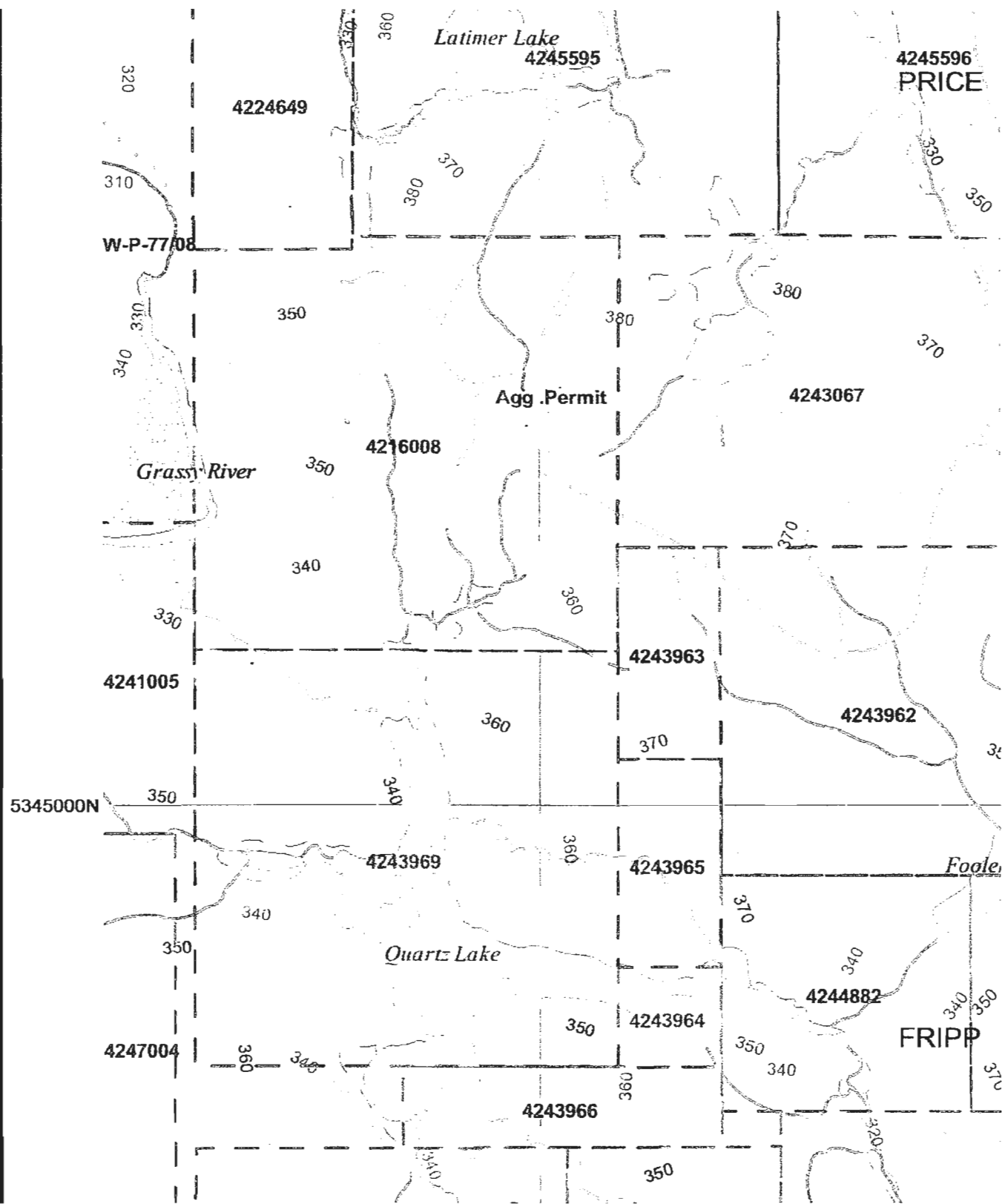



East Arm  
of  
Quartz Lake

UTM  
5344277  
470608  
Sample #001  
(2009)

Claim # 4243964

UTM  
5344282  
470648  
Sample  
#002  
(2009)

← 50m →

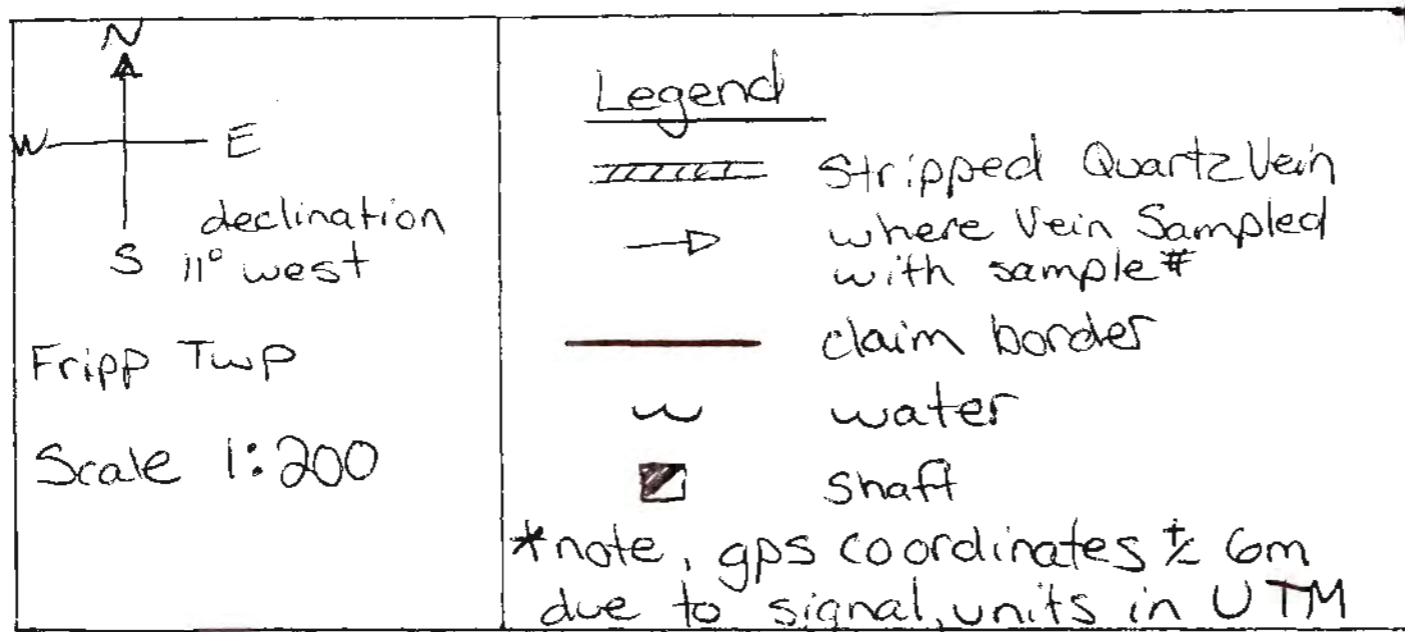

(East border 4243964)

I Shay Simon of timmins ontario was present and directly involved with the work performed on claim 4243964 on dates described in this report

Dated aug 5 2009 at timmins on

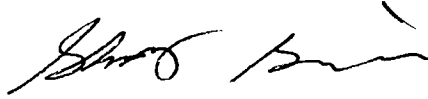
A handwritten signature in black ink, appearing to read "Shay Simon". The signature is written in a cursive style with a prominent loop at the end.

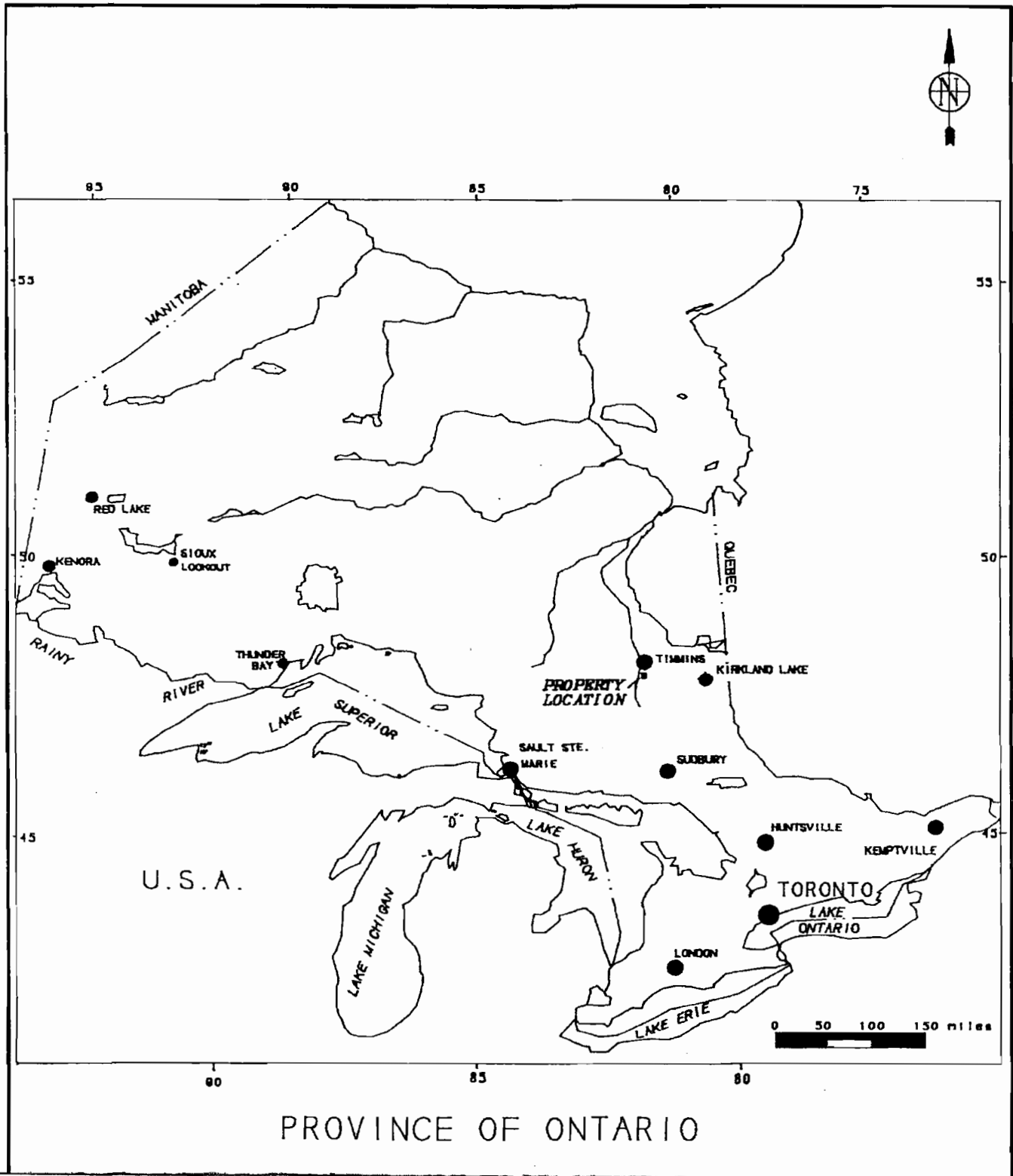



Sample 001

2.2 8493