



≡ GOLDCORP

**GEOTECHNICAL REPORT:
2010 Magnetometric Survey on Graff Lake, Karl
Zeemal, and Lake 282
Zeemal Lake Area Claim Map G-2278**

**S.A. Lyon
August 2010**

Table of Contents

1. Introduction	3
2. Location and Access	3
3. Claims.....	4
4. Previous Work.....	5
5. Personnel	5
6. Geophysical Report.....	7
7. Statement of Expenditures	7
8. Interpretation and Recommendations	7
9. References	7
10. Statement of Qualifications	8
11. Appendix A – Invoices	9

List of Figures

Figure 1 - Location of Musselwhite mine.....	3
Figure 2 - Magnetic survey completed on Musselwhite Mine claims and dispositions.....	6
Figure 3 - Down payment Invoice.	9
Figure 4 - Final Survey Invoice.	10
Figure 5 - Report Invoice.....	11

List of Tables

Table 1 – Total Survey Line Distance (m) for each claim block.	4
Table 2 – Total Survey Line Distance (m) for each disposition.....	5

1. Introduction

A magnetometric survey was carried out for Goldcorp's Musselwhite Mine Property from February 18-23, 2010 by ClearView Geophysics Inc. The survey includes three target areas; Graff Lake, Lake 282, and Karl Zeemal. The purpose of the survey was to acquire a higher resolution magnetic grid to better define the location of a potentially mineralized iron formation.

2. Location and Access

The survey area is southeast of Musselwhite Mine from 680000 mE to 685000 mE and 583300 mN to 582800 mN UTM Zone 15N NAD 83 (Fig. 1). The locations are less than five kilometres away from one another and include Karl Zeemal, Graff Lake, and Lake 282. The survey lines were reached by snow mobile and foot.

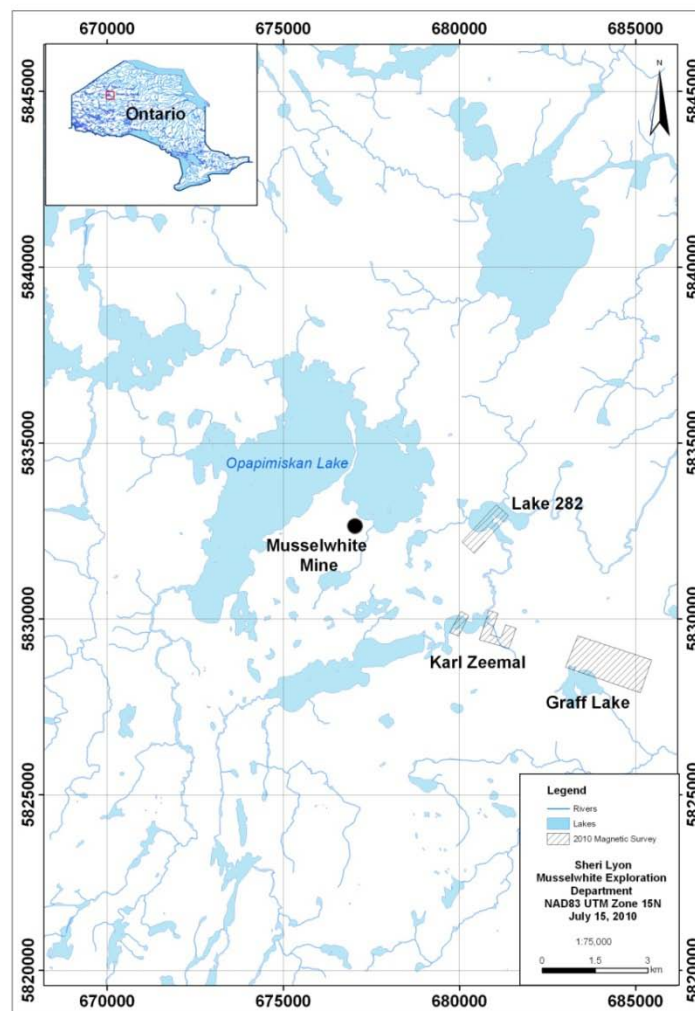

Figure 1 - Location of Musselwhite mine.

3. Claims

The magnetometer survey covered mining claims and dispositions located within the Patricia Mining Division. All claims and dispositions are owned by Goldcorp Canada Ltd. A portion of the Zeemal Lake claim sheet (G-2278), which covers the property, is illustrated in Figure 2. One claim listed below, 1199739, extends into the Karl Lake claim sheet (G-2082). The geophysical survey lines extended into 16 claims as well as 8 dispositions. The total distance of the survey lines within each claim/ disposition are listed below in metres:

Claim	Distance (m)
1199739	3506
529394	1454
529395	235
529641	201
529655	97
529656	333
529657	93
529668	335
529669	204
599167	187
599171	2481
599172	1314
599175	760
599176	1554
TOTAL m	12754

Table 1 – Total Survey Line Distance (m) for each claim block.

Disposition	Distance (m)
PA529833	484
PA529834	330
PA529849	297
PA529902	74
PA529904	143
PA529905	89
TOTAL m	1417

Table 2 – Total Survey Line Distance (m) for each disposition.

4. Previous Work

In 1988, Power Exploration drilled 50 holes around Karl Zeemal Lake. Thirteen of the holes intersected a 475m wide Karl Zeemal Resource. In 2005, Musselwhite Mine underwent an extensive exploration program to better define the resource. Forty-five drill holes corroborated the resource; however, further drilling was recommended.

5. Personnel

The geophysical survey was completed by ClearView Geophysics Inc. based out of Brampton, Ontario. The geophysicist, Joe Mihelcic, worked with operator, Claude Bisson. Jim Edwards, the senior geologist at Musselwhite Mine, looked after the program while the employees of ClearView Geophysics Inc. were at the mine site.

Jim Edwards, Goldcorp Canada Ltd.

Box 7500, Thunder Bay, On, Canada P7B 6S8

Joe Mihelcic and Claude Bisson; ClearView Geophysics Inc.

12 Twisted Oak Street, Brampton, On, Canada L6R 1T1

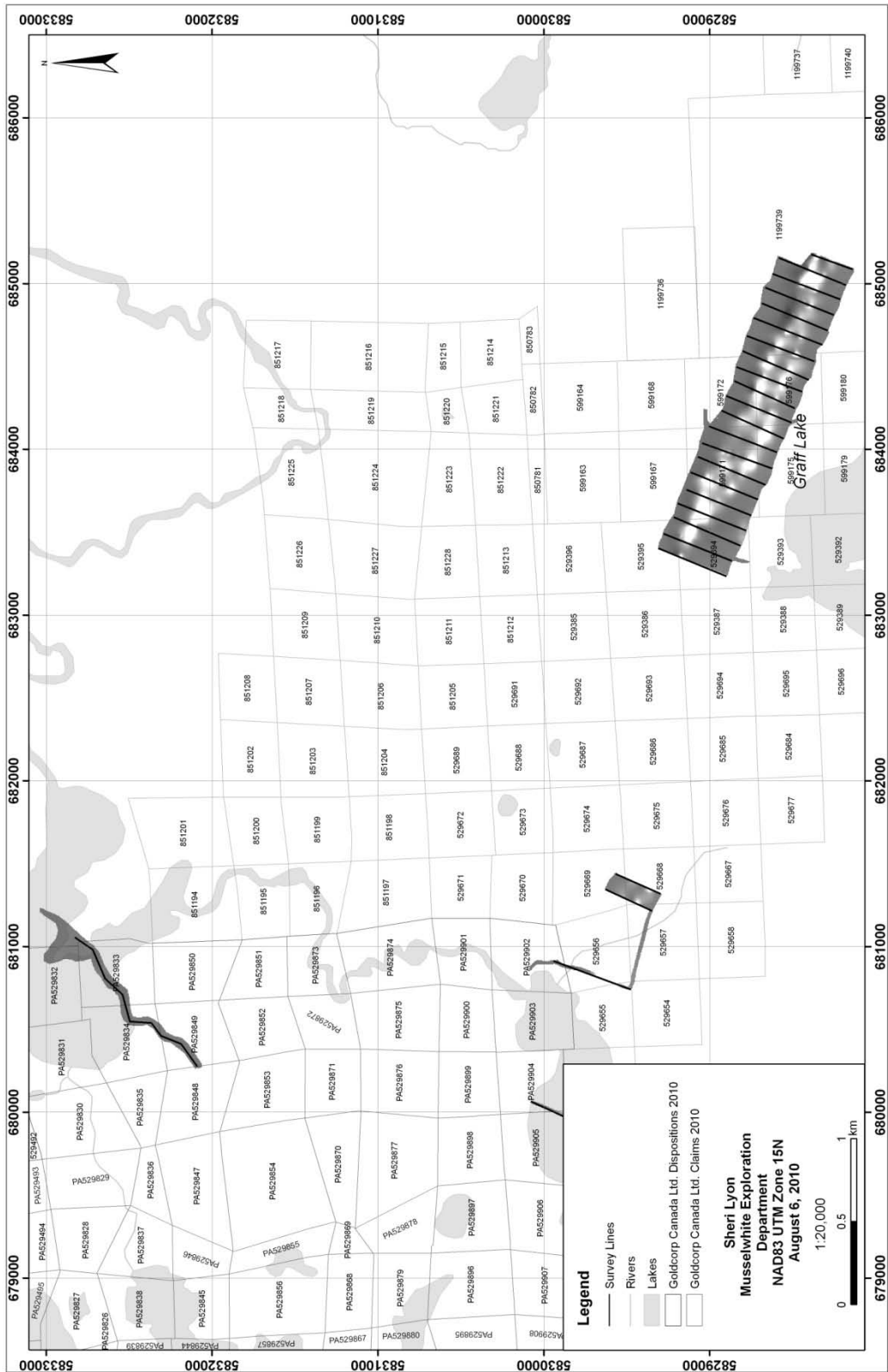

Figure 2 - Magnetic survey completed on Musselwhite Mine claims and dispositions.

6. Geophysical Report

The accompanying geophysical report entitled Report on Magnetometer Surveys at Karl Zeemal, Graff Lake and Lake 282 Musselwhite Mine Site, NW Ontario (Mihelcic 2010) describes the instrumentation, survey methodology, data processing, results, and recommendations by ClearView Geophysics Inc. A Total Field Magnetic colour-contour profile map is also included.

7. Statement of Expenditures

Listed below are the expenditures for the survey. Refer to Appendix A for a further break down of the invoices.

Invoice	Cost
Downpayment	\$ 5 000.00
Magnetic Survey	\$18 111.89
Report	\$ 1 260.00
TOTAL	\$24 371.89

8. Interpretation and Recommendations

The geophysical report by ClearView Geophysics Inc. (Mihelcic 2010) identified a strong magnetic signature similar to the signature produced by iron formations found throughout the Musselwhite Mine property. Further geophysical interpretations of the magnetic grid could suggest potential drill targets for the upcoming winter drilling program.

9. References

Assessment Reports

Mihelcic, J. 2010. Report on Magnetometer Surveys at Karl Zeemal, Graff Lake and Lake 282 Musselwhite Mine Site, NW Ontario, 13 p.

10. Statement of Qualifications

I, Sheri A. Lyon, of the city of Sudbury, Ontario hereby swear and affirm that:

- 1) I am the author of this report.
- 2) I have an Honours Bachelor of Science degree in Earth Science from Dalhousie University in Halifax, Nova Scotia and a Master of Science degree in Geology from Acadia University in Wolfville, Nova Scotia.
- 3) I am currently employed by Goldcorp Canada Ltd. at Musselwhite Mine as an Exploration Geologist.
- 4) I agree with all of the information contained within this report and believe that is an accurate description of the work performed.

Signed:

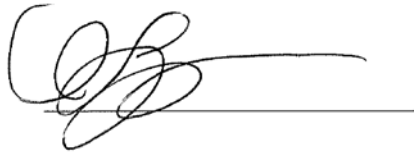
A handwritten signature in black ink, appearing to be 'S. Lyon', written over a horizontal line.

Dated:

July 15, 2010

11. Appendix A - Invoices



12 Twisted Oak Street
Brampton, Ontario
Canada L6R 1T1
Telephone: (905) 458-1883
Facsimile: (905) 792-1884
Cellular: (416) 617-1884
Email: general@geophysics.ca
Web: www.geophysics.ca

CV Ref. #: O0208
Work Order #:
Agreement #:

TO: February 8, 2010

Goldcorp, Musselwhite Mine
P.O. Box 7500
Thunder Bay, Ontario P7B 6S8
telephone: (807) 928-2200
facsimile: (807) 928-2067

Attention: Accounts (refer to Mr. Jim Edwards)

Total Field Magnetics Surveys;

Downpayment-----	\$ 5 000
Total this invoice-----	\$ 5 000

9250 - 3-307 \$5,000
WR WA9M00168

--- THANK-YOU! ---

[Terms: due upon receipt]

Specialists in non-intrusive ground investigations.

Figure 3 - Down payment Invoice.



12 Twisted Oak Street
 Brampton, Ontario
 Canada L6R 1T1
 Telephone: (905) 458-1883
 Facsimile: (905) 792-1884
 Cellular: (416) 617-1884
 Email: general@geophysics.ca
 Web: www.geophysics.ca

CV Ref. #: O0208-1
 Your Ref #: UR9M00885

TO: March 7, 2010

Goldcorp, Musselwhite Mine
 P.O. Box 7500
 Thunder Bay, Ontario P7B 6S8
 telephone: (807) 928-2200
 facsimile: (807) 928-2067

Attention: Accounts (refer to Mr. Jim Edwards)

Total Field Magnetism Surveys;
 Mob/Demob/Standby/Orientation:

Setup -----	\$ 500.00
Airfare, shipping, hotel, meals, taxis; refer to <O0208-1.xlsx> -----	\$ 1 611.89
Two (2) Geophysicist/Operator and Equipment; Mob/Demob, Feb.15-16, March 2 = 3 days @ \$1800/day -----	\$ 5 400.00
Standby for gear, Feb.17 = 1 day @ \$1800 -----	\$ 1 800.00

Field Surveys:

Two (2) Geophysicist/Operator and Equipment; Feb.18-23 = 6 days @ \$2300/day -----	\$ 13 800.00
Total-----	\$ 23 111.89
Less Downpayment-----	<u>(\$ 5 000.00)</u>

Total this invoice----- \$ 18 111.89

--- THANK-YOU! ---

(Kasabonika Lake First Nation Work: February 24-March1)

[Terms: due upon receipt, overdue accounts subject to 2% interest per month]

Specialists in non-intrusive ground investigations.

Figure 4 - Final Survey Invoice.



12 Twisted Oak Street
 Brampton, Ontario
 Canada L6R 1T1
 Telephone: (905) 458-1883
 Facsimile: (905) 792-1884
 Cellular: (416) 617-1884
 Email: general@geophysics.ca
 Web: www.geophysics.ca

CV Ref. #: O0208-2
 Your Ref #: UR9M00885
 March 23, 2010

TO:

Goldcorp, Musselwhite Mine
 P.O. Box 7500
 Thunder Bay, Ontario P7B 6S8
 telephone: (807) 928-2200
 facsimile: (807) 928-2067

Attention: Accounts (refer to Mr. Jim Edwards)

Total Field Magnetics Surveys;

Reporting:

Report – base cost, digital and three (3) hard-copies-----	\$	1 000
Post Processing, Interpretation; 2 hr @ \$100/hr -----	\$	200
Subtotal -----	\$	1 200
Plus GST (#894031145)-----	\$	60
Total this invoice-----	\$	1 260.00

WA 9M00168 9250-3-307

--- THANK-YOU! ---

Canada entered

[Terms: due upon receipt, overdue accounts subject to 2% interest per month]

Specialists in non-intrusive ground investigations.

Figure 5 - Report Invoice.

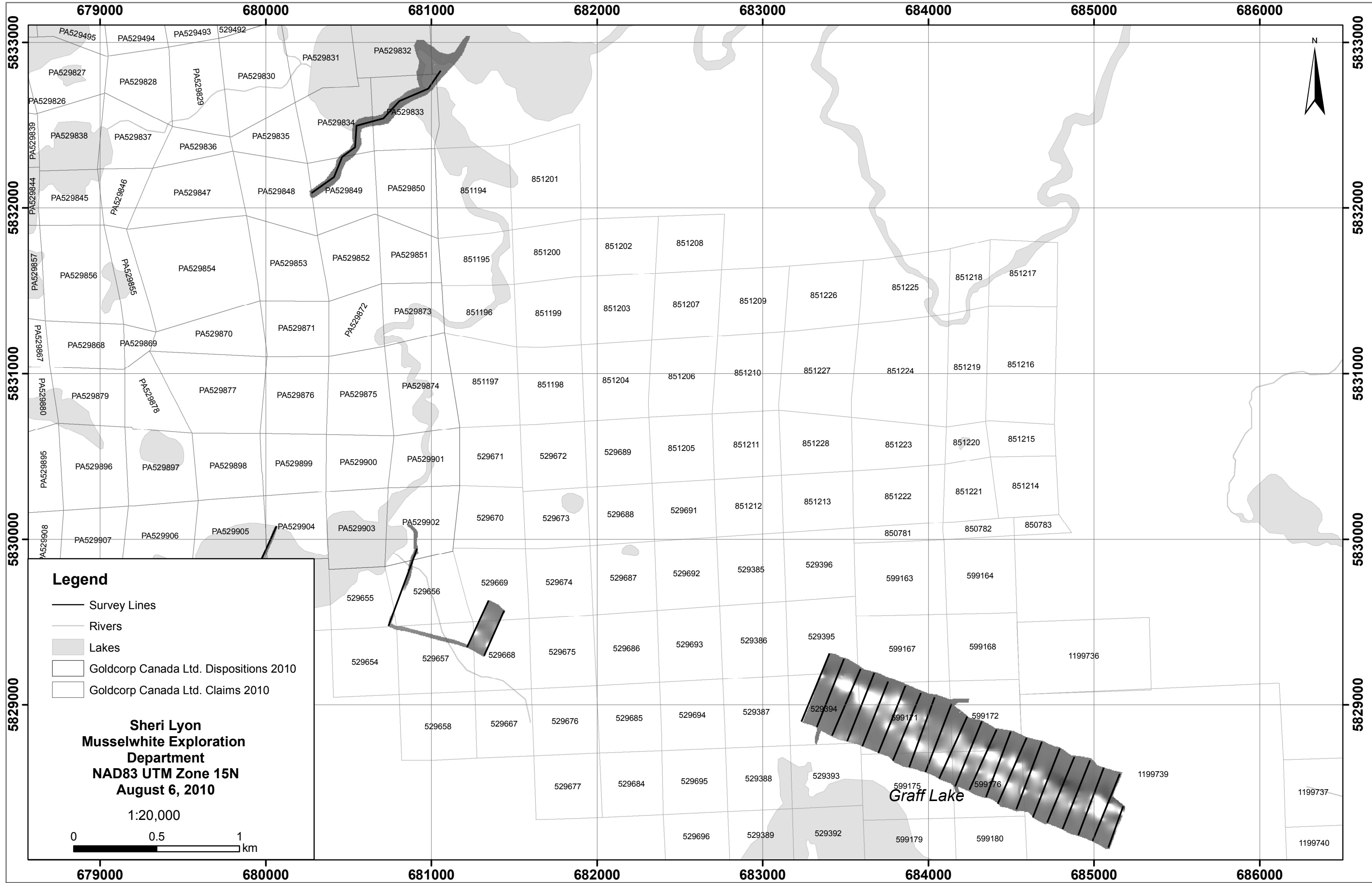

Legend

- Survey Lines
- Rivers
- Lakes
- Goldcorp Canada Ltd. Dispositions 2010
- Goldcorp Canada Ltd. Claims 2010

**Sheri Lyon
Musselwhite Exploration
Department
NAD83 UTM Zone 15N
August 6, 2010**

1:20,000

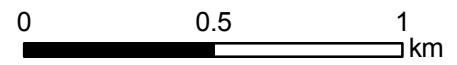

Graff Lake