

2 · 48612

NTS 31 M/5

**VLF-EM Survey
Assessment Report**

Proteus Property

Lorrain Twp.

May 2011

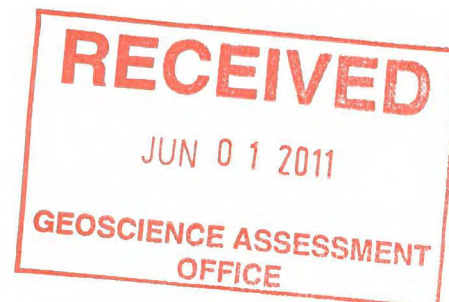

TABLE OF CONTENTS

1.0	Introduction
2.0	Property
3.0	Location and Access
4.0	VLF Survey
	4.1 Instrumentation
	4.2 Survey Results
5.0	Conclusions and Recommendations

LIST OF FIGURES

Figure 1 Claim and Grid Map 1:5000

LIST OF MAPS 1:2500

VLF Profiles map - NAA Cutler, Maine

1.0 INTRODUCTION:

From May 11 to 20, 2011 a program of linecutting and geophysical surveying was carried out on the Proteus Property situated in Lorrain Twp. The objective of the work was to map the electrical characteristics as they relate to structurally controlled epigenetic gold deposits. The property is held by Intervia Inc. Suite 612-401 3702 South Virginia Street, Reno, Nevada USA. The geophysical work was executed by David Laronde and D'Arcy Ryan of Meegwich Consultants Inc. P.O. Box 482, Temagami, Ontario POH 2H0. Laronde authored this report.

The lines were cut by Pactole Exploration of Val D'Or, P.Q. and are considered to be good quality considering the thick deadfall prevalent on this section of the property.

A total of **7.40 km** of new line was cut and surveyed.

2.0 PROPERTY:

The work was done on three mining claims found in lots 1 and 2 in Concessions 11 and 12 of Lorrain Twp. The claims are numbered as follows:

Claim No.	No. of units	Due date
4248871	7	May 18, 2012
4242314	1	June 19, 2011
4248375	1	July 8, 2012

Larder Lake Mining Division
NTS 31 M/5

3.0 LOCATION AND ACCESS:

The property is located 5 km southeast of the town of Cobalt as the crow flies. Access is done by first taking Hwy 567 south from North Cobalt for about 6 km then turning west onto a new logging road that is gated. At a mileage point 1.3 km there is an ATV trail that heads northwest to the northeast corner of the grid.

4.0 VLF Electromagnetic Survey:

A total of **7.40 km** was surveyed for a total of 294 readings taken at 25 meter stations.

4.1 Instrumentation: A Geonics VLF-EM receiver was used for the survey. The VLF transmitter station was Cutler, Maine NAA transmitting at 24.0 kHz. The measured quantities are the in-phase and quadrature components of the vertical magnetic field measured as a percentage of horizontal primary field (read to a resolution of +/- 1%). All readings were taken facing north.

4.2 Survey Results: The results of the survey are presented in profile format on plans at 1:2500 scale.

In many cases weak VLF conductors are electrolytic (bedrock shears and fractures, overburden filled bedrock troughs and valleys) or poorly connected metallic grains such as stringer sulphides.

The weak conductor found on the north central part of the grid would likely fall into this category. The conductor is 400 to 500 meters in length and trends more or less parallel to the baseline. Most of the grid gave a flat response.

5.0 CONCLUSIONS AND RECOMMENDATIONS:

The VLF-EM survey yielded one interesting conductor that may represent a fault or structure. In this area epigenetic gold is known to occur in narrow discontinuous zones concordant with the lithology. Structure enhances the permeability of local volcanic geology and is thus critical in placement of mineralized fluids containing gold.

Further work should extend the grid to cover off the entire property and map structure with VLF and magnetic surveys. An induced polarization survey is then recommended to test for sulphides in and around detected structure.

References

Geological map 1 inch to four miles OGS Sudbury-Cobalt – Geological
Compilation Series

1986 Robert Cintis Geologic Report on the Proteus Resources Inc. – Ruby
Valley Property

CERTIFICATE OF AUTHOR

I, David Laronde of the town of Temagami, Ontario hereby certify:

1. That I am a geology engineering technologist and have been engaged the mineral exploration industry for the past 31 years.
2. That I am a graduate of Cambrian College in Sudbury with a diploma in Geology Engineering Technology 1979.
3. That my knowledge of the property described herein was acquired by field work and documentation.

Dated at Temagami this 20th day of May 2011.



David Laronde

604000E 604100E 604200E 604300E 604400E 604500E 604600E 604700E 604800E 604900E

5248900N 5248800N 5248700N 5248600N 5248500N 5248400N 5248300N 5248200N 5248100N 5248000N

BL 0

L900 N

L800 N

L700 N

L600 N

L500 N

L400 N

L300 N

L200 N

L100 N

L0 N

BL 0

4248871

4248745

4242314

4255504

T975

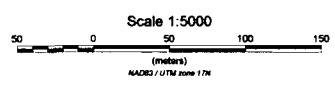
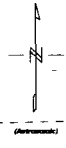

INTERVIA INC. PROTEUS PROPERTY		
LORRAIN TOWNSHIP, ONTARIO LARDER LAKE MINING DIVISION		
CLAIM AND GRID MAP		
Data Processing and Interpretation by: Meegwich Consultants Inc.	SCALE 1:5000 MAY 2011	NTS 31 M/05

RECEIVED
 JUN 01 2011
 GEOSCIENCE ASSESSMENT
 OFFICE

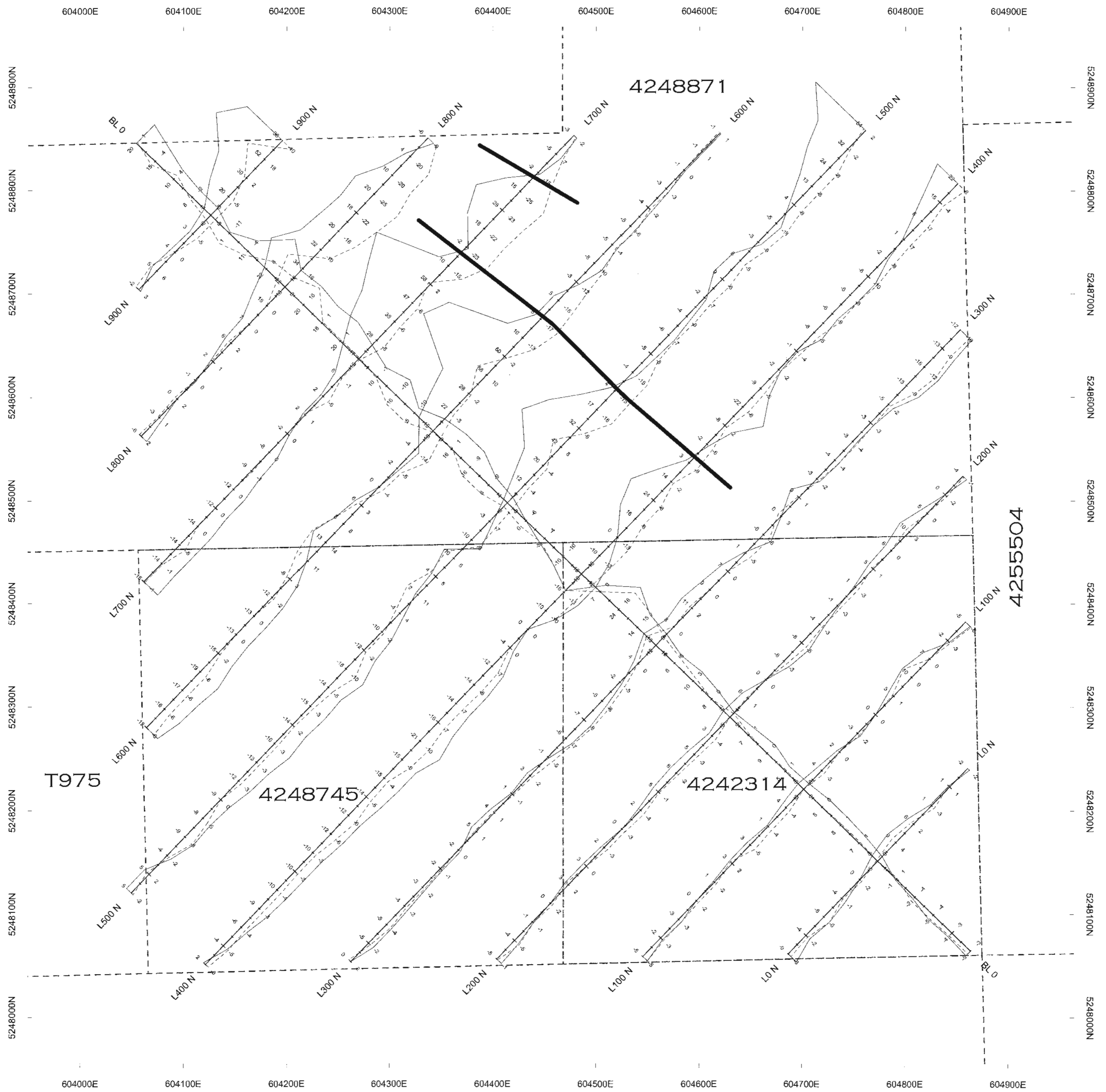
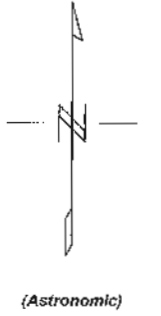

Instruments:
 Geonics EM-16 VLF Receiver Serial #10595
 VLF Station: NAA 24.0 kHz Cutler Maine

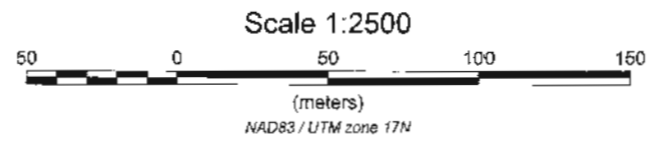
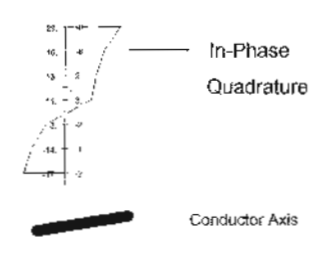

INTERVIA INC.		
PROTEUS PROPERTY		
LORRAIN TOWNSHIP, ONTARIO		
LARDER LAKE MINING DIVISION		
VLF - EM SURVEY		
PROFILES OF THE IN-PHASE AND QUADRATURE		
Data Processing and Interpretation by:	SCALE 1:2500	NTS 31 M/05
Meegwich Consultants Inc.	MAY 2011	