

2 • 4 9 0 2 5

PACIFIC IRON ORE CORPORATION

Suite 1 – 1546 Pine Portage Road

Kenora, Ontario P9N 2K2

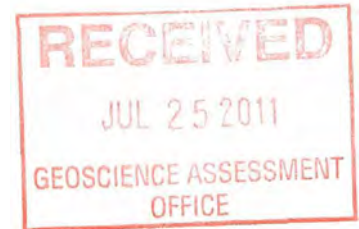

WITCH BAY PROPERTY GEOLOGY REPORT

CODE TOWNSHIP (G-1326)

Kenora Mining Division – 10 – Ontario

NAD 83, Zone 15

Map Reference: 52 E/09SE

By

Alasdair J. M. Mowat, C.E.T.

July 21, 2011

(--- 1 ---)

PACIFIC IRON ORE CORPORATION

-WITCH BAY PROPERTY-

GEOLOGY REPORT

Code Township (G.1326)

NTS 52 E/09 SE

NAD 83, Zone 15

414000m E, 5496000m N

Kenora Mining Division – 10 – Ontario

Project/Property: Witch Bay (Code)

Mineral Commodities: Gold, Copper, PGE

Mining Claim Surveyed: 4224478 (16 claim units – 256 hectares) – recorded January 24, 2008

Claim Ownership Status: 100% Pacific Iron Ore Corporation

Date of Field Surveys: July 13 and 14, 2011; core logging drill hole WB-01 July 17, 2011 and, report July 22 and 23, 2011.

INTRODUCTION

The 256 hectare (1 block claim – 16 units) property is located in Code Township (G-1326) in Ontario's Kenora Mining Division – 10 (fig. 1 & 2).

The claim is located about 20km southeast of the City of Kenora in the northwest quarter of Code Township south of Le May. Access to the property is by Hwy's # 17 and # 71 to the signed Witch Bay (Wendigo Mine) Road turn off. A road/trail takes one west to the historical Witch Bay Mine site lying just south of Kite lake.

(--- 2 ---)

The vegetation is quite mixed from jack pine, spruce, hemlock, poplar, white birch and low bush of juniper, alder and moose maple. The area has been timbered and the re-growth does not look healthy.

Highlights –

1/. The property contains the old *Witch Bay Mine* which lies about 2.5km northeast of the past producing *Wendigo Gold-Copper Mine*, the second largest gold producer in the region next to the *St. Anthony Gold Mine*. The *Wendigo Mine* was in operation from 1899 to 1943 producing 67,000 oz of gold, 14,760 oz of silver and 1,866,246 lb of copper from 206,504 tons milled. The average grade of the ore milled was 0.33 oz gold/ton.

2/. The *Witch Bay Mine* was discovered in the early 1930's. A Government report's assays from the quartz vein from 8.2 to 29.5 g/mt across 0.33m (1.1 ft) over a known length of 240m (787 ft). No production recorded. Chalcopyrite is present in the quartz vein at the No. 2 Shaft.

AREA GEOLOGY

The *Witch Bay* property lies in the *GIBI LAKE AREA* which comprises the eastern part of the Lake of the Woods Metavolcanic-Metasedimentary Belt within the western part of the *Wabigoon Subprovince* of the *Superior Province*.

The belt consists generally of easterly to north-easterly isoclinally folded meta-volcanics and – sediments intruded by mafic to ultramafic and intermediate to felsic intrusions. An example is the gold-copper mineralization at the *Wendigo Mine* which is associated with folded, differentiated and ultramafic to mafic intrusions/extrusions. The Mine development lies on the outside of the south limb of a large "S" fold structure.

The vast majority of the various rock units have been metamorphosed from the greenschist to lower amphibolite.

These ultramafic to mafic units were later intruded by granites; example, the *Dryberry Batholith* which deformed and re-oriented the earlier developed isoclinal and anticlinal folds.

The area's major shearing/faulting is east and north-easterly with minor sets striking north-westerly.

AREA'S EXPLORATION HISTORY

Historically, the area was prospected for gold during the late 1800's continuing into the early 1930's. This resulted in 4 gold discoveries; the Stella, Trigs, Wendigo and Witch Bay mines. Considerable trenching and underground work was performed at all the above sites. The Wendigo Mine (1899 to 1943) was the only gold-copper producer in the area.

After the former years of prospecting and mine development; exploration activities in the area has been sporadic to none existent up to the present. Work consisted of additional pitting, trenching, geological mapping, drilling and geophysics. The primary areas of geological interested being held in old mining claim patents and leases.

WITCH BAY MINE

The Witch Bay Gold Mine (1934) is situated about 30m south of Kite Lake. The main showing consists of lenticular masses of white quartz occupying a shear zone in basalts. The exposed zone had a length of 280 feet striking N 85 degrees E and dipping 45 to 70 degrees south. The maximum surface width of the quartz is about 1.5 ft. Three shafts were sunk on this vein starting with No.1 on the west, No. 2 and No. 3 on the east. The No. 2 had the best gold encouragement and was deepened. A mill plant was installed but work was discontinued in the winter of 1935.

South of this quartz bearing fault zone is a well pronounced rusty shear zone in basalt striking N 60 degrees E dipping 57 to 80 degrees NW. The No.4 shaft was developed at the south end.

Between 1950 and '53, Rexora Mining Corp. Ltd. conducted geological mapping, diamond drilling and trenching. In 1985, Mistango Consolidated and Goldstreet Resources Ltd carried out additional geological mapping and drilling. Canadian Nickel Company Ltd. (Fort Knox Resources) in 1987 performed geological mapping, rock assaying and geophysical work north of the Witch Bay Mine.

DISCUSSION

The author with assistance spent July 13 and 14 in the field conducting a geological ground review and on July 16 logging drill hole # WB-01. The survey started from the west claim boundary zigzagging easterly crossing over the Witch Bay mine site.

(---4---)

The purpose of the field survey was to establish a starting point for a control geological/rock sampling grid line at +/- right angle to the north-easterly strike of the geology trend of this area. The author's economic focus is the layered ultramafic unit. The eastern flank of this unit strikes more or less north-easterly starting south of the Wendigo Mine passing west of the Witch Bay Mine site. These 2 mine sites lying just west of the ultramafic body as does the Stella prospector to the west on the western flank of this stated body.

The property is dominated by 3 geological rock units. The northern portion of the property is dominated by the intrusive Dryberry Batholith. This intrusive body is biotitic, medium grained, equigranular and pink to red in colour.

South of the interfingering Dryberry Batholith Occupying is a north-easterly striking gabbroic unit with a narrow veneer of peridotite underlying the gabbro's eastern flank. The gabbro is massive, equigranular, medium to coarse grained and green to dark green in colour.

Underlying the peridotite are basalts. These basalts consist of massive and porphyritic (plagioclase crystals) flows and pillows. They are dark green to green and fine grained. These volcanic rocks comprise about 60% of the south-east end of the property.

The bedding contacts strike +/- 51 degrees dipping about 70 to 80 degrees facing south-easterly. In most cases, the individual contacts are marked by an escarpment.

On examining the Witch Bay Mine # 2 shaft, the east trending shear zone is about 1.5m wide in basalt. The quartz-calcite vein lenses are fractured and annealed with sulphides of chalcopyrite and pyrite.

During the course of the ground survey, eight rock samples were removed and their location GPS. Previous diamond drill hole # WB-01 (2009) was logged and sampled (4 samples) on July 17, 2011. All these samples were submitted on July 17 to ALS Chemex, Thunder Bay, Ontario for PGM-ICP23, ME-MS61 and ME-MS81d analysis. The 12 samples were shipped by Greyhound Bus courier from Kenora to Thunder Bay for analytical preparation.

Between September 18 and 19, 2009 Jim Resky of Kenora, Ontario started on drill hole #WB-01 (2009). Unfortunately, as a result of mechanical problems had to abandon the drill hole at 3.75m. The hole was located 4 m east and 5 m south of the Witch Bay # 2 shaft facing 360 degrees (north), set at -45 degrees. The hole was planned for 20m to cut the 45 south dipping Au, cp bearing zone and obtain fresh material for examination and analysis.

The core was logged on July 17, 2011 after photographing. Due to the size of the drill core –

(---5---)

20mm – all 100% of the material was submitted for analysis (4 assays). The material was fine grained, green to green-grey basalt, silicified with erratic wispy veinlets of calcite and/or quartz.

Visible sulphide of chalcopyrite and pyrrhotite is limited to about 0.5% of the rock massive in the disseminated form of fine grain specks. Limonite gossan occupies the fracture seams of this brittle rock at 30-45 and 60 degrees to the core axis (c.a.). The 30-45 degree set proceeds the 60 degree 2nd set. Except for a 30 mm visible barren quartz-carbonate veinlet at 1.39 m (60 degree c.a.), the core was boring in this early stage.

CONCLUSION

On this pass, assays are pending. A control grid line is established on the starting from the western north-south claim boundary of the property. The purpose of this line is for detail sampling, to define if a PGE-Au horizon exists in what is believe to be a layered ultramafic intrusive. The claim covers only a small portion of the north-eastern flank of the mentioned unit.

Notes:

#1: Both Spring and Summer weather conditions and concerns for forest fire outbreaks has hindered an early start to the 2011 exploration program.

#2: With follow-up GPS locating, the western claim boundary of Pacific Iron's claim #4224478 is contiguous to the #2 tagged post of claim #1178196 and #1 tagged post of claim #3014900. As shown on the MNDM&F Code Township claim map, there is a field claim discrepancy of 131m west and 56m south to the actual claim locations.

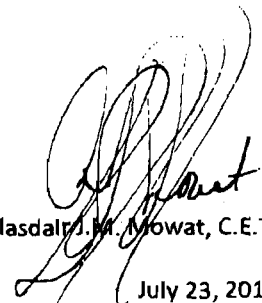

Alasdair M. Mowat, C.E.T.
July 23, 2011

Kenora, Ontario

(--- 6 ---)

SURVEY INFORMATION

| Station # | UTM 15 Co-Ordinates | | Description |
|--------------|---------------------|----------|--|
| | Easting | Northing | |
| 1 | 413002m | 5496039m | - western claim boundary of 4224478 and #1 post of 3014900 and #2 post of 1178196 |
| 2 | 413007m | 5496008m | -gabbro outcrop (#1-sample #57901) |
| 3 | 413046m | 5495970m | -set-up control grid line @ 130 degrees |
| 4 | 412992m | 5495959m | -gabbro outcrop (#2-sample #57902) |
| 5 | 412998m | 5495992m | -4x3x3m deep prospecting pit on 90 degree narrow shear zone, dipping 75 degrees south - 20 to 30mm qtz-calcite veinlets, 2-3% py, po and cp (#3-sample #57903) |
| 6 | 413045m | 5495981m | -gabbro outcrop #3 |
| 7 | 413055m | 5495970m | -gabbro outcrop (#4-sample #57904) |
| 8 | 413149m | 5496000m | -gabbro outcrop (#5-sample #57905) |
| 9 | 413345m | 5496006m | -Witch Bay Mine #2 shaft east side quartz-calcite vein With py, cp and po (#6-sample #57906) |
| 10 | 413451m | 5495943m | -basalt at top of fault escarpment striking 95 degrees, dipping 60 degrees south (#7-sample #57907) |
| 11 | 413753m | 5495969m | -basalt, 15m wide shear zone striking 72 degrees (#8-sample #57908) |

OTHER

| | | | |
|-------|---------|----------|---|
| WB-01 | 413349m | 5496001m | -2009 drill hole east and south of Mine Shaft #2 (sample #57909 to #57912) |
|-------|---------|----------|---|

(--- 7 ---)

TABLE OF CONTENT

Figures

- 1/. Witch Bay location map**
- 2/. Copy of Code Township (Witch Bay) claim map**
- 3/. Witch Bay Geology Map of Outcrops 1-4**
- 4/. Witch Bay Geology Map Sketch of Outcrops 5-8**
- 5/. WB-01 Drill Log**
- 6/. Cross-Section of WB-01**
- 7/. Geological Legend and Abbreviations**
- 8/. Geological Symbols**

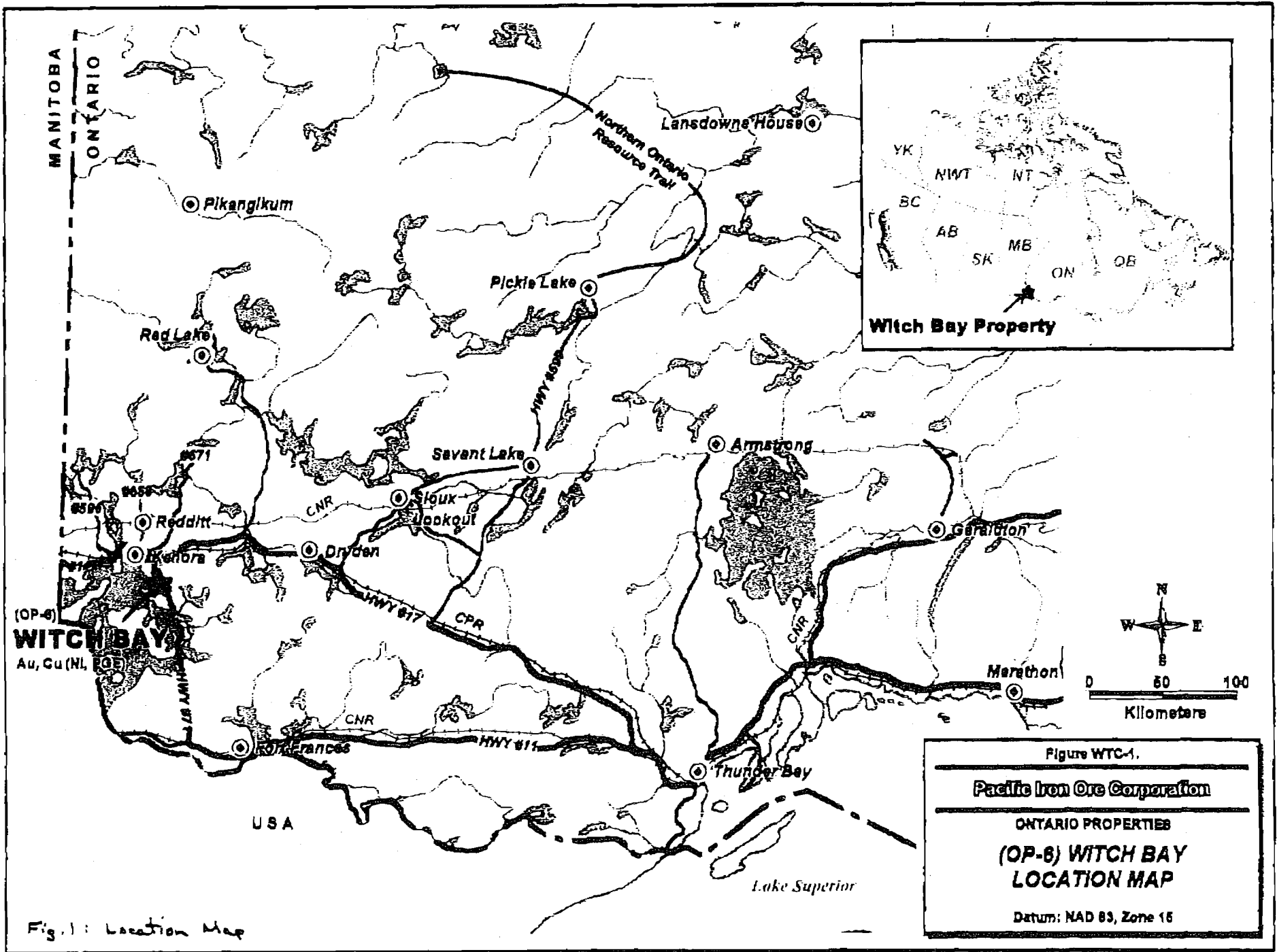

Fig. 1: Location Map

Date / Type of Issue: 1990 JUN 13 12:57:15 EDT 2011

TOWNSHIP / AREA
CODE

PLAN
O-1328

ADMINISTRATIVE DISTRICTS / DIVISIONS

Mining Division
Land Titles/Registry Division
Ministry of Natural Resources District

Kenora
KENORA
KENORA

TOPOGRAPHY

- Watercourse (Unshaded)
- Road
- Utility Line
- Section Boundary
- Township Corner
- Township Quarter Corner
- Township Quarter Corner
- Township Quarter Corner

Land Tenure

- Section Not Being Right
- Mining Patent Only
- Section Not Being Right
- Mining Patent Only
- Claim Not Specified
- Section Right Only
- Mining Patent
- High Claim Point
- Township Quarter
- LAND TENURE WITHDRAWALS

- Section Withdrawal
- Claim Withdrawal
- Section Withdrawal
- Claim Withdrawal

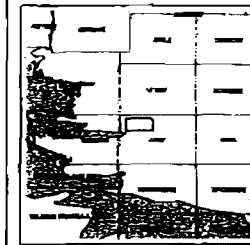

LAND TENURE WITHDRAWAL DESCRIPTIONS (Not necessarily complete)

| Withdrawal No. | Type | Date | Description |
|----------------|---------|-------------|--|
| 1178196 | Section | 1990 Jun 13 | Section 10 Township 18S, Range 30E, District 103 |
| 3014900 | Section | 1990 Jun 13 | Section 10 Township 18S, Range 30E, District 103 |

PACIFIC IRON ORE CORPORATION
Witch Bay Property

Fig. 2

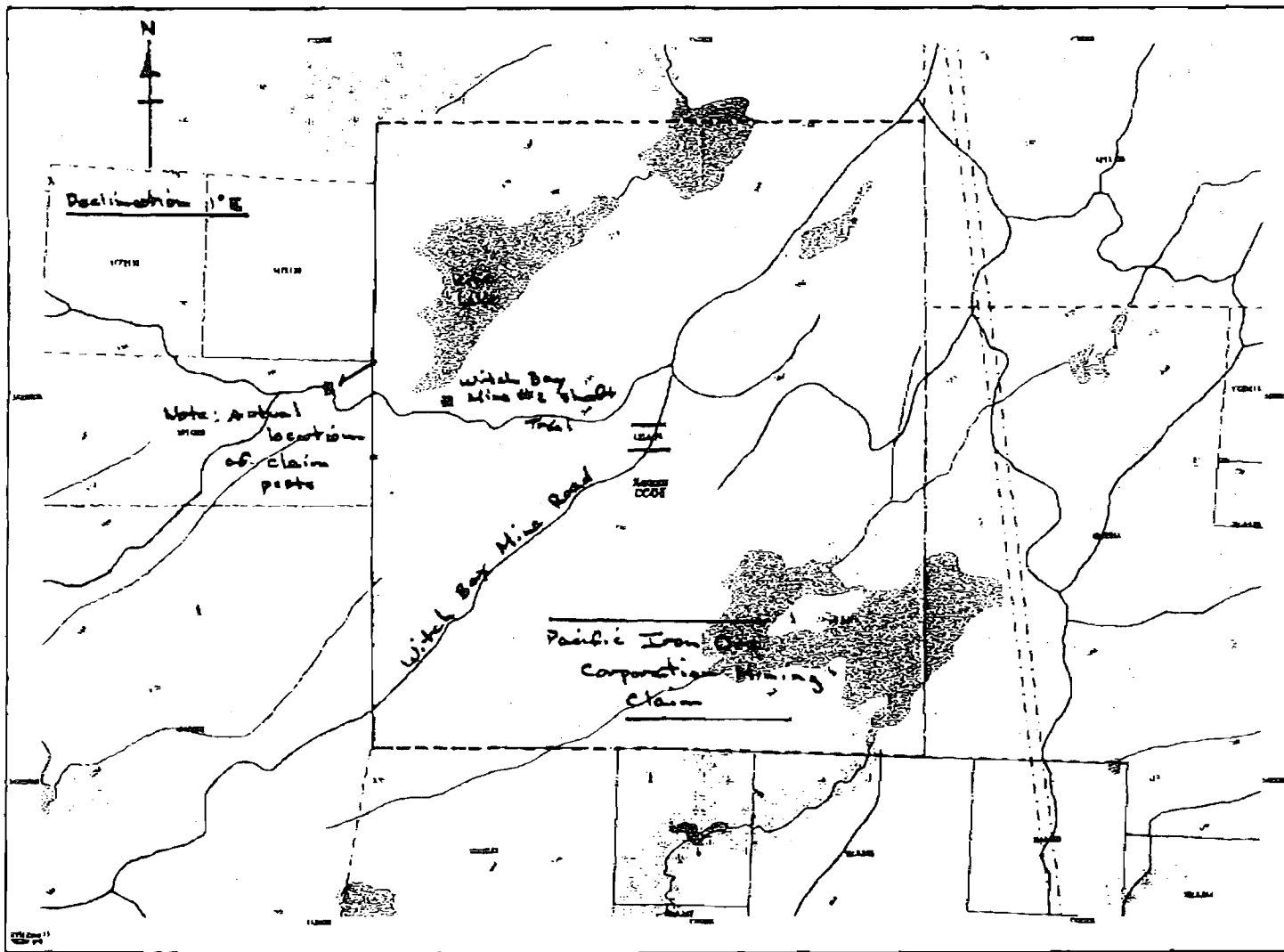

This property is held by the Crown (Canada) and the Provincial Mining Association (CMA) at the Ministry of Northern Development and Mines for settlement.
 The map is not intended to be used for legal purposes. For more information, please contact the Ministry of Northern Development and Mines.
 This map is intended for general information only. It is not intended to be used for legal purposes. For more information, please contact the Ministry of Northern Development and Mines.

General Information and Utilization
 Provincial Mining Association (CMA)
 Mining Division
 Ministry of Northern Development and Mines
 400 University Ave. Toronto, Ont. M5G 1S4
 Tel: (416) 326-3200
 Fax: (416) 326-3201
 Email: mining@ndm.gov.on.ca

This map was prepared and printed at the Ministry of Northern Development and Mines.
 The map is not intended to be used for legal purposes. For more information, please contact the Ministry of Northern Development and Mines.

Note: The actual location of the corner posts for mining claims 1178196 and 3014900, as found in the field, are 131 m west and 56 m south as noted above.

Received
JUL 25 2011 03:58PM

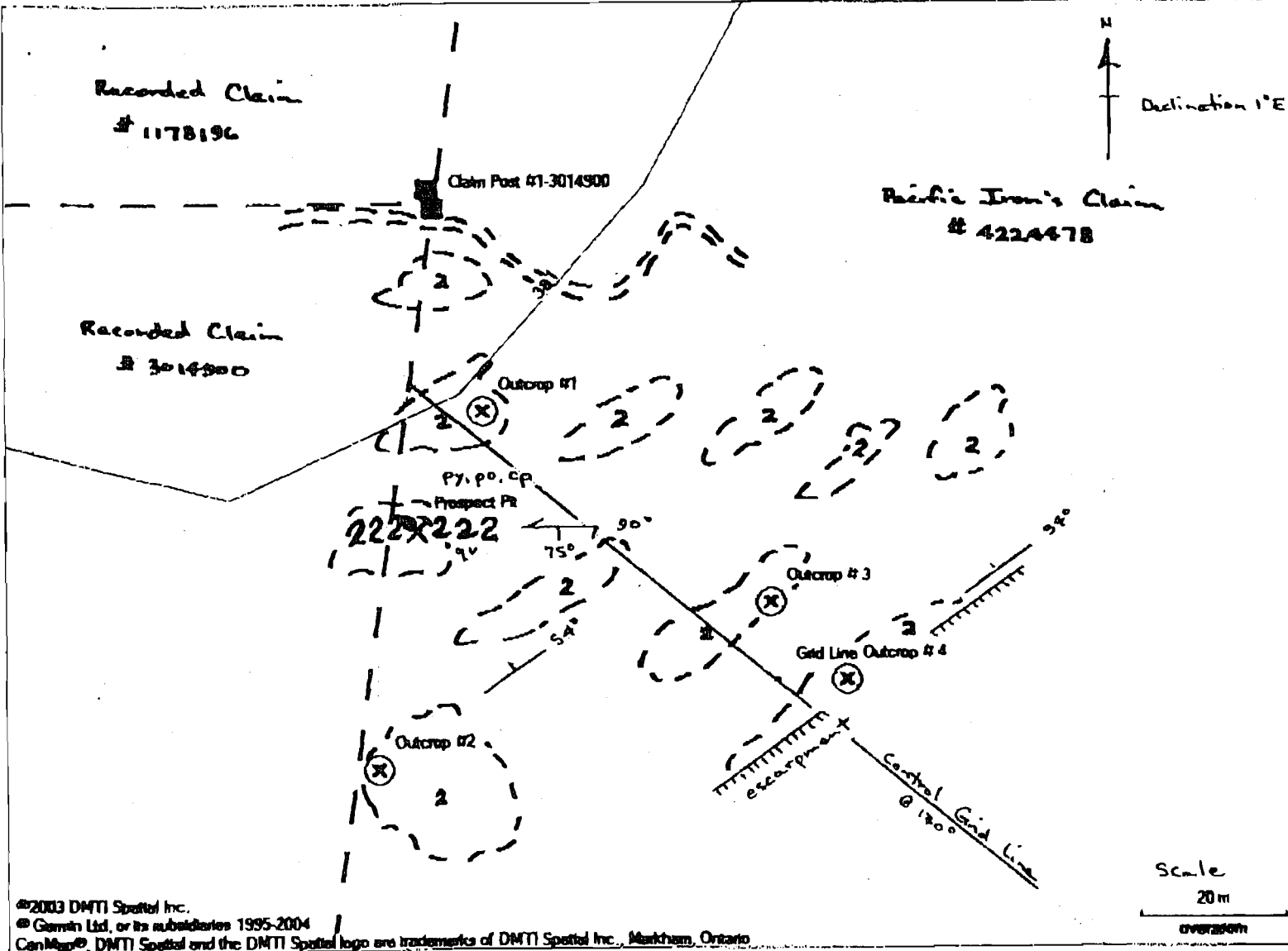

©2013 DMTI Spatial Inc.
 © Garmin Ltd. or its subsidiaries 1995-2004
 CanMap®, DMTI Spatial and the DMTI Spatial logo are trademarks of DMTI Spatial Inc., Markham, Ontario

PACIFIC IRON ONE CORPORATION
 Witch Bay Geology
 Map of Outcrops 1-4

PHANEROZOIC

CEPOZOIC

QUATERNARY

RECENT

alluvium, lake and stream deposits

PLEISTOCENE

sand, gravel and clay

PRECAMBRIAN - ARCHEAN

①

granite intrusions

②

igneosity to metamorphic terranes (gneiss, amphibolite)

③

metamorphic rocks (quartz - mica and sillimanite)

ABBREVIATIONS

Al field Cr Quarry cp Control Grid

SYMBOLS

- outcrop
- geological contact
- shaft
- trail
- road
- stream
- mark
- survey post
- iron mine
- claim line
- topographical contour
- elevation
- hydro line

Fig. 3

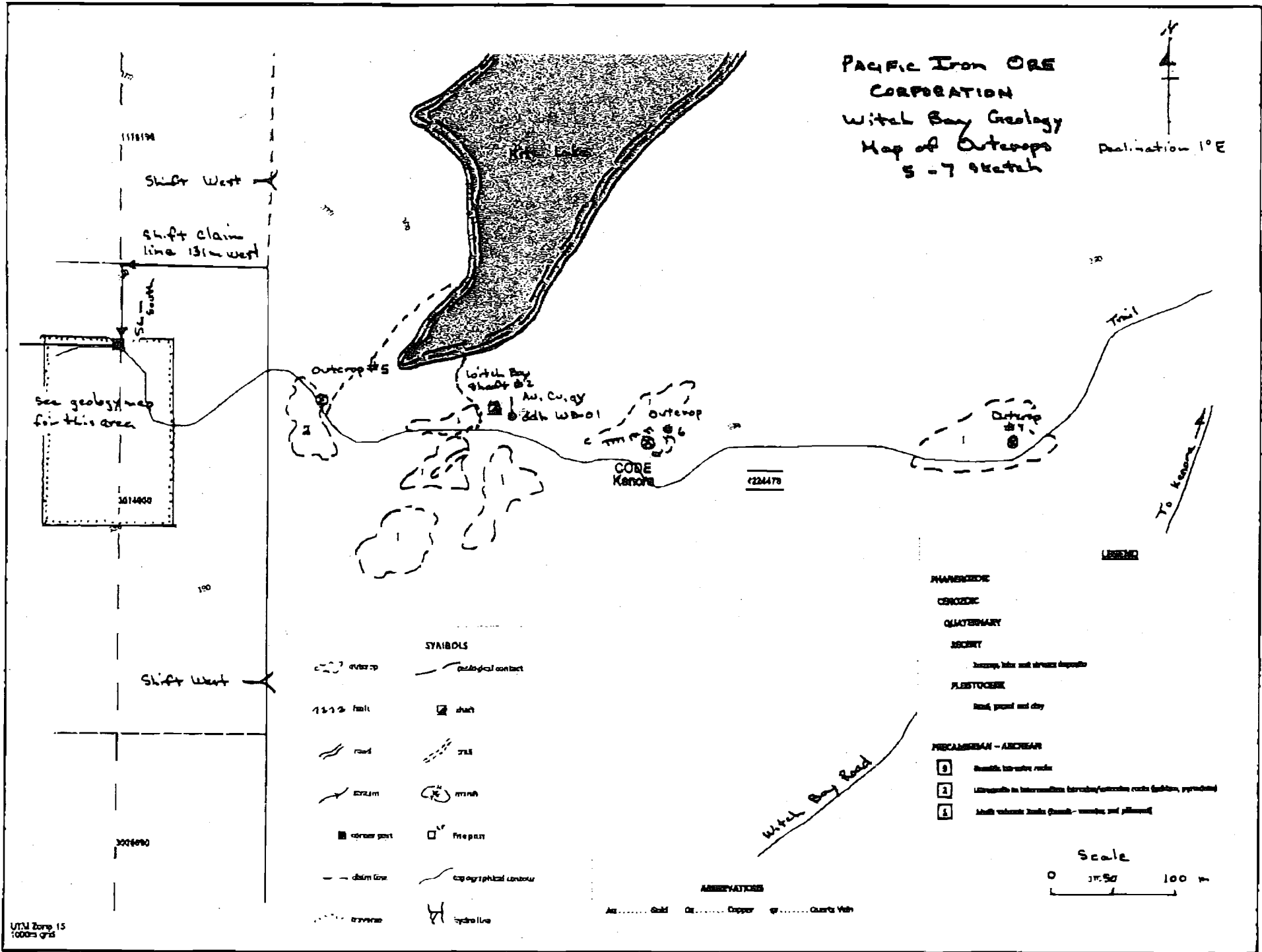

Fig. 4



Ministry of
Northern Development
and Mines

Ministère du
Développement du Nord
et des Mines

Drill Log
Journal de forage

Fig. 5

Page 1 of 1

Under section 8 of the Mining Act, this information is used to maintain a public record. / Aux termes de l'article 8 de la Loi sur les mines, ces renseignements serviront à tenir à jour les dossiers publics.

Received

Jul 25 2011 03:59pm

| | | | | |
|--|---|---|--|--|
| Hole ID / Forage n° WB-01 (2009) | Claim No. / N° de concession minière K.4224478 | Township/Area / Canton Code Tp (G.1326) | | |
| Name of Land Holder / No. de Pacific Iron Ore Corporation Kenora, Ontario | Azimuth 360° | Dip / Inclinaison 45 N° | End of Hole (m) / fin de forage (m) 3.75m | Overburden Depth / profondeur des meris- terraïne 0.13m |
| Drilling Company / Compagnie de forage Jim Resky Kenora, Ontario | Logged by (print) / inscrit par (écrire en lettres majuscules) Alistair Mowat, C.E.T. | | Core Size / Dimensions de la carotte 20mm | Collar Elevation / Élévation du collier +/-380 |
| Date Hole Started (start/commencé) / Date de commencement du forage (commencé) | Date Completed (finish/terminé) / Date d'achèvement (terminé) | Date Logged (written/écrit) / Date d'inscription au journal (écrit) | Location of Core Storage / Endroit où la carotte est stockée 100% core assayed (Actlabs) | |
| 2009-09-18 | 2009-09-19 | 2011-07-17 | | |

| DRILL HOLE COLLAR LOCATION CO-ORDINATES / COORDONNÉES DU COLLIER DE TROU DE FORAGE | |
|--|--|
| <u>UTM / MTU</u> | <u>Latitude / Longitude</u> degrees/minutes/seconds or decimal values degrés/minutes/secondes ou valeurs décimales |
| Datum: <input type="checkbox"/> NAD 27 <input checked="" type="checkbox"/> NAD 83 | Datum: <input type="checkbox"/> NAD 27 <input type="checkbox"/> NAD 83 |
| Zone: <input checked="" type="checkbox"/> 15 <input type="checkbox"/> 16 <input type="checkbox"/> 17 <input type="checkbox"/> 18 | Latitude: |
| Northing / Ordonnée: 5496001m | Longitude: |
| Easting / Abscisse: 413349m | |

| Footage/Avancement | Rock type / type de roche | Description (Colour, grain size, texture, minerals, alteration, etc.) / Description (Couleur, granulométrie, texture, minéraux, transformation, etc.) | Planar Feature Angle ° / Angle des caractéristiques planes | Core Specimen Footage / Longueur en pieds des carottes prélevées | Your Sample No. / N° d'échantillon du prospecteur | Sample Footage / Niveau de prélèvement de l'échantillon (en pieds) | | Sample Length / Longueur de l'échantillon | Assays / Analyses minéralurgiques | |
|--------------------|------------------------------|--|--|---|--|--|------|--|---|----|
| | | | | | | From/De | To/A | | Au | Cp |
| 0.13 | Basalt | F.g. gn-gn gy, silicified - hard, brittle (blocky), +/- 0.5% diss.cp+po -erratic chloritic development seams <= 3 mm @ | 45 | | 57909 | 0.13 | 1.00 | 0.87m | | |
| | | -wispy calt/- qtz. veinlets <= 2 mm - 1 st set @ | 45 | | 57910 | 1.00 | 2.00 | 1.00m | | |
| | | - 2 nd set @ | 30 | | 57911 | 2.00 | 3.00 | 1.00m | | |
| | | -hair thickness limonitic fracture planes @ | 30-45 | | 57912 | 3.00 | 3.75 | 0.75m | | |
| | | -10 mm qtz-cal veinlet between 1.39-1.42m @ | 60 | | | | | | | |
| | | no visible sulphides | | | | | | | | |
| 3.75m | End of Hole | Drill break down. Hole terminated | | | | | | | | |
| | | Note: Drill core photographed prior to examination and 100% assaying | | | | | | | | |

*For features such as foliation, bedding, schistosity, measured from the long axis of the core. / *Exemples de caractéristiques: foliation, schistosité, stratification. L'angle est mesuré par rapport à l'axe longitudinal de la carotte.

"Mining Lands Website: http://www.mndm.gov.on.ca/mndm/mines/lands/default_e.asp
"Site Web de la Section des terrains miniers: http://www.mndm.gov.on.ca/mndm/mines/lands/default_f.asp"

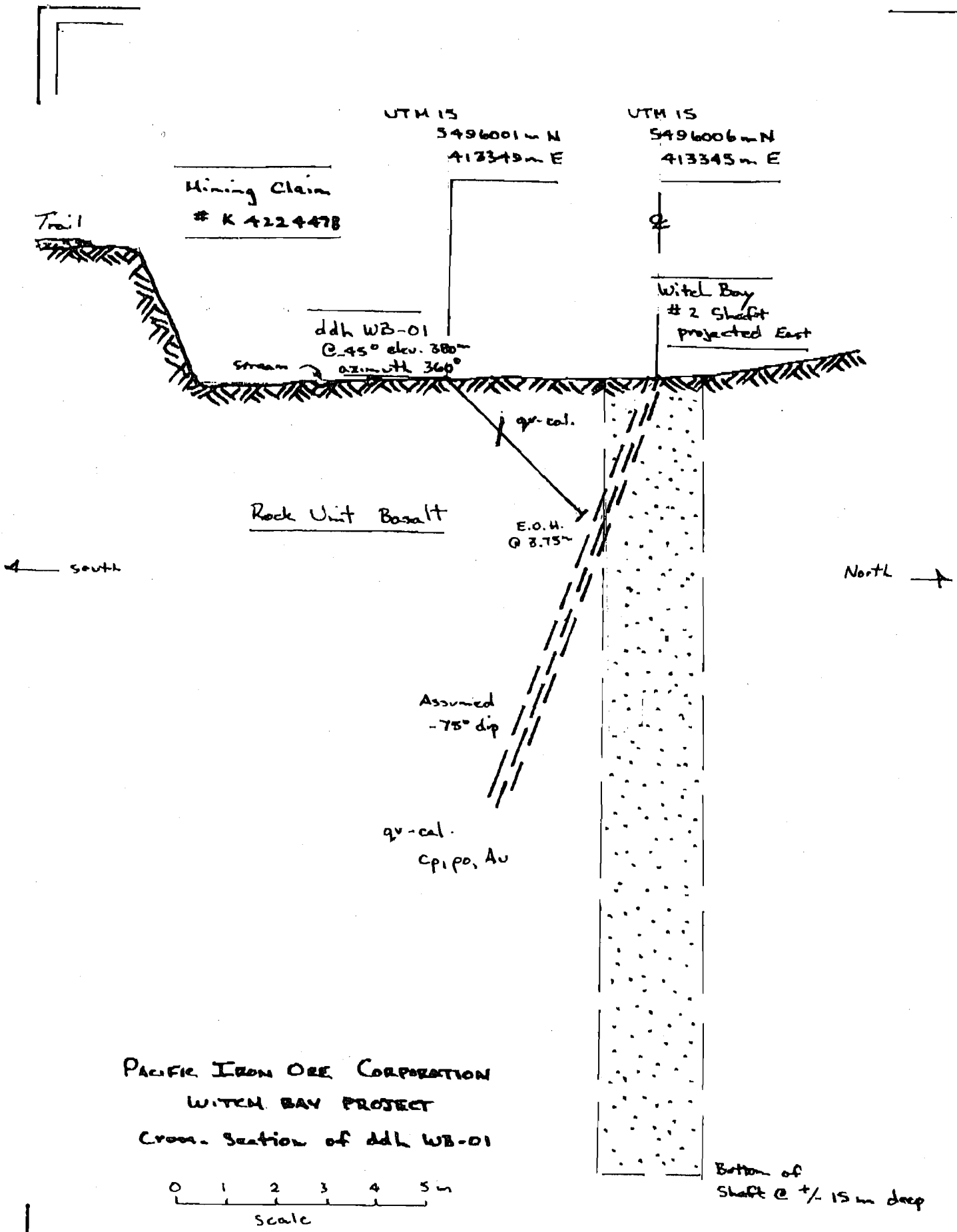

PACIFIC IRON ORE CORPORATION
 WITEL BAY PROJECT
 Cross-section of ddh WB-01

0 1 2 3 4 5 m
 scale

OBSERVER LOOKING WEST

Fig. 6

LEGEND

PHANEROZOIC

CENOZOIC

QUATERNARY

RECENT

Swamp, lake and stream deposits

PLEISTOCENE

Sand, gravel and clay

PRECAMBRIAN – ARCHEAN

- 3 Granitic intrusive rocks
- 2 Ultramafic to Intermediate intrusive/extrusive rocks (gabbro, pyroxinite)
- 1 Mafic volcanic Rocks (basalt – massive and pillowed)

ABBREVIATIONS

Au Gold Cu Copper qv Quartz Vein

Figure 7: Geological Legend and Abbreviations

SYMBOLS

outcrop

geological contact

fault

shaft

road

trail

stream

marsh

corner post

line post

claim line

topographical contour

traverse

hydro line

Figure 8: Geological Symbols