

519,450 mE 519,500 mE 519,550 mE 519,600 mE 519,650 mE 519,700 mE

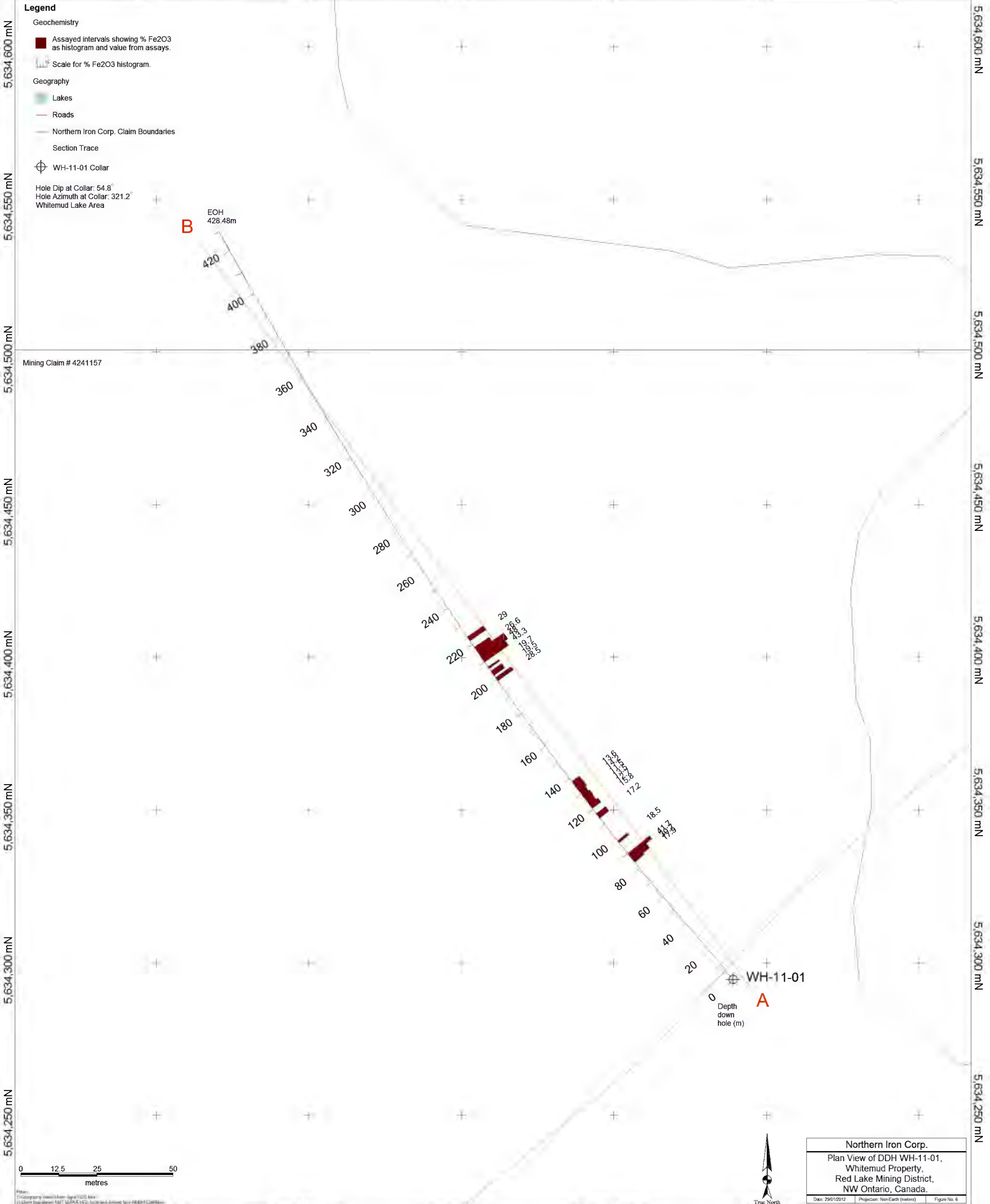

**Legend**

**Geochemistry**

- Assayed intervals showing % Fe2O3 as histogram and value from assays.
- Scale for % Fe2O3 histogram.

**Geography**

- Lakes
- Roads
- Northern Iron Corp. Claim Boundaries
- Section Trace
- WH-11-01 Collar

Hole Dip at Collar: 54.8°  
 Hole Azimuth at Collar: 321.2°  
 Whitemud Lake Area

**B** EOH  
428.48m

**A** WH-11-01

Depth down hole (m)

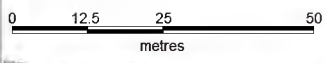

Northern Iron Corp.  
 Plan View of DDH WH-11-01,  
 Whitemud Property,  
 Red Lake Mining District,  
 NW Ontario, Canada.  
 Date: 29/01/2012 | Projection: Non-Earth (metres) | Figure No. 6

519,450 mE 519,500 mE 519,550 mE 519,600 mE 519,650 mE 519,700 mE

5,634,600 mN  
5,634,550 mN  
5,634,500 mN  
5,634,450 mN  
5,634,400 mN  
5,634,350 mN  
5,634,300 mN  
5,634,250 mN

5,634,600 mN  
5,634,550 mN  
5,634,500 mN  
5,634,450 mN  
5,634,400 mN  
5,634,350 mN  
5,634,300 mN  
5,634,250 mN