

South Case Pegmatite Dike
2010 & 2011 Work Assessment Report

Claim L-1214668

Steele Township (G-3571) / Larder Lake Mining Division

NTS Map Sheet 32 E/4
49-02 N 79-55 W

Submitted By:

Peter M. Hermeston
(Lic. 1003623)



September 14th 2011

2.49595

Forward:

The assessment work detailed in this document addresses four mandays of prospecting, mapping, and sampling, along with the subsequent assayed results. The exploration work was performed over the Hermeston portion of what is known as the "South Case Pegmatite Dike" (SCPD).

The field work was accomplished on October 26th, 2010, and July 21st 2011, with the assistance fellow prospector, Ed Shynkorenko (Lic. M-25405) who also assisted with the preparation of this document.

All required illustrations/maps are contained separately within the Appendices of this document.

Expenditure rates for work, transportation, etc., were based upon industry standards.

Based on the results of the data compiled, further work and sampling will be undertaken on the subject area in 2012 which may involve the extension of a previously developed trench situated within the said eastern extremity of the dike.

This document acknowledges previous assessment work/reports filed by other parties.

Table of Contents

Introduction/History:	Page (i)
List of Illustrations:	Page (i)
Location:	Page (i)
Access:	Page (i)
Regional Geology:	Page (ii)
Work Program / Daily Log:	Page (ii)
Conclusion & Recommendations:	Page (iv)
Author's Qualifications:	Page (iv)
Communications (Direct/Indirect):	Page (iv)
References:	Page (iv)

List of Appendices

Appendix A	"Location Map"
Appendix B	"Claim Map (Key Map) Abstracts, and List"
Appendix C	"Access Map"
Appendix D	"Regional Geology Map"
Appendix E	"Assessment Work Performed on Mining Lands Form"
Appendix F	"Work Compilation Plan"
Appendix G	"Assay Certificates"

Introduction/History:

The subject 4-unit claim, being L-1214668, was staked by Peter Hermeston of August 25th 2009. The said claim encompasses approximately 19% of the South Case Pegmatite Dike (SCPD), which in turn, is an intricate part of what is known collectively as the “Case Pegmatites”. The majority of the currently known confines of the SCPD are currently situated on an adjacent staked claim under option.

Documentation pertaining to the Case Pegmatites was first made by the Ontario Geological Survey (Lumbers) in 1962. This resulted in the overall area being held under various mining claims over the decades, including a now expired mining lease that was issued to Dex Ltd.

By the year 2000, the subject work area was then held under the now expired Claim L-1227134, which was part of a larger block of staked claims jointly held by Kirnova Ltd., Navigator Exploration Corp., and Platinova A/S. During this time prospecting, mapping, and sampling efforts were ongoing.

The 2010-2011 work efforts addressed within this text includes additional prospecting and sampling of the easterly extremities of the SCPD, including a test of the muscovite mica content to better ascertain the possibility of lithium and gallium enrichment.

List of Illustrations:

All illustrations, maps, and sketches referred to in this document are labeled accordingly and are contained within the attached appendices.

Location:

As noted above, the subject area of work is contained within staked mining claim L-1214668, situated in Steele Township, District of Cochrane, Larder Lake Mining Division (*See Appendix A “Location Map”*). The recorded claim holder also holds several additional adjoining/contiguous claims in the immediate vicinity amounting to an aggregate of 22-units (*See Appendix B “Claim Map, Abstract, and List”*).

Access:

The property is situated approximately 90 kilometres east of Cochrane, Ontario. It is best accessed by utilizing Highway 652 eastward from Cochrane, Ontario and then turning east again onto the “Trans-Limit Road”; a 2.7 km. secondary road/trail system branching off northward then provides access to within a further 100 metre “bush walk” to the subject work area (*See Appendix C “Access Map”*).

Regional Geology:

As documented by several geological surveys over the years, the system of pegmatites known collectively as the “Case Pegmatites”, are situated along the contact between the northerly, granodiorite and quartz monzonite Case Batholith and the Scapa Meta-Sediments to the south (*See Appendix D “Regional Geology Map”*). The SCPD was previously described by P.C. LeCouteur, Ph.D, P.Eng (BC), in his February 2002 work report, being MNDM&F file KL-5070.

LeCouteur described the SCPD as: *“being a fairly homogenous pegmatite that consists chiefly of coarse grey K-spar (to 70 cm), interstitial quartz, minor (<5%) muscovite, scattered blue-green beryl (to 10 cm) and a little scattered rose garnet. It has a width of about 16m, strikes about 90 degrees for much of its length, and appears to have a steep dip. It contains a number of central lensy quartz segregations up to 2m long, and there has been widespread albitization of the primary K-spar, both as streaky zones parallel to the margins and in more general areas”*.

The segment of the SCPD addressed by this particular report conforms to LeCouteur’s description however it begins to strike more to the northeast, while still dipping sharply. This segment of the SCPD also appears to be positioned nearer the estimated line of contact with the above noted meta-sediments.

The subject area of work is contained within a traditional boreal setting. Forest cover includes black spruce, tamarack, and open bog in the wetter, lower areas changing to a jack pine, balsam fir, and white birch mixture over the more elevated areas of the dike. The area is drained by a slowly moving northward creek commencing at Wheat Lake to the south and emptying into Case Lake to the north.

Work Program / Daily Log:

Rationale:

The SCPD has been proven to host niobium, tantalum, and beryllium, all of which have an economic importance. The collection of additional field data prior to implementing a drill or trench program will augment what has been ascertained thus far.

Prospecting/Mapping & Sampling (Daily Log):

On October 26th 2010, the SCPD portion situated within 4-unit claim, being L- 1214668, was prospected with fellow prospector Ed Shynkorenko Lic. M-25405, (*See Appendix E “Assessment Work Performed on Mining Lands Form”*). Two rock samples were taken and assayed. The compiled data is also presented in map form (*See Appendix F “Work Compilation Plan”*).

Of the 2 samples collected, one was strictly muscovite mica. This was done in order to evaluate possible lithium and/or gallium enrichment within the lattice of the mica.

Work Program / Daily Log continued:

The chipped sample of muscovite, being STSD-001 (578377E x 5431547N) was taken near the midsection of the exposed dike. An optical estimation at this particular location suggested a 5% muscovite content of the dike's overall composition.

A chipped sample, being STSD-002 (578393E x 5431564N) was taken adjacent to a circa 1975 partially flooded trench. A few small (2cm) crystals of greenish-blue beryl were observed in the sample. Most of the trench was water filled at the time.

All recorded sample locations were taken in NAD 83.



"Portion of South Case Pegmatite Dike looking eastward"

Work Program / Daily Log continued:

On July 21st 2011, the property was again prospected by the author with the assistance of Mr. Shynkorenko. A previously reported area of possible columbite-tantalite was sought. Two samples were collected. Sample STSD-003 (578386E x 5431561N) was taken from within said existing water filled trench Sample STSD-004 (578381E x 5431551N) was taken from across the mid section of exposed dike.

In total, four samples were submitted for assaying (*See Appendix G "Assay Certificates"*).

Also, overburden sounding was undertaken adjacent to the SCPD at its most eastern extremity in order to plan a possible 2012 trenching program.

Conclusions & Recommendations:

Although the assayed results derived from the samples taken were not impressive, elevated lithium content was noted within the muscovite mica sample. The low gallium content in the SCPD muscovite mica supports the uniqueness of the neighbouring East Dike, which has mica containing an average 221 ppm gallium.

The consistent lithium grade of the SCPD samples outside of the host mica, while relatively low compared to that of the Main Dike and the North Dike, also suggests that the SCPD may be more evolved than previously believed.

Author Qualifications:

The author of this document has worked for the Ontario Northland Railway for his entire career. As he is now nearing retirement, implementing his interest in mineral exploration/development is rapidly becoming a full time post retirement occupation. This particular undertaking is his third report filed for the Case Pegmatite area.

Communications (Direct & Indirect):

Ed Shynkorenko, fellow prospector, Cochrane, Ontario.

P.C. LeCouteur, Vancouver British Columbia

References:

LeCouteur, P.C. "Geological Report on Case Pegmatite Property" (2002).

Lumbers, S.B. "Steele, Bonis, Scapa, Townships. Geological Report 8 ODM" (1962).

Horne, J.D. "Report of 1999 Field Work on the Case Rare-Earth Metals Pegmatite" (2000).

APPENDICES

1B	18	18
1C	19	19
1D	20	20
1E	21	21
1F	22	22
1G	23	23
1H	24	24
1I	25	25
1J	26	26
1K	27	27
1L	28	28
1M	29	29
1N	30	30
1O	31	31
1P	32	32
1Q	33	33
1R	34	34
1S	35	35
1T	36	36
1U	37	37
1V	38	38
1W	39	39
1X	40	40
1Y	41	41
1Z	42	42

SUBJECT PROPERTY

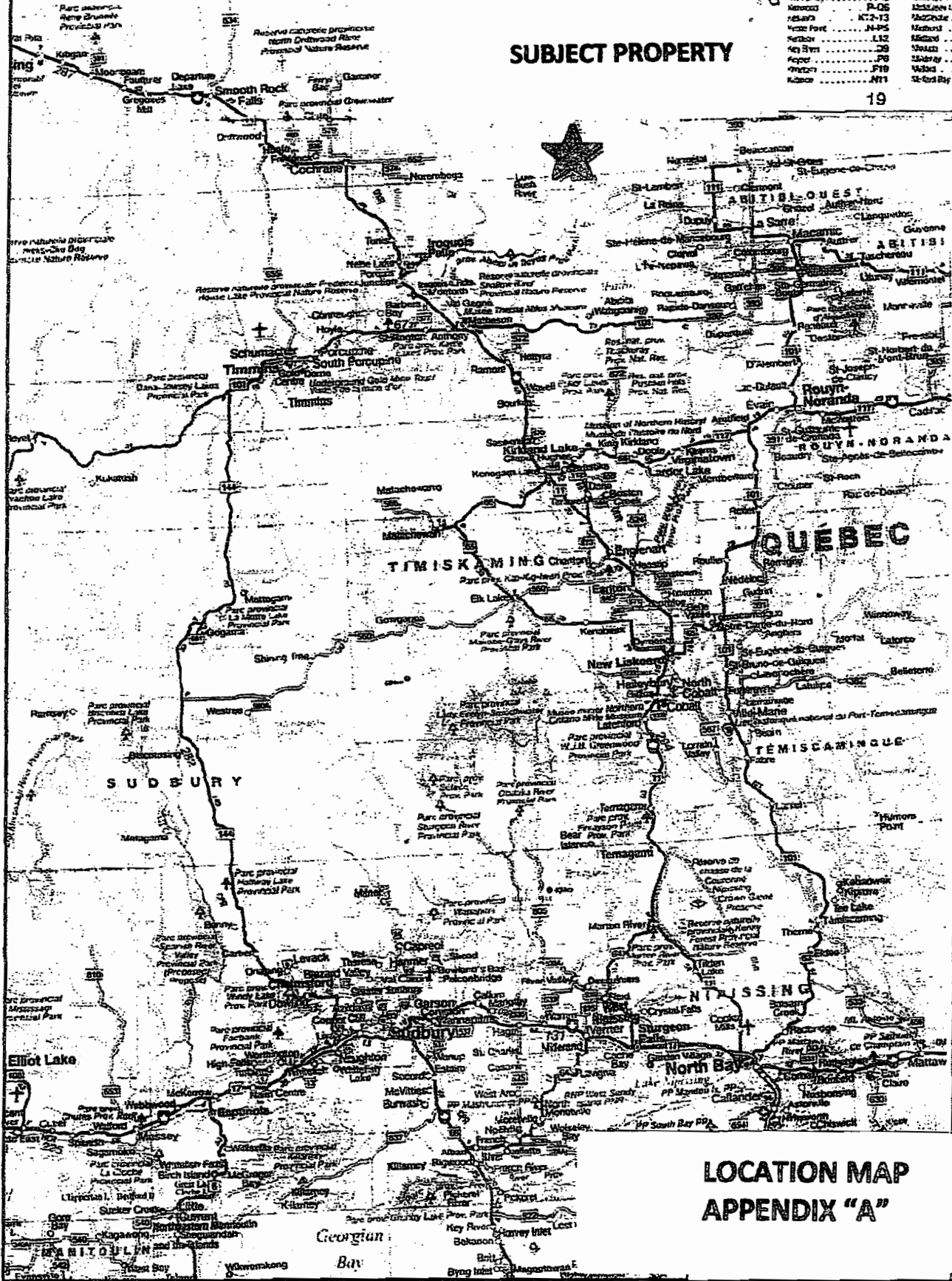

**LOCATION MAP
APPENDIX "A"**



MINISTRY OF NORTHERN DEVELOPMENT,
MINES AND FORESTRY

- [Home](#)
- [Mines and Minerals](#)
- [Northern Development](#)
- [News](#)
- [Site Map](#)
- [Contact Us](#)

Mining Claim Abstract

[Main Menu](#) | [Back](#) |

LARDER LAKE - Division 80		Claim No: L 1214668		Status: ACTIVE
Due Date:	2012-Aug-26	Recorded:	2009-Aug-26	
Work Required:	\$ 1,600	Staked:	2009-Aug-25 16:30	
Total Work:	\$ 1,600	Township/Area:	STEELE (G-3571)	
Total Reserve:	<u>\$ 100</u>	Lot Description:		
Present Work Assignment:	\$ 2,646	Claim Units:	4	
Claim Bank:	\$ 0			

Claim Holders

Recorded Holder(s) Percentage	Client Number
HERMESTON, PETER M (100.00 %)	403428

Transaction Listing

Type	Date	Applied	Description	Performed Number
STAKER	2009-Aug-26		RECORDED BY HERMESTON, PETER M (1003623)	R0980.02636
ORDER	2009-Nov-02		RECORDER'S ORDER. NOTICE OF COMPLIANCE DUE ON OR BEFORE 2009-DEC-11	D0980.00520
ORDER	2009-Nov-18		NOTICE OF COMPLIANCE WITH ORDER (D098000520) RECEIVED	D0980.00601
OTHER	2010-Jun-15		WORK PERFORMED (LC, PROSP) APPROVED: 2010-AUG-09	\$ 4,346 <u>Q1080.01667</u>
WORK	2010-Jun-15	\$ 1,600	WORK APPLIED (LC, PROSP) APPROVED: 2010-AUG-09	<u>W1080.01667</u>

Claim Reservations

- 01 400' surface rights reservation around all lakes and rivers
- 02 Sand and gravel reserved
- 03 Peat reserved
- 04 Other reservations under the Mining Act may apply

- 05 Including land under water
 - 06 Excluding road
-

- [Home](#)
- [Mines and Minerals](#)
- [Northern Development](#)
- [News](#)
- [Site Map](#)
- [Contact Us](#)



This site is maintained by the Government of Ontario, Canada.

- [Accessibility](#)
- [Privacy](#)
- [Important Notices](#)

Copyright information: © [Queen's Printer for Ontario, 2008](#)

Claim Worked in 2010 & 2011:

L-1214668 (4-units)

Other Claims within Contiguous Block

L-4251383 (6-units)

L-4251384 (3-units)

L-4251385 (2-units)

L-4214935 (6-units)

L-4249052 (1-unit)

Access Map

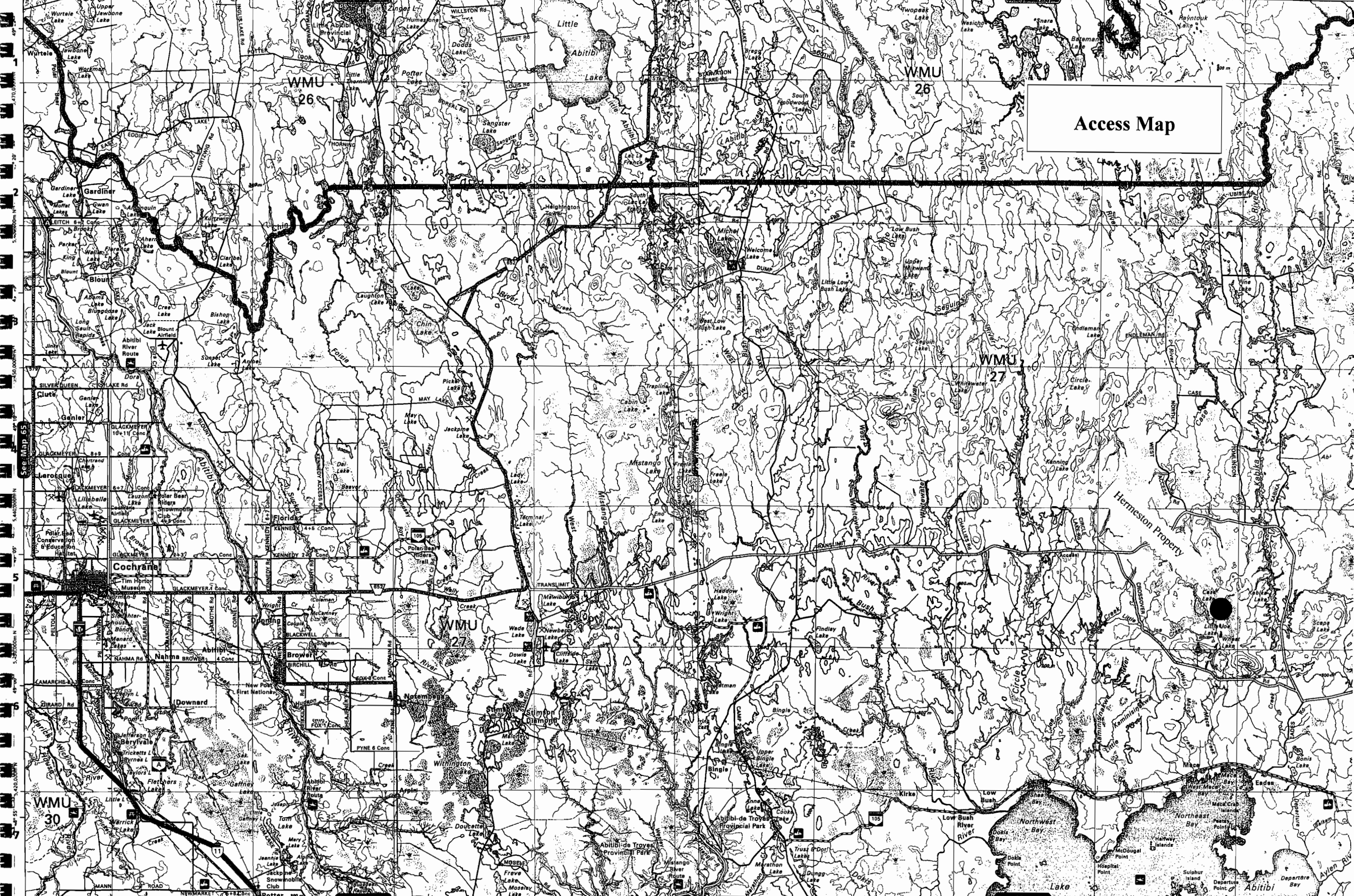

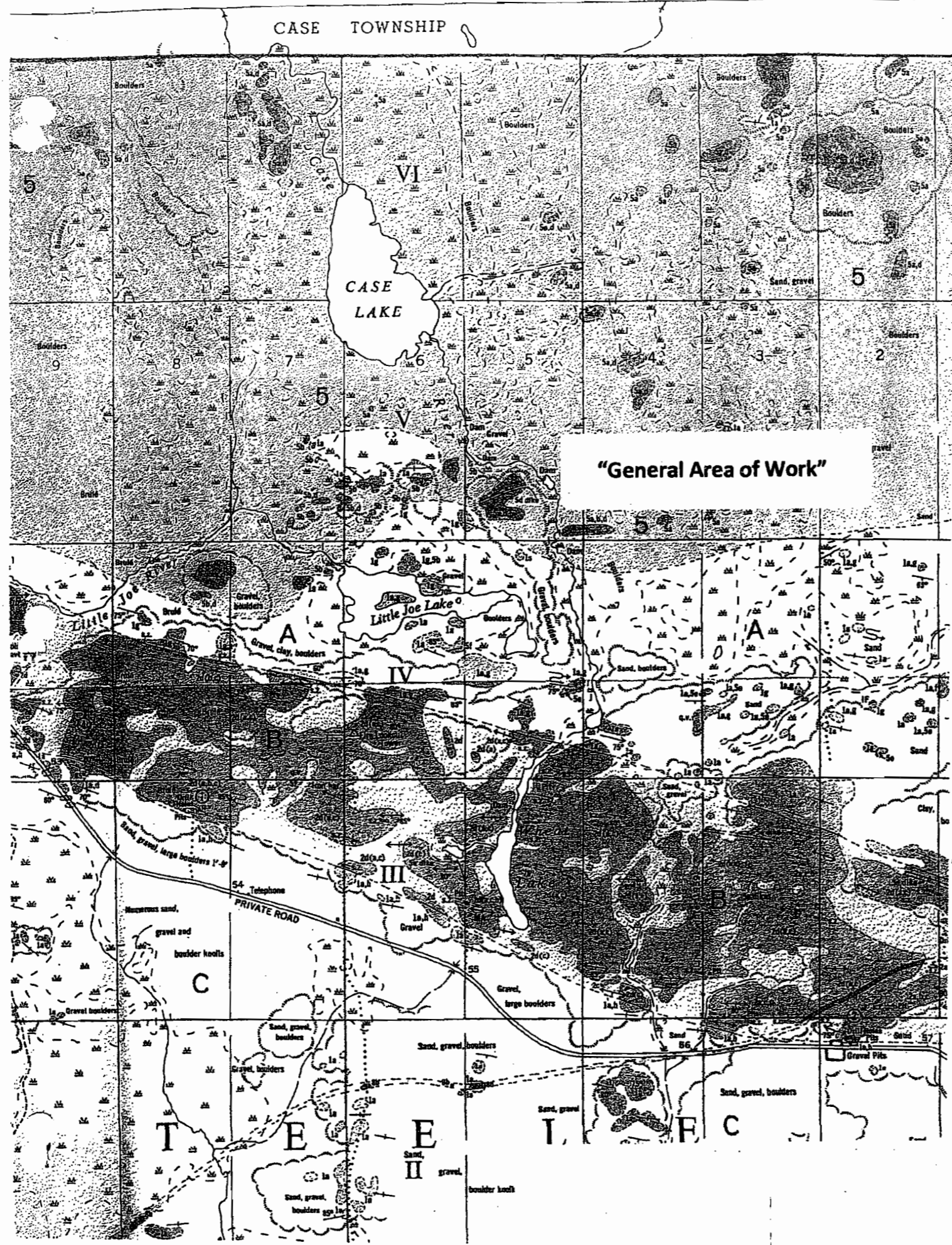

LEGEND

CENOZOIC*

RECENT
Peat, beach deposits, river deposits.

PLEISTOCENE
Varved clay, boulder clay, silt, sand, pebble gravel, boulder gravel.

UNCONFORMITY

PRECAMBRIAN**

LATE BASIC INTRUSIONS
Late diabase

8a Olivine diabase.
8b Diabase.

Early diabase

7a Quartz diabase.

INTRUSIVE CONTACT

ACID INTRUSIONS
Scapa stock***

6a Pink granite.

Case batholith***

5a Leucocratic quartz monzonite.
5b Granodiorite.
5c Pegmatite and aplite.
5e Feldspar porphyry and quartz-feldspar porphyry.
5f Felsite.

Sargeant batholith***

4a Quartz monzonite.
4b Granodiorite.
4c Quartz diorite.
4d Hornblende and pyroxene diorite.
4e Feldspar porphyry and quartz-feldspar porphyry.
4g Lamprophyre.
4h Hybrid rocks.
4j Pegmatite and aplite.

INTRUSIVE CONTACT

ULTRABASIC AND BASIC INTRUSIONS

3a Serpentinite and uralitized pyroxenite.

3b Amphibolite.
3c Diorite.

INTRUSIVE CONTACT

METAVOLCANIC-METASEDIMENT ASSEMBLAGE

D Bonis volcanics

FAULT(?)

C Steele metasediments.

B Steele volcanics.

A Scapa metasediments.

VOLCANIC DIVISIONS OF THE ASSEMBLAGE

2a Intermediate to basic lava.
2b Pillow lava.
2d Amphibolite, amphibole schist. Original rock type in brackets.
2g Diabasic lava.
2p Porphyritic basalt.
2t Flow breccia or tuff.

2e Acid volcanics. Includes rocks of indefinite origin.

METASEDIMENT DIVISIONS OF THE ASSEMBLAGE

1a Metamorphosed greywacke. Includes interbedded calc-silicate rocks.
1g Garnet schist.
1h Hornblende-plegoclase schist.
1s Steurolite schist.

IF Iron formation.

REGIONAL GEOLOGY APPENDIX "D"

Scale 1:31680



Ontario

Ministry of Northern Development and Mines

Assessment Work Performed on Mining Lands

Mining Act, Subsections 65(2) and 66(3), R.S.O. 1990

Folder Identification Number (office use)
Transaction Number (office use) W
Submission Number (office use) 2

This form should be printed on legal paper

Personal information collected on this form is obtained under the authority of subsections 65(2) and 66(3) of the Mining Act. Under section 8 of the Mining Act, this information is used to maintain a public record.

- Instructions: - For work performed on Crown Lands before recording a claim, use form Assessment Work Performed Before Recording Claim(s)
- Please type or print in ink.
- Submit to Geoscience Assessment Office, 933 Ramsey Lake Road, Sudbury Ontario P3E 6B5. Telephone 1-888-415-9845.

Note All correspondence will be sent to the address on record in the Provincial Recording Office, as required under the Mining Act, subsections 19(6) and (8).

1. Submitter I am [] an authorized agent or [X] the recorded holder (if a company, enter name of person submitting)

Name (last) HERMESTON (first) PETER (initial) M. Client number (optional) 403428
Address - Unit number, Street number, Street name 952 FRASER STREET
City, Town or Village NORTH BAY Province or State ONTARIO Country CANADA Postal Code P1B 3X8
Telephone number (705) 476-9131 Fax number E-mail address (optional) PHERMESTON@YAHOO.COM

2. Provide

- [] where there is a surface rights holder, before starting ground exploration work for the first time on a staked claim you must provide notice to the surface rights holder(s) as required by the Mining Act and provide proof of notification to the Ministry
[X] your technical report and maps in paper or on a compact disc
[X] a current legible map showing how the contiguous mining lands are linked for assigning work
[] proof of beneficial interest (if assigning amongst different recorded holders)

3. Work Performed - This includes the date you traveled to the field or mobilized equipment to the date the technical report was completed.

From: DD/MM/YYYY 25/10/2010 To: DD/MM/YYYY 14/09/2011
Regulations: Calculate the time-adjusted credit column, in the tables below, as follows:
1. Work filed within 2 years of performance is claimed at 100%. (Enter 100% of actual costs in both of the last 2 columns).
2. Work filed after 2 years and up to 5 years after performance is credited at 50%. (Enter 100% of actual costs in the 2nd last column and 50% in the last column.)
3. Work older than 5 years is not eligible for credit.

3(A) Dates and Costs of Work Performed

Table with 7 columns: From date, To date, Work Type, Unit of Work, Cost per Unit of Work, Actual Cost, Time-Adjusted Credit. Includes rows for PROSPECTING and REPORT PREP.

3(B) Associated Costs

Table with 5 columns: From date, To date, Associated Costs, Actual Costs, Time-Adjusted Credit. Includes rows for MOBILIZATION, SUPPLIES and ASSAYS.

3(C) Transportation Costs

From date DD/MM/YYYY	To date DD/MM/YYYY	Transportation Costs	Actual Costs (\$)	Time-Adjusted Credit (\$) (See notes 1 and 2 above.)
25/10/2010	27/10/2010	NORTH BAY TO CLAIMS AND RTN. 980 KMS X .40/KM.	\$ 392.00	\$ 392.00
26/10/2010	26/10/2010	COCHRANE TO CLAIMS AND RTN. 185 KMS X .40/KM	\$ 74.00	\$ 74.00
20/07/2011	22/07/2011	NORTH BAY TO CLAIMS AND RTN. 980 KMS X .40/KM	\$ 392.00	\$ 392.00
21/07/2011	21/07/2011	COCHRANE TO CLAIMS AND RTN 185 KMS X .40/KM	\$ 74.00	\$ 74.00

3(D) Food and Lodging Costs

From date DD/MM/YYYY	To date DD/MM/YYYY	Food and Lodging Costs	Actual Costs (\$)	Time-Adjusted Credit (\$) (See notes 1 and 2 above.)
25/10/2010	27/10/2010	GROCERIES, MEALS / WATER.	\$ 50.00	\$ 50.00
20/07/2011	22/07/2011	GROCERIES, MEALS / WATER	\$ 50.00	\$ 50.00

Total of Time Adjusted Credit Columns (3A through 3D)= Total Value of Assessment Work **\$ 3672.00**

4. Type of Work Performed – please check off the type of survey performed (optional)

Work Type	Survey Type	Work Type	Survey Type
Airborne geophysical	<input type="checkbox"/> AEM <input type="checkbox"/> AMAG <input type="checkbox"/> AVLF <input type="checkbox"/> other airborne geophysical	Geophysical	<input type="checkbox"/> EM <input type="checkbox"/> GRAV <input type="checkbox"/> IP <input type="checkbox"/> MAG <input type="checkbox"/> VLF <input type="checkbox"/> other geophysical
Assays	<input type="checkbox"/> assay <input type="checkbox"/> beneficiation <input type="checkbox"/> geochemical	Physical	<input checked="" type="checkbox"/> manual work <input type="checkbox"/> mechanical work <input type="checkbox"/> overburden stripping <input type="checkbox"/> re-cutting claim lines <input type="checkbox"/> trenching <input checked="" type="checkbox"/> other physical
Drilling	<input type="checkbox"/> diamond drilling <input type="checkbox"/> drill core submission to MNDM <input type="checkbox"/> overburden drilling <input type="checkbox"/> boring other than core	Prospecting	<input checked="" type="checkbox"/> Prospecting
Line cutting	<input type="checkbox"/> line cutting	Rehabilitation	<input type="checkbox"/> Rehabilitation
Geochemical	<input type="checkbox"/> geochemical	Other – Please print examples: microscopic studies, bulk sampling, downhole geophysics SOIL SAMPLING FOR OVERBURDEN DEPTHS.	
Geological	<input type="checkbox"/> geological		

5. Commodities Explored for please list (optional)

LITHIUM, TANTALUM, COLUMBIUM.

6. Work Performed, Assigned, Banked

6(A) If you performed work on mining lands other than a staked mining claim, fill in the table below. Lease or Patented Land or Licence of Occupation (LO) or Other Mining Lands: Work performed, assigned or banked

Lease # or Parcel # or G # or LO #	GAO-Approved Identifier (office use only)	Hectares	Amount of Work Performed on this Land (\$)	Amount of Credits Assigned to Mining Claim(s) (\$)	Bank (Amount of credits to be assigned at a future date)
Column Totals for 6(A)			0	0	0

Schedule attached (if you have more entries attach a schedule)

6(B) Mining Claims: Work performed, applied, assigned, banked or assigned from table 6(A) above

Mining Claim Number	Number of Claim Units	Amount of Work Performed on this Claim (\$)	Amount of Credits Applied to this Claim (\$)	Amount of Credits Assigned to Other Mining Claims (\$)	Bank (Amount of credits to be applied or assigned at a future date)
L-1214668	4	\$3672.42	\$3200.00		\$472.42
Column Total for 6(B)		\$3672.42	\$3200.00	0	\$472.42
Column Totals of 6(A) + 6(B)		\$3672.00		0	\$472.00

Note: Work performed on mining claims = credits applied + credits banked

Schedule attached (if you have more entries attach a schedule)

7. Some of the credits claimed in this Assessment Work form may be reduced. Please indicate below how you want your credits reduced if they are not approved. Check (✓) in the boxes below. **If you have not indicated how your remaining credits are to be allocated, credits will be reduced from the Bank first, followed by option number 2 if necessary.** ✓

Credits are to be cutback:

- 1. Credits are to be cut back from the Bank first, followed by option 2 or 3 or 4 as indicated; or
- 2. Credits are to be cut back starting with the claims listed last, working backwards; or
- 3. Credits are to be cut back equally over all claims listed in this Assessment Work form; or
- 4. Credits are to be cut back as **shown below**:

List the claim numbers in the order you want the credits to be cut back (setting your priority list).

Priority	Claim Number
1.	1214668
2.	
3.	
4.	
5.	

Priority	Claim Number
6.	
7.	
8.	
9.	
10.	

Schedule attached (if you have more entries attach a schedule)

8. Certification by Recorded Holder or Authorized Agent

I, Robert Hunter (Signature), do hereby certify on 14/09/2011 (DD/MM/YYYY) that I have personal

knowledge of the facts set forth in this Assessment Work form having caused the work to be performed or witnessed the same during or after its completion and, to the best of my knowledge, the annexed report is true.

"Mining Lands Website: <http://www.ontario.ca/mininglands>"



ALS Canada Ltd.
 2103 Dollarton Hwy
 North Vancouver BC V7H 0A7
 Phone: 604 984 0221 Fax: 604 984 0218 www.alsglobal.com

To: **PETER HERMESTON**
952 FRASER ST
NORTH BAY ON P1B 3X8

Page: 1
 Finalized Date: 31-AUG-2011
 Account: PETHER

CERTIFICATE TM11157532

Project:
 P.O. No.:
 This report is for 4 Rock samples submitted to our lab in Timmins, ON, Canada on 13-AUG-2011.
 The following have access to data associated with this certificate:
 PETER HERMESTON

SAMPLE PREPARATION	
ALS CODE	DESCRIPTION
WEI-21	Received Sample Weight
LOG-22	Sample login - Rcd w/o BarCode
CRU-31	Fine crushing - 70% <2mm
SPL-21	Split sample - riffle splitter
PUL-31	Pulverize split to 85% <75 um .

ANALYTICAL PROCEDURES	
ALS CODE	DESCRIPTION
ME-MS41	51 anal. aqua regia ICPMS

To: **PETER HERMESTON**
ATTN: PETER HERMESTON
952 FRASER ST
NORTH BAY ON P1B 3X8

This is the Final Report and supersedes any preliminary report with this certificate number. Results apply to samples as submitted. All pages of this report have been checked and approved for release.

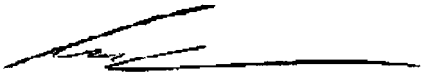
Signature: 
 Colin Ramshaw, Vancouver Laboratory Manager



ALS Canada Ltd.
 2103 Dollarton Hwy
 North Vancouver BC V7H 0A7
 Phone: 604 984 0221 Fax: 604 984 0218 www.alsglobal.com

To: PETER HERMESTON
 952 FRASER ST
 NORTH BAY ON P1B 3X8

Page: 2 - A
 Total # Pages: 2 (A - D)
 Plus Appendix Pages
 Finalized Date: 31-AUG-2011
 Account: PETHER

CERTIFICATE OF ANALYSIS TM11157532

Sample Description	Method Analyte Units LOR	WEI-21	ME-MS41	ME-MS41	ME-MS41	ME-MS41	ME-MS41	ME-MS41	ME-MS41	ME-MS41	ME-MS41	ME-MS41	ME-MS41	ME-MS41	ME-MS41	ME-MS41
		Recvd Wt. kg	Ag ppm	Al %	As ppm	Au ppm	B ppm	Ba ppm	Be ppm	Bi ppm	Ca %	Cd ppm	Ce ppm	Co ppm	Cr ppm	Cs ppm
		0.02	0.01	0.01	0.1	0.2	10	10	0.05	0.01	0.01	0.01	0.02	0.1	1	0.05
STSD-01		0.07	<0.01	0.74	0.9	<0.2	<10	20	1.67	0.01	0.01	0.02	0.38	0.6	10	15.85
STSD-02		0.59	0.05	0.26	0.4	<0.2	<10	<10	0.93	2.45	0.05	0.09	0.55	0.2	4	22.1
STSD-03		0.48	0.03	0.21	0.2	<0.2	<10	10	1.06	0.05	0.03	0.09	4.07	0.2	3	6.73
STSD-04		0.31	0.02	0.14	<0.1	<0.2	<10	<10	0.12	0.01	<0.01	<0.01	0.82	0.2	2	1.81

***** See Appendix Page for comments regarding this certificate *****



ALS Canada Ltd.
 2103 Dollarton Hwy
 North Vancouver BC V7H 0A7
 Phone: 604 984 0221 Fax: 604 984 0218 www.alsglobal.com

To: PETER HERMESTON
 952 FRASER ST
 NORTH BAY ON P1B 3X8

Page: 2 - B
 Total # Pages: 2 (A - D)
 Plus Appendix Pages
 Finalized Date: 31-AUG-2011
 Account: PETHER

CERTIFICATE OF ANALYSIS TM1157532

Sample Description	Method Analyte Units LOR	ME-MS41	ME-MS41	ME-MS41	ME-MS41	ME-MS41	ME-MS41	ME-MS41	ME-MS41	ME-MS41	ME-MS41	ME-MS41	ME-MS41	ME-MS41	ME-MS41	
		Cu ppm	Fe %	Ga ppm	Ge ppm	Hf ppm	Hg ppm	In ppm	K %	La ppm	Li ppm	Mg %	Mn ppm	Mo ppm	Na %	Nb ppm
		0.2	0.01	0.05	0.05	0.02	0.01	0.005	0.01	0.2	0.1	0.01	5	0.05	0.01	0.05
STSD-01		2.8	0.93	10.15	<0.05	0.04	<0.01	<0.005	0.50	0.2	172.5	0.03	117	0.50	0.03	3.31
STSD-02		0.9	0.31	2.08	<0.05	0.06	<0.01	<0.005	0.12	0.3	191.0	0.03	174	0.13	<0.01	0.74
STSD-03		0.9	0.32	1.45	<0.05	0.38	<0.01	<0.005	0.10	2.4	101.0	0.02	128	0.14	0.02	0.62
STSD-04		0.7	0.26	0.62	<0.05	0.21	<0.01	<0.005	0.11	0.4	3.7	0.01	34	0.11	0.04	1.35

***** See Appendix Page for comments regarding this certificate *****



ALS Canada Ltd.
 2103 Dollarton Hwy
 North Vancouver BC V7H 0A7
 Phone: 604 984 0221 Fax: 604 984 0218 www.alsglobal.com

To: PETER HERMESTON
 952 FRASER ST
 NORTH BAY ON P1B 3X8

Page: 2 - C
 Total # Pages: 2 (A - D)
 Plus Appendix Pages
 Finalized Date: 31 - AUG - 2011
 Account: PETHER

CERTIFICATE OF ANALYSIS TM11157532

Sample Description	Method Analyte Units LOR	ME-MS41	ME-MS41	ME-MS41	ME-MS41	ME-MS41	ME-MS41	ME-MS41	ME-MS41	ME-MS41	ME-MS41	ME-MS41	ME-MS41	ME-MS41	ME-MS41	
		Ni ppm 0.2	P ppm 10	Pb ppm 0.2	Rb ppm 0.1	Re ppm 0.001	S % 0.01	Sb ppm 0.05	Sc ppm 0.1	Se ppm 0.2	Sn ppm 0.2	Sr ppm 0.2	Ta ppm 0.01	Te ppm 0.01	Th ppm 0.2	Ti % 0.005
STSD-01		3.4	10	0.6	329	<0.001	<0.01	<0.05	0.4	<0.2	22.5	2.3	0.06	<0.01	<0.2	<0.005
STSD-02		0.9	30	1.5	96.3	<0.001	<0.01	<0.05	0.2	<0.2	1.7	5.8	0.01	0.01	0.4	<0.005
STSD-03		0.9	10	5.4	57.2	<0.001	<0.01	<0.05	0.2	<0.2	1.1	6.0	<0.01	<0.01	3.5	<0.005
STSD-04		2.1	10	1.2	30.7	<0.001	<0.01	<0.05	0.1	<0.2	0.2	4.1	<0.01	<0.01	1.2	<0.005

***** See Appendix Page for comments regarding this certificate *****



ALS Canada Ltd.
 2103 Dollarton Hwy
 North Vancouver BC V7H 0A7
 Phone: 604 984 0221 Fax: 604 984 0218 www.alsglobal.com

To: PETER HERMESTON
 952 FRASER ST
 NORTH BAY ON P1B 3X8

Page: 2 - D
 Total # Pages: 2 (A - D)
 Plus Appendix Pages
 Finalized Date: 31-AUG-2011
 Account: PETHER

CERTIFICATE OF ANALYSIS TM11157532

Sample Description	Method Analyte Units LOR	ME-MS41	ME-MS41	ME-MS41	ME-MS41	ME-MS41	ME-MS41	ME-MS41
		Tl	U	V	W	Y	Zn	Zr
		ppm	ppm	ppm	ppm	ppm	ppm	ppm
		0.02	0.05	1	0.05	0.05	2	0.5
STSD-01		1.73	0.08	2	0.28	0.07	21	<0.5
STSD-02		0.62	0.17	<1	0.12	<0.05	45	<0.5
STSD-03		0.35	1.22	<1	0.11	<0.05	25	2.1
STSD-04		0.24	0.39	<1	0.07	<0.05	<2	1.2

***** See Appendix Page for comments regarding this certificate *****



ALS Canada Ltd.
2103 Dollarton Hwy
North Vancouver BC V7H 0A7
Phone: 604 984 0221 Fax: 604 984 0218 www.alsglobal.com

To: PETER HERMESTON
952 FRASER ST
NORTH BAY ON P1B 3X8

Page: Appendix 1
Total # Appendix Pages: 1
Finalized Date: 31-AUG-2011
Account: PETHER

CERTIFICATE OF ANALYSIS TM11157532

Method	CERTIFICATE COMMENTS
ME-MS41	Gold determinations by this method are semi-quantitative due to the small sample weight used (0.5g).



ALS Canada Ltd.
 2103 Dollarton Hwy
 North Vancouver BC V7H 0A7
 Phone: 604 984 0221 Fax: 604 984 0218 www.alsglobal.com

To: **PETER HERMESTON**
952 FRASER ST
NORTH BAY ON P1B 3X8

INVOICE NUMBER 2371371

BILLING INFORMATION	
Certificate:	TM11157532
Sample Type:	Rock
Account:	PETHER
Date:	31-AUG-2011
Project:	
P.O. No.:	
Quote:	
Terms:	Due on Receipt C3
Comments:	

QUANTITY	CODE	ANALYSED FOR - DESCRIPTION	UNIT PRICE	TOTAL
1	BAT-01	Administration Fee	31.50	31.50
4	PREP-31	Crush, Split, Pulverize	7.10	28.40
1.45	PREP-31	Weight Charge (kg) - Crush, Split, Pulverize	0.65	0.94
4	ME-MS41	51 anal. aqua regia ICPMS	18.55	74.20
4	GEO-AR01	Aqua regia digestion	3.50	14.00

SUBTOTAL (CAD) \$ 149.04
 R100938885 HST ON \$ 19.38
TOTAL PAYABLE (CAD) \$ 168.42

To: **PETER HERMESTON**
 ATTN: PETER HERMESTON
 952 FRASER ST
 NORTH BAY ON P1B 3X8

Payment may be made by: Cheque or Bank Transfer

Beneficiary Name: ALS Canada Ltd.
 Bank: Royal Bank of Canada
 SWIFT: ROYCCAT2
 Address: Vancouver, BC, CAN
 Account: 003-00010-1001098
 Please send payment info to accounting.canusa@alsglobal.com

Please Remit Payments To :
ALS Canada Ltd.
 2103 Dollarton Hwy
 North Vancouver BC V7H 0A7

APPENDIX "F"

"Work Compilation Map"

**Claim
L-1214668**

**Steele Township (G-3571)
Larder Lake, Mining Division**

Scale 1:1000

NAD 83

L-1214668

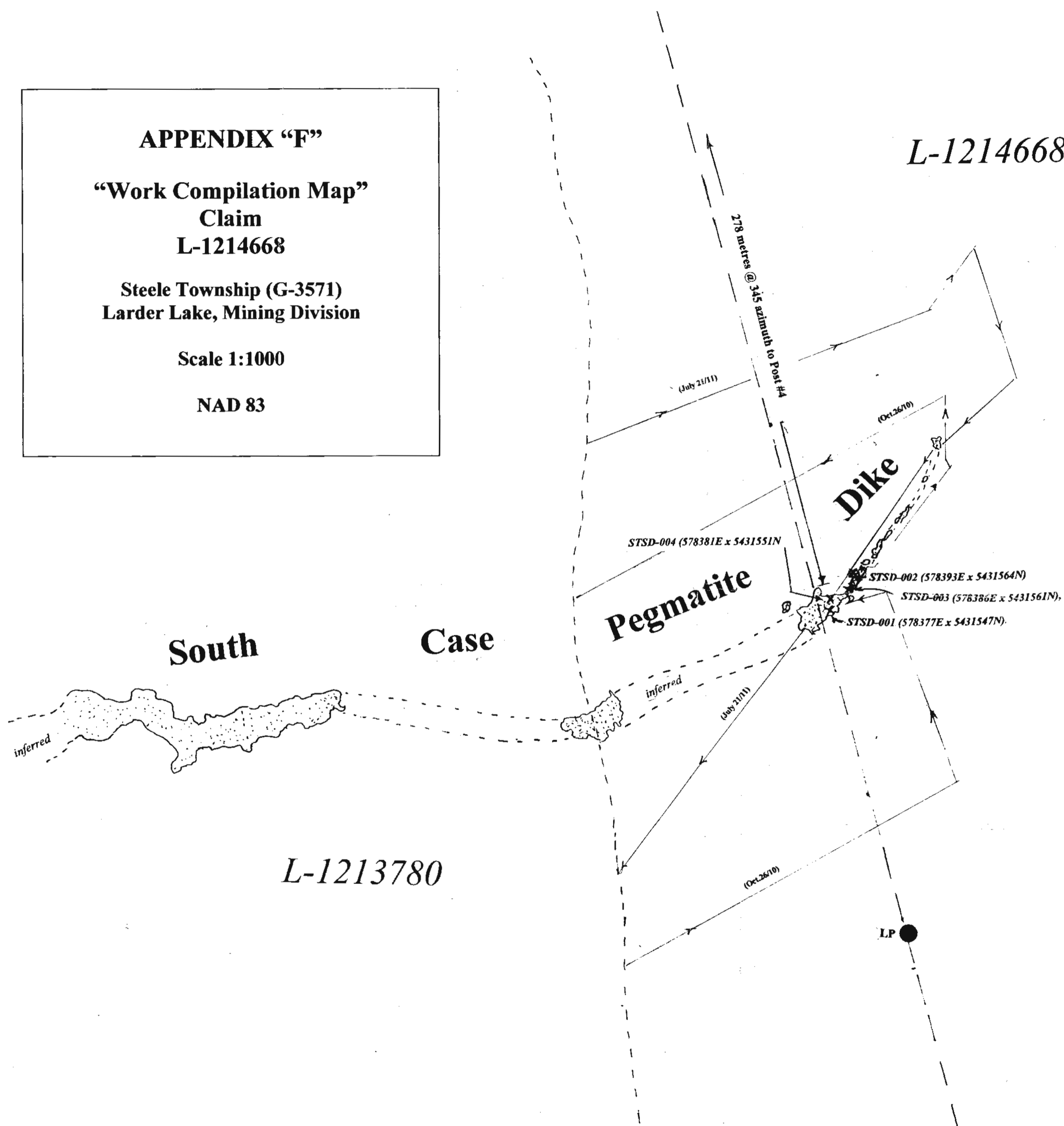

LEGEND

- Claim Post & Line — ● — —
- Line Post L.P. ● — — —
- Line/Date of Traverse (Oct 26/10) >
- Rock Outcrop
- Inferred Area of Dike - - - -
- Trench
- Sample Location ×
- Access Road - - - -
- Swamp ×

Submitted By:

Peter Hermeston Sept. 14th 2011