

WORK REPORT
on the
LEE LAKE PROPERTY
DENYES/GREENLAW TOWNSHIPS
PORCUPINE MINING DIVISION
for
STEVE ANDERSON

Submitted by: Steve Anderson
2041663 ONTARIO LTD.
VISION EXPLORATION
1361 Kraft Creek Rd.
Timmins, Ontario
P4N-7C3
Phone: 705-266-4703
Email: visionexploration@persona.ca
Website: www.duenorth.net/vision

April, 2012

TABLE OF CONTENTS

<u>Page #</u>	<u>Contents</u>
1	Introduction
3	Location and access
3	Personnel
3	Previous work
5	General Geology
5	Claims
5	Work Program
9	Results
9	Recommendations and Conclusions
10	Certificate
	<u>Figures</u>
1	Location map
2	Regional location map
3	Claim sketch and trench location map
4	Regional geology map
5	Assay certificate

INTRODUCTION

The following report will deal with the results of a preliminary prospecting program carried out on the Lee Lake Property. This property consists of one block mining claim (4 units) located in Denyes and Greenlaw Townships, Porcupine Lake Mining Division, Ontario (Figure #3). This work was carried out by George Ross on behalf of Steve Anderson who is the registered owner of the subject claim.

A total of 2 days were spent by two men, relocating a number of old trenches and mine shaft reported to occur within the claim. A total of 13 grab samples were taken and assayed for gold. The purpose of this program was to provide preliminary information as to the general geology of the property as well as provide samples to be assayed for gold. Historic reports from Lee Lake Gold Mines indicate that a shaft was sunk to a depth of 250 feet to test a mineralized shear that had reported gold values of up to .64 oz./ton/Au. This work was carried out on June 5th and 6th 2011.

This report will deal with the results of the preliminary prospecting program carried out on the above-mentioned property.



LOCATION AND ACCESS

The Lee Lake Property consists of a single claim (4 units) that straddles the boundary between Denies and Greeley Township (Figure #2). The property is situated approximately 140km southwest of the city of Timmins, Ontario. (Figure #1).

Access to the work area was gained by taking Hwy 101 west from Timmins for approximately 75km to the Folyet Timber Road. This road heads south from Hwy 101 and provides access to a network of logging roads, one of which runs in an east west direction approximately 1.5 km north of the subject claim. The claim was accessed by boat down Sylvanite Creek which crosses the previously mentioned logging road (Figure #3).

PERSONNEL

The following people were directly involved in carrying out the preliminary prospecting on the Black Gold property.

Prospector
Helper

George Ross
Lanny Anderson

Timmins
Crystal Falls

PREVIOUS WORK

The first phase of exploration was conducted by Steve Anderson on the Lee Lake Project. A previous operator, Lee Lake Mines, report that in the mid 1930's a shaft was sunk to a depth of 250 feet with lateral work performed on the 125 and 150 foot levels. A series of 11 drill holes were put down to test a mineralized shear which reported values ranging from .25 to .64 oz./ton/Au.

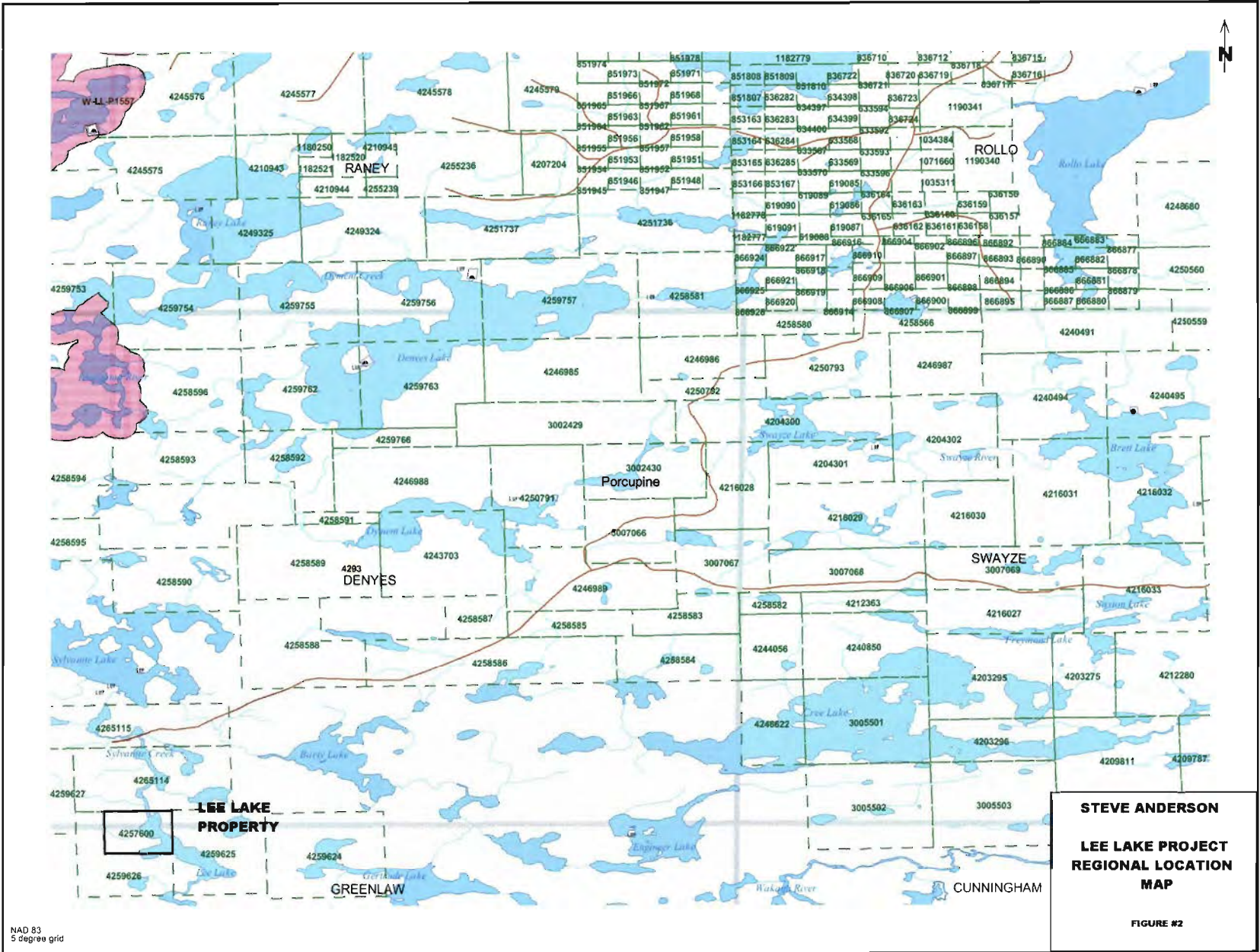

NAD 83
5 degree grid

STEVE ANDERSON
LEE LAKE PROJECT
REGIONAL LOCATION
MAP

FIGURE #2

GENERAL GEOLOGY

The Lee Lake Property is shown by OGS Map # P2121 (Figure #4) "Geology of Tooms and Greenlaw Townships" to be underlain in the north by Felsic volcanic rocks and Mafic volcanic rocks to the south. The area of interest lies within the mafic rocks. Lee Lake Gold Mines reports the presences of a well mineralized shear. A quartz porphyry dike that ranges from 10 to 20 feet in width was traced on surface for a distance of 800 feet striking S 60 E. The shearing is reported to occur on either side of the dike and is carbonatized with quartz veining and is heavily mineralized. This structure is reported to have gold values of up to .64 oz./ton/Au.

CLAIMS

The Lee Lake Property consists of 1 block mining claim (4 units) located in Denyes and Greenlaw Townships (Figure #3). It is within the Porcupine Mining Division, District of Cochrane. The following claim makes up the Lee Lake Property

<u>Claim #</u>	<u>Units</u>	<u>Township</u>
4257600	4 units	Dennes/Greenlaw Twp's.

WORK PROGRAM

The current work program involved spending 2 day prospecting the subject claim in order to located and sample previously reported areas of trenching. The trenches were located and 13 grab samples taken. It should be noted that many of the original trenches were filled with waste rock from the mining operations that subsequently occurred. The sample location map can be found as figure #5 of this report.

All samples were sent to Catterello Assayers Inc. and assayed for gold. The following is a general description of the samples taken and trench locations.

Note: All trenches were oriented in a north south direction and were marked from their centers (Nad 83).

Claim # 4257600

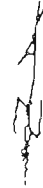

362900 mE
362875 mE
362850 mE
362825 mE

5290700 mN

5290675 mN

5290650 mN

5290625 mN

Trench #2



shaft

Trench #3



Trench #4



Trench #6

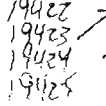

Trench #5

Trench #1

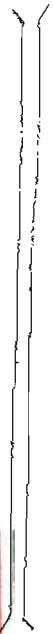

Lee Lake

Lee Lake Project
Trench Location Map

UTM: Nad 83

X - sample location and #

RECEIVED

JUL 16 2012

GEOSCIENCE ASSESSMENT
OFFICE

Trench #1

362823mE, 5290631mN

250 feet in length

No samples taken, filled with waste rock

Old Shaft

362847mE, 5290659m

Old Shaft

No samples taken, caved.

Trench #2

362844mE, 5290687mN

75 feet in length

2 Samples: 19417

19418

Trench #3

362856mE, 5290685mN

100 feet in length

4 Samples: 19413

19414

19415

19416

Trench #4

362872mE, 5290672mN

50 feet in length

3 Samples: 19419

19420

19421

Trench #5

362900mE, 5290670mN

50 feet in length

No samples taken, very deep and full of water

Trench #6

362890mE, 5290649mN

50 feet in length, very deep

4 Samples: 19422
 19423
 19424
 19425

Sample Description

19413 Quartz Carbonate 1% sulphides
19414 Quartz Carbonate 1% sulphides
19415 Seracite, Wall Rock
19416 Mafic volcanic, minor Quartz veining
19417 Mafic volcanic, wall rock
19418 Mafic volcanic, wall rock, trace pyrite
19419 Quartz carbonate 1% sulphides
19420 Mafic volcanics, wall rock
19421 Quartz carbonate
19422 Quartz carbonate, trace Pyrite
19423 Quartz carbonate
19424 Porphyry dike
19425 Quartz carbonate

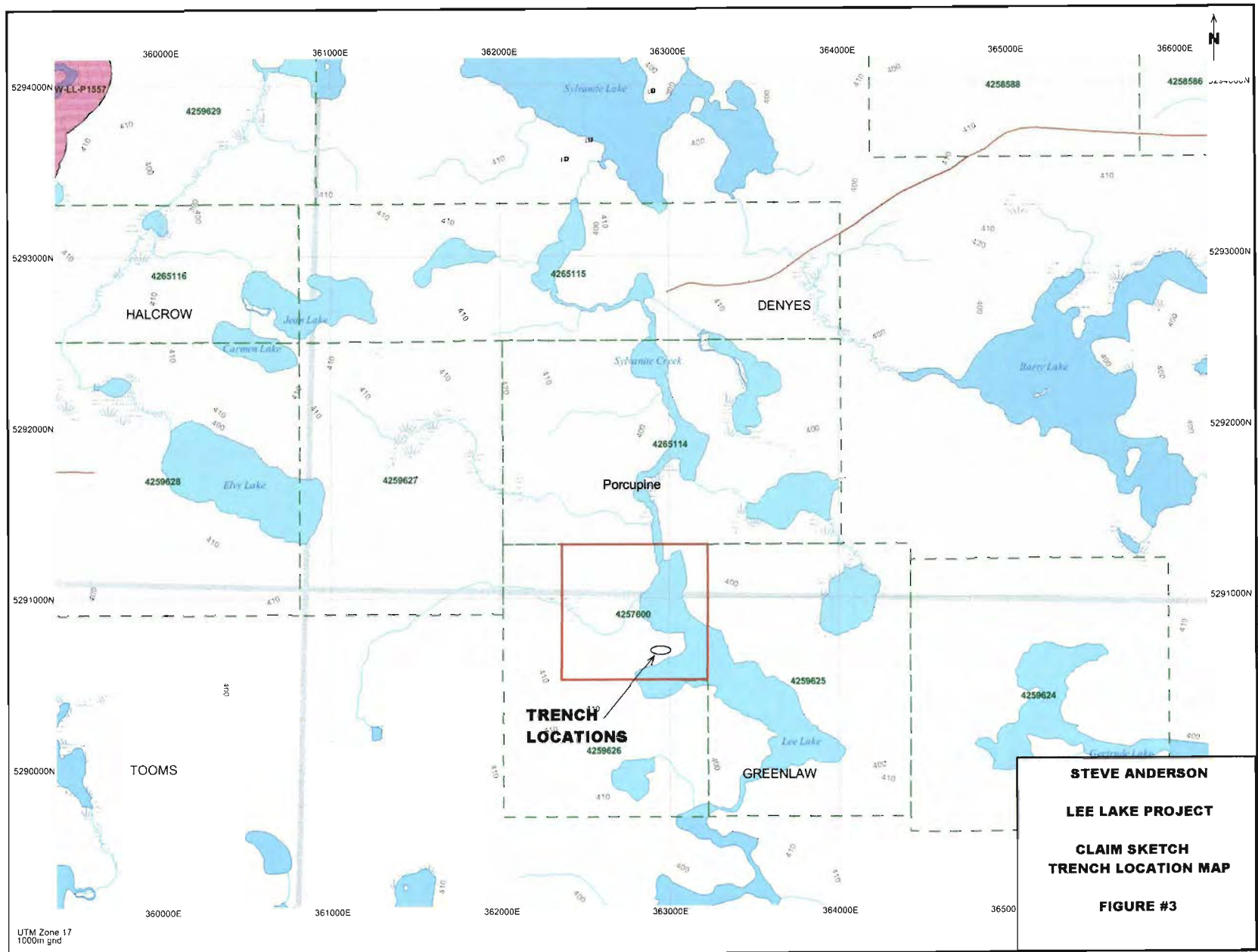

UTM Zone 17
1000m grid

STEVE ANDERSON
LEE LAKE PROJECT
CLAIM SKETCH
TRENCH LOCATION MAP
FIGURE #3

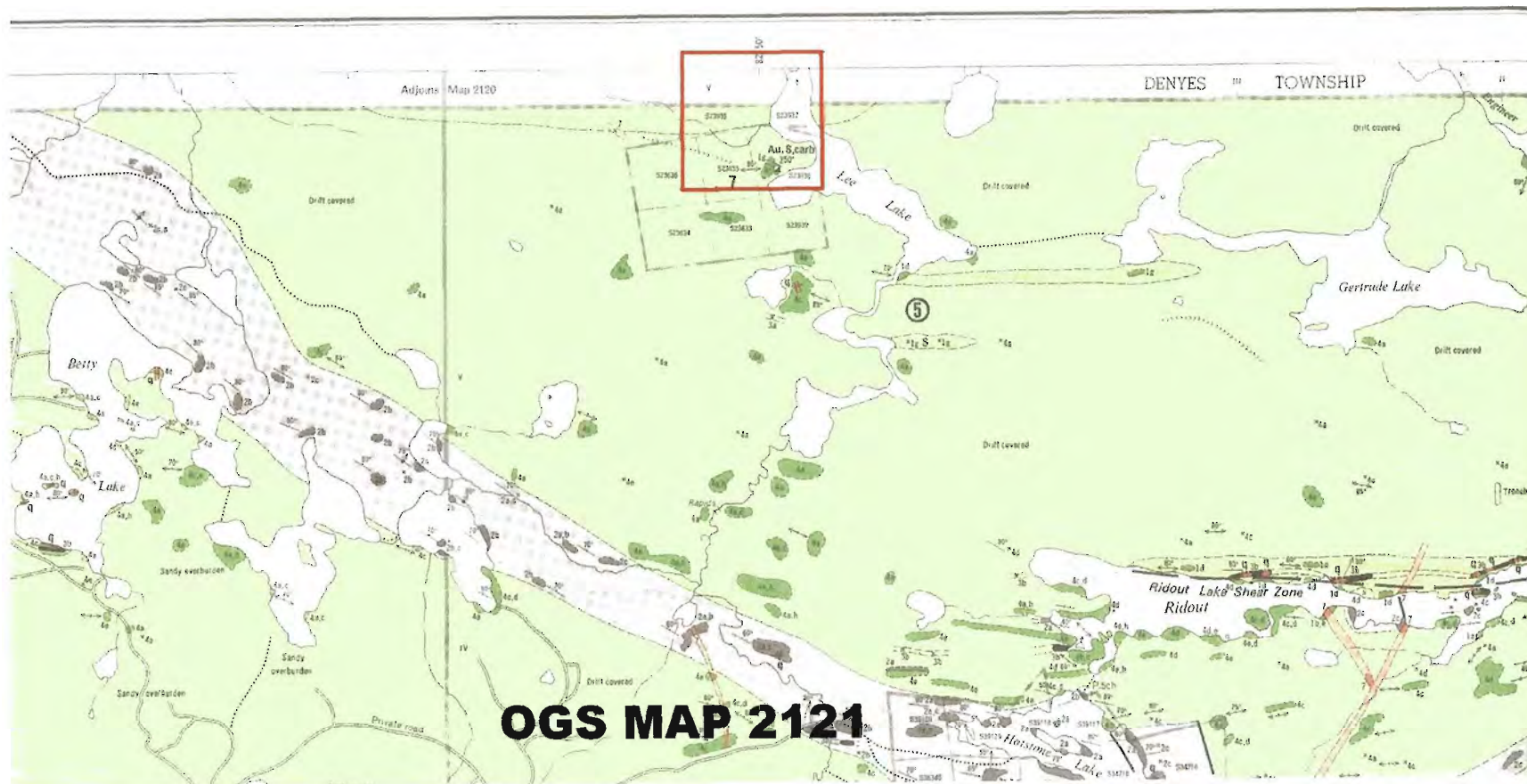

Certificate Of Analysis

Cattarello Assayers Inc.

Number Of Samples: 13

Client: Vision Exploration

Job: 1301

Type Of Sample: Rock



Received Date: 2011-11-25

Processed Date: 2011-11-28

Report Date: 2011-12-06

Sample ID	Au FA-GEO gr/mt 0.005 =====	Au-Dup FA-GEO gr/mt 0.005 =====
19413	1.983	
19414	0.965	
19415	0.230	
19416	0.026	
19417	<0.005	
19418	0.012	
19419	0.584	
19420	0.226	
19421	0.099	
19422	0.102	
19423	0.022	
19424	<0.005	
19425	<0.005	<0.005

Approved By Chief Analyst:

Issue Date	Revision Date	Rev #	Owner	Form ID	Page
2/18/2010	2/18/2010	1	Chris Hacquard	ANAL-002	1 Of 1

SURVEY RESULTS

As previously mentioned a number of old trenches, which were the subject of this program, were located and 13 grab samples taken from the area (Figure #5). As mentioned under the Work Program portion of this report, many of the old trenches were filled with waste rock from the mining operations

Of the 13 samples taken, all but 3 returned anomalous values in gold. These range from trace to 1.983gr/mt/Au.

RECOMMENDATIONS AND CONCLUSIONS

As mentioned under results, 10 of the 13 grab samples showed encouraging results with values of up to 1.983 gm/mt/Au. This confirms that the property has the potential to host gold deposition.

Previous operators of the property had to deal with the lack of access to the area. Recent logging activities have provided road access to within 50m of the old working. As a result the property can now be easily accessed with heavy equipment. The old trenches should be refurbished and properly sampled with the use of an excavator. The shear zone reported by Lee Lake Gold Mines runs up .64 oz/ton/Au be located and resamples with a large scale stripping program.

A number of samples taken contained sulphides, as well the shear zone is reported historically, to be heavily mineralized and would likely respond well to an Induced Polarization survey. As a phase one exploration program, a grid should be established over the claim and surveyed with magnetometer and Induced Polarization. This data can then be used to set up stripping and sampling programs.

CERTIFICATION

I, Steve Anderson of Timmins, Ontario hereby certify that:

1. I hold a three-year Geological Technologist Diploma from Sir Sandford College, Lindsay, and Ontario, obtained in May 1981.
2. I have been practising my profession since 1979 in Ontario, Quebec, Nova Scotia, New Brunswick, Newfoundland, NWT, Manitoba, Saskatchewan and Greenland.
3. I have been employed directly with Asamera Oil Inc. Urangellschaft Canada Ltd. Nanisivik Mines Ltd., R.S. Middleton Exploration Services Ltd., Rayan Exploration Ltd and I am currently co-owner of Vision Exploration.
4. I have based conclusions and recommendations contained in this report on knowledge of the area, my previous experience and on the results of the fieldwork conducted on the property during June, 2011.
5. I hold an interest in the claim which is the subject of this report.

Dated this 24th day of April, 2012
At Timmins, Ontario.

