

ASSESSMENT REPORT

ON PROSPECTING AND ROCK SAMPLING

CLAIM NOS. 4202302 & 4252717

IN CAIRO TOWNSHIP

LARDER LAKE MINING DIVISION

FOR WEST KIRKLAND MINING INC.

2.51748

By Ken Kryklywy, PEng

May 4, 2012

ASSESSMENT REPORT

FOR CLAIMS

IN CAIRO TOWNSHIP

The West Kirkland Mining property, optioned from John Rapski of Kenogami consists of 2 claims in Cairo Township numbered 4202302 and 4252717. Prospecting and rock sampling were performed on the claims on April 2, 2012.

Access to the work location is by paved Highway 66 from Kirkland Lake. The highway crosses through the centre of the claim group.

Previous Work

1952 : 2 DDH's totaling 2254 ft logged by C.G. McIntosh intersected a strong shear zone beneath Morrison Lake

1981 : Ground Mag survey by Newmont Canada

1996 : Stripping by Biralger Resources

2008 : Stripping by John Rapski

2010 : Ground Mag survey by West Kirkland Mining

Work Performed

On April 2, 2012, prospecting and rock sampling were carried out by geologists Ken Kryklywy and James Suma-Momoh of West Kirkland Mining. The focus of the sampling was the Cadillac Larder Fault Zone which is interpreted to run beneath and parallel to Highway 66 on the 2 claims.

The rock samples are described in the following pages. Gold assays were negligible in the areas sampled.

Cairo Township Surface Sampling

April 2, 2011.

Sample #: J449900 533480 E 5313022 N Elevation: 336m Claim #: 4212013

This sample is reddish-brown, coarse-grained and massive. It contains euhedral potassium feldspars as dominant mineral, and these have been moderately altered. Plagioclase feldspars make only about 5% of the rock composition. There is a weak brittle fracturation with chlorite in-filling and quartz veining (rare). Only trace py is observed. Rock type: Syenite.

Sample #: J449901 533667 E 5313062 N Elevation: 348m Claim #: 4212013

The sample appears to contain two rock types: Quartz-syenite and basalt. It could represent the contact between these two rocks. The quartz-syenite is pink-coloured; coarse-grained and weakly magnetic; with visible sulphides. The basalt on the other hand is green-grey, fine- to medium-grained, weakly magnetic, and moderate patchy silica alteration. No visible sulphide mineralization.

Sample #: J449902 533677 E 5313117 N Elevation: 347m Claim #: 4212013

The sample is pinkish-brown in colour; fine-grained; massive and weakly magnetic. Only a weak and patchy chloritic alteration occurs. Pyrite is very finely disseminated in trace amount. Rock type: Syenite.

Sample #: J449903 533015 E 5312858 N Elevation: 349m Claim #: 4202302

Light pinkish-grey, medium- to coarse-grained, massive, and non-magnetic. Dominant moderate fracture-controlled chloritic alteration, followed by a weak to moderate patchy to pervasive calcitic alteration. There is about 2 - 3% finely disseminated pyrite mineralization. Rock type: Mafic Syenite.

Sample #: J449904 533029 E 5312857 N Elevation: 348m Claim #: 4202302

This sample was collected from the slip-face of an outcrop with attitude 258°/80° south. It is medium grey-green, fine- to medium-grained, sheared, and non-magnetic. The rock has suffered a strong pervasive calcitic alteration and a moderate pervasive to fracture-controlled chloritic alteration. There is about 2 - 3% finely disseminated pyrite mineralization. Rock type: Sheared Mafic Syenite.

Sample #: J449905 533042 E 5312868 N Elevation: 348m Claim #: 4202302

Light pinkish-grey, medium- to coarse-grained, sheared, and very weakly magnetic. There is a dominant moderate to strong pervasive calcitic alteration; a moderate fracture-controlled chloritic alteration and a weak vein-controlled silicification. 5% disseminated and fracture-associated pyrite mineralization is observed. Rock type: Sheared Mafic Syenite.

Sample #: J449906 533123 E 5312883 N Elevation: 348m Claim #: 4202302

The sample is medium grey-green in colour. It is fine-grained; sheared and very weakly magnetic. Moderate foliation-controlled silica alteration is dominant, followed by a weak to moderate patchy calcitic alteration and sericitization. 2 – 3% fine pyrite is present. Rock type: Sheared Basalt.

Sample #: J449907 533145 E 5312919 N Elevation: 342m Claim #: 4202302

A possible boulder. The sample was collected about 5m away from the Morrison Lake (heading West). It is light greyish-pink; coarse-grained; semi-massive (with a moderate shear fabric in some rock pieces). Weakly magnetic. Weak to local moderate patchy calcitic alteration; lesser weak fracture-controlled chloritic alteration. Trace to locally 1% py disseminations. Rock type: Mafic Syenite.

Sample #: J449908 533395 E 5312968 N Elevation: 342m Claim #: 4212013

Light grey-green with a pinkish hue; coarse-grained; sheared, and very weakly magnetic. Strong patchy and foliation-controlled chloritic alteration and lesser moderate patchy calcitic alteration occur. 2 – 3% finely disseminated pyrite mineralization. Rock type: Sheared Mafic Syenite.

Sample #: J449909 533235 E 5312917 N Elevation: 342m Claim #: 4202302

Light green-grey, medium- to coarse-grained, generally massive but a faint foliation fabric is observed. Very weakly magnetic. Moderate to strong silica alteration is present, followed by a weak to moderate fracture-controlled and patchy chloritic alteration. 5 – 10% fine pyrite disseminations. Rock type: difficult to determine but perhaps Silicified Syenite.

Sample #: oc15 533372 E 5312920 N Elevation: 341m Claim #: 4212013

A dark grey-coloured sample with an aphanitic texture. It is weakly magnetic. The sample exhibits a strong shear fabric harnessed by weak to moderate calcitic alteration. Calcite veining (with trace py) also cross-cuts the shear fabric in a perpendicular manner. Quartz boudins are observed occurring parallel to the strong foliation planes. Trace py. Rock type: Sheared Basalt.

References

ODM Geological Report 51, Geology of the Matachewan Area, by Howard Lovell, 1967.

Geophysical Survey Report, Magnetometre Survey, Cairo Project, Cairo Township- NTS: 41P/15, by Newmont Exploration of Canada Ltd, 1981.

A Report on Exploration Activity on the Biralger Resources Ltd Cairo-Flavelle Twp Property, Matachewan, Ontario by Raymond A. Bernatchez, May, 1996.

Report of Physical work, Stripping, Morrison Lake Property, Cairo Township, Larder Lake Mining Division, by John Rapski, October 2008.

West Kirkland Mining Inc., Magnetometre Survey over the Cairo Property, Cairo Township, Ontario, by Larder Geophysics Ltd., 2010.

Report submitted by,

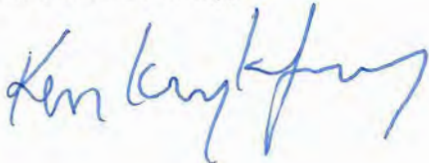

Ken Kryklywy, PEng

May 4, 2012.



ALS Canada Ltd.
 2103 Dollarton Hwy
 North Vancouver BC V7H 0A7
 Phone: 604 984 0221 Fax: 604 984 0218 www.alsglobal.com

To: **WEST KIRKLAND MINING INC.**
328 - 550 BARRARD STREET
VANCOUVER BC V6C 2B5

INVOICE NUMBER 2572887

| BILLING INFORMATION | |
|---------------------|--------------------------|
| Certificate: | SD12065695 |
| Sample Type: | Rock |
| Account: | WKIRMI |
| Date: | 13-APR-2012 |
| Project: | KL HOLMES |
| P.O. No.: | |
| Quote: | ALSM-CE12-042-WKIRMI |
| Terms: | Due on Receipt C2 |
| Comments: | |

| QUANTITY | CODE | ANALYSED FOR DESCRIPTION | UNIT PRICE | TOTAL |
|----------|-----------|--|------------|--------|
| 1 | BAT-01 | Administration Fee | 30.45 | 30.45 |
| 11 | PREP-31 | Crush, Split, Pulverize | 6.85 | 75.35 |
| 36.16 | PREP-31 | Weight Charge (kg) - Crush, Split, Pulverize | 0.64 | 23.14 |
| 11 | Au-AA23 | Au 30g FA-AA finish | 14.77 | 162.47 |
| 11 | ME-ICP61a | High Grade Four Acid ICP-AES | 19.41 | 213.51 |

To: **WEST KIRKLAND MINING INC.**
 ATTN: ACCOUNTS PAYABLE
 328 - 550 BARRARD STREET
 VANCOUVER BC V6C 2B5

| | | |
|----------------------------|-----------|----------------------|
| SUBTOTAL (CAD) | \$ | 504.92 |
| R100938885 HST BC | \$ | 60.59 |
| TOTAL PAYABLE (CAD) | \$ | <u>565.51</u> |

Please Remit Payments To :
ALS Canada Ltd.
 2103 Dollarton Hwy
 North Vancouver BC V7H 0A7

Payment may be made by: Cheque or Bank Transfer

Beneficiary Name: ALS Canada Ltd.
 Bank: Royal Bank of Canada
 SWIFT: ROYCCAT2
 Address: Vancouver, BC, CAN
 Account: 003-00010-1001098
 Please send payment info to accounting.canusa@alsglobal.com



ALS Canada Ltd.
2103 Dollarton Hwy
North Vancouver BC V7H 0A7
Phone: 604 984 0221 Fax: 604 984 0218 www.alsglobal.com

To: WEST KIRKLAND MINING INC.
328 - 550 BURRARD STREET
VANCOUVER BC V6C 2B5

Page: 1
Finalized Date: 13- APR- 2012
Account: WKIRMI

CERTIFICATE SD12065695

Project: KL HOLMES

P.O. No.:

This report is for 11 Rock samples submitted to our lab in Sudbury, ON, Canada on 5- APR- 2012.

The following have access to data associated with this certificate:

MIKE ALLEN

KEN KRYKLYWY

SAMPLE PREPARATION

| ALS CODE | DESCRIPTION |
|----------|--------------------------------|
| WEI- 21 | Received Sample Weight |
| LOG- 22 | Sample login - Rcd w/o BarCode |
| CRU- 31 | Fine crushing - 70% <2mm |
| CRU- QC | Crushing QC Test |
| SPL- 21 | Split sample - riffle splitter |
| PUL- 31 | Pulverize split to 85% < 75 um |

ANALYTICAL PROCEDURES

| ALS CODE | DESCRIPTION | INSTRUMENT |
|------------|-------------------------------|------------|
| Au- AA23 | Au 30g FA- AA finish | AAS |
| ME- ICP61a | High Grade Four Acid ICP- AES | ICP- AES |

To: WEST KIRKLAND MINING INC.
ATTN: KEN KRYKLYWY
328 - 550 BURRARD STREET
VANCOUVER BC V6C 2B5

This is the Final Report and supersedes any preliminary report with this certificate number. Results apply to samples as submitted. All pages of this report have been checked and approved for release.

Signature:

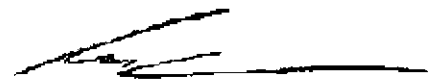

Colin Ramshaw, Vancouver Laboratory Manager



ALS Canada Ltd.
 2103 Dollarton Hwy
 North Vancouver BC V7H 0A7
 Phone: 604 984 0221 Fax: 604 984 0218 www.alsglobal.com

To: WEST KIRKLAND MINING INC.
 328 - 550 BURRARD STREET
 VANCOUVER BC V6C 2B5

Page: 2 - A
 Total # Pages: 2 (A - C)
 Finalized Date: 13- APR- 2012
 Account: WKIRMI

Project: KL HOLMES

CERTIFICATE OF ANALYSIS SD12065695

| Sample Description | Method Analyte Units LOR | WEI- 21 | Au- AA23 | ME- ICP61a | ME- ICP61a | ME- ICP61a | ME- ICP61a | ME- ICP61a | ME- ICP61a | ME- ICP61a | ME- ICP61a | ME- ICP61a | ME- ICP61a | ME- ICP61a | ME- ICP61a | |
|--------------------|--------------------------|--------------|----------|------------|------------|------------|------------|------------|------------|------------|------------|------------|------------|------------|------------|--------|
| | | Recvd Wt. kg | Au ppm | Ag ppm | Al % | As ppm | Ba ppm | Be ppm | Bi ppm | Ca % | Cd ppm | Co ppm | Cr ppm | Cu ppm | Fe % | Ga ppm |
| | | 0.02 | 0.005 | 1 | 0.05 | 50 | 50 | 10 | 20 | 0.05 | 10 | 10 | 10 | 10 | 0.05 | 50 |
| J449900 | | 2.04 | <0.005 | 1 | 4.03 | <50 | 900 | <10 | <20 | 1.73 | <10 | 10 | 50 | 10 | 2.33 | <50 |
| J449901 | | 2.34 | <0.005 | <1 | 3.58 | <50 | 360 | <10 | <20 | 0.80 | <10 | 20 | 60 | 10 | 3.19 | <50 |
| J449902 | | 2.91 | <0.005 | <1 | 3.66 | <50 | 700 | <10 | <20 | 0.85 | <10 | 10 | 80 | 40 | 2.58 | <50 |
| J449903 | | 3.32 | 0.007 | 1 | 5.37 | <50 | 3060 | <10 | <20 | 3.50 | <10 | 30 | 120 | 70 | 5.03 | <50 |
| J449904 | | 2.72 | <0.005 | 1 | 4.95 | <50 | 3440 | <10 | <20 | 5.12 | <10 | 20 | 110 | 50 | 5.53 | <50 |
| J449905 | | 4.52 | 0.010 | <1 | 4.32 | <50 | 850 | <10 | <20 | 2.07 | <10 | 30 | 150 | 40 | 4.52 | <50 |
| J449906 | | 1.64 | 0.006 | 1 | 3.91 | <50 | 1010 | <10 | <20 | 2.86 | <10 | 20 | 160 | 30 | 3.34 | <50 |
| J449907 | | 4.17 | <0.005 | <1 | 3.29 | <50 | 2320 | <10 | <20 | 1.37 | <10 | 10 | 150 | 50 | 4.24 | <50 |
| J449908 | | 4.40 | 0.005 | <1 | 3.44 | <50 | 1260 | <10 | <20 | 3.12 | <10 | 10 | 120 | 70 | 2.86 | <50 |
| J449909 | | 3.82 | 0.005 | <1 | 3.19 | <50 | 230 | <10 | <20 | 1.69 | <10 | 20 | 110 | 20 | 3.12 | <50 |
| J449910 | | 4.32 | <0.005 | <1 | 6.16 | <50 | 50 | <10 | <20 | 4.25 | <10 | 50 | 60 | 140 | 11.35 | <50 |



ALS Canada Ltd.
 2103 Dollarton Hwy
 North Vancouver BC V7H 0A7
 Phone: 604 984 0221 Fax: 604 984 0218 www.alsglobal.com

To: WEST KIRKLAND MINING INC.
 328 - 550 BARRARD STREET
 VANCOUVER BC V6C 2B5

Page: 2 - B
 Total # Pages: 2 (A - C)
 Finalized Date: 13- APR- 2012
 Account: WKIRMI

Project: KL HOLMES

CERTIFICATE OF ANALYSIS SD12065695

| Sample Description | Method Analyte Units LOR | ME-ICP61a | ME-ICP61a | ME-ICP61a | ME-ICP61a | ME-ICP61a | ME-ICP61a | ME-ICP61a | ME-ICP61a | ME-ICP61a | ME-ICP61a | ME-ICP61a | ME-ICP61a | ME-ICP61a | ME-ICP61a | ME-ICP61a |
|--------------------|--------------------------|-----------|-----------|-----------|-----------|-----------|-----------|-----------|-----------|-----------|-----------|-----------|-----------|-----------|-----------|-----------|
| | | K % | La ppm | Mg % | Mn ppm | Mo ppm | Na % | Ni ppm | P ppm | Pb ppm | S % | Sb ppm | Sc ppm | Sr ppm | Th ppm | Ti % |
| | | 0.1 | 50 | 0.05 | 10 | 10 | 0.05 | 10 | 50 | 20 | 0.05 | 50 | 10 | 10 | 50 | 0.05 |
| J449900 | | 3.3 | <50 | 0.77 | 300 | <10 | 3.49 | 20 | 750 | 20 | <0.05 | <50 | <10 | 130 | <50 | 0.17 |
| J449901 | | 1.4 | <50 | 1.22 | 610 | <10 | 3.97 | 40 | 640 | <20 | <0.05 | <50 | 10 | 210 | <50 | 0.30 |
| J449902 | | 1.9 | <50 | 1.10 | 550 | <10 | 3.83 | 40 | 290 | 330 | 0.07 | <50 | 10 | 220 | <50 | 0.22 |
| J449903 | | 3.7 | <50 | 2.65 | 1080 | <10 | 1.76 | 50 | 2660 | 30 | 0.68 | <50 | 10 | 570 | <50 | 0.20 |
| J449904 | | 4.0 | <50 | 2.80 | 1340 | <10 | 1.17 | 50 | 3390 | 30 | 0.48 | <50 | 10 | 640 | <50 | 0.22 |
| J449905 | | 1.5 | <50 | 2.03 | 820 | 10 | 3.21 | 70 | 1640 | <20 | 0.93 | <50 | 10 | 220 | <50 | 0.13 |
| J449906 | | 2.0 | <50 | 1.80 | 670 | <10 | 1.66 | 80 | 1240 | 30 | 0.42 | <50 | 10 | 150 | <50 | 0.14 |
| J449907 | | 1.9 | <50 | 1.31 | 670 | <10 | 3.63 | 80 | 1540 | <20 | 0.14 | <50 | <10 | 170 | <50 | 0.13 |
| J449908 | | 1.5 | <50 | 1.32 | 620 | 10 | 3.50 | 50 | 1100 | <20 | 0.24 | <50 | <10 | 200 | <50 | 0.11 |
| J449909 | | 0.1 | <50 | 0.87 | 650 | <10 | 5.68 | 80 | 600 | <20 | 2.05 | <50 | <10 | 100 | <50 | 0.14 |
| J449910 | | 0.1 | <50 | 3.08 | 1620 | <10 | 2.09 | 30 | 510 | <20 | 0.11 | <50 | 40 | 80 | <50 | 0.54 |



ALS Canada Ltd.
 2103 Dollarton Hwy
 North Vancouver BC V7H 0A7
 Phone: 604 984 0221 Fax: 604 984 0218 www.alsglobal.com

To: WEST KIRKLAND MINING INC.
 328 - 550 BARRARD STREET
 VANCOUVER BC V6C 2B5

Page: 2 - C
 Total # Pages: 2 (A - C)
 Finalized Date: 13- APR- 2012
 Account: WKIRMI

Project: KL HOLMES

CERTIFICATE OF ANALYSIS SD12065695

| Sample Description | Method Analyte Units LOR | ME-ICP61a | ME-ICP61a | ME-ICP61a | ME-ICP61a | ME-ICP61a |
|--------------------|-----------------------------------|-----------|-----------|-----------|-----------|-----------|
| | | Tl | U | V | W | Zn |
| | | ppm | ppm | ppm | ppm | ppm |
| | | 50 | 50 | 10 | 50 | 20 |
| J449900 | | <50 | <50 | 80 | <50 | 40 |
| J449901 | | <50 | <50 | 100 | <50 | 60 |
| J449902 | | <50 | <50 | 80 | <50 | 70 |
| J449903 | | <50 | <50 | 140 | <50 | 110 |
| J449904 | | <50 | <50 | 150 | <50 | 110 |
| J449905 | | <50 | <50 | 120 | <50 | 90 |
| J449906 | | <50 | <50 | 90 | <50 | 100 |
| J449907 | | <50 | <50 | 110 | <50 | 80 |
| J449908 | | <50 | <50 | 60 | <50 | 70 |
| J449909 | | <50 | <50 | 40 | <50 | 80 |
| J449910 | | <50 | <50 | 360 | <50 | 140 |

Cairo Property Regional Map



1:100,000
0 5
Kilometres

Date: April 26, 2012
Projection: NAD 1983 UTM Zone 17N
Source: OGS GIS Data compilation

-  Cairo Property
- Roads**
-  Primary
-  Secondary
-  Tertiary
-  Townships

Cairo Property Surface Sampling Map

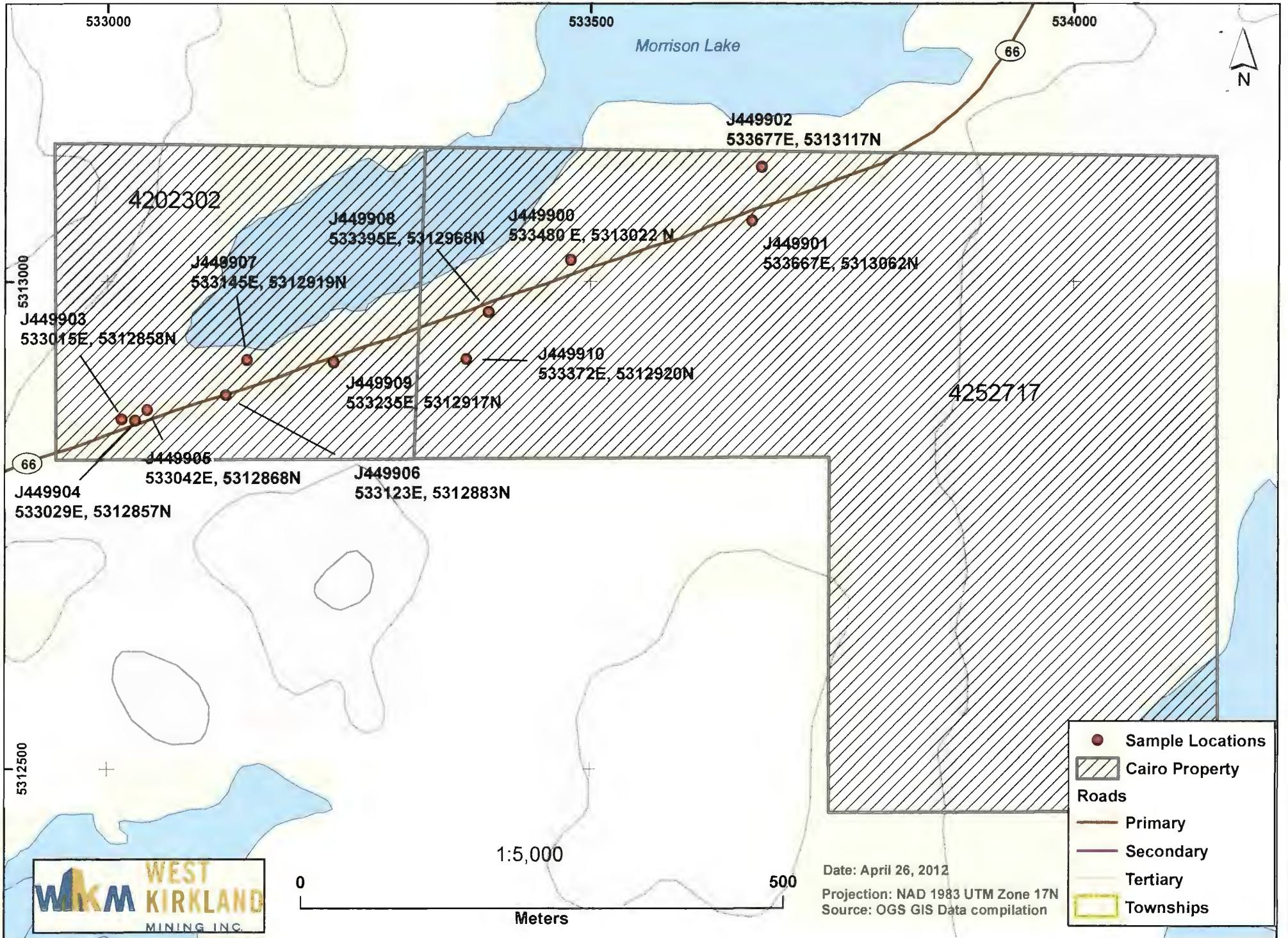

Date: April 26, 2012
Projection: NAD 1983 UTM Zone 17N
Source: OGS GIS Data compilation

- Sample Locations
- ▨ Cairo Property
- Roads
 - Primary
 - Secondary
 - Tertiary
- Townships