

HOLES PLOTTED			
TOTAL 10			
RH-10-01	RH-10-02	RH-10-01	RH-11-01
RH-11-03	RH-11-05	RH-11-15	RH-11-16
RH-11-02	RH-11-04	RH-11-03	RH-11-07

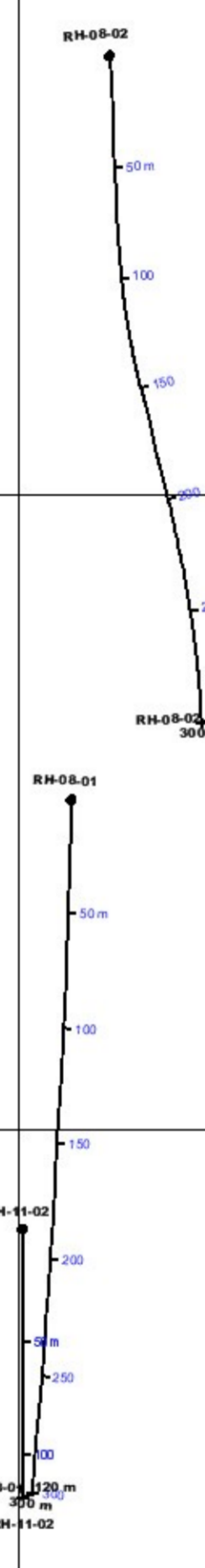

**Claim 4212618**

**Claim 3010209**

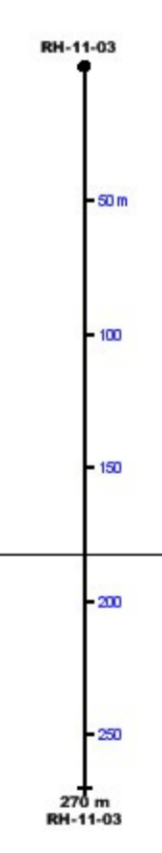
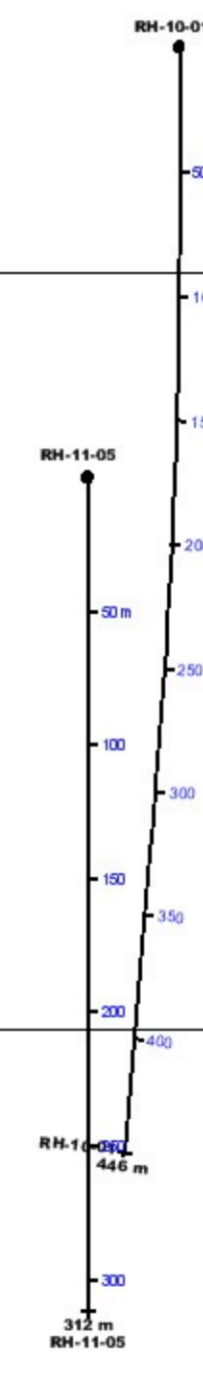
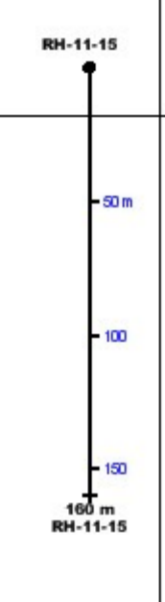
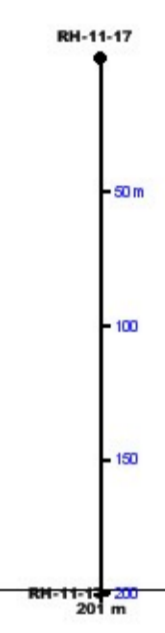

PLAN SPECS:  
 REF. PT. E, N 412403 m 5334000 m  
 EXTENTS 1910 m 1634 m

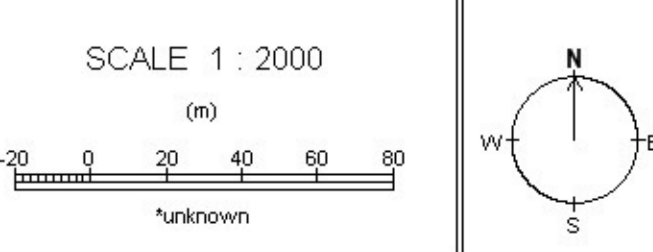

Rogue Resources  
 Radio Hill Property  
 Diamond Drill Hole Plan

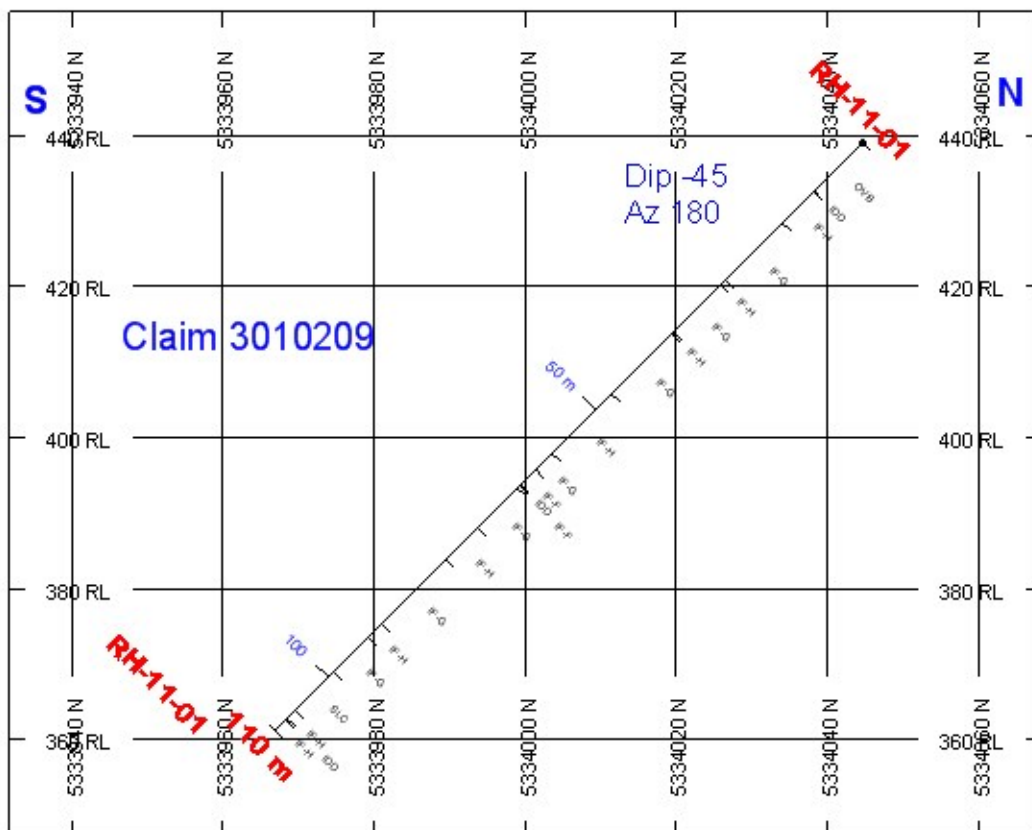
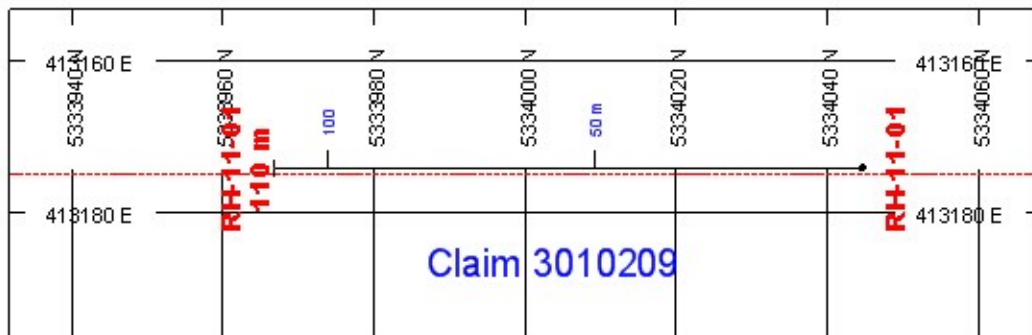

**ROGUE**  
RESOURCES INC.

Looking West

POSTED TEXT	L/R	TEXT	ITEMS
Code	R	-----	All

SCALE 1 : 1000

(m)

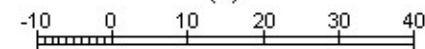

\*unknown

Rogue Resources

Radio Hill

Hole RH11-01

Section 413175E



ROGUE  
RESOURCES INC.

Looking West

POSTED TEXT L/R TEXT ITEMS  
Code R ..... All



Rogue Resources  
Radio Hill  
Hole RH11-02  
Section 413025E

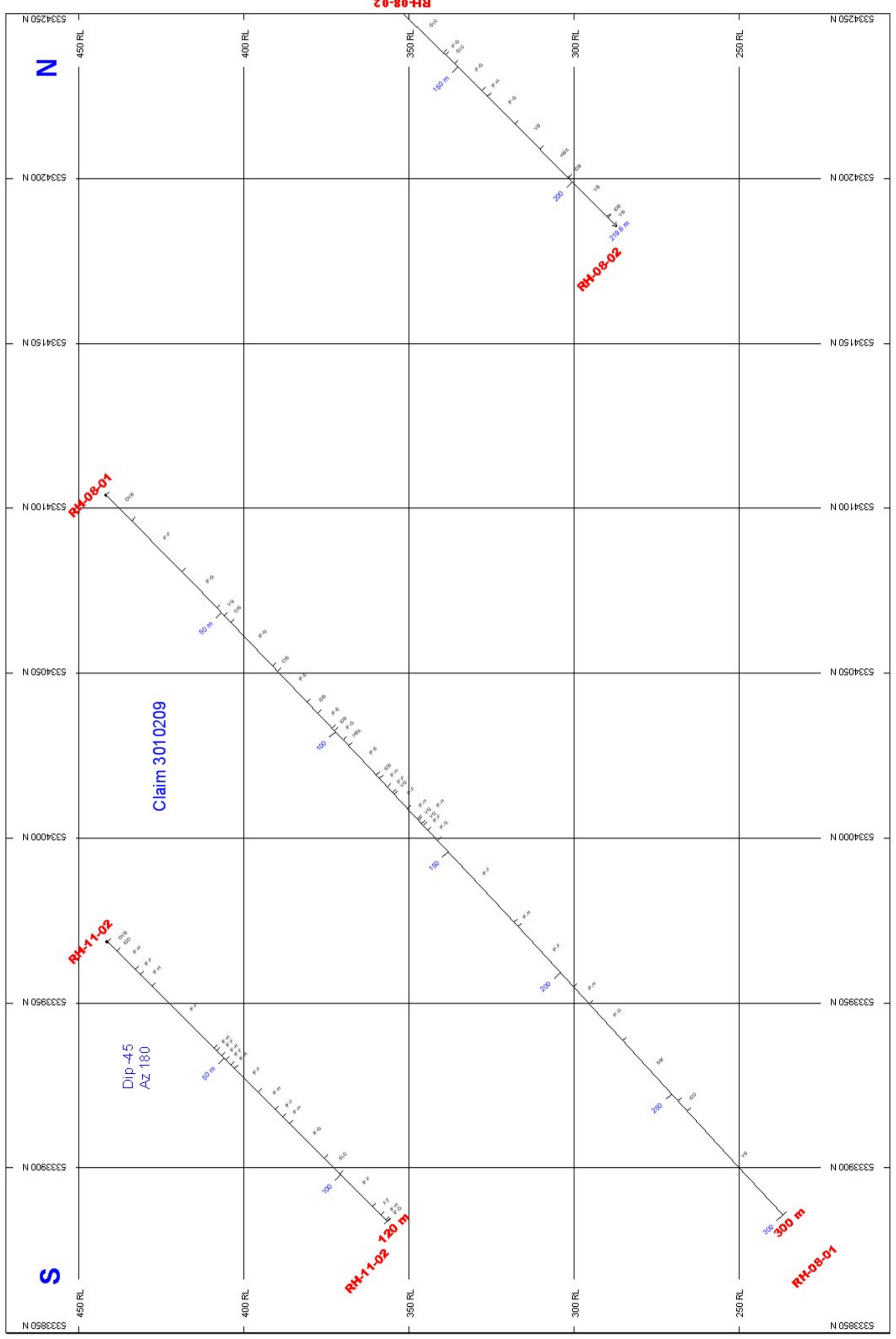
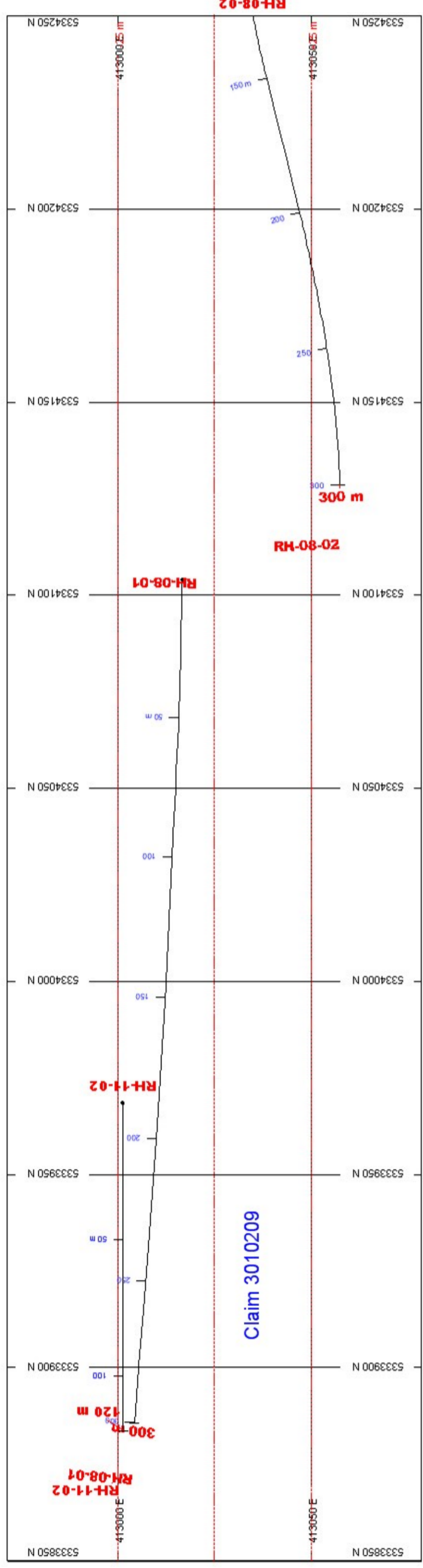

S

N

Dip -45  
AZ 180

Claim 3010209

Claim 3010209

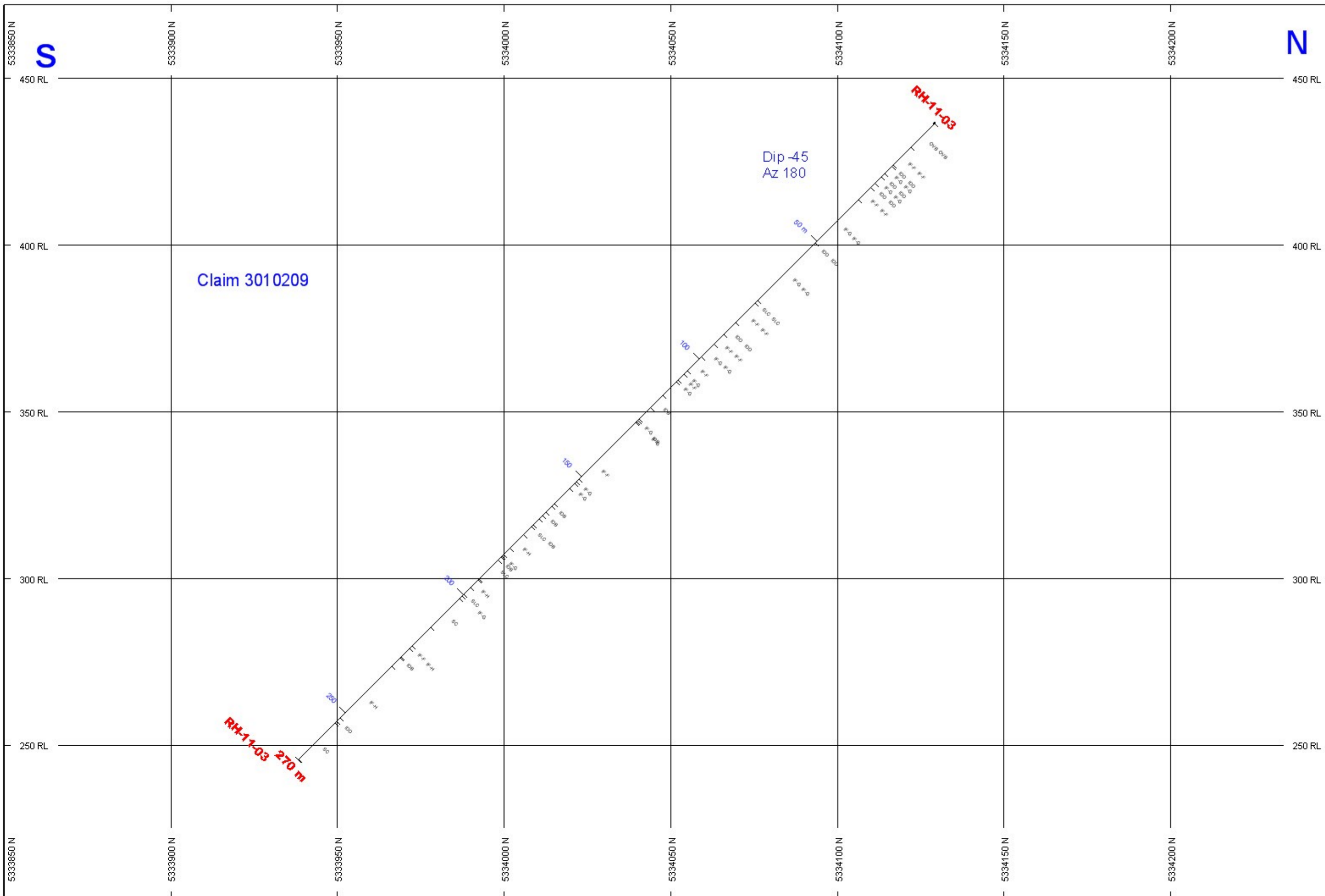
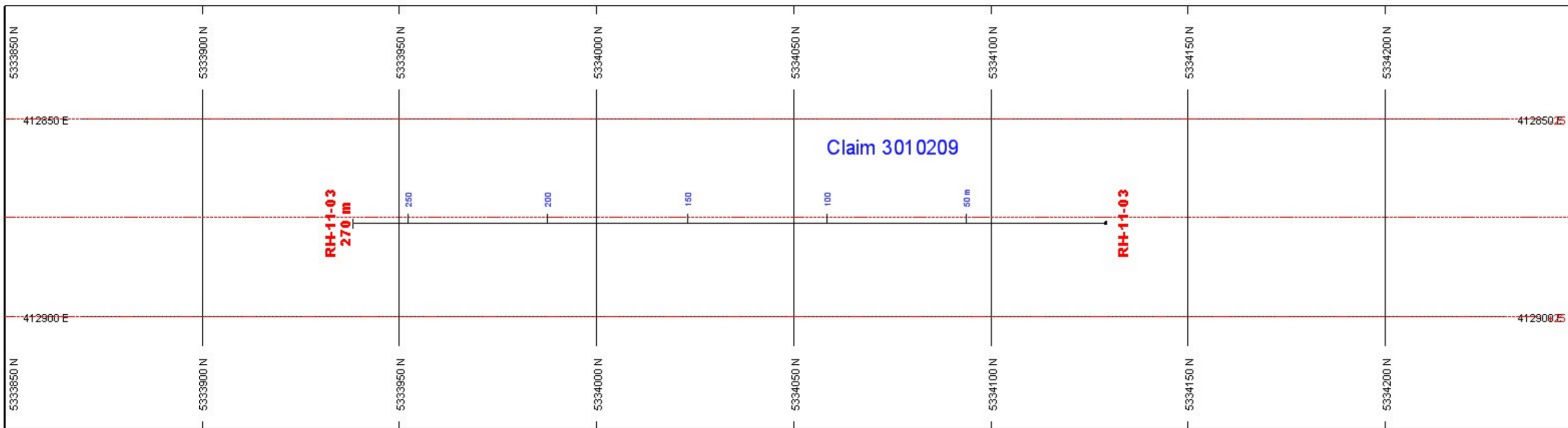

Looking West

POSTED TEXT	L/R	TEXT	ITEMS
Code	R	-----	All

SCALE 1 : 1000  
(m)

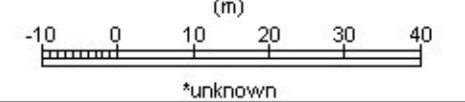

Rogue Resources  
Radio Hill  
Hole RH11-03  
Section 412875E

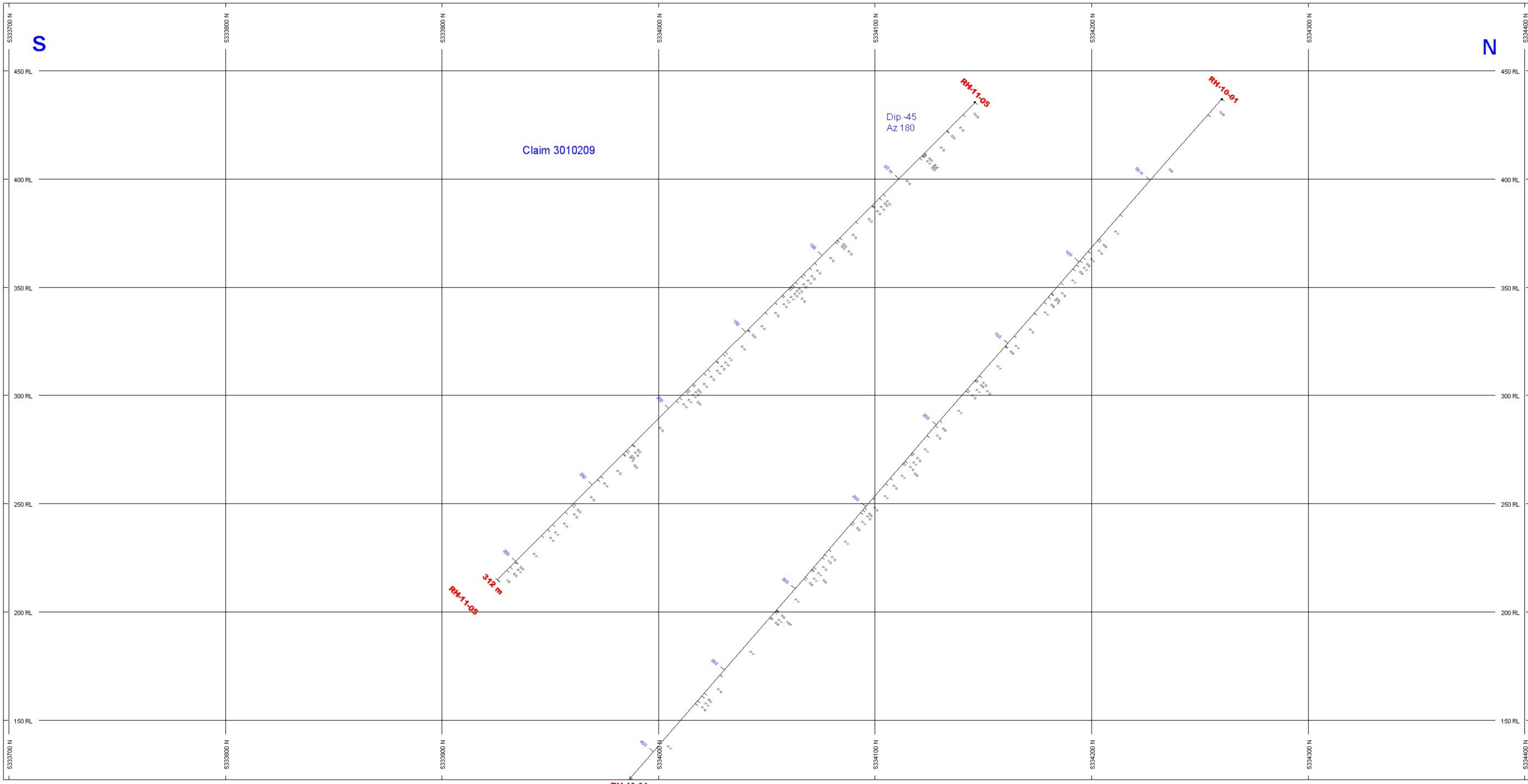
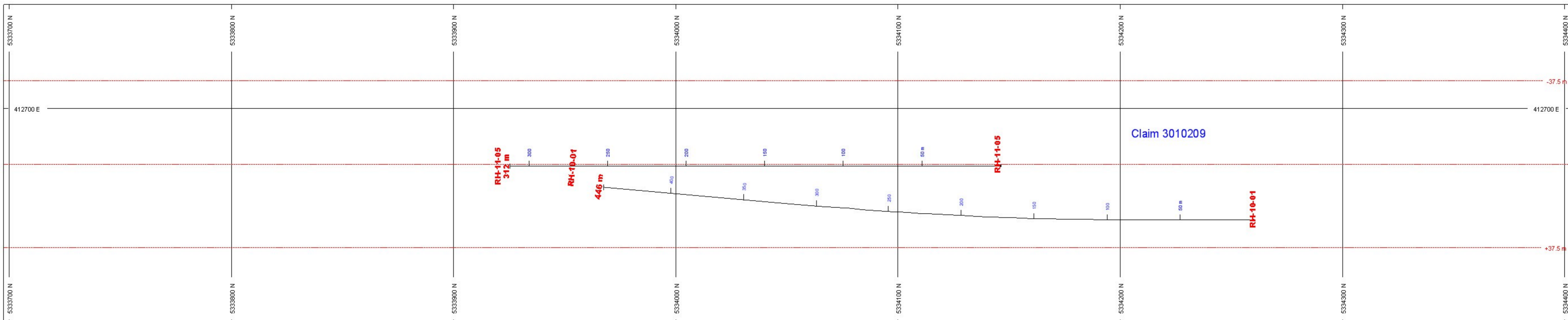

Looking West

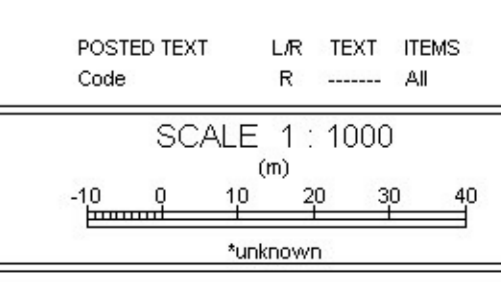

Rogue Resources  
Radio Hill  
Hole RH11-05  
Section 412725E

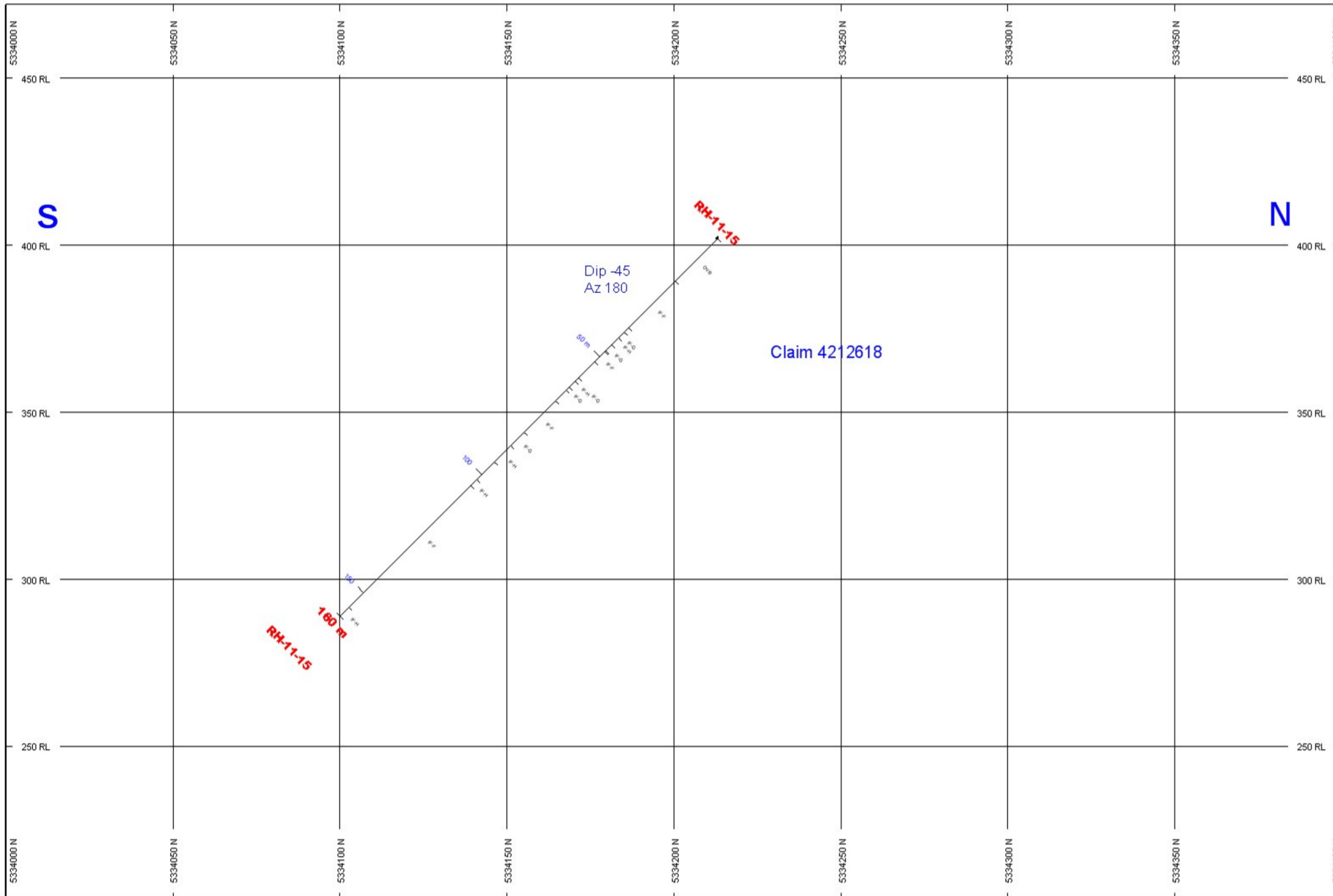
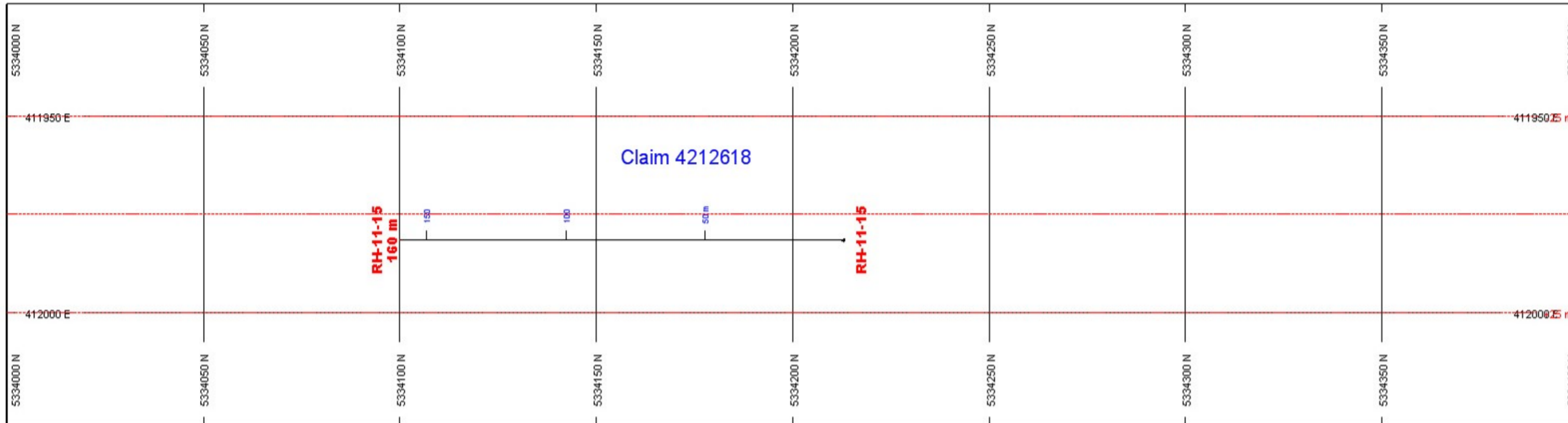

Looking West

POSTED TEXT Code	L/R	TEXT	ITEMS
	R	-----	All

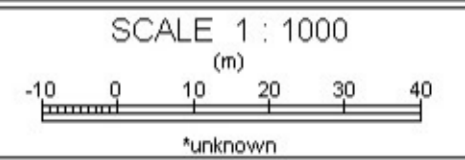

Rogue Resources  
 Radio Hill  
 Hole RH11-15  
 Section 411975E

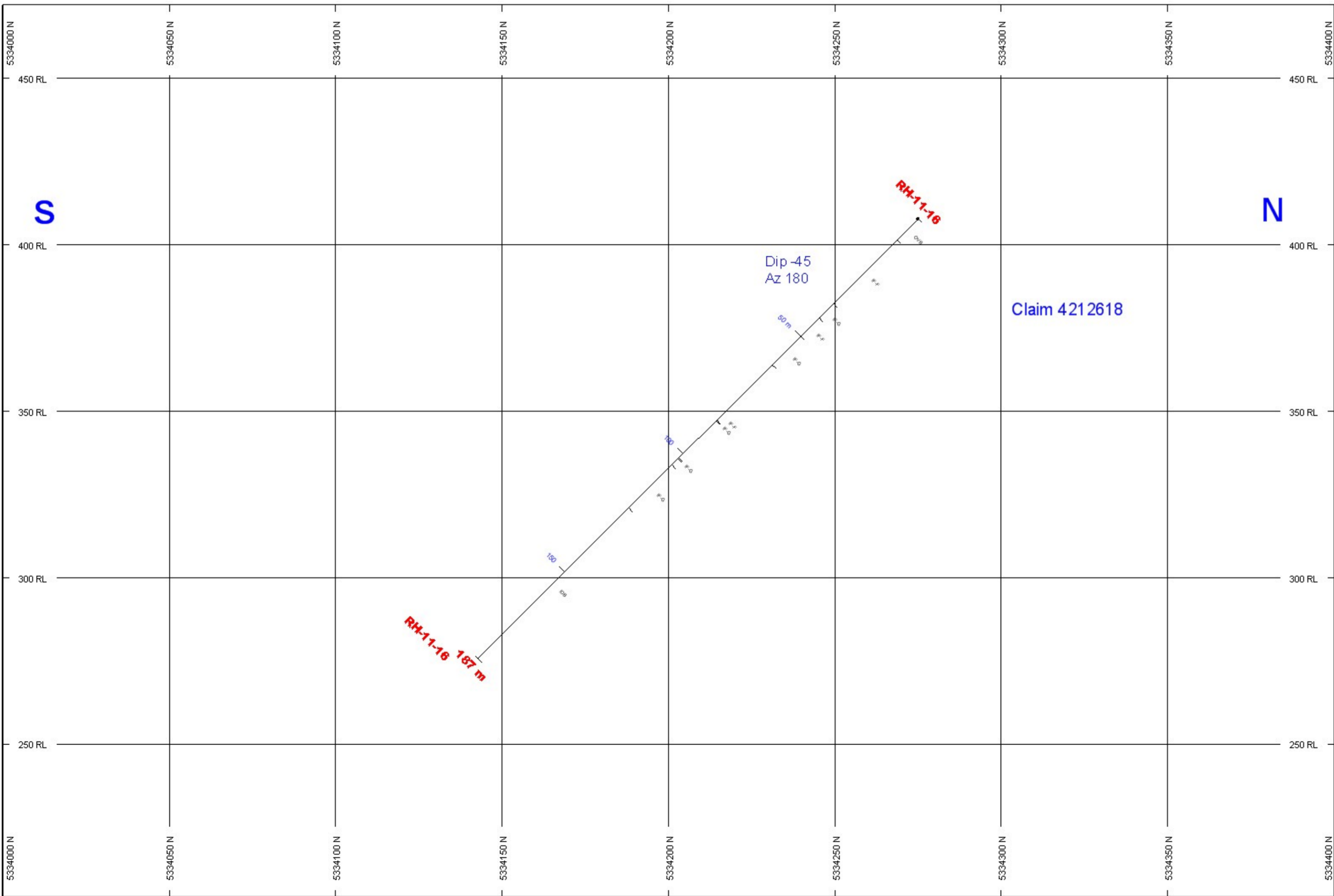
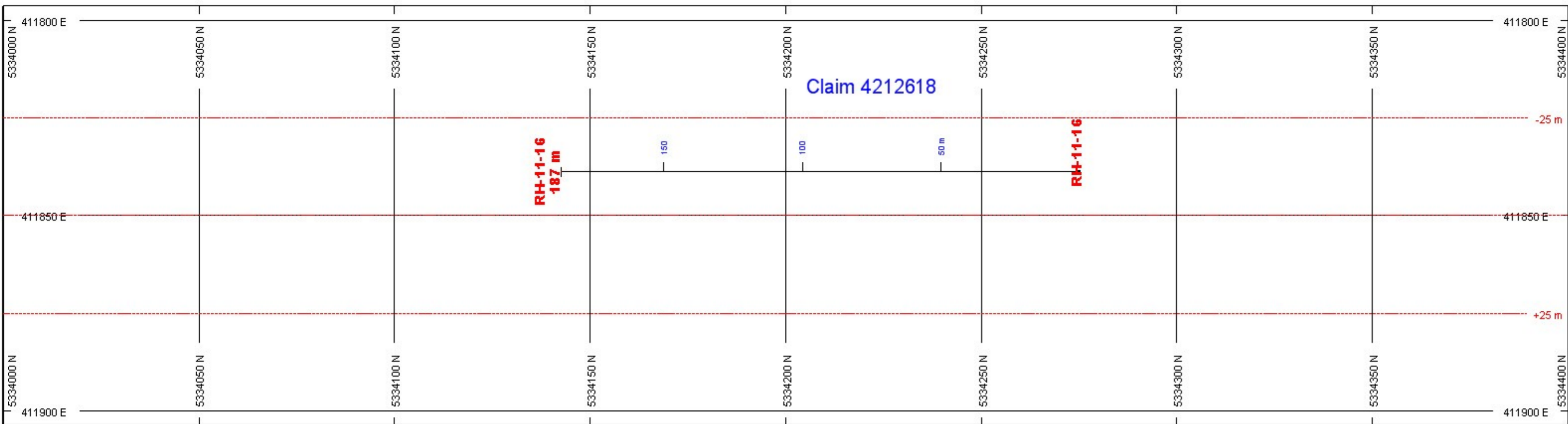

Looking West

POSTED TEXT	L/R	TEXT	ITEMS
Code	R	-----	All

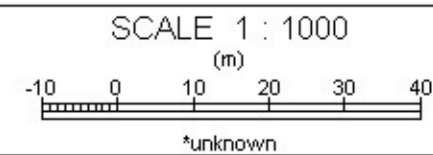

Rogue Resources  
 Radio Hill  
 Hole RH11-16  
 Section 411850E

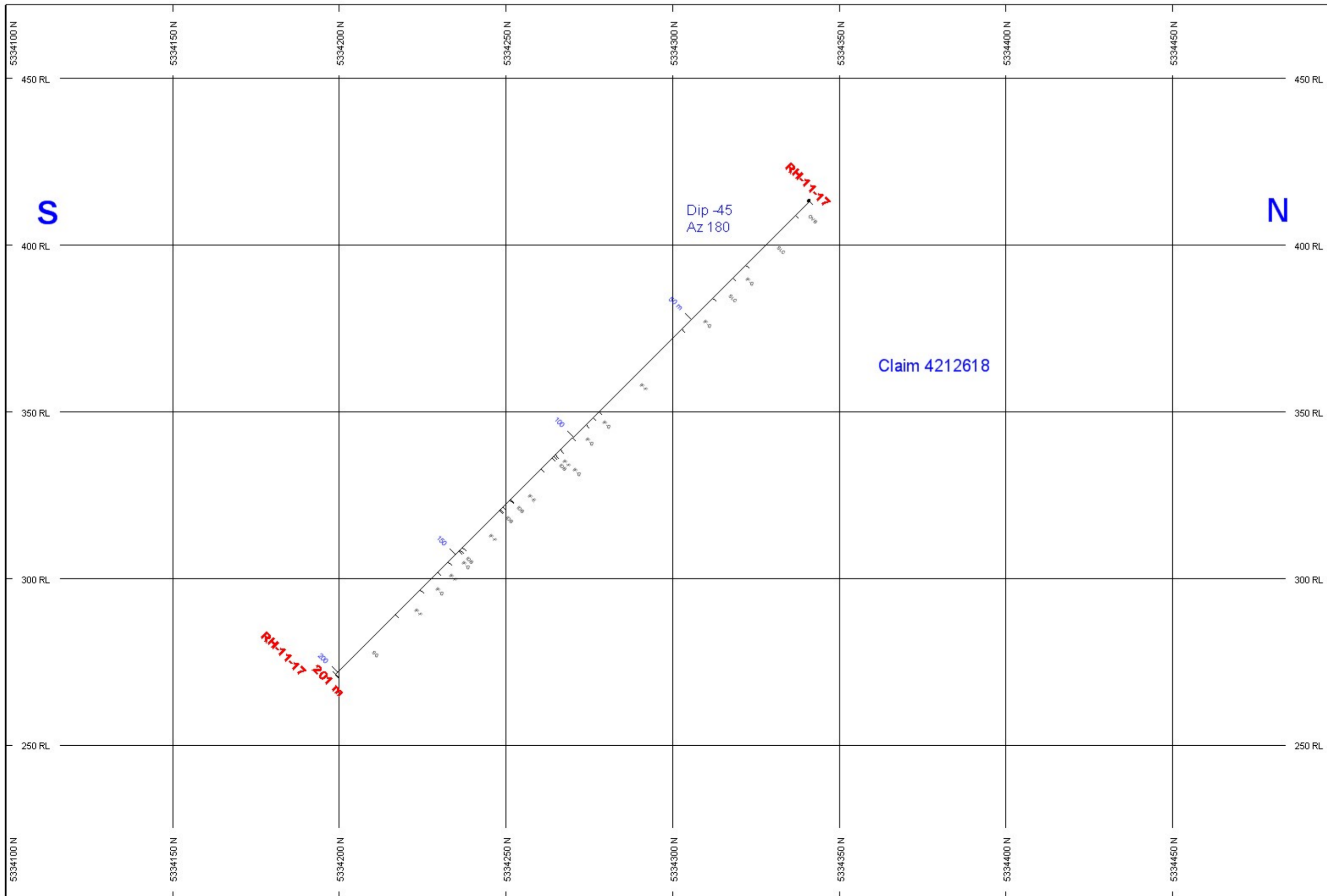
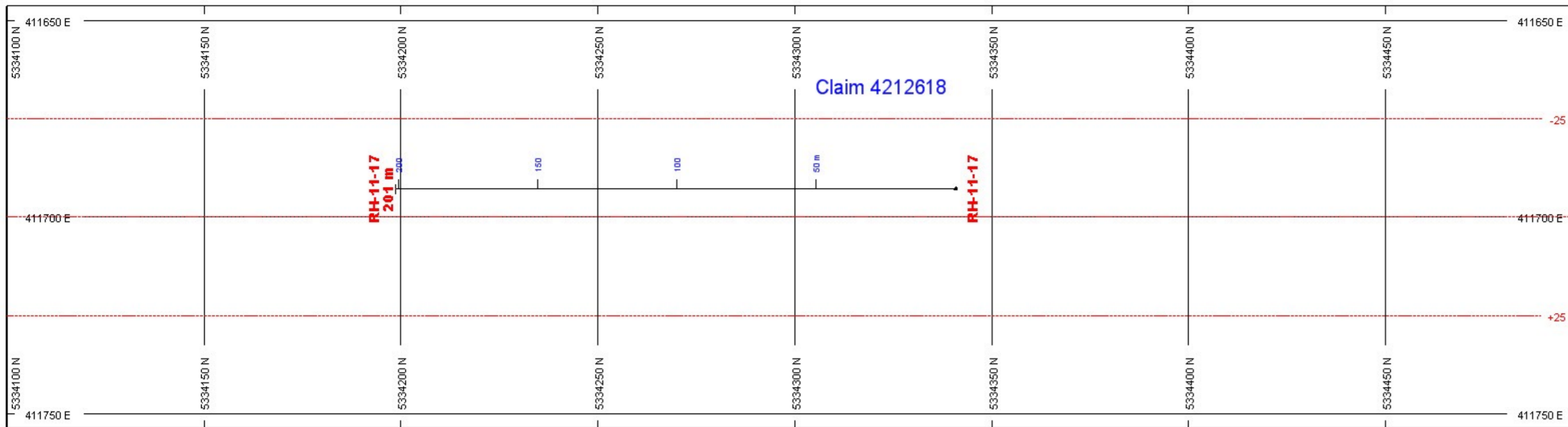

Looking West

POSTED TEXT	L/R	TEXT	ITEMS
Code	R	-----	All

SCALE 1 : 1000



Rogue Resources  
 Radio Hill  
 Hole RH11-17  
 Section 411700E