

Date / Time of Issue: Mon Oct 29 15:02:54 EST 2012

TOWNSHIP / AREA
GREENLAW

PLAN
G-3235

ADMINISTRATIVE DISTRICTS / DIVISIONS

Mining Division: Porcupine
Land Titles/Registry Division: SUDBURY
Ministry of Natural Resources District: CHAPLEAU

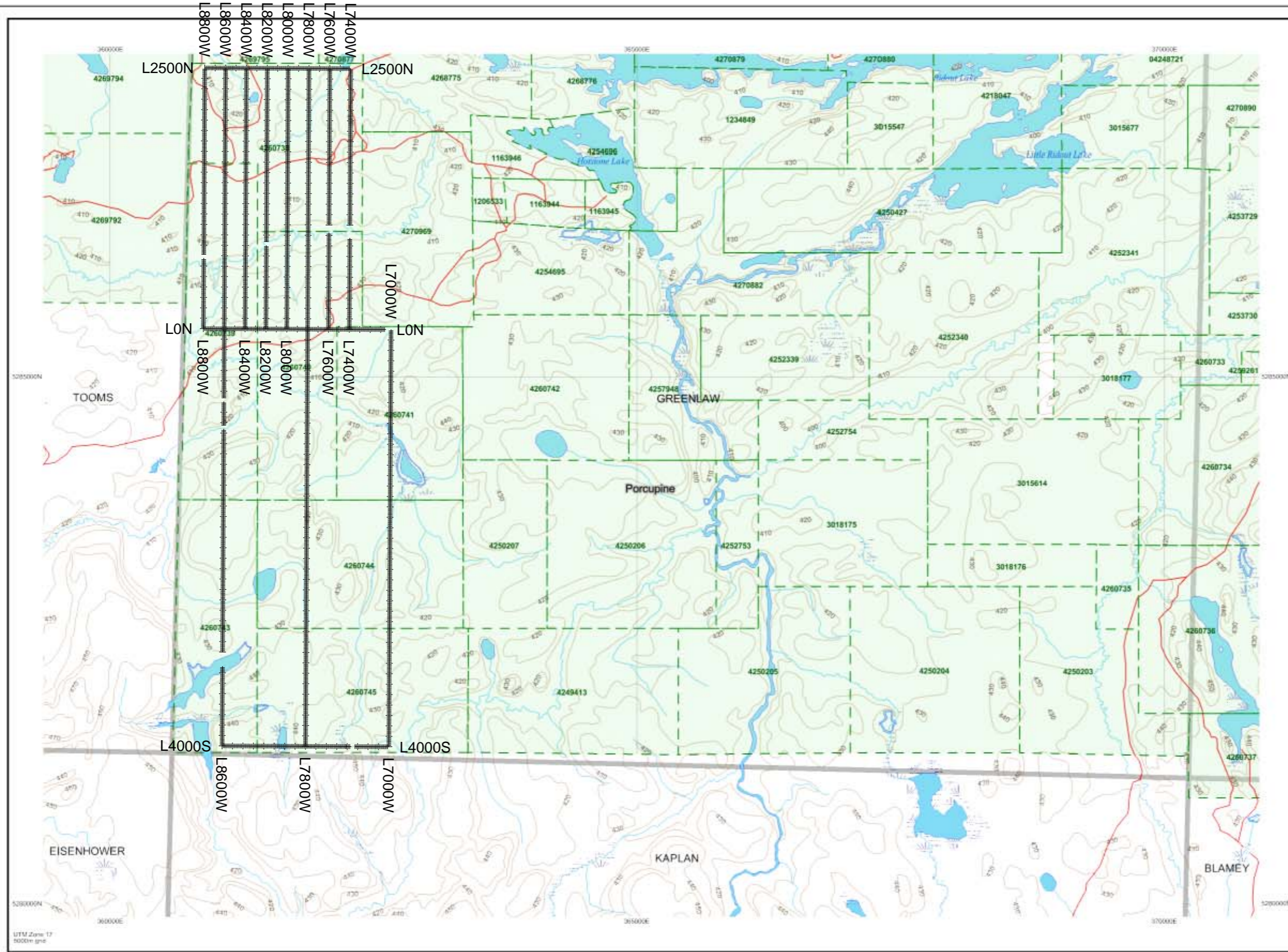

TOPOGRAPHIC

- Administrative Boundaries
- Township
- Concession Lot
- Provincial Park
- Indian Reserve
- C.I.T. Pit & Pile
- Contour
- Mine Shaft
- Mine Headframe
- Railway
- Road
- Trail
- Natural Gas Pipeline
- Utilities
- Tower

Land Tenure

- Freehold Patent:**
- Surface And Mining Rights
 - Surface Rights Only
 - Mining Rights Only
- Leasehold Patent:**
- Surface And Mining Rights
 - Surface Rights Only
 - Mining Rights Only
- License of Occupation:**
- User Not Specified
 - Surface And Mining Rights
 - Surface Rights Only
 - Mining Rights Only
 - Land Use Permit
 - Order In Council (Not open for asking)
 - Water Power Lease Agreement

CROCKETT	RANDY	ROLLO
HALCROW	DENYIS	EMAYZE
TOOME	GREENLAW	CUMMINGS
BRENNOWER	KAPLAN	BLAMEY
HILLIAMS	WAKAM	SHIPLEY

123467 Mining Claim
123467 Filed Only Mining Claims

LAND TENURE WITHDRAWALS

1234 Areas Withdrawn from Disposition
Mining Acts Withdrawal Types
W'm Surface And Mining Rights Withdrawn
W's Surface Rights Only Withdrawn
W'm Mining Rights Only Withdrawn
Order In Council Withdrawal Types
W'm Surface And Mining Rights Withdrawn
W's Surface Rights Only Withdrawn
W'm Mining Rights Only Withdrawn

No IMPORTANT NOTICES



Those wishing to stake mining claims should consult with the Provincial Mining Recorders' Office of the Ministry of Northern Development and Mines for additional information on the status of the lands shown hereon. This map is not intended for navigational, survey, or land title determination purposes as the information shown on this map is compiled from various sources. Completeness and accuracy are not guaranteed. Additional information may also be obtained through the local Land Titles or Registry Office, or the Ministry of Natural Resources.

The information shown is derived from digital data available in the Provincial Mining Recorders' Office at the time of downloading from the Ministry of Northern Development and Mines web site.

General Information and Limitations
 Contact Information:
 Provincial Mining Recorders' Office
 Wilex Green Miller Centre 933 Ramsey Lake Road
 Sudbury ON P3E 6B5
 Home Page: www.mdm.gov.on.ca/MNDM/MINES/LANDS/mimnprpge.htm

Toll Free:
 Tel: 1 (888) 415-9845 ext 574
 Fax: 1 (877) 670-1444

Map Datum: NAD 83
 Projection: UTM 18 Degree
 Topographic Data Source: Land Information Ontario
 Mining Land Tenure Source: Provincial Mining Recorders' Office

This map may not show unregistered land tenure and interests in land including certain patents, leases, easements, right of ways, flooding rights, licences, or other forms of disposition of rights and interest from the Crown. Also certain land tenure and land uses that restrict or prohibit free entry to stake mining claims may not be illustrated.