

Date / Time of Issue: Mon Jan 09 13:38:53 EST 2012

TOWNSHIP / AREA  
ARNOLD

PLAN  
M-0321

ADMINISTRATIVE DISTRICTS / DIVISIONS

Mining Division  
Land Titles/Registry Division  
Ministry of Natural Resources District

Larder Lake  
TIMISKAMING  
KIRKLAND LAKE

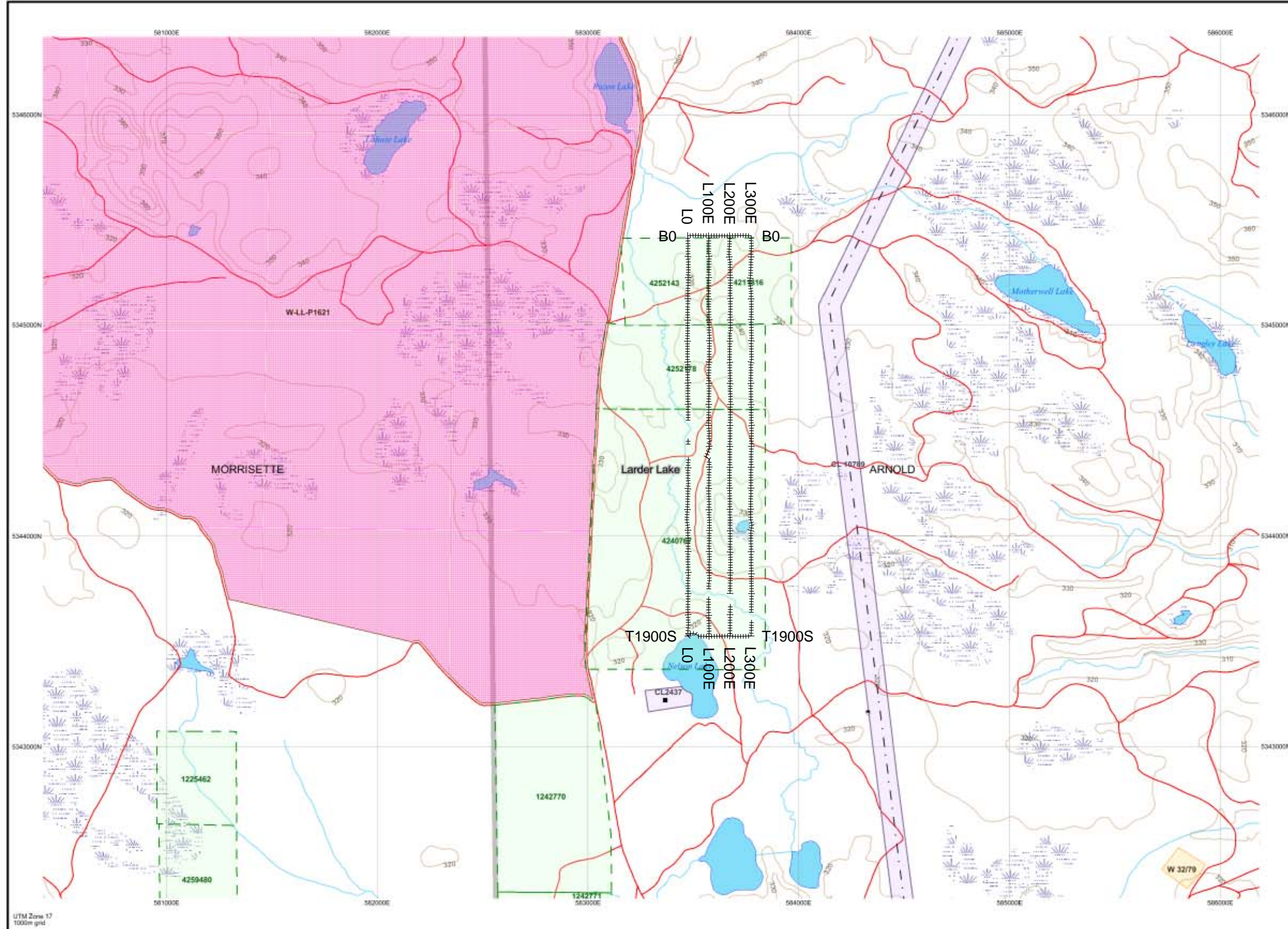

TOPOGRAPHIC

- Administrative Boundaries
- Township
- Concession, Lot
- Provincial Park
- Indian Reserve
- Cliff, Pt & Pile
- Contour
- Mine Shafts
- Mine Headframe
- Railway
- Road
- Trail
- Natural Gas Pipeline
- UBBias
- Tower

Land Tenure

- Freehold Patent**
  - Surface And Mining Rights
  - Surface Rights Only
  - Mining Rights Only
- Leasehold Patent**
  - Surface And Mining Rights
  - Surface Rights Only
  - Mining Rights Only
- Licence of Occupation**
  - Uses Not Specified
  - Surface And Mining Rights
  - Surface Rights Only
  - Mining Rights Only
  - Land Use Permit
  - Order in Council (Not open for staking)
  - Water Power Lease Agreement

BARNET	THACKERAY	ELLIOTT	TANNEHILL
MELBA	WILEY	CLIFFORD	DEWNEWE
BORNHART	MORRISETTE	ARNOLD	KATRINE
TUCK	LEBEL	GAUTHER	MCVITTIE
OTTO	BOSTON	MOELROY	HEARST

LAND TENURE WITHDRAWALS

- Mining Claim
- Filed Only Mining Claims
- 1234** Areas Withdrawn from Disposition
  - Mining Acts Withdrawal Types
  - Wsm Surface And Mining Rights Withdrawn
  - Ws Surface Rights Only Withdrawn
  - Wm Mining Rights Only Withdrawn
  - Order In Council Withdrawal Types
  - W'sm Surface And Mining Rights Withdrawn
  - W's Surface Rights Only Withdrawn
  - W'm Mining Rights Only Withdrawn

IMPORTANT NOTICES



LAND TENURE WITHDRAWAL DESCRIPTIONS (list may not be complete)

Identifier	Type	Date	Description
8997	Ws	Jan 1, 2001	SURFACE RIGHTS WITHDRAWN FROM STAKING SECTION 43 ORDER (R.S.O. 1970) FILE NO 163407
EASEMENT W 32/79	Wsm	Jul 2, 2002	Crown Easement CRE 395 CL 10790 part 1
W-L-L-P1621	Wm	May 4, 2001	NR W 32/79 172213 MAY 4/79 S.R.O.
	Wsm	Feb 1, 2004	Boundary generally depicts area withdrawn Click to view actual area="a"

Those wishing to stake mining claims should consult with the Provincial Mining Recorders' Office of the Ministry of Northern Development and Mines for additional information on the status of the lands shown hereon. This map is not intended for navigational, survey, or land title determination purposes as the information shown on this map is compiled from various sources. Completeness and accuracy are not guaranteed. Additional information may also be obtained through the local Land Titles or Registry Office, or the Ministry of Natural Resources.

The information shown is derived from digital data available in the Provincial Mining Recorders' Office at the time of downloading from the Ministry of Northern Development and Mines web site.

General Information and Limitations

Contact Information:  
Provincial Mining Recorders' Office  
Wilket Green Miller Centre 933 Ramsey Lake Road  
Sudbury ON P3E 6B5  
Home Page: [www.mndm.gov.on.ca/MNDM/MINES/LANDS/mismppg.htm](http://www.mndm.gov.on.ca/MNDM/MINES/LANDS/mismppg.htm)

Toll Free  
Tel: 1 (888) 415-9845 ext 574  
Fax: 1 (877) 670-1444

Map Datum: NAD 83  
Projection: UTM (6 degree)  
Topographic Data Source: Land Information Ontario  
Mining Land Tenure Source: Provincial Mining Recorders' Office

This map may not show unregistered land tenure and interests in land including certain patents, leases, easements, right of ways, flooding rights, licences, or other forms of disposition of rights and interest from the Crown. Also certain land tenure and land uses that restrict or prohibit free entry to stake mining claims may not be illustrated.