

Assays for Assessment

Sothman Twp.

Claim 4259233

J G Salo
For
2127800 Ontario Inc.
An
Roy Annett

While traversing the claim in order to prepare an Exploration Plan and Permit application, Steve Anderson of Vision Exploration collected some samples for assaying.

He was originally looking for the quartz stockwork as show on Map 1953-03.

Project Location
Sothman Township
Porcupine Mining Divison
Claim 4259233 1 unit

The property is accessed via the Grassy Lake Road from its starting point at Highway 560, approximately 6 km east of the hamlet of Shining Tree. Following the Grassy Lake Road north for approximately 50 km to a secondary road which leads west to a boat landing on the Grassy River near Sinclair Lake. A boat is required to reach the claim 5km westerly on the Grassy River to the northeast corner of Sinclair Lake.

General Geology- The area of Sothman Township in which the claim lies are all Pre-Cambrian age. Consisting of folded volcanics and sedimentary horizons cut by irregular shaped bodies of basic intrusives and regular shaped dikes of predominately north striking diabase. Part of the claim is covered by younger flat-lying Cobalt series sediments.

The property is on the east shore of Sinclair Lake which supports small islands of peridotites that are soft, black and appear serpentine rich. The west shore of Sinclair Lake is granite. The property is underlain by mafic volcanics. It exhibits some pillow structures and dioritic rocks that are lightly colored with flecks of pink and white feldspar. Pyrite is common in these rocks.

A series of detailed works have been done the area adjacent to the claim. Directly on the claim work was performed by Miami General Development Mines Limited in 1948. The work is outlined in assessment reports 41P14SW0008 and 41P14SE0046. Miami General covers two properties in these reports- the Miami Group and the Hanson Group of which the claim lies in the Hanson Group. Miami performed geological mapping and Iso-dynamic contours of vertical Intensities. These reports mention that gold was first found on the property by an Indian trapper during WW1. These reports also discuss finding "colors" while panning.

OGS produced a geology map for Sothman Township (Map M1953-03)

In 1969, Albert Decker drilled 4 very short holes on the north boundary of the claim but does not include any assays in the drill logs.

An AEM survey was done by MNM in 1990. This survey identified 2 conductors on the present claim.

In 2004, Mustang Minerals flew a survey over the adjacent claim in Nursey Twp (AFRI 41P14SW2005) and the mapping of the survey shows a 6 and a 5 channel conductor anomaly on the current claim.

In 2008, Ra Resources, under option, performed a VLF and Magnetometer survey over the area of the 2 conductors.

Attached are sample location maps, assays and invoice.

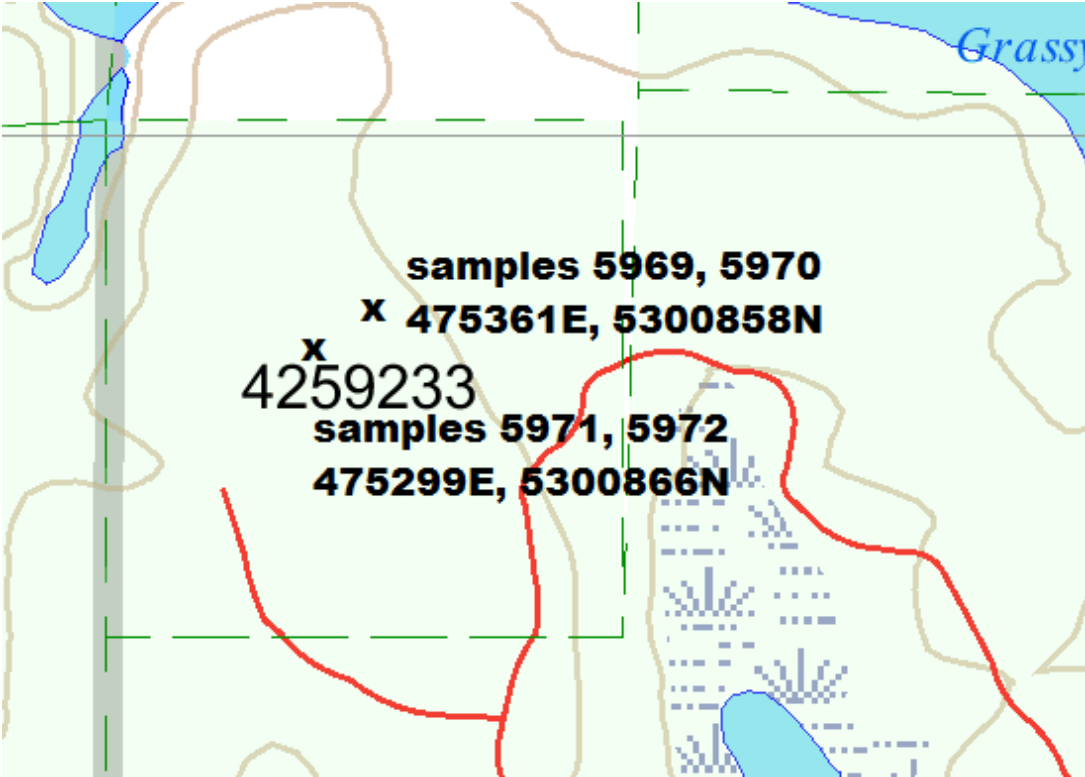

Results

Analyte Symbol	Av
Unit Symbol	ppb
Detection Limit	5
Analysis Method	FA-AA
5989	< 5
5970	< 5
5971	< 5
5972	< 5

Activation Laboratories Ltd.

Report: A14-07320

QC

Analysis Symbol	Au
Unit Symbol	ppb
Detection Limit	5
Analysis Method	F-AQA
SPS7 Meas	655
SPS7 Cert	835.000
Method Blank	< 5
Method Blank	< 5

Quality Analysis ...



Innovative Technologies

This is your final copy. If you require an original to be mailed by post please advise, otherwise this email will be deemed sufficient.

Invoice No.: A14-07320
Purchase Order:
Invoice Date: 09-Oct-14
Date submitted: 06-Oct-14
Your Reference:
GST #: R121979355

Vision Exploration
PO Box 1080
Timmins Ontario P4N 1G1
Canada

ATTN: Vision Exploration Steve Anderson

INVOICE

No. samples	Description	Unit Price	Total
4	RX1-T(TIMMINS)	\$ 10.00	\$ 40.00
4	1A2-Timmins	\$ 15.00	\$ 60.00
		Subtotal: :	\$ 100.00
		HST-13% :	\$ 13.00
		AMOUNT DUE: (CAD) :	\$ 113.00

Net 30 days. 1 1/2 % per month charged on overdue accounts.

Bank Transfers can be made to:
ACTIVATION LABORATORIES LTD at
ROYAL BANK OF CANADA
59 WILSON STREET WEST
ANCASTER, ONTARIO CANADA L9G 1N1
TRANSIT #: 00102 003 ACCOUNT #: 100 154 4
SWIFT CODE#: ROYCCAT2

Please reference the invoice number when making a payment by Bank/Wire transfer. Intermediary Bank Fees are the responsibility of the client.
Thank you!



ACTIVATION LABORATORIES LTD.

41 Bittern Street, Ancaster, Ontario Canada L9G 4V5 TELEPHONE +1.905.648.9611 or +1.888.228.5227 FAX +1.905.648.9613

E-MAIL ancaster@actlabs.com ACTLABS GROUP WEBSITE <http://www.actlabs.com>