

2012 TRENCHING AND BLAST SITE PROGRAM

ON

**CLM-399
HARKER TOWNSHIP
LARDER LAKE MINING DIVISION**

2-53416

FOR

TIGER GOLD EXPLORATION CORPORATION

Dec. 13th/2012

Miss Wendy K. Weller, Geotech.

RECEIVED
DEC 20 2012
GEOSCIENCE ASSESSMENT
OFFICE

TABLE OF CONTENTS

SUMMARY	3
INTRODUCTION	3,4
LOCATION AND ACCESS	5
REGIONAL GEOLOGY	5
PREVIOUS WORK	6
PRESENTATION AND DISCUSSION OF FIELD WORK	6,7
OBSERVATIONS AND CONCLUSIONS	8
ASSAY CERTIFICATES	
BIBLIOGRAPHY	9
CERTIFICATE	11
<u>MAPS</u>	
CLAIM LOCATION MAP	5 a)
GRID LOCATION MAPS: UTM CORDINATES FOR ALL SITES	back pocket
SITE MAPS: CLM-399	8 a,b
Mr. John E. Perron Invoice for work	
Miss Wendy K. Weller Invoice for work	
ROY G. NEWMAN PROSPECTING & EXPLORATION SERVICES	BILLINGS
ROY G. NEWMAN PROSPECTING & EXPLORATION SERVICES	DAILY WORK SHEETS
COMPILATION MAP	Back Pocket

SUMMARY

This report is a geophysical survey as required by The Ministry of Northern Development and Mines for assessment work purposes, following the recommendation set forth in the The Mining Act Regulations 1991.

The report includes an introduction to the properties, general geology, field results and conclusions based on the field data.

Technical Data is provided on the Assessment Data form found at the back of this report.

All field data as compiled on Site Geology Maps for CLM-399 are found behind the Observations of each site in the report.

Mr. Roy G. Newman Prospecting and Exploration Services was contracted out to do the drilling of two sites. Mr. E. Boyce (contractor), was contracted to look after the material (dynamite and blasting material) and blasting the sites on CLM 399 in Harker Township.

Miss Wendy K. Weller and assistant were contracted out to re-establish all grid lines and to measure the stripped areas, take samples from the small trenches and blast sites. Mr. Norman Gilmour and John Perron assisted in the sampling.

The report for the project includes all site maps, compilation maps, grid maps (UTM points) and assessment data forms.

For more information please see the daily work sheets at the back of the report.

**2012 TRENCHING AND BLAST SITE PROGRAM
ON
CLM-399
IN
HARKER TOWNSHIP
LARDER LAKE MINING DIVISION**

INTRODUCTION

Work started on, July 22nd, 2012 on CLM-399 in Harker Township. The mechanical work was carried out by R. G. Newman Prospecting Exploration Services, of Kirkland Lake, Ontario. The purpose of this trenching and blast site project was to find where the Northern Rhyolite Zone crosses the property and sample it for potential minerals.

All interpolation and field work, maps, grid control points, re-cut of picket lines (on the seven sites), report writing and government assessment forms was carried out by Miss Wendy K. Weller, Virginiatown, Ontario (Geo-tech).

Supervision of the project was carried out by Mr. John E. Perron, Tiger Gold Exploration Corporation, Kirkland Lake, Ontario.

Ownership of the aforementioned lease CLM-399 has been attested to by Tiger Gold Exploration Corporation and was independently ascertained by the writer.

To date there has been no trenching or blast sites in the northwest section of CLM-399.

LOCATION AND ACCESS

CLM-399 belongs to the Iris Group located in the south east corner of Harker Township and the north east corner of Elliott Township, Larder Lake Mining Division, Ontario.

The property is situated approximately 75 miles east of Timmins, Ontario and approximately 25 miles north to north east of Kirkland Lake, Ontario.

Access to the property is provided by Highway 672 that runs approximately 400 meters west of the west side of the Iris Property north east of survey line of CLM 399.

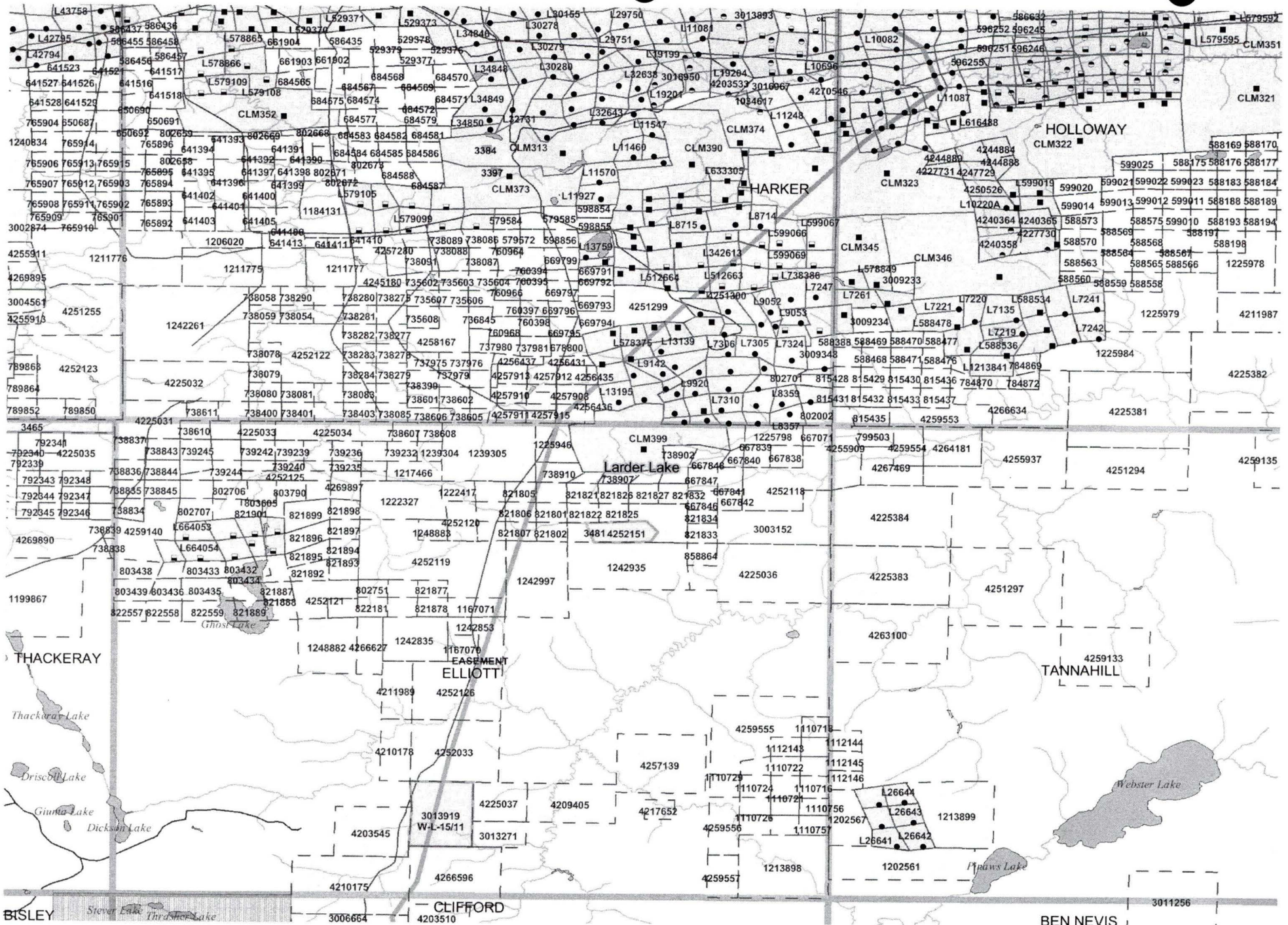

REGIONAL GEOLOGY

The Iris Group is located in the Abitibi Greenstone Belt of the Canadian Shield. This belt is composed of a sequence of metavolcanic and metasedimentary Archean age rocks that cover an area stretching about 220 miles from Timmins, Ontario on the west to Val D'Or, Quebec on the east.

CLM-399 is found in the west section of the Iris Property which is underlain by a sequence of tholeiitic basalt flows belonging to the Upper Blake River Group. This group is composed of a sequence of iron rich and magnesium rich tholeiitic basalt flows forming a stratigraphic package about 30,000 feet thick. These rocks are overlain by younger Blake River Group calc-alkalic volcanics. Both have been folded into a large, east plunging synclinorium, the northern and southern limbs of which have been cut by the major Destor Procupine and Kirkland Lake-Larder Lake fault zones, respectively.

PREVIOUS WORK on CLM-399

During the period 2000 to 2005 detailed ground geophysical surveys were completed by the Perron Group of Companies. All reports can be viewed at the Kirkland Lake Mining Office.

In 2005 in the south west section of CLM-399 a small stripping project was completed along the Southern Rhyolite Horizon. This report can be viewed at the Kirkland Lake Mining Office.

In 2010 a small stripping program was run in the north west corner of CLM-399. This report can be viewed at the ministry office in Kirkland Lake, Ontario.

PRESENTATION AND DISCUSSION OF FIELD RESULTS

In total there are 2 sites on the northwest corner CLM-399. All areas have been stripped, washed, samples taken and assayed and all areas are tied into the existing north/south grid (2000) and GPS waypoints taken (2010 program). For the purpose of this report the field description of the stripping (2010) are included to help identify the geology of the trenches and blast sites.

FIELD DESCRIPTION:

Site A (2010)

Parameters of Site A: PL 2000W 2120N to 2300N

Width- 230 feet

Height-183 feet

Over three quarters of the stripped area is pillow lava. To the north east a contact was noted from pillow lava to flow breccia.

Field Observations:

- 1) Pillow lava
 Colour – dark green (fresh surface)
 Weathering – rust to dark green
 Magnetic – moderate – iron
 Texture- fine grained
 Tops – 80 degrees
 Elongated
 Salvages – thin less than quarter inch – quartz filled small epidote stringers. Quartz vein crossing area at a 48 degree angle, 1 inch to 1 and half inch in width, white to light grey in colour.

- 2) Flow Breccia
 Colour – dark green to black (fresh face)
 Weathering – brown to rust brown
 Magnetic – slightly
 Intense fracturing – 45 degrees to 56 degrees
 No epidote noted
 Few small spider quartz veins noted – white in colour
 Fine grained
 Fine pyrite was noted along the seams of the intensely

SITE A TENCHES AND BLAST SITE

Trench 1

Length: 6.2 feet

Height: 1.9 feet

Samples taken: using the panel sample method

Every two feet starting on the north corner of the trench were taken. 3 samples in total, 1 sample was taken just outside the west side of the trench, all samples can be viewed on the site map for Site A.

Trench 2

Length: 5.3 feet

Height: 1.3 feet

Method for sampling same as trench 1, 3 samples were taken in this site, see site Map A

Blast Site 1

2 feet x 2.3 feet site

1 sample taken

Blast Site 2

2.1 feet x 2.5 feet

1 sample taken

Blast Site 3

2.4 feet by 2.6 feet

1 sample taken

Blast Site 4

2.5 feet x 2.3 feet

1 sample taken

All sites can be seen on Site Map A

Site B:

Parameters of Site B: PL1800W 2083N to 2150N

Width: 155 feet

Height: 105 feet

Over half of the stripped area is flow breccia. To the south the contact between the flow breccia to pillow lava was noted.

There is one small fault noted in the flow breccia crossing north (356 degrees).

Field Observations

- 1) Pillow lava
Colour – dark green
Weathering – rust brown
Magnetic – slightly
Fine grained
Tops – 82 degrees
Salvages – thin less than quarter inch – small white quartz stringers
Elongated
- 2) Flow Breccia
Colour – dark green to black (fresh face)
Weathering – brown to rust brown
Magnetic – slightly
Fracturing – 48 degrees to 54 degrees
Few small spider quartz veins noted, grey to white in colour
Fine grained
Fine pyrite noted along the seams of the fractured breccia

SITE B: TRENCH AND BLAST SITES

Trench 1

Length: 6.22 feet

Height: 2.3 feet

3 two area's sampled, using panel sample method, see Site B map.

Blast Site 1

2 feet x 2.4 feet

1 sample was taken

SITE A - CLM 399 - HARKER TOWNSHIP

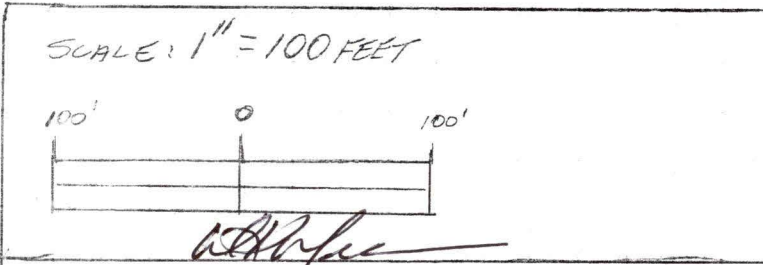

- SYMBOLS
- BLASTSITE (2012)
 - STRIPPED AREA
 - CUM SURVEY PLOT
 - SURVEY LINE
 - ACCESS ROAD
 - NEW CLAIM LINE
- LEGEND
- 1 PILLOW LAVA
 - 2 FLOW BRECCIA
 - FAULT
 - QUARTZ VEIN
 - GRAB SAMPLES
 - TRENCH (2012)

SITE B - CLM 399

HARKER TOWNSHIP

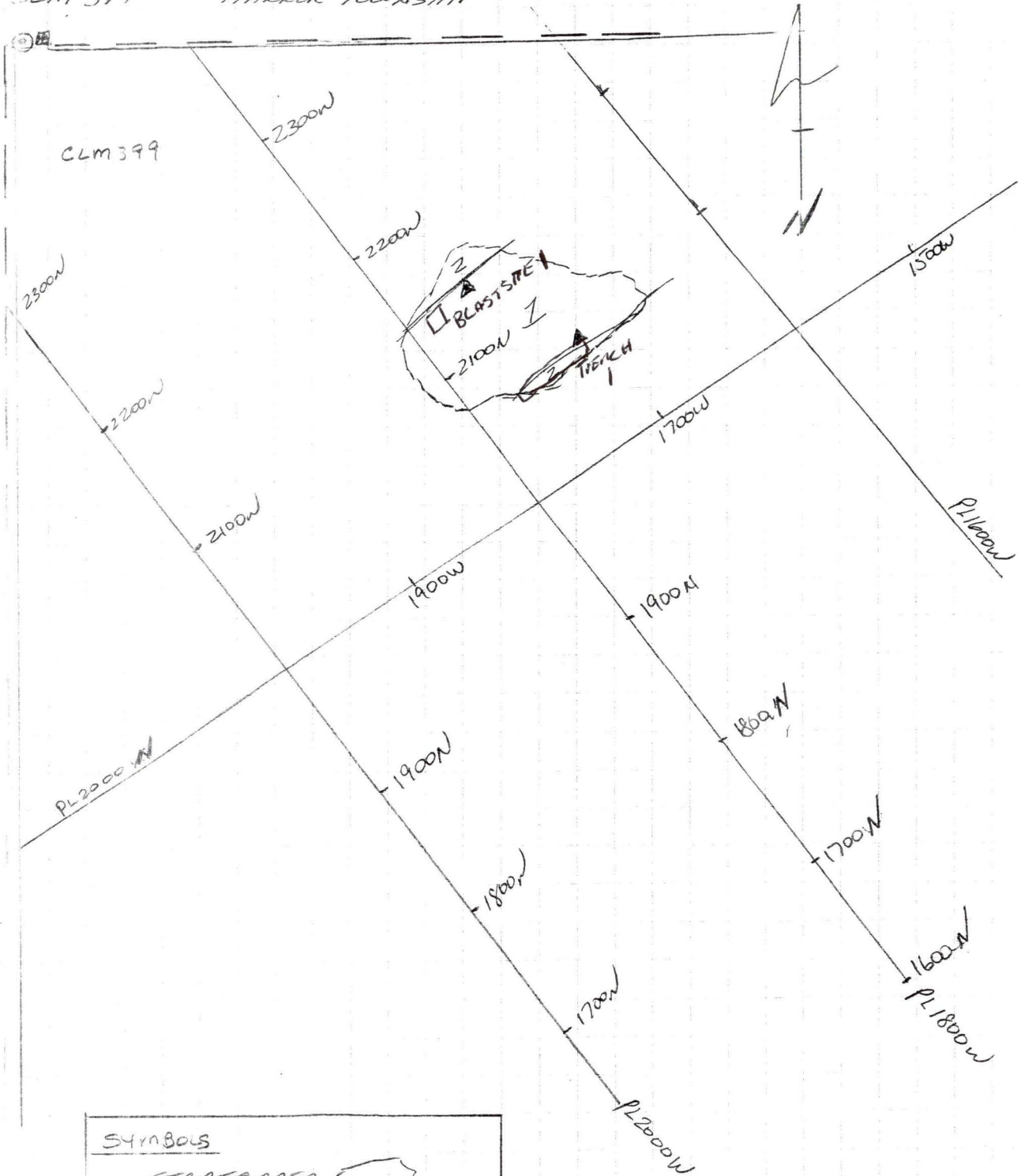

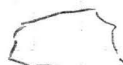

SYMBOLS

STRIPPED AREA 

CLM 399 Post-PIN 

SURVEY LINE 

ACCESS ROAD 

NEW CLAIM LINE 

LEGEND

1 PILLOW LAVA

2 FLOW BRECCIA

 GIAG SAMPLES

 BLAST SITE (2012)

 TRENCH

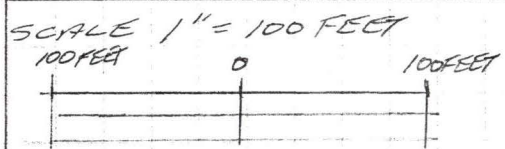

W. H. Harker

OBSERVATIONS AND CONCLUSIONS

D. Drummond (1987) Compilation Map – Back Pocket shows the most Northern Rhyolite Zone crosses the top northwest section of CLM 399. He states in his report (1987) there has been little to no work done on the Northern Rhyolite Zone.

This small trenching and blast site project purpose was to try and uncover where this zone crosses the property. The Rhyolite zone was not found in this project.

It is concluded that the stripping and sampling project:

- 1) confirmed the presence of east-north-east trending diabasic flows with a flow breccia top as well as some diabasic and andesitic pillowed flows. Pillow shapes indicate that stratigraphic tops are to the south. The general bedding attitude is N70-80/75/85 degrees South.
- 2) confirmed small to trace amounts of gold and base metals in small trenches and blast hole sites.

At present time all information concerning the Northern Rhyolite Zone and the Iris Property in whole is being compiled on computer and a discussion will enhance about future projects.

RESPECTFULLY SUBMITTED



Miss Wendy K Weller
Geotech-land manager-agent
Dec. 13th, 2012

REFERENCES

- Jensen, L.S. Geology of Thackeray, Elliott, Tannahill and Dokis Townships, District of Cochrane, Ontario. Geological survey Report 165, 71 p. Accompanied by Maps 2367, 2368, Scale 1:31,680 (1 inch to ½ mile), 1978.
- Ontario Division of Mines Timmins – Kirkland Lake Geological Compilation Series, Map 2205, 1972.
- Ontario Geological Survey Airborne Electromagnetic and Total Intensity Magnetic Survey, Matheson-Black River Area, Elliott Township, by Questor Surveys Limited, Map 80609, Scale 1:20,000. March to July, 1983.

CERTIFICATE

I, Wendy K. Weller, of Virginiatown, Ontario, do hereby certify:

1) That I am a Geotech and reside at:

17 Hilltop Crescent
Box 252
Virginiatown, Ontario
P0K 1X0

- 2) That I graduated from the Haileybury School of Mines as a certified Diamond Driller in 1982. I had a staking license for the past 25 years.
- 3) That I was employed as a Diamond Driller for Heath and Sherwood for 1 year.
- 4) That I have been practicing as a Geotech for a period of twenty seven (27) years and I am qualified to write this report.
- 5) That I supervised and participated in this survey.

Date

Dec 13/2012

Wendy K. Weller

Geotech



Established 1928

Swastika Laboratories Ltd

Assaying - Consulting - Representation

Page 1 of 1

Assay Certificate

Certificate Number: 12-3566

Company: **Tiger Gold Exploration Corp.**

Project: **CLM 399**

Report Date: 29-Oct-12

Attn: **John Perron**

We hereby certify the following Assay of 19 rock/grab samples submitted 22-Oct-12 by John Perron

Sample Number	Au		Ag	Cu	Zn	
	FA-AAS g/Mt	Au Chk FA-AAS g/Mt	AR-AAS ppm	AR-AAS ppm	AR-AAS ppm	
A212751	0.01		< 0.2	30	107	SITE A - TRENCH 1
A212752	< 0.01		< 0.2	23	101	
A212753	< 0.01		< 0.2	40	129	
A212754	0.01		< 0.2	25	78	SITE A TRENCH 2
A212755	< 0.01		< 0.2	19	124	
A212756	< 0.01		< 0.2	18	103	
A212757	< 0.01		< 0.2	20	104	BLAST SITE 1 - SITE A
A212758	< 0.01		< 0.2	28	84	B/S - 2 - SITE A
A212759	< 0.01		< 0.2	41	109	B/S - 3 - SITE A
A212760	< 0.01	< 0.01	< 0.2	23	105	B/S - 4 - SITE A
Blank Value	< 0.01					
A212761	< 0.01		< 0.2	23	108	
OxH97	1.26					
A212762	< 0.01		< 0.2	22	90	SITE B - TRENCH 1
A212763	< 0.01		< 0.2	34	124	
A212764	< 0.01		< 0.2	52	177	BLAST SITE 1 - SITE B
A212765	< 0.01		< 0.2	32	114	BLAST SITE 1 - SITE B
A212766	< 0.01		< 0.2	16	130	" "
A212767	< 0.01		0.2	17	101	" "
A212768	< 0.01		< 0.2	11	97	" "
A212769	< 0.01		< 0.2	47	103	- TRENCH 2 - SITE A

Certified by Jing Lin
Jing Lin, M.Sc.

ERLE BOYCE

865 GOODFISH ROAD, KIRKLAND LAKE, ONTARIO; Telephone 705-567-5893

INVOICE:

September 3, 2012

TO: Tiger Gold Exploration Corporation,
103 Government Road East, Kirkland Lake,
ON, P2N1A9

Attention: John Perron

For Blasting and related services, inclusive of procurement of Dynamite and Blasting supplies and Blasting Crew for the period of September 2, 2012 on the IRIS Property Extension, CLM 399, Harker Township:

Blasting Supplies	\$590.00
Blasting Crew	<u>500.00</u>
Total	<u>\$1090.00</u>

JIM FORBES

200.-
\$ 1290.-

Per:



Erle Boyce

Swastika Laboratories Ltd

Invoice

Box 10, 1 Cameron Ave
Swastika, ON
P0K 1T0

Date	Invoice #
10/30/2012	11725

Invoice To
Tiger Gold Exploration Corp 103 Government Road East Kirkland Lake, ON P2N 1A9

P.O. No.	Terms
	Due on receipt

Qty	Description	Cert #	Rate	Amount
	PROJECT: CLM 399			
19	GOLD ASSAY	12-3566	14.50	275.50
19	SAMPLE PREPARATION		8.00	152.00
19	SILVER		10.00	190.00
19	COPPER		6.00	114.00
19	ZINC		4.00	76.00
	HST (ON) on sales		13.00%	104.98

*paid by
Amy
10/30*

Thank you for your business.	HST Tax Total	\$104.98
	Total	\$912.48

SWASTIKA LABORATORIES
1 CAMERON AVENUE
SWASTIKA, ON
P0K1T0

Oct 30 2012 9:59 am Inv# 100433

TRANSACTION RECORD

Card Number *****1007
Account AMERICAN EXPRESS
Trans Type PURCHASE
Amount \$912.48

Auth # 184519 M@1
Sequence # 001379001
Merchant ID 930230170110
Terminal # P21803015001
Date 10/30/12
Time 09:59:02

APPROVED - THANK YOU

CUSTOMER COPY

Trigui Gold

JOHN E. PERRON, PROSPECTOR
1595 Griffiths Place, West Kelowna, BC, V1Z2T7
Telephone (250)769-6080 Fax: (250) 769-6011

INVOICE

TO: Tiger Gold Exploration Corporation
Exploration Office-Ontario/Quebec
103 Government Road East
Kirkland Lake, ON, P2N1A9

November 15, 2012

IRIS GOLD CLM 399 SITES:

For performance of Report assembly, including assistance in compilation of relevant documents, procurement and gathering of required information and related documents, discussions with Report writer, and related matters, all with respect to the Drilling, Blasting, Trenching and Sampling Programs on the Tiger Gold Exploration Corporation Projects in the Harker-Holloway Gold Camp, Northern Ontario, performed on the Iris Gold Sites, Harker Township, Claim CLM 399 during the Summer and Fall periods of 2012:

: J.E. Perron, Supervisor...2 days @\$350/day	\$700.00
: Truck, 4-wheel drive...62kms @ \$.60x 1 day	37.20
: Lunches: 2 days @\$15.00	<u>30.00</u>

Total **\$767.20**

Per: _____

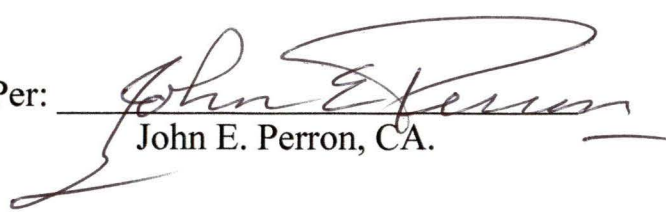
John E. Perron, CA.

PAYMENT DUE IN 30 DAYS OR INTEREST MAY BE APPLIED

JOHN E. PERRON, PROSPECTOR
1595 Griffiths Place, West Kelowna, BC, V1Z2T7
Telephone (250)769-6080 Fax: (250) 769-6011

INVOICE

TO: Tiger Gold Exploration Corporation
Exploration Office-Ontario/Quebec
103 Government Road East
Kirkland Lake, ON, P2N1A9

November 15, 2012

IRIS GOLD CLM 399 SITES:

For performance of Services in respect of the Samples taken from the Drilling, Blasting, Trenching Programs on the Tiger Gold Exploration Corporation Projects in the Harker-Holloway Gold Camp, Northern Ontario, performed on the IRIS GOLD Sites, Harker Township, Claim # CLM 399 during the period of October 21, with the help of Shorty Gilmour, including preparation of relevant documents and the packing, delivery and handling of the numerous bags of the Rock Samples to the Swastika Laboratories Ltd in the town of Swastika:

October 22: J.E. Perron, Supervisor...1/2 day @ \$350/day	\$175.00
: Shorty Gilmour, Helper...1/2 day @ \$200/day	100.00
: Truck, 4-wheel drive...20kms @ \$.60x 1 day	12.00
: Lunches: 1 day @\$15.00 x 2 men	<u>30.00</u>

Total **\$317.00**

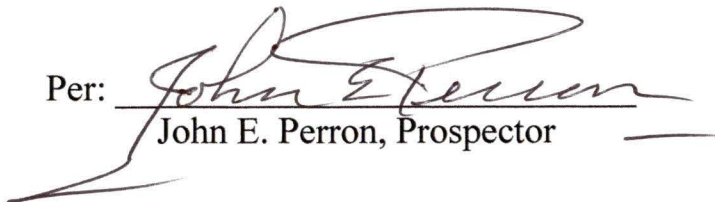
Per: 
John E. Perron, Prospector

PAYMENT DUE IN 30 DAYS OR INTEREST MAY BE APPLIED

JOHN E. PERRON, PROSPECTOR
1595 Griffiths Place, West Kelowna, BC, V1Z2T7
Telephone (250)769-6080 Fax: (250) 769-6011

INVOICE

TO: Tiger Gold Exploration Corporation
Exploration Office-Ontario/Quebec
103 Government Road East
Kirkland Lake, ON, P2N1A9

October 31, 2012

IRIS GOLD CLM 399 SITES:

For performance of Supervisory and Prospecting Services for Sampling of the Drilling, Blasting, Trenching Programs on the Tiger Gold Exploration Corporation Projects in the Harker-Holloway Gold Camp, Northern Ontario, performed on the IRIS GOLD Sites, Harker Township, Claim # CLM 399 during the period of October 21 , with the help of Shorty Gilmour and in the company of Wendy Weller, Geotech in charge, inclusive of rock samples, GPS identification and recording and marking of Sample locations, tagging and bagging samples:

October 21: J.E. Perron, Supervisor...1 day @\$350/day	\$350.00
: Shorty Gilmour, Helper...1 day @ \$200/day	200.00
: Truck, 4-wheel drive...132kms @ \$.60x 1 day	79.20
: Lunches: 1 day @\$15.00 x 2 men	<u>30.00</u>
Total	<u>\$659.20</u>

Per: 

John E. Perron, Prospector

PAYMENT DUE IN 30 DAYS OR INTEREST MAY BE APPLIED

Roy G. Newman

PROSPECTING & EXPLORATION SERVICES

Over 50 Years of Experience

24 OMEARA, KIRKLAND LAKE, ON, P2N 2T6, Tel: (705) 567-6622

INVOICE (Iris Gold):

October 31, 2012

Tiger Gold Exploration Corporation
103 Government Road East
Kirkland Lake, Ontario, P2N1A9

Re: Drilling, Blasting, Trenching, Sampling Project- Harker Township-Claim # CLM 399-IRIS GOLD

August 2,3,4,5,6,7,10,11,13,14,15,16,17,18,19, 2012:

For Drilling, Blasting, Trenching and Sampling Operations at the designated IRIS GOLD sites on Claim CLM 399 in Harker Township, at the agreed on prices for Equipment, Tools, Trucks, Supplies, Fuel, Lubricants, Operators, Labourers and all attendant costs:

PIONJAR Heavy Duty Drill (new), plus Carrying Case, various kinds of new drill bits, different length steels, Diesel fuel cans, spark plugs, filters, drill tools, per day	\$ 200.00
Provision of all Premium #1 Gasoline Fuel and Special 2-stroke Engine Oil, repairs and repair parts, inclusive of freight, per day	100.00
Provision of all ancillary tools and equipment, inclusive of shovels, picks, grub-ho, rakes, Pipe wrenches, machine tools, chainsaw, axe, hammer, sledge hammers, pry-bars. Chains, per day	<u>50.00</u>
Total equipment, tools, gasoline and oil, support supplies, per day	<u>\$ 350.00</u>
1 three-quarter ton Diesel Truck, 4-wheel drive, inclusive of gas and oil, costs, per day	\$ 250.00
1 half-ton 4-wheel drive truck, inclusive of gas and oil, operating costs, tools	<u>250.00</u>
Total trucks, all-in, insurance, repairs, all lubricants, tools, per day, limited mileage	<u>\$ 500.00</u>

Supervisor/Drill Runner, per day	\$ 350.00
Runner @ \$30.00/hour, per day	240.00
Helper @ \$20.00/hour, per day	<u>160.00</u>
Total manpower, per day	<u>\$ 750.00</u>

Per day Direct Drilling cost **\$1600.00**

Days worked in August, 2012, as above: 15 days @ \$1600.00 per day	\$24,000.00
Lunches @ \$15/man/day, \$15 x 3 men x 15 days	<u>675.00</u>

Total Invoice amount for Iris Gold CLM 399 Project **\$24,675.00**

Per: _____



Roy G. Newman (Prospector C23499)

Roy G. Newman

PROSPECTING & EXPLORATION SERVICES

Over 50 Years of Experience

24 OMEARA, KIRKLAND LAKE, ON, P2N 2T6, Tel: (705) 567-6622

INVOICE (IRIS GOLD CLM 399 SITES):

September 30, 2012

Tiger Gold Exploration Corporation
103 Government Road East
Kirkland Lake, Ontario, P2N1A9

Re: Drilling, Blasting, Sampling Project Harker Township-Claim CLM 399 Iris Gold CLM 399 Sites

July 22, 2012: Attending with John Perron, President of Tiger Gold Exploration Corporation, at the Iris Gold CLM 399 Sites in Harker Township, Claim CLM 399 to locate and investigate the stripped rock for determination of Drill targets for Drilling and Blasting and Sampling of the underlying non-weathered and not leached rock for gold and other metals:

1 days at \$300 per day \$300.00

4-wheel drive truck... 132 kms at \$0.60 per km 79.20

Lunches- 1 days at \$15 15.00

Total **\$ 394.20**

Per: 

Roy G. Newman (Prospector C23499)

JOHN E. PERRON, PROSPECTOR
1595 Griffiths Place, West Kelowna, BC, V1Z2T7
Telephone (250)769-6080 Fax: (250) 769-6011

INVOICE

TO: Tiger Gold Exploration Corporation
Exploration Office-Ontario/Quebec
103 Government Road East
Kirkland Lake, ON, P2N1A9

August 31, 2012

IRIS GOLD CLM 399 SITES:

For performance of Supervisory and Prospecting Services for the Drilling, Blasting, Trenching and Sampling Programs on the Tiger Gold Exploration Corporation Projects in the Harker-Holloway Gold Camp, Northern Ontario, performed on the Iris Gold Sites, Harker Township, Claim CLM 399 during the period of July 22, in the company of R.J. Newman, Prospector, inclusive of rock location and investigation for determination of Drill Hole targets for Drilling, Blasting, Trenching and Sampling of the underlying pristine rock:

July 22, 2012: J.E. Perron, Supervisor...1 day @\$350/day	\$350.00
: Truck, 4-wheel drive...132kms @ \$.60x 1 day	79.20
: Lunches: 1 day @\$15.00	<u>15.00</u>

Total **\$444.20**

Per: _____

John E. Perron, Prospector

PAYMENT DUE IN 30 DAYS OR INTEREST MAY BE APPLIED

Roy G. Newman

PROSPECTING & EXPLORATION SERVICES

Over 50 Years of Experience

24 OMEARA, KIRKLAND LAKE, ON, P2N 2T6, Tel: (705) 567-6622

Daily Work Sheet

Client:

Name: TIGER GOLD EXPL. CORP.

Address: 103 GOV'T RD. E, KIRKLAND LAKE

Phone Number: 705-567-3001

Date	Equipment	Job Description	Hours
2012	DRILL	CLM 399 HARKER	
AUG 15	PIONIAR	SUPERVISOR/RUNNER- LAIS GOLD	8
✓ 16	✓	✓ ✓ - ✓ ✓	8
✓ 17	✓	✓ ✓ - ✓ ✓	8
✓ 18	✓	✓ ✓ - ✓ ✓	8
✓ 19	PIONIAR	SUPERVISOR/RUNNER- IRIS	8

Traveling Time

—

Employee's Signature

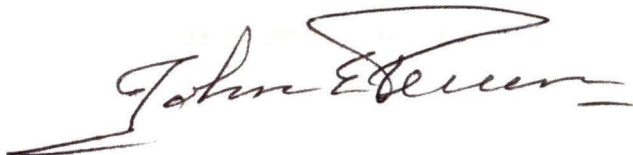

Roy G. Newman

PROSPECTING & EXPLORATION SERVICES

Over 50 Years of Experience

24 OMEARA, KIRKLAND LAKE, ON, P2N 2T6, Tel: (705) 567-6622

Daily Work Sheet

Client:

Name: TIGER GOLD EXPL. CORP.

Address: 103 GOVT. RD. E., K. LAKE

Phone Number: 705-567-3001

Date	Equipment	Job Description	Hours
2012	DRILL	CAM 399 HARKER	
AUG. 7	PIONIAR	SUPERVISOR/RUNNER - IRIS GOLD	8
✓ 10	✓	✓ ✓ ✓ ✓	8
✓ 11	✓	✓ ✓ ✓ ✓	8
✓ 13	✓	✓ ✓ ✓ ✓	8
✓ 14	PIONIAR	SUPERVISOR/RUNNER - IRIS GOLD	8

Traveling Time		

Employee's Signature

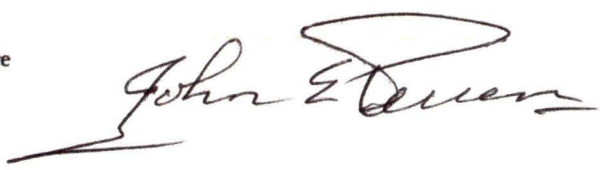

Roy G. Newman

PROSPECTING & EXPLORATION SERVICES

Over 50 Years of Experience

24 OMEARA, KIRKLAND LAKE, ON, P2N 2T6, Tel: (705) 567-6622

Daily Work Sheet

Client:

Name: TIGER GOLD EXPL. CORP.

Address: 103 GOV'T. RD. E K. LAKE

Phone Number: 705-567-3001

Date	Equipment	Job Description	Hours
2012	DRILL	CLM 399 HARKER	
AUG 2	PIONJAR	SUPERVISOR/RUNNER - IRIS GOLD	8
✓ 3	✓	✓ ✓	8
✓ 4	✓	✓ ✓	8
✓ 5	✓	✓ ✓	8
✓ 6	PIONJAR	SUPERVISOR/RUNNER - IRIS GOLD	8

Traveling Time

Employee's Signature

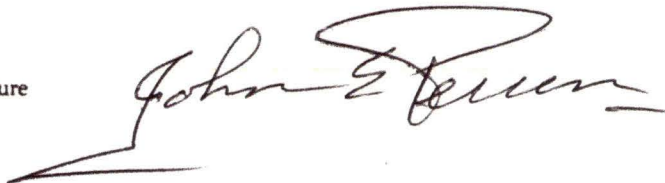

Roy G. Newman

PROSPECTING & EXPLORATION SERVICES

Over 50 Years of Experience

24 OMEARA, KIRKLAND LAKE, ON, P2N 2T6, Tel: (705) 567-6622

Daily Work Sheet

Client:

Name: TIGER GOLD EXPL. CORP
Address: 103 GOV'T. RD. E. K. LAKE
Phone Number: 567-3001

Date	Equipment	Job Description	CLM 399	HARKER	Hours
AUG 15	PIONSTAR	RUNNER		IRIS GOLD	8
16	✓	✓		- -	8
17	✓	✓		- -	8
18	-	-		- -	8
AUG 19	PIONSTAR	RUNNER		IRIS GOLD	8

Traveling Time		
<u>2</u>		

Employee's Signature

M Gilmore

Roy G. Newman

PROSPECTING & EXPLORATION SERVICES

Over 50 Years of Experience

24 OMEARA, KIRKLAND LAKE, ON, P2N 2T6, Tel: (705) 567-6622

Daily Work Sheet

Client:

Name: TIGER GOLD EXPL. CORP.
Address: 103 GOV'T. RD. E. K. LAKE
Phone Number: 567-3001

Date	Equipment	Job Description	CLM 399	HARKER	Hours
AUG 7	PIONJAR	RUNNER		IRIS GOLD	8
✓ 10	✓	✓		✓ -	8
✓ 11	✓	✓		- -	8
- 13	-	✓		- -	8
✓ 14	PIONJAR	RUNNER		IRIS GOLD	8

Traveling Time

—

Employee's Signature

M Gilmore



Roy G. Newman

PROSPECTING & EXPLORATION SERVICES

Over 50 Years of Experience

24 OMEARA, KIRKLAND LAKE, ON, P2N 2T6, Tel: (705) 567-6622

Daily Work Sheet

Client:

Name: TIGER GOLD EXPL. CORP.

Address: 103 GOV'T. RD. E., K. LAKE

Phone Number: 705-567-3001

Date	Equipment	Job Description		Hours
2012	DRILL	CLM 399	HARKER	
AUG. 2	PIONJAR	RUNNER -	IRIS GOLD	8
✓ 3	-	✓	✓ -	8
✓ 4	-	✓	✓ -	8
✓ 5	-	-	✓ -	8
✓ 6	PIONJAR	RUNNER	IRIS GOLD	8

Traveling Time

Employee's Signature

M Gilman



Roy G. Newman

PROSPECTING & EXPLORATION SERVICES

Over 50 Years of Experience

24 OMEARA, KIRKLAND LAKE, ON, P2N 2T6, Tel: (705) 567-6622

Daily Work Sheet

Client:

Name: Tiger gold Expl. corp
Address: 103 govt rd E K lake
Phone Number: 705-5673001

Date	Equipment	Job Description	Client	Hours
2012	Drill	C/m 399	Harker	
Aug 15	Piondar	Helper	irisgold	8
16	✓	✓	✓✓	8
17	✓	✓	✓✓	8
18	✓	✓	✓✓	8
Aug 19	Piondar	Helper	irisgold	8

Traveling Time		

Employee's Signature

C. Custod

JSL

Roy G. Newman

PROSPECTING & EXPLORATION SERVICES

Over 50 Years of Experience

24 OMEARA, KIRKLAND LAKE, ON, P2N 2T6, Tel: (705) 567-6622

Daily Work Sheet

Client:

Name: Tiger gold Expl. Corp
Address: 103 govt rd E K. Lake
Phone Number: 705 567-3001

Date	Equipment	Job Description		Hours
2012	Drill	clm 399	Harker	
Aug 7	Piondar	Helper	1515gold	8
10	✓	✓	✓	8
11	✓	✓	✓	8
13	✓	✓	✓	8
14	Piondar	Helper	1515gold	8

Traveling Time		

Employee's Signature

C. Washburn

JEL

Roy G. Newman

PROSPECTING & EXPLORATION SERVICES

Over 50 Years of Experience

24 OMEARA, KIRKLAND LAKE, ON, P2N 2T6, Tel: (705) 567-6622

Daily Work Sheet

Client:

Name: Tiger gold Expl. corp
Address: 103 govt rd E K lake
Phone Number: 705-567-3001

Date	Equipment	Job Description		Hours
2012	Drill	clm 399	Hacker	
Aug 2	Pion Jar	Helper	iris gold	8
3	✓	✓	✓	8
4	✓	✓	✓	8
5	✓	✓	✓	8
6	Pion Jar	Helper	iris gold	8

Traveling Time		

Employee's Signature

@ [Signature]

[Signature]

AUGUST

July 2012							August 2012						
S	M	T	W	T	F	S	S	M	T	W	T	F	S
1	2	3	4	5	6	7			1	2			
8	9	10	11	12	13	14	5	6	7	8	9	10	11
15	16	17	18	19	20	21	12	13	14	15	16	17	18
22	23	24	25	26	27	28	19	20	21	22	23	24	25
29	30	31					26	27	28	29	30	31	

IRIS GOLD
CLAIM CLM 399 - HARLER

2 Thursday

8:00 ~~STJ+C~~

9:00 ~~Dill - IRIS~~

10:00 ~~Previously stripped~~

11:00 ~~Targets set by~~

12:00 ~~Roy & John July 22.~~

1:00

2:00

3:00

4:00

5:00

6:00

Notes

FIRSTLINE

AUGUST

September 2012							October 2012						
S	M	T	W	T	F	S	S	M	T	W	T	F	S
						1	1	2	3	4	5	6	
2	3	4	5	6	7	8	7	8	9	10	11	12	13
9	10	11	12	13	14	15	14	15	16	17	18	19	20
16	17	18	19	20	21	22	21	22	23	24	25	26	27
23	24	25	26	27	28	29	28	29	30	31			
						30							

IRIS

CLM 399

Friday 3

8:00 ~~STJ+C~~

9:00 ~~Dill IRIS~~

10:00 ~~SLOW~~

11:00 ~~Light rain at noon~~

12:00

1:00

2:00

3:00

4:00

5:00

6:00

Notes

FIRSTLINE

AUGUST

July 2012						
S	M	T	W	T	F	S
1	2	3	4	5	6	7
8	9	10	11	12	13	14
15	16	17	18	19	20	21
22	23	24	25	26	27	28
29	30	31				

August 2012						
S	M	T	W	T	F	S
		1	2	3	4	
5	6	7	8	9	10	11
12	13	14	15	16	17	18
19	20	21	22	23	24	25
26	27	28	29	30	31	

IRIS CLM 399

4 Saturday

8:00 S+J+C 2:00
 9:00 Drill Site 3:00
 10:00 Jan & Wendy 4:00
 11:00 Pictures 5:00
 12:00 - Iris 6:00
 - Shiloh Bits
 - New Button Bits
 - much better

Notes

5 Sunday

8:00 RAIN 2:00 IRIS
 9:00 S+J+C 3:00
 10:00 DRILLING 4:00
 11:00 HOT 5:00
 12:00 MUGGY 6:00
 1:00 SWEAT
 FLIES
 WASPS

Notes

2/16 date

AUGUST

September 2012						
S	M	T	W	T	F	S
						1
2	3	4	5	6	7	8
9	10	11	12	13	14	15
16	17	18	19	20	21	22
23	24	25	26	27	28	29
30						

October 2012						
S	M	T	W	T	F	S
						1
						2
						3
						4
						5
						6
						7
						8
						9
						10
						11
						12
						13
						14
						15
						16
						17
						18
						19
						20
						21
						22
						23
						24
						25
						26
						27
						28
						29
						30
						31

IRIS CLM 399

Monday 6

8:00 S+J+C
 9:00 Drill Site
 10:00 Small Button Bits
 11:00 seem the best
 12:00 Larger Button Bit &
 1:00 screw-on steel also
 2:00 good.
 3:00 HOT & Muggy

Notes

AUGUST

July 2012							August 2012						
S	M	T	W	T	F	S	S	M	T	W	T	F	S
1	2	3	4	5	6	7			1	2	3	4	
8	9	10	11	12	13	14			5	6	7	8	9
15	16	17	18	19	20	21			12	13	14	15	16
22	23	24	25	26	27	28			19	20	21	22	23
29	30	31							26	27	28	29	30
									31				

IRIS
CLM 399

7 Tuesday

8:00 *S & J C* *IR*

9:00 *Drilling*

10:00 *Trouble restarting*

11:00 *Drill*

12:00 *Too hot*

1:00

2:00

3:00

4:00

5:00

6:00

Notes

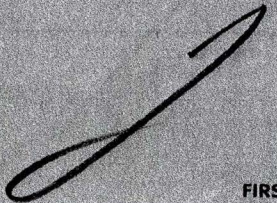

FIRSTLINE

September 2012	October 2012
S M T W T F S	S M T W T F S
1	1 2 3 4 5 6
2 3 4 5 6 7 8	7 8 9 10 11 12 13
9 10 11 12 13 14 15	14 15 16 17 18 19 20
16 17 18 19 20 21 22	21 22 23 24 25 26 27
23 24 25 26 27 28 29	28 29 30 31
30	

AUGUST

IRIS - CLM 399

Friday 10

8:00 Drill - IRIS

9:00 SHIRTY + JOHN
+ CHUCK

11:00 LOTS OF PILLOW LAVA

12:00 SOME SEAMS SO

1:00 HAVE TO BE

2:00 CAREFUL.

3:00 LOTS OF FLIES,

4:00 HORNETS

5:00

6:00

Notes



AUG

AUGUST

July 2012						
S	M	T	W	T	F	S
1	2	3	4	5	6	7
8	9	10	11	12	13	14
15	16	17	18	19	20	21
22	23	24	25	26	27	28
29	30	31				

August 2012						
S	M	T	W	T	F	S
		1	2	3	4	
5	6	7	8	9	10	11
12	13	14	15	16	17	18
19	20	21	22	23	24	25
26	27	28	29	30	31	

IRIS CLM 399

11 Saturday

8:00 RAIN 2:00 IR

9:00 THUNDER 3:00 S&J/C

10:00 HAVE TO STOP 4:00

11:00 WHEN LIGHTING IS TOO CLOSE 5:00

12:00 DRILLING OK - ROCK 6:00

1:00 SLIPPERY Notes J

12 Sunday

8:00 RAIN 2:00

9:00 THUNDER 3:00

10:00 NO DRILLING 4:00

11:00 TOO MANY T-STORMS 5:00

12:00 6:00

1:00 Notes J

September 2012						
S	M	T	W	T	F	S
						1
2	3	4	5	6	7	8
9	10	11	12	13	14	15
16	17	18	19	20	21	22
23	24	25	26	27	28	29
30						

October 2012						
S	M	T	W	T	F	S
						1
2	3	4	5	6	7	8
9	10	11	12	13	14	15
16	17	18	19	20	21	22
23	24	25	26	27	28	29
30	31					

AUGUST

IRIS CLM 399

Monday **13**

8:00 B&S TIME - SHIMON

9:00 Roger Williams Center

10:00 Tony Gabe 2

11:00 SITE

12:00 - Shorty + John + Chuck

1:00 HOT Sunny/Rain

2:00 DRILLING IRIS

3:00

4:00

5:00

6:00

Notes J

AUG

AUGUST

July 2012						
S	M	T	W	T	F	S
1	2	3	4	5	6	7
8	9	10	11	12	13	14
15	16	17	18	19	20	21
22	23	24	25	26	27	28
29	30	31				

August 2012						
S	M	T	W	T	F	S
			1	2	3	4
5	6	7	8	9	10	11
12	13	14	15	16	17	18
19	20	21	22	23	24	25
26	27	28	29	30	31	

IRIS - CIM 399

14 Tuesday

8:00

9:00

10:00

11:00

12:00

1:00

2:00

3:00

4:00

5:00

6:00

Notes

FIRSTLINE

AUGUST

September 2012						
S	M	T	W	T	F	S
					1	
2	3	4	5	6	7	8
9	10	11	12	13	14	15
16	17	18	19	20	21	22
23	24	25	26	27	28	29
30						

October 2012						
S	M	T	W	T	F	S
						1
2	3	4	5	6	7	8
9	10	11	12	13	14	15
16	17	18	19	20	21	22
23	24	25	26	27	28	29
30	31					

IRIS CIM 399

Wednesday 15

8:00

9:00

10:00

11:00

12:00

1:00

2:00

3:00

4:00

5:00

6:00

Notes

FIRSTLINE

AUGUST

July 2012							August 2012						
S	M	T	W	T	F	S	S	M	T	W	T	F	S
1	2	3	4	5	6	7			1	2	3	4	
8	9	10	11	12	13	14	5	6	7	8	9	10	11
15	16	17	18	19	20	21	12	13	14	15	16	17	18
22	23	24	25	26	27	28	19	20	21	22	23	24	25
29	30	31					26	27	28	29	30	31	

IRIS CLM 399

16 Thursday

8:00

9:00

10:00

11:00

12:00

1:00

2:00

3:00

4:00

5:00

6:00

Notes

AUGUST

September 2012							October 2012						
S	M	T	W	T	F	S	S	M	T	W	T	F	S
						1	1	2	3	4	5	6	
2	3	4	5	6	7	8	7	8	9	10	11	12	13
9	10	11	12	13	14	15	14	15	16	17	18	19	20
16	17	18	19	20	21	22	21	22	23	24	25	26	27
23	24	25	26	27	28	29	28	29	30	31			
30													

IRIS CLM 399

Friday 17

8:00

9:00

10:00

11:00

12:00

1:00

2:00

3:00

4:00

5:00

6:00

Notes

AUGUST

July 2012						
S	M	T	W	T	F	S
1	2	3	4	5	6	7
8	9	10	11	12	13	14
15	16	17	18	19	20	21
22	23	24	25	26	27	28
29	30	31				

August 2012						
S	M	T	W	T	F	S
		1	2	3	4	
5	6	7	8	9	10	11
12	13	14	15	16	17	18
19	20	21	22	23	24	25
26	27	28	29	30	31	

IRIS - CLM 399

18 Saturday

8:00 S & J & C 2:00
9:00 IRIS 3:00
10:00 DRILL 4:00 COOL - GOOD
11:00 SWIM 5:00
12:00 FEEL FEEL 6:00
1:00 Notes
J

19 Sunday

8:00 S & J & C 2:00
9:00 IRIS SUN & CLOUDS 3:00
10:00 ~~COOL~~ GOOD TEMP 4:00
11:00 BEES - BW yellow jackets 5:00
12:00 6:00
1:00 IRIS CLM 399 Notes
J

LEGEND

- Quartz vein (with associated gold)
- Interbedded sediments (rhyolite)
- Syenite
- Fault
- Electromagnetic anomaly VLF-EM
- Geochemical anomaly XXXX A.E.M.
- New stripping
- Old trenches
- Old pit workings on showings

1000 0 1000 2000

Scale: 1 inch to 1000 feet

Modified after Greer (1986)

HARKER TOWNSHIP

Golden Harker Mine

No. 1 vein

Showing No. 1

No. 3

No. 2

ELLIOTT TOWNSHIP

HOLLOWAY TOWNSHIP

TANNAHILL TOWNSHIP

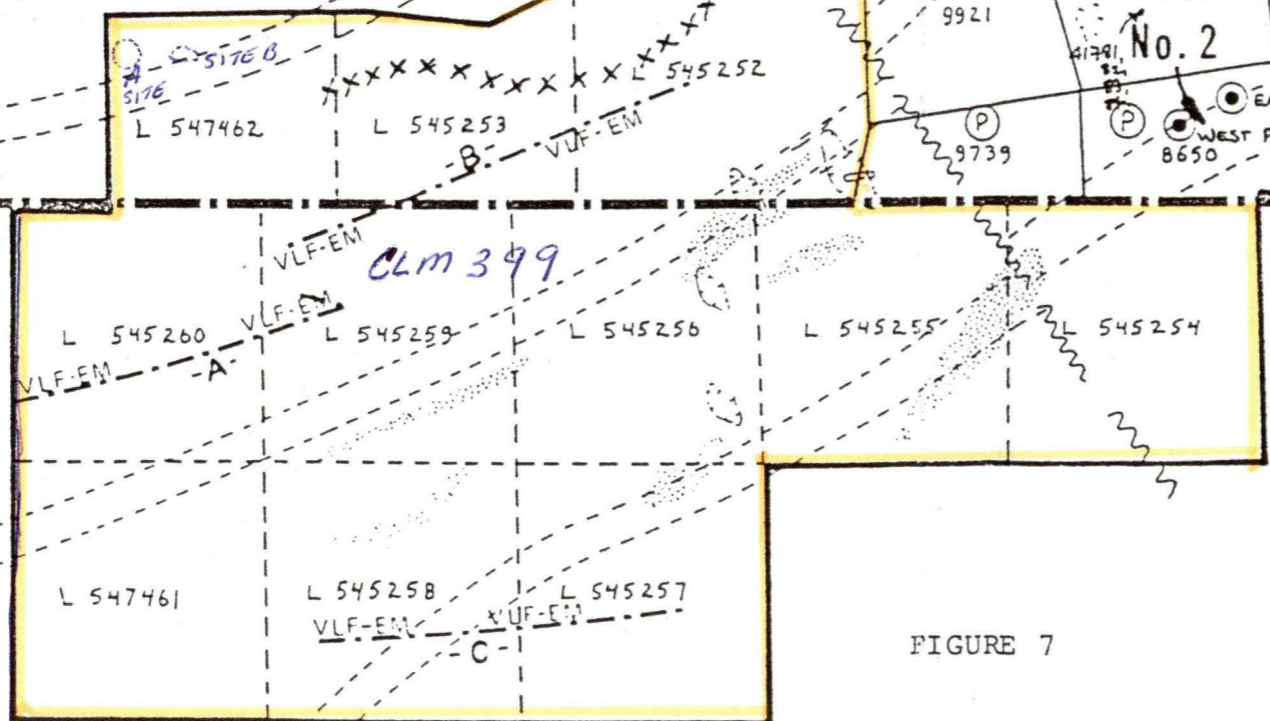

FIGURE 7

(P) DENOTES PATENTED CLAIM

THE ALBERTA GOLD EXPLORATION CORPORATION

IRIS GOLD GROUP

COMPILATION MAP

HARKER - ELLIOTT TOWNSHIP
DISTRICT OF COCHRANE, ONTARIO

