

We are committed to providing [accessible customer service](#).
If you need accessible formats or communications supports, please [contact us](#).

Nous tenons à améliorer [l'accessibilité des services à la clientèle](#).
Si vous avez besoin de formats accessibles ou d'aide à la communication, veuillez [nous contacter](#).

Prospecting report on claim 4279192

Claim 4279192 is registered to Peter Gehrels and Allan Onchulenko

Location and Access

Claim 4279192 is located on the north shore of Sapawe Lake in Hutchinson township (G-0571) approximately 21 km's east-northeast of Atikokan Ontario. Access can be gained travelling north on highway 623 off highway 11 to a boat launch on Sapawe lake alternatively you can access the claim from a camp access road approximately 10 km's north of highway 11 on highway 623 turn west and the road will lead into toward the claim and get within 70m of the claim by atv you can enter the property.

Summary of Previous Work

The property is also referred to as the mammoth occurrence, or mammoth vein

1901 the property was registered as mining location ES53
1926 land transferred
1927 land restaked
1929 mapped by Hawley, (1930)
1933 land restaked
1956 land restaked
1960 land restaked
1960 all interest transferred to Lindsay Exploration
1961 trenching
1963 trenching
1967 land transferred
1969 land restaked
1969 land restaked
1970 land transferred to Kemins Exploration
1973 land restaked
1978 land restaked
1981 property optioned to Steep Rock Iron Mines mapping, geophysics, sampling.

Geology

The country rocks consist of mafic to intermediate metavolcanics with intercalated intermediate to felsic volcanics. Felsic porphyritic rocks of the Marmion Lake Batholith and gabbroic dikes and sills intrude metavolcanics. The occurrence is located 0.5 km's north of the Quetico fault.

The mammoth vein was described as a highly schistose band of chloritic and sericitic rocks with a width of 30 feet, striking north 75 degrees east. In places the schist contains small lenses of quartz and an apple green chromium bearing mica. Original descriptions describe the vein as being 250 feet in length (76m) however we have determined it to be much longer in length.

Prospecting

On April 15 2017 one day was spent prospecting the claim to determine the extent of the mammoth vein and associated shear zone. Prior to the visit 1 day was spent researching previous work reports and ministry documents relating to the mammoth occurrence. During the history of the property several parties have worked pitted trenched and excavated several areas along shear zones found on the property. Some of this work has been recorded and some has not. Our goal was to determine the exact location of the mammoth vein and how traceable it is over length and width. Using estimates from the old reports we were easily able to find some original workings of the mammoth vein in the described location and then prospected both east and west from there. Using a gps we recorded locations of quartz veining in the shear zone in both directions. Although at some places the bedrock is under cover following exposures and digging where there wasn't we determined there to be at least 515 m of length to the shear.

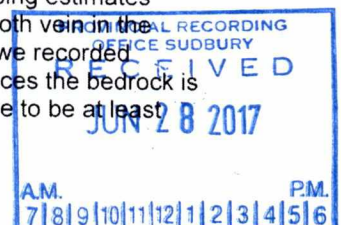

Conclusions and Recommendations

After prospecting along strike of the mammoth vein it was determined that the shear structure is much longer in length than previously described. As the occurrence has never been drilled it would be difficult to estimate the possible depth of the structure. To the east the shear enters the lake and on the west end it dips under swampy cover near the shore of the lake. Likely this is part of an extended shear zone related to the Quetico fault. Prospecting south of the mammoth shear another shear is located and it runs parallel to the mammoth shear. Previous sampling programs have determined areas of elevated gold along the mammoth vein it is recommended to carry out a sampling program along the entire structure to determine if the entire shear is gold bearing.

Maps

Regional map
Claim location
Shear structure map

Summary of work

1 day researching
2 days prospecting by Peter Gehrels and Allan Onchulenko driving return from Thunder Bay Ontario
½ day preparing report and maps

3.5 days x \$250 a day = \$875
190 kms x \$.50 per km = \$95 x 2 = \$190

Total \$1065

Allan Onchulenko

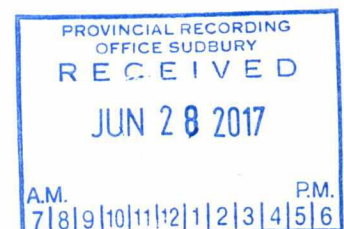

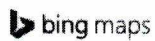

Regional Map

- A** Thunder Bay
B Sapawe Lake, Ontario

2 hr 30 min, 189.5 km

Light traffic (2 hr 27 min without traffic)

Via HWY-17, HWY-11

Location of Sapawe Lake
from Thunder Bay Ont.
re claim 4279192

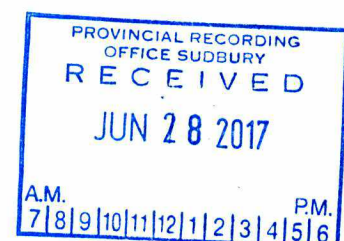
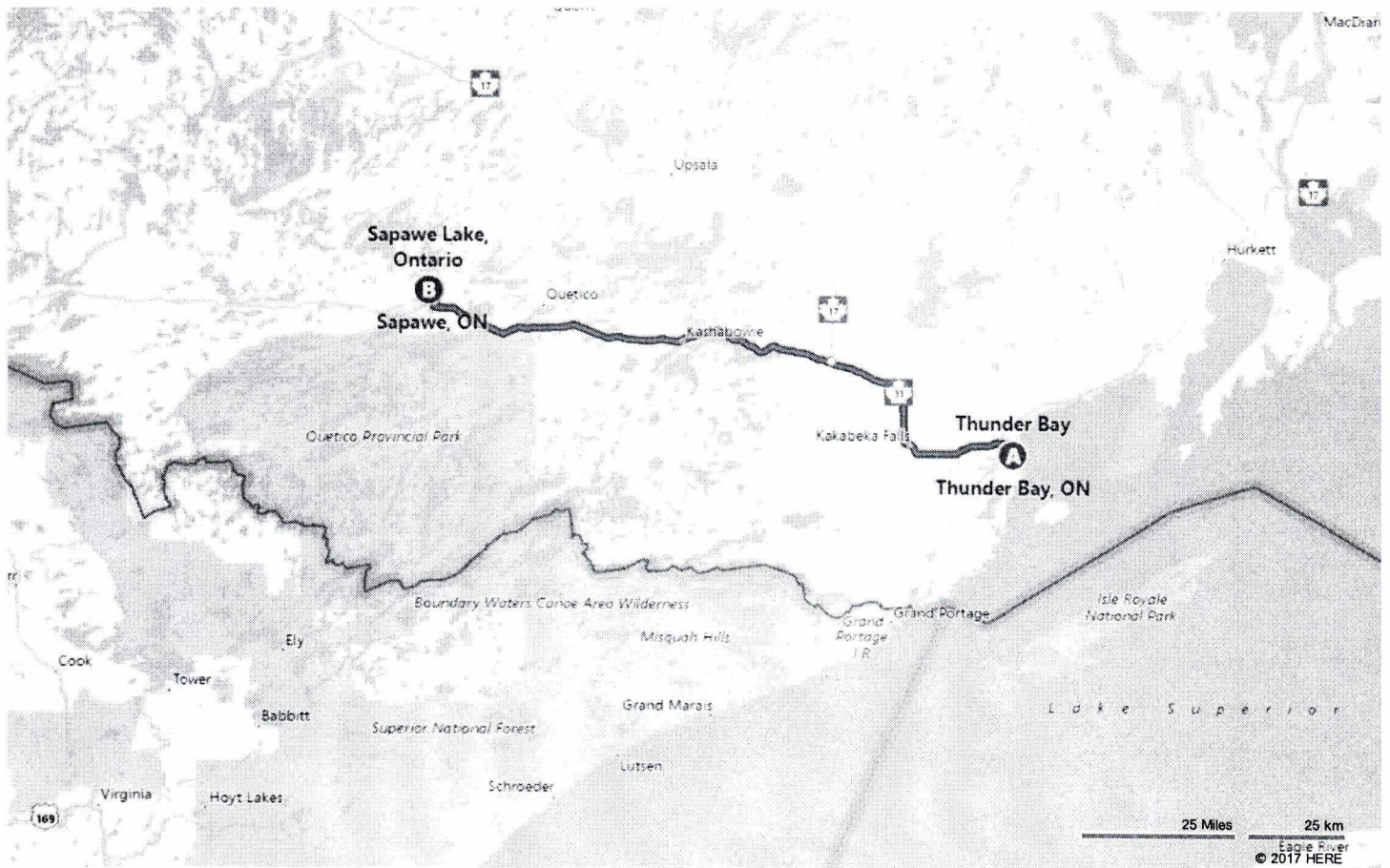

Claim Location

4279192 (2 units)



Ontario

MINISTRY OF NORTHERN DEVELOPMENT AND MINES
CLAIMaps

Enter map title

Notes:

Enter map notes

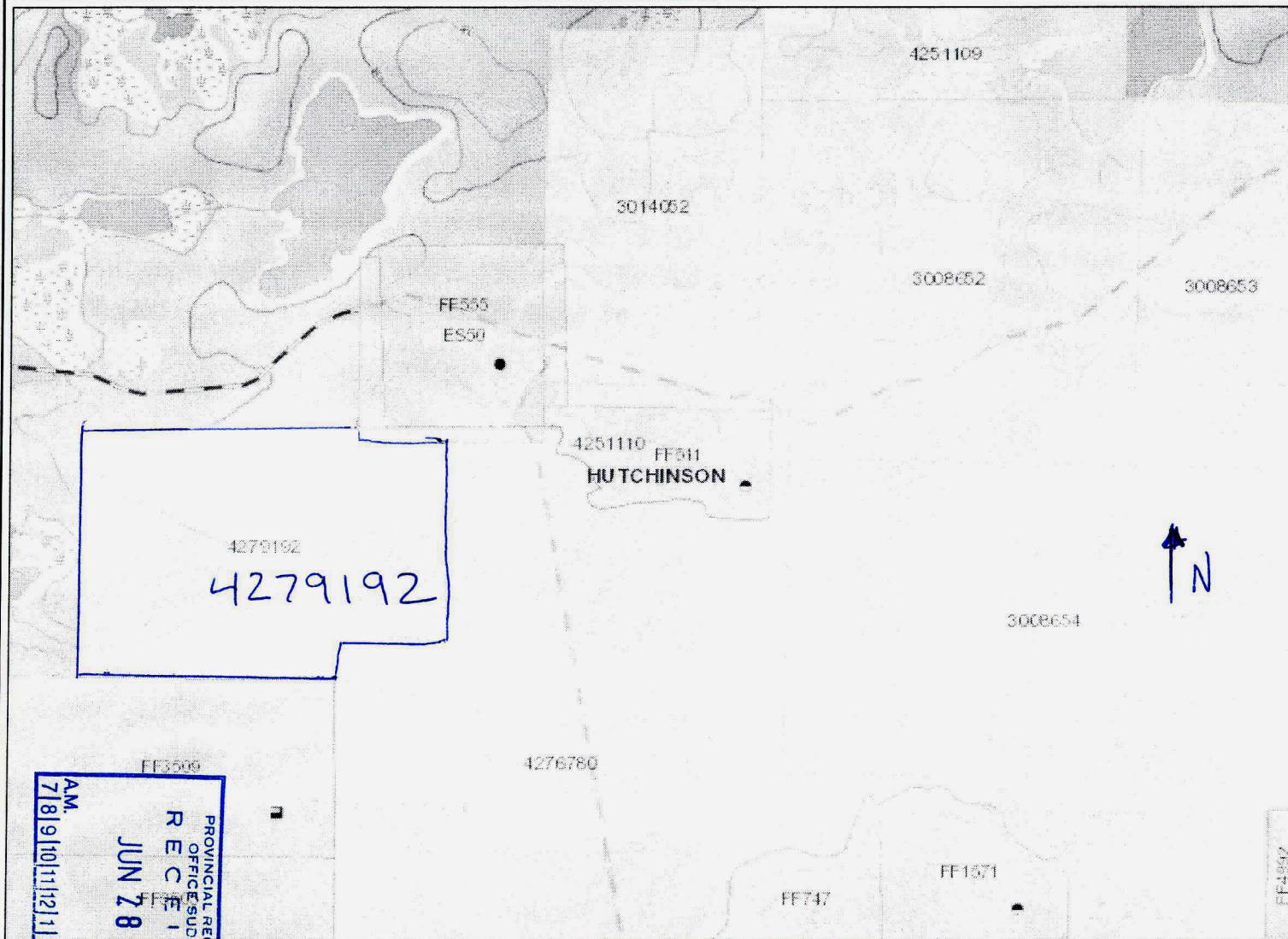

Legend

Administration Boundaries

- Mining Divisions
- Resident Geologist District
- Townships and Areas
- UTM Grid
- Geographic Lot Fabric
- Other Federal Land

Mineral Tenure Grid

- QMTG Tenure Grid

Alienations

- Withdrawal
- Notice

Unpatented Claim

- Active
- Reconciled
- Pending

Disposition

- Disposition

Disposition Symbols

- Camp
- Disposition: Unknown/Pending
- Freehold Patent Mining Rights Only
- Freehold Patent Surface Rights Only
- Freehold Patent Surface and Mining Rights
- Land Use Permit
- Leasehold Patent Mining Rights Only
- Leasehold Patent Surface Rights Only
- Leasehold Patent Surface and Mining Rights
- License of Occupation Mining Use Only
- License of Occupation Surface Use Only
- License of Occupation Surface and Mining Rights
- License of Occupation Uses Not Specified
- Order in Council
- Tower
- WPLA

Geology Layers

- AM'S Sites
- AM'S Features
- Drill Holes
- Mineral Occurrences

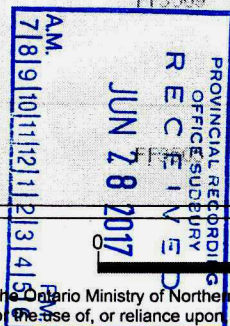

0 0.67 km

Projection: Web Mercator



The Ontario Ministry of Northern Development and Mines shall not be liable in any way for the use of, or reliance upon, this map or any information on this map. This map should not be used for: navigation, a plan of survey, routes, nor locations.

© Queen's Printer for Ontario, 2016

Imagery Copyright Notices: Ontario Ministry of Natural Resources and Forestry; NASA Landsat Program; First Base Solutions Inc.; Aéro-Photo (1961) Inc.; DigitalGlobe Inc.; U.S. Geological Survey.

© Copyright for Ontario Parcel data is held by Queen's Printer for Ontario and its licensors and may not be reproduced without permission.

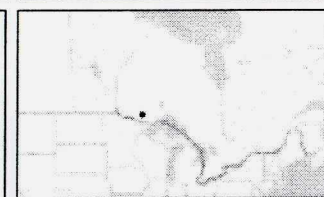

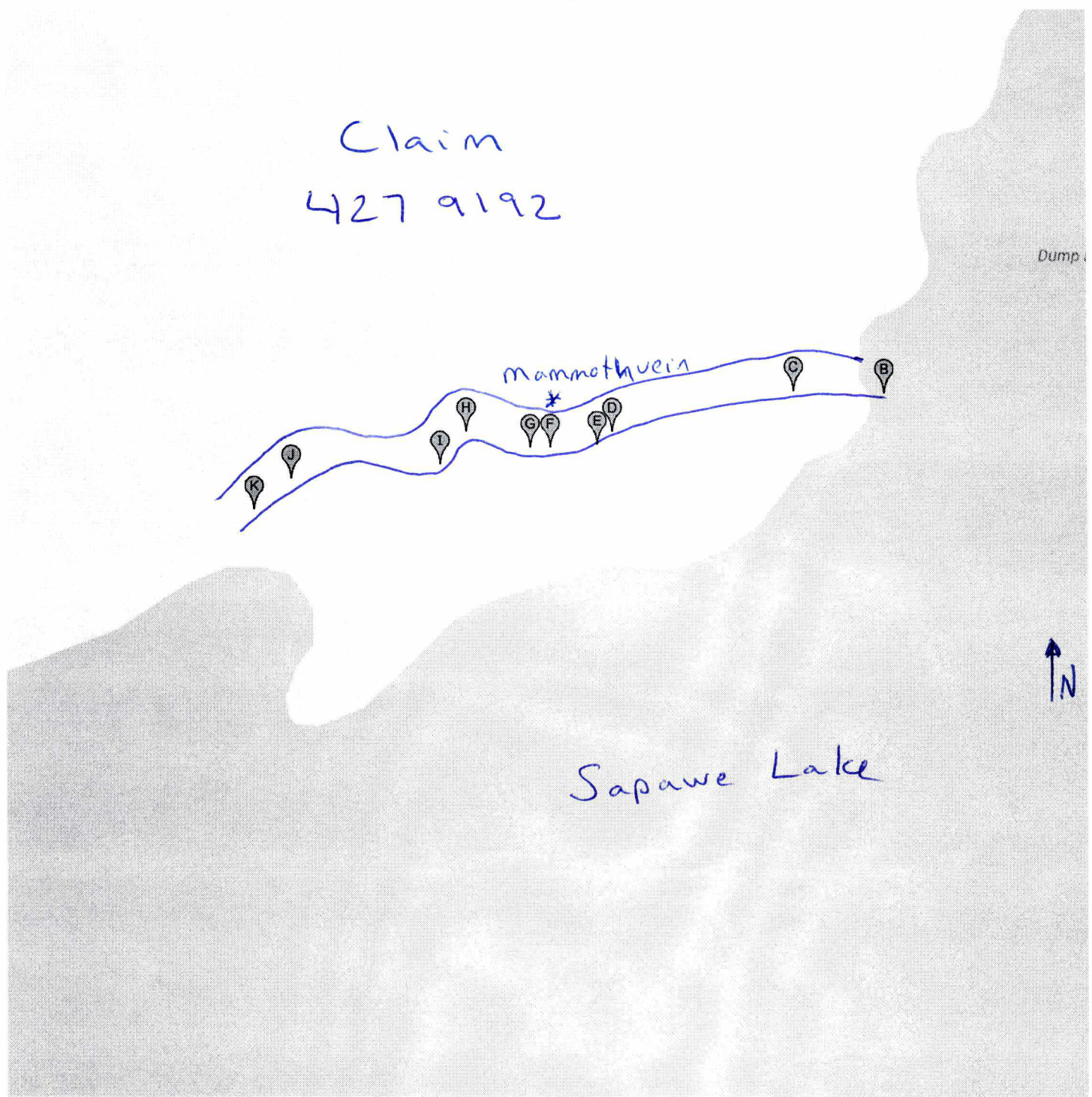

📍 gps locations

= shear structure (mammoth vein)

📍 K = UTM 15U 621124 5404139

📍 B = UTM 15U 621616 5404242

PROVINCIAL RECORDING OFFICE SUDBURY													
RECEIVED													
JUN 28 2017													
<div style="display: flex; justify-content: space-between;"> A.M. P.M. </div> <div style="display: flex; justify-content: space-between;"> 789101112123456 </div>													