

We are committed to providing [accessible customer service](#).  
If you need accessible formats or communications supports, please [contact us](#).

Nous tenons à améliorer [l'accessibilité des services à la clientèle](#).  
Si vous avez besoin de formats accessibles ou d'aide à la communication, veuillez [nous contacter](#).

2-57402

**Sturgeon Supreme Gold Property  
Mapping and Prospecting Report  
Patricia Mining Division, Beckington Lake Area**



Submitted By:  
David R Healey  
December 2016

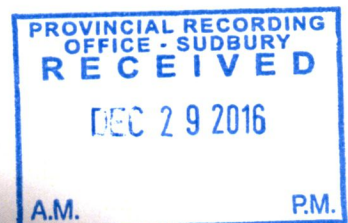

## Table Of Contents

Property Location Map	Fig-1
Summary, Access & Ownership	Page-1
Observations & Conclusions	
Sturgeon Supreme Claim Location	Fig-2
Observations & Conclusions	Page-2
Daily Log	Page-3,4
Rock Sample Descriptions	Page-5
Personnel	Page-6
Appendix Assay Certificates	
Map Mapping & Prospecting	Back Pocket





Figure 1: Location Map.

Gold Star Project  
Sturgeon Supreme Claims



# Sturgeon Supreme Gold Property

## Summary

Last summer 4 days (20,21,22,23 June 2016) were spent mapping and prospecting on claims 4276427 & 4249672 by David R Healey with the majority of the work on the Thomas Lake claim (4276427). The focus of the program was to find similar veining and Fe-Carb alteration to the Triplex Gold showing and stripping on the east shore of Thomas Lake, the program was successful in finding a Fe-Carb zone with quartz veining at the south end of Thomas Lake trending north into the lake itself opening up a new target area. Four sample were taken from the zone which did not return any gold but the presence of Fe-Carb and quartz veining provide an excellent target in Thomas Lake. Observations from previous work and workers was that Fe-Carb alteration seems to play an important role in gold mineralization in the area.

## Access & Ownership

The Sturgeon Supreme Gold Property consists of four claims 4249672, 4276539, 4276540 & 4276427 totalling 36 units (Fig-2). The property is 100% owned and in the name of David R Healey. The property is located 230 kilometers northwest of the city of Thunder Bay (Fig-1) Ontario and near the village of Savant Lake (Fig-2), good access is provided by a series of well maintained logging roads.

## Observations & Conclusions

This mapping and prospecting program concentrated on the area around Thomas Lake with the main gold showing for the area the Triplex Vein also known as the Thomas Lake prospect. The most recent work on the prospect was by Paragon Minerals which sampled coarse visible gold from a 2 metre wide composite quartz vein zone located at a mafic-felsic contact. The vein, exposed in a historic trench assayed between 0.14 g/t gold and 62.80 g/t gold (1.83 oz/t) Trenching by Paragon in October 2010 (1 trench) uncovered four composite quartz, Fe-Carb and sulphide vein zones that measure between 0.3 to 3.0 metres in width. The vein zones are hosted by strongly sheared quartz porphyry rocks measuring up to 15 metres in width and marked by significant sericite, chlorite and Fe-Carb alteration. The vein zone remains open along strike. A total of 114 channel samples were collected by Paragon from the trench with significant assay of 15.4 g/t gold over 0.5 meters. No drilling has been reported in this area.

This years (2016) program indentified a new Fe-Carb zone with quartz veining at the SE corner of Thomas Lake where shearing and folding can be observed at the lakeshore as the zone goes into the Lake in a northerly direction. Though the 4 samples taken did not run gold, this area was not as intensely sheared as the Triplex and lacked sulphides, but with that being said a gold bearing zone could be developed in this structure underneath the lake, similar to the Triplex vein. Prospecting to the south of the Fe-Carb zone, the area opens up into a spruce bog with no outcrop, also the felsic rocks on the east side of the bog start to show a moderate to strong north-south foliation possibly indicating a nearby structure.



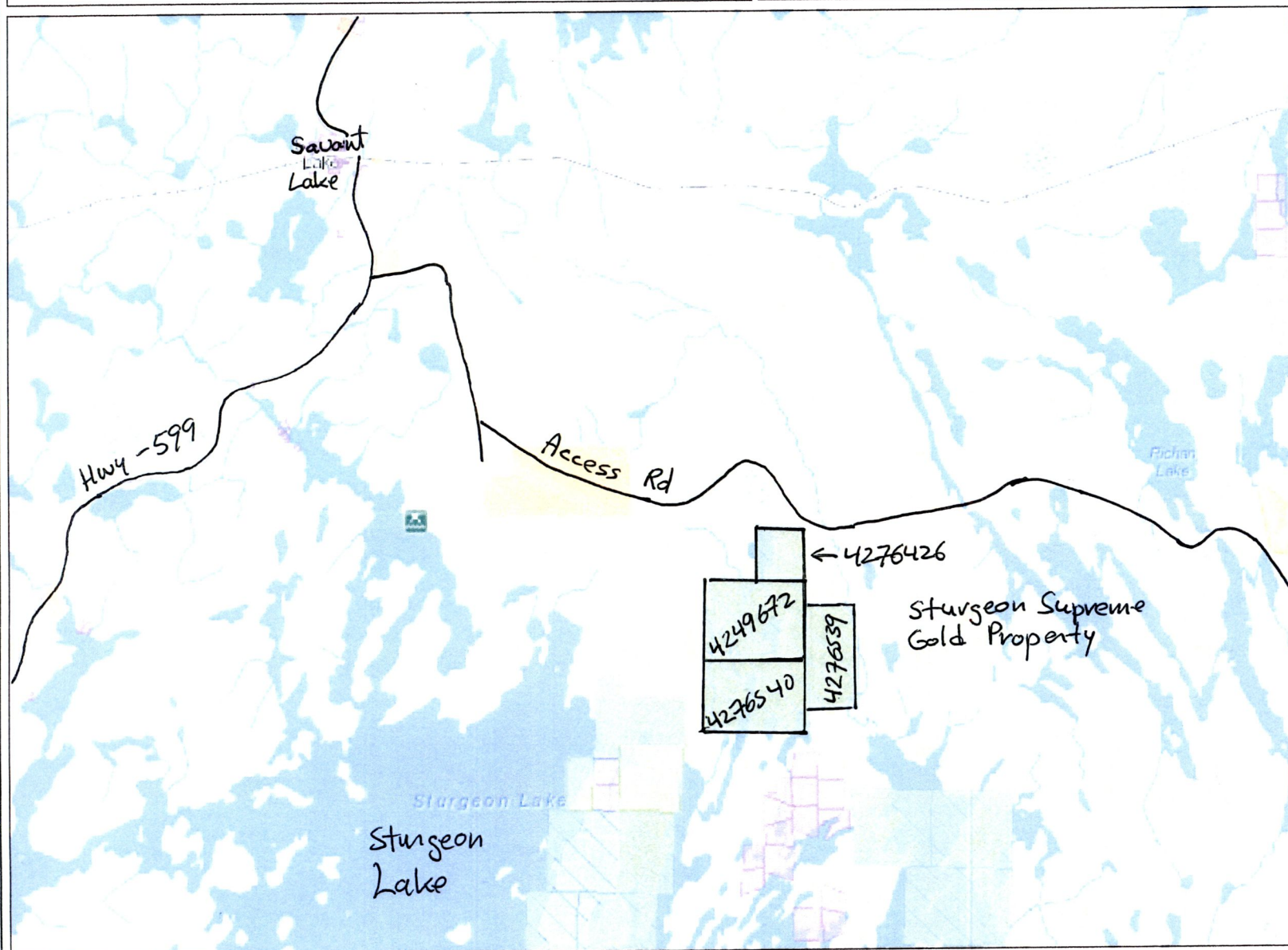

### Legend

#### Administration Boundaries

- Mining Divisions
- Resident Geologist District
- Townships and Areas
- UTM Grid
- Geographic Lot Fabric
- Other Federal Land

#### Mineral Tenure Grid

- DMTG Tenure Grid

#### Allotments

- Withdrawal
- Notice

#### Unpatented Claim

- Active
- Reconciled
- Pending

#### Disposition

- Disposition

#### Disposition Symbols

- Camp
- Disposition Unknown/Pending
- Freehold Patent Mining Rights Only
- Freehold Patent Surface Rights Only
- Freehold Patent Surface and Mining Rights
- Land Use Permit
- Leasehold Patent Mining Rights Only
- Leasehold Patent Surface Rights Only
- Leasehold Patent Surface and Mining Rights
- License of Occupation Mining Use Only
- License of Occupation Surface Use Only
- License of Occupation Surface and Mining Rights
- License of Occupation Uses Not Specified
- Order in Council
- Tower
- WFLA

#### Geology Layers

- AMIS Sites
- AMIS Features
- DRIH Holes
- Mineral Occurrences

FIG-2

0 4.7 km

Projection: Web Mercator



The Ontario Ministry of Northern Development and Mines shall not be liable in any way for the use of, or reliance upon, this map or any information on this map. This map should not be used for: navigation, a plan of survey, routes, nor locations.

© Queen's Printer for Ontario, 2016

Imagery Copyright Notices: Ontario Ministry of Natural Resources and Forestry; NASA Landsat Program; First Base Solutions Inc.; Aéro-Photo (1961) Inc.; DigitalGlobe Inc.; U.S. Geological Survey.

© Copyright for Ontario Parcel data is held by Queen's Printer for Ontario and its licensors and may not be reproduced without permission.





Enter map title

Notes:  
Enter map notes

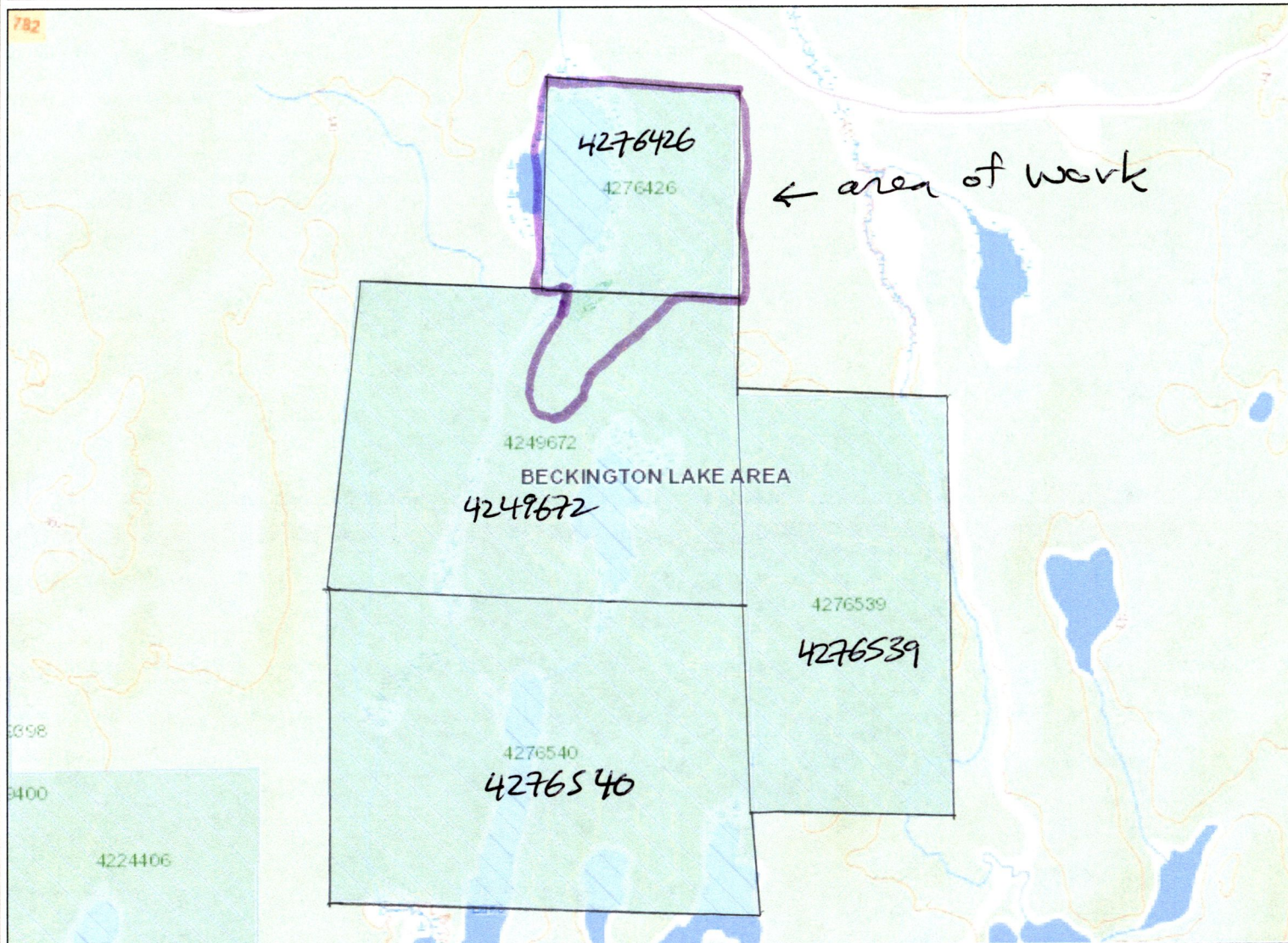

### Legend

#### Administration Boundaries

- Mining Divisions
- Resident Geological District
- Townships and Areas
- UTM Grid
- Geographic Lot Fabric
- Other Federal Land

#### Mineral Tenure Grid

- DMTG Tenure Grid

#### Alienations

- Withdrawal

- Notice

#### Unpatented Claim

- Active

- Reconciled

- Pending

#### Disposition

- Disposition

#### Disposition Symbols

- Came
- Disposition Unknown/Pending
- Freehold Patent Mining Rights Only
- Freehold Patent Surface Rights Only
- Freehold Patent Surface and Mining Rights
- Land Use Permit
- Leasehold Patent Mining Rights Only
- Leasehold Patent Surface Rights Only
- Leasehold Patent Surface and Mining Rights
- License of Occupation Mining Use Only
- License of Occupation Surface Use Only
- License of Occupation Surface and Mining Rights
- License of Occupation Uses Not Specified
- Order in Council
- Tower
- WFLA

#### Geology Layers

- AMIS Sites
- AMIS Features
- DRIH Holes
- Mineral Occurrences

0 1.17 km

Projection: Web Mercator



The Ontario Ministry of Northern Development and Mines shall not be liable in any way for the use of, or reliance upon, this map or any information on this map. This map should not be used for: navigation, a plan of survey, routes, nor locations.

© Queen's Printer for Ontario, 2016

Imagery Copyright Notices: Ontario Ministry of Natural Resources and Forestry; NASA Landsat Program; First Base Solutions Inc.; Aéro-Photo (1961) Inc.; DigitalGlobe Inc.; U.S. Geological Survey.

© Copyright for Ontario Parcel data is held by Queen's Printer for Ontario and its licensors and may not be reproduced without permission.

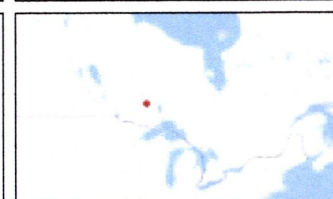

Two Fe-Carb zones outcrop on the shore of Thomas Lake, the Triplex (or Thomas Lake prospect) and the new Fe-carb zone at the SE corner of the Lake which is trending to the north into Thomas Lake. More stripping would be useful by the Triplex Vein to follow along strike and to locate possible parallel zones as well. For the Fe-Carb zone at the SE corner of the lake an IP survey over Thomas Lake itself and the Triplex Vein as well, would be a useful in finding new zones, such as sulphide mineralization which I think you need for gold as well as Fe-Carb and sericite alteration. To the south more prospecting should be done along the edges of the spruce bog such as the east side where foliation picks up from weak to strong possibly indicating a nearby structure.

Yours Respectfully

David R Healey



## Daily Log

**19 June 2016** overcast and humid

- leave Brandon Mb at 7.00 AM travel 810 kms (417 km Ontario) to Whisky Jack Lodge at the north end of Sturgeon Lake, picked up groceries in Dryden on the way
- set up tent and prepared for tomorrow, heavy rain and strong winds at night

**20 June 2016** sun and showers during day

- rained off and on all day
- mapped in trail from access road to #1 post of 4276426 and mapped and prospected from #1 post to #2 post then west along south boundry to access trail
- nothing really interesting all day, encountered felsic volcanics, intermediate volcanics, mafic volcanics and gabbro, some deformation in felsics or at contacts
- walked access trail to north and located the Triplex Vein and stripping situated on the east side of Thomas lake.
- the Main Vein on the west side of the stripping 340'/60' and the Fe-Carb Vein on the east side of the stripping 360'/45'
- note I flagged out the east boundry as there was not much flagging at all, especially in the old burn, mapping and prospecting for the day 1600 meters

**21 June 2016** sun and cloud nice day +20C

- finished off mapping and prospecting claim boundry from access trail at south boundry west to the #3 post and north along the west side of Thomas Lake to the #4 post and then east along the claim line to access trail
- rocks encountered felsic volcanics, mafic volcanics and gabbro
- took on sample (KO29052) on the west side of Thomas lake, a disjointed irregular quartz vein in a felsic tuff? Otherwise nothing interesting the rest of the day, mapped and prospected 1700 meters

**22 June 2016** sun and cloud, warm

- started mapping and prospecting at the south boundry and headed north along Thomas Creek towards Thomas Lake
- just north of the south boundry hit a Fe-Carb zone with no quartz veining but 20 meters further north hit more Fe-Carb which had quartz veining which was perpendicular to the north-south trend of the Fe-Carb zone
- took 4 samples (KO29053,54,55,56) of quartz veining

- Fe-Carb zone averaged 2-4 meters in width going into Thomas Lake with deformation and folding in the host rocks at the SE corner of the lake
- rocks to the east were gabbro to ultra-mafic looking in places
- continued north along eastern shoreline and sampled a quartz-eye felsic unit with 1-2% pyrite, sample KO28057
- continued north along shoreline to Triplex Vein stripping and out the access trail
- rocks encountered for the day quartz-eye felsic unit, mafic volcanics and gabbro

**23 June 2016** sunny warm 25C

- warm and humid in the bush
- mapped and prospected south of claim 4276426 onto claim 4249672 looking for the continuation of the Fe-Carb zone found yesterday, no luck finding the zone the area opened up into a spruce bog with no outcrop
- to the east minor to moderate shearing was found but no alteration or quartz veining
- encountered the quartz eye felsic unit again which was showing a strong north-south foliation, other rocks encountered for the day were mafic volcanics and gabbro, no rock samples were taken
- at the end of the day walked down to the north end of Mine Lake and looked at the Fe-Carb zone which seems very similar to the Fe-Carb zones on the east side of Thomas Lake, also foliation becomes stronger as you head south

**24 June 2016** nice day

- packed up the campsite and paid Lodge owners and headed back to Brandon MB
- 823 km trip (420 km Ontario)



**Sturgeon Supreme Gold Property Thomas Lake Claim**

Sample#	Easting	Northing	Sulphide	% Quartz	Other	Sample Description	Au PPB
KO29052	670163	5561966	0%	99%		disjointed quartz vein, W side of lake, felsic tuff?	<5
KO29053	670394	5561481	0%	70%		Fe-Carb zone 3-5cm disjointed quartz veins, SE corner Thomas Lake	<5
KO29054	670392	5561491	0%	60%		Fe-Carb zone 2-3cm glassy white quartz veins, SE corner Thomas Lake	<5
KO29055	670392	5561492	tr py	80%	tr aspy?	Fe-Carb zone with quartz fracture fill, SE corner of Thomas Lake	<5
KO29056	670392.5	5561493	0%	70%		Fe-Carb zone, chips off 3 white quartz veins, SE corner of Thomas Lake	<5
KO29057	670540	5561734	1-2% py	0%	tr po	quartz eye felsic unit with diss py, po, silicified, east side Thomas Lake	<5

## Personnel

**David R Healey    Prospector**

Ministry of  
Northern Development  
and Mines

Ministère du  
Développement du Nord  
et des Mines

L.C. A49300

C.N.A. 143039

DAVID R. HEALEY





## **Appendix**

### **Assay Certificates**



Date Submitted: 24-Aug-16  
Invoice No.: A16-08572  
Invoice Date: 25-Aug-16  
Your Reference: Thomas

David Healey  
2114 9th Street  
Brandon Manitoba R7A 7S3  
Canada

ATTN: David Healey

## CERTIFICATE OF ANALYSIS

6 Rock samples were submitted for analysis.

The following analytical package(s) were requested:

Code 1A2-Timmins Au - Fire Assay AA

REPORT      **A16-08572**

This report may be reproduced without our consent. If only selected portions of the report are reproduced, permission must be obtained. If no instructions were given at time of sample submittal regarding excess material, it will be discarded within 90 days of this report. Our liability is limited solely to the analytical cost of these analyses. Test results are representative only of material submitted for analysis.

Notes:

If value exceeds upper limit we recommend reassay by fire assay gravimetric-Code 1A3.

CERTIFIED BY:

A handwritten signature in black ink, appearing to read "Emmanuel Esemé", written over a horizontal line.

Emmanuel Esemé, Ph.D.  
Quality Control

ACTIVATION LABORATORIES LTD.  
1752 Riverside Drive, Timmins, Ontario, Canada, P4R 1N1  
TELEPHONE +705 264-0123 or +1.888.228.5227 FAX +1.905.648.9613  
E-MAIL Timmins@actlabs.com ACTLABS GROUP WEBSITE www.actlabs.com



Report Number: A16-08572	
Report Date: 25/8/2016	
Analyte Symbol	Au
Unit Symbol	ppb
Detection Limit	5
Analysis Method	FA-AA
K020952	< 5
K020953	< 5
K020954	< 5
K020955	< 5
K020956	< 5
K020957	< 5



