

We are committed to providing [accessible customer service](#).
If you need accessible formats or communications supports, please [contact us](#).

Nous tenons à améliorer [l'accessibilité des services à la clientèle](#).
Si vous avez besoin de formats accessibles ou d'aide à la communication, veuillez [nous contacter](#).

2.57391

Prospecting Report
On The
Sheppard Group Claims 4203306 and
4216910
Aylmer Township, Sudbury, Ontario
September 27, 2016

F. Delabbio, P.Eng.

TABLE OF CONTENTS

Location and Access	1
Location Map	2
Claim Map	3
Work Log (Sept. 27, 2016)	4 & 4a
Preamble	5
Work Location Map	6
Picture of Trench Work	7 (5 Pictures)
List of Workers	8

LOCATION AND ACCESS

Aylmer Township is located north of Lake Wanapitei, Sudbury Mining Division. Access to the mining claims in Aylmer Township is via Highway 545 North of Capreol and onto the Portelance Road. You travel north for 18 km after the turnoff for the Wanapitei First Nation. You then leave the Portelance Road and turn South over the bridge of the Wanapitei River onto the Poupore Road. You travel on the Poupore Road for 11 km to 13 km to access the claims in difference areas.

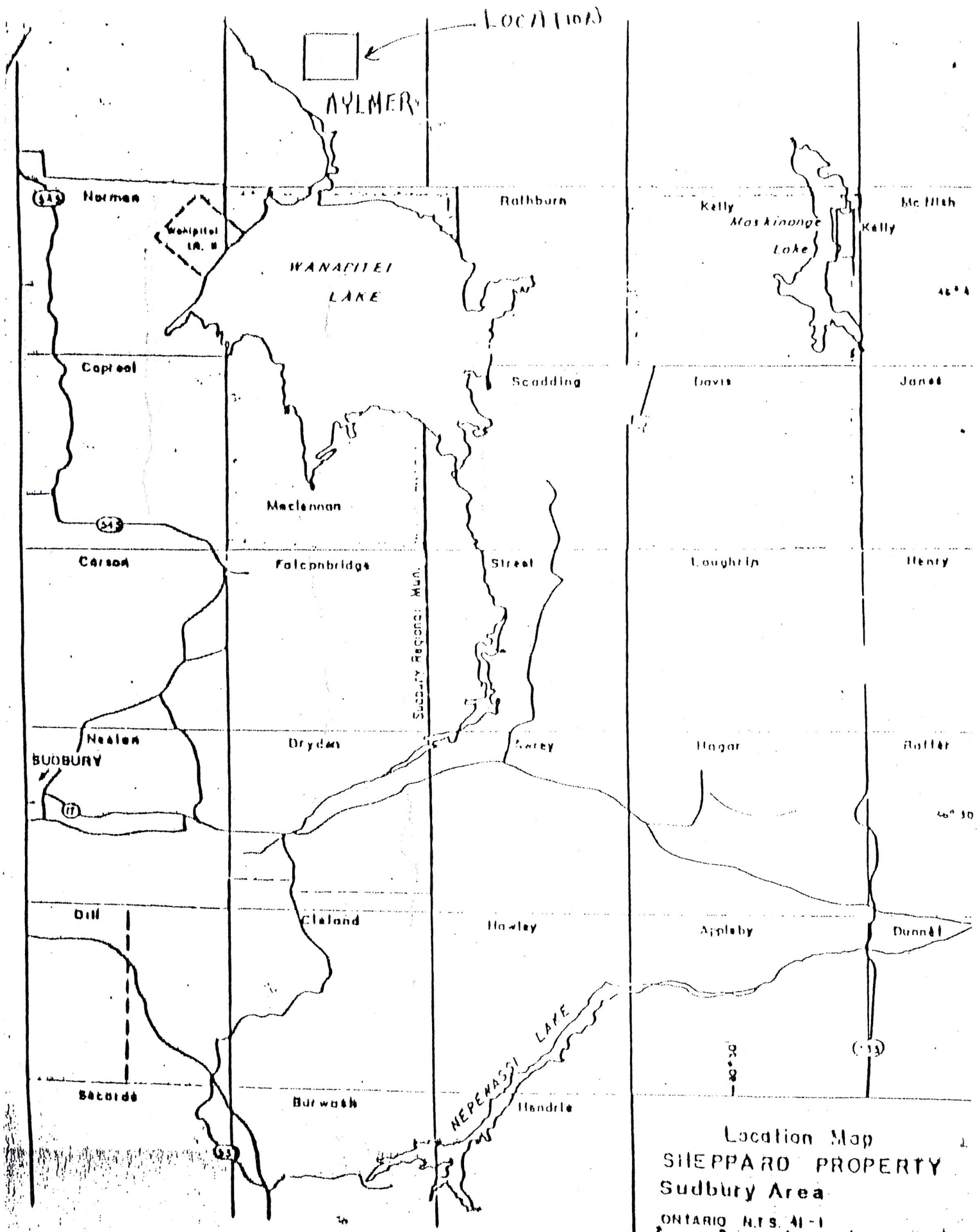

Location Map
SHEPPARD PROPERTY
Sudbury Area
ONTARIO N.T.S. 41-1

4216908
W-S-05/11

4216909

A.P. 108326
4203306

4219155

4216910

SHEPPARD CLAIMS
AYLMER
Sudbury

Job: Aylmer

Date: September 27, 2016

Picked up Tom in Capreol and we travelled up to Gervais. Gervais trucks hauling logs from northern area of claim group. After much difficulty we located the trench on claim 4203306 that I had found last week. We worked at removing debris from the trench and there is a lot of rock on top of the barrel hoops. We will need pry bars to try and get to the bottom. We took pictures. The trench is 43 north of the road and 22 ft. long. We then moved south onto 4216910 and worked at stripping the quartzite to determine if it's float or bedrock. It is bed rock and we took pictures of the stripping.

Party Chief: Fred Delabbio

Weather: 22 degrees, Sunny

JOB... MYLNER

DATE... SEPT 27/16

PAGE.....

Picked up Tom in Capreol
and we travelled up to Gervais
Gervais trucks hauling logs from
northern area of claim group.

AFTER much difficulty we located
the trench on claim 4203306
that I had found last week.

We worked at removing debris
from the trench and there is a
lot of rock on top of the barrel
hoops. We will need pry bars to
try and get to the bottom. We took
pictures. The trench is 43 NORTH OF
the road and 22 ft long.

We then moved south on to 4216910
and worked at stripping the quartzite
to determine if it float or bedrock.
It is bed rock and we took
pictures of the stripping.

PARTY CHIEF.....

F. DeLabbio

WEATHER.....

22° SUNNY

AYLMER TWP

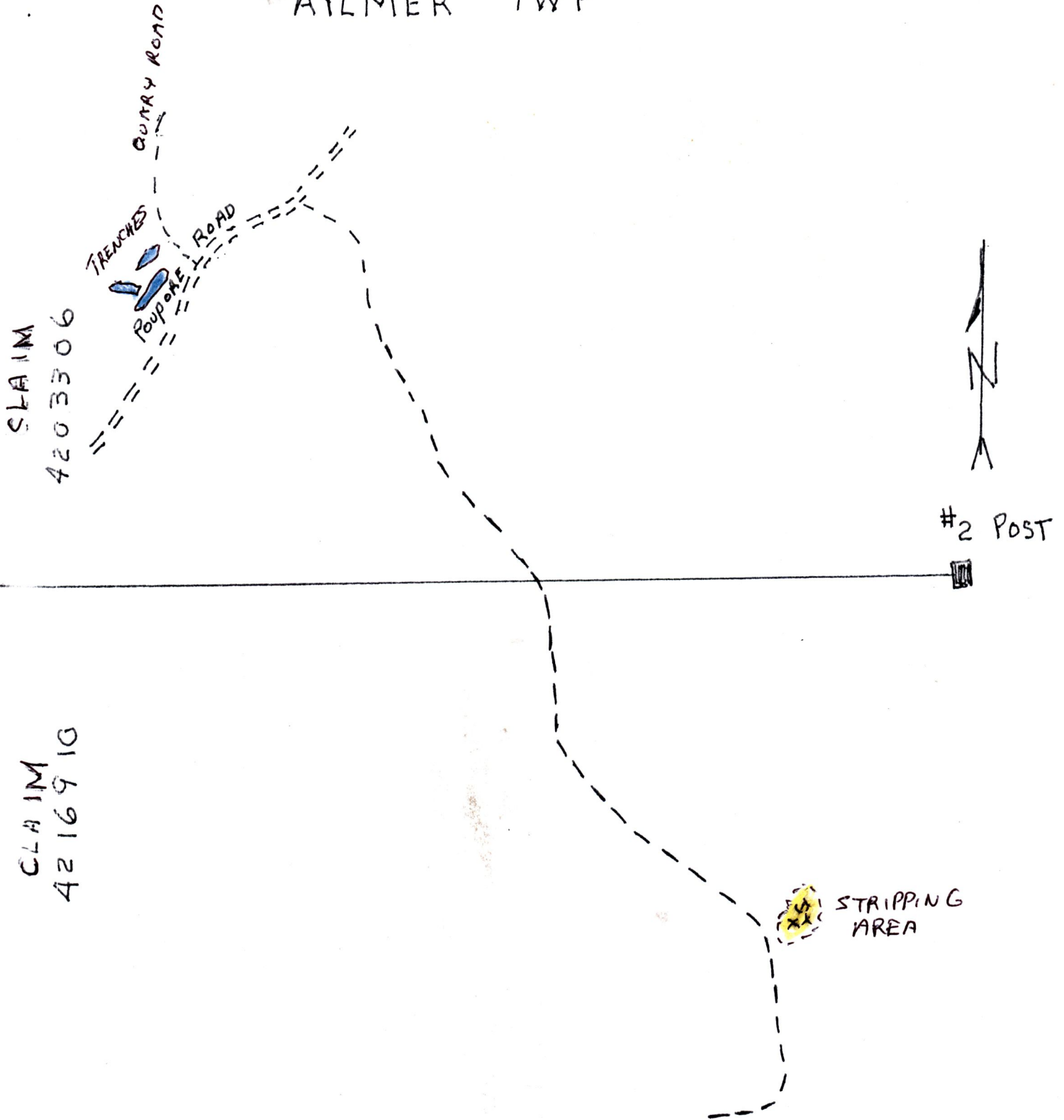

SCALE
0 200 400
1" = 200M

OCT. 20/2016

TRENCHES 



Exposed Barrel hoop in trench



Quartzite showing



Exposed barrel hoop



Partly exposed barrel hoop



Quartzite showing cleaned off

Names and Signatures of workers

Tom Sheppard

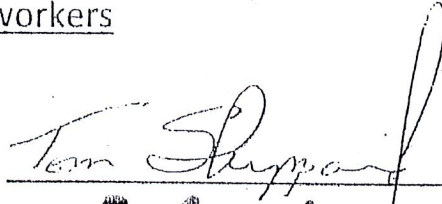

Jim Jackson



Fred Delabbio



Blaine Olivier

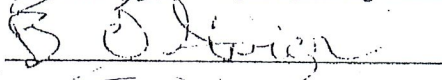

B. L. Montgomery

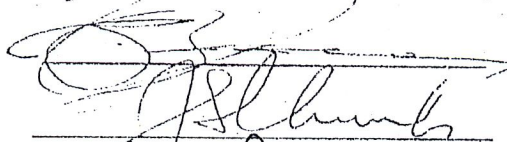

Joe Church



Nancy Delabbio

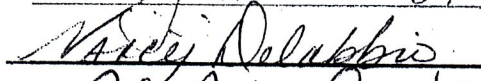

Dr. G. Courtin

