

We are committed to providing [accessible customer service](#).  
If you need accessible formats or communications supports, please [contact us](#).

Nous tenons à améliorer [l'accessibilité des services à la clientèle](#).  
Si vous avez besoin de formats accessibles ou d'aide à la communication, veuillez [nous contacter](#).

# **2016 Work Assessment Report**

**Claim L-4269515**

**Tannahill Township (G-3717)  
Larder Lake, Mining Division**

**NTS 32 D/5**

**Prepared By:**

A handwritten signature in purple ink, appearing to be 'ES' or 'Ed Shynkorenko'.

**Ed Shynkorenko  
Prospector License M-25405  
MAAP D838-4240-0A12-2023**

**January, 2017**

## **Forward:**

This report addresses the 2016 exploration activities conducted on a four unit mining claim being L-4269515, situated in Tannahill Township, Larder Lake Mining Division. The said claim is held 100% by licensed prospector Peter Hermeston. The 2016 field work focused entirely on a particular outcrop that had been found on the actual work day addressed by this report. The outcrop had been subject to a past channel cut by previous holders of the property and had not been located by the current claim holder, or the author, during previous visits.

The subject property was prospected by Ed Shynkorenko (Lic. M-25405) along with the claim holder Peter Hermeston (Lic. 1003623); both are Mining Act Awareness Program (MAAP) verified. The field work detailed in this document, being prospecting, hand sampling, and mapping, occurred on June 29<sup>th</sup>, 2016; an accumulative total of 2 mandays were expended in this effort.

The report was prepared by Ed Shynkorenko. Stations quoted in this report, and shown on the work compilation map, correspond to the assayed samples "tag number". All required illustrations and maps are contained separately within the Appendices of this document.

Expenditure rates for work, transportation, etc., were derived from industry standards.

## **Table of Contents**

Introduction/History:	Page (i)
List of Illustrations:	Page (i)
Property Description and Location:	Page (i)
Access:	Page (i)
Regional & Property Geology:	Page (ii)
Work Program:	Page (iii)
Rationale:	Page (iii)
Daily Log:	Page (iii)
Conclusions:	Page (iv)
Recommendations:	Page (iv)
Author's Qualifications:	Page (iv)
Communications (Direct/Indirect):	Page (iv)
References:	Page (iv)

## **List of Appendices**

Appendix A	"Location Map"
Appendix B	"Claim Map &, Abstract"
Appendix C	"Access Map/Key Map"
Appendix D	"Regional Geology Map"
Appendix E	"Assessment Work Performed on Mining Lands" Form
Appendix F	"Work Compilation Plan"
Appendix G	"Assay Results & Receipts"



## **Introduction/History:**

The general area of the subject property has been known to host gold since the early decades of the 20<sup>th</sup> century. The lands now contained within the boundaries of the subject property had been staked and worked off and on, over the decades. It is known that in 1931 V. Jordan staked the southwestern portion of Tannahill Township and conducted surface trenching however, he did not report additional work. In 1935 J. McClosky, and Erie Canadian Mines Ltd., completed trenching and sampling in the vicinity, with selections taken from quartz veining in shear zones returning assayed gold values of up to 29 ppm.

In 1991 G. Bastarache undertook an IP survey, stripping and drilling. His singular 96 metre drill hole intersected mafic flows and feldspar porphyry dykes with minor sulfides. In 1995 two additional holes were drilled intersecting narrow silicified mineralization. In 1996 Otis J/Pacific Mariner undertook line cutting along with magnetometer and IP surveys. The company soon afterward changed their name to Abitibi Mining Corp. / Sedex Mining Corp. From the winter of 1996 to the spring of 1997 Abitibi Mining Corp. / Sedex Mining Corp. undertook considerable drilling with an accumulative total of 6171.16 metres over their "Tannahill Township Project" which included lands now contained within the subject claim. Significant intersections were encountered and two parallel gold-bearing shear zones were ascertained. The property, now being claim L-4269515, was acquired by Hermeston from the Abitibi Mining Corp. in 2014.

In previous years, several mandays of "boot and hammer" prospecting were conducted with less than desirable assayed results achieved. However, given the known high potential of the property (via past geophysics and drilling) it was felt that an additional effort should still be made to ascertain additional potential drill target locations.

## **List of Illustrations:**

All required maps and sketches referred to in this document are contained within the attached Appendices.

## **Property Description and Location:**

The property is comprised of a four unit staked mining claim being L-4269515, Tannahill Township, Larder Lake Mining Division. The claim is currently held 100% by prospector Peter Hermeston. The subject property is located approximately 60 kilometres southeast of Matheson, Ontario. (*See Appendix A "Location Map" and Appendix B "Claim Map & Abstract"*).

## **Access:**

Access is best gained by utilizing Highway 101 for 59 kilometres eastward of Matheson, Ont., then highway 672 for 15 kilometres southward from its junction with Highway 101. From this point, 9 kilometres eastward along an existing logging road provides access to the property. (*See Appendix C "Access Map/Key Map"*). Access via Highway 672 from Kirkland Lake, Ontario is also available.



### **Regional & Property Geology:**

As previously documented (Keast, 1998), the general area is “hosted in the Archean aged Blake River Group of the Abitibi sub-province. Volcanic rocks of the area are classified chemically as tholeiitic and calc-alkaline. They include a wide spectrum of rock types ranging from basalts to rhyolites”. Generally the property is “underlain by a wide sequence of calc-alkaline flows of predominantly basaltic and andesitic composition. The flows are a generally massive pillowed, or flow brecciated”.

Localized topography conditions are commonly shared amongst the outcrops. Elevations on the property range from 310 metres to 350 metres above sea level. On average, soils consist of a dark deep organic “A” horizon with coverings of clay, coarse gravel, and in some locations sand (See Appendix D “Regional Geology Map”).



*“Portion of subject outcrop with previous channel cut”*

The subject area is situated within a traditional Boreal Forest setting. Forest cover includes black spruce, alder, cedar, and tamarack in the lower, wetter areas changing to a white spruce, jack pine, balsam fir, white birch, and trembling aspen over the more elevated areas of the property. Much of the northern portion of the property is thickly regenerated with alder and young aspen effectively obscuring outcrops in some cases.

The property is partially drained by a creek system and several intermittent draws.



## **2016 Work Program:**

### *Rationale:*

The purpose of the activities reported in this document was to locate, and to examine other outcrops found on the property. However, during the traverse a previously undiscovered outcrop with a past channel cut was happened upon. As such the remainder of the day was spent analyzing and sampling this particular outcrop. Similar “boot and hammer” efforts on another nearby but non-contiguous claim held by Hermeston (L-4270331) produced a promising gold value of 2.96 g/t taken from a grab sample of the local host igneous rock type (2013). Locating additional drill target sites to further expand the known gold deposit on the property (as defined by the Abitibi Mining Corp. in the late 1990’s), remains the main objective.

### *Daily Log:*

June 29<sup>th</sup> 2016: two man-days were spent prospecting on the property. Working as a two man team, approximately 1 kilometre was traversed. While traversing southward a basaltic outcrop of approximately 30 metres x 8 metres, striking northeast-southwest and dipping south 30 degrees west, was happened upon. The said outcrop had been subjected to a past channel cutting of about a length totaling 28 metres. What appeared to be shallow pits along the sides of this outcrop were also found. The channel cut included areas of narrow intermittent veins of quartz. Two chip samples were taken from along the walls of the channel cut, being TAN-01-16 and TAN-02-16.

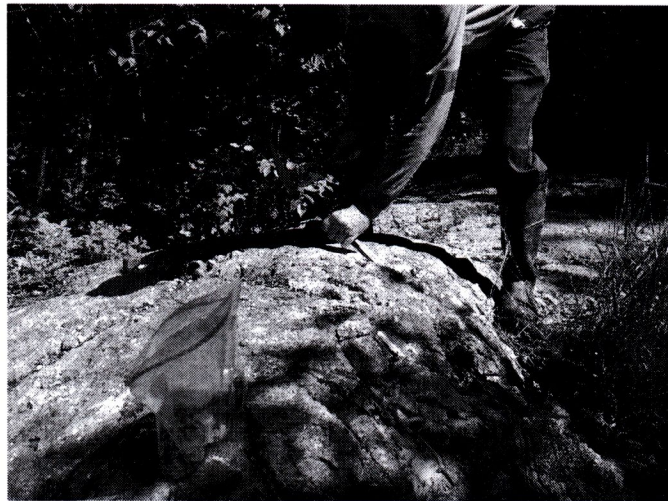

*“Sampling of channel cut wall”*

The sample locations were recorded in NAD 83 using a handheld GPS unit (Garmin Etrex 10 model). Routes traversed, and the location of the samples taken, are indicated on the enclosed work compilation plan (See Appendix E “Assessment Work Performed on Mining Lands” form, and Appendix F “Work Compilation Plan”). The assayed results of the samples taken are also provided (See Appendix G “Assay Results & Receipts”).

**Conclusions:**

The assayed samples produced non commercial results for gold with TAN-01-16 at 0.02 g/tonne, and TAN-02-16 at 0.05 g/tonne.

**Recommendations:**

It is recommended that further work in the form of additional drilling be done on the property.

**Author Qualifications:**

The author is an honour graduate of the Sault College of Applied Arts and Technology forestry program (1980, Sault Ste. Marie, Ontario), and a long time employee with the Ministry of Natural Resources. Over the past three (plus) decades he has been exposed to numerous mining projects (Hemlo, Detour Lake, and Agrium). As a private individual he has staked and transferred numerous mining claims since 1983. An avid reader of accredited material, the author is in the ongoing process of expanding his knowledge base in order to augment his prospecting efforts. Prospecting remains his life-long hobby.

**Communications (Direct & Indirect):**

Richard Hughes, Abitibi Mining Corp. Vancouver B.C.  
Mark Luchinski, Abitibi Mining Corp. Vancouver B.C.  
Peter Hermeston, claim holder & fellow prospector, North Bay, Ontario.

**References:**

OGS Report 5439 "Industrial Minerals of Northern Ontario-Supplement 2" (Vos and Smith) 1983.

"Sedex Mining Corp. / Abitibi Mining Corp. Tannahill Project Assessment Report on Diamond Drilling" (Keast 1998).

"Geological Report for Tannahill Township" (Obradovich 1989) MND&M # 2.12966

## **APPENDICES**



**Scale 1: 250,000**

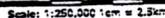

Scale: 1:250,000 1cm = 2.5km

## Lake



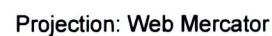
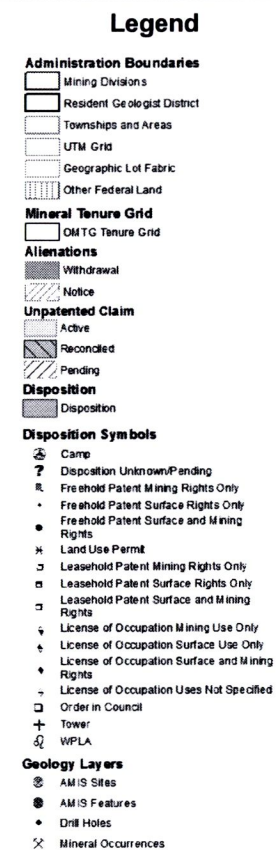

The Ontario Ministry of Northern Development and Mines shall not be liable in any way for the use of, or reliance upon, this map or any information on this map. This map should not be used for: navigation, a plan of survey, routes, nor locations.

© Queen's Printer for Ontario, 2016

**Imagery Copyright Notices:** Ontario Ministry of Natural Resources and Forestry; NASA Landsat Program; First Base Solutions Inc.; Aéro-Photo (1961) Inc.; DigitalGlobe Inc.; U.S. Geological Survey.

© Copyright for Ontario Parcel data is held by Queen's Printer for Ontario and its licensors and may not be reproduced without permission.

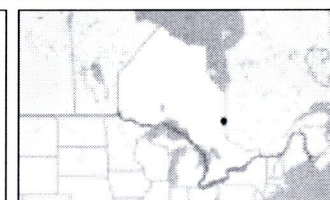





# Ministry of Northern Development and Mines

[HOME](#) [MINES AND MINERALS](#) [NORTHERN DEVELOPMENT](#) [NEWS](#) [SITE MAP](#) [CONTACT US](#)

## Mining Claim Abstract

[Main Menu](#) | [Back](#) |

LARDER LAKE - Division 80		Claim Number: L 4269515	Status: ACTIVE
<b>Due Date:</b>	2017-May-24	<b>Recorded:</b>	2013-May-24
<b>Work Required:</b>	\$1,600	<b>Staked:</b>	2013-May-23 16:30
<b>Total Work:</b>	\$3,200	<b>Township/Area:</b>	TANNAHILL (G-3717)
<b>Total Reserve:</b>	\$1,063	<b>Lot Description:</b>	
<b>Present Work Assignment:</b>	\$2,000	<b>Claim Units:</b>	4
<b>Claim Bank:</b>	\$0		

## Claim Holders

**Recorded Holder(s) Percentage**  
HERMESTON, PETER M ( 100.00 %)

**Client Number**  
403428

## Transaction Listing

Type	Date	Applied	Description	Performed	Number
OTHER	2013-Aug-14		WORK PERFORMEDPROSP APPROVED: 2013-OCT-18	\$2,227	Q1380.02113
STAKER	2013-May-24		RECORDED BY SHYNKORENKO, EDWARD (M25405)		R1380.00842
STAKER	2013-May-24		SHYNKORENKO, EDWARD (194158) RECORDS 100.0 % IN THE NAME OF ABITIBI MINING CORP. (403752)		R1380.00843
TRAN	2014-Jun-02		ABITIBI MINING CORP. (403752) TRANSFERS 100.0 % TO HERMESTON, PETER M (403428)		T1480.00118
OTHER	2015-Jan-13		WORK PERFORMEDASSAY, PROSP APPROVED: 2015- JAN-16	\$2,058	Q1580.00119
WORK	2015-Jan-13	\$1,600	WORK APPLIEDASSAY, PROSP APPROVED: 2015-JAN-16		W1580.00119
OTHER	2015-Nov-03		WORK PERFORMEDASSAY, PROSP APPROVED: 2015- NOV-09	\$1,978	Q1580.02162
WORK	2015-Nov-03	\$1,600	WORK APPLIEDASSAY, PROSP APPROVED: 2015-NOV-09		W1580.02162

## Claim Reservations

- 01 400' surface rights reservation around all lakes and rivers
- 02 Sand and gravel reserved
- 03 Peat reserved
- 04 Other reservations under the Mining Act may apply
- 05 Including land under water

[Home](#) | [Mines and Minerals](#) | [Northern Development](#) | [Ring of Fire Secretariat](#)  
| [News](#) | [Site Map](#) | [Contact Us](#)



This site is maintained by the Government of Ontario, Canada.

[Accessibility](#) | [Privacy](#) | [Term of use](#)

Copyright Information: © Queen's Printer for Ontario, 2015



# Access/Key Map

Scale 1:250000

APPENDIX C

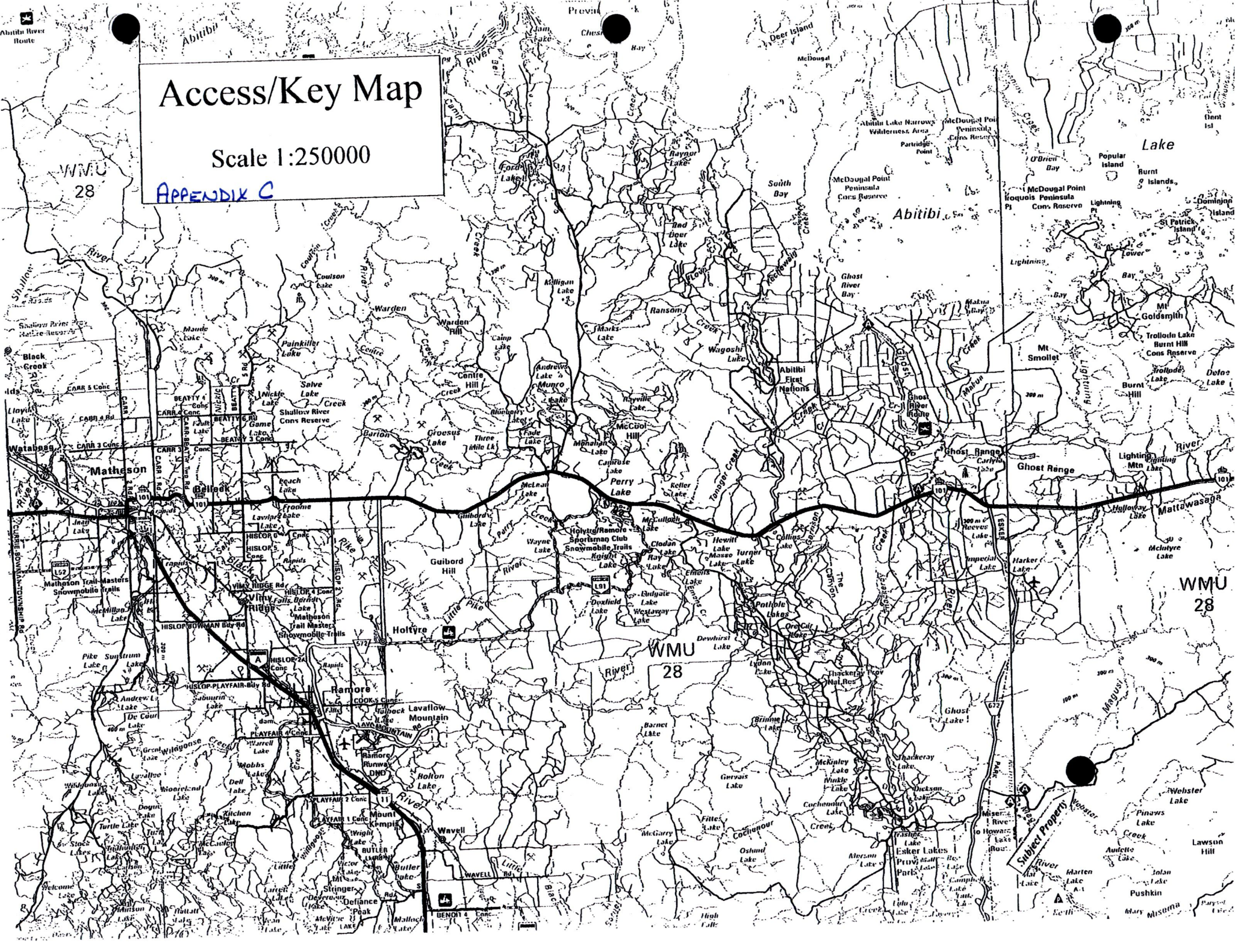







“APPENDIX F”

“Work Compilation Plan”

Claim L-4269515

Tannahill Township  
Larder Lake Mining Division

Scale 1: 4000

NAD 83

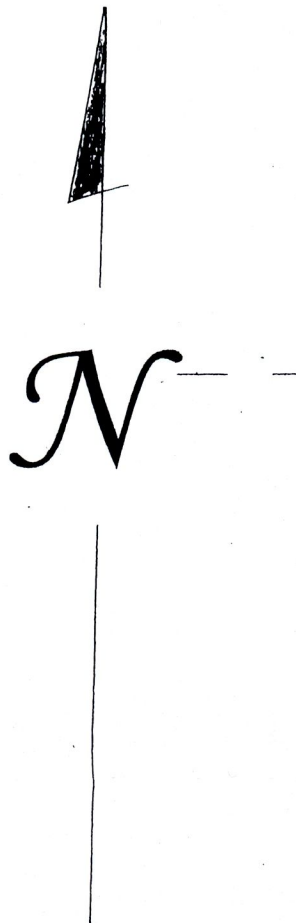
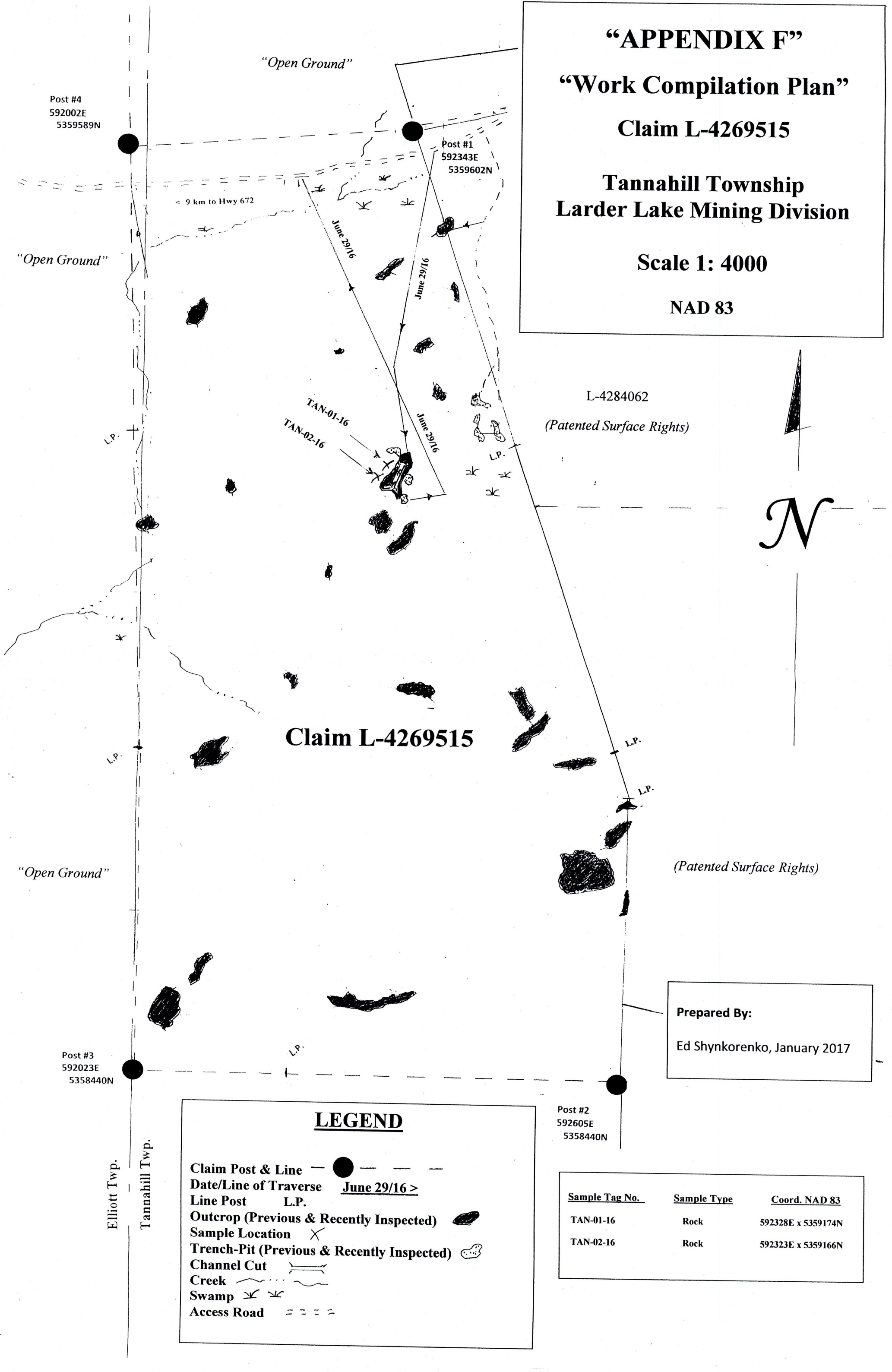

Claim L-4269515

Prepared By:

Ed Shynkorenko, January 2017

**LEGEND**

- Claim Post & Line — ● — — — —
- Date/Line of Traverse June 29/16 >
- Line Post L.P.
- Outcrop (Previous & Recently Inspected)
- Sample Location X
- Trench-Pit (Previous & Recently Inspected)
- Channel Cut
- Creek
- Swamp
- Access Road

Sample Tag No.	Sample Type	Coord. NAD 83
TAN-01-16	Rock	592328E x 5359174N
TAN-02-16	Rock	592323E x 5359166N



Established 1928

APPENDIX G

# Swastika Laboratories Ltd

Assaying - Consulting - Representation

Page 1 of 1

## Assay Certificate

**Certificate Number: 16-1537**

Company: **Ed Shynkorenko**

Project:

Report Date: 08-Nov-16

Attn: **Ed Shynkorenko**

*We hereby certify* the following Assay of 2 rock/grab samples  
submitted 03-Nov-16 by Ed Shynkorenko

Sample Number	Au FA-MP g/Mt
TA 01 16	0.02
TA 02 16	0.05

Certified by

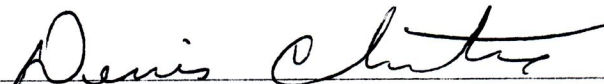
  
Denis Chartre