

We are committed to providing [accessible customer service](#).  
If you need accessible formats or communications supports, please [contact us](#).

Nous tenons à améliorer [l'accessibilité des services à la clientèle](#).  
Si vous avez besoin de formats accessibles ou d'aide à la communication, veuillez [nous contacter](#).

2-56883

**Prospecting  
On The  
Delabbio Claim 4219156  
Aylmer Township, Sudbury, Ontario  
October 3<sup>rd</sup> & 4<sup>th</sup>, 2015**

**F. Delabbio, P.Eng.**

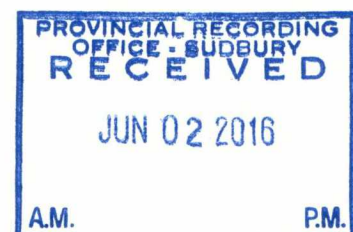

## **TABLE OF CONTENTS**

Location and Access	1
Location Map	2
Claim Map & Work Area	3
Work Log (03/10/2015-Typed)	4
Work Log (04/10/2015-Typed)	5
Preamble	6
Prospecting Map	7
List of Workers	8

## **LOCATION AND ACCESS**

Aylmer Township is located north of Lake Wanapitei, Sudbury Mining Division. Access to the mining claims in Aylmer Township is via Highway 545 North of Capreol and onto the Portelance Road. You travel north for 18 km after the turnoff for the Wanapitei First Nation. You then leave the Portelance Road and turn south over the bridge of the Wanapitei River onto the Poupore Road. You travel south on the Poupore Road for 11 km to 13 km to the gravel pit on the edge of the east branch of the Wanapitei River. You turn south towards lake Wanapitei on the North River Park Road for 2 km to the middle of the claim.

LOCATION



AYLMER

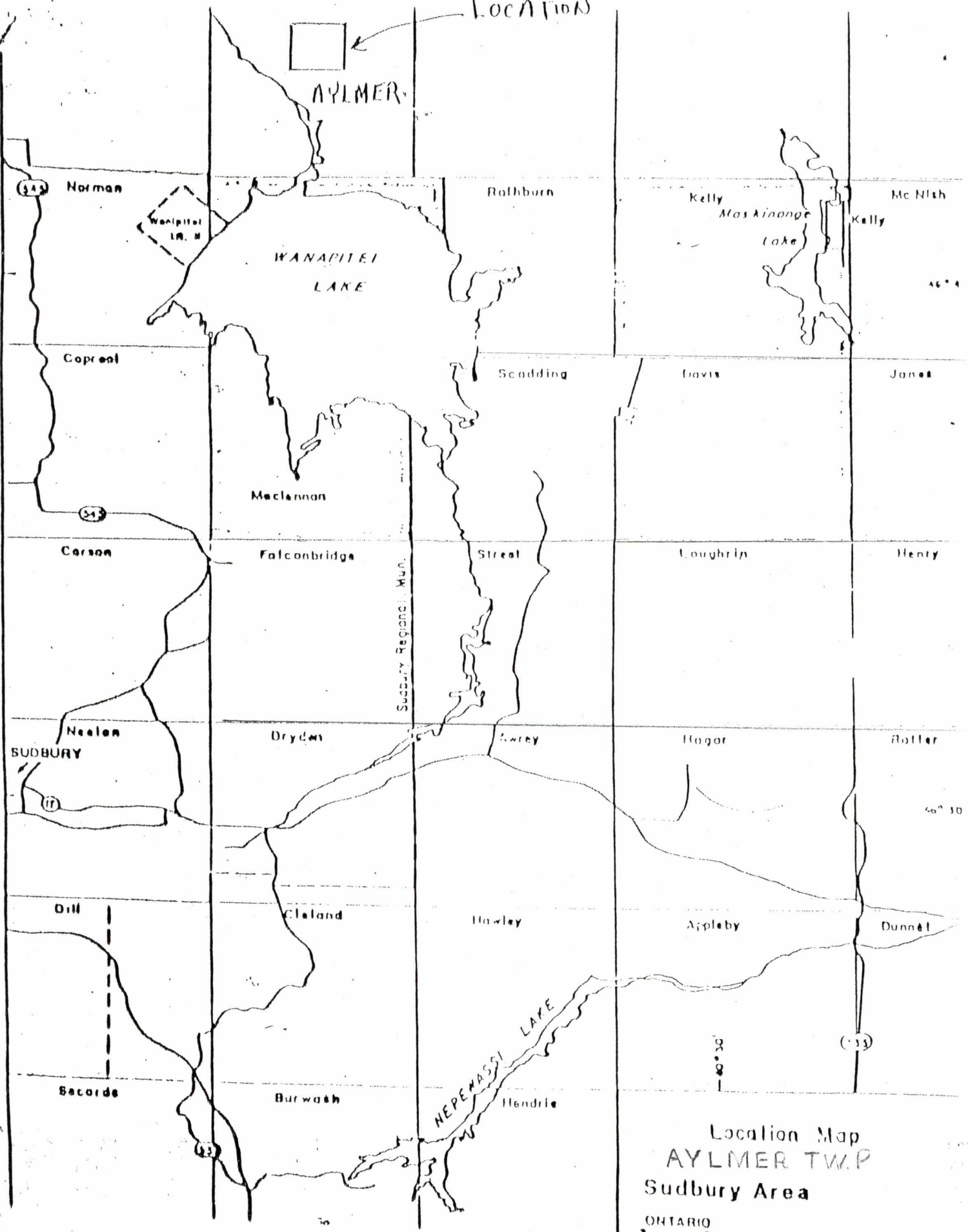

Location Map  
AYLMER TWP  
Sudbury Area

ONTARIO



4216908  
W-S-05/11

4216909

A.P. 108326  
4203306

4219155

4219156

16 UNITS

4216910

CLAIMS

AYLMER  
Sudbury

**Job:** Aylmer

**Date:** October 3, 2015

Picked up Jim and Tom in Capreol. Travelled up to map and prospect on claim 4219156 in the area of the falls on the east bench. Gervais is cutting the western side of the road north of the chutes. The bedrock in this area appears to be flat lying mudstone with the main joints close to N/S. Gervais has a backhoe digging in the gravel pit on 4216908. The bedding in the gravel is interesting so we will pan the various levels at a later date.

**Party Chief:** Fred Delabbio

**Weather:** 9 degrees Celsius, Cloudy

**Job:** Aylmer

**Date:** October 4, 2015

Picked up Jim and Tom in Capreol and travelled up to Aylmer Township to do more prospecting on claim 4219156. It is marvelous the amount of land being cleared by Gervais. The mudstone along the East branch watershed, tends to alter into grey wacke as we move to the West.

**Party Chief:** Fred Delabbio

**Weather:** 7 degrees Celsius, Partly Cloudy



## **Preamble**

We prospected the central and bottom portion of claim 4219156. Gervais is doing a lot of cutting in the area and exposing a lot of outcrop that will be mapped in the central area. The travel route of October 3<sup>rd</sup> was mainly covered by sand and gravel with some mudstone at the edge of the East branch river. We crossed the East branch at the falls and this was prospected, but it appears to be all mudstone and will be mapped separate.

Names and Signatures of workers

Tom Sheppard

Tom Sheppard

Jim Jackson

Jim Jackson

Fred Delabbio

Fred Delabbio

Blaine Olivier

Blaine Olivier

B. L. Montgomery

B. L. Montgomery

Joe Church

Joe Church

2-56883

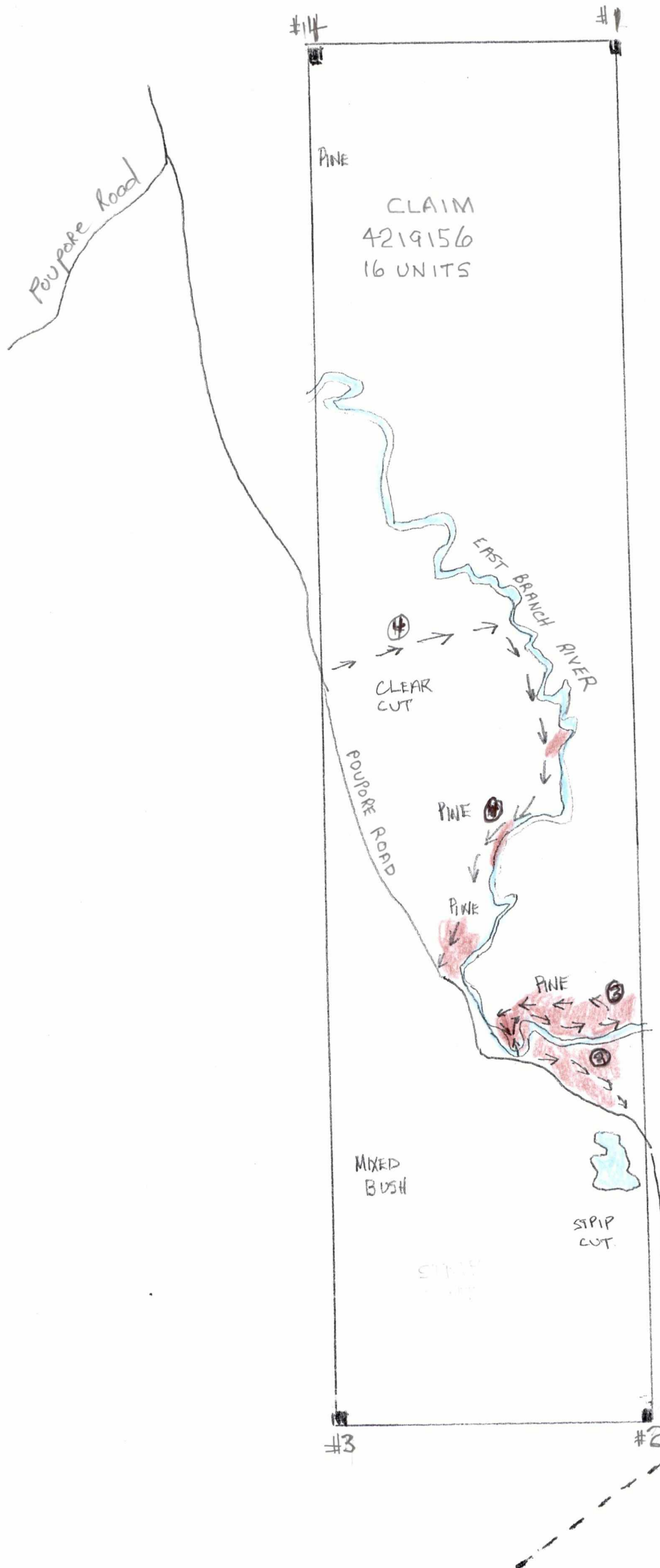

PROSPECTING  
MAP

- ③ DATE OF ROUTE
  - Route
  - CUT ROAD
  - MUDSTONE
- SCALE  
1" = 350 m.

F. Delabbio