

2.55338

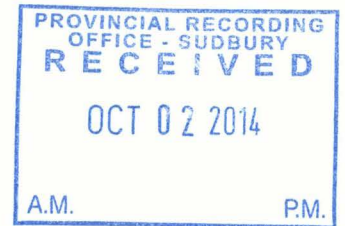

**REPORT ON 2014 EXPLORATION**

**FOR**

**GOLD CACHE INC.**

**(CLIENT #407356)**

**GOLD CACHE PROPERTY**

**DAWSON ROAD LOTS  
AND  
HORNE TOWNSHIP**

**NTS 53A/12  
UTM COORDINATES  
MAP DATUM NAD 83  
0287997E / 5384225N**

**THUNDER BAY MINING DIVISION**

**Prepared by Terry Yahn  
Sept 2014**

## INTRODUCTION

We have focused on areas within claim 1173912 (16 claim block) to explore high potential areas within our claim's boundaries. We have chosen this area as past assays have shown higher gold content and we wish to expand our sampling to test where similar assays may occur southeast of our old trenches.

Within the boundaries of this claim are Pillow Lava extrusions which extend to the southwest and our claims in that area. This entire area consists of bands of mineralization with most gold findings in the quartz veins of Mafic rock.

The Gold Cache Project contains 7 properties with 61 Claim units. It is situated 80 kms west of the city of Thunder Bay on Hwy 11/17, at Shabaqua. Highway access is available to this property. All of the work under this project was conducted on Claim #TB1173912.

## PROJECT HISTORY

This block of claims, staked starting in 1994, once contained 93 mining units in 28 contiguous mining claims straddling the Dawson Road Lots and Horne Township, with one claim in Laurie Township. One of the main features of the property is the caldera-like structure covering approximately one third of the claim block.

During the past twenty years, the Shabaqua area has become one of the most active areas for mineral exploration in Northwestern Ontario. Much of the recent staking activity radiated from this structure. The subject property (in part) triggered the regional staking frenzy in 1995. It was surrounded by quality exploration companies, three of which obtained land positions on both sides of the subject property. Over twenty-five publicly traded companies swarmed into this "emerging gold camp", which is now referred to by the industry as the "Matawin Gold Belt".

During 1996 and 1997 considerable line cutting and geophysical surveys were conducted by most of the companies in the area. In 1997 several of the companies

**conducted diamond drill programs, with at least 12 holes drilled resulting and results up to .300 oz/t. Au. Expectations for the area remain high.**

**Exploration continued in the late 90's and into 2014. Although it had slowed down somewhat from its previous pace, the work simply became more concentrated (targeted) and results continued to improve. Assays in the range of .400 oz/t to 1.400 oz/t were now being found in the key properties.**

**In 2001 thru to 2014 work performed on nearby claims continued to yield good results with additional assays in the 1.250 oz/t (56 g/t) range. There has been renewed activity during 2004/06 with additional mining companies taking over some claims and actively testing the area. Almost 90 % of the area has now been re-staked.**

## WORK PERFORMED

Starting on June 16<sup>th</sup> and throughout the summer we will be working on three Gold Cache Claims (1216710, 1173911, and 1173912) in the area. We will be concentrating on each claim on certain days. On June 17<sup>th</sup>, 18<sup>th</sup> and 20<sup>th</sup>, 2014 we worked within claim 1173912 gaining access to several new areas and then returned on Sept 10<sup>th</sup> and 12<sup>th</sup> to take samples. This report only deals with those five days. We trenched, stripped and sampled 3 sites in particular.

The backhoe, a Komat'su 22 Bus LC from Bruno's Contracting (Thunder Bay) Limited was brought in on the 16<sup>th</sup> and supervised by Bill Yahn who setting up the work schedule for each day going forward.

We were attempting to extend the gold bearing rock found on central sections of this claim (1173909). The backhoe was used to clear and access trench target areas. We used the backhoe to give us good access to the bedrock but it was a slow process. Three samples were taken altogether and most were taken by channel cuts.

The trenches were created to seek out mineralization that is similar to those in the adjoining ground. In fact, similar patterns were located. At the time of filing this report we did not yet have the assays back from processing and will forward those when recieved.

We used the backhoe to check for bedrock near the surface as we progressed. Test areas were filled back in and we moved on.

Nearby samples on an adjoining claim (1173909) brought gold assays of up to 1.200 oz/ton were found by tracking low level assays to better ground.

## DAILY LOG FOR THIS PROJECT

Target rocks – The primary rock type in this area of the claim is Mafic with fine grains like a Basalt, but moves towards a Rhyolite with courser grains in some sections. In both cases we are looking for target rock similar to other gold bearing assays where there was an abundance of quartz infused in the rock or by way of small spider veins throughout. We are looking for larger forming Pyrite cubes within those samples. In some cases larger, “smoky” quartz veins were discovered. This claim (TB1173912) contains pillow lava formations which extend from the centre of the claim and to the south and southwest.

TUESDAY, JUNE 17, 2014 – BILL YAHN AND WAYNE HUBBARD – (Two vehicle, safety vests and supplies, backhoe with operator, GPS, compass, camera, rock hammers, pen flare with bear-bangers) A bear has been seen in the area.

The plan on this first day was to head southwest off the access road at co-ordinate 0288318 E 5384725 N. We hoped to pick up another ridge and outcroppings similar to those found at the main trench road but instead found that the ground was low and lots of overburden, heading on a downslope as we progressed. This area had never been examined. We were able to continue westward until we hit swamp and then returned to the access road. There was an old Inco pit to the east off the access road. We found the small pit about 100 meters in.

Komat's backhoe – With Operator (Keith). Bill Yahn supervised and directed the backhoe operations taking GPS coordinates and record keeping.

From the access road we headed west into the bush. We walked the backhoe through the area trying to find outcrops or areas of low overburden and slowly made our way back to access road. We found no bedrock once on the trail and so at waypoint 288241 E 5384655 N we turned west as far as 287852 E 5384678 N

Wayne Hubbard and Bill Yahn (as time permitted) prospected points of interest as the backhoe move to the next targeted area.

We next headed east to the Inco pit site.

GPS readings were taken at each turn and used to guide us through the area.

The backhoe and all equipment were taken back to the access road.

**WEDNESDY, JUNE 18, 2014 – BILL YAHN – (One vehicle, safety vests and supplies, backhoe with operator, GPS, compass, camera, rock hammers, pen flare with bear-bangers)**

Our plan for this day was to move 200 meters north of the previous day's start position. We headed westward toward our next claim boundary. There were a couple targeted areas along the way that we had not visited in the past.

Komat'su backhoe – With Operator (Keith). The Backhoe was directed to our start point this morning at Bill Yahn supervised and directed the backhoe operations, taking GPS coordinates and record keeping.

We hit a swampy area. Circumvented that area to our original bearing and headed west again for a short distance. GPS readings were taken.

The backhoe and equipment were taken back to the access road.

**FRIDAY JUNE 20, 2014 – BILL YAHN – (One vehicle, safety vests and supplies, backhoe with operator, GPS, compass, camera, rock hammers, pen flare with bear-bangers)**

This third day on claim 1173912 we headed west off the access road.

We were searching for a possible trail in that area where previous claim owners had recorded a positive assay for gold.

We headed to where the ground dropped off severely to an old riverbed. The bedrock was exposed and samples would be taken later.

We returned to the access road and went further south to cut back in again to travel on smoother ground. We ended up backing up about 50 meters and heading south (parallel to access road) but ran into a ridge.

**ON SEPTEMBER 10<sup>TH</sup> AND 12<sup>TH</sup> WE SAMPLED TWO AREAS ON 1173912  
GPS CO-ORDINATES (NAD 83 DATUM USED)  
UTM ZONE 16U**

<b>SAMPLE #</b>	<b>TAG #</b>	<b>EASTING</b>	<b>NORTHING</b>
<b>01</b>	<b>447205A</b>	<b>0288420</b>	<b>5384768</b>
<b>02</b>	<b>447205B</b>	<b>0288420</b>	<b>5384768</b>
<b>03</b>	<b>447210</b>	<b>0288666</b>	<b>5384444</b>
<b>04</b>	<b>447215</b>	<b>0288021</b>	<b>5383842</b>

**Outcrop / Pit / Trench Location Map attached as Schedules**

**Pit/Trench 01/14**

Located on Claim 1173912 this area is on the east side of the north-south access road. The pit/trench was 100 meters from the road as you start your way into the brush. We dug downward and then dropped 1 meters at the end of the run. The main part of the pit is 3 wide and over 14 meters in length. The trench has quartz.

Two samples were taken.

Assay Tag 447205A      Not available at time of filing

Assay Tag 447205B      Not available at time of filing

A full ICP ASSAY REPORT was also ordered

**Pit/Trench 02/14**

Located on Claim 1173912 this area is 300 meters south and 240 meters east of Pit 01/14. The ground drops off as we reach an old riverbed. We cleared off the slope to expose the rock. The area is 8 meters in length and 4-5 meters wide in areas.

The rock contained spider veins of quartz and a small amount of pyrite. 3 inch Quartz where sample was taken

One sample was taken.

Assay Tag 447210      Not available at time of filing

A full ICP ASSAY REPORT was also ordered

**Pit/Trench 03/14**

Located on Claim 1173912 this area is 600 meters further west. We cleared an area 3 meters by 5 meters. The pit drops by over 3 meters in tiers. The sample taken contained high quartz and pyrite.

One sample was taken.

Assay Tag 447215      Not available at time of filing

A full ICP ASSAY REPORT was also ordered



**People and Days Worked**

**June – Sept 2014**

**Physical: trenching, cleaning, sampling.**

**Supervise - Backhoe operator and work performed.**

**Bill Yahn                      5    June 17, 18, 20, Sept 10, 12**

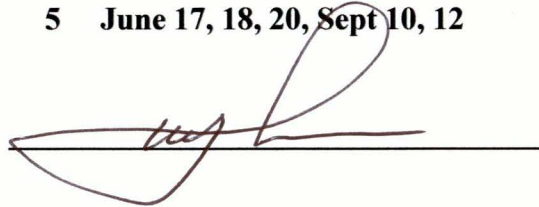
A handwritten signature in dark ink, appearing to read "Bill Yahn", is written over a horizontal line.

**Wayne Hubbard              2    June 17, Sept 10**

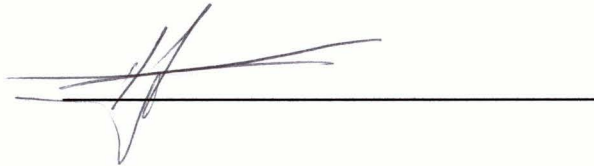
A handwritten signature in dark ink, appearing to read "Wayne Hubbard", is written over a horizontal line.

**Total                      7 days.**

## **SUMMARY AND CONCLUSIONS**

**We have already gone a long way in determining the potential for gold in the Shabaqua area. Zone formations from TB1173909 have developed a pattern which we will continue to expose and sample on all claims we hold in the area.**

**The work done in this report covers claim #TB1173912. Any reasonable assays in this area go a long way in proving the commercial value of the entire area.**

**During the summer and fall (2014) we will begin to concentrate on our claims south and southwest of this claim (TB1173912) where the pillow lava area of this claim continues.**

**There are other areas within the 61 claims that have similar mineral composition but none have yielded that high gold found in our northern claims.**

**We will continue to track and sample in this area as more and more ground is being uncovered by forestry operations within our claims. The work we completed in these two days will be followed up with additional work with a smaller backhoe and several more samples (channel cutting) will be taken after cleaning the exposed areas.**

## ATTACHMENTS

- SCHEDULE 1**      **Details of Pit/Trench locations – Google Earth (NAD 83)**
- SCHEDULE 2**      **Receipt of samples from Accurassay Lab. Dated Sept 4, 2014**
- SCHEDULE 3**      **Map of claims**
- SCHEDULE 4**      **Invoice from Bruno's Contracting (Thunder Bay) Limited  
highlighting only June 17<sup>th</sup>, 18<sup>th</sup>, and 20<sup>th</sup> for the purposes of this  
assessment report.**
- SCHEDULE 5**      **Drawing of Trench #01/14**
- SCHEDULE 6**      **Drawing of Trench #02/14**
- SCHEDULE 7**      **Drawing of Trench #03/14**

**DISC WITH PICTURES ENCLOSED**

Go

© 2014 Google  
Image © 2014 DigitalGlobe

Trench 03 Sample 447215 Claim 1173912

Trench 02 Sample 447210 Claim 1173912

Start June 20

Trench 01 Sample 205 A & B Claim 1173912

Start Tuesday June 17

Start June 18

SCHEDULE #1

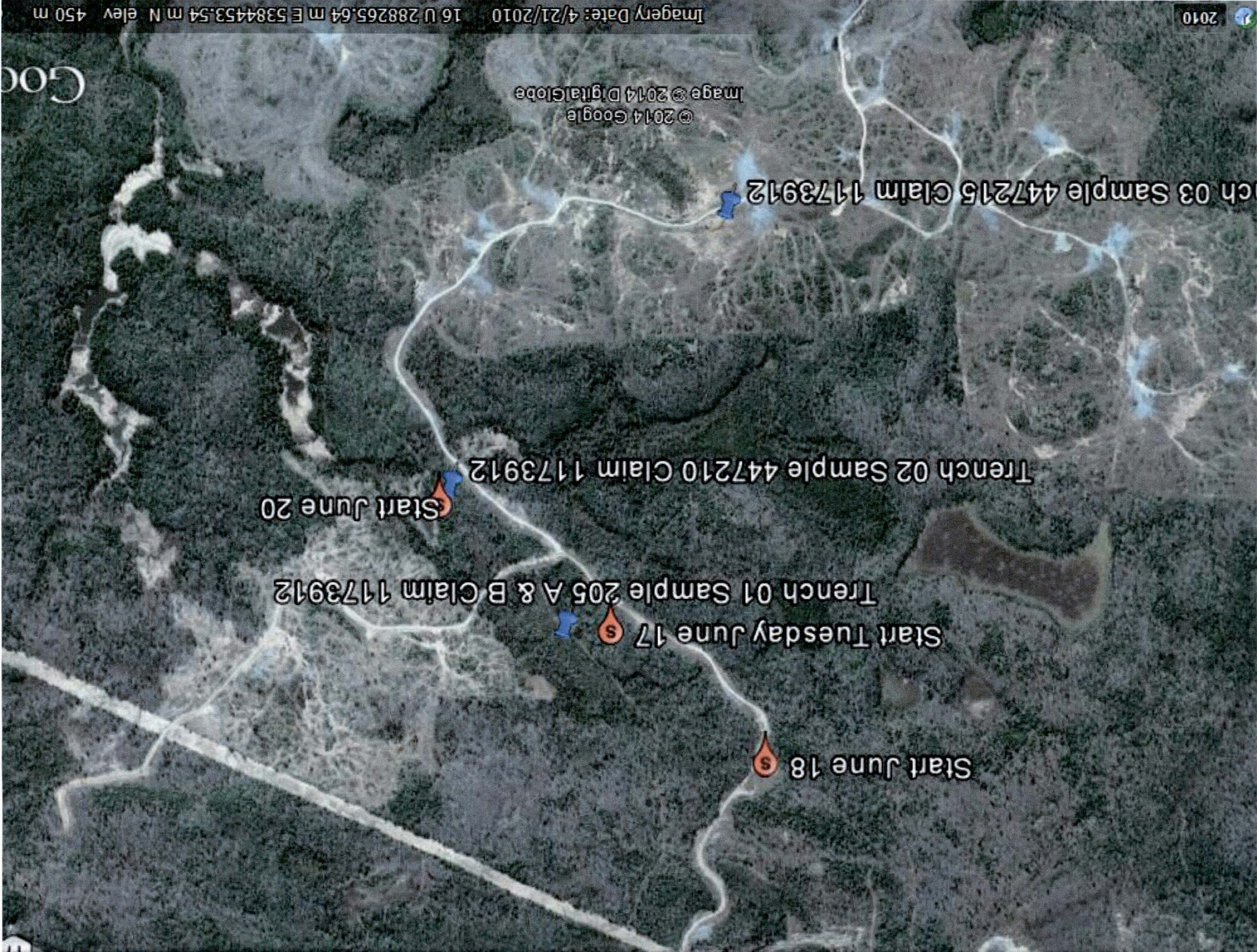

**Terry Yahn**

**From:** Lims Accurassay <receipts@accurassay.com>  
**Sent:** September-17-14 2:49 PM  
**To:** tyahn@bellaliant.net  
**Subject:** Project ID claim #1173912 --Confirmation of Sample Receipt

	
Client Project ID:	claim #1173912
Number of Samples:	4
Sample Series:	447205A 447205B 447210 447215
Analysis:	P1 FA1 AR1
Client:	Gold Cache Inc. / 251
Reception Date:	09/04/2014
Estimated Completion Date for Primary Analysis:	09/18/2014
Accurassay Job #:	201442018

4  
 JH

SCHEDULE #3

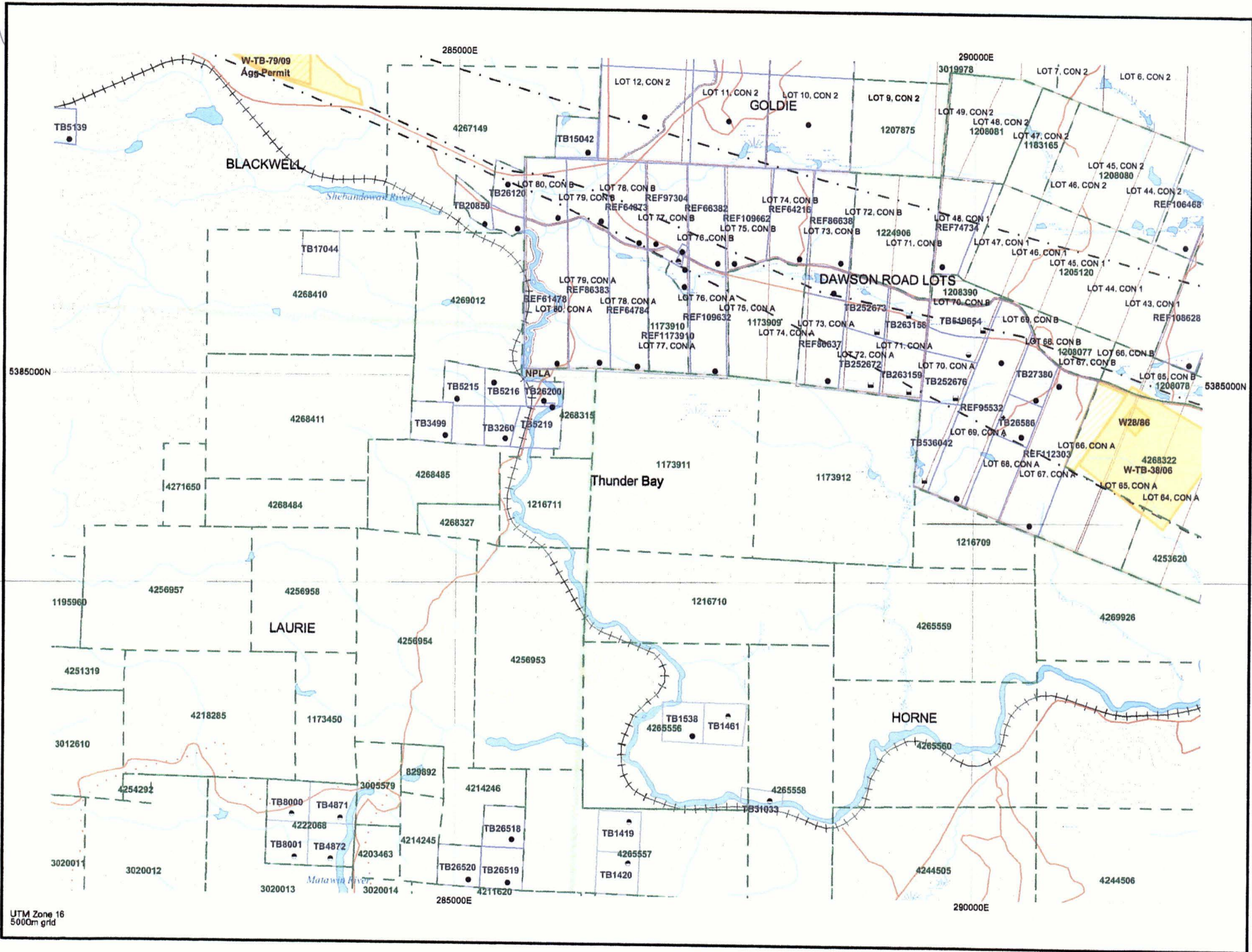

UTM Zone 16  
5000m grid



# Bruno's Contracting

General Contractors

(Thunder Bay) Limited

SCHEDULE #4

685 Hewitson Street  
Thunder Bay, ON P7B 5V5  
Phone: (807) 623-1855  
Fax: (807) 623-0360

Invoice Number : 573306  
Invoice Date : 06/20/2014  
Customer Number : GOCA01  
Job Number : A0145  
Due Date : 07/20/2014

GOLD CACHE INC.  
C/O TERRY YAHN  
225 UNIVERSITY AVE  
THUNDER BAY, ON P7C 2Z3

2014/2015 EQUIP RENTALS

Description	Qty.	UOM	Unit Price	Total
FLOAT & BACKHOE RENTAL FOR SHABAQUA				
✂ 06/16/2014	3.00	HR	138.0000	414.00
✂ 06/16/2014	6.00	HR	145.0000	870.00
✓ 06/17/2014	9.50	HR	145.0000	1,377.50
✓ 06/18/2014	10.00	HR	145.0000	1,450.00
✂ 06/19/2014	9.50	HR	145.0000	1,377.50
✓ 06/20/2014	7.50	HR	145.0000	1,087.50
✓ 06/20/2014	3.50	HR	138.0000	483.00
SUBTOTAL:				7,059.50
H.S.T.:				917.74
NET INVOICE:				7,977.24

414.00  
870.00  
1377.50  

---

2661.50  
TAX 346.00  

---

\* # 3007.50 CLAIM TB 1173909 ONLY  

---

✓ 4969.74 CLAIM TB 1173912 ONLY

118443

INVOICE

INTEREST CHARGED AT 2% PER MONTH ON OVERDUE ACCOUNTS

G.S.T. NO: R100674498



CLAIM # TB 1173912  
VTM LOCATION 164 0288420 E 5384768 NAD83

SCHEDULE 5

TRENCH/PIT 0114

TO POST #4  
METERS  
BEARING

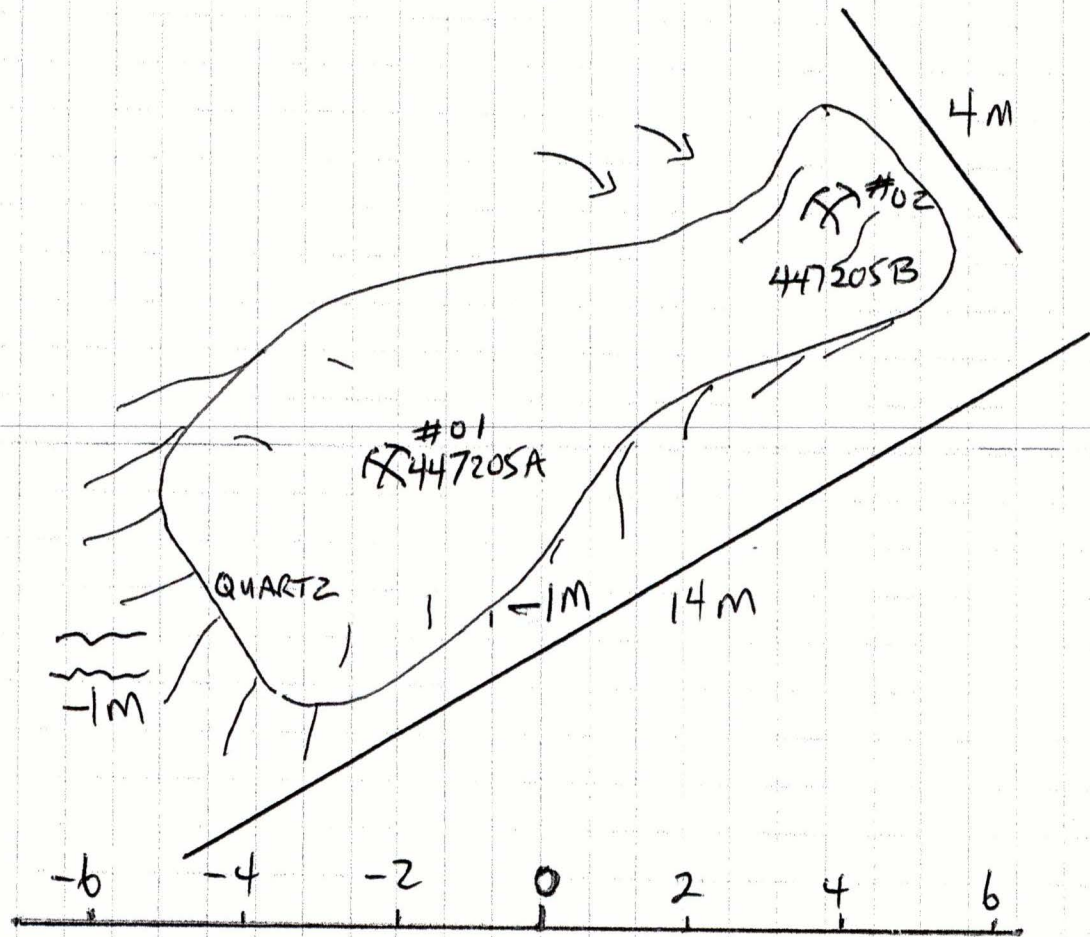

SYMBOLS	
SAMPLE	X
SLOPE	↗
RIDGE	
WATER	~ ~ ~
OUTCROP	⊙
ELEVATION	±m

SCALE: 1 CM = 1 METER



SYMBOLS	
	SAMPLE
	SLOPE
	RIDGE
	WATER
	OUTCROP
	ELEVATION

SCALE: 1 CM = 1 METER

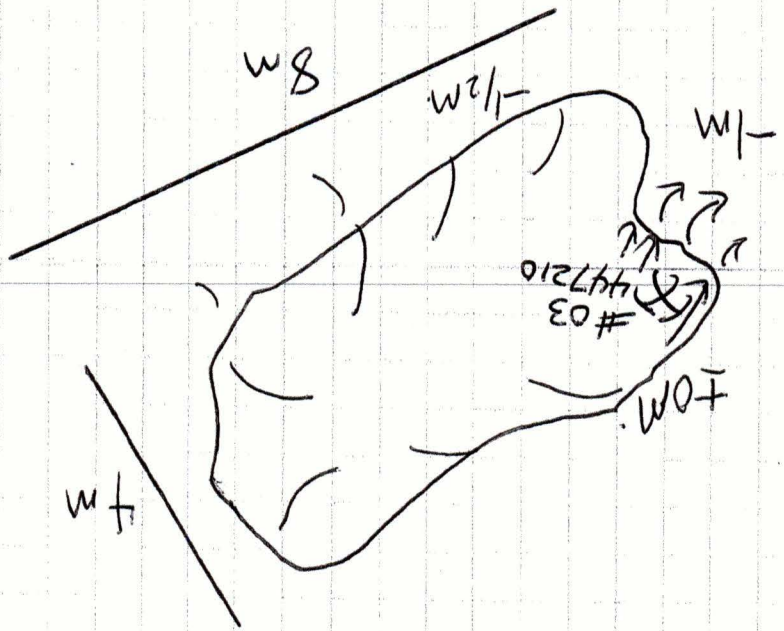

TO POST#	
	METERS
	BEARING

TRENCH / PIT 02/14

VTM LOCATION 1640288666E538444YN NAD83

CLAIM # TR 1173912

SCHEDULE 9





CLAIM # TB 1173912  
UTM LOCATION 164 288021E 5383842N NAD83

SCHEDULE 7

TRENCH/PIT 03/14

TO POST #4  
METERS  
BEARING

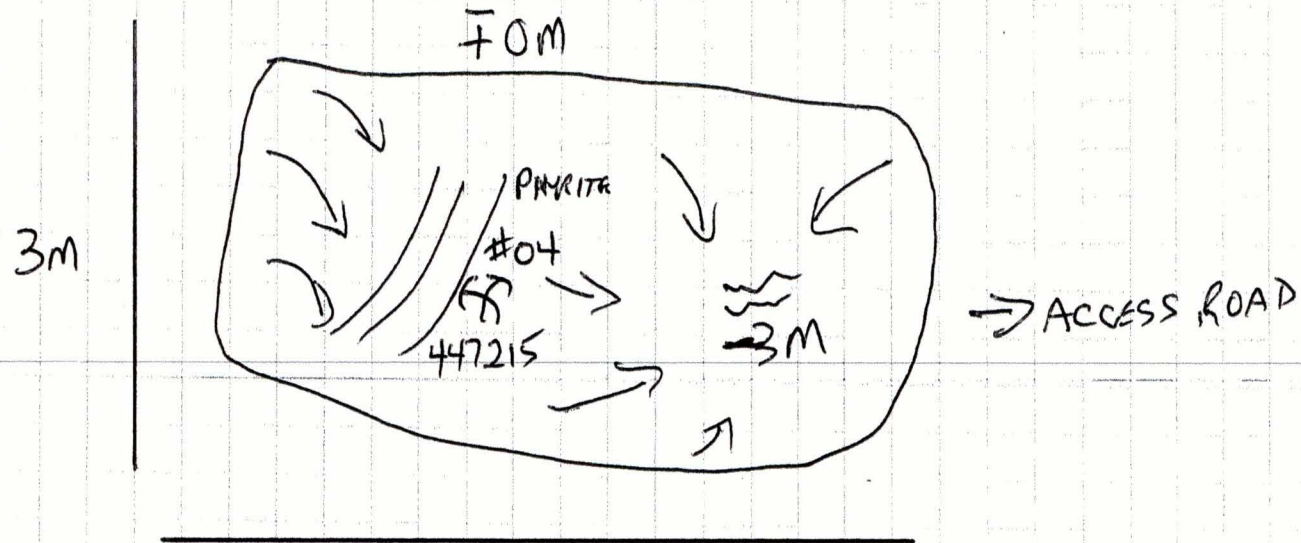

10cm = 5m

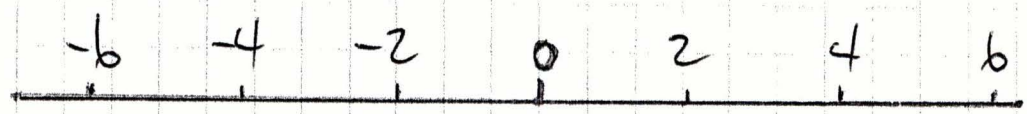

SCALE: 2 CM = 1 METER

SYMBOLS	
SAMPLE	⊗
SLOPE	↗
RIDGE	
WATER	~
OUTCROP	⊙
ELEVATION	±m

ON SEPTEMBER 10<sup>TH</sup> AND 12<sup>TH</sup> WE SAMPLED TWO AREAS ON 1173912

GPS CO-ORDINATES (NAD 83 DATUM USED)

UTM ZONE 16U

<b>SAMPLE #</b>	<b>TAG #</b>	<b>EASTING</b>	<b>NORTHING</b>
<b>01</b>	<b>447205A</b>	<b>0288420</b>	<b>5384768</b>
<b>02</b>	<b>447205B</b>	<b>0288420</b>	<b>5384768</b>
<b>03</b>	<b>447210</b>	<b>0288666</b>	<b>5384444</b>
<b>04</b>	<b>447215</b>	<b>0288021</b>	<b>5383842</b>

**Outcrop / Pit / Trench Location Map attached as Schedules**

**Pit/Trench 01/14**

Located on Claim 1173912 this area is on the east side of the north-south access road. The pit/trench was 100 meters from the road as you start your way into the brush. We dug downward and then dropped 1 meters at the end of the run. The main part of the pit is 3 wide and over 14 meters in length. The trench has quartz.

Two samples were taken.

Assay Tag 447205A Not available at time of filing

A full ICP ASSAY REPORT was also ordered (attached)

**Additional information: Report attached dated September 24, 2014**

**Assay Tag 447205A**

**Gold (Au) 0.007 ppm**

**Aluminum (Al) 1.91 %**

**Calcium (Ca) 4.28 %**

**Iron (Fe) 4.28 %**

Assay Tag 447205B Not available at time of filing

A full ICP ASSAY REPORT was also ordered (attached)

**Additional information: Report attached dated September 24, 2014**

**Assay Tag 447205B**

**Gold (Au) 0.019 ppm**

**Aluminum (Al) 1.04 %**

**Calcium (Ca) 4.09 %**

**Iron (Fe) 2.06 %**

**Pit/Trench 02/14**

Located on Claim 1173912 this area is 300 meters south and 240 meters east of Pit 01/14. The ground drops off as we reach an old riverbed. We cleared off the slope to expose the rock. The area is 8 meters in length and 4-5 meters wide in areas.

The rock contained spider veins of quartz and a small amount of pyrite. 3 inch Quartz where sample was taken. One sample was taken.

Assay Tag 447210 Not available at time of filing

A full ICP ASSAY REPORT was also ordered (attached)

**Additional information: Report attached dated September 24, 2014**

**Assay Tag 447210**

**Gold (Au) 0.007 ppm**

**Aluminum (Al) 3.22 %**

**Calcium (Ca) 4.15 %**

**Iron (Fe) 5.21 %**

**Titanium (Ti) 3,361 ppm**

**Pit/Trench 03/14**

Located on Claim 1173912 this area is 600 meters further west. We cleared an area 3 meters by 5 meters. The pit drops by over 3 meters in tiers. The sample taken contained high quartz and pyrite.

One sample was taken.

Assay Tag 447215 Not available at time of filing

A full ICP ASSAY REPORT was also ordered (attached)

**Additional information: Report attached dated September 24, 2014**

**Assay Tag 447215**

**Gold (Au) 0.006 ppm**

**Aluminum (Al) 3.42 %**

**Calcium (Ca) 5.53 %**

**Iron (Fe) 7.43 %**

**Titanium (Ti) 3,317 ppm**

## Gold Cache Inc.

225 University Drive  
Thunder Bay, Ontario  
P7C 2Z3  
CANADA



Nov 15, 2014

Ministry of Northern Development and Mines  
Geoscience Assessment Office  
933 Ramsey Lake Road, 3<sup>rd</sup> Floor  
Sudbury, Ontario  
P3E 6B5  
Attention: Roy Denomme, Senior Manager, Mining Lands Section

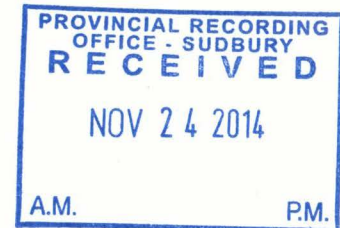

Dear Mr. Denomme

Re: Response to questions raised in 45 day notice Claim TB#1173912 Horne Township Transaction #W1440.01918

First of all I must deal with your concern over similar wording in our submission. We completed the assessment reports at the same time. Therefore we used one report to as the base for the other. It was not a case of cut and paste, but simply modifying the template that we have been using for years (one established in response to a 45 day request from your office several years ago). The phases are the same because that is always what we are looking for "ridges and outcroppings". This entire area is the same terrain, if we don't catch an outcrop or ridge that bedrock drops off and there is lots of overburden. Also in the claims being compared, the rock type is the same. If the reports had not been submitted at the same time this would not have been an issue.

As your concerns are similar to those express for Claim TB1216710, I will use the same format to reply and simply add additional information if appropriate. As noted below (\*), we have attached a separate letter that explains the timing of the work, which led to some of the confusion.

Q. Pictures of the stripped areas...

A. We did not take pictures of the trenches except for work done on claim #TB1173911 (assessment report not yet submitted) where a larger trench was involved and a variety of mineralization exposed. That assessment report has not been filed. I will provide you with those pictures. We have not been asked for pictures of the trenches in the past although we have submitted pictures with our reports in the past when they were appropriate. We will make this part of our ongoing reporting.

Q. The section "Work Performed".....

A. See covering letter (\*) to explain that we were on the property in June. Even during that time we were deciding which claims we would cover that week. All claims are within 15 minutes of each other but much longer moving a backhoe around. We began working on this claim on June 17 and continued on the 18<sup>th</sup> and back again June 20<sup>th</sup>.

Q. Three samples were taken.....by channel cuts....

A. Originally only one sample was to be taken in each cleared area. This should read "Four samples were taken". As in my report for TB1216710, I should have caught this error.

Q. The Project History.....

A. This is a 16 claim block and we have spent a lot of time, effort and expense to explore the area. All of this work was done with a backhoe and physical labor. This block is just a part of 7 contiguous blocks (61 claims) which require over \$24,000 per year in assessment work to be performed. Forestry activities in the area have provided access roads to a variety of target areas that were indicated on VLF EM mapping done several years ago on this claim. We do not maintain master files for each claim. We file the assessment files and refer back to them when we require clarification. We have not had significant assay results in any of our claims other than TB1173909 where assays reached 56 grams per ton after blasting was done in those trenches. Knowing that those assays are possible, we have been searching for similar surface samples.

Q. Please provide this geological information....

A. The areas that we have worked have been consistent in its geology. We have only given additional detail where it had varied from the norm. Mafic rock with high quartz infused or spider veins, pyrite indicated but only in high concentration in the samples coming from our blasting pits. On claims 1173909, 1173911 and 1216710 we have Pillow Lava formations with higher levels of Titanium but no gold findings at surface which is our target mineral. In the recent samples we are getting a higher level of Iron and some base minerals.

Q. Assay results.....

A. I have attached the assay results for this claim, along with the invoice (I did not include/(claim the assay cost in the report). I also modified two pages of the assessment report to include a sample of those reports.

This year I was not present during the original work looked after by Bill Yahn and Wayne Hubbard. This was the first year that we worked on so many claims at once but there were several areas that we wanted to get to in order to prove the value of the claims. I currently reside in Paradise, Newfoundland where I may be working for the next couple of years. I get back to Thunder Bay as often as I can and go out to the claim each time. We are actively trying to option these claims and for two years were under a confidentiality agreement with a company interested in the property. That did not work out and placed us back working the claims. We look after the claims for the Widow of the original owner Thomas Kukkee. We created the company Gold Cache Inc. but it is still a few people spending their time and money to keep things current until the property can be optioned. There has been interest from some local Junior Mining Companies because of the high gold assays in our main trenches.

Yours truly

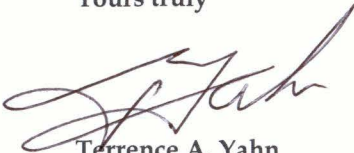

Terrence A. Yahn

President

[tyahn@bellaliant.net](mailto:tyahn@bellaliant.net)

1-709-699-8555

Gold Cache Inc.