

2.56017

2015 Sampling Program on Mining Claim L 4246849 Located in the Township of Lebel

Introduction

On May 24/2015 a sampling program began on Mining Claim L 4246849 located in the central part of Lebel Township in the District of Timiskaming. The single unit claim encompasses the central and eastern part Julia Lake. The purpose of this program was to test mineralized outcrop exposers found in the southern part of the claim. The area along the south boundary is on higher ground in the form of a small ridge. The outcrop exposers are near surface and easily located. The downward slope trends towards the north to Julia Lake. The terrain is rough and the forest floor is littered with dead fall. The main vegetation is mainly spruce and birch trees. Alders are thick and extended north to Julia Lake where the ground is low and swampy.

Access

There are no roads to the southern part of the claim but an atv trail which runs north to Julia lake which begins at Mr. Dave Rogers property to the east. Mr. Rodgers has allowed us to access claim L 4246849 using this trail. A dry weather road 400 meters south of the claim which runs in a east- west direction was also used to get to the atv trail on the western limit of the small Town of King Kirkland.

Property Geology

The southern part of mining claim L 4246849 is mostly underlain with sediments, mainly conglomerate. The conglomerate exposers examined during this sampling program is slightly altered with minor carbonization with fine sulfides. It is fine to medium grain light grey in color. Little is known about the claim since it was a June 1st opening in 2009. There are no reports in the assessment files at the MNDM office in Kirkland Lake on the former patent mineral rights. Map No. 53a shows mostly sediments (conglomerates) in the southern section of L 4246849. Near the number 3 post just north and west a small outcrop of quartz- feldspar porphyry. The feldspar porphyry was pale red in color , medium grain with fine sulfides (up to 1 %) with small quartz stringers up to 1 cm wide in places. Although a small exposer and not indicated on any map was encouraging. Some small slumped in trenches were noticed in the immediate area but a chainsaw would be needed to examine them due to the dead fall covering them. For the most part Map No. 53a is accurate , but there are more exposers of bed rock than indicated. Further mapping and sampling will be done throughout the summer, hand trenching and brush clearing will have to be done to get to these exposers.

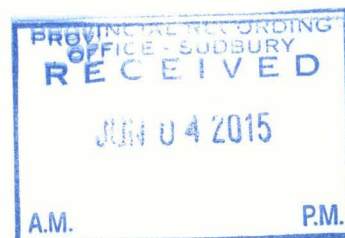

The Sampling Program

The sampling in this report was carried out on May 24th 2015. One day was spent to see if any mineralization could be found in the southern part of the claim. Although there was no assessment files to be found on mining claim L 4246849 since it was a patent until June 1st 2009, when it was released for staking. Map No. 53a was very helpful in locating bedrock exposers and seemed to be accurate in showing the rock types. A total of five samples were taken, four on the meta - sediments, mainly the slightly altered conglomerate, one on the quartz feldspar porphyry. At these sample sites the mineralization was of a fine disseminated sulfide and minor cubic pyrite. The rocks examined were slightly carbonated with rusty surface in places. Two traverse lines in an east – west direction were completed on May 24/15, line #1 traveled east, 25 meters north of the south boundary in the morning. In the afternoon line #2 travelling west 50 meters north of the south boundary.

<u>Sample #</u>	<u>Description</u>	<u>Au, grams/ton</u>
21411	meta-sediment, (conglomerate) light grey in color, fine to medium grain pebbles are small 2 to 3 cm in diameter, fine disseminated sulfides < 1%, slightly carbonated,	0.01
21212	meta-sediment,(conglomerate) light grey in color, fine to medium grain pebbles are small 2 to3cm in diameter, fine disseminated sulfides < 1% slightly carbonated,	<0.01
21213	meta-sediment,(conglomerate) light grey in color, fine to medium grain Pebbles are small 1 to 2 cm in diameter, fine disseminated sulfides <1% Slightly carbonated	<0.01
21214	meta sediment,(conglomerate) light grey in color, fine to medium grain Pebbles are small 1 to 2 cm in diameter, fine disseminated sulfides<1% Slightly carbonated,	<0.01
21215	quartz-feldspar porphyry, pale red in color, medium grain, cubic pyrite <1% Quartz stringers up to 1cm wide, slightly carbonated.	<0.01

Conclusions

Although the assays returned trace gold at best, further prospecting will be carried out throughout the summer. Mineralization and some alteration is present similar to the Kirkland Lake deposit. The conglomerate is similar to outcrops on the Federal Kirkland where the assays reach up to 13 grams per ton in some of the channel samples. If the conglomerate on mining claim L 4246849 can be found with elevated silica content it could return higher gold assays. Further work must be done to determine if gold is present in the meta- sediments and porphyry s.

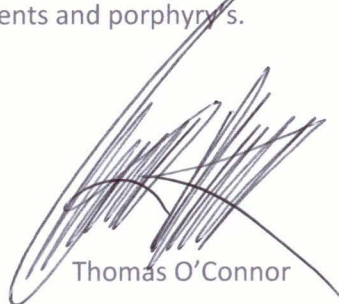

Thomas O'Connor

Statement of Cost for the 2015 Prospecting & Sampling Program on Mining Claim L 4246849

<u>Date</u>	<u>Description</u>	<u>Amount</u>
May24/15	T. O'Connor, prospecting & sampling, 350.00/day	350.00
	Mark Mahonen, helper, 250.00/day	250.00
	Atv ,(all-terrain vehicle, Honda 450 Foreman) 200.00/day	200.00
May28/15	5 gold assays @ Swastika Labs @ 22.50/sample + HST	127.13
June1/15	T. O'Connor, Report, 1 day @ 350.00/day	<u>350.00</u>
	Total amount claimed	\$1,277.13

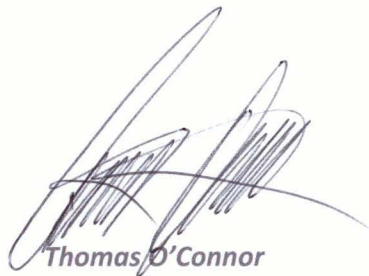

Thomas O'Connor

Sample locations

- 21411- 28 meters north of the # 3 post
- 21412- 50 meters north – east of the # 3 post @ 45 degrees
- 21413- 112 meters north- east of the #3 post @ 70 degrees
- 21414- 127 meters north-east of the # 3 post @ 73 degrees
- 21415- 98 meters north-west of the # 2 post @ 315 degrees

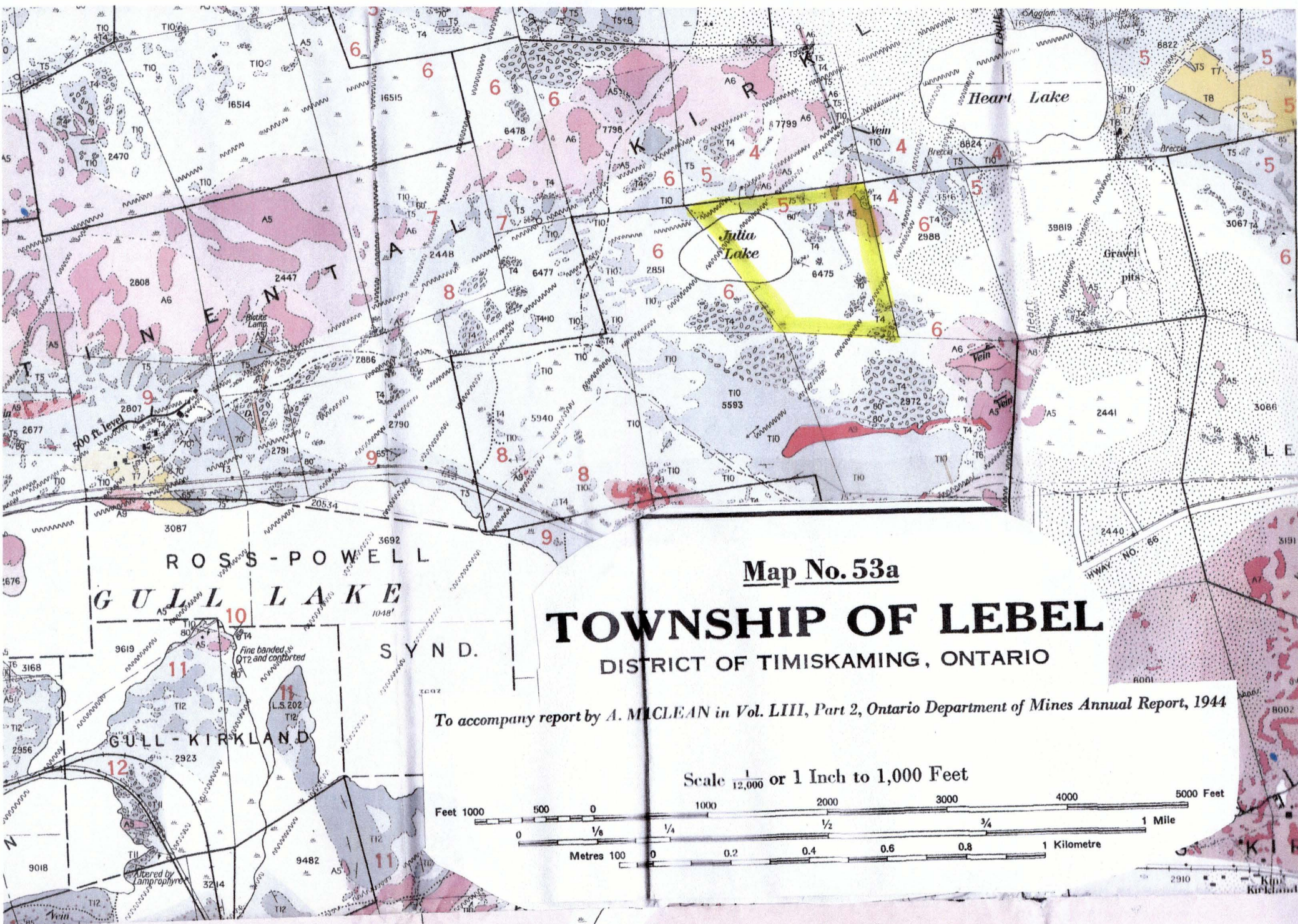

Map No. 53a

TOWNSHIP OF LEBEL

DISTRICT OF TIMISKAMING, ONTARIO

To accompany report by A. McCLEAN in Vol. LIII, Part 2, Ontario Department of Mines Annual Report, 1944

Scale $\frac{1}{12,000}$ or 1 Inch to 1,000 Feet

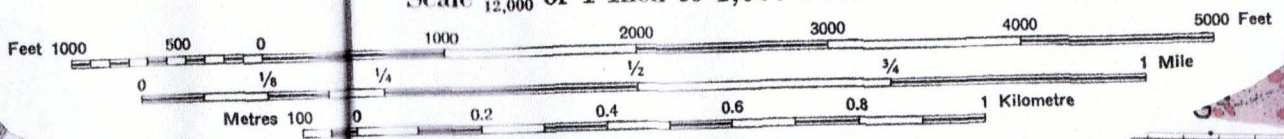

Largely syenite

AM. PM.
 JUN 04 2015
 RECEIVED
 OFFICE - SUDBURY
 PROVINCIAL RECORDING

L 4246849

6547

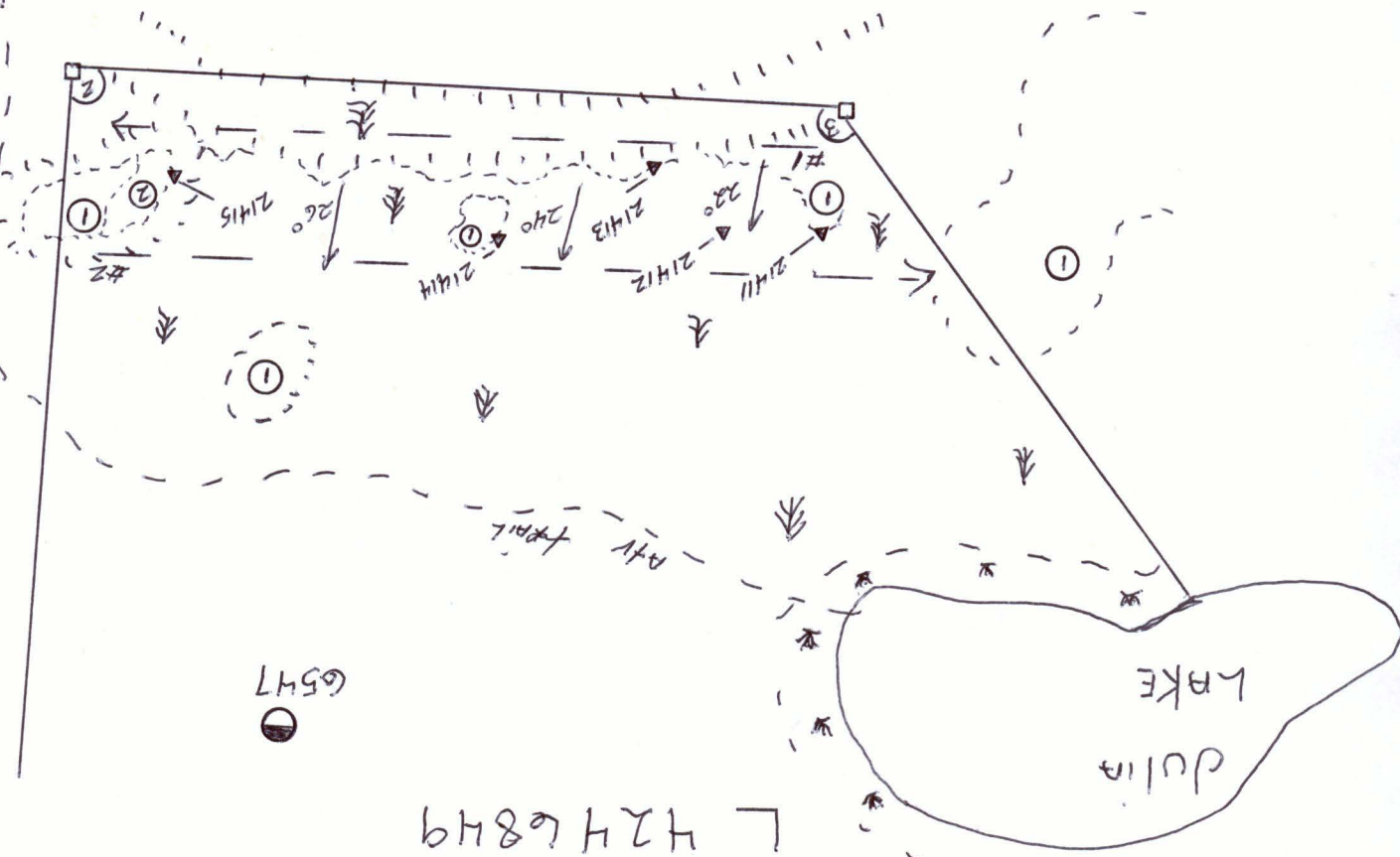

Scale: 1cm = 25 meters

LEGEND
 □ CLAIM POST WITH CORNER #
 ○ LOW LYING OUTCROP
 --- RIDGE TOP
 --- MATURE FOREST (SPRUCE + BIRCH + ALDERS)
 ↓ DIRECTION OF SLOPE
 ▼ 21H1 SAMPLE LOCATION WITH SAMPLE #
 ○ CONGLOMERATE
 ② QUARTZ-FELDSPAR PORPHYRY

TRAVELERS LINE WITH DIRECTION
 0.8 KM TO KINGSTON

NORTH



Established 1928

Swastika Laboratories Ltd

Assaying - Consulting - Representation

Page 1 of 1

Assay Certificate

Certificate Number: 15-1244

Company: **Tom O'Connor**

Project: 4246849

Report Date: 27-May-15

Attn: Tom O'Connor

We hereby certify the following Assay of 5 rock/grab samples
submitted 25-May-15 by Tom O'Connor

Sample Number	Au	Au Chk
	FA-MP g/Mt	FA-MP g/Mt
21411	0.01	
21412	< 0.01	
21413	< 0.01	
21414	< 0.01	
21415	< 0.01	

Certified by *Jing Lin*

Jing Lin, M Sc.