

Prospecting Report on claim 4276009 McOuat Lake Area G-0542

The property is located about 20 kms west of Atikokan Ontario off a logging road marked as Elizabeth Road travel south on Elizabeth about 5 kms where it will turn east and is known as Cirrus Road this road leads right into the claim about another 2kms.

Previous work was recorded prior to 1979 although not much documentation could be found related to the MDI. The property was looked at again in the early 2000s which included trenching sampling and a magnetics survey. Some of the more recent work was located while prospecting including stripped areas and areas that had been channel sampled. Some other workings were encountered that were much older some grown in pits and trenches.

On July 29th 1 day was spent by Allan Onchulenko of Gorham Ontario and Peter Gehrels of Thunder Bay Ontario prospecting on the claim. The goal was to follow up on some prospecting we had done late in 2014 where we outlined an ultramafic intrusion on the claim. We started where we left off previously a stripped area about 100m north of cirrus road roughly in the center of the claim. Of interest the cirrus road is a newer bush road which did not exist at the time the last work was done in the area. We traversed along the intrusion north towards the lake at several places the contact could be found with the surrounding quetico sediments. No major mineralization was found however of note we located a breccia zone which could be described as a lac des isle style breccia (broken bits of quetico seds with quartz within the ultramafic intrusion). As we continued around the contacts we realized that the trend of the intrusion was going to lead outside of the claim boundaries.

Based on the further prospecting and discovery of the breccia zone it was decided to add claims and continue prospecting the intrusion which is much larger than previous work had indicated and shows the potential to host economic mineralization.

Allan Onchulenko

Google Maps Thunder Bay, ON to McOuat Lake

Drive 226 km, 2 h 28 min



Map data ©2016 Google 20 km

 via Trans-Canada Hwy/ON-11 W
 2 h 16 min without traffic

2 h 28 min
 226 km

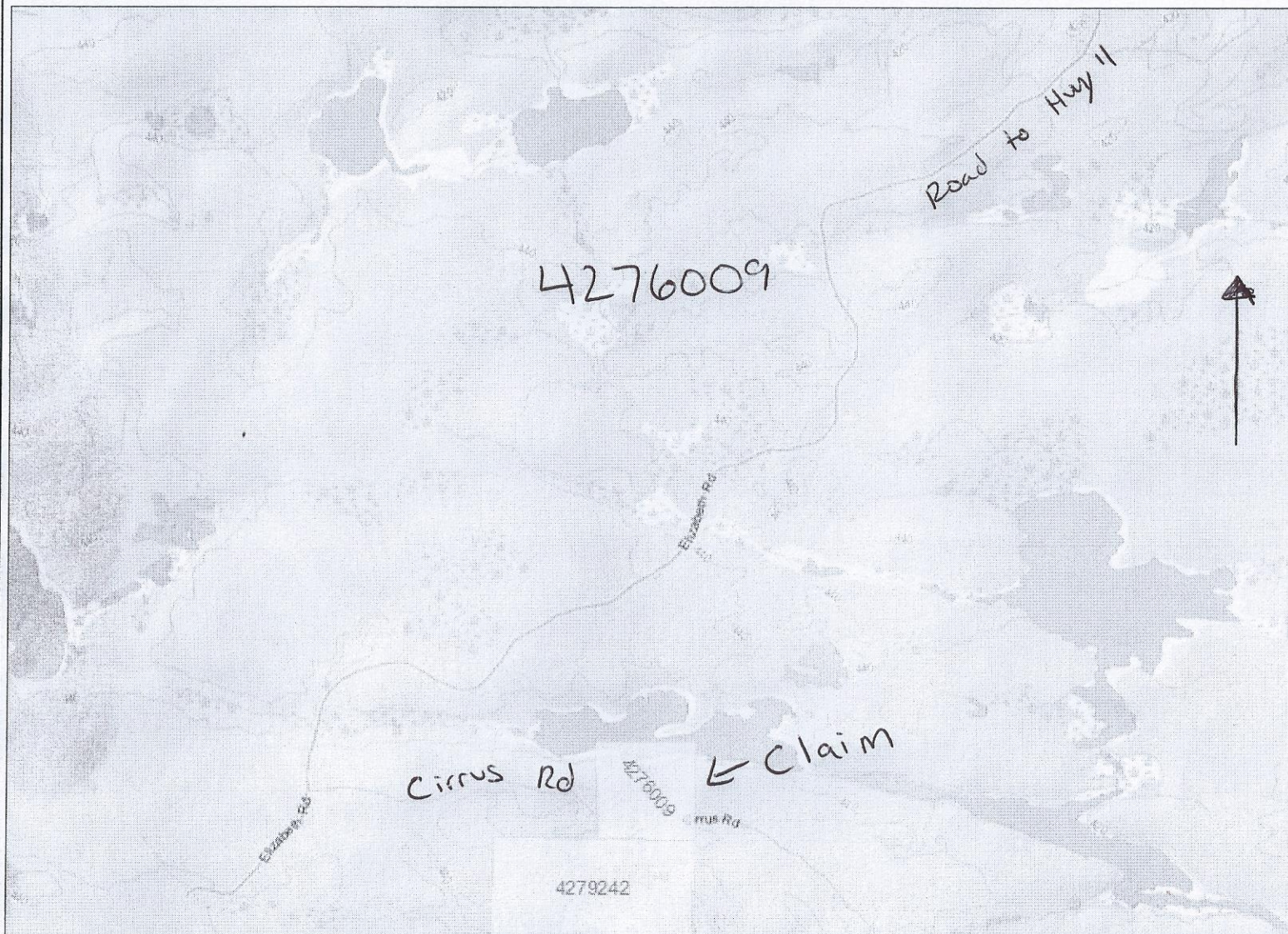
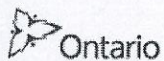

Legend

- Administration Boundaries**
 - Mining Divisions
 - Resident Geologist District
 - Townships and Areas
 - UTM Grid
 - Geographic Lot Fabric
 - Other Federal Land
- Mineral Tenure Grid**
 - OMTG Tenure Grid
- Alienations**
 - Withdrawal
 - Notice
- Unpatented Claim**
 - Active
 - Reconcoiled
 - Pending
- Disposition**
 - Disposition
- Disposition Symbols**
 - Camp
 - Disposition Unknown/Pending
 - Freehold Patent Mining Rights Only
 - Freehold Patent Surface Rights Only
 - Freehold Patent Surface and Mining Rights
 - Land Use Permit
 - Lesseehold Patent Mining Rights Only
 - Lesseehold Patent Surface Rights Only
 - Lesseehold Patent Surface and Mining Rights
 - License of Occupation Mining Use Only
 - License of Occupation Surface Use Only
 - License of Occupation Surface and Mining Rights
 - License of Occupation Uses Not Specified
 - Order in Council
 - Tower
 - WPLA
- Geology Layers**
 - AMIS Sites
 - AMIS Features
 - DRI Holes
 - Mineral Occurrences

400 M

0 1.2 km

Projection: Web Mercator



The Ontario Ministry of Northern Development and Mines shall not be liable in any way for the use of, or reliance upon, this map or any information on this map. This map should not be used for: navigation, a plan of survey, routes, nor locations.

Imagery Copyright Notices: Ontario Ministry of Natural Resources and Forestry; NASA Landsat Program; First Base Solutions Inc.; Aéro-Photo (1961) Inc.; DigitalGlobe Inc.; U.S. Geological Survey.



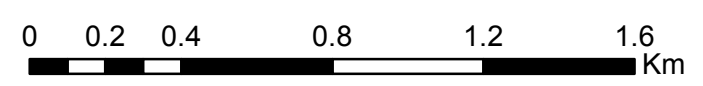
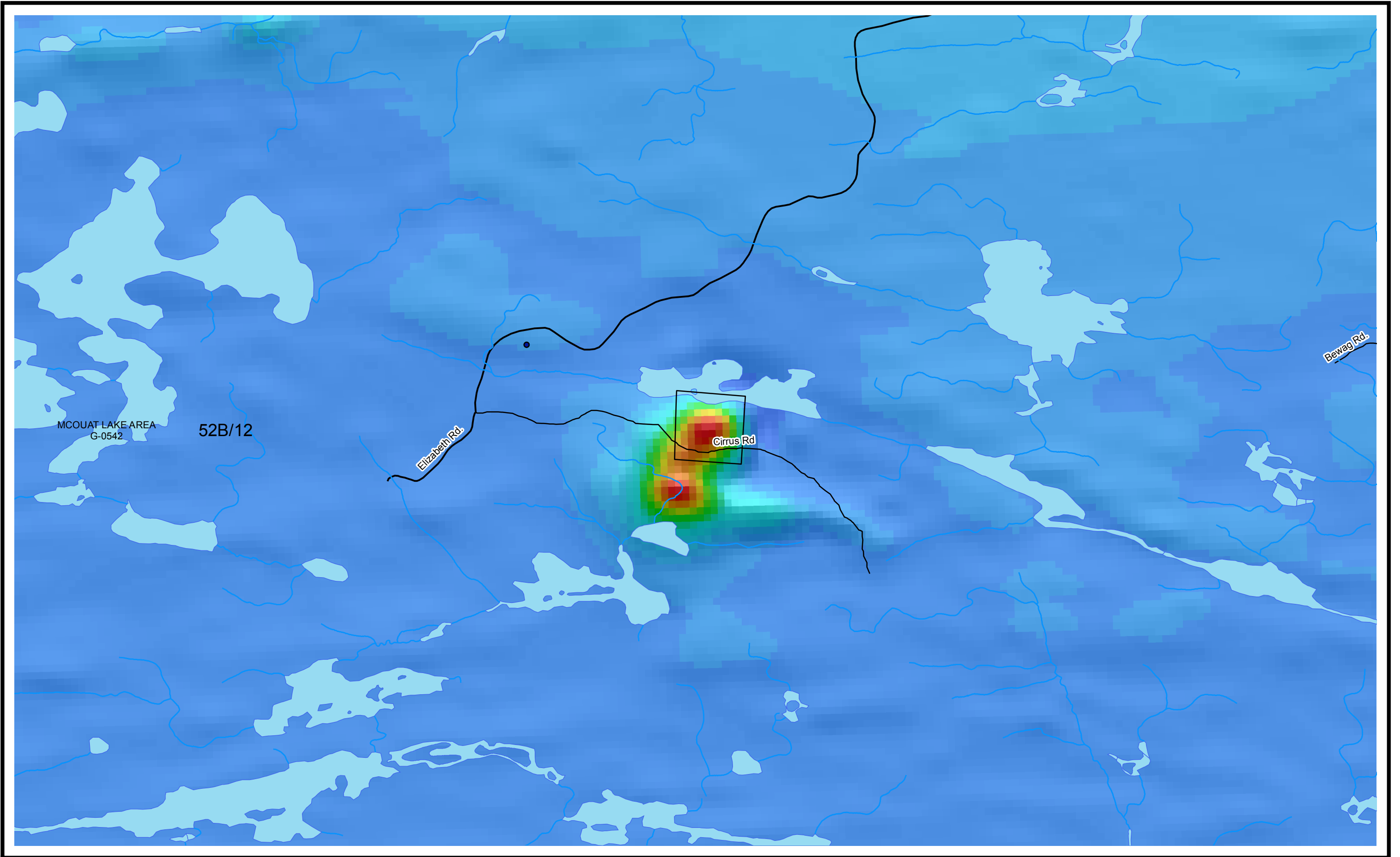

440 M

183.43 km

W

120m

0M

010

107

112

GARMIN

