

We are committed to providing [accessible customer service](#).  
If you need accessible formats or communications supports, please [contact us](#).

Nous tenons à améliorer [l'accessibilité des services à la clientèle](#).  
Si vous avez besoin de formats accessibles ou d'aide à la communication, veuillez [nous contacter](#).

2-56697

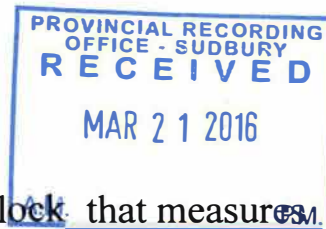

## **Deva property**

The Deva Property consists of four claim units in one block that measures 400m x 1600m. The property is in the Sudbury mining division in Waters township and is located between little round lake and page lake. The property is 5.5 km south-west of Kelly lake. The ground was staked by R.J Fielding and Todd Fielding to cover a distal portion of the Copper Cliff Offset Dyke as indicated on a map by Grant and Bite on page 280. (geology of the sudbury structure 1984.) see map #2.

## **Deva Property Previous Work**

Previous exploration work on the Deva Property area is very limited. At the Deva property prospecting in 1999, led to the discovery of the offset dyke, which was substantiated by petrographic microscopic examinations (Peredery, 2001). Rod and Todd Fielding essentially followed a known occurrence of the Copper Cliff offset dyke located just further north, found earlier by Andy Bite in the 1970s (Inco).

Catherine Farrow, on behalf of Inco, Examined the area in 2000. She produced a map of the Deva Property area and assaying work. Her map and assays of the Deva property was made available to Rod Fielding and is in his possession.

Geophysical surveys on the deva property were carried out by BP resources Canada in 1989 and included magnetometer and VLF EM/EM 16 surveys.

A number of anomalies were identified in the claim block. From the In phase and Out of phase quadrature lines there is a contact / resistivity contrast anomaly trending North South that corresponds to the known portion of the Deva offset Dyke. A north south trending resistivity anomaly occurs on the western side of little round lake, this anomaly lines up with the deva dyke anomaly. BP Resources did not follow up on any of these anomalies and never identified any quartz diorite, and the claims were allowed to lapse. The lack of exploration on this section of the copper cliff offset is surprising considering the volume of ore bodies hosted by quartz diorite dyke along strike to the north. Map #2

## **Geology of Deva Property**

The Deva property is underlain by quartzites of the Mississagi formation, Nipissing gabbro and late olivine diabase dykes (Card, 1965; Dressler, 1984). Impact related breccia is common within the quartzites and likely also occurs within the Nipissing gabbros. The quartz diorite dykes identified by Grant and Bite (1984) is not shown on the regional geological maps, but its occurrence has been independently confirmed by W. Peredery (2001)

## **INTRODUCTION**

This report covers work carried out on the Deva property in the sw1/2 lot 3 con 1 Waters twp, claim #1237335. Work was carried out in June 2014. The claim is recorded in the name of Rod Fielding and Todd Fielding.

This is phase 3 of work project. Phase 1 and 2 were performed in 2011 and 2012 and already filed at the Sudbury MNDM assessment office. In October 2012 stripping was performed with small excavator in 4 locations, this work report in 2014 was performed to wash off and map these 4 locations.

### **June 14/2014**

Rented a 2in trash pump along with hoses from Valcaron equipment rental, drove out to Deva property. Used Polaris quad to bring in equipment to area 1. UTM zone 17 coordinates easting 491679 northing 5136332. Set up pump at sump area in gully. Started washing off stripped area from 2012. After 4 hours of washing, sump hole was emptied. Equipment was left in place for next day.

### **June 15/2014**

Returned to work area 1, sump hole was refilled, continued washing of area along with raking and shovelling out larger rocks and debris. Sump hole lasted all day as lots of water was recycled back into sump hole. Time was spent looking for any sulfides at contact between sedimentary tan coloured bedrock and grey coloured quartz diorite. An area 28ft X 40ft was washed off.

### **June 16/2014**

Returned to area 1 and set up to wash off area 2. UTM zone 17 coordinates easting 491718 northing 5136338. This area is only about 30 metres east of area 1 in a north-south gully, same sump hole was used. A full day was spent washing off area. This area was hard to wash mostly blocky type large rocks. Exposing blocky type grey fine grained quartz diorite. An area 17ft X 20ft was washed off.

### **June 17/2014**

Returned to equipment and moved everything over to area 3. UTM zone 17 coordinates easting northing 5136310. Set up pump at small creek east of area 3, washed off bedrock, exposing a tan coloured quartzite rock, also spent time prospecting in general area. An area 10ft X 25ft was washed off.

### **June 18/2014**

Set pump again at small creek and washed off area 4. UTM zone 17 coordinates easting 491786 northing 5136310. Exposing a tan coloured quartzite with a 4in quartz vein at

## Summary

## COST BREAKDOWN OF DEVA PROPERTY WATERS TWP.

## Man days

**Todd Fielding**      **5 days on site**

**Rod Fielding**      **5 days on site**

**Jon Fielding**      **5 days on site**

**15 man days x 250 = \$3750**

## Transportation

**Truck**                      **5 days x 120km x .40 = \$240.00**

**Pump rental and gas for equipment =380.00**

**Food & beverages 15 man days x 15.00 = \$225.00**

**Report building 1 man day = \$250.00**

**Total** = \$4845.00



# MAP #4

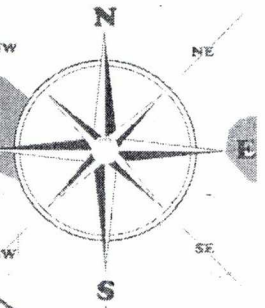

ROUND  
LAKE

CLAIM  
#1237335

AREA 1+2 QD  
AREA 3+4 QUARTZITE



PAGE  
LAKE

JUNE 2014  
4 AREAS WASHED OFF  
FROM STRIPPING IN 2012

WATERS  
TWP.

Deva Property

0 0.25 0.5  
kilometers

DETAILED  
DRAWING

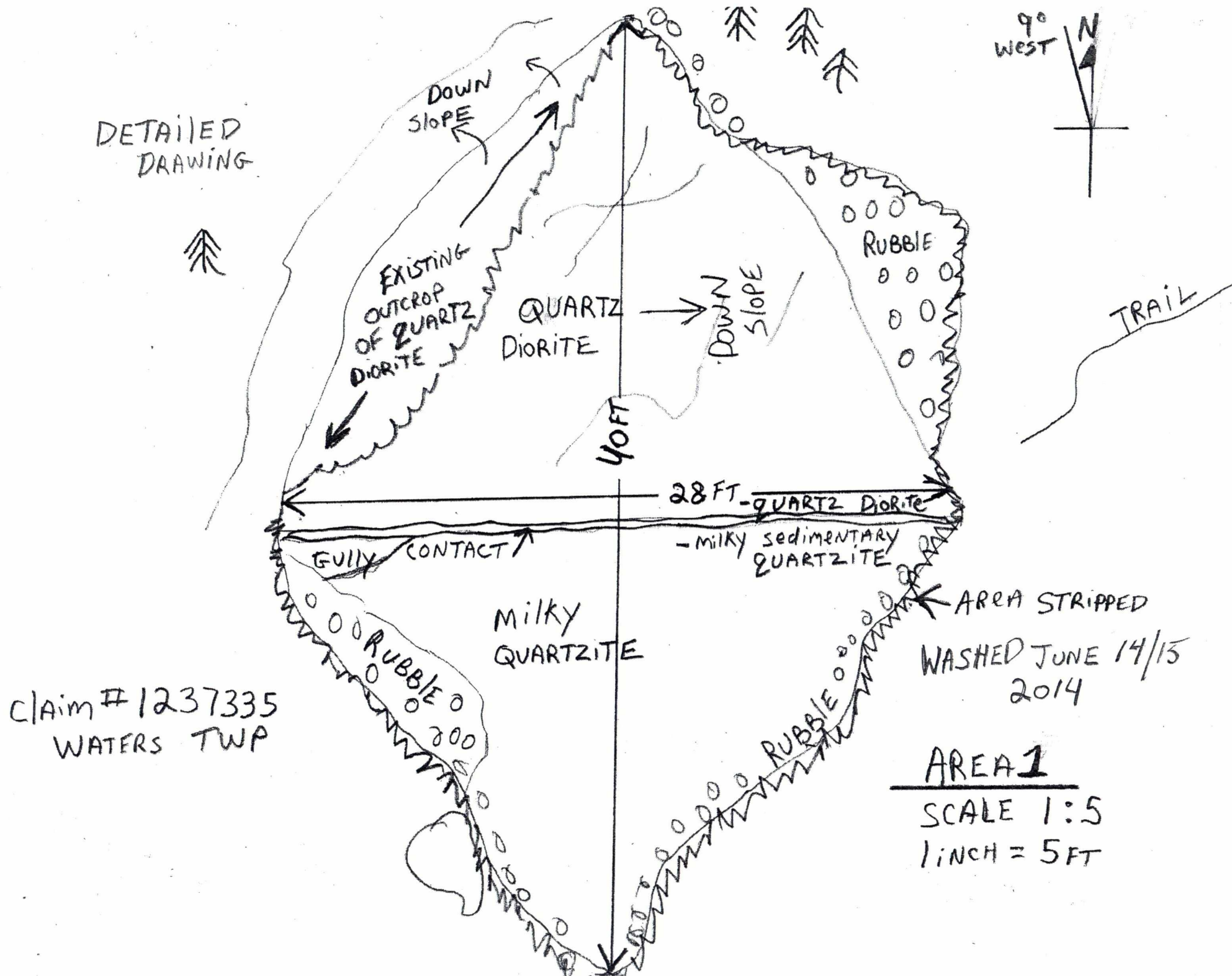
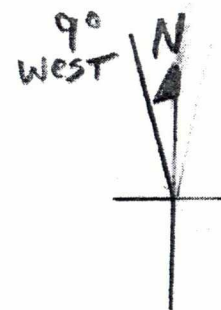

DETAILED  
DRAWING

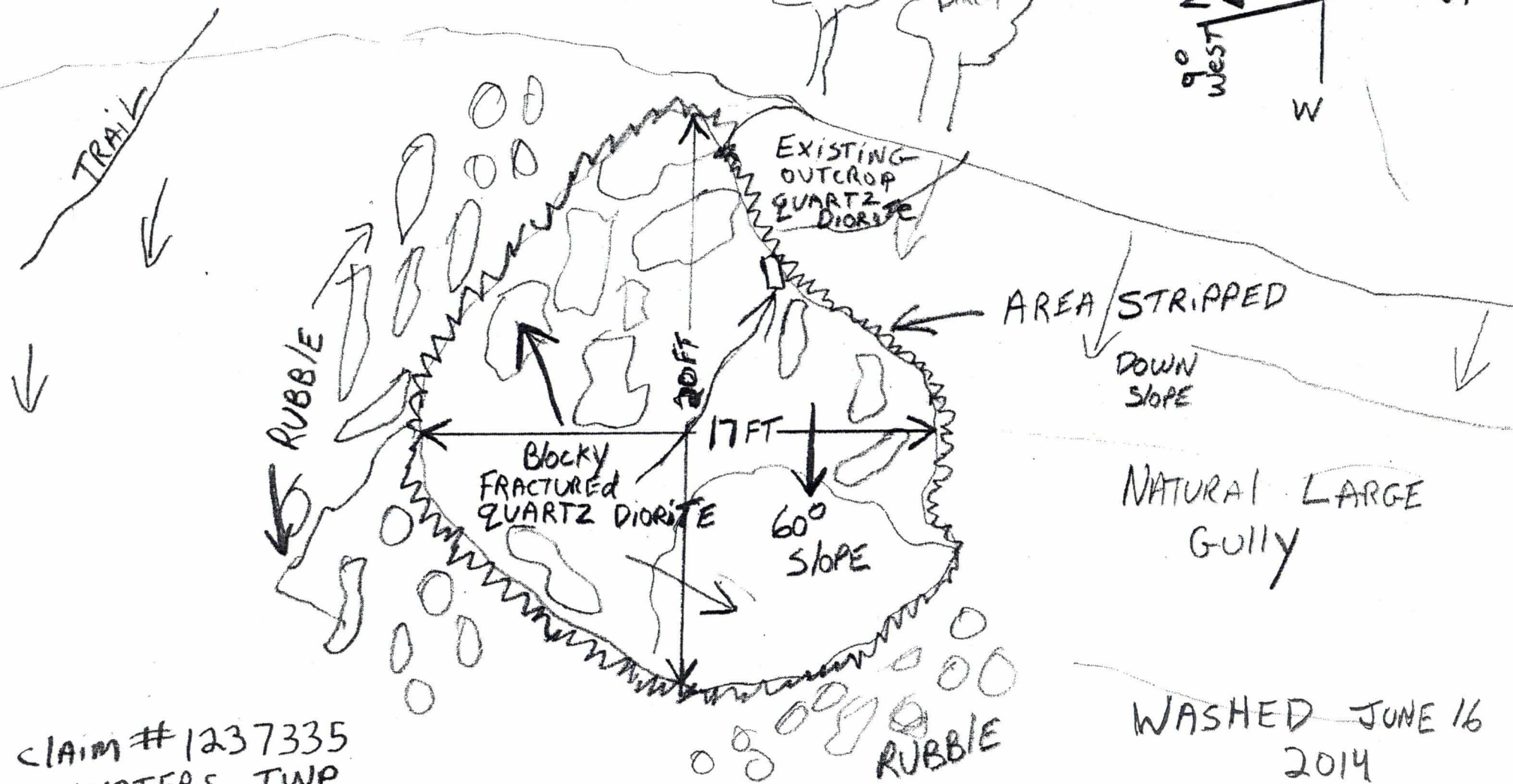
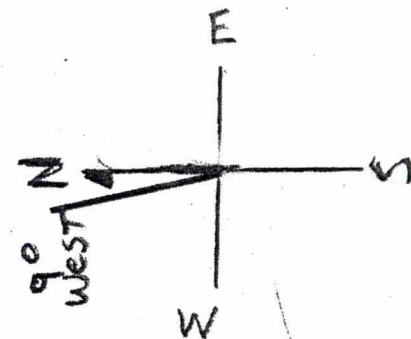

CLAIM # 1237335  
WATERS TWP.

\* LOOKING EAST  
AREA # 2  
SCALE 1:5  
1 INCH = 5 FT

WASHED JUNE 16  
2014



CLAIM # 1237335  
WATER TWP.

DETAILED  
DRAWING  
AREA # 3  
SCALE 1:5  
1 INCH = 5 FT

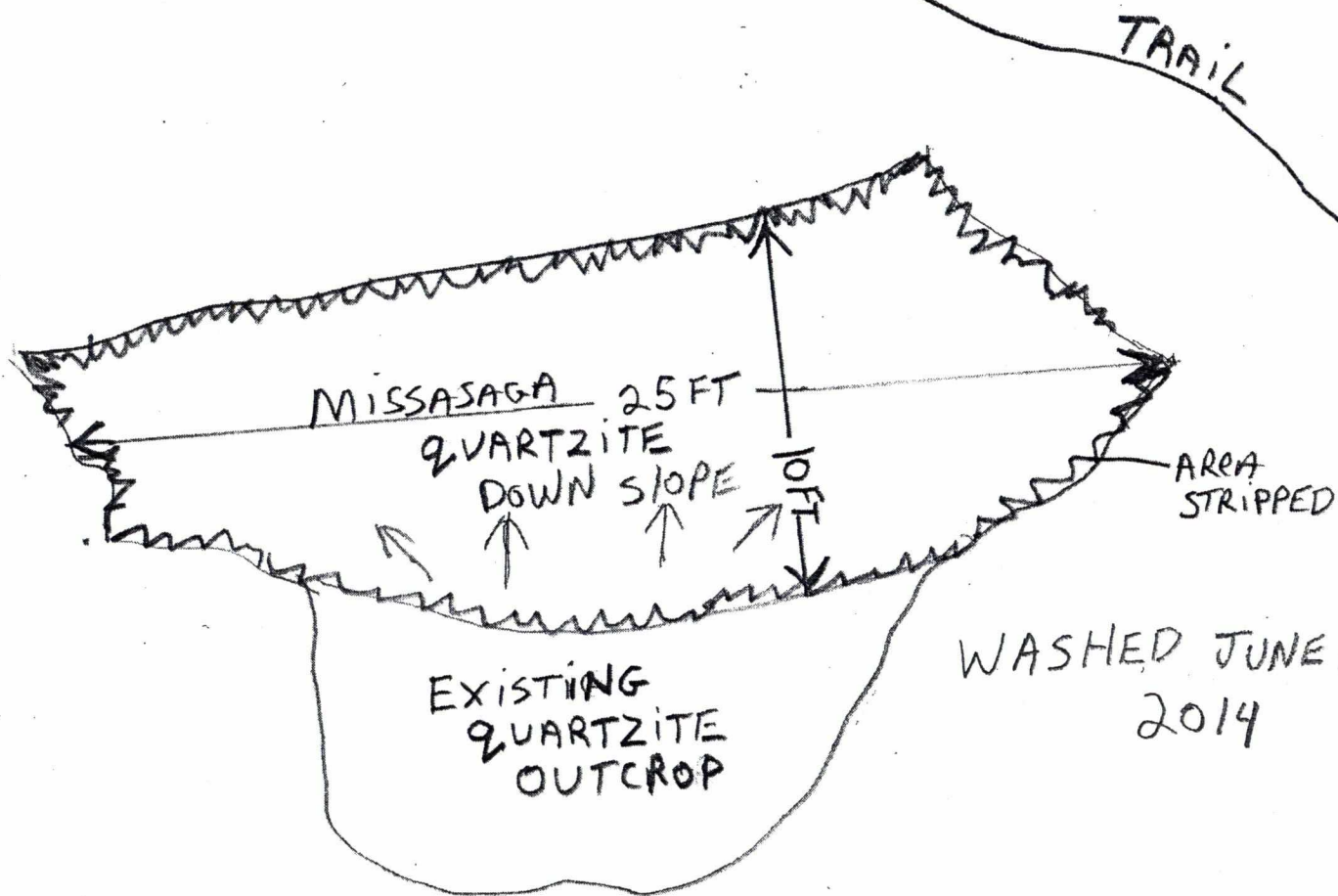
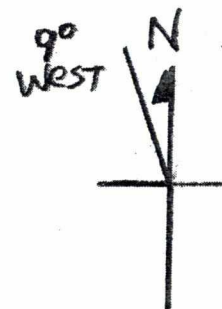



DETAILED  
DRAWING

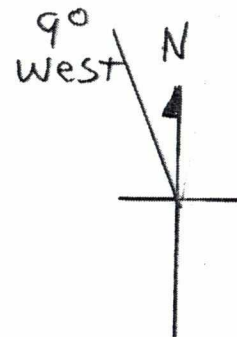

TRAIL

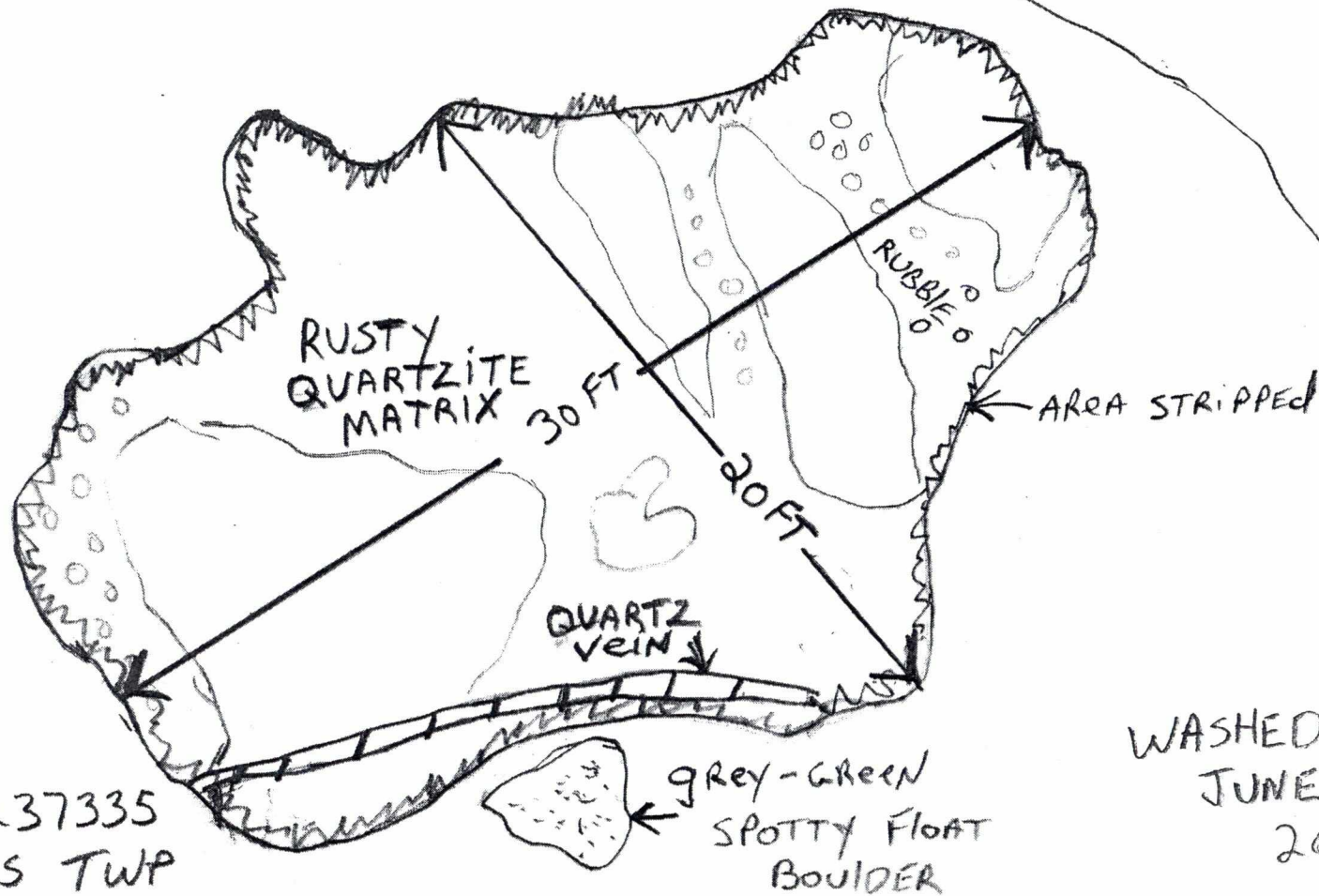

CLAIM #1237335  
WATERS TWP

AREA #4  
SCALE 1:5  
1 INCH = 5 FT

WASHED OFF  
JUNE 18  
2014







# SUDBURY AREA PROPERTIES FOR OPTION

## SUDBURY AND WANAPITEI TWIN GRAVITY AND MAGNETIC ANOMALIES

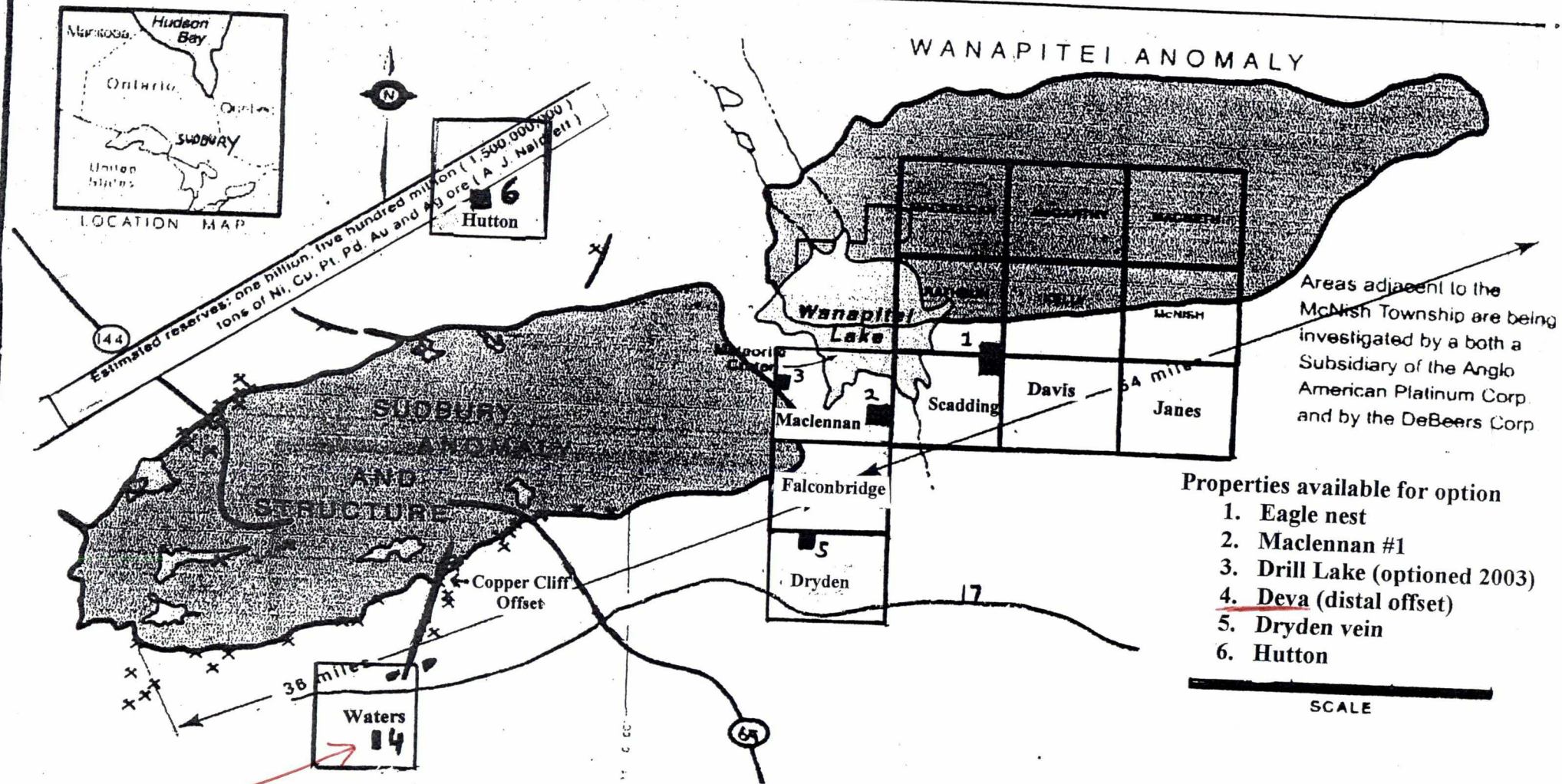

### Properties available for option

1. Eagle nest
2. MacLennan #1
3. Drill Lake (optioned 2003)
4. Deva (distal offset)
5. Dryden vein
6. Hutton

MAP # 1

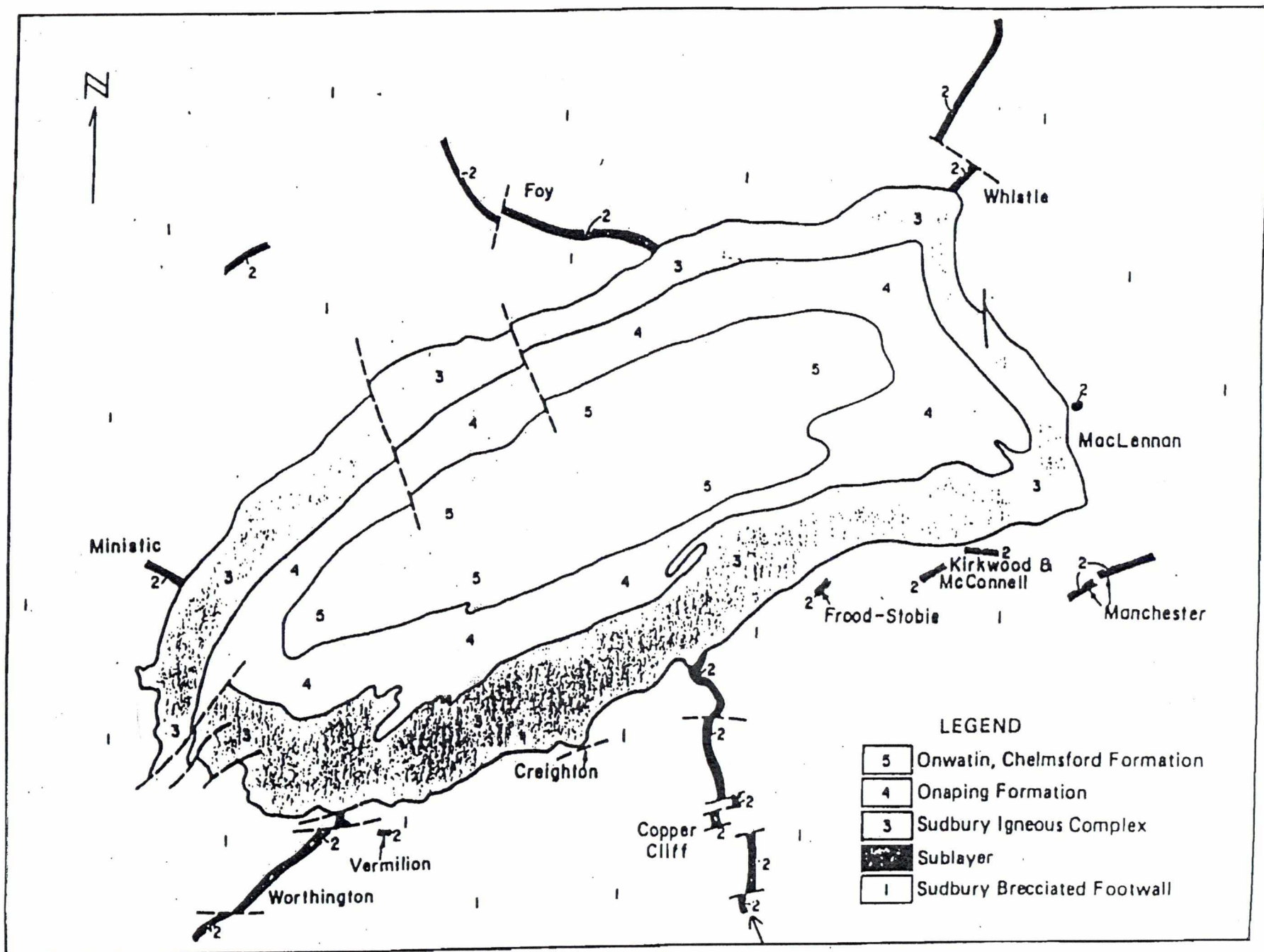







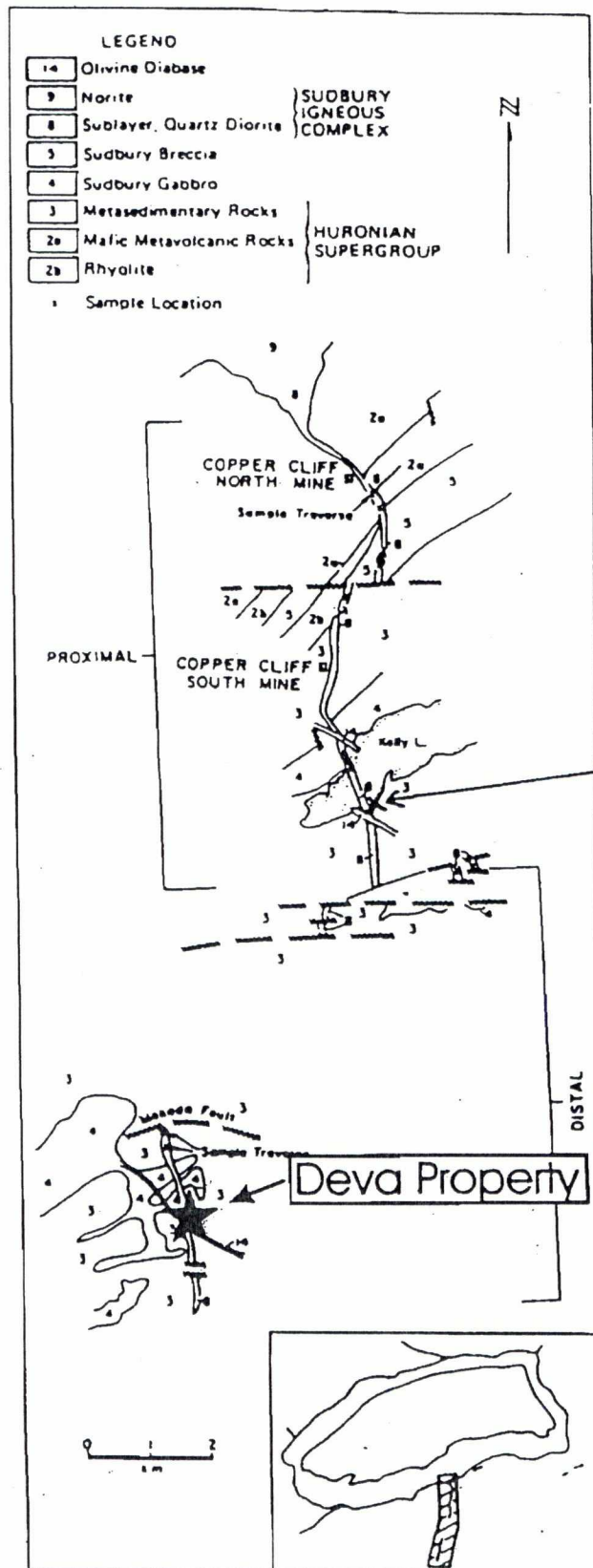

Figure 3. Known distribution of the Copper Cliff offset and location of the Deva property (Grant and Bite, 1984).