

# 2014 Work Assessment Report

## Claim

**L-4253744**

**Mickle Township (G-3683)  
Larder Lake Mining Division**

**NTS Map Sheet 41P/9NW  
47-44-20 N 80-26-10 W**

Prepared By:



Ed Shynkorenko  
Prospector License M-25405  
MAAP 6728-4A77-EFC8-1FBF

**2.55584**

December 2014

## **Forward:**

This report addresses a 2014 effort to further ascertain the drilling potential of a historical trench system located along the southern extremity of the subject property. The trench system has already produced high assayed values for copper along with promising values for silver and gold.

Given that the said east-west trending trench system is approximately 150 metres in accumulative length, it was felt that additional sampling from untested diabase rock faces along the trench walls of the eastern portion of the system should be further examined prior to defining actual drill target locations.

The 2014 work was performed on the subject 2-unit property, being staked claim L-4253744, which is held 100% by Amador Gold Corp. The property is also part of a larger claim block comprised of contiguous mining claims L-4248818, L-4248819, L-4256046 and L-4256047. All are situated in Mickle Township, Larder Lake Mining Division.

The field work detailed in this document, being hand grubbing, sampling, and the mapping within the eastern portion of historical trench system was undertaken by the author, voluntarily and intermittently, over a period of 4.5 man-days commencing June 2<sup>nd</sup> 2014 and finishing on June 8<sup>th</sup>, 2014. Fellow prospector Peter Hermeston, (Lic. 1003623, MAAP Verification 9958-D8C9-DED2-BF4E) also assisted with field efforts.

Stations quoted in the report, and shown on the work compilation plan correspond to the assayed sample "tag number". All required illustrations and maps are contained separately within the Appendices of this document.

Expenditure rates for work, transportation, etc. were derived from industry standards.

## **Table of Contents**

Introduction/History:	Page (i)
List of Illustrations:	Page (i)
Location & Ownership:	Page (i)
Access:	Page (ii)
Regional & Property Geology:	Page (ii)
Work Program:	Page (ii)
Rationale:	Page (ii)
Daily Log:	Page (iii)
Conclusion:	Page (iv)
Recommendations:	Page (iv)
Author's Qualifications:	Page (iv)
Communications (Direct/Indirect):	Page (iv)
References:	Page (iv)

## **List of Appendices**

Appendix A	"Location Map"
Appendix B	"Claim Map, Abstracts, and List"
Appendix C	"Access Map/Key Map"
Appendix D	"Regional Geology Map"
Appendix E	"Assessment Work Performed on Mining Lands" Form
Appendix F	"Work Compilation Plan"
Appendix G	"Assay Results & Receipts"

## **Introduction/History:**

The subject property, being staked claim L-4253744, is known to contain copper and varying amounts of silver/gold. The property had been previously staked, leased, and worked off and on, for ten decades. By late 2009 the said lands became open for prospecting-staking and were acquired by Hermeston and Shynkorenko during the summer of 2010.

During the late summer of 2010, and spring of 2011, grab samples taken from showings along 150 metres of historical trenching located within the southern portion of the property, and stemming westward into adjoining claim L-4248819, returned assayed high values of 21.1% copper and 65.2 ppm silver. Other samples taken produced results of 11.3%, 10.85%, and 12.8% copper. Over the length of the trench system copper averaged 8.69%. The westerly portion of the trench system, which includes the waste rock near an adjoining exploration shaft, also produced averaged assay values for gold at 1.55 ppm (high of 5.5 ppm). A subsequent re-analysis of assayed “pulp” performed by Xstrata resulted in their approval for the potential ore to be received by the Horne Smelter in Quebec. The overall property was subsequently optioned to Amador Gold Corp. in late 2011.



*Recently exposed displays of Chalcocite*

## **List of Illustrations:**

All required maps and sketches referred to in this document are contained within the attached Appendices.

## **Location & Ownership:**

The 2-unit property, being claim L-4253744, Mickle Township, Larder Lake Mining Division, is held 100% by Amador Gold Corp. The property is located approximately 6 kilometres northwest of the community of Elk Lake, Ontario. (See Appendix A “Location Map” and Appendix B “Claim Map, Abstracts, and List”).

### **Access:**

Access to within 200 metres of the property's northern boundary is gained by utilizing 3.0 kilometres of a secondary forest access road, which commences westward from Highway 65 at approximately 4 kilometres north of the community of Elk Lake, Ontario (*See Appendix C "Access Map/Key Map"*). The property can also be accessed from the south via Silverclaim Lake.

### **Regional & Property Geology:**

As previously documented (Sergiades, 1968), the general area is overlain by "*Nipissing diabase in the form of a sill or sheet about 750 feet dipping S/W off Algoman granite and Gowganda conglomerate to underlie gently with banded greywacke and Lorain arkosic sandstone. The diabase shows marked columnar jointing and varies locally into its granophyric phase*".

Columnar jointing was noted at several locations thus far examined. From field observations, approximately 30% of the property is exposed rock, and where located, the copper (primarily chalcopyrite, chalcocite, and native copper), appears within narrow calcite veining. Assayed results have also, thus far, indicated a modest cobalt-nickel presence as well (*See Appendix D "Regional Geology Map"*).

Generally, localized topography conditions are commonly shared amongst the outcrops. Elevations on the property range from 350 metres to 411 metres above sea level. The said exposed outcrops are, for the most part, steeply sloped. On average, soils consist of an organic "A" horizon covering a shallow coarse gravel, and in some places, a yellowish sand.

The subject area is situated within a traditional Boreal Forest and Great Lakes St. Lawrence Forest transitional zone setting. Forest cover includes cedar, black spruce, black ash, and tamarack in the lower, wetter areas changing to a white spruce, white pine, jack pine, red pine, balsam fir, white birch, and red maple over the more elevated areas of the property. The subject property is drained by one creek along its northern boundary and by several intermittent creek/draw systems.

### **Work Program:**

#### *Rationale:*

The objective of the activities reported in this document was to further examine the untested diabase rock faces of the said historical trench in advance of setting actual drill target locations. A rudimentary effort to determine the viability of on-site concentration of the potential ore was also undertaken. A commercially viable deposit of copper, with recoverable gold and silver is the main objective pursued. As such, an effort to collect additional field information in advance of drilling was undertaken.

*Daily Log:*

On June 2<sup>nd</sup> and June 5<sup>th</sup> 2014 a total of 4 intermittent man-days were spent prospecting, sampling, and mapping additional faces within, and near, the studied historical trench system. Working as a 2 man team, the trench system was meticulously traversed and re-studied. Three new rock face locations found at the eastern extremity of the trench system were exposed by hand grubbing away a thick matt of moss, and three samples were chipped out from sulfide mineralization (mainly chalcocite) within the diabase host rock. An accumulative total of approximately 4.0 kilometres were traversed while on the property.

At Cochrane Ontario, on June 8<sup>th</sup> 2014, ½ man-day was expended compositing these three samples into one, panning out the lighter materials, and “roasting off” much of the sulphur component (*See Appendix E “Assessment Work Performed on Mining Lands” form*). The composited residual sample (WALL-01-14) was then submitted for assaying.

All work-sample locations were recorded in NAD 83 using a handheld GPS unit (Garmin Etrex 10 model). Routes traversed, and locations of the samples taken, are indicated on the enclosed work compilation plan (*See Appendix F “Work Compilation Plan”*). The assayed results of the composited sample are also provided (*See Appendix G “Assay Results & Receipts ”*).



*A portion of studied historic trench (2010 photo)*

### **Conclusions:**

The composited and crudely concentrated sample WALL-01-14, taken from newly exposed faces of diabase displaying mineralization has produced assayed values of 14.980% Cu, 75.5 ppm Ag, 144 ppm Ni, and 33 ppb Au. Approximately 150 metres of historical trenching have now been field examined several times since 2010. The rudimentary concentration efforts have raised the overall average Cu grade within the trench system from 8.69% to 11.84%. An increased averaged Ag grade, now approaching 3 ounces per tonne, was also realized within the eastern portion of the trench system.

### **Recommendations:**

Commercial values of copper have now been confirmed warranting a future drill program to define the actual deposit.

### **Author Qualifications:**

The author is an honour graduate of the Sault College of Applied Arts and Technology forestry program (1980, Sault Ste. Marie, Ontario), and is a long time employee with the Ministry of Natural Resources. Throughout the past 3 plus decades he has been exposed to numerous mining projects (Hemlo, Detour Lake, and Agrium). An avid reader of accredited material, the author is in the process of expanding his knowledge base in order to augment his prospecting efforts. Prospecting remains his life-long hobby.

### **Communications (Direct & Indirect):**

Peter Hermeston, fellow prospector, North Bay, Ontario.  
Michael Palangio, fellow prospector, Cochrane, Ontario.  
Mark Luchinski, Director Amador Gold Corp. Vancouver, B.C.  
Richard Hughes, President Amador Gold Corp. Vancouver, B.C.

### **References:**

OGS Report 5439 "Industrial Minerals of Northern Ontario-Supplement 2" (Vos and Smith) 1983, page 207, (re: Sergiades).

"Report on Geological and Geophysical Surveys-Cameron Silver & Cobalt Property" (Willars 1979).

**APPENDICES**



# Appendix "A" Location Map

Scale 1:250,000



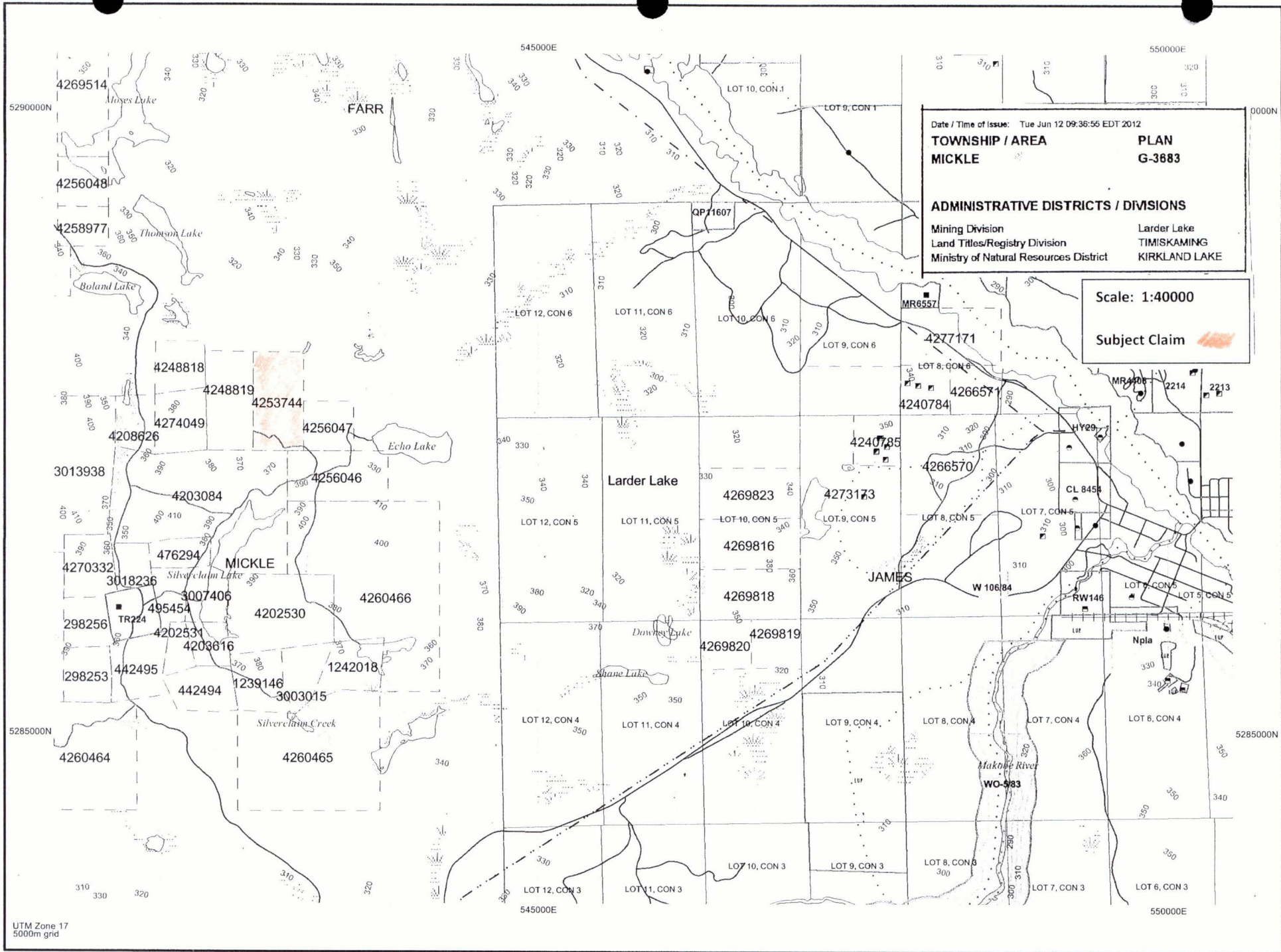

Date / Time of Issue: Tue Jun 12 09:36:55 EDT 2012  
**TOWNSHIP / AREA** PLAN  
**MICKLE** G-3683

**ADMINISTRATIVE DISTRICTS / DIVISIONS**  
 Mining Division Larder Lake  
 Land Titles/Registry Division TIMISKAMING  
 Ministry of Natural Resources District KIRKLAND LAKE

Scale: 1:40000  
 Subject Claim



## Ministry of Northern Development and Mines

- [Home](#)
- [Mines and Minerals](#)
- [Northern Development](#)
- [News](#)
- [Site Map](#)
- [Contact Us](#)

### Mining Claim Abstract

| [Main Menu](#) | [Back](#) |

LARDER LAKE - Division 80		Claim No: L 4253744		Status: ACTIVE
<b>Due Date:</b>	2015-Aug-16	<b>Recorded:</b>	2010-Aug-16	
<b>Work Required:</b>	\$ 800	<b>Staked:</b>	2010-Aug-11 16:22	
<b>Total Work:</b>	\$ 2,400	<b>Township/Area:</b>	MICKLE (G-3683)	
<b>Total Reserve:</b>	<u>\$ 332</u>	<b>Lot Description:</b>		
<b>Present Work Assignment:</b>	\$ 1,200	<b>Claim Units:</b>	2	
<b>Claim Bank:</b>	\$ 0			

### Claim Holders

Recorded Holder(s) Percentage	Client Number
AMADOR GOLD CORP ( 100.00 %)	402170

### Transaction Listing

Type	Date	Applied	Description	Performed	Number
STAKER	2010-Aug-16		RECORDED BY SHYNKORENKO, EDWARD (M25405)		R1080.02883
OTHER	2011-Mar-04		WORK PERFORMED (ASSAY, PROSP) APPROVED: 2011-MAR-15	\$ 873	<u>Q1180.00550</u>
OTHER	2011-Mar-04		WORK PERFORMED (PROSP) APPROVED: 2011-MAR-15	\$ 120	<u>Q1180.00552</u>
WORK	2011-Mar-04	\$ 800	WORK APPLIED (ASSAY, PROSP) APPROVED: 2011-MAR-15		<u>W1180.00550</u>
OTHER	2011-Oct-19		WORK PERFORMED (PROSP) APPROVED: 2011-NOV-04	\$ 2,139	<u>Q1180.02320</u>

WORK 2011-Oct-19 \$ 800

WORK APPLIED (PROSP) APPROVED: 2011-NOV-04

W1180.02320

TRAN 2014-Mar-05

SHYNKORENKO, EDWARD (194158) TRANSFERS  
100.0 % TO AMADOR GOLD CORP (402170)

T1480.00072

WORK 2014-Jun-03 \$ 800

WORK APPLIED ASSAY, PROSP APPROVED: 2014-  
JUN-12

W1480.01300

### Claim Reservations

---

- 01 400' surface rights reservation around all lakes and rivers
- 02 Sand and gravel reserved
- 03 Peat reserved
- 04 Other reservations under the Mining Act may apply
- 05 Including land under water
- 06 Excluding road

- [Home](#)
- [Mines and Minerals](#)
- [Northern Development](#)
- [News](#)
- [Site Map](#)
- [Contact Us](#)



This site is maintained by the Government of Ontario, Canada.

- [Accessibility](#)
- [Privacy](#)
- [Important Notices](#)

Copyright information: © [Queen's Printer for Ontario, 2008](#)



# Ministry of Northern Development and Mines

- [Home](#)
- [Mines and Minerals](#)
- [Northern Development](#)
- [News](#)
- [Site Map](#)
- [Contact Us](#)

## Mining Claim Abstract

| [Main Menu](#) | [Back](#) |

LARDER LAKE - Division 80		Claim No: L 4256046		Status: ACTIVE
<b>Due Date:</b>	2015-Sep-21	<b>Recorded:</b>	2010-Sep-21	
<b>Work Required:</b>	\$ 800	<b>Staked:</b>	2010-Sep-19 13:15	
<b>Total Work:</b>	\$ 2,400	<b>Township/Area:</b>	MICKLE (G-3683)	
<b>Total Reserve:</b>	<u>\$ 0</u>	<b>Lot Description:</b>		
<b>Present Work Assignment:</b>	\$ 0	<b>Claim Units:</b>	2	
<b>Claim Bank:</b>	\$ 0			

## Claim Holders

Recorded Holder(s) Percentage	Client Number
AMADOR GOLD CORP ( 100.00 %)	402170

## Transaction Listing

Type	Date	Applied	Description	Performed Number
STAKER	2010-Sep-21		RECORDED BY SHYNKORENKO, EDWARD (M25405)	R1080.03126
OTHER	2011-Mar-04		WORK PERFORMED (ASSAY, PROSP) APPROVED: \$ 800 2011-MAR-15	<u>Q1180.00550</u>
WORK	2011-Mar-04	\$ 800	WORK APPLIED (ASSAY, PROSP) APPROVED: 2011-MAR-15	<u>W1180.00550</u>
WORK	2011-Oct-19	\$ 800	WORK APPLIED (PROSP) APPROVED: 2011-NOV-04	<u>W1180.02320</u>
TRAN	2014-Mar-05		SHYNKORENKO, EDWARD (194158) TRANSFERS 100.0 % TO AMADOR GOLD CORP (402170)	T1480.00072

## Claim Reservations

---

- 01 400' surface rights reservation around all lakes and rivers
  - 02 Sand and gravel reserved
  - 03 Peat reserved
  - 04 Other reservations under the Mining Act may apply
  - 05 Including land under water
  - 06 Excluding road
- 

- [Home](#)
- [Mines and Minerals](#)
- [Northern Development](#)
- [News](#)
- [Site Map](#)
- [Contact Us](#)



This site is maintained by the Government of Ontario, Canada.

- [Accessibility](#)
- [Privacy](#)
- [Important Notices](#)

Copyright information: © [Queen's Printer for Ontario, 2008](#)



Ministry of Northern  
Development and Mines

- [Home](#)
- [Mines and Minerals](#)
- [Northern Development](#)
- [News](#)
- [Site Map](#)
- [Contact Us](#)

### Mining Claim Abstract

| [Main Menu](#) | [Back](#) |

LARDER LAKE - Division 80		Claim No: L 4256047		Status: ACTIVE
<b>Due Date:</b>	2015-Sep-21	<b>Recorded:</b>	2010-Sep-21	
<b>Work Required:</b>	\$ 400	<b>Staked:</b>	2010-Sep-19 17:10	
<b>Total Work:</b>	\$ 1,200	<b>Township/Area:</b>	MICKLE (G-3683)	
<b>Total Reserve:</b>	<u>\$ 346</u>	<b>Lot Description:</b>		
<b>Present Work Assignment:</b>	\$ 1,600	<b>Claim Units:</b>	1	
<b>Claim Bank:</b>	\$ 0			

### Claim Holders

Recorded Holder(s) Percentage	Client Number
AMADOR GOLD CORP ( 100.00 %)	402170

### Transaction Listing

Type	Date	Applied	Description	Performed Number
STAKER	2010-Sep-21		RECORDED BY SHYNKORENKO, EDWARD (M25405)	R1080.03126
OTHER	2011-Mar-04		WORK PERFORMED (ASSAY, PROSP) APPROVED: 2011-MAR-15	<u>Q1180.00550</u>
WORK	2011-Mar-04	\$ 400	WORK APPLIED (ASSAY, PROSP) APPROVED: 2011-MAR-15	<u>W1180.00550</u>
WORK	2011-Oct-19	\$ 400	WORK APPLIED (PROSP) APPROVED: 2011-NOV-04	<u>W1180.02320</u>
WORK	2013-Sep-06	\$ 400	WORK APPLIED ASSAY, PROSP APPROVED: 2013-NOV-01	<u>W1380.02161</u>

TRAN	2014-Mar-05	SHYNKORENKO, EDWARD (194158) TRANSFERS 100.0 % TO AMADOR GOLD CORP (402170)	T1480.00072
OTHER	2014-Jun-03	WORK PERFORMED ASSAY, PROSP APPROVED: 2014-JUN-12	\$ 1,946 <u>Q1480.01300</u>

## Claim Reservations

---

- 01 400' surface rights reservation around all lakes and rivers
  - 02 Sand and gravel reserved
  - 03 Peat reserved
  - 04 Other reservations under the Mining Act may apply
  - 06 Excluding road
- 

- [Home](#)
- [Mines and Minerals](#)
- [Northern Development](#)
- [News](#)
- [Site Map](#)
- [Contact Us](#)



This site is maintained by the Government of Ontario, Canada.

- [Accessibility](#)
- [Privacy](#)
- [Important Notices](#)

Copyright information: © [Queen's Printer for Ontario, 2008](#)





# Ministry of Northern Development and Mines

- [Home](#)
- [Mines and Minerals](#)
- [Northern Development](#)
- [News](#)
- [Site Map](#)
- [Contact Us](#)

## Mining Claim Abstract

| [Main Menu](#) | [Back](#) |

LARDER LAKE - Division 80		Claim No: L 4248819		Status: ACTIVE	
<b>Due Date:</b>	2017-Apr-19	<b>Recorded:</b>	2010-Apr-19		
<b>Work Required:</b>	\$ 800	<b>Staked:</b>	2010-Apr-17 16:15		
<b>Total Work:</b>	\$ 4,000	<b>Township/Area:</b>	MICKLE (G-3683)		
<b>Total Reserve:</b>	<u>\$ 811</u>	<b>Lot Description:</b>			
<b>Present Work Assignment:</b>	\$ 400	<b>Claim Units:</b>	2		
<b>Claim Bank:</b>	\$ 0				

## Claim Holders

Recorded Holder(s) Percentage	Client Number
AMADOR GOLD CORP ( 100.00 %)	402170

## Transaction Listing

Type	Date	Applied	Description	Performed	Number
STAKER	2010-Apr-19		RECORDED BY HERMESTON, PETER M (1003623)		R1080.01158
TRAN	2010-Jun-16		HERMESTON, PETER M (403428) TRANSFERS 50.00 % TO SHYNKORENKO, EDWARD (194158)		T1080.00267
OTHER	2011-Mar-04		WORK PERFORMED (ASSAY, PROSP) APPROVED: \$ 800 2011-MAR-15		<u>Q1180.00550</u>
OTHER	2011-Mar-04		WORK PERFORMED (PROSP) APPROVED: 2011-MAR-15 \$ 120		<u>Q1180.00552</u>
WORK	2011-Mar-04	\$ 800	WORK APPLIED (ASSAY, PROSP) APPROVED: 2011-MAR-15		<u>W1180.00550</u>

OTHER	2011-Oct-19		WORK PERFORMED (PROSP) APPROVED: 2011-NOV-04	\$ 1,600	<u>Q1180.02320</u>
WORK	2011-Oct-19	\$ 800	WORK APPLIED (PROSP) APPROVED: 2011-NOV-04		<u>W1180.02320</u>
OTHER	2013-Nov-20		WORK PERFORMED ASSAY, PROSP APPROVED: 2014-JAN-10	\$ 1,891	<u>Q1380.02829</u>
WORK	2013-Nov-20	\$ 1,600	WORK APPLIED ASSAY, PROSP APPROVED: 2014-JAN-10		<u>W1380.02829</u>
TRAN	2014-Apr-03		HERMESTON, PETER M (403428) TRANSFERS 50.0 % TO AMADOR GOLD CORP (402170)		T1480.00085
TRAN	2014-Apr-03		SHYNKORENKO, EDWARD (194158) TRANSFERS 50.0 % TO AMADOR GOLD CORP (402170)		T1480.00086
OTHER	2014-Jun-20		WORK PERFORMED GPSG APPROVED: 2014-JUN-23	\$ 800	<u>Q1480.01353</u>
WORK	2014-Jun-20	\$ 800	WORK APPLIED GPSG APPROVED: 2014-JUN-23		<u>W1480.01353</u>

## Claim Reservations

- 
- 01 400' surface rights reservation around all lakes and rivers
  - 02 Sand and gravel reserved
  - 03 Peat reserved
  - 04 Other reservations under the Mining Act may apply
  - 05 Including land under water

- [Home](#)
- [Mines and Minerals](#)
- [Northern Development](#)
- [News](#)
- [Site Map](#)
- [Contact Us](#)



This site is maintained by the Government of Ontario, Canada.

- [Accessibility](#)
- [Privacy](#)
- [Important Notices](#)

Copyright information: © [Queen's Printer for Ontario, 2008](#)



# Ministry of Northern Development and Mines

- [Home](#)
- [Mines and Minerals](#)
- [Northern Development](#)
- [News](#)
- [Site Map](#)
- [Contact Us](#)

## Mining Claim Abstract

| [Main Menu](#) | [Back](#) |

LARDER LAKE - Division 80		Claim No: L 4248818		Status: ACTIVE
<b>Due Date:</b>	2017-Apr-19	<b>Recorded:</b>	2010-Apr-19	
<b>Work Required:</b>	\$ 400	<b>Staked:</b>	2010-Apr-05 15:30	
<b>Total Work:</b>	\$ 2,000	<b>Township/Area:</b>	MICKLE (G-3683)	
<b>Total Reserve:</b>	<u>\$ 38</u>	<b>Lot Description:</b>		
<b>Present Work Assignment:</b>	\$ 400	<b>Claim Units:</b>	1	
<b>Claim Bank:</b>	\$ 0			

## Claim Holders

Recorded Holder(s) Percentage	Client Number
AMADOR GOLD CORP ( 100.00 %)	402170

## Transaction Listing

Type	Date	Applied	Description	Performed Number
STAKER	2010-Apr-19		RECORDED BY HERMESTON, PETER M (1003623)	R1080.01158
TRAN	2010-Jun-16		HERMESTON, PETER M (403428) TRANSFERS 50.00 % TO SHYNKORENKO, EDWARD (194158)	T1080.00267
OTHER	2011-Mar-04		WORK PERFORMED (ASSAY, PROSP) APPROVED: \$ 400 2011-MAR-15	<u>Q1180.00550</u>
WORK	2011-Mar-04	\$ 400	WORK APPLIED (ASSAY, PROSP) APPROVED: 2011-MAR-15	<u>W1180.00550</u>
WORK	2011-Oct-19	\$ 400	WORK APPLIED (PROSP) APPROVED: 2011-NOV-04	<u>W1180.02320</u>
OTHER	2013-Sep-06		WORK PERFORMED ASSAY, PROSP APPROVED: \$ 1,638	<u>Q1380.02161</u>

			2013-NOV-01	
WORK	2013-Sep-06	\$ 1,200	WORK APPLIEDASSAY, PROSP APPROVED: 2013-NOV-01	<u>W1380.02161</u>
TRAN	2014-Apr-03		HERMESTON, PETER M (403428) TRANSFERS 50.0 % TO AMADOR GOLD CORP (402170)	T1480.00085
TRAN	2014-Apr-03		SHYNKORENKO, EDWARD (194158) TRANSFERS 50.0 % TO AMADOR GOLD CORP (402170)	T1480.00086

## Claim Reservations

---

- 01 400' surface rights reservation around all lakes and rivers
- 02 Sand and gravel reserved
- 03 Peat reserved
- 04 Other reservations under the Mining Act may apply

- [Home](#)
- [Mines and Minerals](#)
- [Northern Development](#)
- [News](#)
- [Site Map](#)
- [Contact Us](#)



This site is maintained by the Government of Ontario, Canada.

- [Accessibility](#)
- [Privacy](#)
- [Important Notices](#)

Copyright information: © [Queen's Printer for Ontario, 2008](#)

**Subject claim worked**

L-4253744

**Contiguous claims**

L-4248818

L-4248819

L-4256046

L-4256047

**Claims to which work credits are also to be applied**

L-4248818

L-4256046

L-4256047

**APPENDIX C**  
**“Access/Key Map”**  
**Scale: 1:40000**

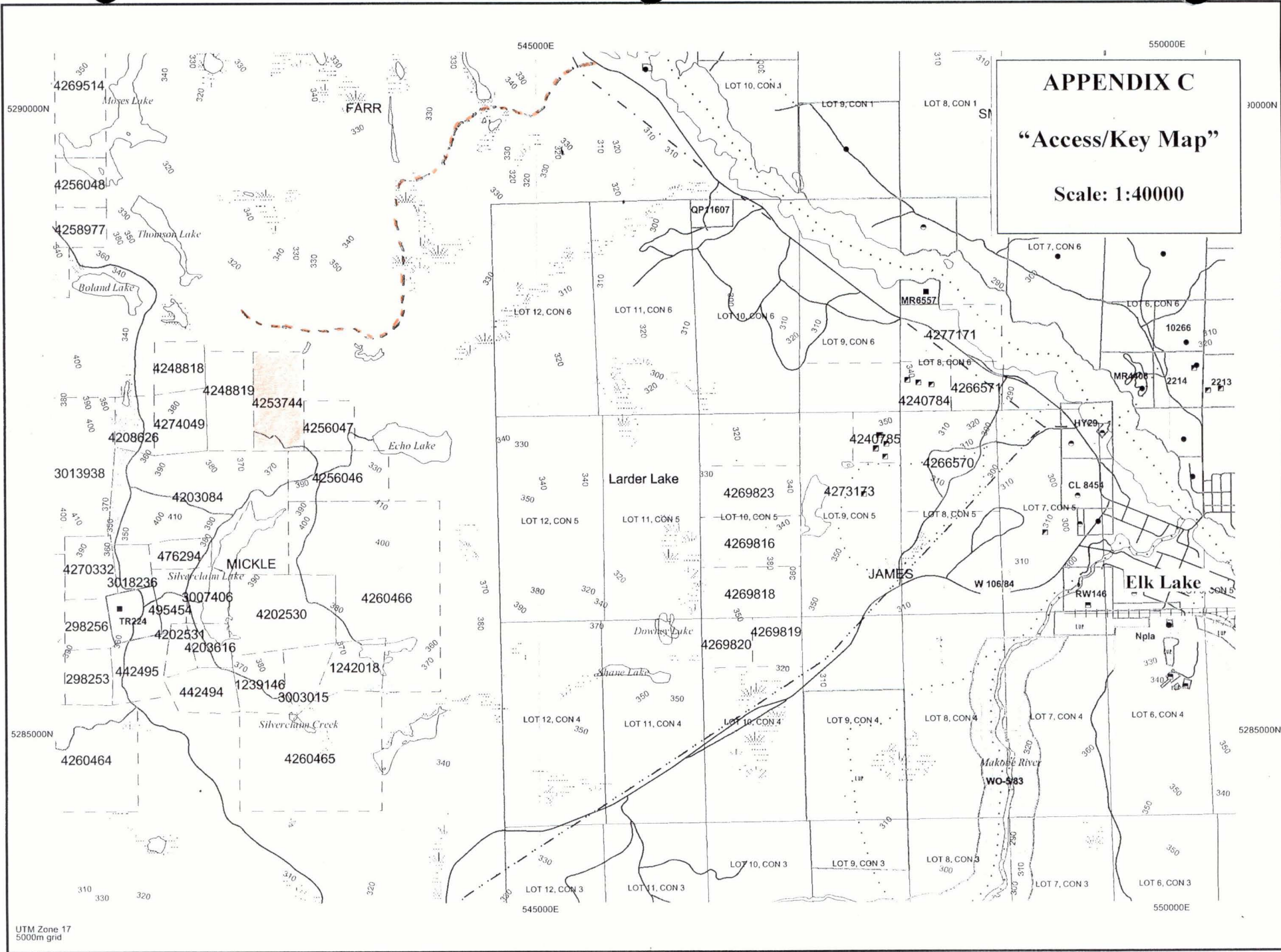

# APPENDIX D

## GENERAL-REGIONAL GEOLOGY

Legend

- Phanerozoic (Bordenland's) Rocks
- Proterozoic (Southern Province) Rocks
- Alkaline intrusive rocks
- Gneisses and migmatites
- Sudbury intrusive Complex
- Whitewater Group Sediments
- Mafic intrusives (dikes and sills)
- Keeweenaw mafic volcanic and associated sedimentary rocks
- Cobalt Group sedimentary rocks
- Ultramafic to mafic intrusive rocks
- Archean (Superior Province) Rocks
- Sedimentary rocks, some highly metamorphosed
- Intermediate to felsic volcanic rocks
- Mafic to intermediate volcanic rocks
- Felsic intrusive rocks and gneisses

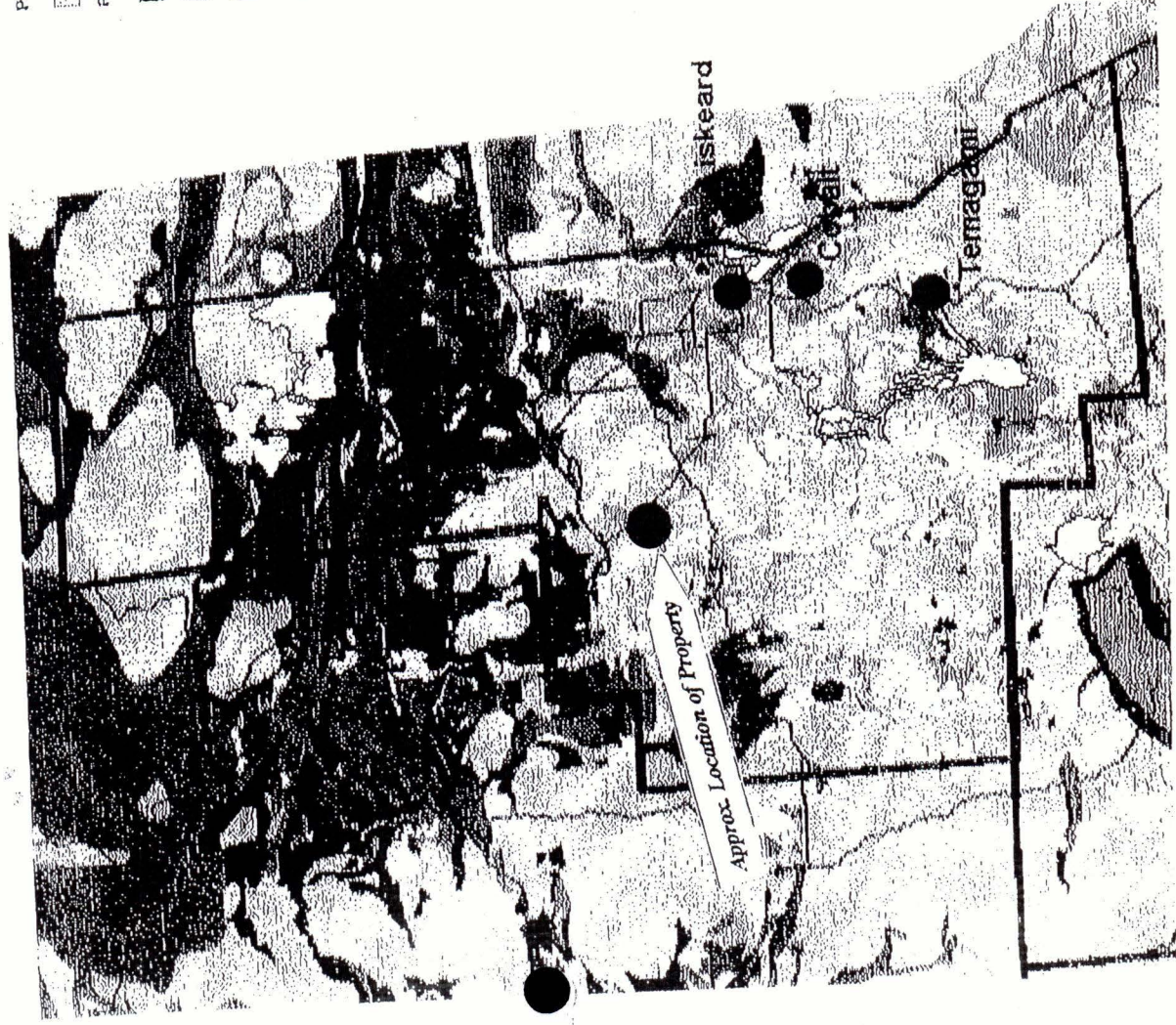



Ministry of  
Northern Development,  
Mines and Forestry

**Assessment Work  
Performed on Mining Lands**  
Mining Act, Subsections 65(2)  
and 66(3), R.S.O. 1990

Folder Identification Number (office use)
Transaction Number (office use) W -
Submission Number (office use) 2.

Personal information collected on this form is obtained under the authority of subsections 65(2) and 66(3) of the Mining Act. Under section 7 of the Mining Act, this information is used to maintain a public record. This information will be also used to review the assessment work and correspond with the mining land holder. Questions about this collection should be directed to the Senior Manager, Mining Lands Section, Ministry of Northern Development and Mines, 3rd Floor, 933 Ramsey Lake Road, Sudbury ON P3E 6B5. Telephone 1 888 415-9845.

- Instructions:
- For work performed on Crown Lands before recording a claim, use form Assessment Work Performed Before Recording Claim(s)
  - Please type or print in ink
  - Submit to Geoscience Assessment Office, 933 Ramsey Lake Road, Sudbury ON P3E 6B5. Telephone 1 888 415-9845

Note: All correspondence will be sent to the address on record in the Provincial Recording Office, as required under the Mining Act, subsections 19(6) and (8).

**Section 1. Submitter**

I am  an authorized agent  the recorded holder (if a company, enter name of person submitting)

Last Name: SHYMKORENIKO First Name: EDWARD Middle Initial: -

Address: Unit No.  Street No. P.O. Box 1715 Street Name  Client No. (optional) 194158

City, Town or Village: COCHRANE Province or State: ONTARIO Country: CANADA Postal Code: P0L-1C0

Telephone No.: (705) 272-3998 Fax No.: (705) 272-8454 Email Address (optional): MAGGIE4@PUC.NET

**Section 2. Provide**

- proof of beneficial interest (if assigning amongst different recorded holders)
- a current legible map showing how the contiguous mining lands are linked for assigning work
- your technical report and maps in paper or on a compact disc
- where there is a surface rights holder, before starting ground exploration work for the first time on a staked claim you must provide notice to the surface rights holder(s) as required by the Mining Act and provide proof of notification to the Ministry

**Section 3. Work Performed** This includes the date you traveled to the field or mobilized equipment to the date the technical report was completed.

From: YYYY/MM/DD (enter the month in full in this box e.g. 2008/July/12) To: YYYY/MM/DD (enter the month in full in this box e.g. 2008/July/12)

2014 / JUNE / 02 2014 / DECEMBER / 07

Regulations: Calculate the time-adjusted credit column, in the tables below, as follows:

- Work filed within 2 years of performance is claimed at 100%. (Enter 100% of actual costs in both of the last 2 columns).
- Work filed after 2 years and up to 5 years after performance is credited at 50%. (Enter 100% of actual costs in the 2nd last column and 50% in the last column.)
- Work older than 5 years is not eligible for credit.

**3(A) Dates and Costs of Work Performed**

From date YYYY/MM/DD	To date YYYY/MM/DD	Work Type	Unit of Work (example: hours/ day, metres of drilling, km of grid lines)	Cost per Unit of Work	Actual Costs (\$)	Time-Adjusted Credit (\$) (See notes 1 and 2 above)
<u>2014/06/02</u>	<u>2014/06/02</u>	<u>PROSPECTING</u>	<u>2 MANHOURS</u>	<u>\$240/NO</u>	<u>\$480.00</u>	<u>\$480.00</u>
<u>2014/06/05</u>	<u>2014/06/05</u>	<u>PROSPECTING</u>	<u>2 MANHOURS</u>	<u>\$240/NO</u>	<u>480.00</u>	<u>480.00</u>
<u>2014/06/08</u>	<u>2014/06/08</u>	<u>SAMPLING PREP</u>	<u>1/2 MANHOURS</u>	<u>\$240/NO</u>	<u>\$120.00</u>	<u>\$120.00</u>
<u>2014/12/02</u>	<u>2014/12/07</u>	<u>REPORT PREP</u>	<u>4.5 MANHOURS</u>	<u>\$240/NO</u>	<u>\$1090.00</u>	<u>\$1090.00</u>

**3(B) Associated Costs**

From date YYYY/MM/DD	To date YYYY/MM/DD	Associated Costs (example: supplies, mobilization, demobilization)	Actual Costs (\$)	Time-Adjusted Credit (\$) (See notes 1 and 2 above)
<u>2014/06/10</u>	<u>2014/06/10</u>	<u>MAIL OUT OF SAMPLE</u>	<u>\$10.93</u>	<u>\$10.93</u>
<u>2014/06/10</u>	<u>2014/06/25</u>	<u>ASSAYS FROM MAIL OUT TO RESULTS REC'D.</u>	<u>\$59.33</u>	<u>\$59.33</u>
<u>2014/06/02</u>	<u>2014/06/05</u>	<u>FIELD SUPPLIES TAPES, BATTERIES</u>	<u>\$10.00</u>	<u>\$10.00</u>

**3(C) Transportation Costs**



From date YYYY/MM/DD	To date YYYY/MM/DD	Transportation Costs	Actual Costs (\$)	Time-Adjusted Credit (\$) (See notes 1 and 2 above)
2014/06/02	2014/06/02	COCHRANE TO CLAIM + RTN. 458 KMS X 0.40 =	\$ 183.20	\$ 183.20
2014/06/02	2014/06/02	NORTH 1394 TO CLAIM + RTN 460 KMS X 0.40 =	\$ 184.00	\$ 184.00
2014/06/05	2014/06/05	COCHRANE TO CLAIM + RTN. 458 KMS X 0.40 =	\$ 183.20	\$ 183.20
2014/06/05	2014/06/05	NORTH 1394 TO CLAIM + RTN 460 KMS X 0.40 =	\$ 184.00	\$ 184.00

3(D) Food and Lodging Costs

From date YYYY/MM/DD	To date YYYY/MM/DD	Food and Lodging Costs	Actual Costs (\$)	Time-Adjusted Credit (\$) (See notes 1 and 2 above)
2014/06/02	2014/06/05	4/- BUS MEALS + WATER.	\$ 40.00	\$ 40.00

Total of Time Adjusted Credit Columns (3A through 3D) = Total Value of Assessment Work \$ 3014.00

Section 4. Type of Work Performed – please check off the type of survey performed (optional)

Work Type	Survey Type
Airborne geophysical	<input type="checkbox"/> AEM <input type="checkbox"/> AMAG <input type="checkbox"/> AVLF <input type="checkbox"/> other airborne geophysical
Assays	<input checked="" type="checkbox"/> assays <input type="checkbox"/> beneficiation <input type="checkbox"/> geochemical
Drilling	<input type="checkbox"/> diamond drilling <input type="checkbox"/> drill core submission to MNDM <input type="checkbox"/> overburden drilling <input type="checkbox"/> boring other than core
Line cutting	<input type="checkbox"/> line cutting
Geochemical	<input type="checkbox"/> geochemical
Geological	<input type="checkbox"/> geological
Geophysical	<input type="checkbox"/> EM <input type="checkbox"/> VLF <input type="checkbox"/> GRA <input type="checkbox"/> other geophysical <input type="checkbox"/> V IP <input type="checkbox"/> MAG
Physical	<input type="checkbox"/> manual work <input type="checkbox"/> trenching <input type="checkbox"/> mechanical work <input type="checkbox"/> other physical <input type="checkbox"/> overburden stripping <input type="checkbox"/> re-cutting claim lines
Prospecting	<input checked="" type="checkbox"/> prospecting
Rehabilitation	<input type="checkbox"/> rehabilitation
Ground Truthing	<input type="checkbox"/> attach a report as described in the <b>Georeferencing Standards for Unpatented Mining Claims</b>
Aboriginal Consultation	<input type="checkbox"/> please complete and submit the form 0318E <b>Aboriginal Consultations Cost Report</b>
Other	Please print (examples: microscopic studies, bulk sampling, down hole geophysics)

Section 5. Commodities Explored for - please list (optional)

CU, AG, AU, NI

Section 6. Work Performed, Assigned, Banked

6(A) If you performed work on mining lands other than a staked mining claim, fill in the table below. Lease or Patented Land or Licence of Occupation (LO) or Other Mining Lands: Work performed, assigned or banked

Lease No. or Parcel No. or G No. or LO No.	GAO-Approved Identifier (office use only)	Hectares	Exploration Plan or Exploration Permit Number (where applicable)*	Amount of Work Performed on this Land (\$)	Amount of Credits Assigned to Mining Claim(s) (\$)	Bank (Amount of credits to be assigned at a future date)

Lease No. or Parcel No. or G No. or LO No.	GAO-Approved Identifier (office use only)	Hectares	Exploration Plan or Exploration Permit Number (where applicable)*	Amount of Work Performed on this Land (\$)	Amount of Credits Assigned to Mining Claim(s) (\$)	Bank (Amount of credits to be assigned at a future date)
Column Totals for 6(A)				—	—	—

Schedule attached (if you have more entries attach a schedule)

\*Enter 'N/A' for work for which an exploration plan or exploration permit is not required.

**6(B) Mining Claims: Work performed, applied, assigned, banked or assigned from table 6(A) above**

Mining Claim Number	Number of Claim Units	Exploration Plan or Exploration Permit Number (where applicable)*	Amount of Work Performed on this Claim (\$)	Amount of Credits Applied to this Claim (\$)	Amount of Credits Assigned to Other Mining Claims (\$)	Bank (Amount of credits to be applied or assigned at a future date)
L-4253744	2	N/A	\$ 3014.66	\$ 800.00	\$ 2000.00	\$ 214.66
L-4256046	2	N/A	\$ 0.00	\$ 800.00	\$ 0.00	\$ 0.00
L-4256047	1	N/A	\$ 0.00	\$ 800.00	\$ 0.00	\$ 0.00
L-4248818	1	N/A	\$ 0.00	\$ 400.00	\$ 0.00	\$ 0.00
Column Total for 6(B)			\$ 3014.66	\$ 2800.00	\$ 2000.00	\$ 214.66
Column Totals of 6(A) + 6(B)			\$ 3014.66		\$ 2000.00	\$ 214.66

Note: Work performed on mining claims = credits applied + credits banked

\*Enter 'N/A' for work for which an exploration plan or exploration permit is not required.

Schedule attached (if you have more entries attach a schedule)

**Section 7.**

Some of the credits claimed in this Assessment Work form may be reduced. Please indicate below how you want your credits reduced if they are not approved. Check (☑) in the boxes below. If you have not indicated how your remaining credits are to be allocated, credits will be reduced from the Bank first, followed by option number 2 if necessary. Credits are to be cutback:

- 1. Credits are to be cut back from the Bank first, followed by option 2 or 3 or 4 as indicated; or
- 2. Credits are to be cut back starting with the claims listed last, working backwards; or
- 3. Credits are to be cut back equally over all claims listed in this Assessment Work form; or
- 4. Credits are to be cut back as shown below:

List the claim numbers in the order you want the credits to be cut back (setting your priority list).

Priority	Claim Number	Priority	Claim Number
1.	L-4248818	6.	
2.	L-4256047	7.	
3.	L-4256046	8.	
4.	L-4253744	9.	
5.		10.	

Schedule attached (if you have more entries attach a schedule)

**Section 8. Certification by Recorded Holder or Authorized Agent**

I, ES VOL. AGENT do hereby certify on 2017/12/07 that I have personal knowledge  
 Signature yyyy/mm/dd

of the facts set forth in this Assessment Work form having caused the work to be performed or witnessed the same during or after its completion and, to the best of my knowledge, the annexed report is true.

**Subject claim worked**

L-4253744

**Contiguous claims**

L-4248818

L-4248819

L-4256046

L-4256047

**Claims to which work credits are also to be applied**

L-4248818

L-4256046

L-4256047

Map for Distribution  
of  
Assessment Work Credits

Mickle Township,  
Larder Lake Mining Division

Scale: 1:40000

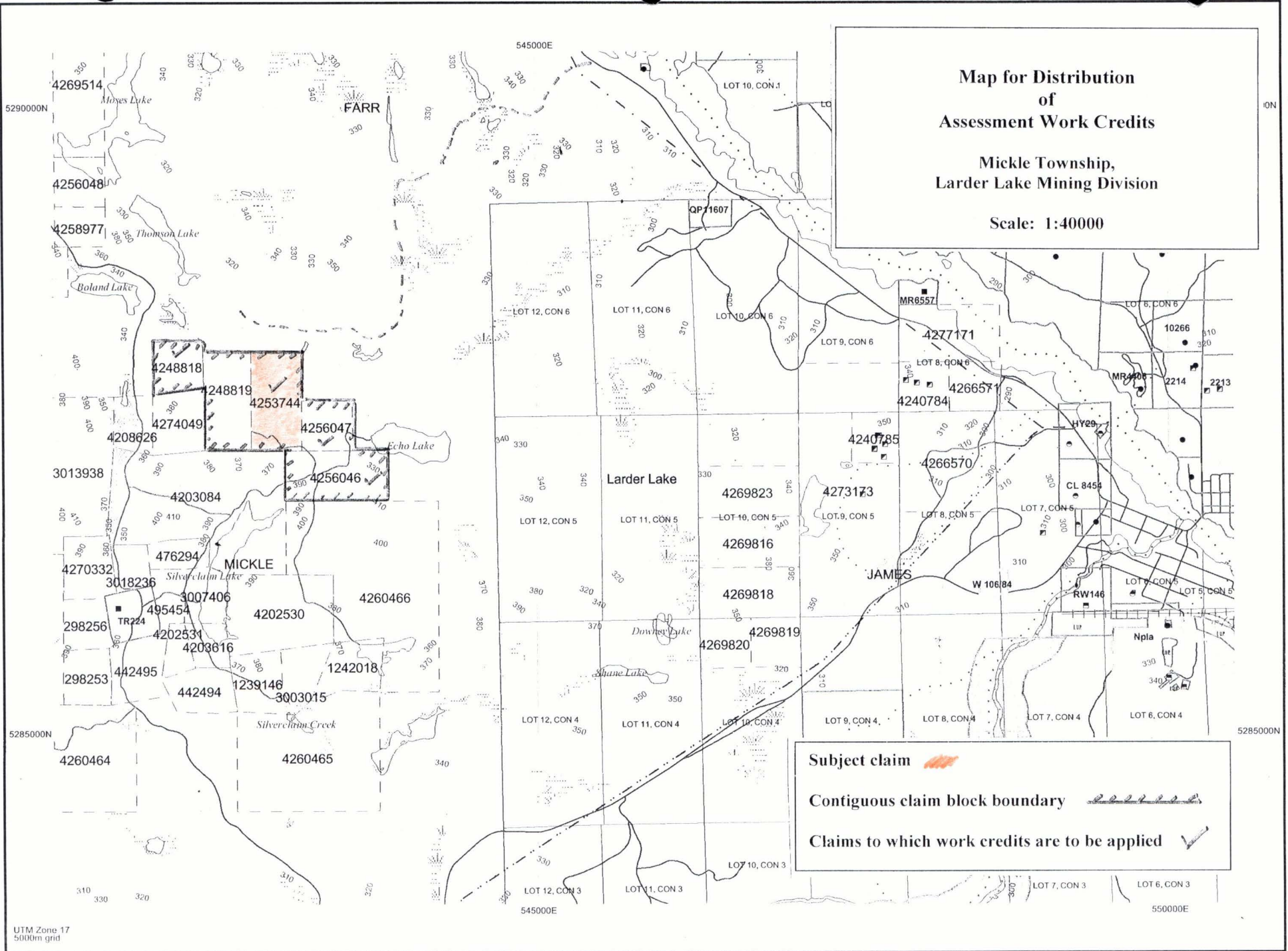

Subject claim 

Contiguous claim block boundary 

Claims to which work credits are to be applied 

UTM Zone 17  
5000m grid

Canada Post / Postes Canada  
COCHRANE  
146 6th Ave  
COCHRANE POL1C0  
GST/TPS#: 119321495

*MANOUT  
WALL-01-14  
S.KOPPE*

2014/06/10 10:40:07 ELAINE  
CC/CC450588 W/G1 TR1380256

TRANSACTION RECORD/RELEVÉ DE TRANSACTION

Purchase  
Achat  
Total \$10.93CAD

OO APPROVED-THANK YOU  
OO APPROUVÉ-MERCI

Card #/N° de carte \*\*\*\*\*8136 C  
Account Chequing  
Compte Chèque  
14/06/10/10:39:49 Debit/Débit  
Merchant ID#/N° du commerçant 20446294  
A0000002771010 Interac  
TCC 124  
Term Id/N° du terminal CPH045058801  
Invoice/N° de facture 138025601  
Auth #/Numéro d'autorisation 15DB98  
RRN/NRR 001001937

Retain this copy for your records.  
Conservez cette copie pour vos dossiers

Customer Copy/Copie du client

Swastika Laboratories Ltd

Box 10, 1 Cameron Ave  
Swastika, ON  
P0K 1T0

# Invoice

Date	Invoice #
6/25/2014	13502

Invoice To
ED SHYNKORENKO P.O. BOX 1715 COCHRANE, ON P0L 1C0

P.O. No.	Terms
	Due on receipt

Qty	Description	Cert #	Rate	Amount
	ATTENTION: ED SHYNKORENKO			
2	WHOLE ROCK <i>STEELE TWP.</i>	A14-03859	40.00	80.00
2	INAA	SL #14-456	25.00	50.00
2	ICP/MS		24.00	48.00
2	SAMPLE PREPARATION -		8.00	16.00
1	GOLD ASSAY	14-486	14.50	14.50
1	SILVER		10.00	10.00
1	NICKEL <i>MIDDLE TWP.</i>		10.00	10.00
1	COPPER		10.00	10.00
1	SAMPLE PREPARATION		8.00	8.00
	HST (ON) on sales		13.00%	32.05
			<i>52.50</i>	
			<i>6.83 HST</i>	
			<i>59.33</i>	
Thank you for your business.			<b>HST Tax Total</b>	\$32.05
			<b>Total</b>	\$278.55

*WALL-OI-14*

*paid by credit card June 25/14*

# APPENDIX "F"

## "Work Compilation Plan"

Claim L-4253744

Mickle Township (G-3683)  
Larder Lake Mining Division

Scale 1:1500

NAD 83

L-4253744

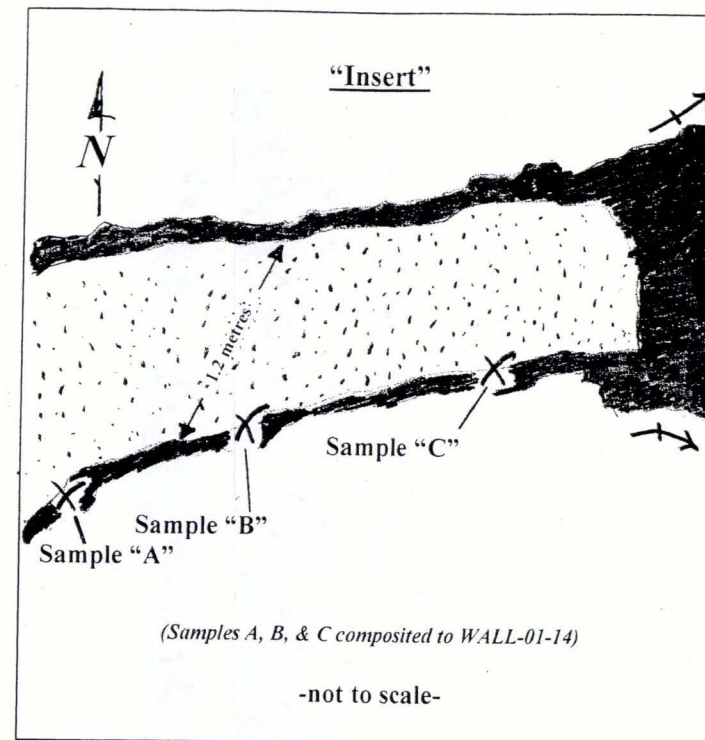

### LEGEND

- Claim Post & Line
- Date/Line of Traverse June 2/14
- Outcrop
- Slope greater than 30 deg.
- Trench
- Shaft
- Sample Location
- Swamp

Tag Number	Coord. NAD 83
WALL-01-14	(A) 543129E x 5287361N (B) 543129E x 5287361N (C) 543130E x 5287362N

Note: WALL-01-14 is composited/concentrated from rock samples (A), (B) & (C)

Prepared by: E. Shynkorenko Dec. 2014

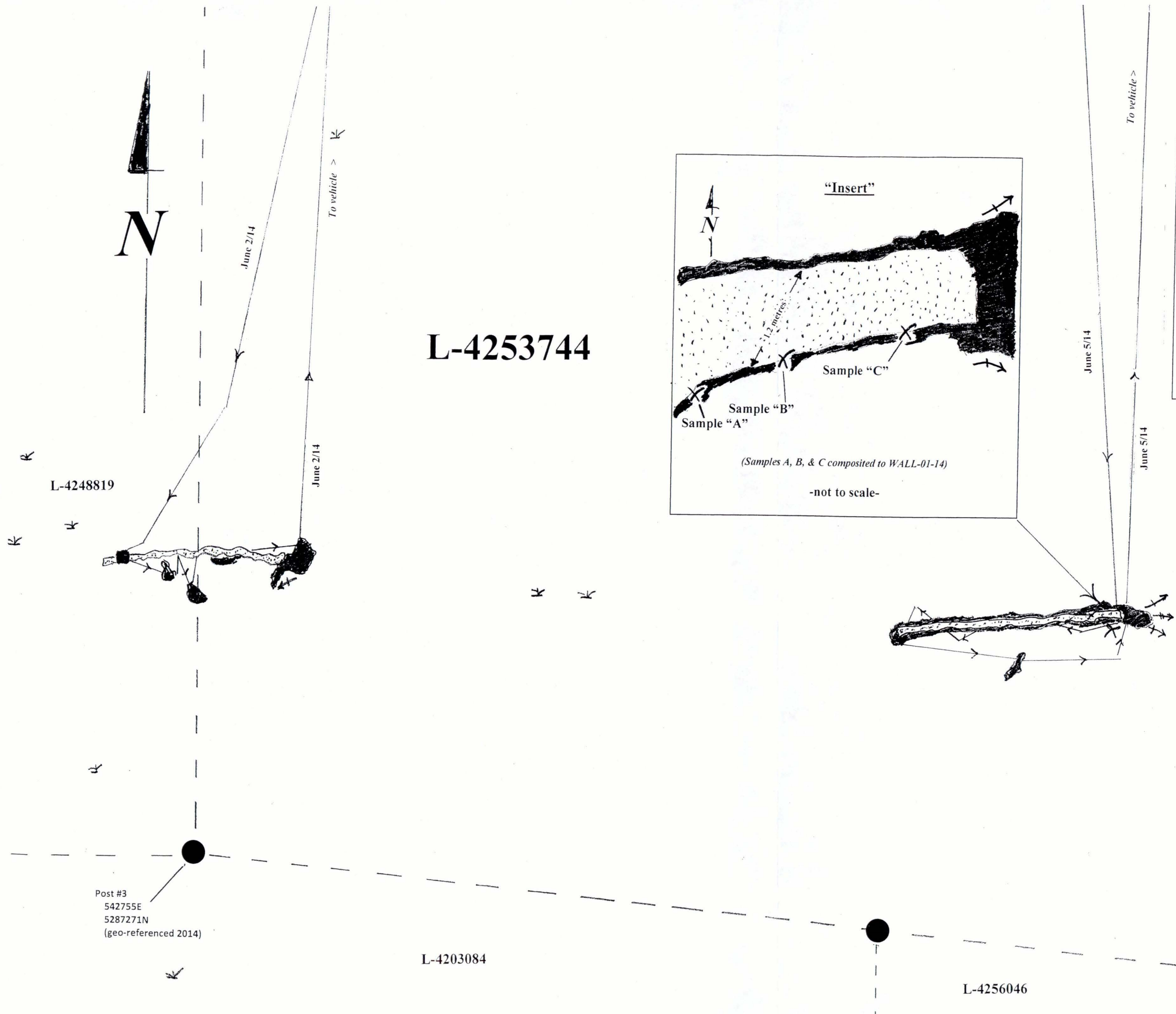

Post #3  
542755E  
5287271N  
(geo-referenced 2014)

Post #2  
543159E  
5287226N  
(geo-referenced 2014)

L-4203084

L-4256046

L-4256047