



CANADIAN EXPLORATION SERVICES LTD

PO Box 219, 14579 Government Road, Larder Lake, Ontario, P0K 1L0, Canada
Phone (705) 643-2345 Fax (705) 643-2191 www.cxsltd.com

SKEAD HOLDINGS LTD.

Claim Line Rehabilitation

Lawson Property Haultain, Chown and Lawson Townships, Ontario

TABLE OF CONTENTS

1. SURVEY DETAILS 3

1.1 PROJECT NAME 3

1.2 CLIENT 3

1.3 LOCATION 3

1.4 ACCESS 4

1.5 SURVEY AREA 4

2. SURVEY WORK UNDERTAKEN 5

2.1 PERSONNEL 5

2.2 PURPOSE 5

2.3 SURVEY LOG 5

3. OVERVIEW OF SURVEY RESULTS 6

3.1 CLAIM LINES REHABILITATED 6

LIST OF APPENDICES

APPENDIX A: STATEMENT OF QUALIFICATIONS

LIST OF TABLES AND FIGURES

Figure 1: Location of the Lawson Property 3

Figure 2: Claim Map with Claims Being Rehabilitation..... 4

Figure 3: Boundaries Rehabilitated of Mining Claims 6

Table 1: Survey Log..... 5

1. SURVEY DETAILS

1.1 PROJECT NAME

This project is known as the **Lawson Property**.

1.2 CLIENT

SKEAD HOLDINGS LTD.

28 Ford St.
Sault Ste. Marie, Ontario
P6A 4N4

1.3 LOCATION

The Lawson Property is located in Haultain, Chown and Lawson Townships approximately 8 km east of Gowganda, Ontario. The survey area covers mining claims 496432, 495403, 495404, 446692, 446691, 446688, 446689 and 446690 within the Larder Lake Mining Division.

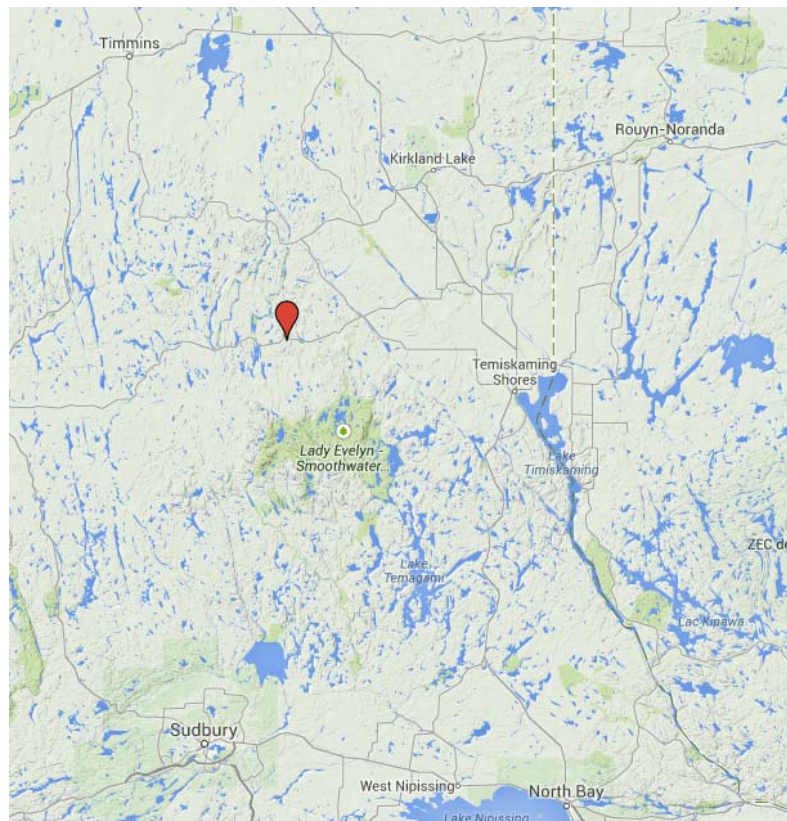

Figure 1: Location of the Lawson Property

1.4 ACCESS

Access to the property was attained via highway 560. The claim group crosses the highway approximately 9.5 kilometers east of the town of Gowganda, Ontario.

1.5 SURVEY AREA

The claim lines being rehabilitated are for claims numbered 496432, 495403, 495404, 446692, 446691, 446688, 446689 and 446690 and are located within Haultain, Chown and Lawson Townships, within the Larder Lake Mining Division.

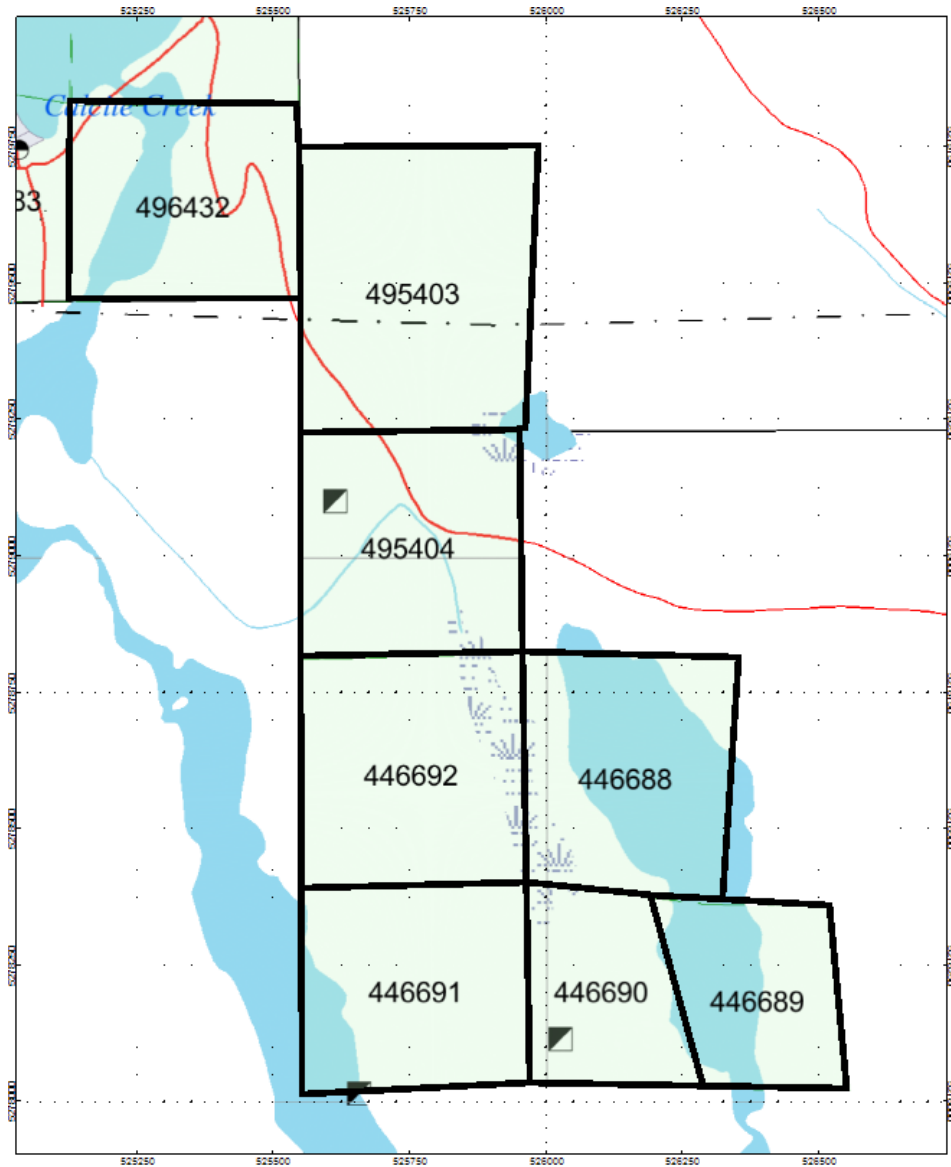

Figure 2: Claim Map with Claims Being Rehabilitation

2. SURVEY WORK UNDERTAKEN

2.1 PERSONNEL

Bruce Lavalley and Claudia Moraga both of Britt, Ontario and Bill Bonney of Kirkland Lake, Ontario located and rehabilitated all of the claim lines.

2.2 PURPOSE

The rehabilitation was performed to further define the boundaries.

2.3 SURVEY LOG

Date	Description
November 3, 2014	Locate and begin rehabilitation of claim lines.
November 17, 2014	Continue rehabilitation of claim lines.
November 18, 2014	Complete rehabilitation of claim lines.

Table 1: Survey Log

3. OVERVIEW OF SURVEY RESULTS

3.1 CLAIM LINES REHABILITATED

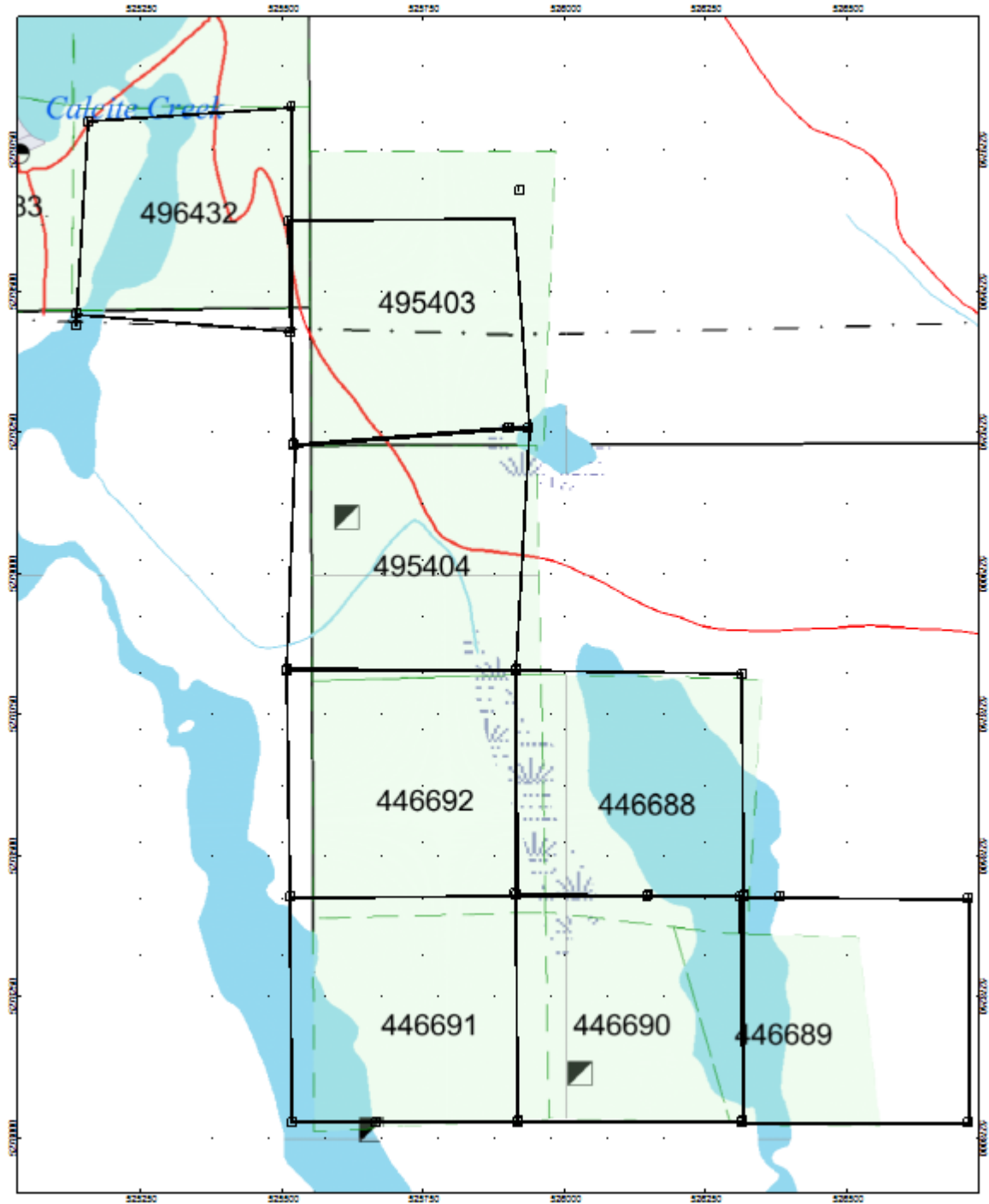

Figure 3: Boundaries Rehabilitated of Mining Claims

APPENDIX A

STATEMENT OF QUALIFICATIONS

I, C. Jason Ploeger, hereby declare that:

1. I am a professional geophysicist with residence in Larder Lake, Ontario and am presently employed as a Geophysicist and Geophysical Manager of Canadian Exploration Services Ltd. of Larder Lake, Ontario.
2. I am a Practising Member of the Association of Professional Geoscientists, with membership number 2172.
3. I graduated with a Bachelor of Science degree in geophysics from the University of Western Ontario, in London Ontario, in 1999.
4. I have practiced my profession continuously since graduation in Africa, Bulgaria, Canada, Mexico and Mongolia.
5. I am a member of the Ontario Prospectors Association, a Director of the Northern Prospectors Association and a member of the Society of Exploration Geophysicists.
6. I do not have nor expect an interest in the properties and securities of **Skead Holdings Ltd.**
7. I am responsible for the final processing and validation of the survey results and the compilation of the presentation of this report. The statements made in this report represent my professional opinion based on my consideration of the information available to me at the time of writing this report.



C. Jason Ploeger, P.Geo., B.Sc.
Geophysical Manager

Canadian Exploration Services Ltd.

Larder Lake, ON
December 2, 2014