

We are committed to providing [accessible customer service](#).  
If you need accessible formats or communications supports, please [contact us](#).

Nous tenons à améliorer [l'accessibilité des services à la clientèle](#).  
Si vous avez besoin de formats accessibles ou d'aide à la communication, veuillez [nous contacter](#).



**ST ANDREW**  
**GOLDFIELDS LTD.**

**2015 Clergue Property**

**Prospecting Report**

**For Claims**

**1204367 and 1204567**

**Clergue Township**

**Porcupine Mining Division**

**J.McKenzie**

**August 20, 2015**

## **Table of Contents**

1. Introduction, Figure 1.
2. Location/Access/Property Description, Property Geology, Previous work.
3. Prospecting/Traverses, Days 1, 2 and 3.
4. Prospecting/Traverses Table 1, Day 4.
5. Prospecting/Traverses Table 2, Day 5.
6. Prospecting/Traverses Table 3, Days 6, 7 and 8.
7. Prospecting Traverses Table4, Results.
8. Results cont'd, Table 5.
9. Table 5 cont'd.
10. Table 5 cont'd.
11. Table 5 cont'd.
12. Statement of Qualifications.

### **List of Figures**

**Fig 1 Provincial Scale property location map**

**Fig 2 Property Location Map**

**Fig 3 Sample Location Map**

**Fig 4 Channel Sample Location Map**

**Fig 5 Property Geology Map**

**Fig 6 Outcrop Geology Map**

### **List of Appendices**

**App 1 Assay Certificates**

## Introduction

Beginning on May 30th 2015, personnel in the employ of St. Andrews Goldfields carried out a mapping/prospecting/sampling program on mining claims 1204367 and 1204567 in Clergue Township (see fig 1), Timmins Mining Division. Field work in the claim block was completed on June 24<sup>th</sup> 2015. The initial concept was to carry out a reconnaissance sampling program and follow up on any successes with a focused mapping and channel sampling program. This however did not work out as no (remotely) significant assay values were identified during the course of sampling. The following is an overview of property location, access to site and prospecting work carried out.

Fig 1.

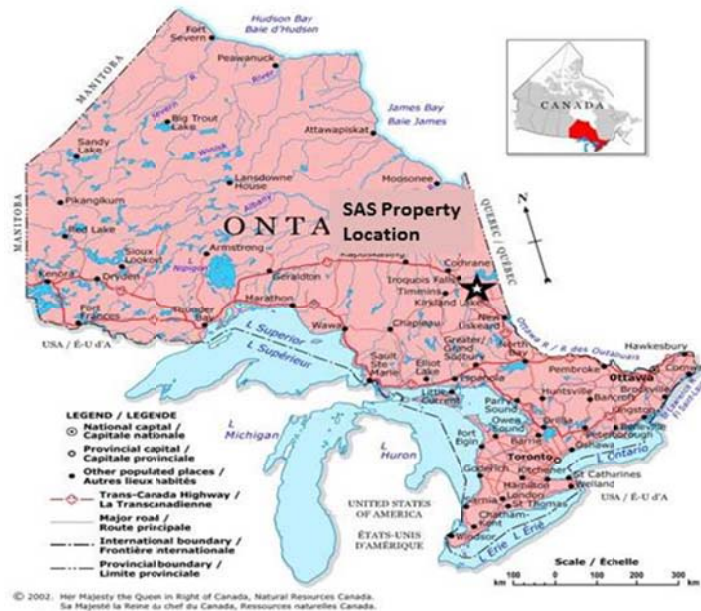

# Clergue Property Location Map

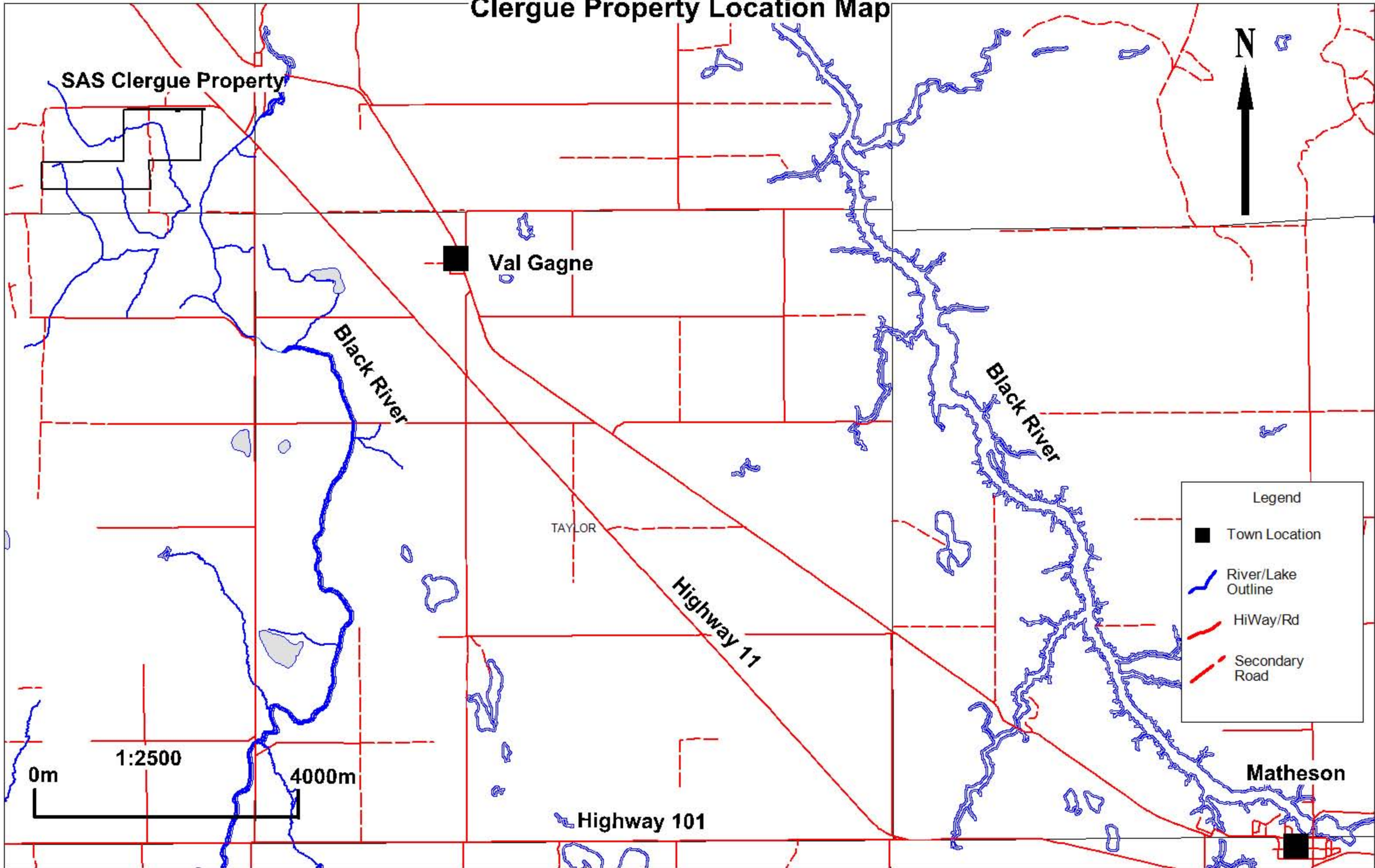

SAS Clergue Property

Val Gagne

Black River

Black River

TAYLOR

Highway 11

Highway 101

Matheson

Legend

- Town Location
- River/Lake Outline
- HiWay/Rd
- - - Secondary Road

1:2500

0m

4000m



**Location/Access/Property Description**

Mining Claims 1204367 (6 units) and 1204567 (4 units) are located the South-Eastern corner of Clergue Township, within the Porcupine Mining Division. Access to the claim is made by driving along Highway 11 West approximately 22 km west of the Town of Matheson Ontario, turning due West at this point and traveling 0.5 km along Biglow Road. At this point one is along the northern boundary of claim block 1204367.

**Property Geology**

Outcrop exposure within the claims is relatively sparse. However, through diamond drilling and local field mapping in the 1930's shows that the area is underlain by felsic to mafic volcanics, ultramafics and diabase dikes.

In 2006, St Andrew Goldfields Ltd drilled a single hole in the southeastern part of claim 1204567. From top to bottom, medium grained, grey-green diabase, sheared ultramafics and fine grained mafic volcanics with serpentized sections were intercepted. The mafic volcanics and the ultramafic unit belong to the Deloro Group, Cycle II rocks.

**Previous Work**

The earliest recorded work carried out on claim 1204367 was by Erie Canada Gold Mines in 1938-39. The company carried out diamond drilling in what appears to be the northwestern part of the claim. Ten holes were drilled with minor gold values.

In 1975, Noranda Inc. carried out a ground magnetic survey over parts of the property.

In 1980, Dalhousie Oil Company carried out a 603.0 foot single hole drill program in the east end of the property.

In 1981, Kidd Creek Mines Ltd carried out a Mag, EM and HLEM survey over parts of claim 1204367. The assessment report suggested a two hole drill program based on the geophysical results.

From 1994 to 1998, the claim was held by Gryba et al. Gryba et al carried out geotechnical work and an IP survey in 1998.

In late 1998, Moneta Porcupine Mines transferred their share of the property to Pentland Firth Ventures. They carried out a Mag and VLF survey over all of the property in 1999.

In 2002, Pentland Firth Ventures sold its 100% share to Kinross Gold Corp. In the same year, Kinross transferred 51% interest to Placer Dome. In 2006, Placer Dome changes its name to Goldcorp Canada.

In 2003, St Andrew Goldfields Ltd signed an option agreement with Goldcorp to vend it from 20-40% based on yearly expenditures.

In 2006, St Andrew Goldfields Ltd. carried out a one hole 182 meter diamond drill program. The best assay returned was from sample 39982 with 816 ppb gold.

### **Prospecting/Traverses**

#### **Day 1 (May 30<sup>th</sup> 2015)**

Representatives of SAS met with the surface rights owners within the claim block to discuss upcoming work and give them a sense of the general scope of activity to be carried out. Residents were insured that excavations/disturbances would be minimal and that any visual signs of our work be mitigated and or removed upon completion of the program.

#### **Day 2 (June 5<sup>th</sup> 2015)**

Field Crew departed from the St. Andrews Exploration office at 8:00 am arriving on work site at approximately 8:30 am. A general reconnaissance of the property was carried out in order to better identify access points, existing roads and trails, and various cultural features (ie. Power-lines, gas lines, houses, sheds etc). Crew returned to Matheson Exploration office at approximately 12:00pm.

#### **Day 3 (May 6th)**

Again Field crew departed from the Matheson office at approximately 8:30am and arrived on site approximately a ½ later that morning. Beginning on the north-eastern edge of claim 1204367, a total of 12 samples were collected during the day. The following charts are the results received, locations etc. for samples taken.

Table 1

Project	Sample ID	Au ppm	Easting	Northing	Rock Code	Rock Type	Date	Coordinates	Zone
Clergue	E402965	0.04	522351	5387273	VMO	Weakly Silicified Basalt	06/06/2015	UTM NAD 83	17
Clergue	E402966	0.005	522361	5387254	VIO	Intermediate Tuff	06/06/2015	UTM NAD 83	17
Clergue	E402967	0.005	522436	5387139	VMM	Massive Basalt	06/06/2015	UTM NAD 83	17
Clergue	E402968	0.005	522427	5387136	VMM	Massive Basalt	06/06/2015	UTM NAD 83	17
Clergue	E402969	0.005	522421	5387134	VMM	Massive Basalt	06/06/2015	UTM NAD 83	17
Clergue	E402970	0.005	522406	5387085	VMO	Weakly Silicified Basalt	06/06/2015	UTM NAD 83	17
Clergue	E402971	0.005	522414	5387131	VMO	Weakly Silicified Basalt	06/06/2015	UTM NAD 83	17
Clergue	E402972	0.005	522580	5386833	LDO	Diabase	06/06/2015	UTM NAD 83	17
Clergue	E402973	0.005	522122	5386630	VMO	Weakly Silicified Basalt	06/06/2015	UTM NAD 83	17
Clergue	E402974	0.005	521944	5386818	LDO	Diabase	06/06/2015	UTM NAD 83	17
Clergue	E402975	0.005	521820	5386645	LDO	Diabase	06/06/2015	UTM NAD 83	17
Clergue	E402976	0.005	521820	5386645	LDO	Diabase	06/06/2015	UTM NAD 83	17

#### Day 4 (June 8<sup>th</sup> 2015)

As with previous days, crew left the office at 8:00 am and arrived on site at approximately 8:30 am. Sampling focused on a series of outcrops and ridges located in the south-west/central portion of claim 1204367 and parts of the NE and North Central portions of claim 120567. Below are results, descriptions, locations of samples taken during the 8<sup>th</sup> of June.



Table 2

Project	Sample ID	Au ppm	Easting	Northing	Rock Code	Rock Type	Date	Coordinates	Zone
Clergue	E402977	0.005	521720	5386754	VMM	Massive Basalt	08/06/2015	UTM NAD 83	17
Clergue	E402978	0.005	521686	5386749	VMO	Weakly Silicified Basalt	08/06/2015	UTM NAD 83	17
Clergue	E402979	0.005	521947	5386498	VMO	Weakly Silicified Basalt	08/06/2015	UTM NAD 83	17
Clergue	E402980	0.005	521740	5386566	VMO	Weakly Silicified Basalt	08/06/2015	UTM NAD 83	17
Clergue	E402981	0.005	521745	5386603	VMO	Weakly Silicified Basalt	08/06/2015	UTM NAD 83	17
Clergue	E402982	0.005	521718	5386491	VMM	Massive Basalt	08/06/2015	UTM NAD 83	17
Clergue	E402983	0.005	521936	5386480	VMO	Weakly Silicified Basalt	08/06/2015	UTM NAD 83	17
Clergue	E402984	0.005	521853	5386451	VIO	Intermediate Tuff	08/06/2015	UTM NAD 83	17
Clergue	E402985	0.005	521560	5386507	VIO	Intermediate Tuff	08/06/2015	UTM NAD 83	17
Clergue	E402986	0.005	521550	5386547	VIO	Intermediate Tuff	08/06/2015	UTM NAD 83	17
Clergue	E402988	0.005	521244	5386441	VIO	Intermediate Tuff	08/06/2015	UTM NAD 83	17

Day 5 (June 9<sup>th</sup> 2015)

Work on the 9<sup>th</sup> of June consisted of carrying out rock descriptions, data entry into the SAS database as well as plotting of sample locations, descriptions etc. into Mapinfo.

Day 6: (June 10<sup>th</sup>) Field crew once again departed SAS office at approx. 8:00 am and reached work site at 8:30. Before sampling commenced in earnest thunderstorm activity forced workers to return to truck due to safety concerns. After waiting an approximate 2 hrs for the storm to pass (which it did not), crew returned to office at approximately 11:30 am.

Day 7 (June 11<sup>th</sup>): Sampling commenced again on the 11<sup>th</sup>, focusing on the Eastern portion of claim 1204567. See list below for details.

Table 3

Project	Sample ID	Au ppm	Easting	Northing	Rock Code	Rock Type	Date	Coordinates	Zone
Clergue	E402989	0.005	521567	5386350	VMO	Weakly Silicified Basalt	11/06/2015	UTM NAD 83	17
Clergue	E402990	0.005	521615	5386291	LDO	Diabase	11/06/2015	UTM NAD 83	17
Clergue	E402991	0.005	521628	5386373	VMO	Weakly Silicified Basalt	11/06/2015	UTM NAD 83	17
Clergue	E402992	0.005	521876	5386232	VMO	Weakly Silicified Basalt	11/06/2015	UTM NAD 83	17
Clergue	E402993	0.005	521810	5386214	VMO	Weakly Silicified Basalt	11/06/2015	UTM NAD 83	17
Clergue	E402994	0.005	521773	5386273	VMO	Weakly Silicified Basalt	11/06/2015	UTM NAD 83	17
Clergue	E402995	0.005	521772	5386344	VMO	Weakly Silicified Basalt	11/06/2015	UTM NAD 83	17
Clergue	E402996	0.005	521825	5386550	VMO	Weakly Silicified Basalt	11/06/2015	UTM NAD 83	17

Day 8 (June 24<sup>th</sup>)

This was to be the final day of field work on the property. With little Au values of note received from the recon sampling portion of the program an area of silicified mafic volcanics within the NW corner of claim 1204367 was selected as a location to take a handful of channel samples to

try and identify any possible Au bearing features. The results below in essence speak for them self.

Table 4

Project	Sample ID	Au ppm	Easting	Northing	Rock Code	Rock Type	Date	Coord	Zone
Clergue	E604455	0.005	522366	5387247	VMO	Weakly Silicified Basalt	24/06/2015	UTM NAD 83	17
Clergue	E604456	0.005	522358	5387017	VMO	Weakly Silicified Basalt	24/06/2015	UTM NAD 83	17
Clergue	E604457	0.005	522358	5387016	VMO	Weakly Silicified Basalt	24/06/2015	UTM NAD 83	17
Clergue	E604458	0.005	522359	5387015	VMO	Weakly Silicified Basalt	24/06/2015	UTM NAD 83	17
Clergue	E604459	0.005	522355	5387249	VMO	Weakly Silicified Basalt	24/06/2015	UTM NAD 83	17
Clergue	E604460	0.005	522355	5387251	VIO	Intermediate Tuff	24/06/2015	UTM NAD 83	17
Clergue	E604461	0.005	522355	5387251	VMO	Weakly Silicified Basalt	24/06/2015	UTM NAD 83	17
Clergue	E604462	0.005	522358	5387239	VMO	Weakly Silicified Basalt	24/06/2015	UTM NAD 83	17
Clergue	E604463	0.005	522358	5387239	VMO	Weakly Silicified Basalt	24/06/2015	UTM NAD 83	17
Clergue	E604464	0.005	522362	5387234	VIO	Intermediate Tuff	24/06/2015	UTM NAD 83	17
Clergue	E604465	0.005	522363	5387234	VIO	Intermediate Tuff	24/06/2015	UTM NAD 83	17

## Results

During the sampling phase of the program several lithologic units were identified, these include a fine grained weakly silicified mafic volcanic unit, which locally contained a very weak foliation fabric. Massive fine to medium grained Basalt was also noted, unit was typical of massive basalts throughout the area, with trace amounts of py and moderate chlorite alteration. Also noted in the field was a fine to locally medium grained Intermediate Tuff, trace amounts of py where present typically with spotty q-c threads/stringers. Matachewan Diabase units also cut through the property in several locations. A complete list of Sample Locations, descriptions etc. can be found in table 5.

In total 43 samples were taken during the execution of the program, Figs 2 and 3 show grab sample and channel sample locations along with corresponding sample numbers. Furthermore 11 channel samples were collected, again no significant values were intersected (see fig.3). All but one of these returned a value less than detectable levels, with that sampling grading 0.04 g/t Au. Outside of possible drilling programs that would be better able to detect and geologic features that do not come to surface (and are somewhat detectable on the OGS mag survey) further work in the area is going to be difficult to justify.

Table 5

Sample ID	Au ppm	Easting	Northing	Rock Code	Rock Type	Description	Coordinates
E402965	0.04	522351	5387273	VMO	Weakly Silicified Basalt	weekly to Moderately silicified basalt, minor microfractures within	UTM NAD 83 Zn 17
E402966	0.005	522361	5387254	VIO	Intermediate Tuff	tuff with small quartz veins, fragmented light pieces, oxidized	UTM NAD 83 Zn 17
E402967	0.005	522436	5387139	VMM	Massive Basalt	trace sulfides, massive, light purple, basalt oxidized fractures within	UTM NAD 83 Zn 17
E402968	0.005	522427	5387136	VMM	Massive Basalt	n/a roughly same location as above and below	UTM NAD 83 Zn 17
E402969	0.005	522421	5387134	VMM	Massive Basalt	trace sulfides, massive, light purple, basalt oxidized fractures within	UTM NAD 83 Zn 17
E402970	0.005	522406	5387085	VMO	Weakly Silicified Basalt	weakly silicified basalt trace sulfides with small quartz veins	UTM NAD 83 Zn 17

E402971	0.005	522414	5387131	VMO	Weakly Silicified Basalt	weakly silicified basalt trace sulfides with small quartz veins	UTM NAD 83 Zn 17
E402972	0.005	522580	5386833	LDO	Diabase	diabase	UTM NAD 83 Zn 17
E402973	0.005	522122	5386630	VMO	Weakly Silicified Basalt	weakly silicified basalt, microfractures within	UTM NAD 83 Zn 17
E402974	0.005	521944	5386818	LDO	Diabase	diabase	UTM NAD 83 Zn 17
E402975	0.005	521820	5386645	LDO	Diabase	diabase with calcite veins, fractured	UTM NAD 83 Zn 17
E402976	0.005	521820	5386645	LDO	Diabase	n/a roughly same location as above	UTM NAD 83 Zn 17
E402977	0.005	521720	5386754	VMM	Massive Basalt	basalt, dense	UTM NAD 83 Zn 17
E402978	0.005	521686	5386749	VMO	Weakly Silicified Basalt	lightly silicified basalt, quartz veins	UTM NAD 83 Zn 17
E402979	0.005	521947	5386498	VMO	Weakly Silicified Basalt	dolomite, fractured, light purple, massive, hard	UTM NAD 83 Zn 17
E402980	0.005	521740	5386566	VMO	Weakly Silicified Basalt	basalt, quartz veins, trace sulfides, microfractures	UTM NAD 83 Zn 17
E402981	0.005	521745	5386603	VMO	Weakly Silicified Basalt	basalt, quartz veins, trace sulfides, microfractures	UTM NAD 83 Zn 17
E402982	0.005	521718	5386491	VMM	Massive Basalt	very fine grained, massive, basalt	UTM NAD 83 Zn 17
E402983	0.005	521936	5386480	VMO	Weakly Silicified Basalt	navy blue with light green veins, basalt?	UTM NAD 83 Zn 17
E402984	0.005	521853	5386451	VIO	Intermediate Tuff	light blue, tuff?	UTM NAD 83 Zn 17
E402985	0.005	521560	5386507	VIO	Intermediate Tuff	intermediate very fine grained tuff	UTM NAD 83 Zn 17
E402986	0.005	521550	5386547	VIO	Intermediate Tuff	intermediate very fine grained tuff	UTM NAD 83 Zn 17
E402988	0.005	521244	5386441	VIO	Intermediate Tuff	1% sulfides, microfractures, Moderately silicified intermediate tuff	UTM NAD 83 Zn 17

E402989	0.005	521567	5386350	VMO	Weakly Silicified Basalt	massive, dense, microfractures, lightly silicified basalt?	UTM NAD 83 Zn 17
E402990	0.005	521615	5386291	LDO	Diabase	diabase	UTM NAD 83 Zn 17
E402991	0.005	521628	5386373	VMO	Weakly Silicified Basalt	navy blue, massive, fractures green-pink veins, basalt?	UTM NAD 83 Zn 17
E402992	0.005	521876	5386232	VMO	Weakly Silicified Basalt	trace sulfides, micro fractures basalt or tuff?	UTM NAD 83 Zn 17
E402993	0.005	521810	5386214	VMO	Weakly Silicified Basalt	trace sulfides, micro fractures basalt or tuff?	UTM NAD 83 Zn 17
E402994	0.005	521773	5386273	VMO	Weakly Silicified Basalt	navy blue, trace sulfides, massive, fractured, basalt?	UTM NAD 83 Zn 17
E402995	0.005	521772	5386344	VMO	Weakly Silicified Basalt	navy blue, trace sulfides, massive, fractured, basalt?	UTM NAD 83 Zn 17
E402996	0.005	521825	5386550			n/a	UTM NAD 83 Zn 17
E604455	0.005	522366	5387247	VMO	Weakly Silicified Basalt	Mafic volcanic quartz veins trace sulfides Moderately silicified	UTM NAD 83 Zn 17
E604456	0.005	522358	5387017	VMO	Weakly Silicified Basalt	Mafic volcanic Moderately silicified	UTM NAD 83 Zn 17
E604457	0.005	522358	5387016	VMO	Weakly Silicified Basalt	Mafic volcanic Moderately silicified	UTM NAD 83 Zn 17
E604458	0.005	522359	5387015	VMO	Weakly Silicified Basalt	Mafic volcanic Moderately silicified	UTM NAD 83 Zn 17
E604459	0.005	522355	5387249	VMO	Weakly Silicified Basalt	Mafic volcanic Moderately silicified	UTM NAD 83 Zn 17
E604460	0.005	522355	5387251	VIO	Intermediate Tuff	Tuff Moderately silicified	UTM NAD 83 Zn 17
E604461	0.005	522355	5387251	VMO	Weakly Silicified Basalt	Mafic volcanic with quartz veins and microfractured Moderately silicified	UTM NAD 83 Zn 17

E604462	0.005	522358	5387239	VMO	Weakly Silicified Basalt	Mafic volcanic with quartz veins and microfractured Moderately silicified	UTM NAD 83 Zn 17
E604463	0.005	522358	5387239	VMO	Weakly Silicified Basalt	Mafic volcanic with quartz veins and microfractured lightly silicified	UTM NAD 83 Zn 17
E604464	0.005	522362	5387234	VIO	Intermediate Tuff	Tuff Moderately silicified	UTM NAD 83 Zn 17
E604465	0.005	522363	5387234	VIO	Intermediate Tuff	Tuff Moderately silicified with quartz veining and fractured	UTM NAD 83 Zn 17

Submitted By:

John McKenzie

August 5<sup>th</sup> 2015

#### Statement of Qualifications

- I (John McKenzie) currently reside at 313 Vimy Ave. Timmins On. P4N 4H3
- This report is being submitted on behalf of St. Andrews Goldfields Ltd. For whom I am an assigned agent.
- I have no interests either directly or indirectly nor do I expect to receive any in the future in regards to the Clergue Property
- I am a Graduate of Cambrian College's Geological Technician Program.
- I have completed my Mining Act Awareness Program and have been assigned the verification number 4EC3-6704-542E-AF12.
- During the course of the prospecting program J.V. Bonhomme, Cole O'Neil and Yvan Labelle also assisted in field work and data compilation. Signatures below.

August 5<sup>th</sup> 2015



John McKenzie

Senior Exploration Technician



# Clergue Sample Location Map

See Fig. 2  
for channel  
sample  
locations

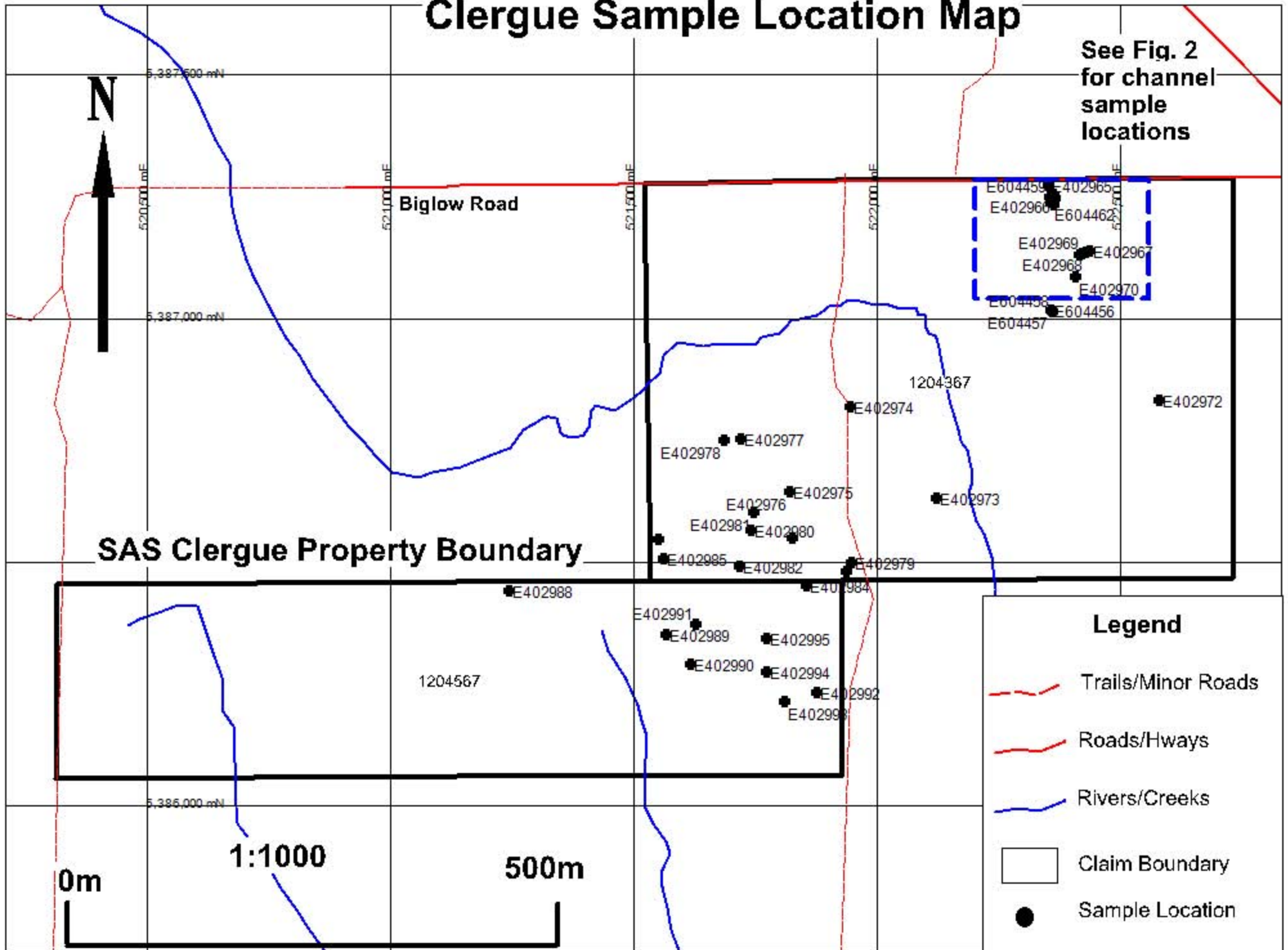

# Clergue Channel Sample Location Map

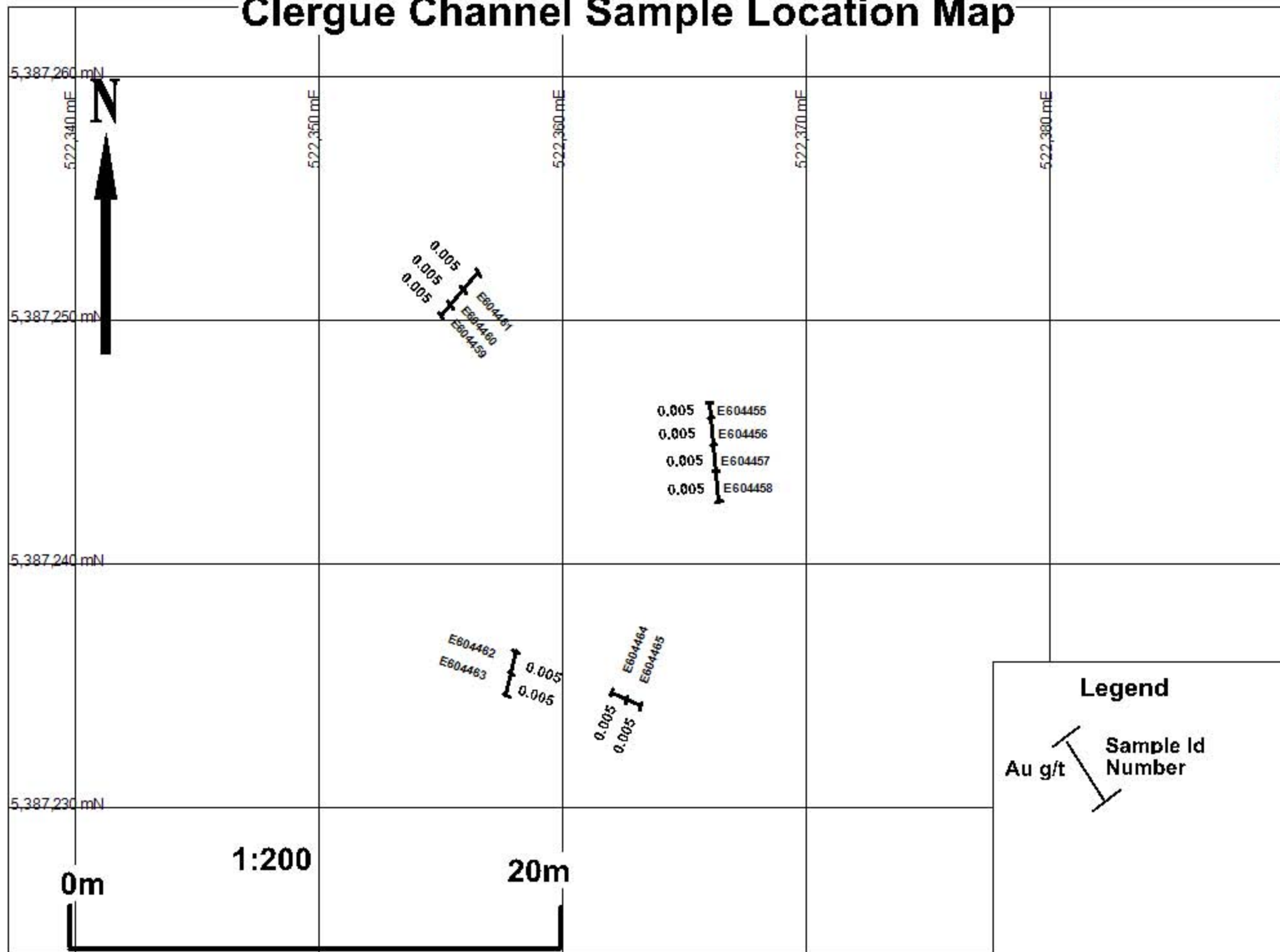

# Clergue Geology Map

Fig 5

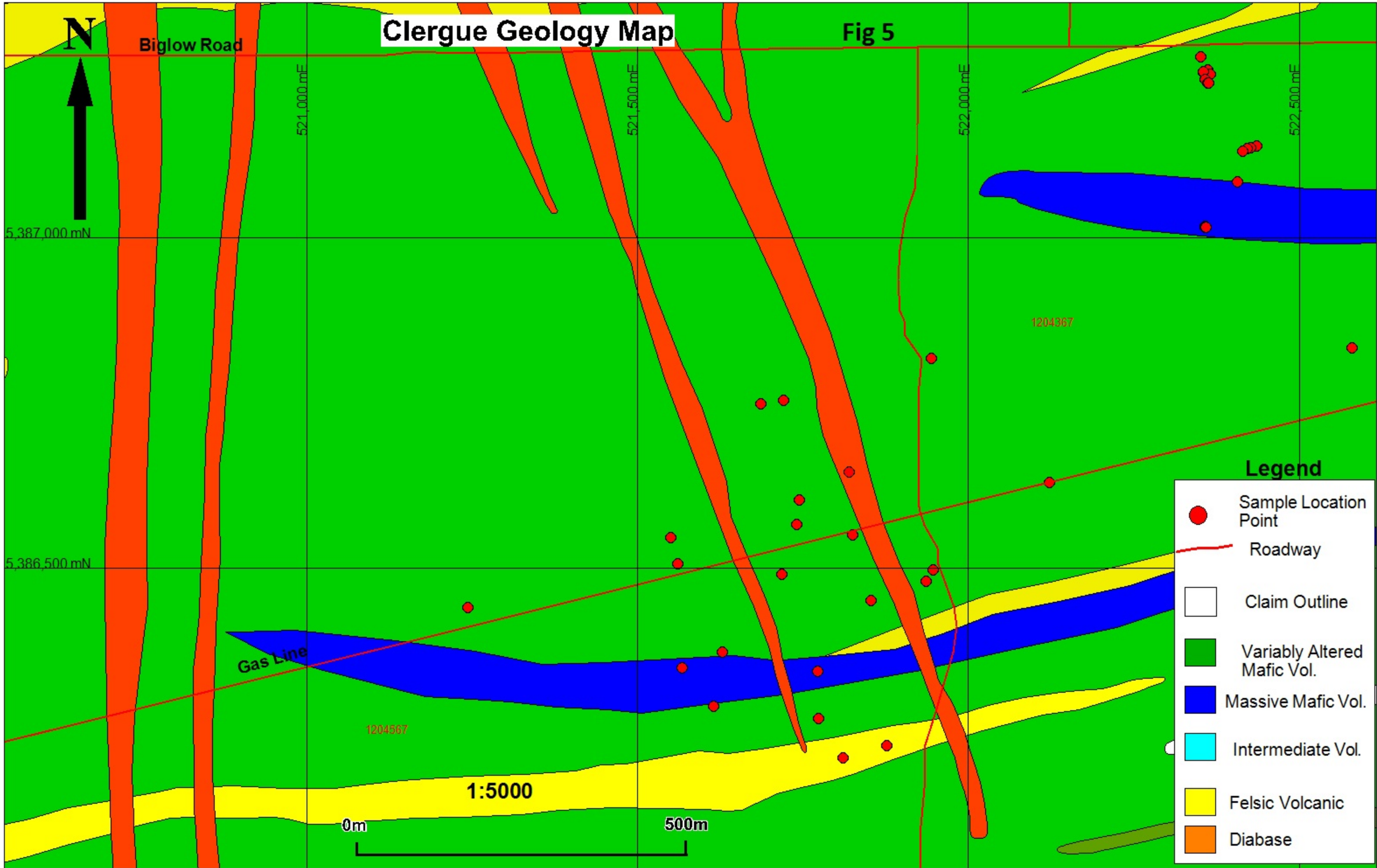

## Legend

- Sample Location Point
- Roadway
- Claim Outline
- Variably Altered Mafic Vol.
- Massive Mafic Vol.
- Intermediate Vol.
- Felsic Volcanic
- Diabase

# Clergue Geology/Outcrop Map Fig 6

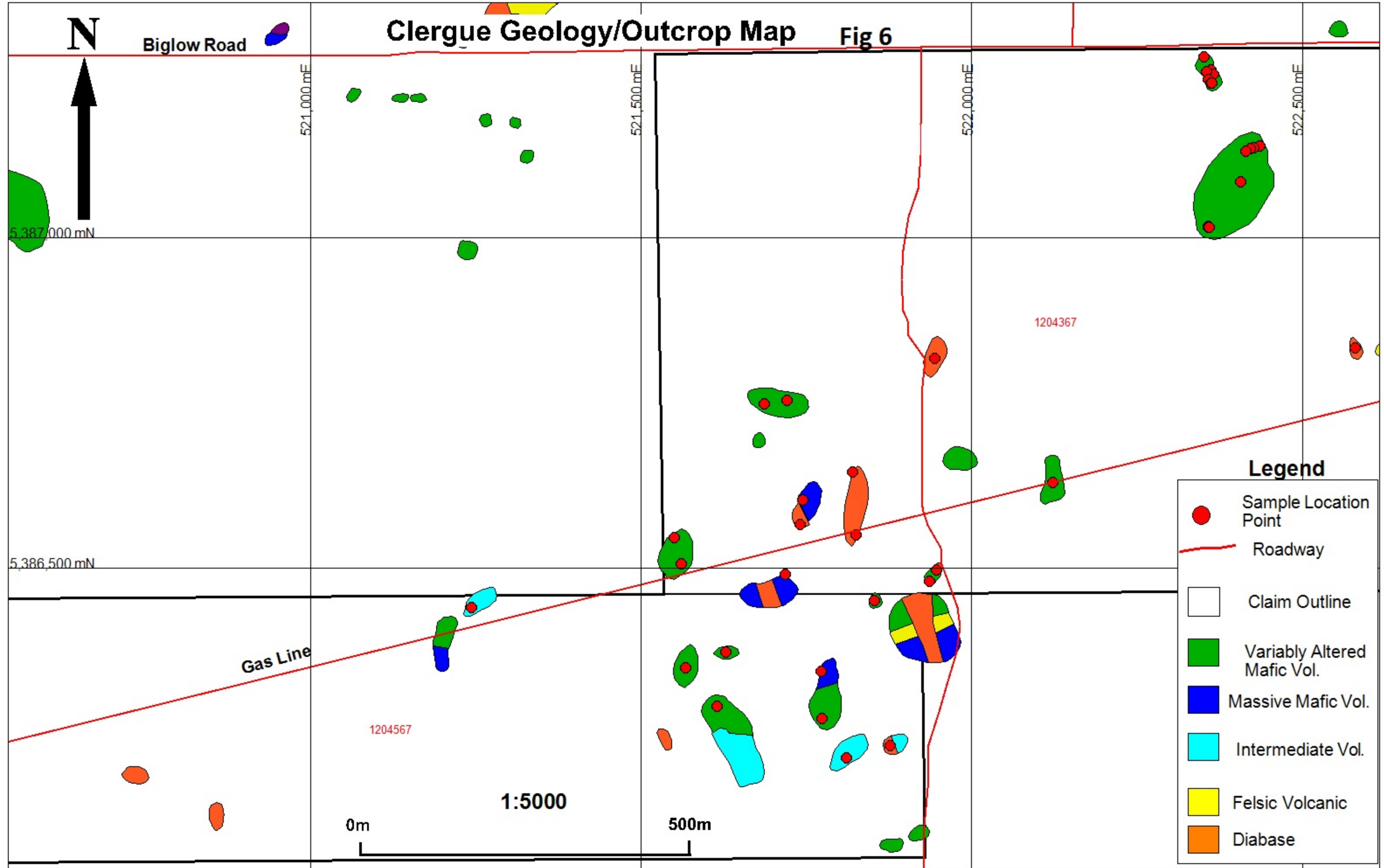

## Legend

- Sample Location Point
- Roadway
- Claim Outline
- Variably Altered Mafic Vol.
- Massive Mafic Vol.
- Intermediate Vol.
- Felsic Volcanic
- Diabase

**Appendix 1**  
**Assay Certificates**

\*\*\* Certificate of analysis \*\*\*

**Laboratoire Expert Inc.**

127, Boulevard Industriel  
Rouyn-Noranda, Québec  
Canada, J9X 6P2  
Telephone : (819) 762-7100, Fax : (819) 762-7510

Date : 2015/06/19

Page : 1 of 2

Client : <b>St-Andrew / Hislop Exploration Project</b>	
Addressee : <b>John Mckenzie</b>	Folder : <b>43154</b> Your order number : <b>4500034103</b> Project :
	Total number of samples : <b>32</b>

<u>Designation</u>	Au FA-GRAV g/t 0.03	Au-Dup FA-GRAV g/t 0.03
E402965	0.04	<0.03
E402966	<0.03	
Blk-01	<0.03	
E402967	<0.03	
E402968	<0.03	
E402969	<0.03	
SE68-01	0.58	
E402970	<0.03	
E402971	<0.03	
E402972	<0.03	
E402973	<0.03	
E402974	<0.03	
E402975	<0.03	
E402976	<0.03	
E402977	<0.03	<0.03
E402978	<0.03	
E402979	<0.03	
E402980	<0.03	
E402981	<0.03	
E402982	<0.03	

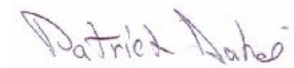
  
Patrick Dubé, Assistant Manager

**\*\*\* Certificate of analysis \*\*\***

**Laboratoire Expert Inc.**

127, Boulevard Industriel  
 Rouyn-Noranda, Québec  
 Canada, J9X 6P2  
 Telephone : (819) 762-7100, Fax : (819) 762-7510

Date : 2015/06/19

Page : 2 of 2

Client : <b>St-Andrew / Hislop Exploration Project</b>	
Addressee : <b>John Mckenzie</b>	Folder : <b>43154</b>
	Your order number : <b>4500034103</b>
	Project :
	Total number of samples : <b>32</b>

<u>Designation</u>	Au FA-GRAV g/t 0.03	Au-Dup FA-GRAV g/t 0.03
E402983	<0.03	
E402984	<0.03	
E402985	<0.03	
E402986	<0.03	
E402987	1.04	
E402988	<0.03	
E402989	<0.03	<0.03
E402990	<0.03	
E402991	<0.03	
E402992	<0.03	
E402993	<0.03	
Blk-02	<0.03	
E402994	<0.03	
E402995	<0.03	
E402996	<0.03	
OXF100-01	0.80	

\*\*\* Certificate of analysis \*\*\*

**Laboratoire Expert Inc.**

127, Boulevard Industriel  
Rouyn-Noranda, Québec  
Canada, J9X 6P2  
Telephone : (819) 762-7100, Fax : (819) 762-7510

Date : 2015/07/10

Page : 1 of 1

Client : <b>St-Andrew / Hislop Exploration Project</b>	
Addressee : <b>John Mckenzie</b>	Folder : <b>43280</b> Your order number : <b>4500034103</b> Project : Total number of samples : <b>11</b>

<u>Designation</u>	Au FA-GRAV g/t 0.03	Au-Dup FA-GRAV g/t 0.03
E604455	<0.03	<0.03
E604456	<0.03	
E604457	<0.03	
E604458	<0.03	
E604459	<0.03	
E604460	<0.03	
E604461	<0.03	
E604462	<0.03	
Blk-01	<0.03	
E604463	<0.03	
E604464	<0.03	
E604465	<0.03	
SE68-01	0.60	



Joe Landers, Manager