

We are committed to providing [accessible customer service](#).
If you need accessible formats or communications supports, please [contact us](#).

Nous tenons à améliorer [l'accessibilité des services à la clientèle](#).
Si vous avez besoin de formats accessibles ou d'aide à la communication, veuillez [nous contacter](#).

June 16, 2015

Mr. Nelson Turcotte(client 203656)/Mr. Glen Goodman(client 138136)/John
Turcotte(cleint 203632)
764 Lexington Cr.
Thunder Bay, Ontario, CANADA
P7B 7B8
Cell Phone – 1-807-633-3362
Home Phone – 1-807-768-4034

Ms. Lucille Jerome
Provincial Recording Office
Geoscience Assessment Office
Ministry of Northern Development and Mines
933 Ramsey Lake Road
3rd Floor
Sudbury, Ontario, CANADA
P3E 6B5
Email – james.mcauley@ontario.ca
Phone – 1-888-415-9845
Fax – 1-877-670-1444

Attention: Ms. Jerome

***Re: Glen Goodman (Client #138136) and John Turcotte (Client #203632) and Nelson
Turcotte (Client #203656) Filing of 2015 Assessment Report for Claim No. 4204002 in
Sandra Township – near Beardmore, Ontario***

Dear Ms. Jerome:

We are filing our 2015 Assessment Work Report, through the MNDM's electronic
assessment system.

This cover letter includes the following:

- Attachment #1 - Access to Mining Claim 4204002 overview map
- Attachment #2 - Close-up of Access Route to Mining Claim 4204002 overview map
- Attachment #3 - 1:5000 2015 mapping showing where prospecting and grab samples were taken from in 2015.
- Attachment #4 - Excel spreadsheet detailing costs provided for in Electronic Assessment System Cost Categories
- Attachment #5 - Evidence from Accurassay Labs in Thunder Bay that we dropped off five (5) grab samples on June 16, 2015 - results to follow
- Description of Samples taken

Google

To see all the details that are visible on the screen, use the "Print" link next to the map.

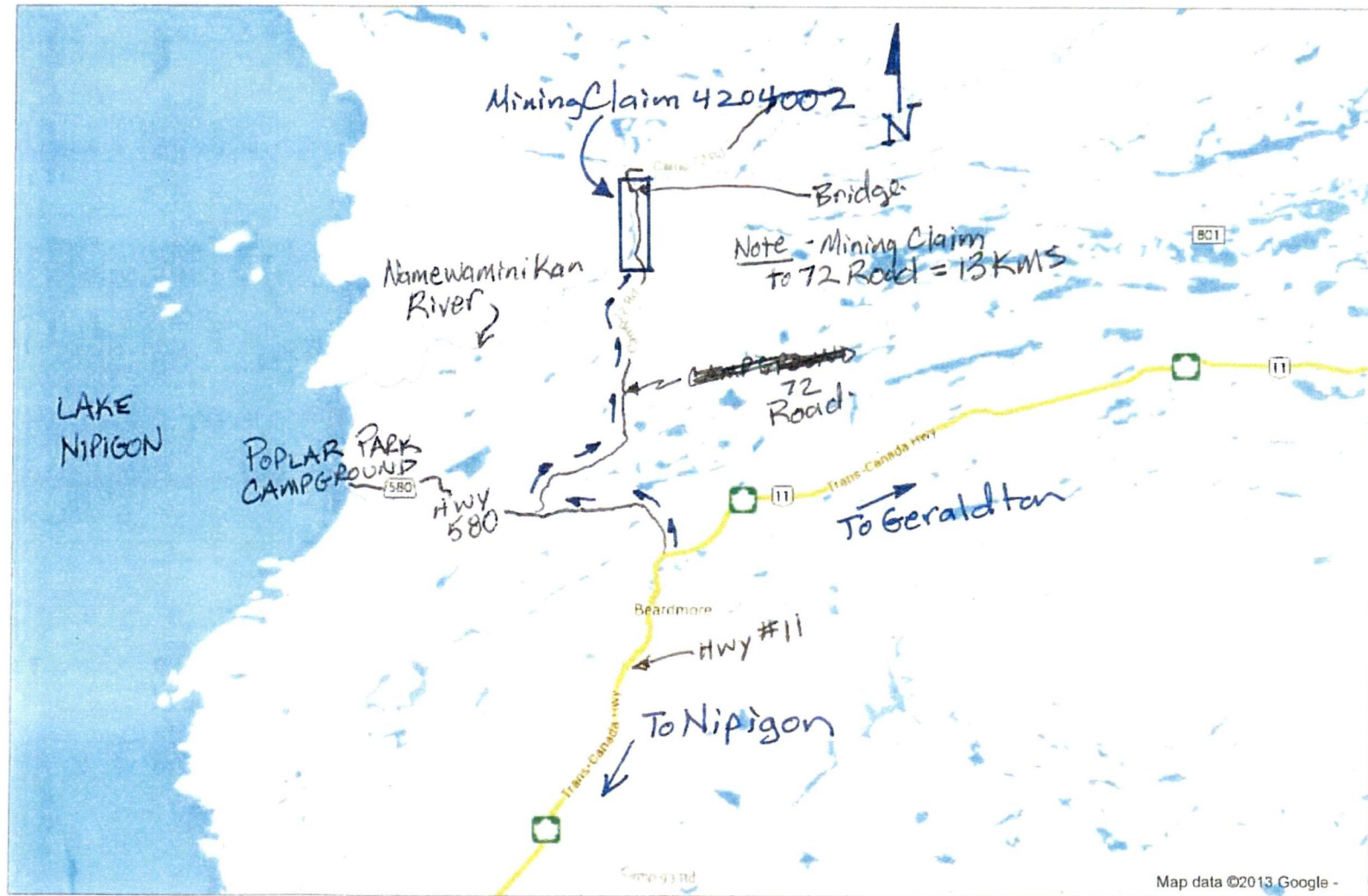

-see Attachment #2
Close Up of Access Route.

Attachment #1 - Access to
Mining Claim 4204002

June 16, 2015

Attachment #2

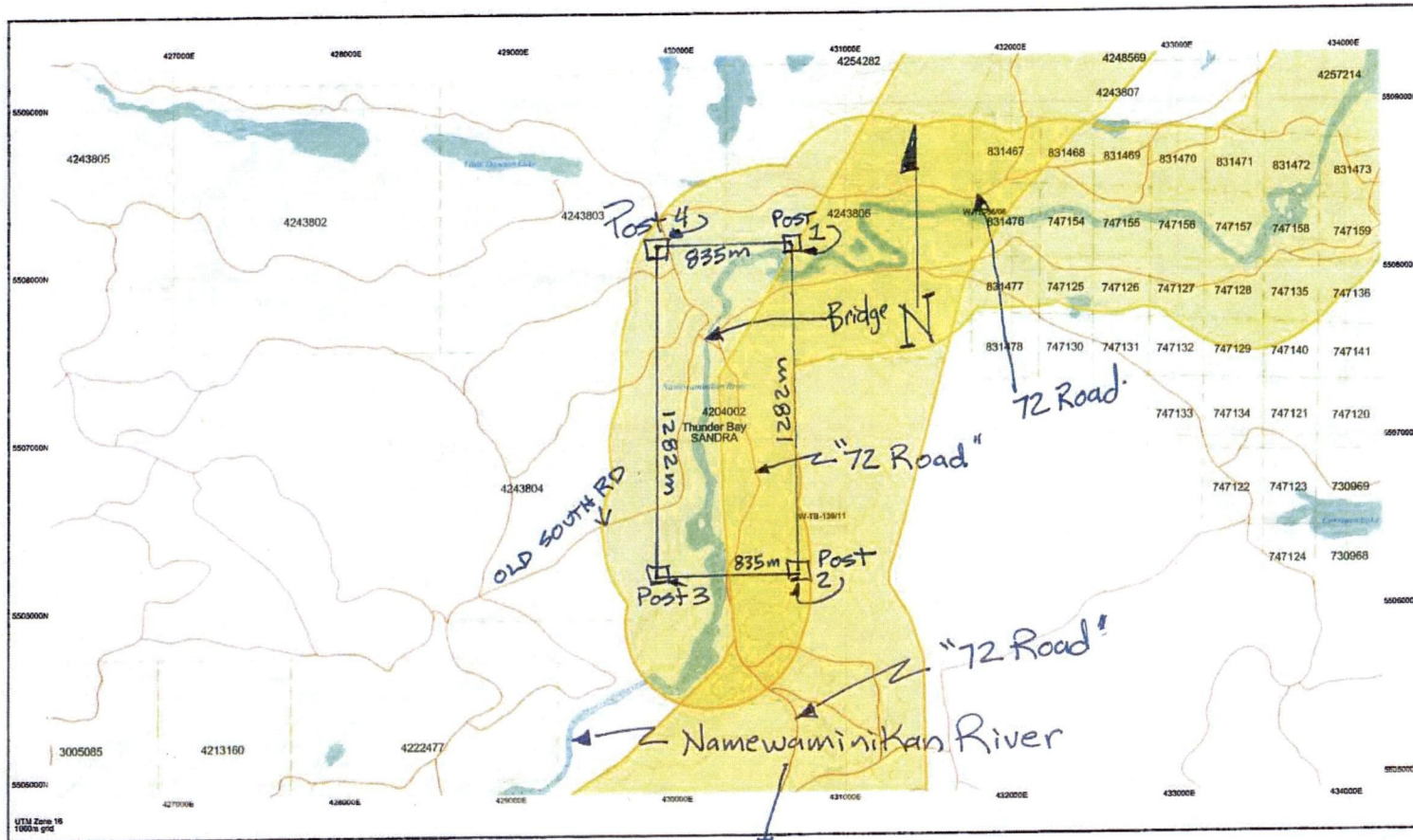

Attachment #2 - Close-Up
of Access Route to

Mining Claim 4204002
John Torcotte
Glen Goodman
Nelson Torcotte

June 16, 2015

Attachment #3-2015 Report

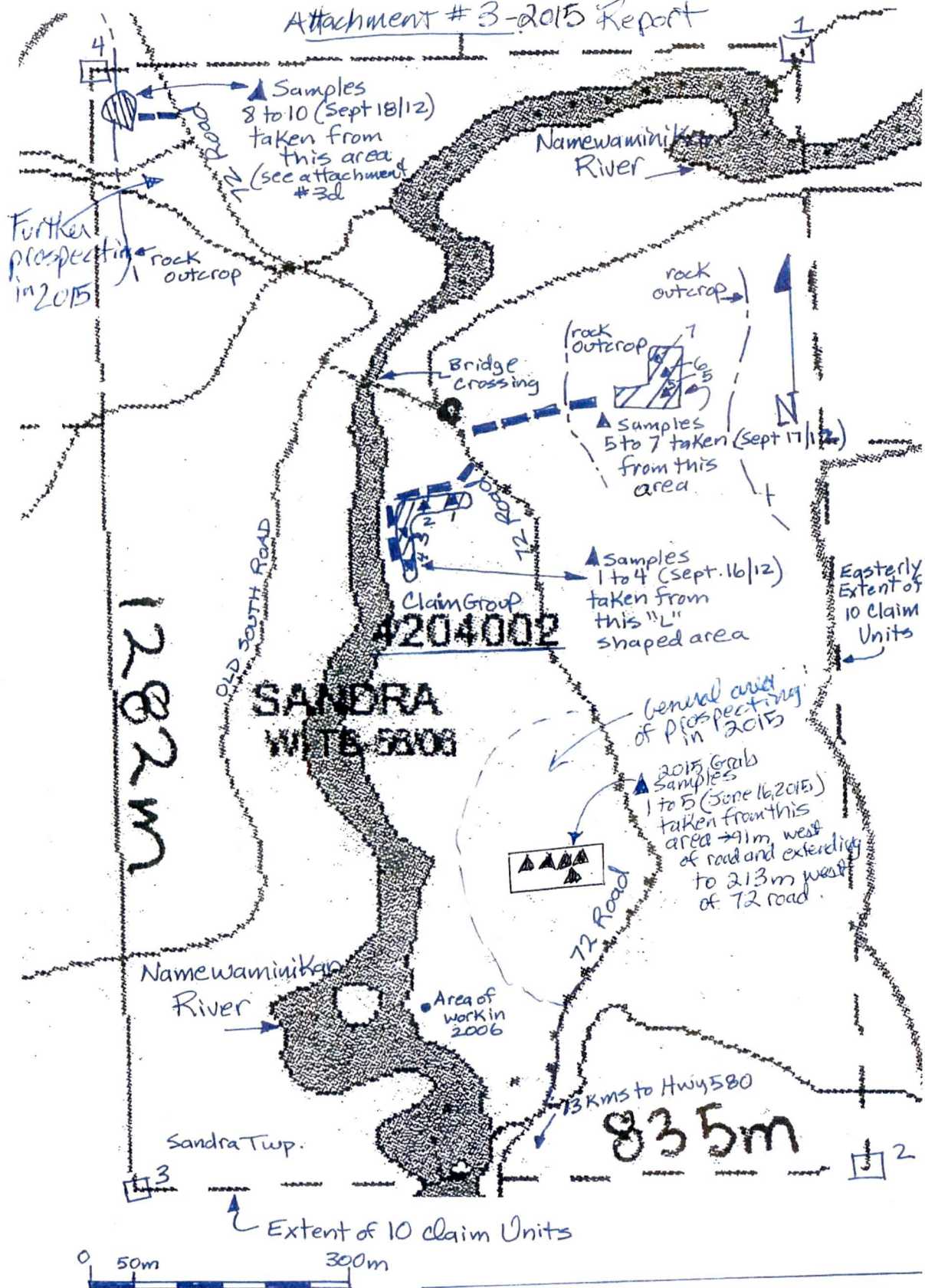

Attachment #3
Plan of Sampling
June 16, 2015

Key Plan	
▲ = sample #	□ = Claim Post
■ = trail	■ = water
---	= extent of claim units (boundary)
---	= rock outcrop
■ = 2015	■ = 2012
	Sampling

CLAIM NO. TB 4204002 - 2015 ASSESSMENT WORK REPORT

Report dated Tuesday, June 16, 2015

	Hourly Rate	Hours	Materials	Sundries	TOTAL	NOTES
	(\$/hr.)					

Labor Prospecting - Glen Goodman - June 9, 10, 11, 12, 2015 = 4 days x 10 hours of prospecting = 40 hours

Labor assistance to digging/sample taking - Carl Turcotte

Labor - Nelson Turcotte - assisting with grab samples and confer with Mr. Goodman on reporting and future approach to claim work also - discuss 120m easement awarded to Namewaminikan Hydro for new hydropower plant and scope out their work and future placement of laydown areas and poles

Labor - Nelson Turcotte - draft report = 16 hours

Labor - Glen Goodman - communicate's with Nelson Turcotte for report drafting and sketching of map = 2 hours

Labor - Nelson Turcotte - drive to Beardmore, pick up samples and deliver to Thunder Bay = 6 hours

Subtotal

\$ 4,660

Cost of Assay Work - 5 samples - Accurassay - Thunder Bay

Use of Four Wheeler each day - 4 days x \$125/day (gas included)

Subtotal

\$ 675

Gas - Nelson Turcotte - Thunder Bay to Beardmore, return (assays) - June 10 and June 11, 2015 and discuss with Glen

Gas for Glen's truck - 4 days x 30 km's per day = 120 km's in June 2015

Subtotal

\$ 350

Nelson Turcotte and Carl Turcotte (2 days each)

Glen Goodman - 4 days

Subtotal

§ 22

GRAND TOTAL

\$ 5,910

2015 assessment work claim TB 4204002

NOTE - PLEASE SEE ASSESSMENT WORK REPORT FORM FOR DATES

Description of the samples that were collected

Five granular/sandy samples were taken between June 9, 2015 and June 13, 2015. These samples were all very similar; natural gravel (small gravel of 3mm and smaller size – dark grey and almost black in color) of uniform size. The gravel samples were taken from a ridge that runs parallel to the Namewaminikan River. The samples were taken as follows:

Sample #5 - 120m east of Namewaminikan River
Sample #4 - 150m east of Namewaminikan River
Sample #3 - 180m east of Namewaminikan River
Sample #2 - 210m east of Namewaminikan River
Sample #1 - 215m east of Namewaminikan River

The assay results shall be forwarded, via facsimile to your attention once they become available.

Should you have any questions, please do not hesitate to contact me at my home office at 807-768-4034.

Thank-you for your cooperation and assistance.

Yours truly,



Nelson P. Turcotte

cc. Glen A. Goodman - Beardmore, Ontario and Mr. John Turcotte – Terrace Bay, Ontario



ACCURASSAY
LABORATORIES

1046 Gorham Street
101 Magill St.,
150 Jaguar Drive, RR#2
443 J.R. Smallwood Blvd., PO Box 791,
859-861 Blvd. Granada

Thunder Bay, ON
Lively, ON
Timmins, ON
Gambo South, NL
Rouyn-Noranda, QC

Canada P7B 5X5
Canada P3Y 1K6
Canada P4N 7C3
Canada A0G 1T0
Canada J9Y 1G8

Ph: (807) 626-1630
Ph: (705) 692-9963
Ph: (705) 264-6266
Ph: (709) 674-4755
Ph: (819) 797-7580

Fax: (807) 622-7571
Fax: (705) 692-4508
Fax: (705) 264-6244
Fax: (709) 674-4757
Fax: (819) 797-7581

ANALYTICAL REQUEST SHEET

Attachment #5
- evidence that
samples were dropped
of -

Company Name: _____

Submitted By: _____

Field Office Phone #: _____

Purchase Order #: _____

Date Submitted: _____

Internal Use Only

Date Received: June 13

Location Received At: 15th

Accepted by (name): SUSAN

Work Order No.: _____

Results Sent To:

Address: NELSON TUCKER

Ch Allen Goodman

Email: _____ Fax: _____

Invoice Sent To:

Address: 1111 1st St

Myarob@eastlinn.ca

Attention: _____ Phone: _____

ANALYSIS REQUESTED[illegible]

Client Authorization:

Name: NICOLSON

Signature: [Signature]

Sample Disposition:

Return after analysis

Return after 30 days

Discard after 30 days

Long Term storage after 30 days

Pulps

7



11

11

Rejects

11

11

11

