

We are committed to providing [accessible customer service](#).
If you need accessible formats or communications supports, please [contact us](#).

Nous tenons à améliorer [l'accessibilité des services à la clientèle](#).
Si vous avez besoin de formats accessibles ou d'aide à la communication, veuillez [nous contacter](#).

Claims Report

This report covers the prospecting work carried out during the fall of 2017 on 4 mining claims located in Benoit Township, Larder Lake Mining division. The claim units encompass the former Bourkes mine.

The three claims 919906, 919907 and 919908 were staked January 1987 and 1217763 was staked May 4, 2004. These claims cover possible ore extensions from the Bourkes mine. The ODM geology map 2215 (Benoit and Maisonville Township – see map #1) illustrate a North 30 degree shear zone. The staked ground encompasses this trend.

The claims are located north of the Town of Kirkland Lake and are shown on the attached claim map for Benoit Township. The property is easily accessed by year round township roads that meet highway 11. The Ontario Northland Railway marks the eastern boundary of this property as well.

A total of 8 days were spent line cutting and prospecting.

October 3 – 4, 2017

Line cutting of old property boundaries around mining claims. Claim lines were in bad shape from beaver flooding, wind falls and overgrowth.

Located drill holes around Bourkes mine on claim #919906. Used pickets and flagging tape to mark drill holes.

October 26 – 27, 2017

Continued line cutting of old property boundaries around mining claims. Traversed claim #1217763 and 919907 at 100m intervals in an attempt to located possible outcrops. Located several outcrops and glacial boulders. Used pickets and flagging tape to mark locations. Located drill holes 92-B-38 and 92-B-37. Utilized steel bar to check overburden in areas that seemed close to surface (such as a sharp three foot elevation gain on the west side of claim) for future trenching.

November 23 – 24, 2017

Continued line cutting of old property boundaries around mining claims. Exposed abandoned test pit along the shore of the White Clay River and verified that the rock is a mafic basalt from previous exploration programs. Could not locate any test holes that were drilled around the test pit in past years.

November 26 – 27, 2017

Finished line cutting of old property boundaries around mining claims.

With most of the leaves gone I took the opportunity to prospect along the river shore. Using a sledge hammer and pick, many outcrops were exposed containing mafic basalt. However; there was no appreciable mineralization.

Future Work Required

A diamond drill hole should be completed to the west of holes 92-B-37 and 92-B-38.

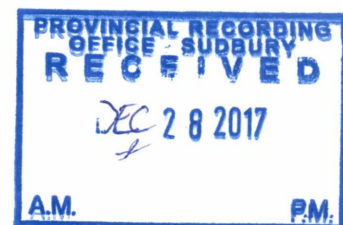

Benoit Claims For Line Cutting



Legend

- Drill Hole
- River / Water
- Railway
- Powerline
- Road
- Sample Location
- Test Pit

Location Plan

Bourkes Mine
Benoit Township
District of Cochrane, Ontario
Larder Lake Mining Division
NTS: 42A/SE
Scale: 1:2500
Date: December 20, 2017

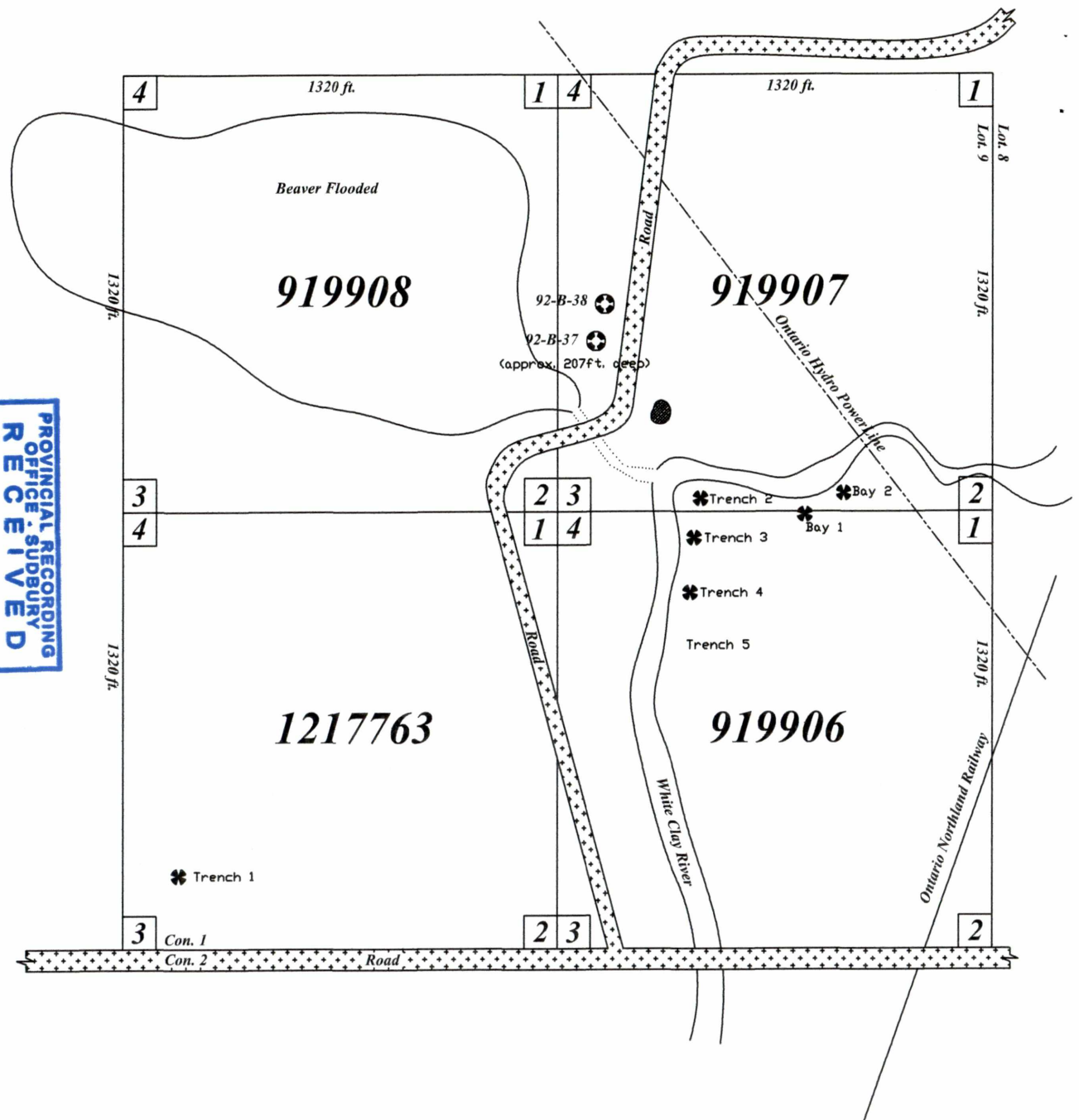
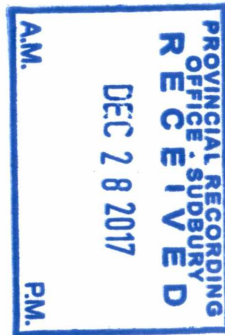

Fig 2054

