

We are committed to providing [accessible customer service](#).
If you need accessible formats or communications supports, please [contact us](#).

Nous tenons à améliorer [l'accessibilité des services à la clientèle](#).
Si vous avez besoin de formats accessibles ou d'aide à la communication, veuillez [nous contacter](#).

2 · 44956

REPORT OF DIAMOND DRILLING PROGRAM FOR

EXPLORERS ALLIANCE CORPORATION

ENID CREEK PROJECT

LOVELAND TOWNSHIP

PORCUPINE MINING DIVISION

Submitted by Lionel Bonhomme
May 25, 2010

Contents

Page 1:	Introduction, Location, Regional & Local Geology
Page 2:	Previous Work
Page 3:	Certificate
Page 4:	Claim Sketch
Page 5:	Regional Location
Page 6:	EL-25-08X Drill Hole Plan
Page 7:	EL-25-08X Drill Hole Section
Pages 9-:	EL-25-08X Core Log

Introduction:

The Enid Creek project is located in south east Loveland Township, approximately 14km north of the past producing KamKotia Mine. International Explorers & Prospectors Inc conducted a one drill hole program, totaling 60m by extending a previous drill hole that had not reached a favourable contact. The contractor was Colbert Drilling (167 Jury Lane, Timmins) with a start date of May 20, 2010 to May 24, 2010. The layout and location was performed by Peter Colbert, who located the previous casing. Wayne Corstorphine was retained to log and describe the drill hole. The drill hole collar for EL25-08X is 50+00E, 10+175N, 452282mE, 5383225mN, Nad 27 zone 17, 270° azimuth, with a dip of -70°. Water for the drilling was obtained from a low marsh nearby.

Location:

The property owned by International Explorers & Prospectors Inc in Loveland Township, plan M-0293 consists of 22 unpatented contiguous units. The property can be accessed by paved highway 101 west from the City of Timmins, then following the Malette Logging road for 20km and turning onto Winter Lake Road for 8km, then 1.5km on a previously used drill road constructed by a logging company. A four wheel drive vehicle is required to access the drill site. Travel time to the drill site is approximately 90min.

Regional Geology:

The area is situated at the west end of the Abitibi Greenstone Belt, which consists of archean meta sediments and felsic to mafic volcanics, intruded granitic and mafic intrusive bodies. A description of the geology is reported by Ferguson (1944), Middleton (1972), Pyke (1970), Hart (1983), Barrie (1990) and Ayer (2005).

Local Geology:

The property is overburden covered but detailed studies by Ore Systems Consulting have concluded that the mafic and felsic volcanics are classified as FIIIa and FIIIb types (Leshner, C.M. Et al 1986 CJES vol. 23). The geology north of Halfmoon Lake is similar to the south of the lake but appears in reverse order suggesting an anticline east of the local area. The purpose of this drill hole is to fill in a stratigraphic gap between two previous holes.

Previous Work:

1955 Dominion Gulf – geophysics, soil geochem and geological mapping

1964 Mepsi Mines – geophysics

1965 Cincinnati Porcupine – diamond drilling program

1992 Falconbridge – geophysics and diamond drilling

1996 Explorers Alliance Corporation – geophysics and diamond drilling

1997 -2009 International Explorers & Prospectors Inc ongoing programs of geophysics, drilling, lithochem studies.

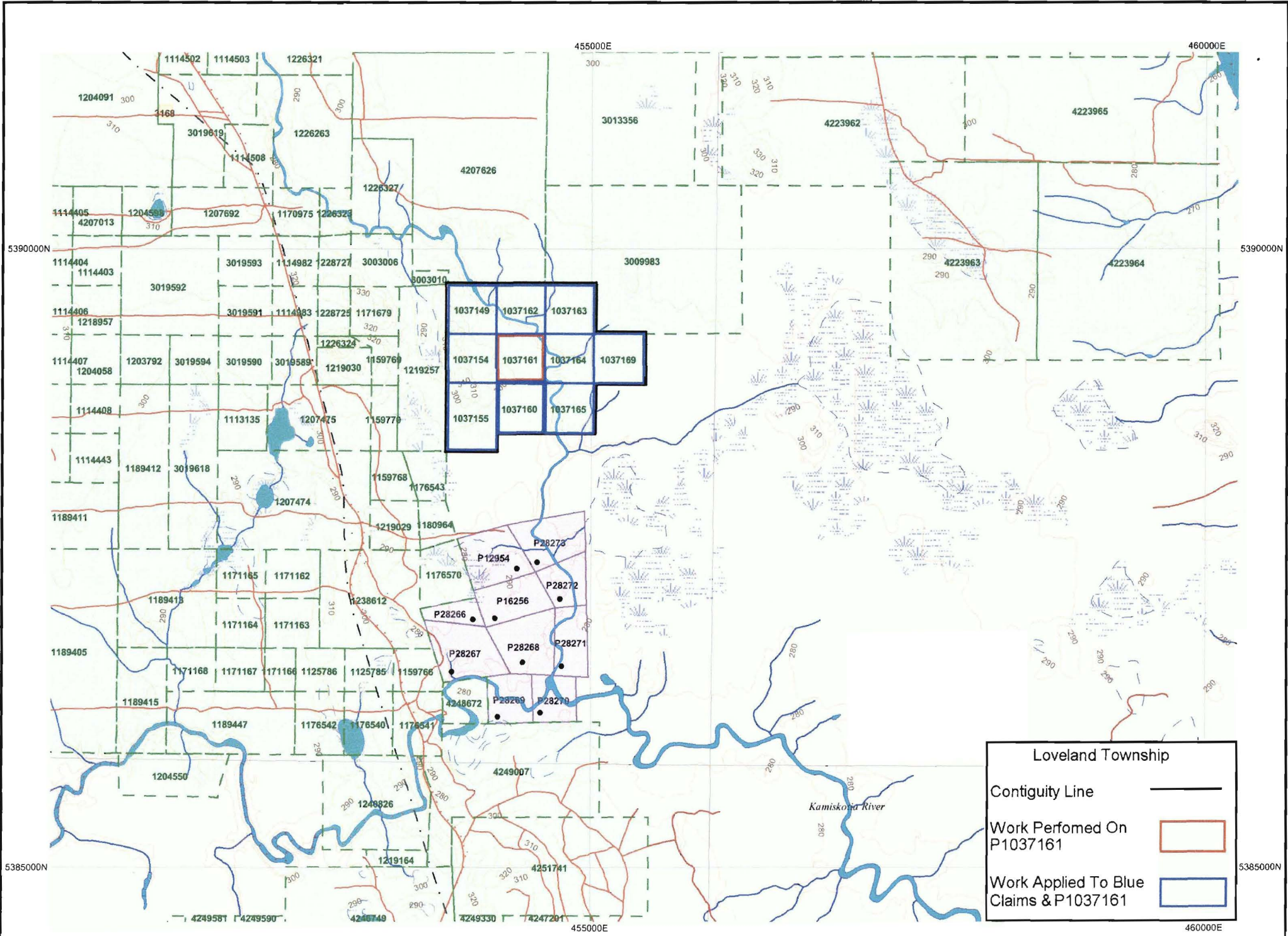

Loveland Township

Contiguity Line 

Work Performed On P1037161 

Work Applied To Blue Claims & P1037161 

Certificate

I, Lionel Bonhomme, hereby certify that,

I am a member of the PDAC of Canada and Porcupine group,
I am the holder of a valid prospector's license for the province of Ontario,
I am a member of the Geological Association of Canada,
I have been actively involved in exploration since 1964,
My spouse is a shareholder of International Explorers & Prospectors Inc,
1218395 Ontario Inc has provided consulting services to International
Explorers & Prospectors Inc and my spouse is the owner of that
corporation.



Regional Location Map
Enid Creek/Loveland Project
DDH EL25-08X (extension)

International Explorers & Prospectors Inc.

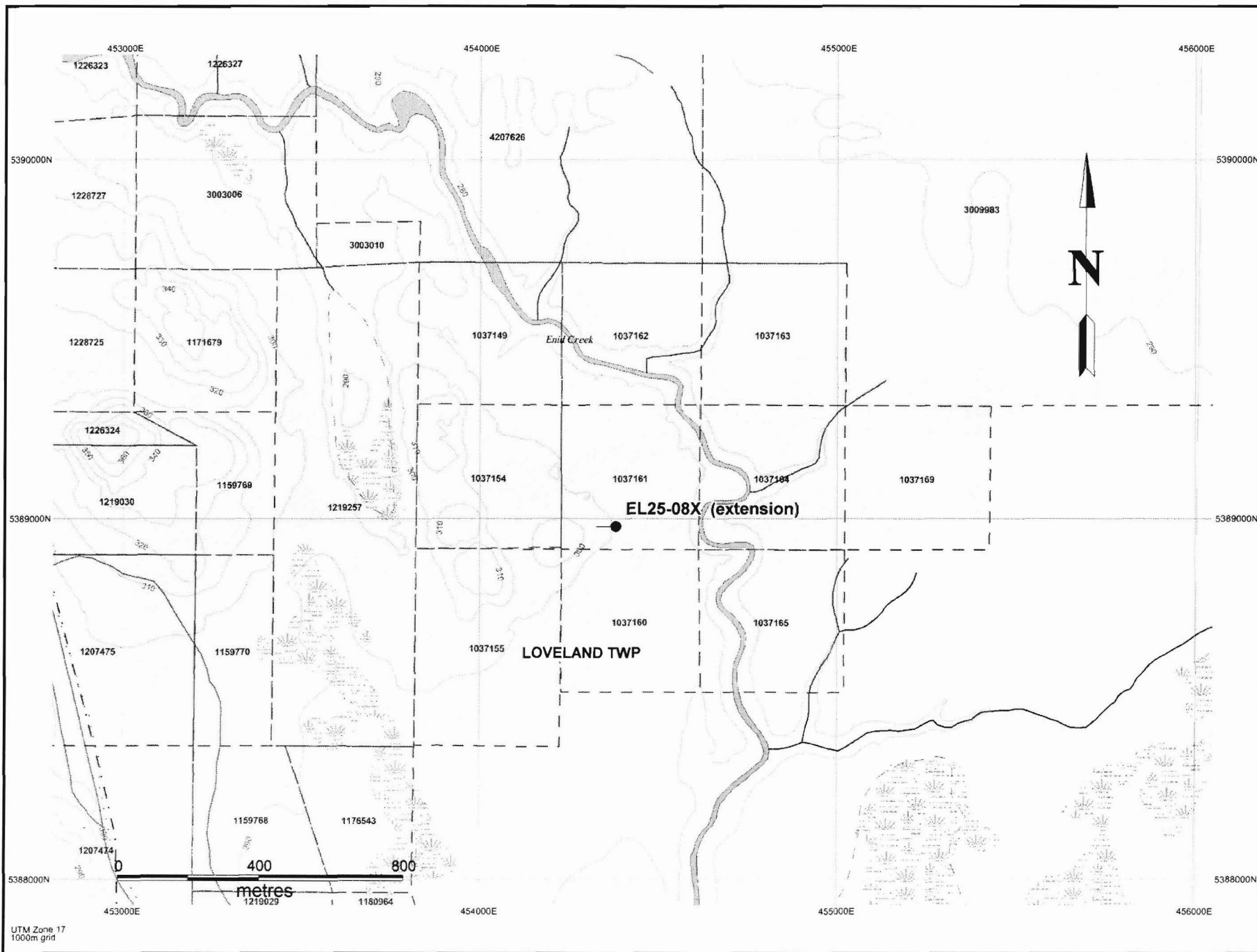

DRILL HOLE LOCATION MAP

INTERNATIONAL EXPLORERS & PROSPECTORS INC.

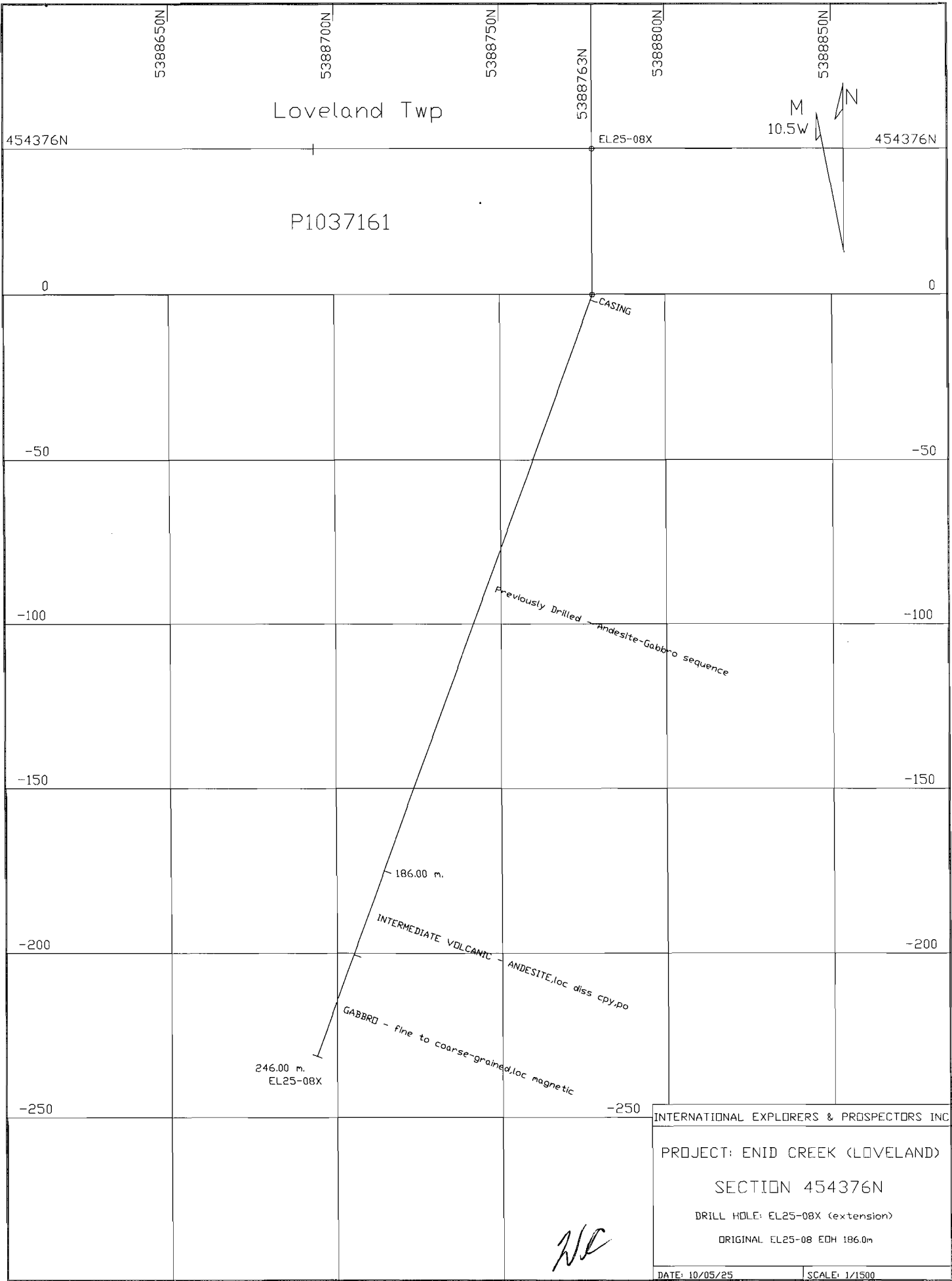

5388650N

5388700N

5388750N

5388763N

5388800N

5388850N

Loveland Twp

454376N

EL25-08X

M
10.5W

N

454376N

P1037161

0

0

CASING

-50

-50

-100

-100

Previously Drilled - Andesite-Gabbro sequence

-150

-150

-200

-200

186.00 m.

INTERMEDIATE VOLCANIC - ANDESITE, loc diss cpy, po

246.00 m.
EL25-08X

GABBRO - fine to coarse-grained, loc magnetic

-250

-250

INTERNATIONAL EXPLORERS & PROSPECTORS INC

PROJECT: ENID CREEK (LOVELAND)

SECTION 454376N

DRILL HOLE: EL25-08X (extension)

ORIGINAL EL25-08 EDH 186.0m

NE

DATE: 10/05/25

SCALE: 1/1500

Under section 8 of the Mining Act, this information is used to maintain a public record. / Aux termes de l'article 8 de la Loi sur les mines, ces renseignements serviront à tenir à jour les dossiers publics.

Hole ID / Forage n° EL25-08X - extension	Claim No. / N° de concession minière P1037161	Township/Area / Canton Loveland
---	--	------------------------------------

Name of Land Holder / No, de International Explorers and Prospectors Inc.	Azimuth 270 °	Dip / Inclinaison -70 °	End of Hole (m) / fin de forage (m) 246.0m	Overburden Depth / profondeur des morts-terrains (1.7m)
---	------------------	----------------------------	---	--

Drilling Company / Compagnie de forage Colbert Drilling	Logged by (print) / Inscrit par (écrire en lettres moulées) W Corstorphine	Core Size / Dimensions de la carotte BQ	Collar Elevation / Elévation du collier Surface
--	---	--	--

Date Hole Started (yyyy/mm/dd) / Date de commencement du forage (aaaa/mm/jj) 2010-05-20	Date Completed (yyyy/mm/dd) / Date d'achèvement (aaaa/mm/jj) 2010/05/24	Date Logged (yyyy/mm/dd) / Date d'inscription au journal (aaaa/mm/jj) 2010-05-25	Location of Core Storage / Endroit où la carotte est stockée Timmins - off Airport Road
--	--	---	--

DRILL HOLE COLLAR LOCATION CO-ORDINATES / COORDONNÉES DU COLLIER DE TROU DE FORAGE	
<u>UTM / MTU</u>	<u>Latitude / Longitude</u> degrees/minutes/seconds or decimal values degrés/minutes/secondes ou valeurs décimales
Datum: <input checked="" type="checkbox"/> NAD 27 <input type="checkbox"/> NAD 83	Datum: <input type="checkbox"/> NAD 27 <input type="checkbox"/> NAD 83
Zone: <input type="checkbox"/> 15 <input type="checkbox"/> 16 <input checked="" type="checkbox"/> 17 <input type="checkbox"/> 18	Latitude:
Northing / Ordonnée: 5388763	Longitude:
Easting / Abscisse: 454376	

Footage/Avancement	Rock type / type de roche	Description (Colour, grain size, texture, minerals, alteration, etc.) / Description (Couleur, granulométrie, texture, minéraux, transformation, etc.)	Planar Feature Angle * / Angle des caractéristiques planes	Core Specimen Footage / Longueur en pieds des carottes prélevées	Your Sample No. / N° d'e hantillon du prospecteur	Sample Footage / Niveau de prélèvement de l'échantillon (en pieds)		Sample Length / Longueur de l'échantillon	Assays / Analyses minéralurgiques
						From/De	To/À		
186.00	Intermedeate	ANDESITE							
	Volcanic	Flow rock - fine-grained, medium grey-green with frequent, randomly distributed paler grey to greenish-grey patches up to .5m in width.							
		Faintly to well defined internal flow-breccia structures over intervals up to a metre or more - rounded to subangular "fragments" forms up to 4-5cm in size.							
		Relatively homogeneous overall appearance.							
		Amygdules relatively common as rounded blebs up to 5-6mm but distribution is intermittent and random, typically in clusters.							
		195.5: appearance of sulphides as rare splash of chalcopyrite and pyrrhotite??							
		Sulphide presence continues downhole but concentrations are low overall - trace to 1% with local concentrations to 2-3% as at through 195.5 to 197.0.							

*For features such as foliation, bedding, schistosity, measured from the long axis of the core. / *Exemples de caractéristiques : foliation, schistosité, stratification. L'angle est mesuré par rapport à l'axe longitudinal de la carotte.

"Mining Lands Website: http://www.mndm.gov.on.ca/mndm/mines/lands/default_e.asp
"Site Web de la Section des terrains miniers : http://www.mndm.gov.on.ca/mndm/mines/lands/default_f.asp"

Footage/Avancement		Rock type / type de roche	Description (Colour, grain size, texture, minerals, alteration, etc.) / Description (Couleur, granulométrie, texture, minéraux, transformation, etc.)	Planar Feature Angle * / Angle des caractéristiques planes	Core Specimen Footage / Longueur en pieds des carottes prélevées	Your Sample No./ N° d'e hantillon du prospecteur	Sample Footage / Niveau de prélèvement de l'échantillon (en pieds)		Sample Length / Longueur de l'échantillon	Assays / Analyses minéralurgiques	
From/De	To/À						From/De	To/À			
			Unit is nonmagnetic except where there is the obvious presence of pyrrhotite.								
			No significant veining – very minor seams of white quartz are rare, white calcite is more common but still rare.								
			The unit is very competent, rare narrow seam of slight stress as at 196.7 oriented at 45 degrees to core axis.								
			204.8: 2cm long by 3mm wide splash of massive pyrrhotite and trace chalcopyrite.								
			Lower contact indistinct – somewhat arbitrary placement based on grain size								
213.35	246.0	Mafic Intrusive	GABBRO								
			Medium to coarse-grained, dark green. Massively textured.								
			Initial section to about 225.0m is generally finer textured with occasional coarse sections of variable width. From about 222.0m onward the Gabbro is weakly magnetic.								
			225.0-235.2: Coarsely textured, massive Gabbro characterized by the presence of darker, blackish-green spotting. Dark patches are typically 1-3mm in size and likely represent phyric hornblende. This section of the Gabbro is moderately magnetic throughout.								
			No significant sulphides were noted in the Gabbro. No notable alteration present.								
			Epidote present in minor amounts related to specific “blemishes” in the unit.								
	246.0		End of Hole								

*For features such as foliation, bedding, schistosity, measured from the long axis of the core. / *Exemples de caractéristiques : foliation, schistosité, stratification. L'angle est mesuré par rapport à l'axe longitudinal de la carotte.

"Mining Lands Website: http://www.mndm.gov.on.ca/mndm/mines/lands/default_e.asp"

"Site Web de la Section des terrains miniers : http://www.mndm.gov.on.ca/mndm/mines/lands/default_f.asp"