

Date Submitted: 18/11/2013
Invoice No.: A12-10057
invoice date: 18/11/2013
Your Reference:

Douglas Lalonde
53 Way Ave
Timmins Ontario
Canada

ATTN: Douglas Lalonde

CERTIFICATE OF ANALYSIS

5 Rock samples were submitted for analysis.

The following analytical package was requested: Code 1D INAA(INAAGEO)

REPORT **A12-10057**

This report may be reproduced without our consent. If only selected portions of the report are reproduced, permission must be obtained. If no instructions were given at time of sample submittal regarding excess material, it will be discarded within 90 days of this report. Our liability is limited solely to the analytical cost of these analyses. Test results are representative only of material submitted for analysis.

Notes:

For values exceeding the upper limits we recommend assays.

CERTIFIED BY :



Emmanuel Esemé, Ph D.

Quality Control



ACTIVATION LABORATORIES LTD.

1336 Sandhill Drive, Ancaster, Ontario Canada L9G 4V5 TELEPHONE +1.905.648.9611 or
+1.888.228.5227 FAX +1.905.648.9613
E-MAIL Ancaster@actlabs.com ACTLABS GROUP WEBSITE www.actlabs.com

Quality Analysis ...



Innovative Technologies

This is your final copy. If you require an original to be mailed by post please advise, otherwise this email will be deemed sufficient.

Invoice No.: **A12-10057**
Purchase Order:
Invoice Date: **28-Sep-13**
Date submitted: **12-Sep-13**
Your Reference:
GST #: **R121979355**

Douglas Lalonde
53 Way Ave
Timmins Ontario
Canada

ATTN: **Douglas Lalonde**

INVOICE

No. samples	Description	Unit Price	Total
5	RX1-T(TIMMINS)	\$ 9.50	\$ 47.50
5	1D	\$ 17.50	\$ 87.50
5	disposal	\$ 0.20	\$ 1.00
Subtotal: :			\$ 136.00
HST-13% :			\$ 17.68
AMOUNT DUE: (CAD) :			\$ 153.68

Net 30 days. 1 1/2 % per month charged on overdue accounts.

Bank Transfers can be made to:
ACTIVATION LABORATORIES LTD at
ROYAL BANK OF CANADA
59 WILSON STREET WEST
ANCASTER, ONTARIO CANADA L9G 1N1
TRANSIT #: 00102 003 ACCOUNT #: 100 154 4
SWIFT CODE#: ROYCCAT2

Please reference the invoice number when making a payment by Bank/Wire transfer. Intermediary Bank Fees are the responsibility of the client.
Thank you!



ACTIVATION LABORATORIES LTD.

1336 Sandhill Drive, Ancaster, Ontario Canada L9G 4V5 TELEPHONE +1.905.648.9611 or
+1.888.228.5227 FAX +1.905.648.9613

E-MAIL ancaster@actlabsint.com ACTLABS GROUP WEBSITE <http://www.actlabsint.com>

Report Date: 18/11/2013

Analyte Symbol	Au	Au
Unit Symbol	ppb	g/tonne
Detection limit	5	0.03
Analysis Method	FA-AA	FA-GRA

37304

29

37305

834

Cancelled

37306

3000

3.03

Cancelled Trip Samples

37307

3000

3.21

Cancelled

Taken From Strip Area

37308

3000

3.13

Cancelled

Report on Prospecting in Cancellation Group

Spent 1 day each man Douglas Johnson
and Bill Blair

Prospecting the striped area. The strip zone is about 300 ft wide and about 500 ft long. The zone is striking at 15-20° NW it is really large mineralized and very altered zone. It is a stock work formation with quartz veins going all direction. The wall rock contains lots and lots of very fine mineral and also some small and large cube pyrite all

through the whole rock system which is striped off. It also contains tourmaline. This was the first visit to the property. We took 5 grab samples to run them for gold we had assays returning from 834 ppb to as high as 3000 ppb and the assay carried 3.03 gms - 3.21 gms on the check assay. \$600.00

Property visit Sept 7/2013 - 2 men x 300.00 each = 600.00
\$200.00
\$200.00
\$200.00
Total 800.00
truck & gas and etc. 100.00 each x 2 = 200.00

10.5° WEST



- Layers**
- Visible
- Divisions
 - Building Points
 - Alienations
 - Federal Lands
 - Parks
 - Pending Claims - Including Filed Only Claims
 - Disposition Symbols
 - Dispositions
 - Pending Disposition Symbols
 - Pending Dispositions
 - Lots & Concessions
 - Buildings
 - Cliff, Pit & Pile
 - Utilities
 - Trails
 - Roads
 - Railways
 - Mine Sites
 - Mine Headframes
 - Towers
 - Contours
 - Swammland

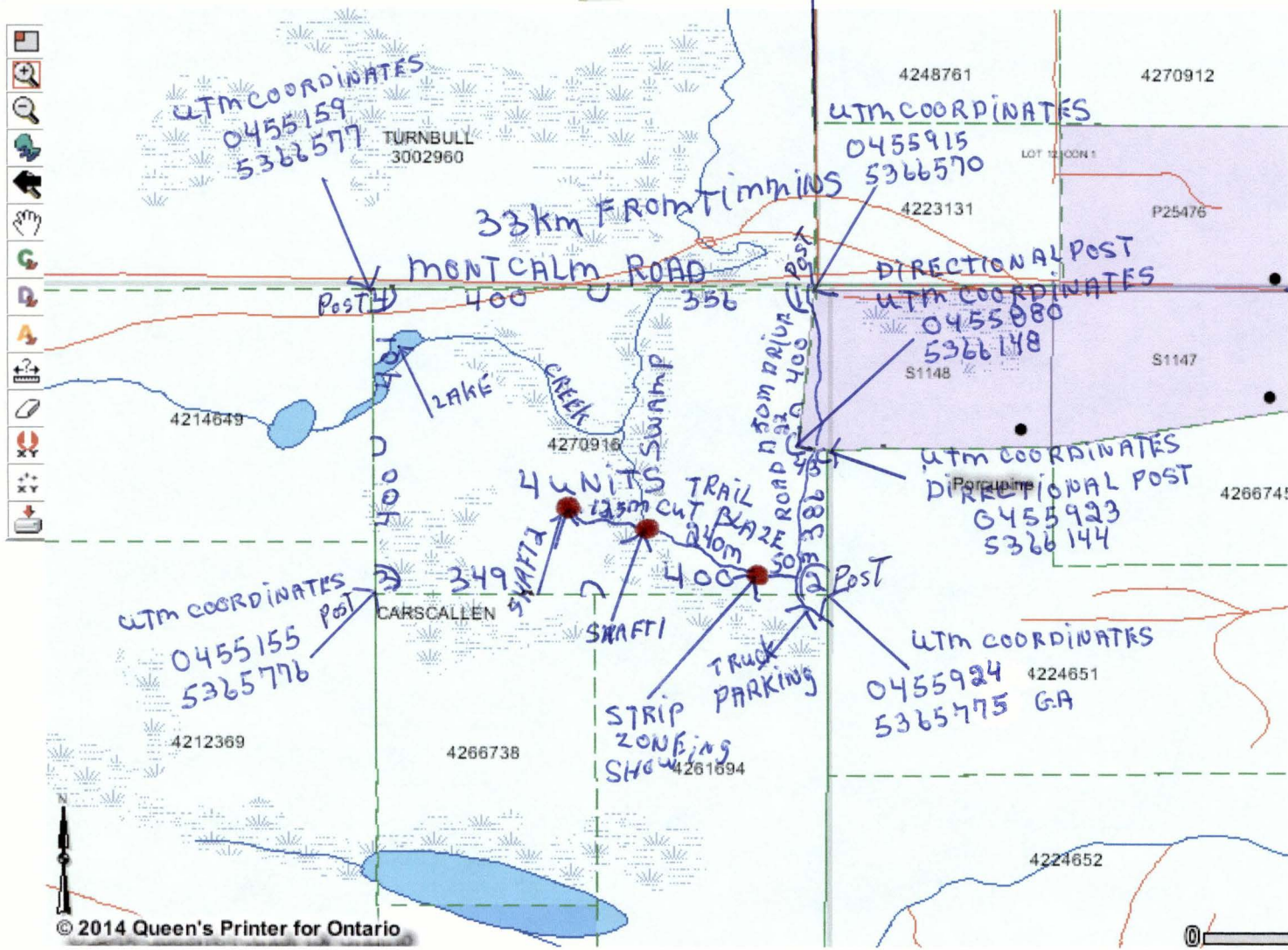

© 2014 Queen's Printer for Ontario

Administrative Boundaries is now the Active Layer

Zoom In

GPS UTM Coordinates

UTM Zone: 15 16 17 u 18

Claim Number	Claim post # 1		Claim post # 2		Claim post # 3		Claim post # 4		Directional post	
	Easting X	Northing Y	Easting X	Northing Y	Easting X	Northing Y	Easting X	Northing Y	Easting X	Northing Y
4270916	5366570	0455915	GA 5365775	GA 0455924	5365776	0455155	5366577	0455159	5366148	0455880
									5366144	0455923

The claim(s) are not recordable, if GPS Coordinates of the claim that meets the Standards for the Geo-referencing of Unpatented Mining Claims is not provided.

TYPE OF G.P.S ETREX LEGEND H GARMIN