

We are committed to providing [accessible customer service](#).
If you need accessible formats or communications supports, please [contact us](#).

Nous tenons à améliorer [l'accessibilité des services à la clientèle](#).
Si vous avez besoin de formats accessibles ou d'aide à la communication, veuillez [nous contacter](#).

2.58178

REPORT OF SAMPLING PROGRAM

DRILL HOLE 07-02-xx

CARSCALLEN TOWNSHIP, ONTARIO

PORCUPINE MINING DIVISION

FOR

INTERNATIONAL EXPLORERS & PROSPECTORS INC.

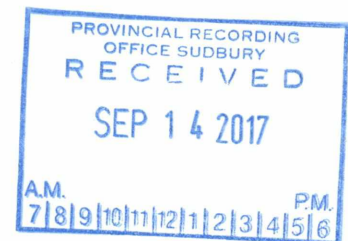

SEPTEMBER 13, 2017

Submitted by: Lionel Bonhomme

Table of Contents

Page 1: Summary, Introduction, Location & Access

ATTACHMENT A Claim Map with sample location section

ATTACHMENT B Certificate of analysis

ATTACHMENT C Original log 6HC-07-02 x Mining lands 2.44755

Summary:

During the month of April 2017 Lionel Bonhomme marked up 29 samples of drillcore on the claims to determine the potential for gold.

Introduction:

The Harron property consists of 3 unpatented mining claims numbered P3016565, P4204349, P4261853 located in Carscallen Township.

Location & Access:

The Harron property is located approximately 30 km west of the City of Timmins, Ontario by travelling 10 km west on highway 101 then to km 15 on the Mallette logging road and then 4 km south on old logging roads.

Regional Geology:

The property is located in the Abitibi Greenstone Belt as identified on map P3379 OGS. The Kidd-Monro assemblage is located on the drill location the City of Timmins boundary where gold discoveries have been made north of the Pipestone fault.

CONCLUSION:

The samples did not extend previously low gold values .



Appendix "A"

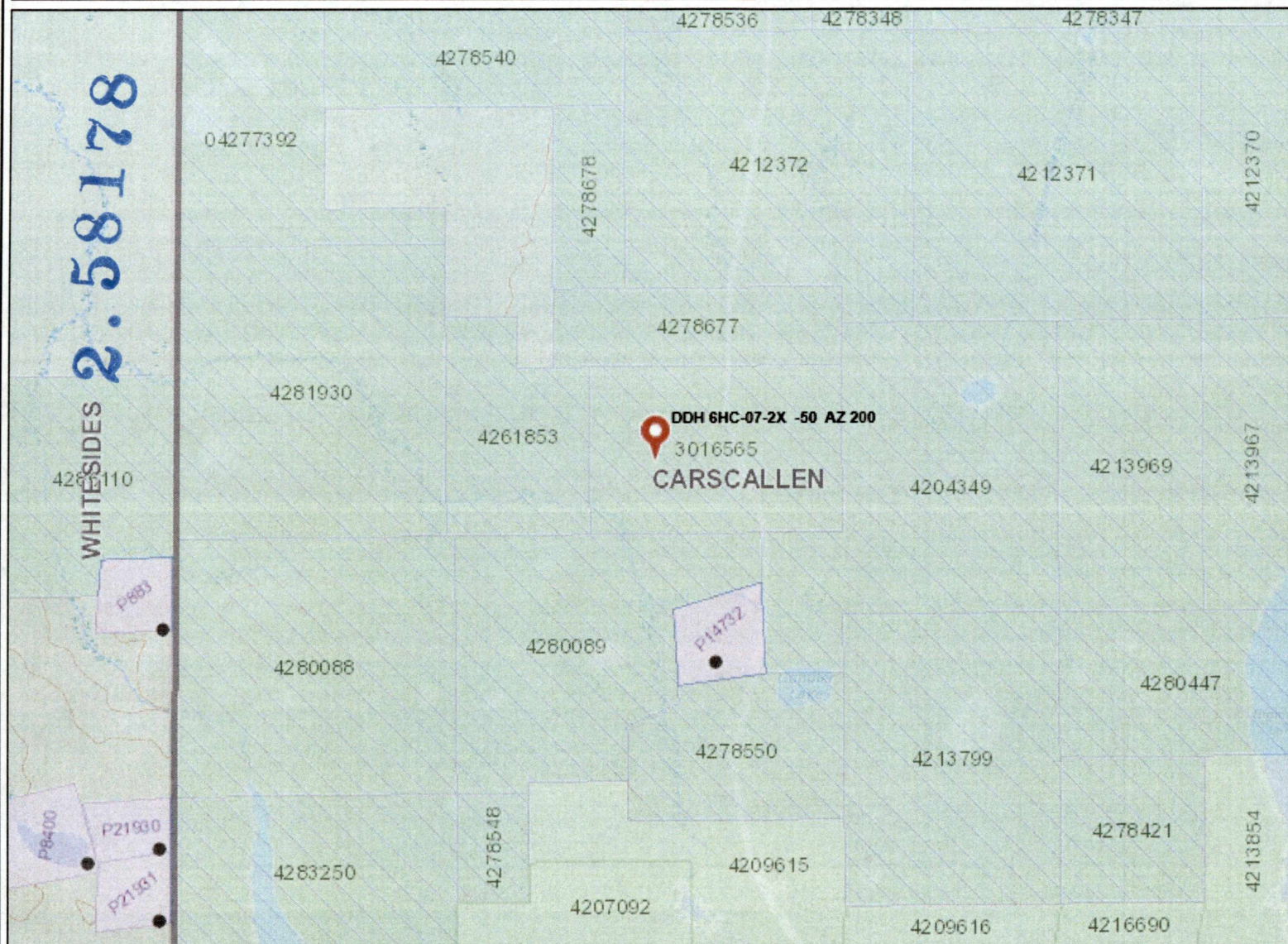

Legend

Administration Boundaries

- Mining Divisions
- Resident Geologist District
- Townships and Areas
- UTM Grid
- Geographic Lot Fabric
- Other Federal Land

Mineral Tenure Grid

- DM TG Tenure Grid

Alienations

- Withdrawal
- Notice

Unpatented Claim

- Active
- Reconciled
- Pending

Disposition

- Disposition

Disposition Symbols

- Camp
- Disposition Unknown/Pending
- Freehold Patent Mining Rights Only
- Freehold Patent Surface Rights Only
- Freehold Patent Surface and Mining Rights
- Land Use Permit
- Leasehold Patent Mining Rights Only
- Leasehold Patent Surface Rights Only
- Leasehold Patent Surface and Mining Rights
- License of Occupation Mining Use Only
- License of Occupation Surface Use Only
- License of Occupation Surface and Mining Rights
- License of Occupation Uses Not Specified
- Order in Council
- Tower
- WPLA

Geology Layers

- AMIS Sites
- AMIS Features
- Drill Holes
- Mineral Occurrences



Projection: Web Mercator



The Ontario Ministry of Northern Development and Mines shall not be liable in any way for the use of, or reliance upon, this map or any information on this map. This map should not be used for: navigation, a plan of survey, routes, nor locations.

© Queen's Printer for Ontario, 2016

Imagery Copyright Notices: Ontario Ministry of Natural Resources and Forestry; NASA Landsat Program; First Base Solutions Inc.; Aéro-Photo (1961) Inc.; DigitalGlobe Inc.; U.S. Geological Survey.

© Copyright for Ontario Parcel data is held by Queen's Printer for Ontario and its licensors and may not be reproduced without permission.

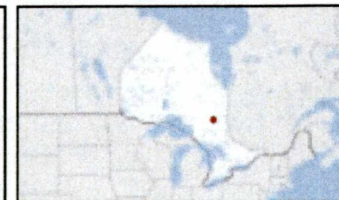

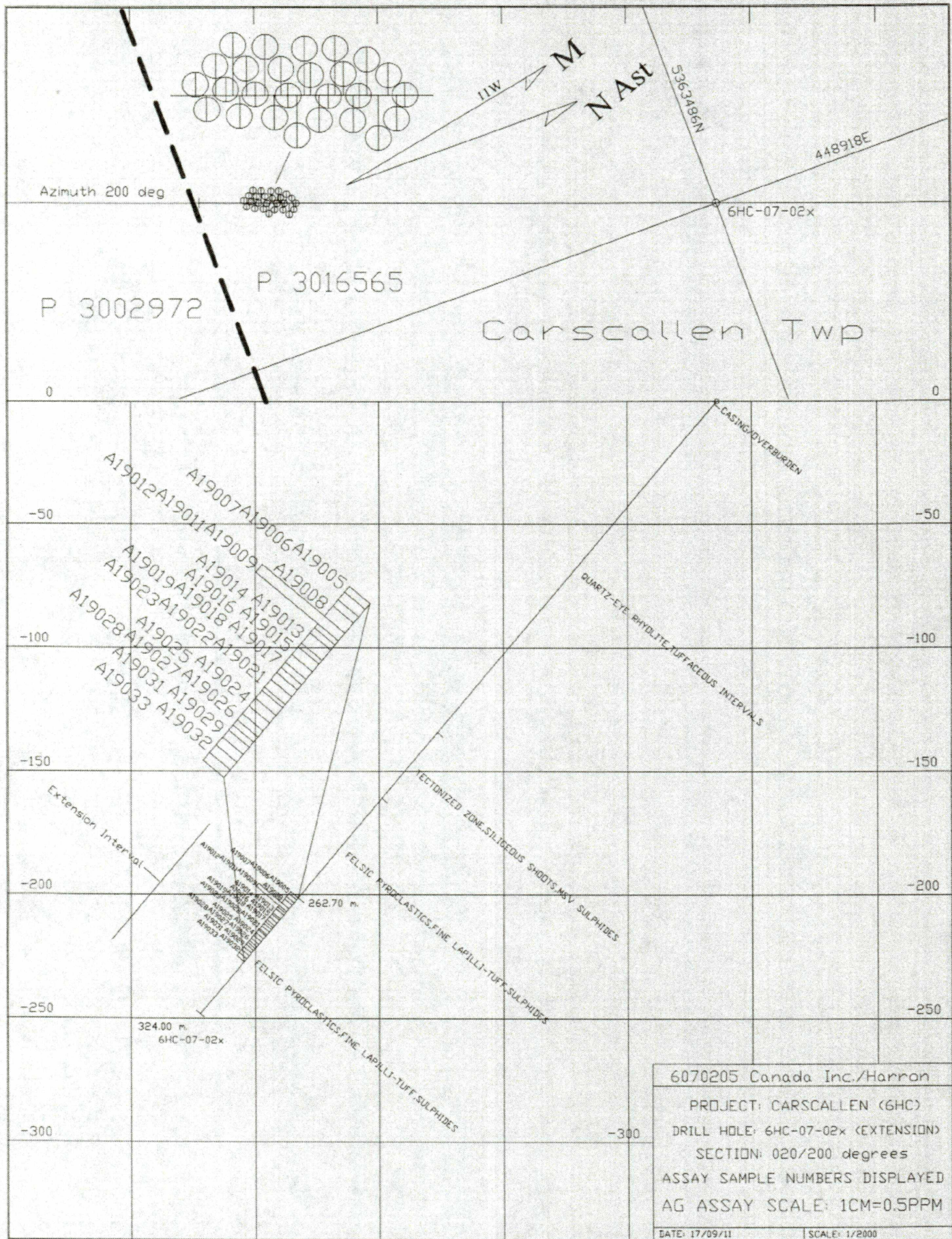

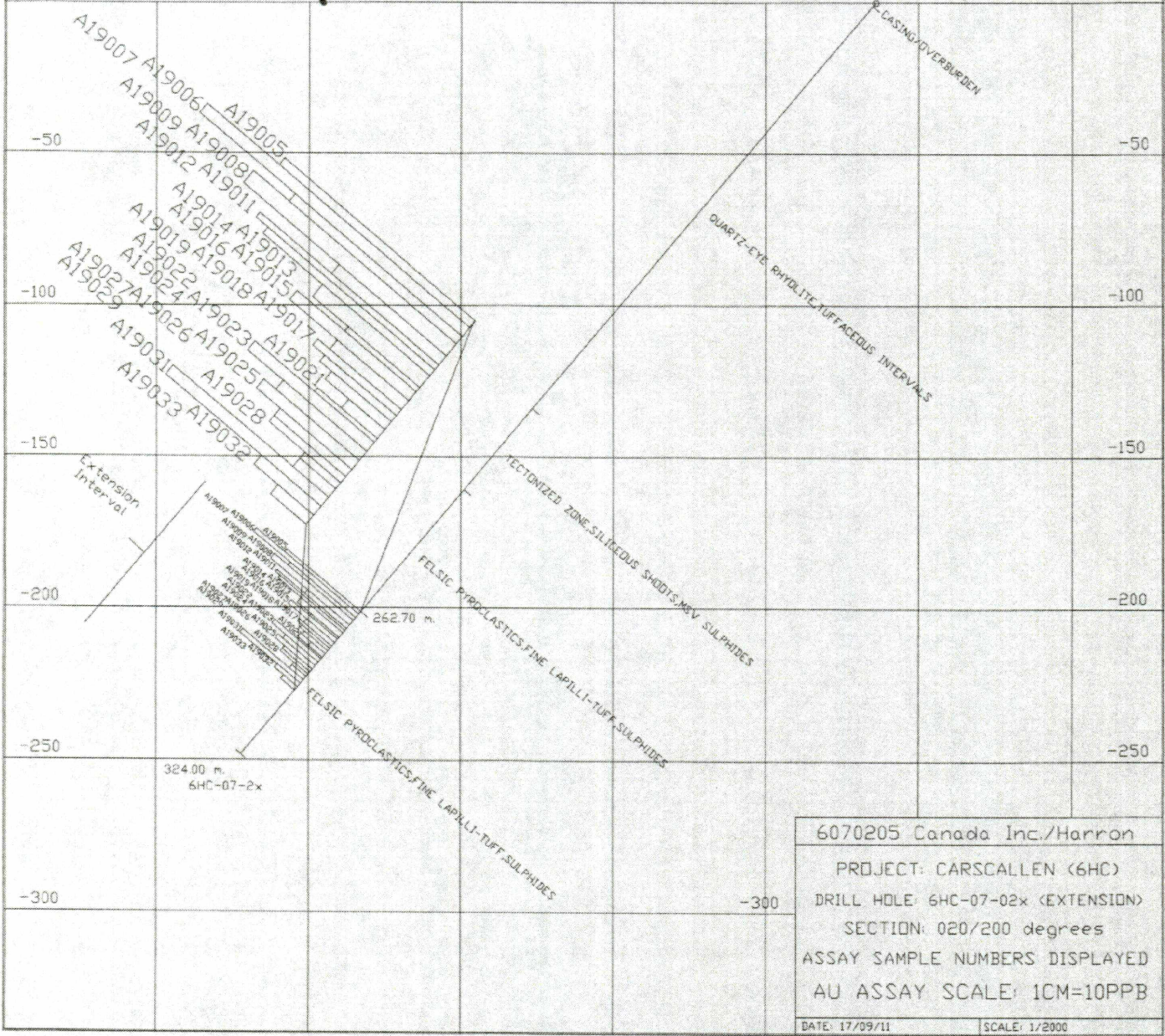
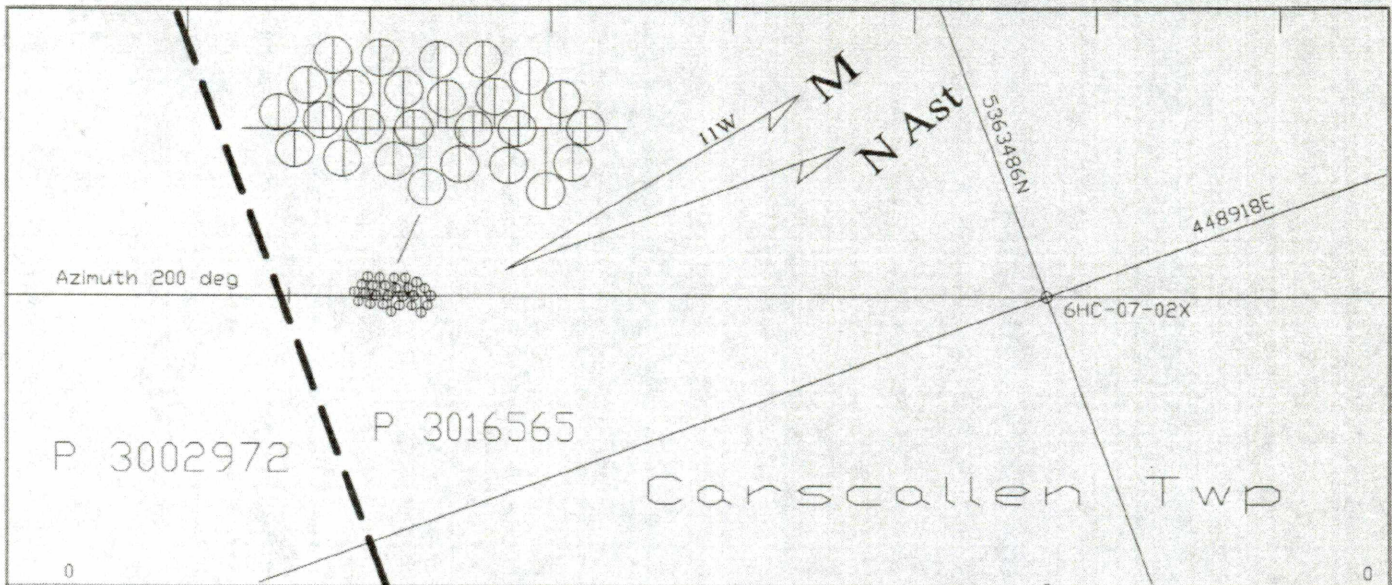

6070205 Canada Inc./Harron
 PROJECT: CARSCALLEN (6HC)
 DRILL HOLE: 6HC-07-02x (EXTENSION)
 SECTION: 020/200 degrees
 ASSAY SAMPLE NUMBERS DISPLAYED
 AU ASSAY SCALE: 1CM=10PPB
 DATE: 17/09/11 SCALE: 1/2000

Appendix "B"

2.58178

Laboratoire Expert Inc.

127, Boulevard Industriel
Rouyn-Noranda, Québec
Canada, J9X 6P2
Telephone : (819) 762-7100, Fax : (819) 762-7510

***** Certificate of analysis *****

Date : 2017/05/25
Page : 1 of 2

Client : International Explorers and Prospectors Inc.	
Addressee : Lionel Bonhomme 168 Algonquin East. Timmins Ontario Canada, P4N 1A9 Telephone : (705) 268-2632 Fax : (705) 268-1725	Folder : 48146 Your order number : Project : 6HC Total number of samples : 29

Designation	Au FA-GEO ppb 5	Au-Dup FA-GEO ppb 5	Au FA-GRAV g/l 0.03	Ag AAT-7 ppm 0.2	Ag-Dup AAT-7 ppm 0.2
A19005	16	13		<0.2	<0.2
A19006	22			<0.2	
A19007	14			<0.2	
A19008	17			<0.2	
A19009	9			0.4	
A19010	4388		4.46	5.2	
A19011	15			<0.2	
A19012	14			<0.2	
A19013	9			<0.2	
A19014	6			<0.2	
A19015	10			<0.2	
A19016	6			<0.2	
A19017	7	5		<0.2	<0.2
A19018	6			<0.2	
A19019	5			<0.2	
A19020	<5			<0.2	
A19021	<5			<0.2	
A19022	5			<0.2	
A19023	10			<0.2	
A19024	7			<0.2	

Patrick Dubé
Patrick Dubé, Assistant Manager

Laboratoire Expert Inc.

127, Boulevard Industriel
 Rouyn-Noranda, Québec
 Canada, J9X 6P2
 Telephone : (819) 762-7100, Fax : (819) 762-7510

***** Certificate of analysis *****

Date : 2017/05/25
 Page : 2 of 2

Client : International Explorers and Prospectors Inc.			
Addressee : Lionel Bonhomme 168 Algonquin East.		Folder : 48146	
Timmins Ontario Canada, P4N 1A9	Telephone : (705) 268-2632 Fax : (705) 268-1725	Your order number : Project : 6HC	Total number of samples : 29

Designation	Au FA-GEO ppb 5	Au-Dup FA-GEO ppb 5	Au FA-GRAV g/t 0.03	Ag AAT-7 ppm 0.2	Ag-Dup AAT-7 ppm 0.2
A19025	8			<0.2	
A19026	6			<0.2	
A19027	6			<0.2	
A19028	<5			<0.2	
A19029	<5			<0.2	
A19030	4286		4.39	5.3	
A19031	13			<0.2	
A19032	5			<0.2	
A19033	<5			<0.2	

Location Map

2.58178

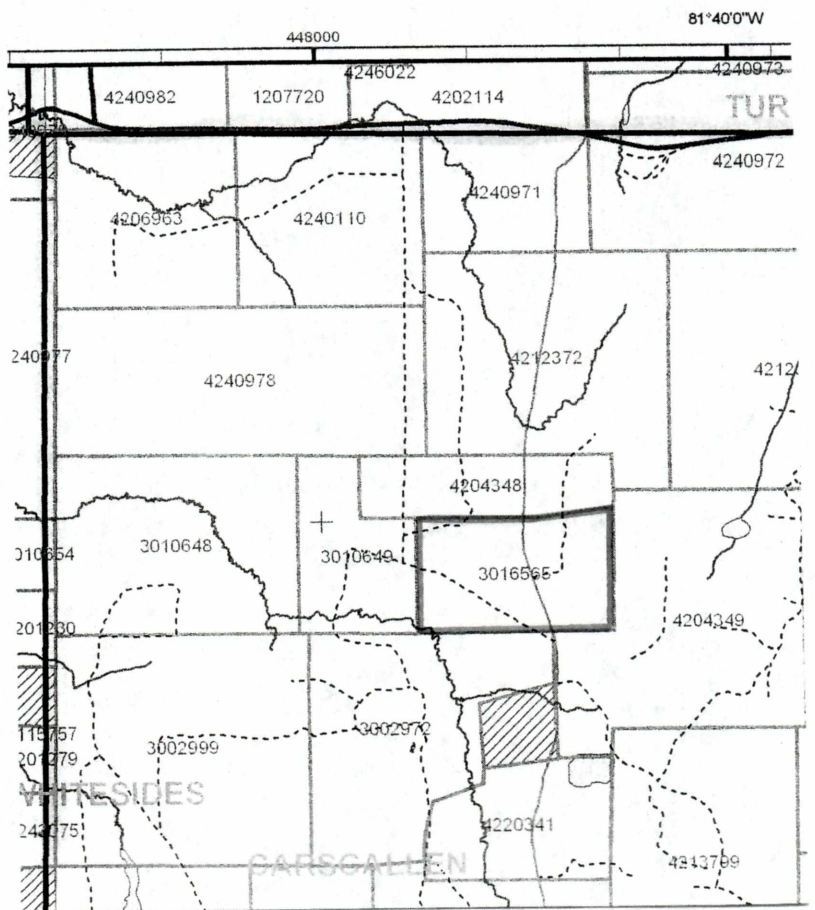

Scale 1:50 000

Date Rec'd in RGO 15-Jun-10	Year of Work 2010
Company Harron, G.A. / 6070205 Canada Inc.	
Twp / Area(s) Carscallen	
Type of Work DD - 1 - 324m	
Mining Lands GAO Number 2.44755	Office File Number T-6078

27.44755

DUPLICATE
COPY

REPORT OF DIAMOND DRILLING

FOR G. HARRON & 6070205 CANADA INC

CARSCALLEN TOWNSHIP

PORCUPINE MINING DIVISION

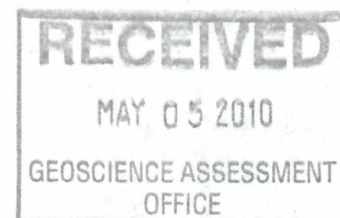

T - 6078

Submitted by Lionel Bonhomme
May 2, 2010

Table of Contents

Page 1:	Property Description, Drill Program, Location & Access, Topography, Geology
Page 2:	Previous Work, Summary
Page 3:	Regional Location Map
Page 4:	Claim Sketch
Page 5:	6HC-07-02X Drill Hole Plan
Page 6:	6HC-07-02X Drill Hole Section
Page 7-8:	6HC-07-02X Core Log

T - 6078

Property:

6070205 Canada & G. Harron acquired claim 3016565, consisting of 8 units in May 2004. Claims 4204348 and 4204349 were later acquired in September 2006.

Drill Program:

A one drill hole program consisting of 263m was commenced on December 4, 2007 and completed on January 20, 2008. The purpose of the drill hole was to test the Volcanic Massive Sulphides 50m east of drill hole 6HC-06-01. On April 26, 2010 a drill was sent to the property to extend the drill hole.

Location & Access:

The property is located 30km west of the City of Timmins in the District of Cochrane, Porcupine Mining Division, NTS 42 A05 in the Township of Carscallen. Access is available by following Highway 101 west and turning on Mallette logging road for a distance of 16km. Then turning south on a gravel road to the property.

Topography:

The area has been logged extensively and has a young growth of spruce, poplar and birch with small clusters of cedar. Water is available from nearby casings or a small creek that crosses the southern portion of claim 3016565.

Geology:

Kidd Assemblage Volcanic underlies the property as documented by OGS from a sample taken on the property. Exploration work to date had indentified mafic, felsic, Ultramafic and diabase dykes. Massive sulphides of sub-economic values have been encountered on the property.

Previous Work:

1926 – Ontario Bureau of Mines (Township Mapping)

1965 – Mepsi Mines, Diamond Drilling

1989 – Airborne Geophysical Survey Funded by The Ministry of Mines

1989 – Finneth Exploration, Diamond Drilling

1992 – BHP Minerals, Prospecting, Geology & Geochemistry Program

1993 – Falconbridge, Magnetic & HLEM Geophysical Surveys, Mapping With Geochemical Sampling

1998 – The Carscallen Syndicate Extended the Finneth Drill Hole

1997-2000 – Explorers Alliance Corporation Completed 7 Drill Holes & An IP Survey Over Select Lines

1997-2000 - Explorers Alliance Corporation Completed Geotem And Megatem Surveys

Summary:

This drill program was successful in confirming the strike of geological contacts and Sulphides associated with the contact. The extension is ongoing to determine the extent of a pyrite stringer zone and determine the next geological contact.

T - 6078



6070205 Canada Inc.

T-6078

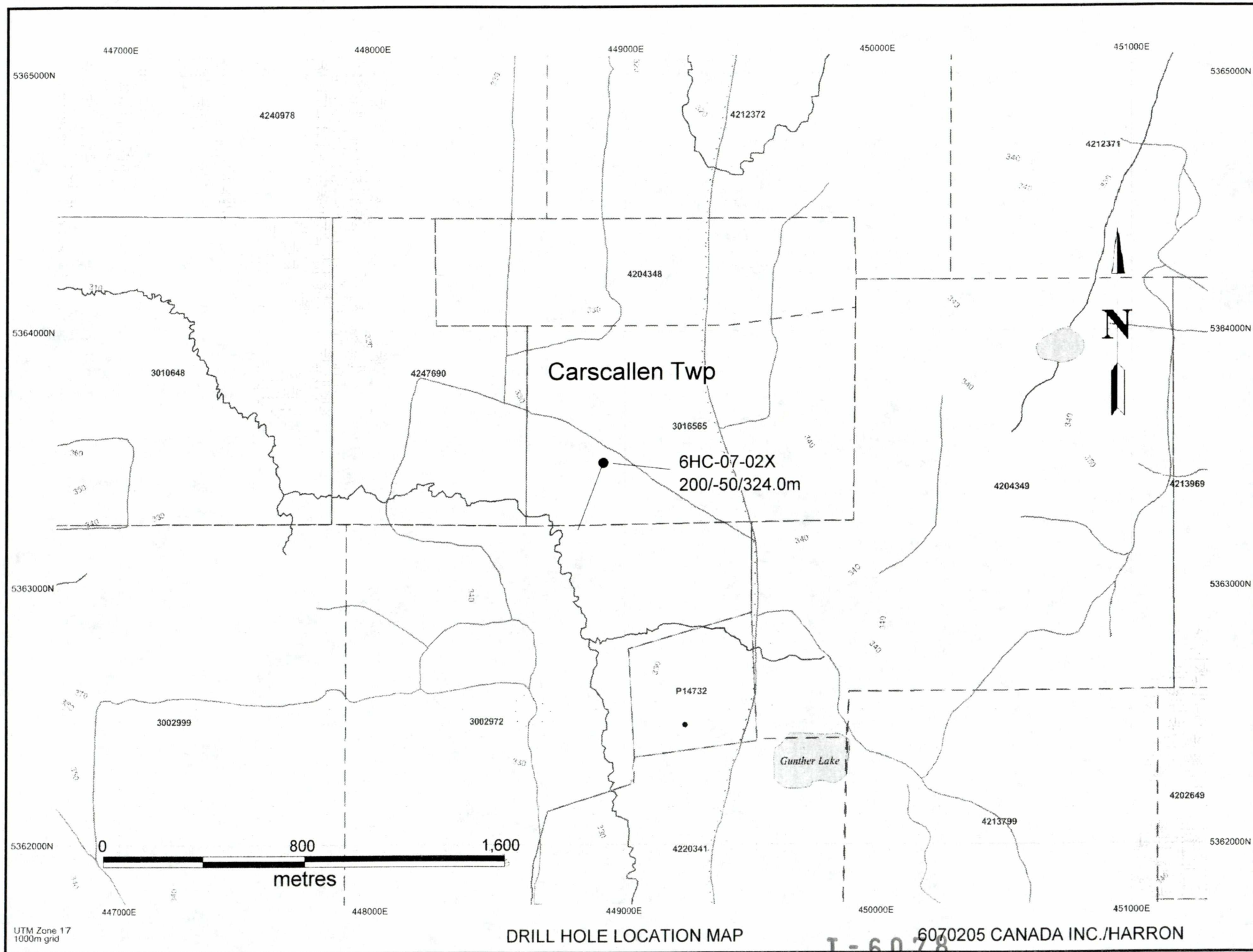

Carscallen Twp

6HC-07-02X
200/-50/324.0m

Gunther Lake

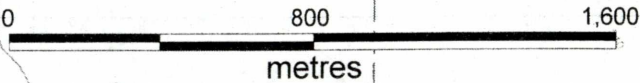

DRILL HOLE LOCATION MAP

6070205 CANADA INC./HARRON

T-6078

UTM Zone 17
1000m grid

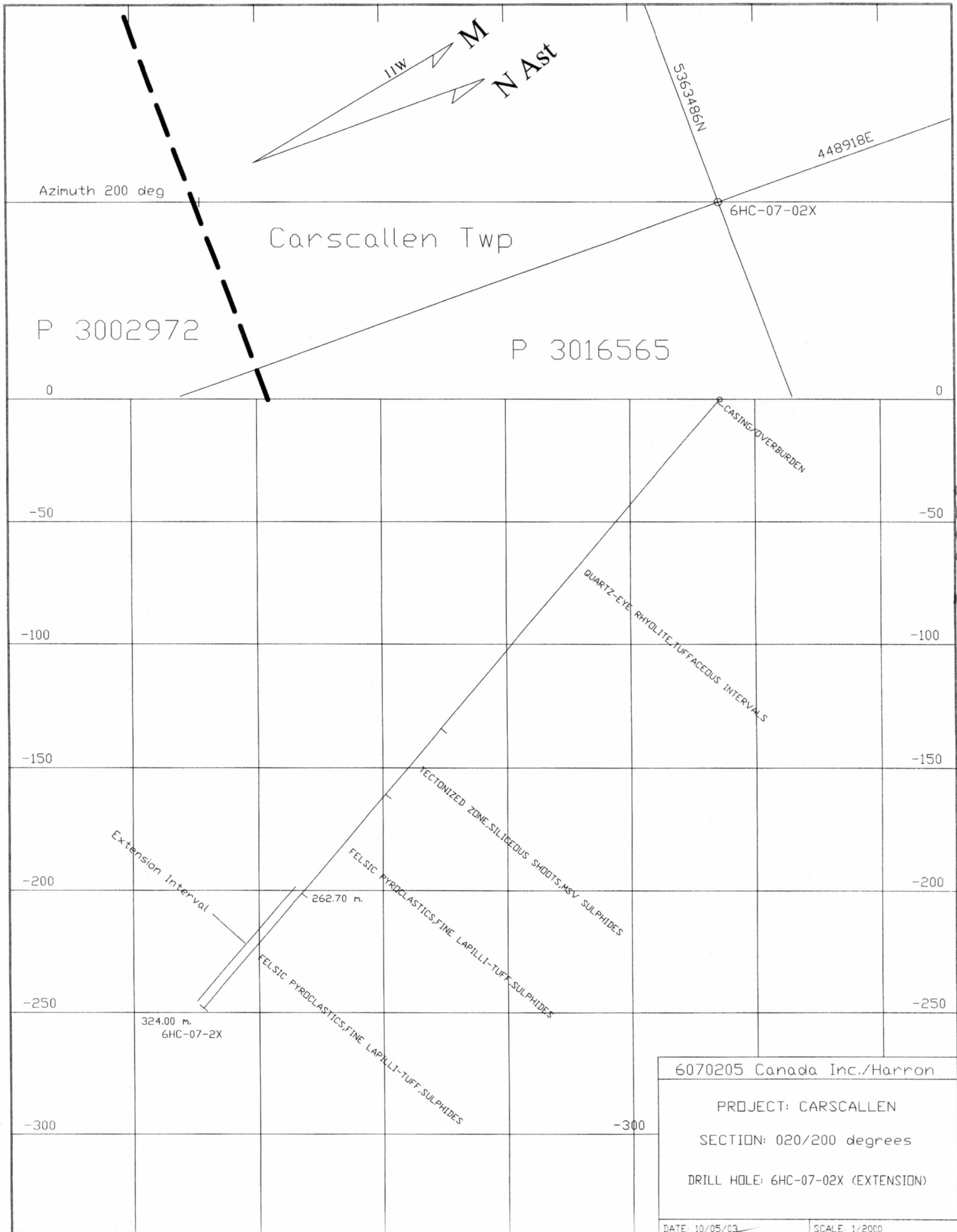

1-6078

1/10/03

DIAMOND DRILL LOG

Drillhole Name: 6HC-07-02X (extension)			Project Name: Carscallen/Harron			Azimuth: 200° Dip: -50° E.O.H. 324.0m			Orientation Tests: (azimuth / dip)			Test Type:			
Drill Log For: 6070205 Canada Inc & Harron			Started: April 27, 2010			Bit Size: BQ / NQ / HQ			Depth	Azimuth /	Dip	Depth	Azimuth /	Dip	
Drilling Contractor: Colbert Drilling			Ended: April 30, 2010			Casing Length: Pulled: Yes / No			/	/	/	/	/	/	
Collar Easting (UTM): 448918mE (NAD83)			Township: Carscallen			Geologist's Name: W Corstorphine			/	/	/	/	/	/	
Collar Northing (UTM): 5363486mN (NAD83)			Claim: P 3016565			Geologist's Signature: <i>W. Corstorphine</i>			/	/	/	/	/	/	
Core Storage: Timmins, Airport Road			Comments: ddh extended to 324.0m			Date Logged: May 2, 2010			/	/	/	/	/	/	
Meterage			Rock Type			Description			Pyrite	Sample Intervals		Sample	Sample No.	Assays	
From	To	Length				Colour, Grain Size, Texture, Minerals, Alteration, etc.			%	From	To	Length			
262.70	324.00	61.30	Felsic Pyroclastic -			Original drill hole 6HC-07-02 extended 61.3 metres from previous eoh of 262.7m.									
			Tuff-Fine Lapilli-tuff			Same as 210.0-262.7m in all respects - see description in original log.									
			Sulphide Associated			Overall colour varies between dark green to pale greenish grey. Complete mixing of these colours. The greyer shades are best seen on dry core and tend to be of subtle and indistinct extent.									
						Grain size in both darker greens areas and grey areas is fine to very fine and in the case of the grey patches aphanitic except for the scattered presence of mm-scale green blebs always present in the grey groundmass.									
						The grey segments and irregular patches comprise about 20-60 percent of the unit and are thought to be felsic (rhyolitic) fragments and lapilli which appear to be hosted by chlorite-rich matrix material of either primary iron-rich volcanic material or chlorite-altered rock.									
						The contacts between the "felsic" fragmental material and the more mafic-looking host rock range between sharp and diffuse.									
						Some sections display variable quantities of thin, stretched lapilli of greyish colour while elsewhere the felsic material form large cm-scale masses up to 10 and 20cm. The relative distributions are completely variable - a complex distribution.									
						A third significant component in the interval is a paler grey, siliceous, very fine-grained material carrying magnetite as small crystals at 3-5% and fine to coarse crystal pyrite at 3-15% concentrations. This component is distributed in a seemingly random fashion throughout the section although it appears to diminish through 291.0m and assumes a less significant role toward the end of the hole. This magnetite-pyrite-silica component appears to behave as an intrusive, vein-like material coursing randomly through the unit where present in variable amounts from 1-2% as thin irregular veinlet up to widths of 20 to 30cm where strongly developed. No other sulphides were readily identified in these									

T - 6078

DIAMOND DRILL LOG

Hole Name: 6HC-07-02X							Date: May 3, 2010	Page # 2			
Meterage			Rock Type	Description Colour, Grain Size, Texture, Minerals, Alteration, etc.	Pyrite %	Sample Intervals		Sample Length	Sample No.	Assays	
From	To	Length				From	To				
				<p>"shoots".</p> <p>The largest patch of siliceous "shoot" material occurs at 279.1-279.4 and it contains several large "clumps" of very fine dark green chlorite.</p> <p>The contacts between the siliceous vein-like component and host rocks is generally sharp but very irregular and often ragged.</p> <p>After 290.0 there is a 5% concentration of variably distributed intercalated white, calcite - rich, largely conformable vein-like material. Past 291.0 there is only a trace amount of pyrite related to any specific rock component.</p> <p>The section displays a strong overall streaky-type of fabric that varies in orientation between 25 and 60 degrees to core axis with a more frequent range of between 30 and 50 degrees.</p> <p>This section of rock appears to be a rhyolitic sequence of pyroclastic material that has either undergone strong chlorite alteration with attendant magnetite or has been deposited into an iron formation-type of environment.</p> <p>All rocks are relatively hard and assumed to be "siliceous" even much of the material that looks to be of "mafic" composition.</p> <p>Some core angle include:</p> <p>263.2: 60 degree fabric.</p> <p>285.4: 30-45 degree fabric.</p> <p>286.7: 40 degree fabric</p> <p>273.7: 30 degree fabric.</p> <p>296.8: 40 degree fabric.</p> <p>302.6: 30 degree fabric.</p> <p>310.6: 35 degree fabric.</p> <p>316.6: 30 degree fabric.</p> <p>323.0: 40 degree fabric.</p> <p>Two small quartz veinlets noted - both concordant to fabric, one at 289.08 (1.5cm) the other at 289.88 (2.5cm). No significant sulphides noted.</p>							
	324.00			End of Hole							

Project	DDH	From	To	Sample number
6HC-07	2X	262.7	263.8	A19005
6HC-07	2X	263.8	265.3	A19006
6HC-07	2X	265.3	266.5	A19007
6HC-07	2X	266.5	268.5	A19008
6HC-07	2X	268.5	270	A19009
6HC-07	2X	270	270.8	A19011
6HC-07	2X	270.8	271.8	A19012
6HC-07	2X	271.8	273.8	A19013
6HC-07	2X	273.8	274.5	A19014
6HC-07	2X	274.5	276	A19015
6HC-07	2X	276	277.5	A19016
6HC-07	2X	277.5	278.5	A19017
6HC-07	2X	278.5	279.5	A19018
6HC-07	2X	279.5	280.8	A19019
6HC-07	2X	280.8	282.3	A19021
6HC-07	2X	282.3	282.9	A19022
6HC-07	2X	282.9	284.4	A19023
6HC-07	2X	284.4	285.9	A19024
6HC-07	2X	285.9	287.4	A19025
6HC-07	2X	287.4	288.6	A19026
6HC-07	2X	288.6	289.6	A19027
6HC-07	2X	289.6	290.6	A19028
6HC-07	2X	290.6	292	A19029
6HC-07	2X	292	293.5	A19031
6HC-07	2X	293.5	295	A19032
6HC-07	2X	295	296.5	A19033