

We are committed to providing [accessible customer service](#).  
If you need accessible formats or communications supports, please [contact us](#).

Nous tenons à améliorer [l'accessibilité des services à la clientèle](#).  
Si vous avez besoin de formats accessibles ou d'aide à la communication, veuillez [nous contacter](#).

2017 assessment report for claims 4275710 and 4275711.

#### Location and access:

Both claims are located in Pardee township on the historic Stuart Location. They can be accessed off Hwy 61 50 km south of Thunder Bay. Turn onto Hwy 593 for 2.8 km. Park at yellow gate. Property is accessed through a series of old logging roads starting right here.

#### History:

The Stuart location was originally explored in the latter half of the 1800's for silver/copper potential. There is an old adit/ shaft combination which we were able to locate at 16 U 303489 5321204. (It took a couple of trips to locate as the map that I originally saw it on was pretty vague and the terrain is very steep and grown over and very hard to move around on). The adit goes in about 25 meters with a short drift with a short 4meter shaft.

A second wave of exploration happened with the discovery of The Great West Nickel prospect in the late 1920's(?). That's when I believe the Copper Bar and the Stuart dike trenches were put down. The area was explored numerous times between then and 1970 when the last report was done on these trenches. Since then it has been staked and explored numerous times but no work or even mention of these two locations comes up. The ministry had no idea these trenches were there.

In June 2015 I found this old report ,

<http://www.geologyontario.mndm.gov.on.ca/mndmfiles/afri/data/imaging/52A04SW0106/52A04SW0106.Pdf>

and it was misplaced on the map to the west slightly. This I believe is why there was no work done or mention of it since.

Most importantly no drilling or record of such has taken place on these two locations to date.

#### 2015 work program:

The main objective was to locate all the old trenches and the old adit from the above report and clear the trails/old roads into both of the showings.

We went in and located The Copper Bar occurrence and the three main trenches there before we staked the property on June 20<sup>th</sup> 2015. From what we saw we decided to come back and stake the property.

We were able to locate everything except for trench #1 on the Stuart Dike.

June 20 2015: First trip onto the property was to see what we could find. This was before we staked it. Spent half the day exploring and clearing the trail to find our way over to where we suspected Copper Bar to be. After a few traverses we notice a higher area to the north of the road and once in we soon located the Copper Bar Dike, on the eastern end it rises up out of the flats like the prow of a ship. It is about 20m tall on the eastern end and

is about 150m long by 15 to 35 m wide. Upon getting up on top we soon found the first trench and after a quick inspection decided to come back and stake the area. We then stopped at the Stuart dike on the way out and within an hour found an old pit with some good cpy and called it a day.

July 12 2015: Now that we had staked the showings we returned on the 12th of July and spent the day prospecting. We first went to Copper bar where we located two trenches and a pit in between the trenches and two more pits to the west another 20m or so. We took some samples from both trenches and the pits. We didn't do any assays at this point but will be mentioning them in the 2016 report. The whole Copper Bar area is all a medium to fine-grained gabbro. It varies in colour and is a little more rusty in the trench to the west. There is also slightly higher amount of mineralization on the west end of Copper Bar East. The total amount of sulfide content is around 15 to 20% in the trenches. Mineralization is 65%pyrrhotite and 35%chalcopyrite. Trench #1 can be found at 16 U 304860 5322624. Trench #2 at 16 U 304807 5322591 and Trench #3 at 16 U 304790 5322589.

We then did a traverse at the Stuart Dike location and found what later turned out to be trench #2 and trench #3. The area is a Diabase Dike but the trenches all are sunk in rusty coarser grained Diabase while the mineralization is usually in or next to coarse grained gabbro(possibly olivine). We took samples at these two locations. The mineralization is overall less than Copper bar at maybe 15% of the total rock content and consists of 60%pyrrhotite and 40%chalcopyrite. Later Rio Tinto assayed a rock from a pit between these two trenches and got around around gram combined PGE's. I do not have a copy of their assay results. This ended up prompting a property visit but did not lead anywhere with them.

Trench #2 is located at 16 U 303203 5321045. Trench #3 at 16 U 303289 5321090 and the pit with the good sample coming from a small pit at 16 U 303270 5321072. Rio Tinto assayed the sample from the small pit. These were the results:

Au	Pt	Pd	Cu	Ni
----	----	----	----	----

0.232	0.366	0.379	1.72	.429
-------	-------	-------	------	------

I will be claiming a full day for two people plus travel km's for July 12.

August 16 2015: We spent about half the day looking for the west trench of the Copper bar showing. Eventually we located it at 16 U 304604 5322501. Examined the trench and the area for the rest of the day. We sampled the trench and two other spots near by.

I will not be claiming credit for this day as the claim had expired by the time the ministry got around to reviewing the assessment work.

September 19 2015: We spent the day on claim 4275711 looking for the adit. We knew that if we could find it we could use it to position our selves to find the rest of the six trenches of the Stuart Dike. We had no luck but did find what later turned out to be trench

#4 at 16 U 303395 5321141. The area is a Diabase Dike but the trenches all are sunk in rusty coarser grained Diabase while the mineralization is usually in or next to coarse grained gabbro (possibly olivine). Mineralization in Trench #4 is also pyrrhotite and chalcopyrite.

I am claiming a full day of assessment credits for two people for September 19<sup>th</sup> plus km's for travel.

October 4<sup>th</sup> 2015: Again we searched for the Adit and ended up finding the shear zone first and then the adit a little lower down in it at 16 U 303489 5321204. As soon as we found it we were able to orient our selves and soon we found trench #5 at 16 U 303464 5321289 and then shortly after trench #6 at 16 U 303572 5321363. We now confirmed trench three at 16 U 303289 5321090. And trench two at 16 U 303203 5321045.

I am claiming a half day for two people of assessment credits and travel km's as the adit, trench #5 and #6 are located on the claim that has since expired.

October 11<sup>th</sup> 2015: We returned to try and now find trench #1, the only one we had not found yet. After 2 hours searching for it we gave up and re visited trench #2, 3, 4 and then did another traverse up near #5 and #6. We finished off the day cleaning up the trail a bit so we could quad further in towards the trenches.

I am claiming .75 of a days credit for two people plus driving km's as we spent a few hours on a claim that has since expired.

November 1st 2015: We spent the day mostly on 4275710 searching for the Copper Bar North trench we had read of in the report. After a number of traverses we found it at 16 U 304756 5322869. The Copper Bar north trench was in a finer grained gabbro with mostly pyrrhotite and the odd speck of cpy. The trench is about 4 meters long and 1 meter deep. We sampled it but have never assayed it. Then we went to look at a rusty spot we had found to the west while staking 4267973. The first visit to the area around 16 U 303862 5322576 turned up nothing real great and we called it a day.

I am claiming .75 of a day for two people for assessment credits plus driving km's as about a quarter of the day was spent on a claim that has since expired.

September 10 2016. We brought Lakehead University student Matthew Melchiorre out to Copper bar to collect samples for his Thesis. I am including the results from Matt's work. I am claiming a full day of assessment credit for two people plus travel km's for driving Matt out there, providing an atv to get into the Copper Bar site and showing him around and helping photograph, sample and carry out the samples.

I was hoping to submit a number of maps with gps tracks but could not get my computer to talk with google earth at this time. I still can not get my map program to talk with google earth but I have printed out traverse maps using Garmin Base Camp.

Totals of what we are claiming:

July 12 2015- One full day, Two people=\$500

September 19 2015- One full day, Two people=\$500

October 4<sup>th</sup> 2015-One half day, Two people=\$250

October 11<sup>th</sup> 2015-.75 of a day, Two people=\$375

November 1st 2015-.75 of a day, Two people=\$375

September 10 2016- One full day, Two people=\$500

6 return trips at 140 km per trip=840km x\$.50= \$420

1.5 days working on the two versions of this report=\$375

This equals a total of \$3295 to be divided up equally between claim # 4275710 and claim # 4275711.

Since 2015 we had had two property visits with companies and one visit with the MNDM. The property was a recommended property in the 2017 recommendations, and also was the subject of a Graduate Thesis from Lakehead University.

Peter Gehrels

4275710 + 4275711



Global Map

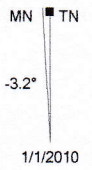
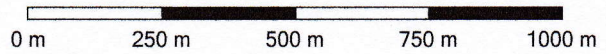

12.07.15

GARMIN.

1/1/2010

4275710

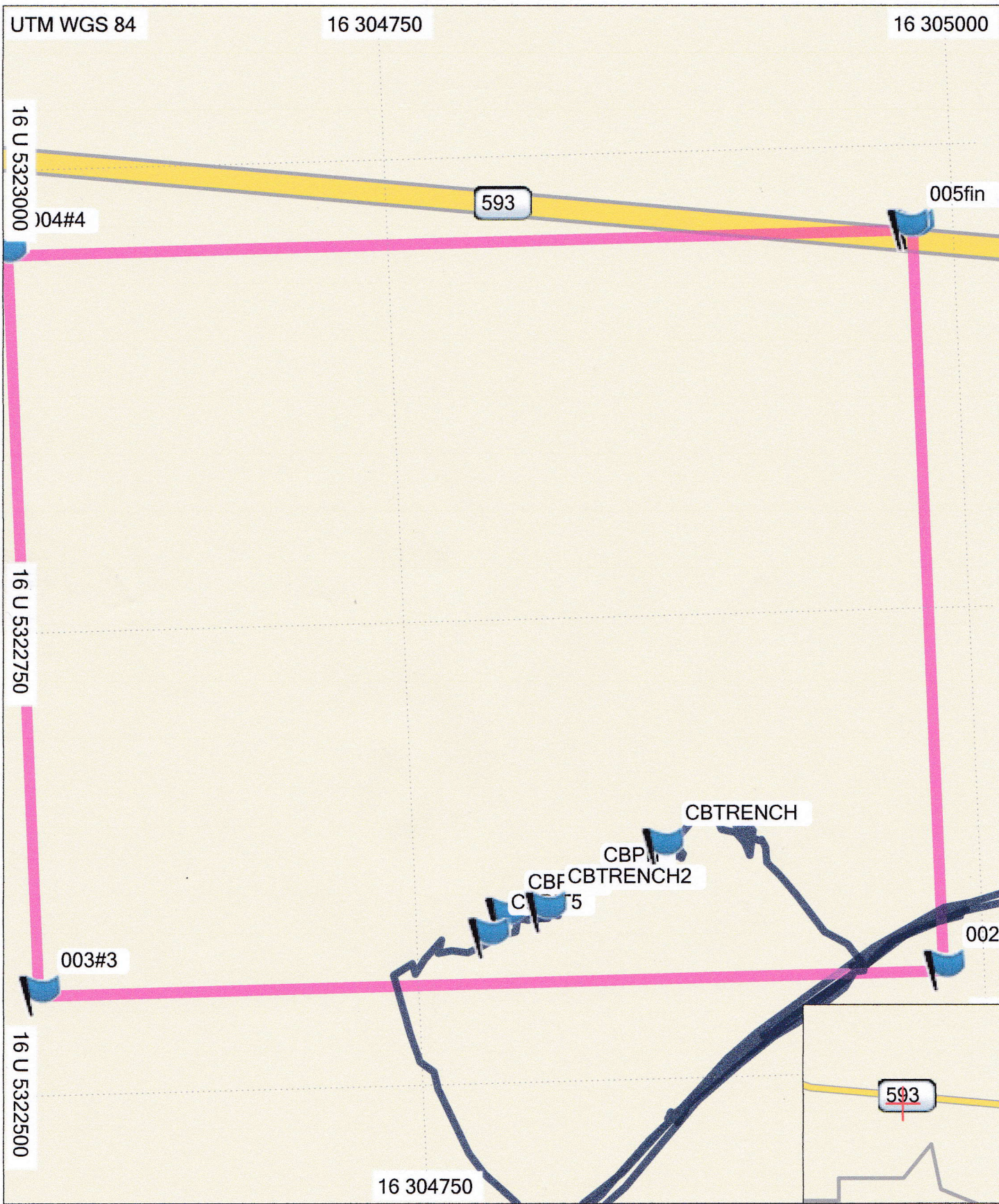

Global Map

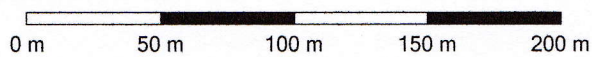

MN TN

-3.2°

12.07.15

GARMIN.

1/1/2010

4275710

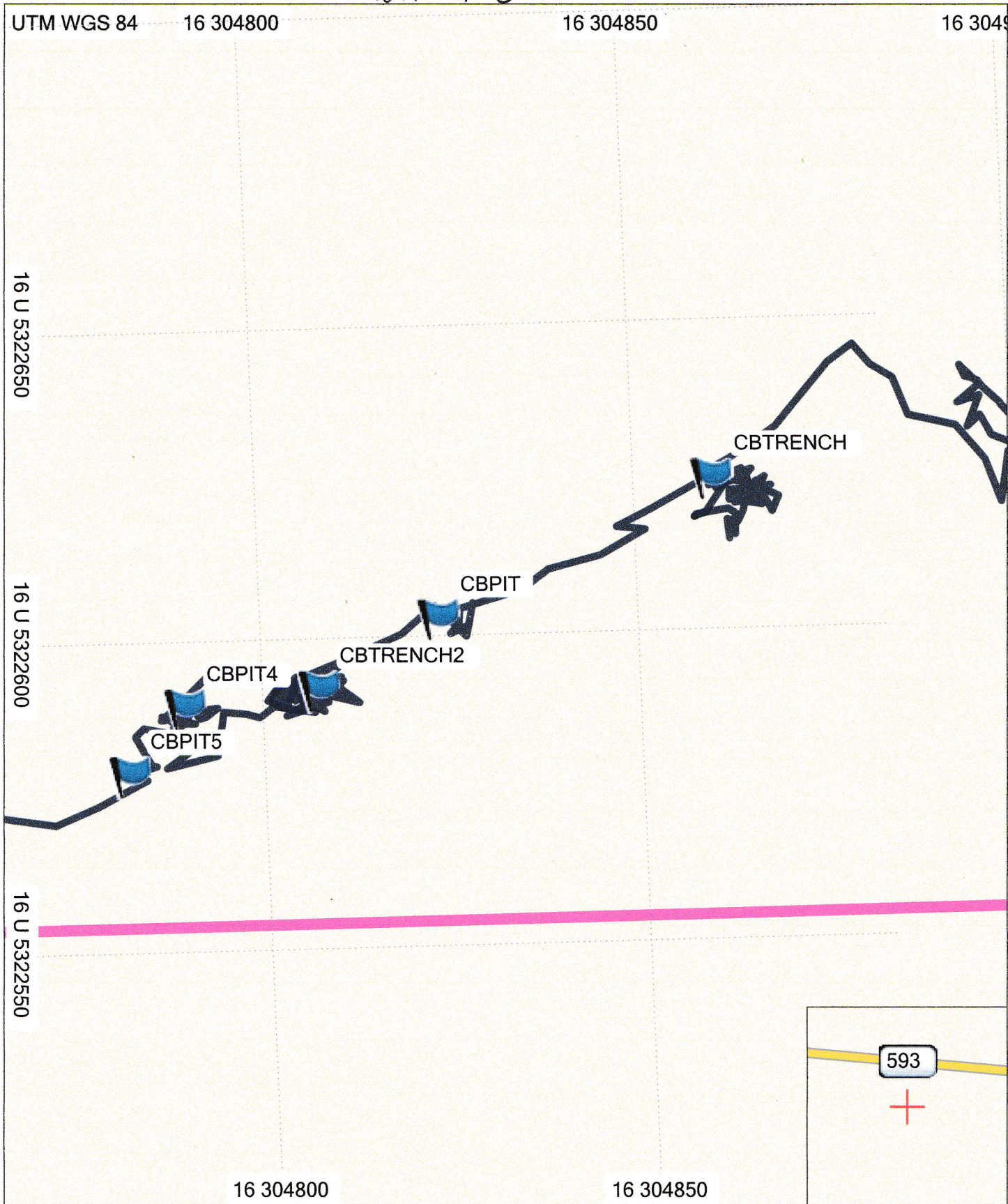

Global Map

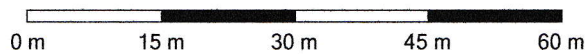

12.07.15



GARMIN.





### Legend

**Administration Boundaries**

- Mining Divisions
- Resident Geologist District
- Townships and Areas
- UTM Grid
- Geographic Lot Fabric
- Other Federal Land

**Mineral Tenure Grid**

- OMTG Tenure Grid

**Alienations**

- Withdrawal
- Notice

**Unpatented Claim**

- Active
- Reconciled
- Pending

**Disposition**

- Disposition

**Disposition Symbols**

- Camp
- Disposition Unknown/Pending
- Freehold Patent Mining Rights Only
- Freehold Patent Surface Rights Only
- Freehold Patent Surface and Mining Rights
- Land Use Permit
- Leasehold Patent Mining Rights Only
- Leasehold Patent Surface Rights Only
- Leasehold Patent Surface and Mining Rights
- License of Occupation Mining Use Only
- License of Occupation Surface Use Only
- License of Occupation Surface and Mining Rights
- License of Occupation Uses Not Specified
- Order in Council
- Tower
- WPLA

**Geology Layers**

- AMIS Sites
- AMIS Features
- Drill Holes
- Mineral Occurrences



Projection: Web Mercator



The Ontario Ministry of Northern Development and Mines shall not be liable in any way for the use of, or reliance upon, this map or any information on this map. This map should not be used for: navigation, a plan of survey, routes, nor locations.

Imagery Copyright Notices: Ontario Ministry of Natural Resources and Forestry; NASA Landsat Program; First Base Solutions Inc.; Aéro-Photo (1961) Inc.; DigitalGlobe Inc.; U.S. Geological Survey.



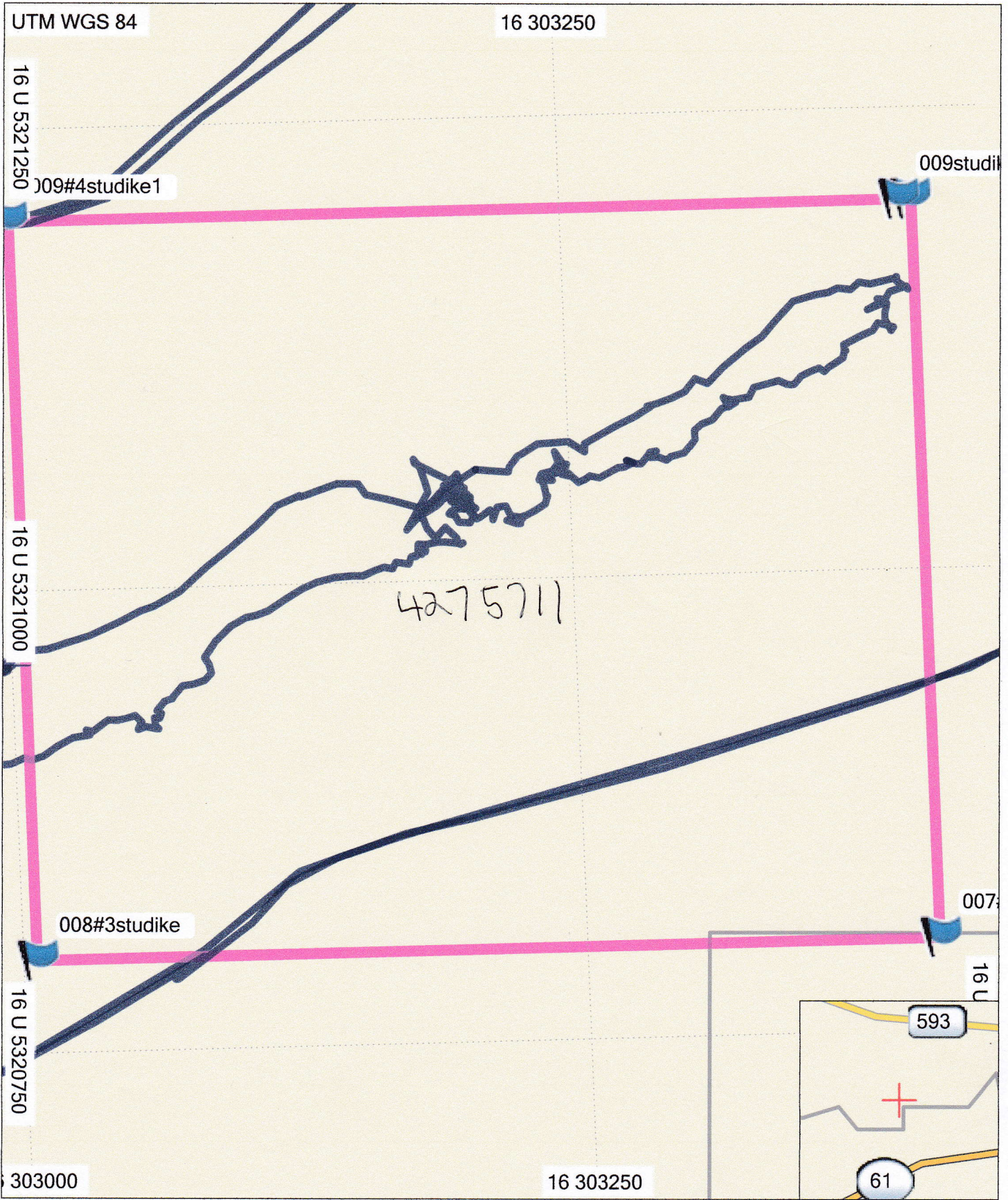

Global Map

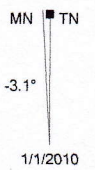
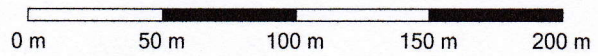

12.07.15  
July 12 2015 tracks  
from traverse.

GARMIN.

UTM WGS 84

16 303250

16 303500

16 U 5321250

16 U 5321000

16 U 5320750

16 U 5321250

16 U 5321000

16 U 5320750

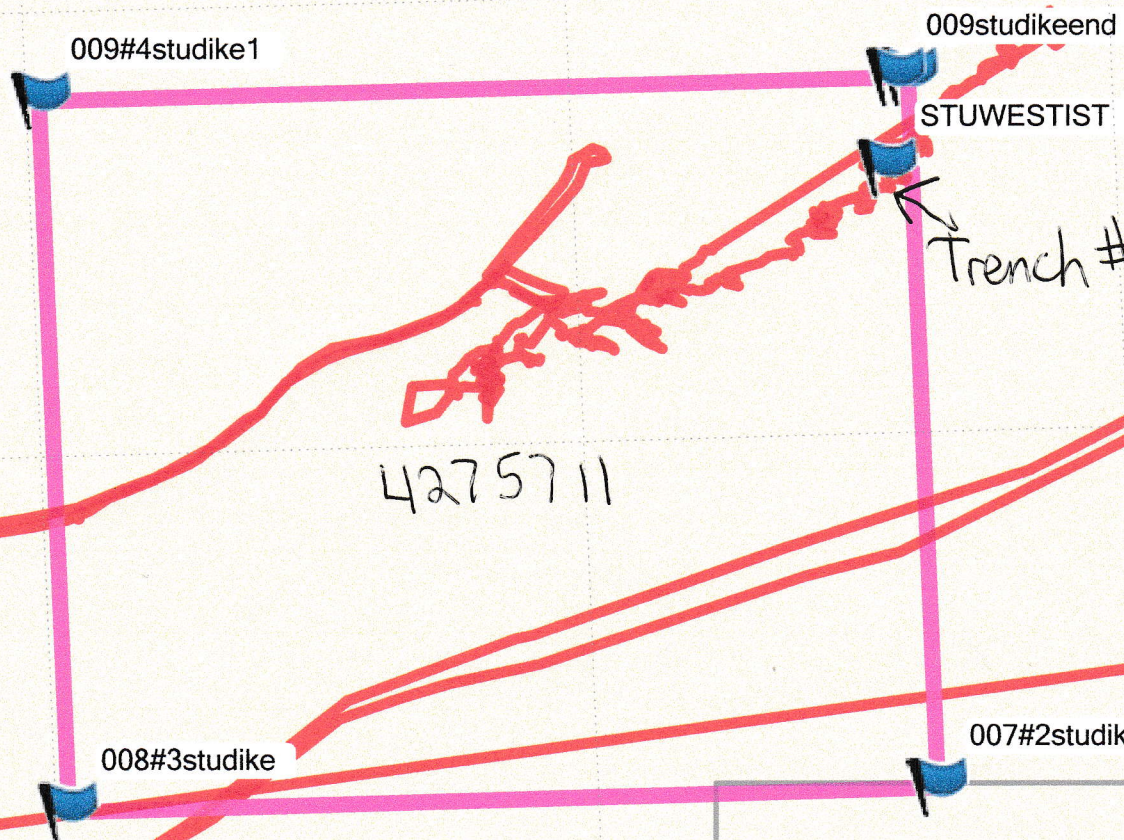

16 303000

16 303250

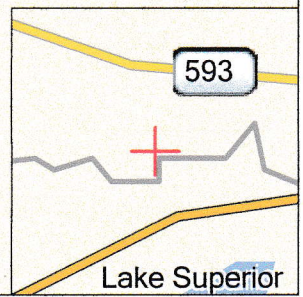

Global Map

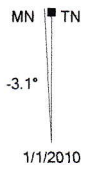
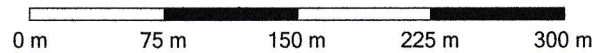

19.9.15  
 Sept 19 2015  
 traverse.

GARMIN

UTM WGS 84

16 303500

16 U 5321500

16 U 5321000

16 U 5320500

16 303000

16 30

Lake Superior

009#4studike1

009studike

STUADITACTUAL

STUTRENCH3ACTUAL

STUTRENCH2ACTUAL

4275711

008#3studike

007#2studike

Global Map

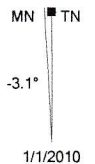
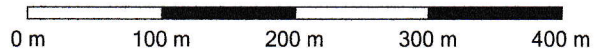

04.10.15

October 4th 2015.  
Traverse.

GARMIN.

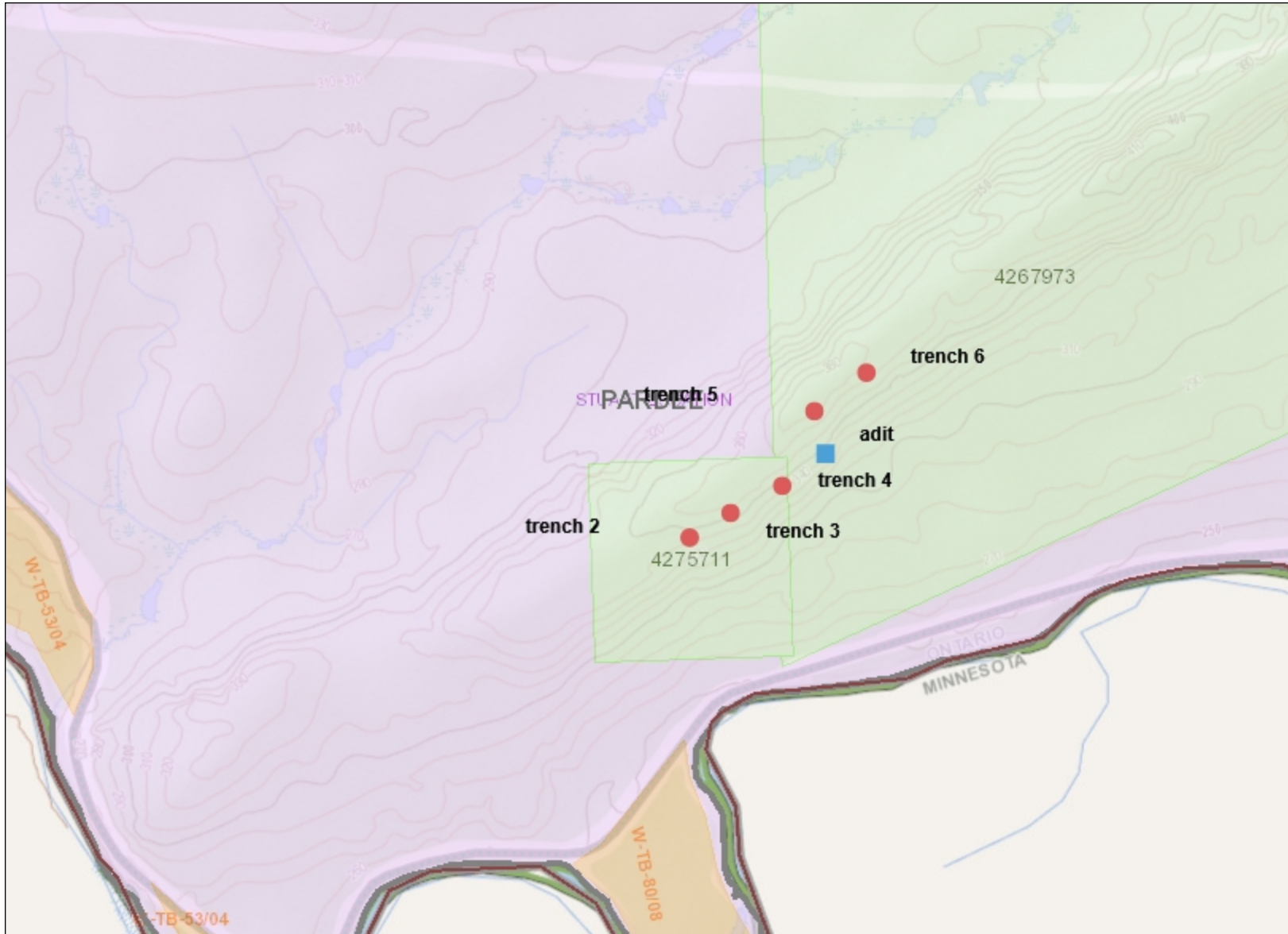

### Legend

- Administration Boundaries**
  - Mining Divisions
  - Resident Geologist District
  - Townships and Areas
  - UTM Grid
  - Geographic Lot Fabric
  - Other Federal Land
- Mineral Tenure Grid**
  - OMTG Tenure Grid
- Alienations**
  - Withdrawal
  - Notice
- Unpatented Claim**
  - Active
  - Reconciled
  - Pending
- Disposition**
  - Disposition
- Disposition Symbols**
  - Camp
  - Disposition Unknown/Pending
  - Freehold Patent Mining Rights Only
  - Freehold Patent Surface Rights Only
  - Freehold Patent Surface and Mining Rights
  - Land Use Permit
  - Leasehold Patent Mining Rights Only
  - Leasehold Patent Surface Rights Only
  - Leasehold Patent Surface and Mining Rights
  - License of Occupation Mining Use Only
  - License of Occupation Surface Use Only
  - License of Occupation Surface and Mining Rights
  - License of Occupation Uses Not Specified
  - Order in Council
  - Tower
  - WPLA
- Geology Layers**
  - AMIS Sites
  - AMIS Features
  - Drill Holes
  - Mineral Occurrences



Projection: Web Mercator



The Ontario Ministry of Northern Development and Mines shall not be liable in any way for the use of, or reliance upon, this map or any information on this map. This map should not be used for: navigation, a plan of survey, routes, nor locations.

© Queen's Printer for Ontario, 2016

Imagery Copyright Notices: Ontario Ministry of Natural Resources and Forestry; NASA Landsat Program; First Base Solutions Inc.; Aéro-Photo (1961) Inc.; DigitalGlobe Inc.; U.S. Geological Survey.

© Copyright for Ontario Parcel data is held by Queen's Printer for Ontario and its licensors and may not be reproduced without permission.



UTM WGS 84

16 303100

16 303200

16 U 5321100

16 U 5321000

16 U 5320900

3000

16 303100

STUTREN

4275711

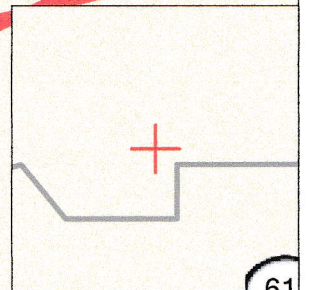

Global Map

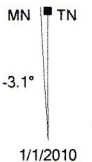
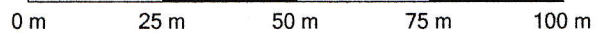

11.10.15  
 October 11th 2015  
 Traverse → searching for trench #1.

GARMIN.

UTM WGS 84

16 303500

16 U 5321500

16 U 5321000

16 U 532

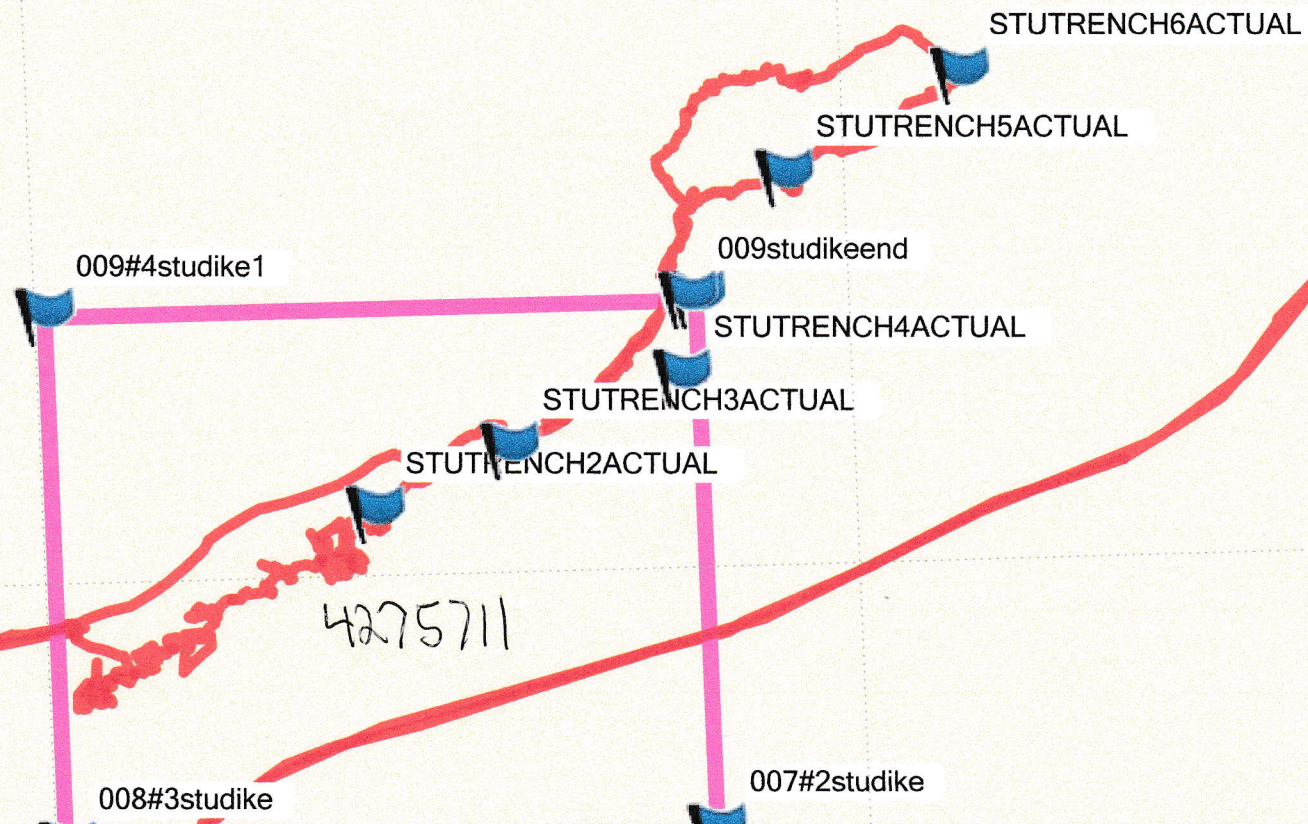

16 303000

16 303500

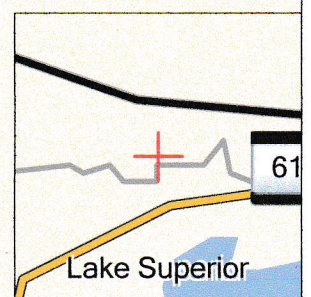

Global Map

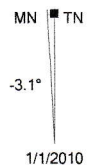
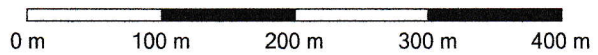

11.10.15  
 October 11th 2015  
 Traverse.

**GARMIN.**

UTM WGS 84

16 304000

16 305000



Global Map

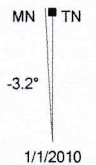
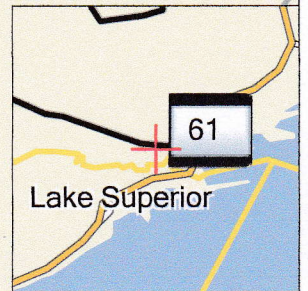
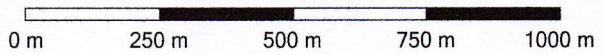

01.11.2015  
Nov 1st 2015 Traverse

GARMIN.



UTM WGS 84

16 304750

16 U 5323000

16 U 5322750

16 U 5322750

593

004#4

CB1000NTRENCH

4275710

003#3

16 304750

593

Global Map

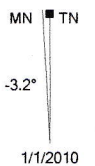
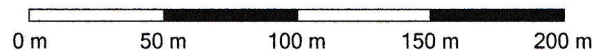

01.11.2015  
Nov 1st 2015 traverse.

GARMIN.