

We are committed to providing [accessible customer service](#).
If you need accessible formats or communications supports, please [contact us](#).

Nous tenons à améliorer [l'accessibilité des services à la clientèle](#).
Si vous avez besoin de formats accessibles ou d'aide à la communication, veuillez [nous contacter](#).

2.58228

REPORT ON

**ENID CREEK
DIAMOND DRILL PROGRAM
DRILL HOLE IL17-25-14**

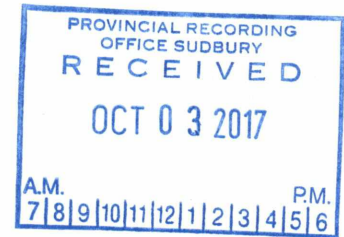

**LOVELAND TOWNSHIP, ONTARIO
PORCUPINE MINING DIVISION**

FOR

INTERNATIONAL EXPLORERS & PROSPECTORS INC.

October 2, 2017

Submitted by: Lionel Bonhomme

Table of Contents

Page 1	Introduction, Location, Regional Geology, & Previous Work
Page 2	Previous Work (cont.), Personnel
Page 3	Program Costs for IL17-25-14
Page 4	Map of Regional Location
Page 5	1:20000 Map of Claim
Page 6	1:5000 Map of Claim & DDH IL17-25-14
Page 7	Plan View of IL17-25-14
Page 8	Vertical Section of IL17-25-14
Attachment A	Log of drill hole IL17-25-14

Introduction

During the month of August 2017, International Explorers and Prospectors Inc. commenced a drill program in Loveland Township, Ontario Canada. The project name is Enid Creek with Permit number PR-17-1108. Drilling began on August 15, 2017 and concluded on August 20, 2017 by NPLH Drilling. The drill hole identification is IL17-25-14 and the collar was located at 454217E, 5389162N (NAD83). A water line was used from nearby Enid Creek. The drilling contractor created sumps to ensure the capture of sulphides to protect the returning water. An existing forest logging road network was used for access.

The Enid Creek project contains a NI-43-101 non-compliant estimated resource of Cu-Ni-Platinum Group Metals (PGM) calculated in 2001. A 3D model was completed in 2004. In December 2016 and January 2017, a VTEM- Max airborne survey and interpretation on the property was conducted by Geotech Airborne Geophysical Surveys. The interpretation was completed in July 2017. The first target was tested with drill hole IL17-25-14. The log of this hole is being filed with ongoing sampling, pending analysis and geophysical surveys planned to be completed this winter.

The program was to create a downhole platform to allow testing of a geophysical conductor 150 meters below the known resource and to be used as a platform to guide future exploration.

Location

DDH IL17-25-14 is located in Loveland Township, District of Cochrane in the Porcupine Mining Division claim number 1037161. The claim is approximately 30km northeast of the City of Timmins, Ontario. Access to the property is gained by following Kamiskotia Highway to Tembec logging road to marker 10. A logging trail built when the property was logged provides access to the claims. The vegetation in the area has rebounded from the logging and is lush and green.

Regional Geology

The property is located in the Abitibi Greenstone Belt as identified on map P3379 OGS. The Kidd-Munro assemblage is located on the drill location the City of Timmins boundary where Gabbro and Mafic Volcanics outcrop.

Previous Work

- 1957, Tilmac Group drilled 9 holes (T-640)
- 1964-1968, Hollinger Mines drilled 25 holes (T -794)
- 1969-1971, Hollinger Mines performed a MAG survey (T-1358)
- 1970, Hollinger Mines performed an AMAG EM survey (T -681)

1978, Texas Gulf Canada performed a MAG survey (T-1873)
1980, Gulf Minerals Ltd performed and AMAG EM survey (T-1929)
1988-1989, Falconhridge drilled 3 holes and performed a MAG EM survey (T -3311)

(1)

1994-1996, West Miner Ltd drilled 1 hole and performed geophysical surveys
2000, Explorers Alliance Corporation drilled 8 holes (T -4488)
2006, Explorers Alliance Corporation drilled 3 holes
2006, Explorers Alliance Corporation drilled 2 holes
2016-17, Geotech Airborne Geophysical Surveys, VTEM Max Geophysical Survey
2016-17, Geotech Airborne Geophysical Surveys, VTEM Max Geophysical Survey
Interpretation

Personnel

The program was managed by Lionel Bonhomme and the drill core was logged by Geotechnician LeAnn van Hees under the supervision of Lionel Bonhomme. Detailed logs are attached with the location maps, plans and sections.

program costs for IL 17-14

August, September 2017

dozer	aug.10		9.5 hrs	150/hr	1,425	
brushing	aug,11		8 hrs	150/hr	1,200	
mob	aug,14		15.5 hrs	130 /hr	2,015	
				mobe/access		<u>4,640</u>
casing	15,aug		9 m	68/m	612	
coring	15-Aug	20-Aug	282 m	68/m	19,176	
reflex test			6 tests	65.4/test	392	
reflex rental	Aug-14	19-Aug	6days	75/day	450	
casing left			3 pieces	120/piece	360	
nw crown			1 shoe	445/shoe	445	
core trays			68 trays	7/tray	476	
				total drill cost		<u>21,911</u>
				meters drilled		291
				cost per meter		75.30
LeAnn Van Hees	Aug 4 - Oct 2		54.75 hr	43.75/hr	2,395	
W Corstopherine	Sep 27-28		9 hours	\$50/hr	450	
S Woolhead	Aug 4 - 20		53 hours	\$35.00	1,855	
L Bonhomme	Aug 14 - Oct 2		6 days	500	3,000	
				Total		<u>7,700</u>
room & board	Aug-14	19-Aug	6 days	180	1,080	
Polk Geological	core shack rental	1/6 of monthly rental			375	
LeAnn van Hees			2 days	50/day	100	
S Woolhouse milleage	Aug 4 - 20		724 km	\$0.50	362	
				Transportation costs		<u>462</u>
				Total costs		<u>36,168</u>



Claim 1037161

IL17-25-14 454217E,5389162N

Date / Time of Issue: Mon Oct 02, 10:53:38 EST 2017



Ontario Ministry of Northern Development and Mines
Mining Lands Tenure Map

Administrative Districts

Township
LOVELAND
Mining Division
Porcupine
Land Registry
COCHRANE
MNRF District Office
TIMMINS

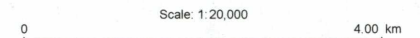
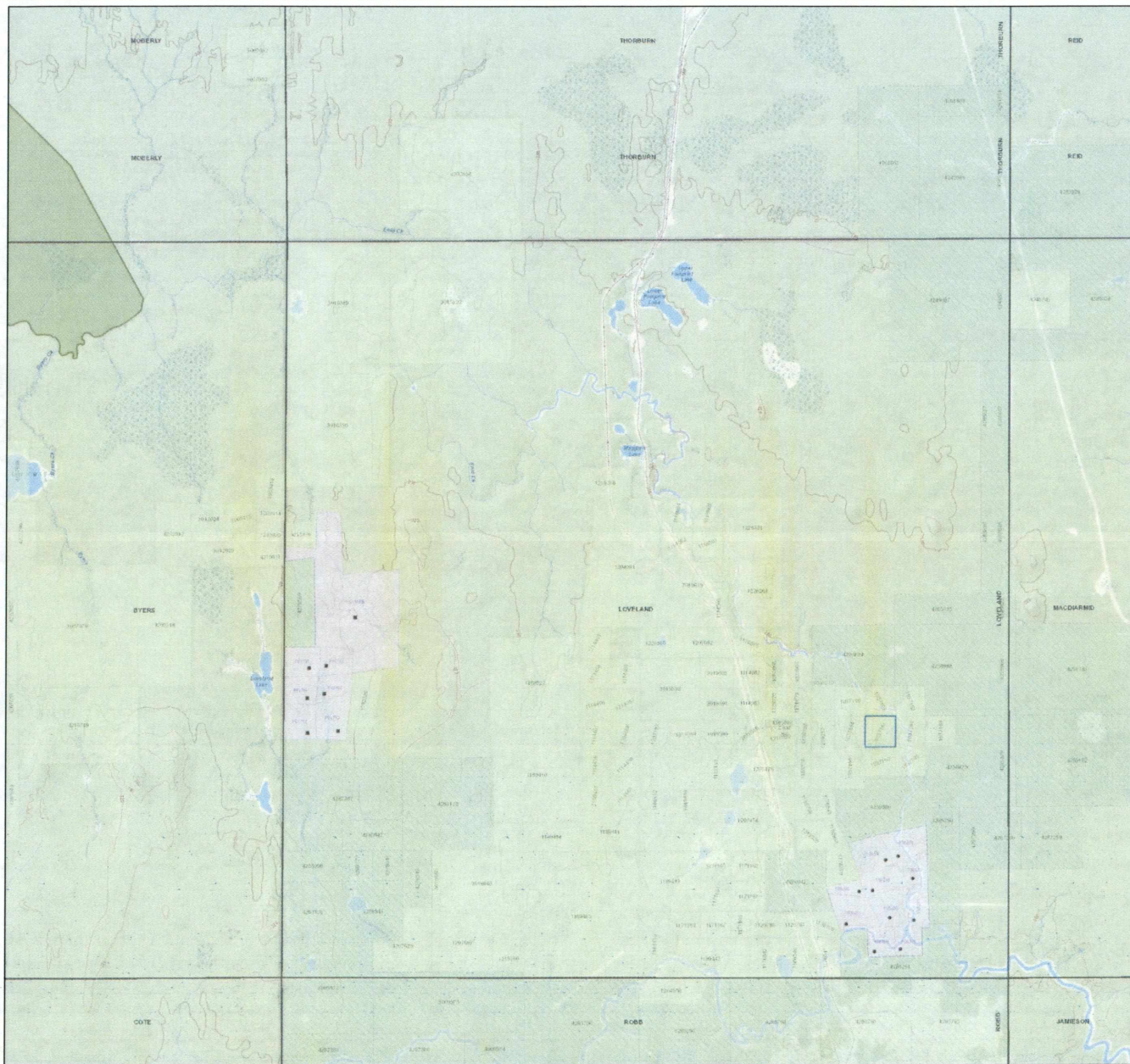

Map Datum: NAD 83
Projection: Web Mercator



Those wishing to stake mining claims should consult with the Provincial Mining Records' Office of the Ministry of Northern Development and Mines for additional information on the status of the lands shown hereon. This map is not intended for navigational, survey, or land title determination purposes as the information shown on this map is compiled from various sources.
Completeness and accuracy are not guaranteed.

Additional information may also be obtained through the local Land Titles or Registry Office, or the Ministry of Natural Resources and Forestry.
The information shown is derived from digital data available in the Provincial Mining Records' Office at the time of downloading from the Ministry of Northern Development and Mines web site.
© Queen's Printer for Ontario, 2016

Claim 1037161

IL17-25-14 454217E,5389162N

Date / Time of Issue: Mon Oct 02, 11:06:44 EST 2017



Ontario Ministry of Northern Development and Mines
Mining Lands Tenure Map

Administrative Districts

Township
LOVELAND
Mining Division
Porcupine
Land Registry
COCHRANE
MNRF District Office
TIMMINS

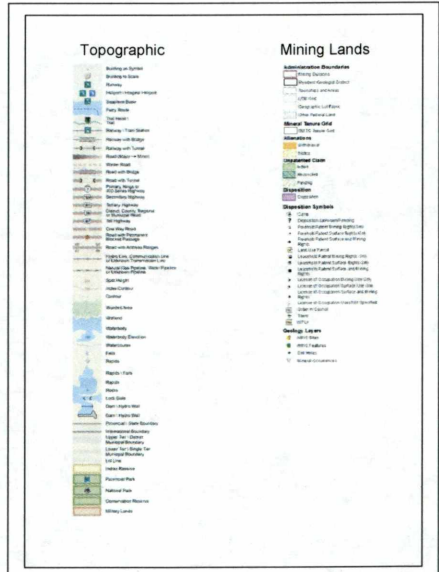
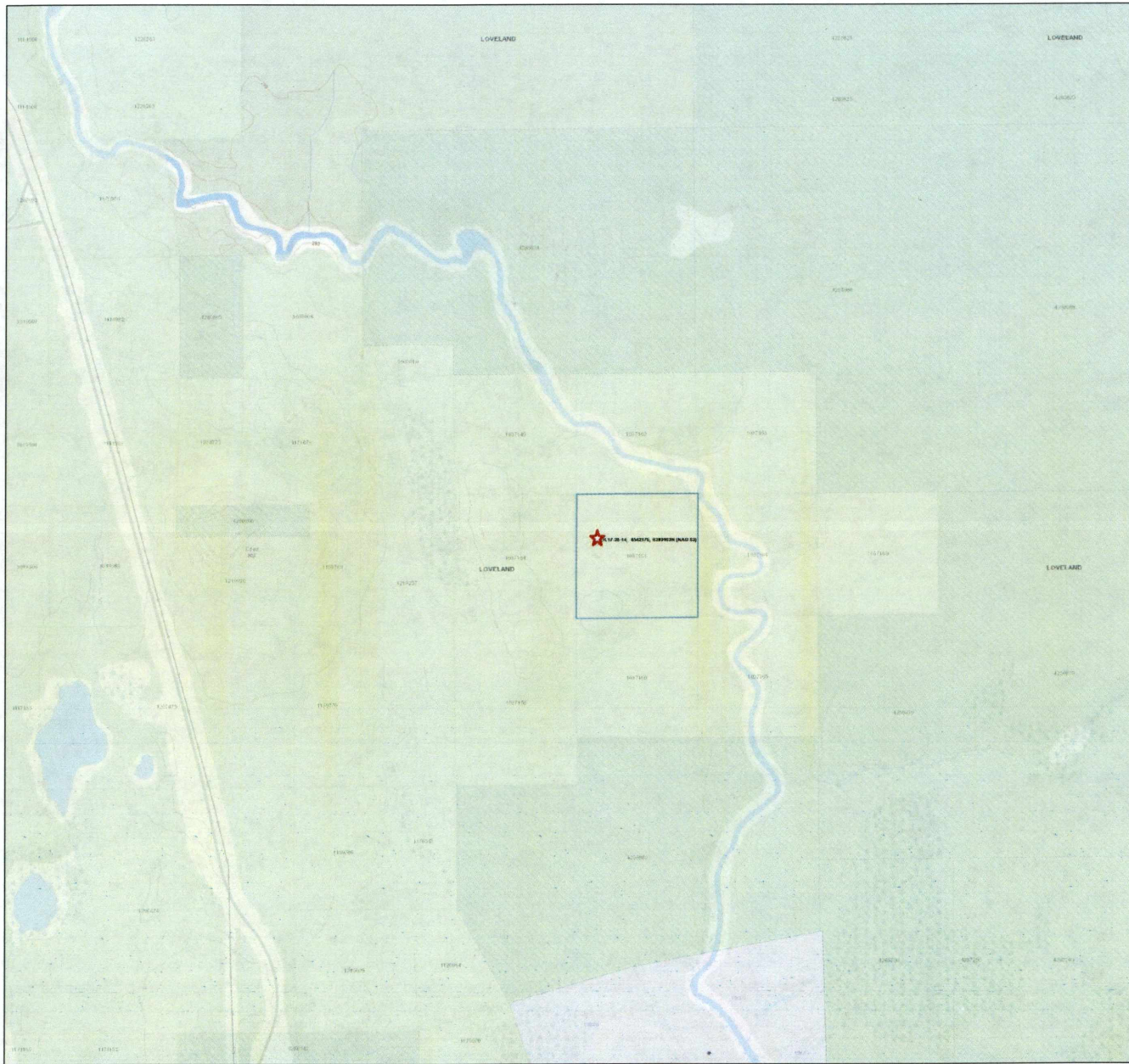

Scale: 1:5,000
0 1.00 km

Map Datum: NAD 83
Projection: Web Mercator



Those wishing to stake mining claims should consult with the Provincial Mining Recorder's Office of the Ministry of Northern Development and Mines for additional information on the status of the lands shown hereon. This map is not intended for navigational, survey, or land title determination purposes as the information shown on this map is compiled from various sources.
Completeness and accuracy are not guaranteed.

Additional information may also be obtained through the local Land Titles or Registry Office, or the Ministry of Natural Resources and Forestry.
The information shown is derived from digital data available in the Provincial Mining Recorder's Office at the time of downloading from the Ministry of Northern Development and Mines web site.
© Queen's Printer for Ontario, 2016



Legend

Administration Boundaries

- Mining Divisions
- Resident Geologist District
- Townships and Areas
- UTM Grid
- Geographic Lot Fabric
- Other Federal Land

Mineral Tenure Grid

- OMTG Tenure Grid

Alienations

- Withdrawal
- Notice

Unpatented Claim

- Active
- Reconciled
- Pending

Disposition

- Disposition

Disposition Symbols

- Camp
- Disposition Unknown/Pending
- Freehold Patent Mining Rights Only
- Freehold Patent Surface Rights Only
- Freehold Patent Surface and Mining Rights
- Land Use Permit
- Leasehold Patent Mining Rights Only
- Leasehold Patent Surface Rights Only
- Leasehold Patent Surface and Mining Rights
- License of Occupation Mining Use Only
- License of Occupation Surface Use Only
- License of Occupation Surface and Mining Rights
- License of Occupation Uses Not Specified
- Order in Council
- Tower
- WFLA

Geology Layers

- AMIS Sites
- AMIS Features
- Drill Holes
- Mineral Occurrences



Projection: Web Mercator



The Ontario Ministry of Northern Development and Mines shall not be liable in any way for the use of, or reliance upon, this map or any information on this map. This map should not be used for: navigation, a plan of survey, routes, nor locations.

© Queen's Printer for Ontario, 2016

Imagery Copyright Notices: Ontario Ministry of Natural Resources and Forestry; NASA Landsat Program; First Base Solutions Inc.; Aéro-Photo (1961) Inc.; DigitalGlobe Inc.; U.S. Geological Survey.

© Copyright for Ontario Parcel data is held by Queen's Printer for Ontario and its licensors and may not be reproduced without permission.

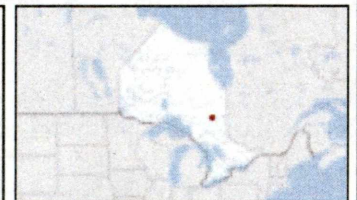

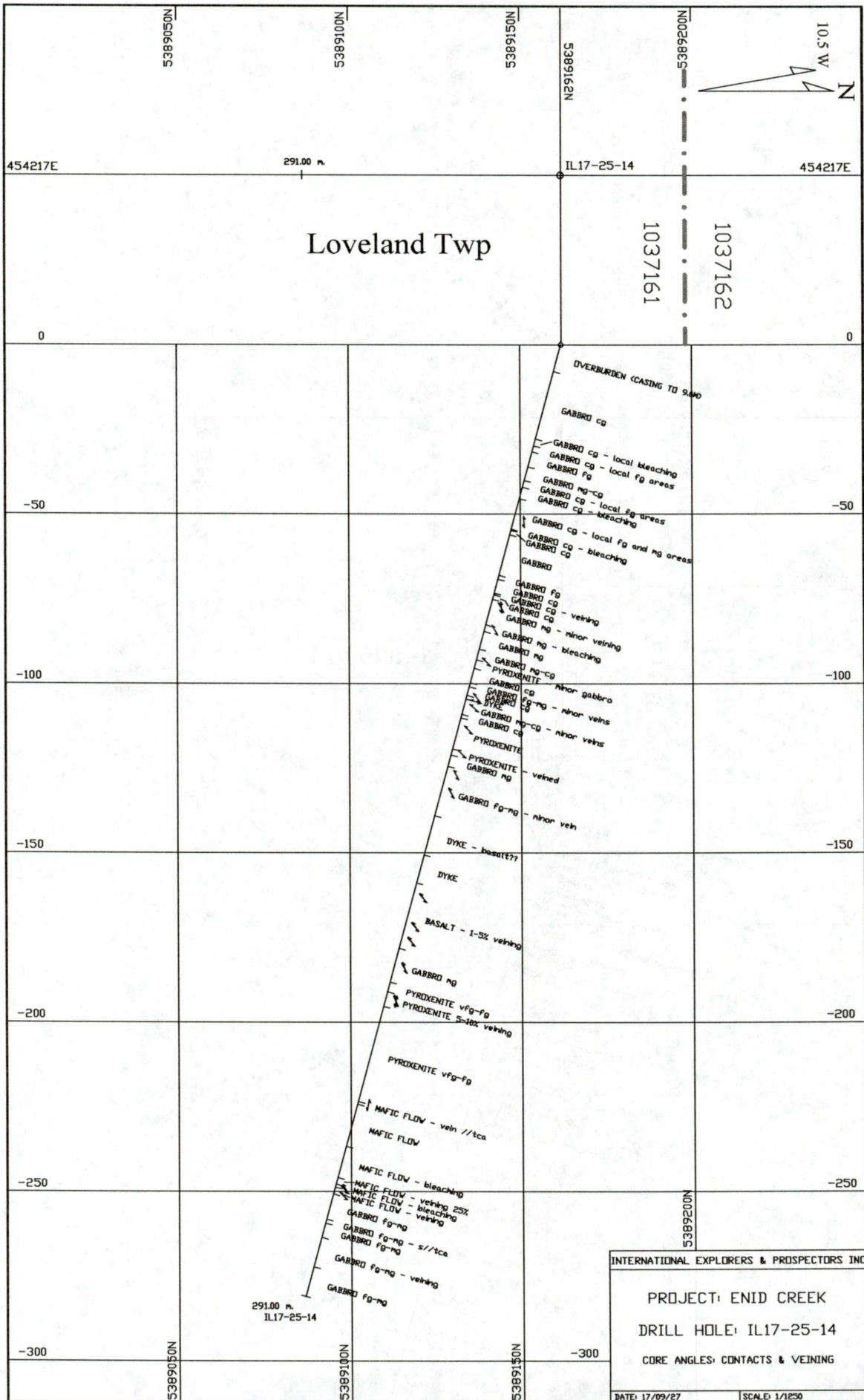

ATTACHMENT A

<u>PROJECT</u>	<u>Hole ID</u>	<u>Date Drilled</u>	<u>Logged by</u>
Enid Creek	IL17-25-14	August 15-20, 2017	LeAnn van Hees under the surpervision of Lionel Bonhomme

<u>UTM Coordinates</u>		<u>Azimuth</u>	<u>Dip</u>
<u>Easting</u>	<u>Northing</u>		
454217	5389162	180	-75

Project	DDH	Major Unit		Major Unit Title	Minor Unit		Minor Unit Title	Description
		From	To		From	To		
Enid Creek	IL17-25-14	0	8.2	Overburden				
Enid Creek	IL17-25-14	8.2	32.7	Gabbro				Casing goes to 9m. Medium Grey to dark green with white to greenish whit feldspar - speckled appearance. Not magnetic. Hard. Coarse Grained with patches of fine to medium grained with a few small irregular fragments of fine grained grey basalt. Over all trace sulphides
Enid Creek	IL17-25-14				28.8	29.3	Bleaching	Fine grained gabbro with weak to moderate bleaching - cream to greenish cream in color with grey areas; fairly sharp slightly irregular contacts; hard
Enid Creek	IL17-25-14				29.5	30	Bleaching	Fine grained gabbro with weak to moderate bleaching - cream to greenish cream in color with grey areas; fairly sharp slightly irregular contacts; hard
Enid Creek	IL17-25-14				30.5	30.9	Bleaching	Fine grained gabbro with weak to moderate bleaching - cream to greenish cream in color with grey areas; fairly sharp slightly irregular contacts; hard
Enid Creek	IL17-25-14				31.2	31.3	Fine Grained Gabbro	Fine Grained gabbro; medium grey; hard
Enid Creek	IL17-25-14				31.8	32	Fine Grained Gabbro	Fine Grained gabbro; dark green/grey; hard
Enid Creek	IL17-25-14	32.7	37.4	Gabbro				Fine grained; medium to dark green grey; moderate patchy bleaching to a creamy buff/green buff; not magnetic; few small patches of medium to coarse grained with feldspar of white to greenish - speckled; hard; trace qtz veinlets; trace sulphides
Enid Creek	IL17-25-14	37.4	41.5	Gabbro				Dark green; medium to coarse grained; speckled with white to greenish feldspar; 5% epidote/feldspar/qtz/carbonate veinlets; not magnetic; hard; trace sulphides
Enid Creek	IL17-25-14	41.5	58.1	Gabbro				Dark green to medium grey/green with mostly white feldspar; cream to greenish and rare pinkish feldspar also; coarse grained intermixed with fine grained gabbro; patches of weak bleaching to buff or greenish buff; not magnetic; hard; rare qtz clots; trace sulphides
Enid Creek	IL17-25-14				42	42.5	Fine/Med Grained Gabbro	Fine Grained/Medium Grained Gabbro; dark to medium grey.

Enid Creek	IL17-25-14				43.6	47.1	Bleaching	Fine Grained/Medium Grained Gabbro; weakly bleached to greenish buff with medium to dark patches
Enid Creek	IL17-25-14				48.1	50.8	Fine/Coarse Grained Gabbro	Gabbro; 50% Coarse Grained; 50% Fine Grained; medium to dark green with creamy white feldspar
Enid Creek	IL17-25-14				53.1	53.6	Fine/Med Grained Gabbro	Fine Grained/Medium Grained Gabbro; weakly bleached to buff with a sharp contact of 20 deg tca at 53.6m.
Enid Creek	IL17-25-14				54	54.3	Fine/Med Grained Gabbro	Fine Grained/Medium Grained Gabbro; dark green.
Enid Creek	IL17-25-14				56.4	56.8	Bleaching	Fine Grained/Medium Grained Gabbro; weakly bleached fractures of buff to greenish buff in a dark green matrix.
Enid Creek	IL17-25-14	58.1	70.5	Gabbro				Dark grey to green grey with creamy white to greenish white feldspar - speckled; not magnetic; hard; no significant sulphides
Enid Creek	IL17-25-14	70.5	71.7	Gabbro				Fine grained; greenish creamy buff with medium to dark grey; either a fine grained gabbro or basalt; moderate bleaching; few hairline fractures/veinlets of qtz; weak ff carbonate most likely calcite; greenish clots of fine grained feldspar (?); less than 0.5% epidote/feldspar/minor qtz veinlets; trace sulphides
Enid Creek	IL17-25-14	71.7	77.8	Gabbro				Coarse grained; dark green to medium grey with creamy to white feldspar; not magnetic; hard; no significant sulphides
Enid Creek	IL17-25-14				75.9	76.4	Veining	Fine grained gabbro; light to medium grey cut by many irregular veinlets of buff to greenish buff feldspar with minor qtz
Enid Creek	IL17-25-14	77.8	96.2	Gabbro				Medium grained; dark green/grey with creamy to white to greenish feldspar intermixed with fine grained dark green/grey to greenish buff to buff patches; patchy weakly magnetic; hard; weak to moderate patchy bleaching green/buff to buff in color; few areas of weak ff calcite; few qtz clots <1cm; Overall trace sulphides
Enid Creek	IL17-25-14				79.6	79.7	Veining	Veining; 25% qtz/carb/feldspar veinlets at 45 deg and 20 deg tca
Enid Creek	IL17-25-14				85.6	87.6	Bleaching	Medium Grained Gabbro; Weak to moderate bleaching; weak ff carbonate; many veinlets with feldspar/minor qtz/minor carb; most veinlets at 45 deg tca
Enid Creek	IL17-25-14				93	96.2	Medium/Coarse Grained Gabbro	Medium to Coarse grained gabbro; medium to dark grey with creamy white feldspar.
Enid Creek	IL17-25-14	96.2	98.8	Pyroxenite				Different texture and color than above and below; Fine grained to medium grained; medium grey with hue of blue green; upper contact is sharp but irregular at 60 deg tca; Gabbro intermixed; blue/green mica possibly fuchsite; small clots of feldspar; small clots of chlorite; small clots of qtz; not magnetic; hard; no significant veining; no significant sulphides
Enid Creek	IL17-25-14				96.2	96.7		gabbro; Gradational contact into pyroxenite

Enid Creek	IL17-25-14				98.6	98.8		pyroxenite; Gradational contact into gabbro
Enid Creek	IL17-25-14	98.8	108.3	Gabbro				Coarse grained; medium green/grey with creamy feldspar; area of strongly broken rock - no indications of fault; very weak to weak ff calcite; hard; not magnetic; overall trace qtz/carbonate/feldspar hairline veinlets; overall trace sulphides
Enid Creek	IL17-25-14				103.3	104.5	Fine/Med Grained Gabbro	Fine grained/medium grained gabbro
Enid Creek	IL17-25-14				104.1	104.2	Vein	5cm qtz/feldspar/carbonate vein
Enid Creek	IL17-25-14				103.6	103.8	Vein	Buff to greenish in color; feldspar/minor qtz vein
Enid Creek	IL17-25-14				107.2	108.3	Dyke	Sharp irregular contact at 55 deg tca; creamy white feldspar dyke; lower contact at 90 deg tca; mostly feldspar with speckles of dark green chlorite rich gabbro
Enid Creek	IL17-25-14	108.3	112.9	Gabbro				Medium grained to coarse grained; areas of fine grained dark greyish green gabbro with white/creamy/greenish white feldspar; small chlorite clots; mica like fragments; hard but softer than above unit; patchy magnetic possibly due to po; small sections with a blue green hue possibly pyroxenite; <1% qtz veinlets up to 1cm in width; trace-6% sulphides
Enid Creek	IL17-25-14				110.1	110.6	Veins/Dykes	Series of vein/dyke structures filled with larger feldspar/chlorite/minor qtz; 65 deg tca
Enid Creek	IL17-25-14	112.9	114	Gabbro				Coarse Grained; dark green with white to greenish white feldspar; strongly broken with no indication of fault; hard; weakly mineralized with up to 1% sulphides
Enid Creek	IL17-25-14	114	125.4	Pyroxenite				Fine grained to medium grained; medium blueish green grey; areas of dioritic texture; small chlorite clots; patchy magnetic; still hard but softer than above unit; few veins of creamy to greenish larger grained feldspar/chlorite at 60 deg tca; trace-12% sulphides
Enid Creek	IL17-25-14				114	116	Broken	Strongly broken pyroxenite with no indications of fault
Enid Creek	IL17-25-14				123.5	125.4	Veining	2-3% hairline veinlets/fractures with carbonate/qtz/feldspar generally trending at 60 deg tca with other angles as well; much harder possibly silicified or albitized
Enid Creek	IL17-25-14	125.4	128.8	Gabbro				Medium grained; light to medium grey gabbro; weakly bleached; few small chlorite clots; very weak ff calcite; very sparse mica like fragments; no significant veining; not magnetic; hard and glossy; 1% sulphides
Enid Creek	IL17-25-14	128.8	144	Gabbro				Medium green/grey; intermittent fine grained alternating with medium grained with greenish white to white feldspar; patchy weakly magnetic possibly due to occasional magnetite filled vesicles; hard; 1-2% feldspar/carbonate/epidote veinlets some with magnetite hairline to 5 cm in width generally at 40-45 deg tca; trace-3% sulphides
Enid Creek	IL17-25-14				130.8	130.85	Vein	Feldspar/epidote/carbonate vein with magnetite at 45 deg tca

Enid Creek	IL17-25-14	144	164.6	Mafic Dyke (?)		Very dark green; very fine grained to fine grained basalt or mafic dyke; no distinct contacts; magnetic; hard; rare calcite/epidote veinlet hairline to 1cm in width; few to rare small sections of fine to medium grained wallrock with tiny feldspar;no significant sulphides visible-3% sulphides
Enid Creek	IL17-25-14		156		Dyke	Mafic Dyke; Noticable small clusters or rosettes of greenish white possibly epidote; easier to see from distance than with hand lens - tends to blend in when viewed up close
Enid Creek	IL17-25-14	164.6	184.7	Basalt		Very fine grained to fine grained; medium to dark green/grey basalt; hard; weakly magnetic; possible fuchsite along some fractures; periodic veining; trace-3% sulphides
Enid Creek	IL17-25-14		164.6		Veining	2% Epidote/qtz/carbonate veinlets hairline to 3cm in width generally at 50-55 deg tca
Enid Creek	IL17-25-14		175.5		Veining	5% Carbonate/epidote/calcite veinlets hairline to 3cm in width; iron staining at 176 and 178m pink to reddish in color generally at 50-55 deg tca
Enid Creek	IL17-25-14		179.5		Veining	1-2% epidote veinlets hairline to 3 cm in width generally at 50-55 deg tca
Enid Creek	IL17-25-14	184.7	195	Gabbro		Very dark green with greenish to white feldspar lathes; medium grained; hard; weakly magnetic possible due to visible fine grained disseminated magnetite; occasional hairline to 3mm veinlets of epidote/calcite generally at 35-45 deg tca; trace-5% sulphides
Enid Creek	IL17-25-14	195	231.3	Pyroxenite		Medium to dark green to bluish green; 2 phases a very fine grained and a fine grained; some areas have a soapy or waxy feel; blue green hue; the 2 phases are separated by a light green to white irregular hairline fracture or surface; small sections of very tiny fine grained feldspar lathes; hard; weakly magnetic; sections with visible but fine grained vesicle filling magnetite; small patches of moderate calcite alteration; most veinlets/fractures are filled with calcite; section of increased veining; appearance of white/silvery sulphide; trace-6% sulphides
Enid Creek	IL17-25-14		197.9		Veining	5-10% calcite/epidote/minor qtz/minor iron staining veinlets hairline to 5cm in width; various deg tca 30/40/sub-parallel
Enid Creek	IL17-25-14	231.3	259.6	Mafic Flow		Light to medium green mafic flow; intermixed very fine grained and fine grained; has small to medium sized patches with fracture filled "crackle" breccia; sections of filled vesicles; hard; irregular very fine grained sections possible cooled edges or surfaces; area with increased veining; periodic epidote/carbonate veinlets hairline to 4cm in width generally at 40/30/80 deg tca; calcite ff throughout; patchy magnetite filled vesicles throughout; trace-2% sulphides
Enid Creek	IL17-25-14		231.3		Vein	1cm wide qtz/carbonate/syenite vein; sub-parallel tca
Enid Creek	IL17-25-14		245		Bleaching	Altered Mafic Flow; Moderate to strong patchy bleaching

Enid Creek	IL17-25-14					254.6	256.6	Veining	25% veinlets/fractures with qtz/carbonate/iron staining to reddish possible syenite; 2 major veinlets sub-parallel tca
Enid Creek	IL17-25-14					257.5	257.7	Vein	Carbonate/qtz vein with sharp upper contact at 45 deg tca; strongly bleached; followed by series of small hairline veinlets of same material
Enid Creek	IL17-25-14					257.7	259.6	Vein	Brecciated Carbonate vein with sharp upper contact of 60 deg tca; strongly bleached; angular fragments of medium green wallrock; sharp lower contact at 60 deg tca
Enid Creek	IL17-25-14	259.6	291	Gabbro					Fine to medium grained gabbro with few sections of very fine grained; dark green with white to greenish white feldspar; hard; weakly magnetic in patches; areas of increased veining; trace-2% sulphides
Enid Creek	IL17-25-14					267.4	268.6	Vein	Qtz/carbonate/syenite vein 1.5-2.5cm in width in very fine grained rock; sub-parallel tca
Enid Creek	IL17-25-14					273	282	Veining	Epidote/carbonate veinlets hairline to 3cm in width; various angles tca
Enid Creek	IL17-25-14	291	291	EOH					