

We are committed to providing [accessible customer service](#).  
If you need accessible formats or communications supports, please [contact us](#).

Nous tenons à améliorer [l'accessibilité des services à la clientèle](#).  
Si vous avez besoin de formats accessibles ou d'aide à la communication, veuillez [nous contacter](#).

**WORK REPORT**  
**MINING CLAIM 3013197**  
**CARR TOWNSHIP, LARDER LAKE MINING DIV.**  
**ONTARIO**

**UTM NAD 83, ZONE 17**  
**535700 E 5380000N**

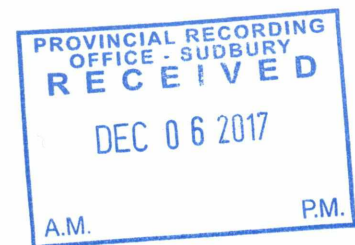

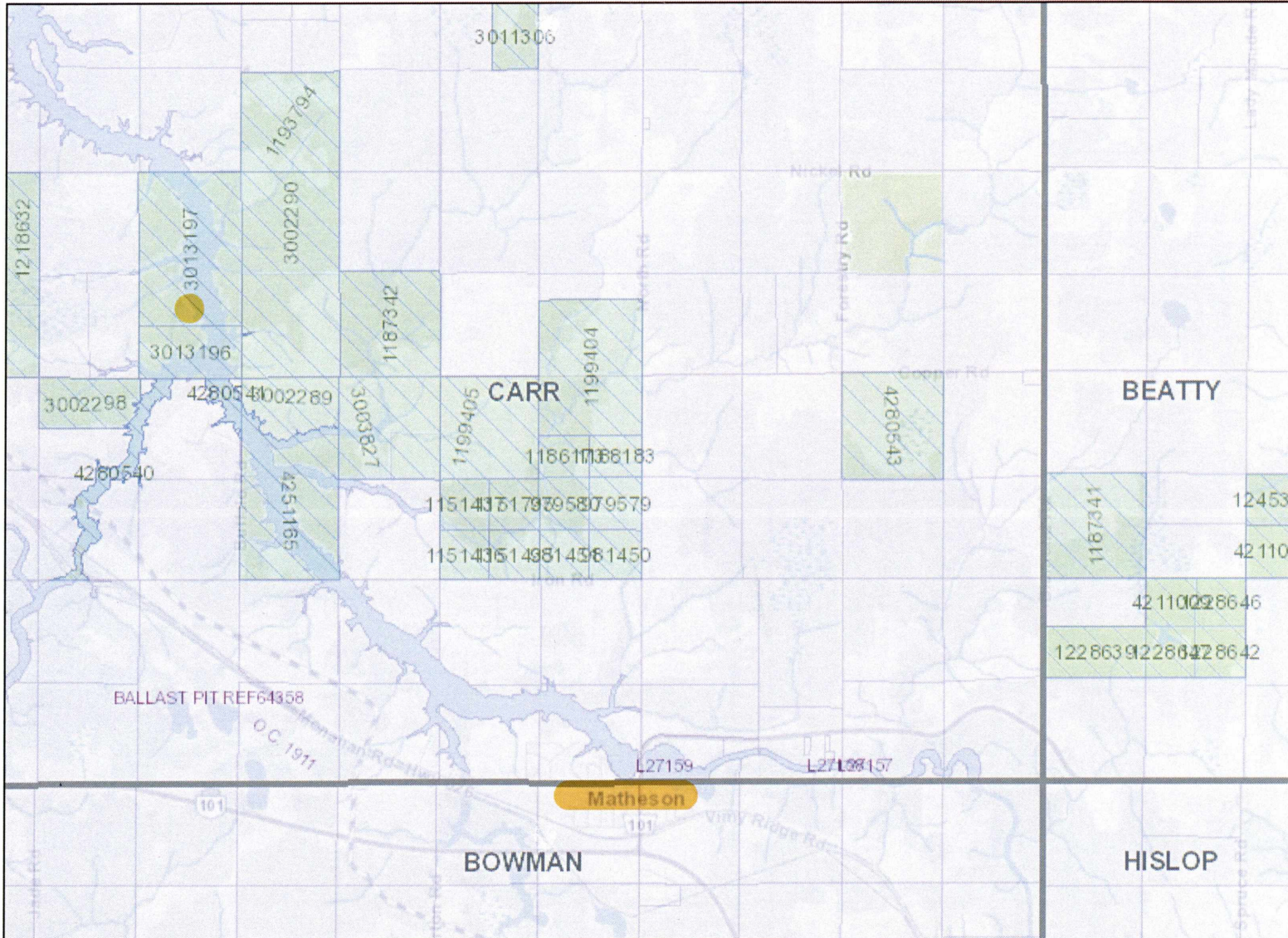

**Legend**

- Administration Boundaries**
  - Mining Divisions
  - Resident Geologist District
  - Townships and Areas
  - UTM Grid
  - Geographic Lot Fabric
  - Other Federal Land
- Mineral Tenure Grid**
  - OM TG Tenure Grid
- Alienations**
  - Withdrawal
  - Notice
- Unpatented Claim**
  - Active
  - Reconciled
  - Pending
- Disposition**
  - Disposition
- Disposition Symbols**
  - Camp
  - Disposition Unknown/Pending
  - Freehold Patent Mining Rights Only
  - Freehold Patent Surface Rights Only
  - Freehold Patent Surface and Mining Rights
  - Land Use Permit
  - Leasehold Patent Mining Rights Only
  - Leasehold Patent Surface Rights Only
  - Leasehold Patent Surface and Mining Rights
  - License of Occupation Mining Use Only
  - License of Occupation Surface Use Only
  - License of Occupation Surface and Mining Rights
  - License of Occupation Uses Not Specified
  - Order in Council
  - Tower
  - WPLA
- Geology Layers**
  - AMIS Sites
  - AMIS Features
  - DRIH Holes
  - Mineral Occurrences



Projection: Web Mercator



The Ontario Ministry of Northern Development and Mines shall not be liable in any way for the use of, or reliance upon, this map or any information on this map. This map should not be used for: navigation, a plan of survey, routes, nor locations.

© Queen's Printer for Ontario, 2016

Imagery Copyright Notices: Ontario Ministry of Natural Resources and Forestry; NASA Landsat Program; First Base Solutions Inc.; Aéro-Photo (1961) Inc.; DigitalGlobe Inc.; U.S. Geological Survey.

© Copyright for Ontario Parcel data is held by Queen's Printer for Ontario and its licensors and may not be reproduced without permission.

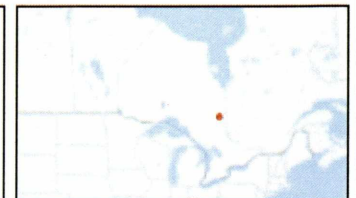

## **INTRODUCTION**

A Beep Mat Survey was conducted over an area of Mining claim 3013197, Carr Township in the Larder Lake Mining Division. The purpose of this work was to follow up on a 2013 magnetometer survey of the area and locate any near surface conductors that could be exposed.

## **PROPERTY STATUS**

This claim are recorded entirely in the name of Martyn Harrington, (Lic.K22526), of Kirkland Lake, Ontario.

## **LOCATION/ ACCESS**

The claim is located in Lot 9, Concession 3, Carr Township and was accessed via Cougar Road which forms the Lot 10-11 boundary. An ATV trail then leads east to the SW quadrant of the survey area.

## **WORK HISTORY**

The main geological feature in the area is the Porcupine-Destor Fault Zone, a major gold producing structure. Past explorers have explored the Carr Township area and have proven the existence of gold by diamond drilling. These claims have been held by the current holder since 2009, since then, only grassroots prospecting and geophysics have taken place in an effort to find gold values on the property.

## **WORK PERFORMED/ RESULTS**

A Beep Mat survey, utilizing a Kirkland Lake MNDM instrument, was conducted by Martyn Harrington on September 16-17 and November 27-28, 2017. to determine if any near surface conductive rock could be located. Control was maintained using a handheld Garmin GPS. Readings were noted at 50m intervals along lines spaced 50m apart. The survey gave low readings of both high frequency/HFR and low frequency/LFR which is indicative of relative conductivity. No MAG values were displayed which indicates a lack of magnetite, therefore, the instrument did display intrinsic conductivity/Rt%.

## **RECOMMENDATION**

Future work in this area should include soil geochem to determine if any anomolous gold values exist. Any prospective areas could then be tested by diamond drilling.

## **REFERENCES**

MNDM Claimaps , Carr Township (G-3613)  
ODM Geology Map of Carr Township  
Beep Mat Manual, GDD Instruments Ltd.  
Ontario Assessment File: 20000008519

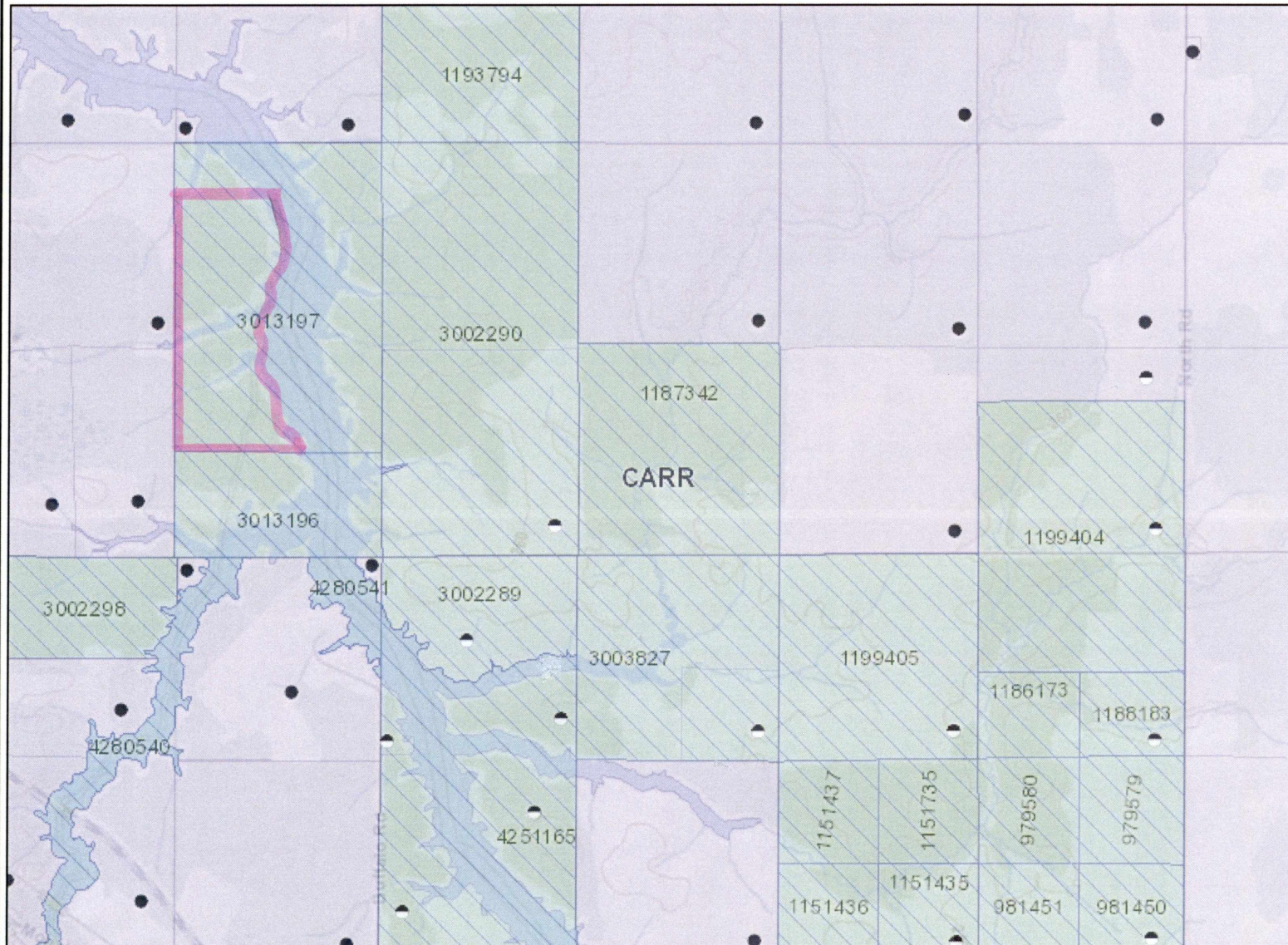

### Legend

**Administration Boundaries**

- Mining Divisions
- Resident Geologist District
- Townships and Areas
- UTM Grid
- Geographic Lot Fabric
- Other Federal Land

**Mineral Tenure Grid**

- OMTG Tenure Grid

**Alienations**

- Withdrawal
- Notice

**Unpatented Claim**

- Active
- Reconciled
- Pending

**Disposition**

- Disposition

**Disposition Symbols**

- Camp
- Disposition Unknown/Pending
- Freehold Patent Mining Rights Only
- Freehold Patent Surface Rights Only
- Freehold Patent Surface and Mining Rights
- Land Use Permit
- Leasehold Patent Mining Rights Only
- Leasehold Patent Surface Rights Only
- Leasehold Patent Surface and Mining Rights
- License of Occupation Mining Use Only
- License of Occupation Surface Use Only
- License of Occupation Surface and Mining Rights
- License of Occupation Uses Not Specified
- Order in Council
- Tower
- WPLA

**Geology Layers**

- AMIS Sites
- AMIS Features
- Drill Holes
- Mineral Occurrences



Projection: Web Mercator



The Ontario Ministry of Northern Development and Mines shall not be liable in any way for the use of, or reliance upon, this map or any information on this map. This map should not be used for: navigation, a plan of survey, routes, nor locations.

Imagery Copyright Notices: Ontario Ministry of Natural Resources and Forestry; NASA Landsat Program; First Base Solutions Inc.; Aéro-Photo (1961) Inc.; DigitalGlobe Inc.; U.S. Geological Survey.

© Copyright for Ontario Parcel data is held by Queen's Printer for Ontario and its licensors and may not be reproduced without permission.

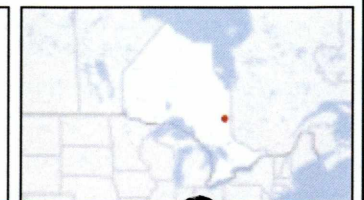

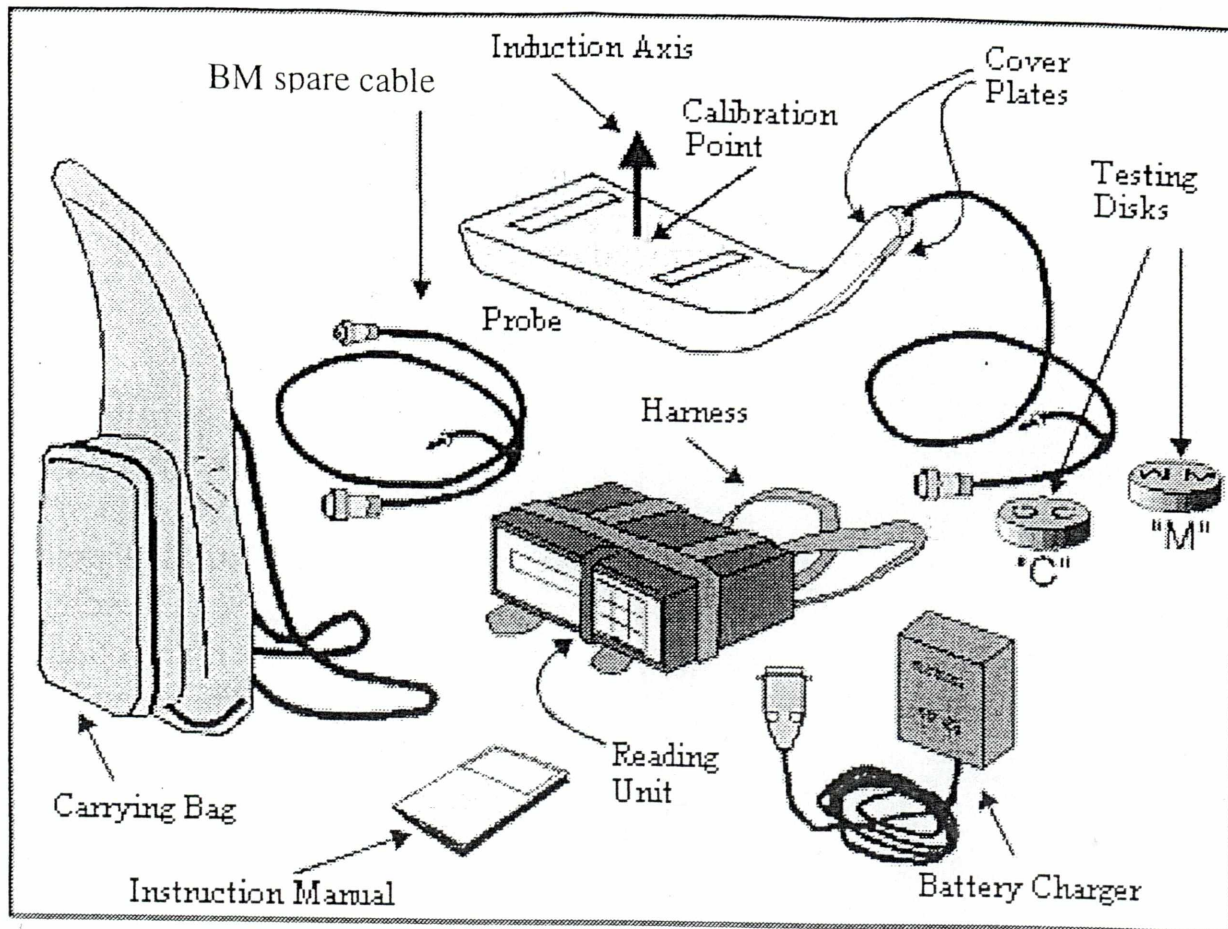

Illustration 1: Beep Mat components

5380820 N

21|0  
16|

11|0  
4|

22|0  
17|

-4|0  
-5|

6|0  
4|

13|0  
-6|

LOW

POPLAR

BLOW DOWN

5|0  
7|

-3|0  
-4|

21|0  
7|

7|0  
-4|

6|0  
-2|

5|0  
7|

16|0  
-3|

-15|0  
-6|

-1|0  
-5|

-10|0  
-4|

11|0  
5|

12|0  
2|

17|0  
-6|

10|0  
-3|

SPRUCE

-10|0  
-4|

-8|0  
-6|

5|0  
-22|

21|0  
16|

-32|0  
9|

-14|0  
7|

-11|0  
-6|

BALSAM

21|0  
9|

14|0  
3|

-12|0  
3|

5|0  
7|

17|0  
-4|

-4|0  
23|

-6|0  
-2|

BRUSH

BLOW DOWN

10|0  
13|

6|0  
-9|

-14|0  
27|

-5|0  
-9|

21|0  
-7|

16|0  
-1|

17|0  
5|

POPLAR

8|0  
27|

3|0  
-2|

-6|0  
2|

-8|0  
7|

-22|0  
3|

10|0  
12|

-6|0  
-7|

LOW

11|0  
7|

22|0  
7|

16|0  
-13|

-7|0  
-9|

6|0  
-23|

14|0  
9|

22|0  
7|

CON 3

22|0  
-14|

19|0  
7|

31|0  
-13|

16|0  
7|

14|0  
-9|

-7|0  
-5|

21|0  
-10|

BEEP MAT SURVEY SKETCH  
CARR TOWNSHIP-NOV. 2017  
MINING CLAIM 3013197  
SCALE: 1cm = 25m

HFR	RT%
LF	

LOT 10

LOT 9

-31|0  
5|

-16|0  
4|

3|0  
-2|

BALSAM

-45|0  
7|

-31|0  
9|

16|0  
-7|

SPRUCE

14|0  
2|

11|0  
-6|

14|0  
-7|

21|0  
-3|

13|0  
-25|

10|0  
-7|

16|0  
-4|

26|0  
4|

17|0  
3|

12|0  
-4|

13|0  
12|

6|0  
-7|

-26|0  
-10|

7|0  
32|

7|0  
0|

26|0  
4|

20|0  
-12|

13|0  
-25|

BLACK RIVER

SPRUCE, BALSAM, POPLAR

10|0  
4|

-6|0  
8|

-10|0  
-14|

21|0  
-9|

27|0  
9|

18|0  
-4|

-7|0  
2|

-15|0  
16|

2|0  
-10|

10|0  
-18|

6|0  
5|

7|0  
21|

-6|0  
2|

14|0  
7|

3|0  
-1|

20|0  
-2|

16|0  
-10|

14|0  
1|

7|0  
2|

-4|0  
-6|

18|0  
-2|

LOW GROUND

6|0  
7|

-8|0  
4|

12|0  
7|

-5|0  
2|

-8|0  
10|

16|0  
-2|

11|0  
1|

6|0  
2|

SPRUCE

-15|0  
6|

5|0  
11|

7|0  
2|

14|0  
5|

-10|0  
-2|

16|0  
7|

17|0  
11|

-7|0  
-2|

-22|0  
3|

BRUSH

BALSAM

21|0  
6|

2|0  
4|

18|0  
31|

16|0  
4|

7|0  
-2|

8|0  
1|

13|0  
-4|

-6|0  
4|

-12|0  
3|

33|0  
-5|

13|0  
-4|

21|0  
7|

2|0  
4|

-20|0  
8|

-15|0  
8|

-10|0  
11|

16|0  
5|

7|0  
9|

POPLAR

NAD 83  
535530 E  
5379820 N

22|0  
-15|

6|0  
-25|

8|0  
35|

1|0  
0|

-45|0  
9|

-5|0  
25|

-40|0  
5|

11|0  
3|

14|0  
10|

5379820 N