

We are committed to providing [accessible customer service](#).  
If you need accessible formats or communications supports, please [contact us](#).

Nous tenons à améliorer [l'accessibilité des services à la clientèle](#).  
Si vous avez besoin de formats accessibles ou d'aide à la communication, veuillez [nous contacter](#).

2 · 58443

**Prospecting  
On The  
Sheppard Group Claim 4203306  
Aylmer Township, Sudbury, Ontario  
October 26, 2017**

**F. Delabbio, P.Eng.**

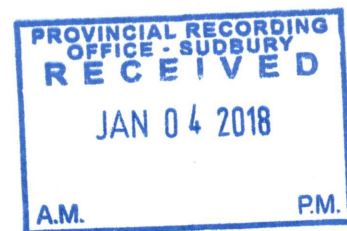

## TABLE OF CONTENTS

Location and Access	1
Location Map	2
Claim Map	3
Work Log (October 26, 2017)	4 & 4a
Preamble	5
Work Location Map	6
List of Workers	7

## LOCATION AND ACCESS

Aylmer Township is located north of Lake Wanapitei, Sudbury Mining Division. Access to the mining claims in Aylmer Township is via Highway 545 North of Capreol and onto the Portelance Road. You travel north for 18 km after the turnoff for the Wanapitei First Nation. You then leave the Portelance Road and turn south over the bridge of the Wanapitei River onto the Poupore Road. You travel south on the Poupore Road for 11 km to 13 km to the gravel pit on the edge of the east branch of the Wanapitei River. You turn south towards lake Wanapitei on the North River Park Road for 2 km to the middle of the claim.

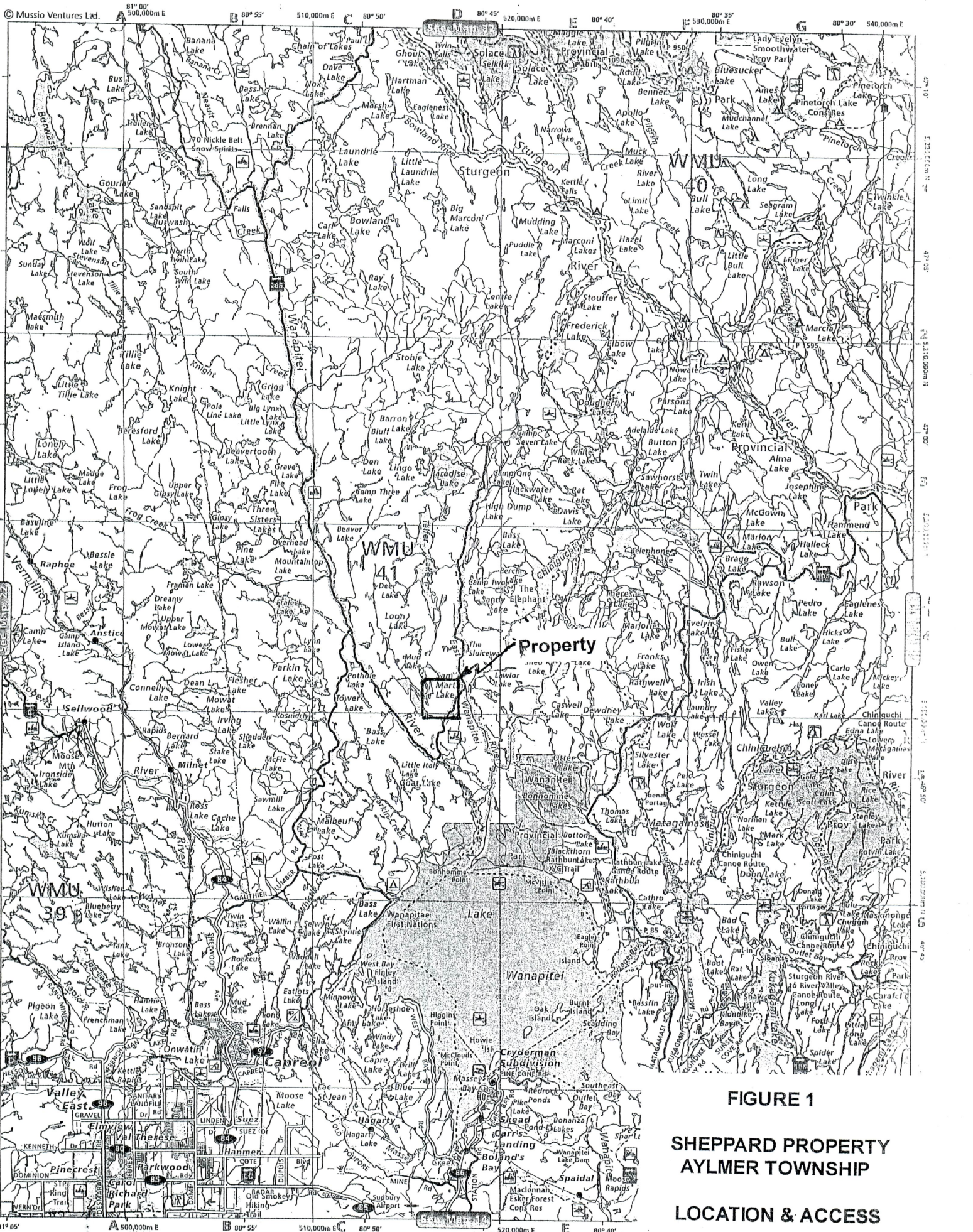

**FIGURE 1**

**SHEPPARD PROPERTY  
AYLMER TOWNSHIP  
LOCATION & ACCESS**

**Scale: 1:250 000 Nov 2017**

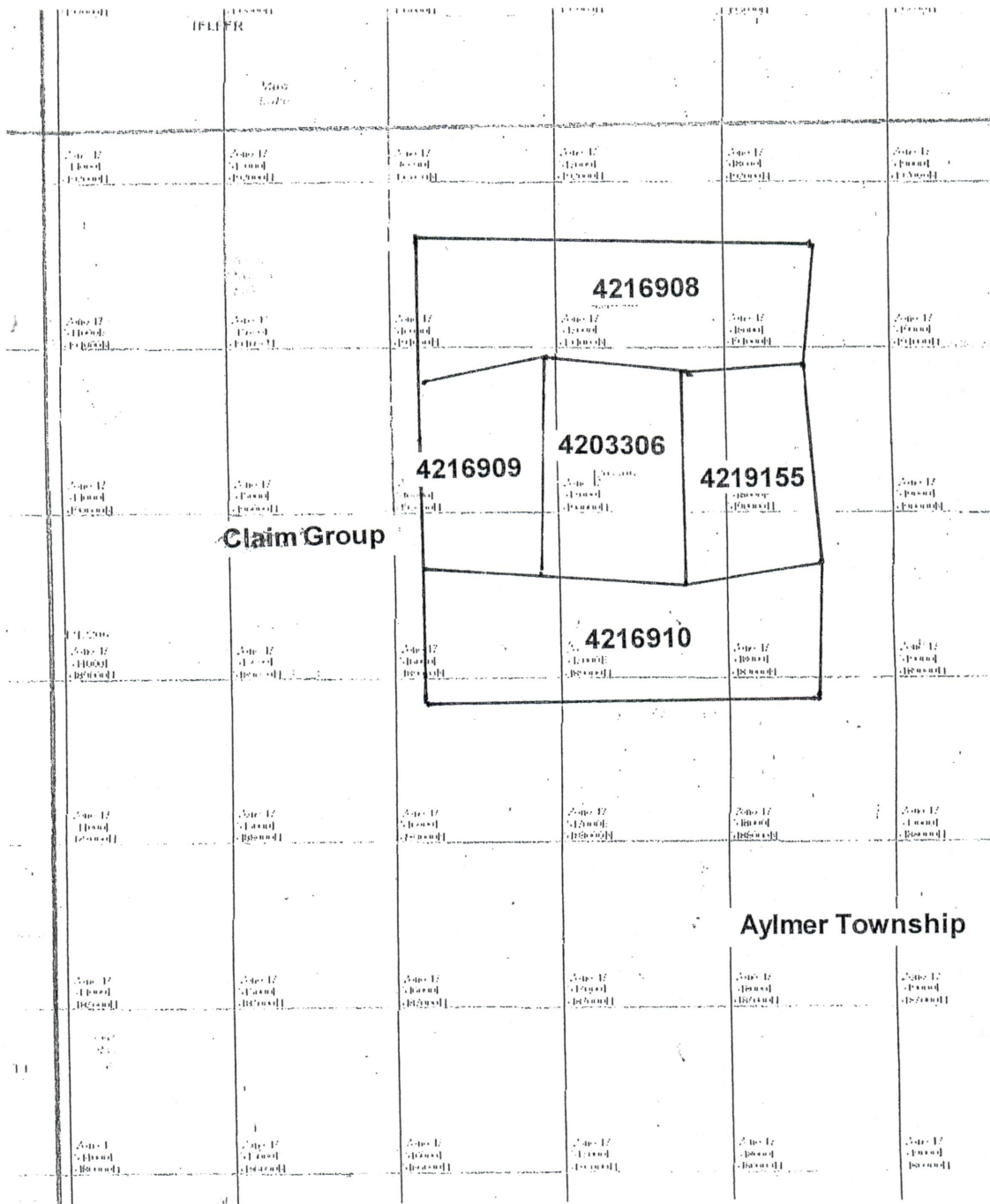

**FIGURE 2**

**SHEPPARD PROPERTY  
AYLMER TOWNSHIP**

**CLAIM MAP**

**Job:** Aylmer

**Date:** October 26, 2017

Picked up Stu Winter and met Tom in Capreol. Travelled up to work on claim 4203306. We followed up on showing of quartz breccia on the road that I had found Sept. 30<sup>th</sup>. We cleared off with shovels and washed down a location on the north side of the road just east of the gate to the quarry road – FPS 0517276 5189595. We cleared off a showing of quartz breccia with grey wacke on one side. The quartz breccia has a lot of small milky quartz stringers with little sulphides.

**Party Chief:** Fred Delabbio

**Weather:** Mixed clear and rain, +5 degrees

JOB..... RYANER .....  
DATE..... Oct 26 / 17 ..... PAGE.....

JOB.....  
DATE..... PAGE.....

Picked up Stu Winter and  
met Tom in CARAEDL.

Travelled up to work on  
claim 4203306. We followed  
up on showing of quartz breccia  
on the road that I had found  
Sept 30. We cleared off with

shovels and washed down  
a location on the north side  
of the road just east of the  
gate to the quarry road GPS 0517276  
5189595. We cleared off a

showing of quartz breccia with  
gregynite on one side. The  
quartz breccia has a lot of small  
milky quartz stringers with  
little sulphides.

PARTY CHIEF.....

WEATHER..... MIXED CLEAR + RAIN + 5° .....

PARTY CHIEF.....

WEATHER.....



## **Preamble**

Recent grading on the Poupore Road has exposed new ground on the immediate North portion of the road (down slope from the copper showing). We cleared off and washed the ground confirming the ground to be quartz breccia. We will now have to trench between the road and the copper/breccia showing.

AYLMER  
TWP.

5,189,900 mN

CLAIM  
4203306

5,189,800 mN

5,189,700 mN

5,189,600 mN

quarry road

quarry road

Perseus Road

Copper  
&  
showing

gate

gate

work  
location

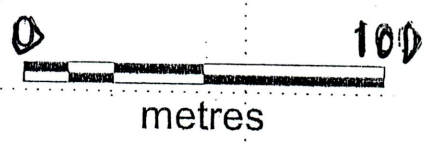

#2 post

CLAIM  
4216910

Names and Signatures of Workers

Fred Delabbio F. Delabbio

Tom Sheppard Tom Sheppard

Jim Jackson [Signature]

Gerry Gereghty Gerald J. Gereghty

Stewart Winter LDS. Winter