

We are committed to providing [accessible customer service](#).

If you need accessible formats or communications supports, please [contact us](#).

Nous tenons à améliorer [l'accessibilité des services à la clientèle](#).

Si vous avez besoin de formats accessibles ou d'aide à la communication, veuillez [nous contacter](#).

**Prospecting on Legacy**

**Claim 4216910**

**Aylmer Township, Sudbury, Ontario**

**Sheppard Claims**

**May 15, 2018**

**F. Delabbio, P.Eng.**

## TABLE OF CONTENTS

Location and Access	1
Location Map	2
Claim Map (Legacy)	3
Claim Map (Single Cell)	4
Work Log	5
Preamble	6
Prospecting Map	7
Aerial Photo	8
Overlay of Photo	9

## LOCATION AND ACCESS

Aylmer Township is located north of Lake Wanapitei, Sudbury Mining Division. Access to the mining claims in Aylmer Township is via Highway 545 North of Capreol and onto the Portelance Road. You travel north for 18 km after the turnoff for the Wanapitei First Nation. You then leave the Portelance Road and turn south over the bridge of the Wanapitei River onto the Poupore Road. You travel south on the Poupore Road for 11 km to 13 km to the gravel pit on the edge of the east branch of the Wanapitei River. You turn south towards lake Wanapitei on the North River Park Road for 2 km to the middle of the claim.

LOCATION



AYLMER

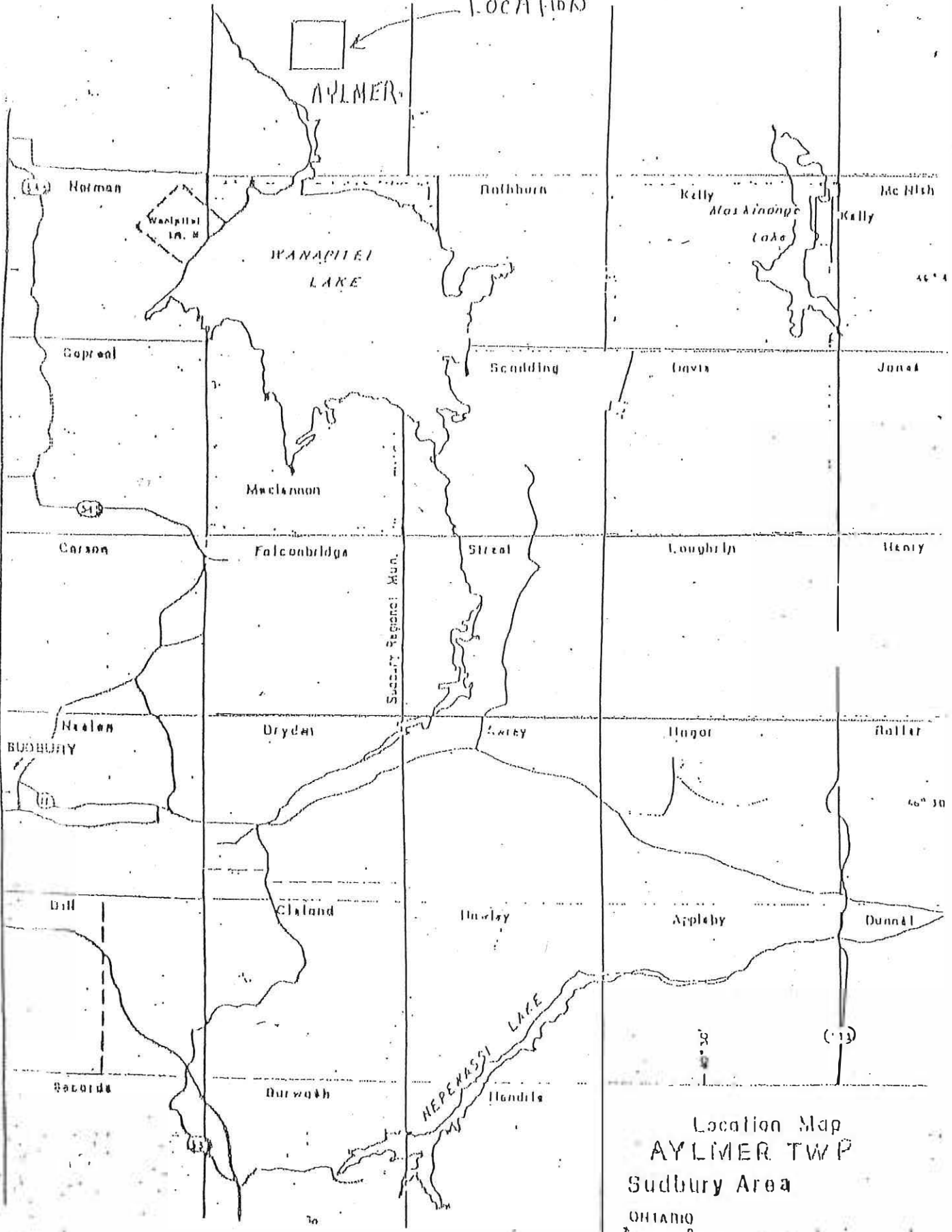

ONTARIO

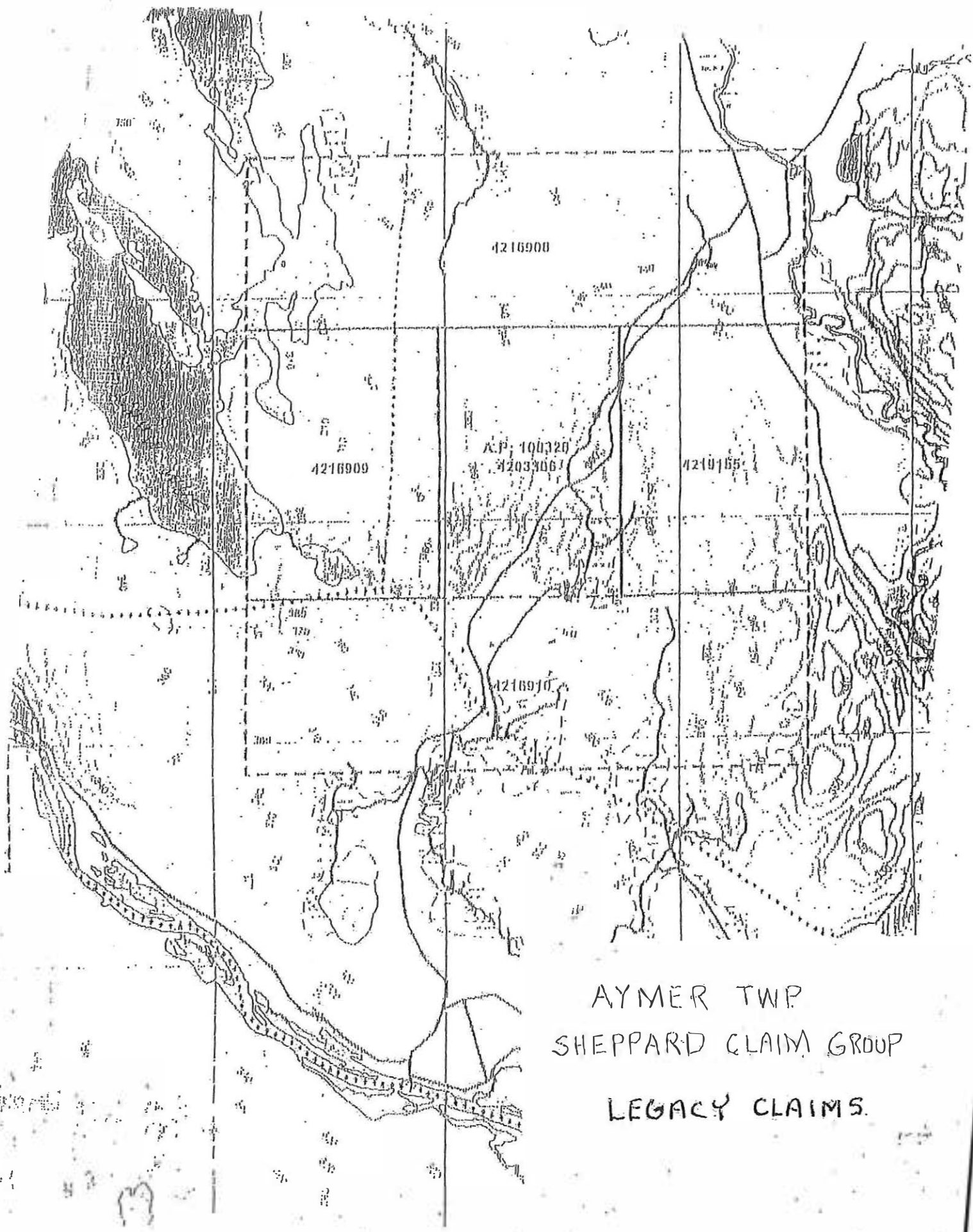

AYMER TWP  
SHEPPARD CLAIM GROUP  
LEGACY CLAIMS.

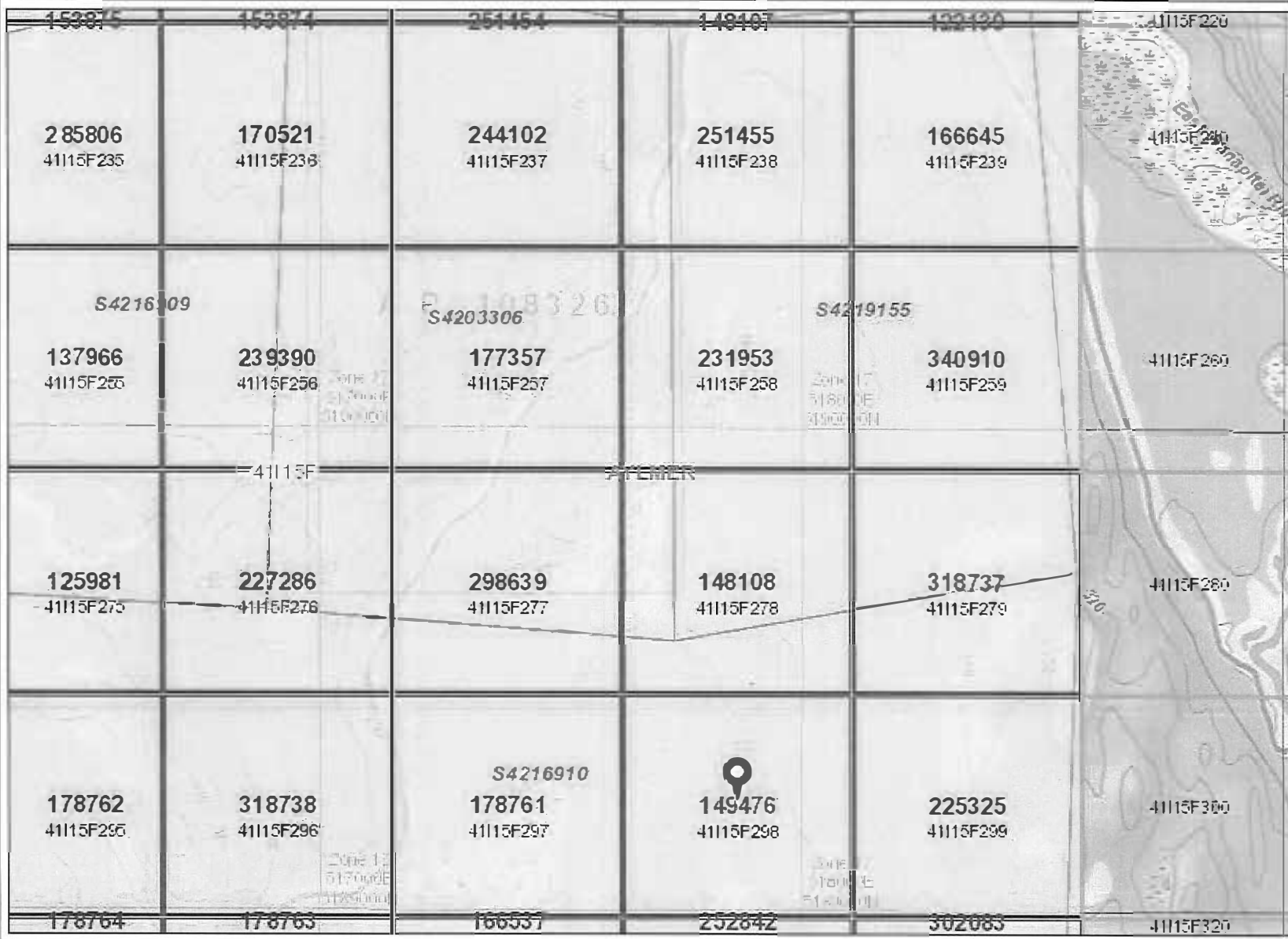

### Legend

**Provincial Grid Cell**

- Available
- Pending
- Unavailable

**Mining Claim**

- Mining Claim

**Mining Lease**

- Surface Rights Only
- Mining Rights Only
- Surface and Mining Rights

**Mining Licence of Occupation**

- Surface Rights Only
- Mining Rights Only
- Surface and Mining Rights

**Mining Patent**

- Surface Rights Only
- Mining Rights Only
- Surface and Mining Rights

**Boundary Claim**

- Boundary Claim

**Legacy Claim**

- Legacy Claim

**Mining Claim - History**

- Mining Claim - History

**Mining Land Tenure - History**

- Mining Land Tenure - History

**Mining Division**

- Mining Division

**MNDM Townships and Areas**

- MNDM Townships and Areas

**Provincial Grid Group**

- Provincial Grid Group

**Non-Mining Land Tenure**

- Patent, Surface Rights Only
- Patent, Mining Rights Only
- Patent, Surface and Mining Rights
- Lease, Surface Rights Only



Projection: Web Mercator



The Ontario Ministry of Northern Development and Mines shall not be liable in any way for the use of, or reliance upon, this map or any information on this map. This map should not be used for: navigation, a plan of survey, routes, nor locations.

Imagery Copyright Notices: Ontario Ministry of Natural Resources and Forestry; NASA Landsat Program; First Base Solutions Inc.; Aéro-Photo (1961) Inc.; DigitalGlobe Inc.; U.S. Geological Survey.



**Job:** Aylmer

**Date:** May 15, 2018

Picked up Jim and Tom and drove up to claims. Road opened on Saturday and is in good shape. Equipped with a recent aerial photo of a portion of legacy claim 4216910. We tried to locate the reported trenches in old O.D.M. reports. We were unable to locate them and mapped in any new outcrops which appeared to all be grey wacke. We also tried to get through the over burden between the Poupore road and the copper showing on claim 4203306, but there are too many boulders. We then stopped at the Wanapitei First Nation and met Ms. Hannah Burke who would like to visit the site in early June.

**Party Chief:** Fred Delabbio

**Weather:** Sunny, +12 degrees



## PREAMBLE

We obtained a recent aerial photo of an area around the creek bed on claim 4216910 and 4219155. We have been trying to locate pits and trenches from O.D.M. reports but to no avail. We have included the aerial photo as well as an overlay showing our traverse as well the outcrops along the edge of the swamp that we all grey wacke.

AYLMER TWP

CLAIM  
4203300

CLAIM  
4216910

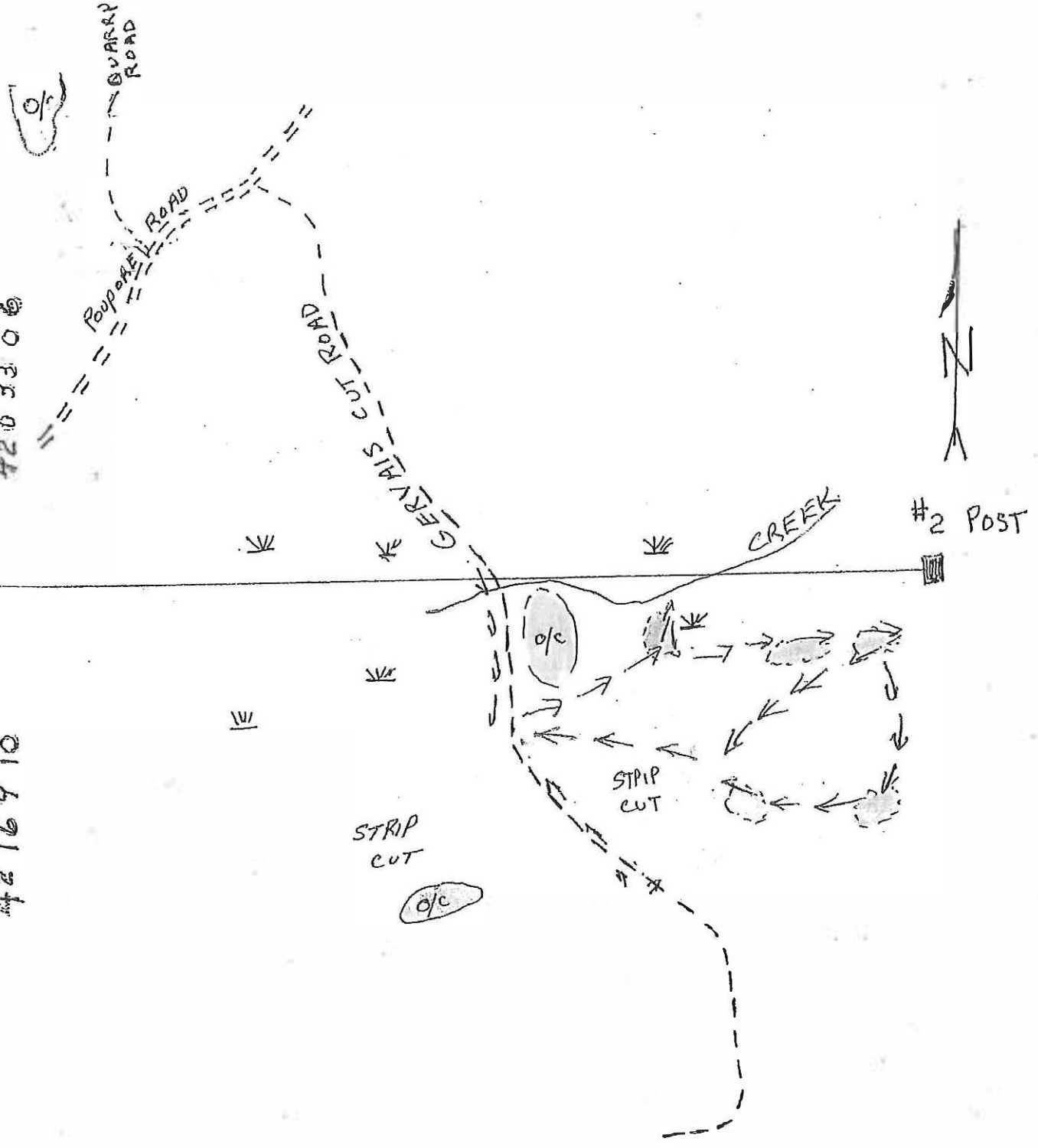

← TRAVERSE

- o/c OUTCROP
- QUARTZITE
- GREYWACKE

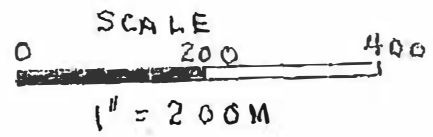

F. Delabbio MAY 2018

OVERLAY OF PHOTO  
SWAMP  
← TRAVERSE  
O/C OUTCROP

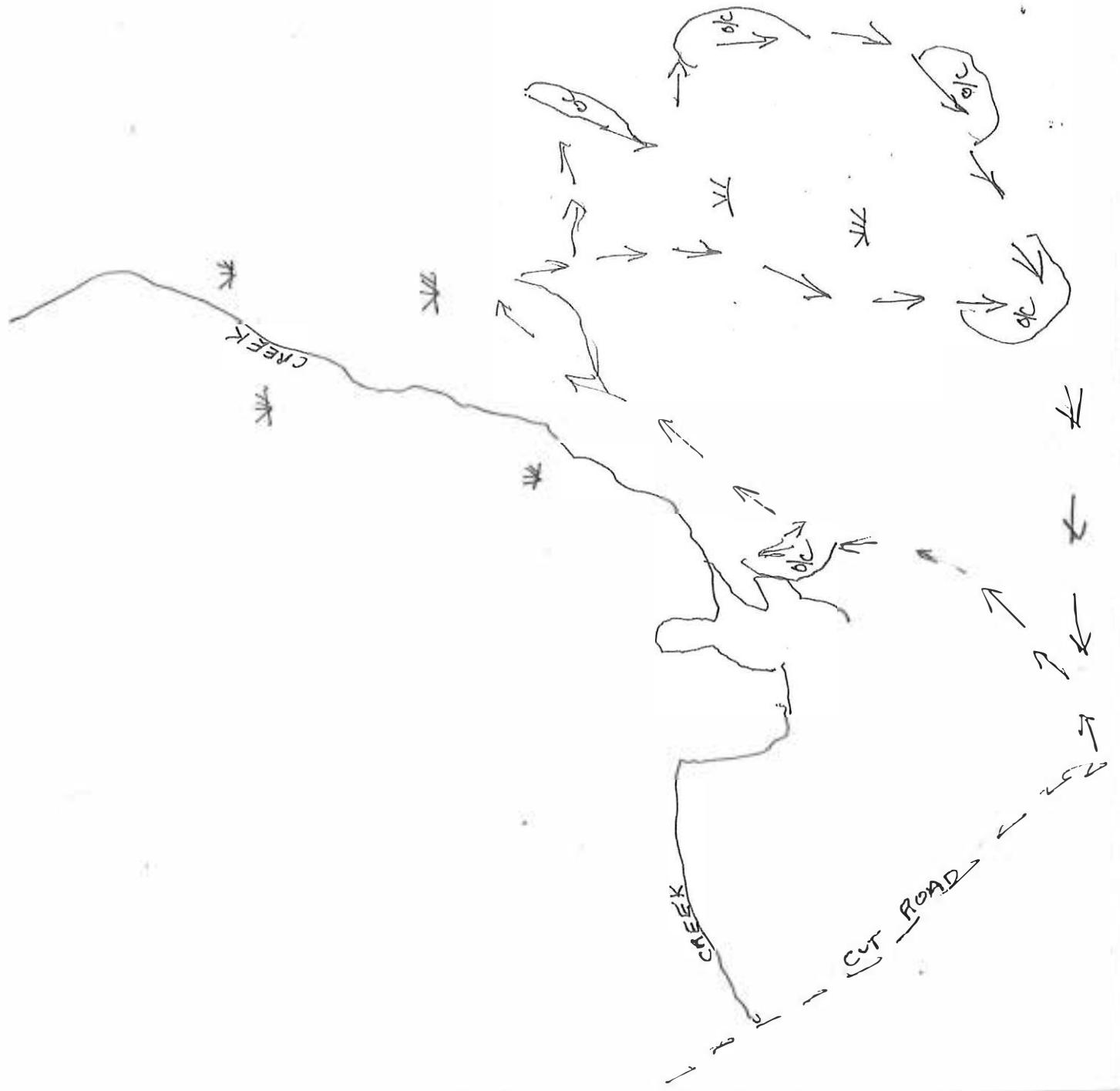

AIP PHOTO  
2016

Map

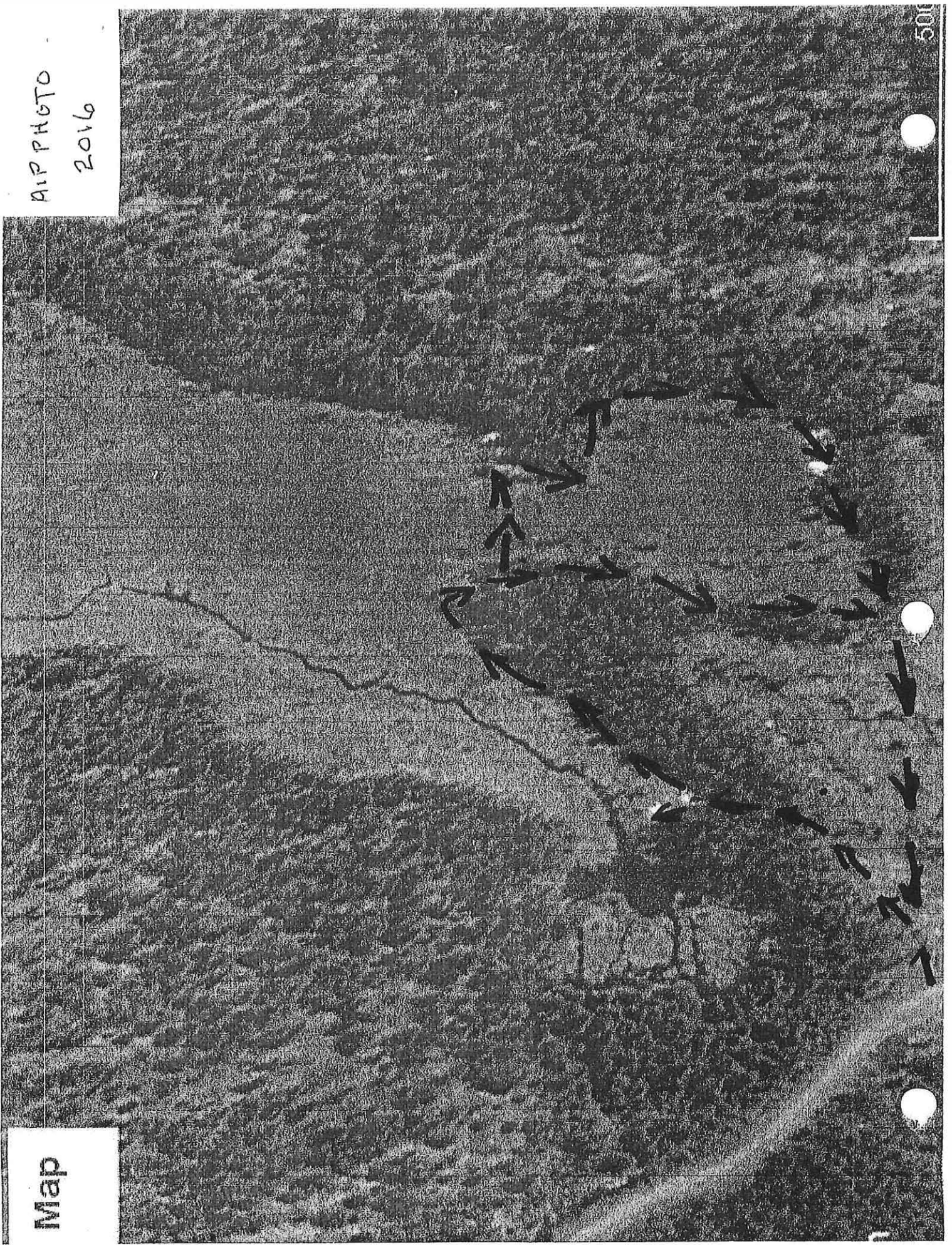

500

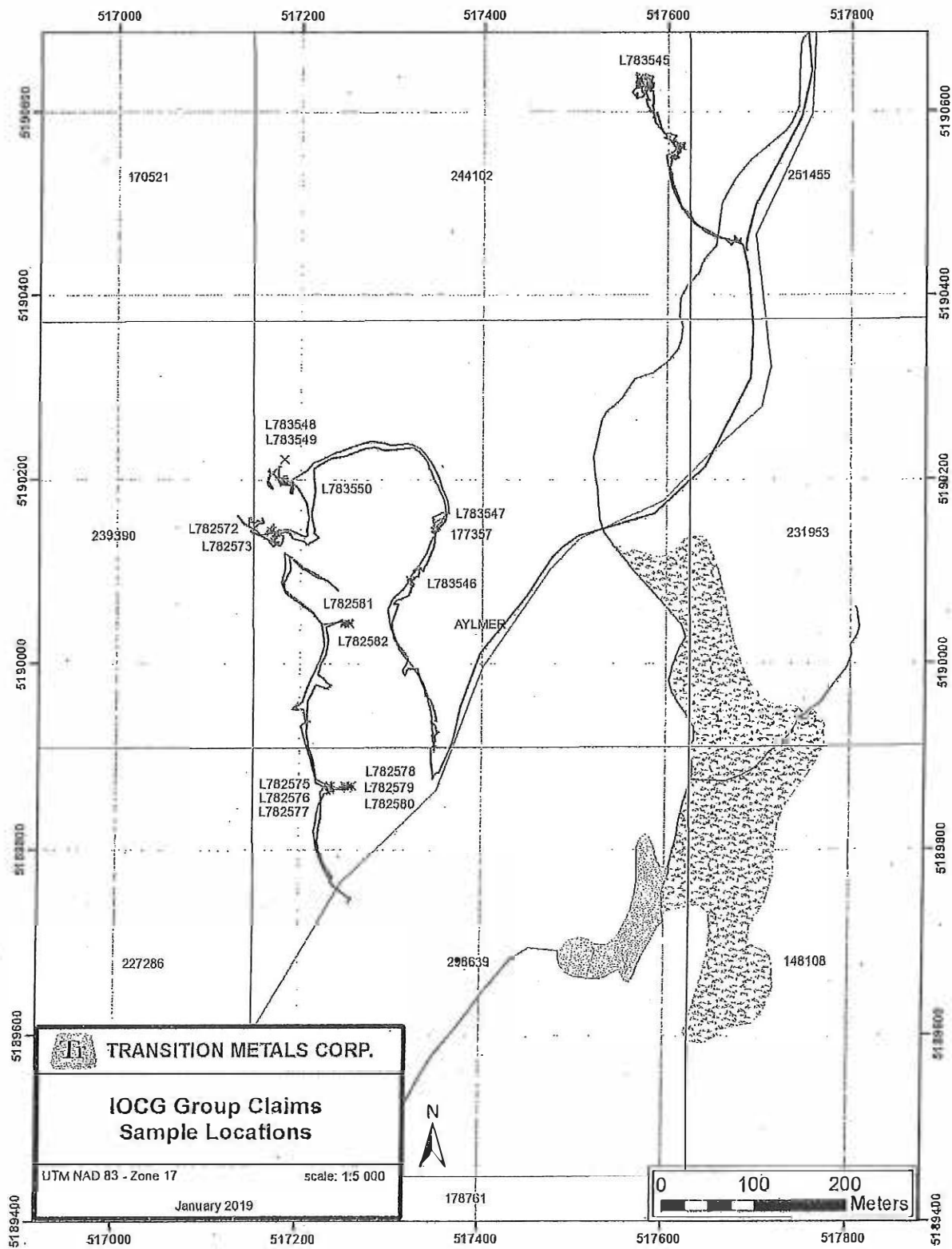

Figure 5: Claims map of the property with the locations of sampled collected in 2018.