

We are committed to providing [accessible customer service](#).

If you need accessible formats or communications supports, please [contact us](#).

Nous tenons à améliorer [l'accessibilité des services à la clientèle](#).

Si vous avez besoin de formats accessibles ou d'aide à la communication, veuillez [nous contacter](#).

**Prospecting  
On Claim 524992  
Telfer Township, Sudbury, Ontario  
August 23, 2018  
Sheppard Claims**

**F. Delabbio, P.Eng.**

**Job:** Telfer

**Date:** August 23, 2018

Stu and I picked up Tom in Capreol and travelled up to the north end of Sam Martin to check on the access from the Gervais Lumber cut roads to the north west area of the northern cells of our property. We flagged the area of the northern and western boundary. We only found one area of bedrock and this was an outcrop of grey wacke. The area is still heavily wooded with deep glacial moraine.

**Party Chief:** Fred Delabbio

**Weather:** Sunny, +22 degrees

## **LOCATION AND ACCESS**

Telfer Township is located north of Lake Wanapitei, Sudbury Mining Division. Access to the mining claims in Aylmer Township is via Highway 545 North of Capreol and onto the Portelance Road. You travel north for 18 km after the turnoff for the Wanapitei First Nation. You then leave the Portelance Road and turn south over the bridge of the Wanapitei River onto the Poupore Road. You travel south on the Poupore Road for 11 km to 13 km to the gravel pit on the edge of the east branch of the Wanapitei River. You turn south towards lake Wanapitei on the North River Park Road for 2 km to the middle of the claim.

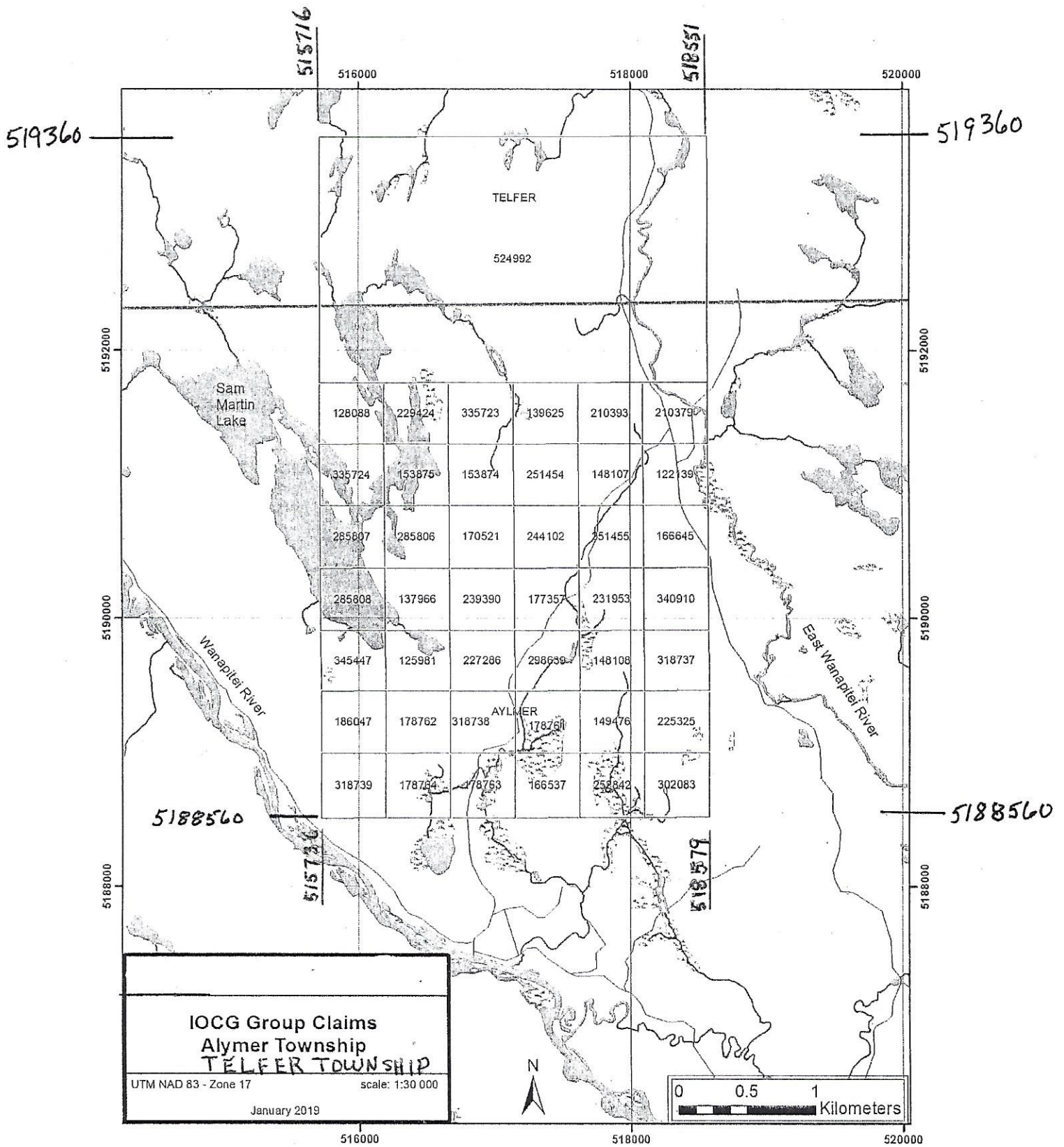

Figure 2: IOCG Joint Venture Group claim map

515000E

516000E

517000E

518000E

519000E

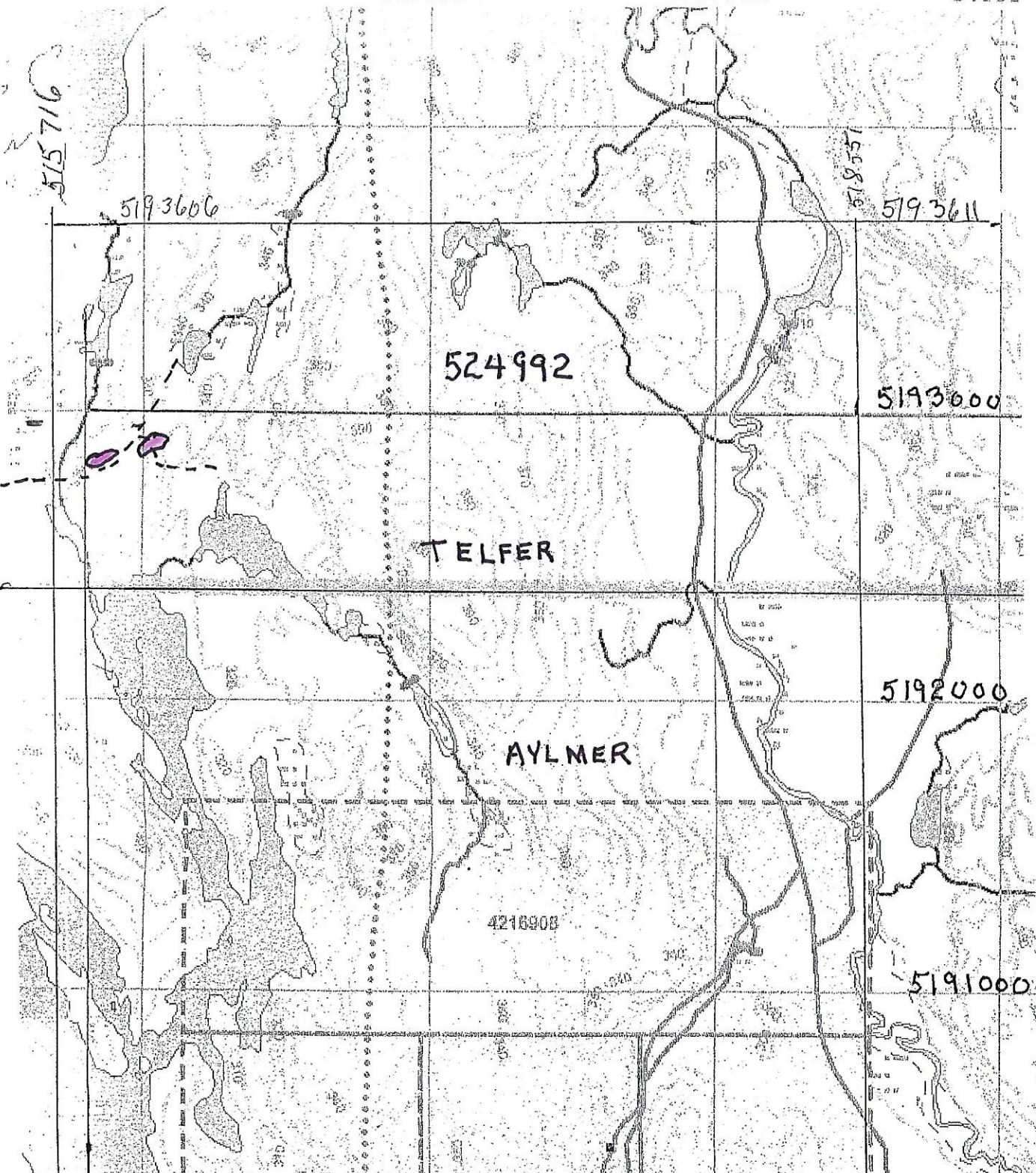

I.O.C.G CLAIMS  
 TELFER-AYLMER  
 TWPS

ACCESS ROAD - - - -  
 GRAVEL PIT ○  
 CULVERT OUT \*  
 GREYWACKE □

SCALE  
 1:20000  
 SEPT 6/19