

We are committed to providing [accessible customer service](#).

If you need accessible formats or communications supports, please [contact us](#).

Nous tenons à améliorer [l'accessibilité des services à la clientèle](#).

Si vous avez besoin de formats accessibles ou d'aide à la communication, veuillez [nous contacter](#).

**Prospecting on
Multicell 524992 in
Telfer Township, Sudbury, Ontario
And Cell 298639 in
Aylmer Township, Sudbury, Ontario
Sheppard Claims
July 15, 2019**

F. Delabbio, P.Eng.

TABLE OF CONTENTS

Location and Access	1
Location Map	2
Claim Map (Cells)	3
Work Log	4
Preamble	5
Pictures of Road Work	6, 6a)
Prospecting Map	7
WORK MAP	7(a)
Pictures of Pot Holes	8, 8a)

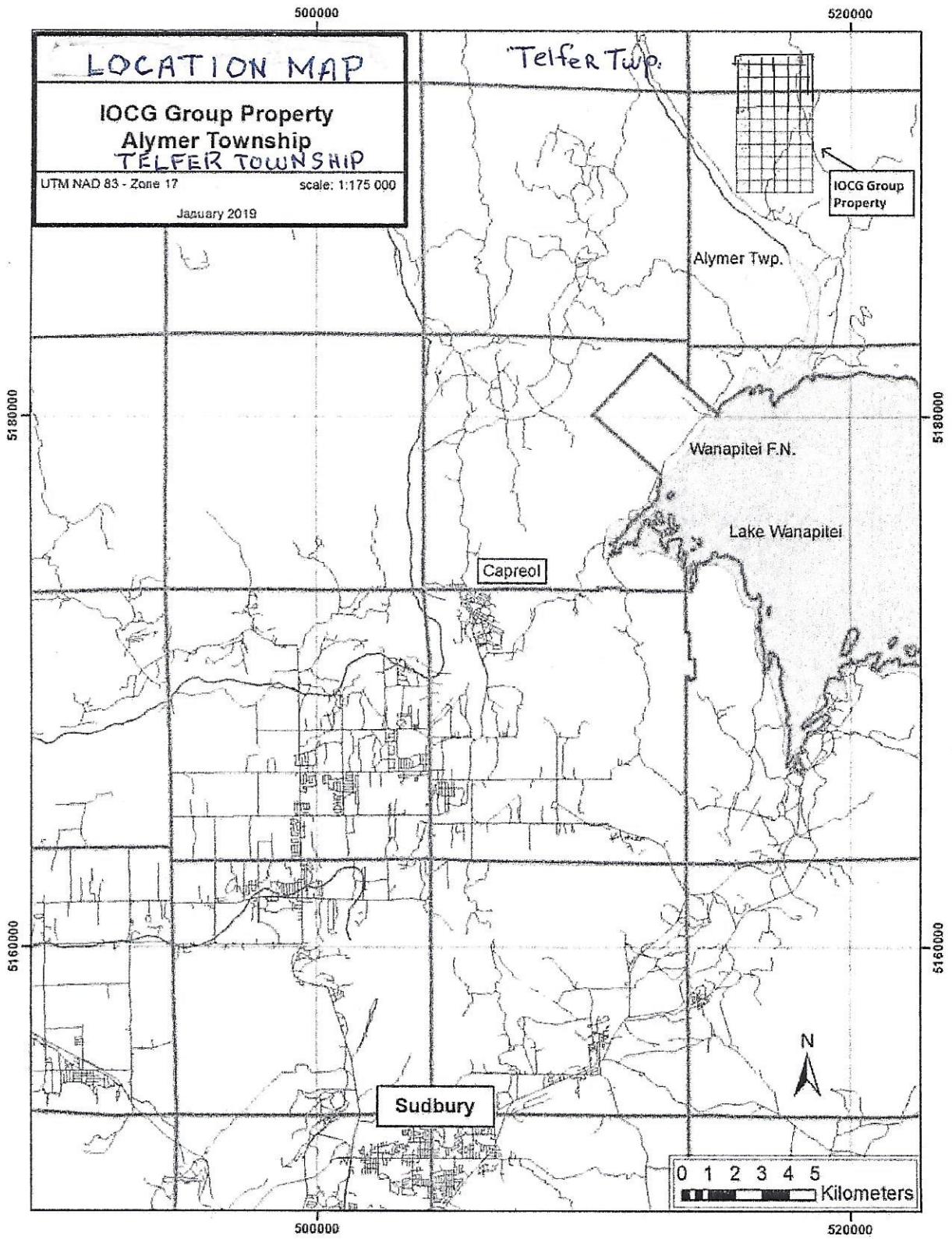

Figure 1: Property location map

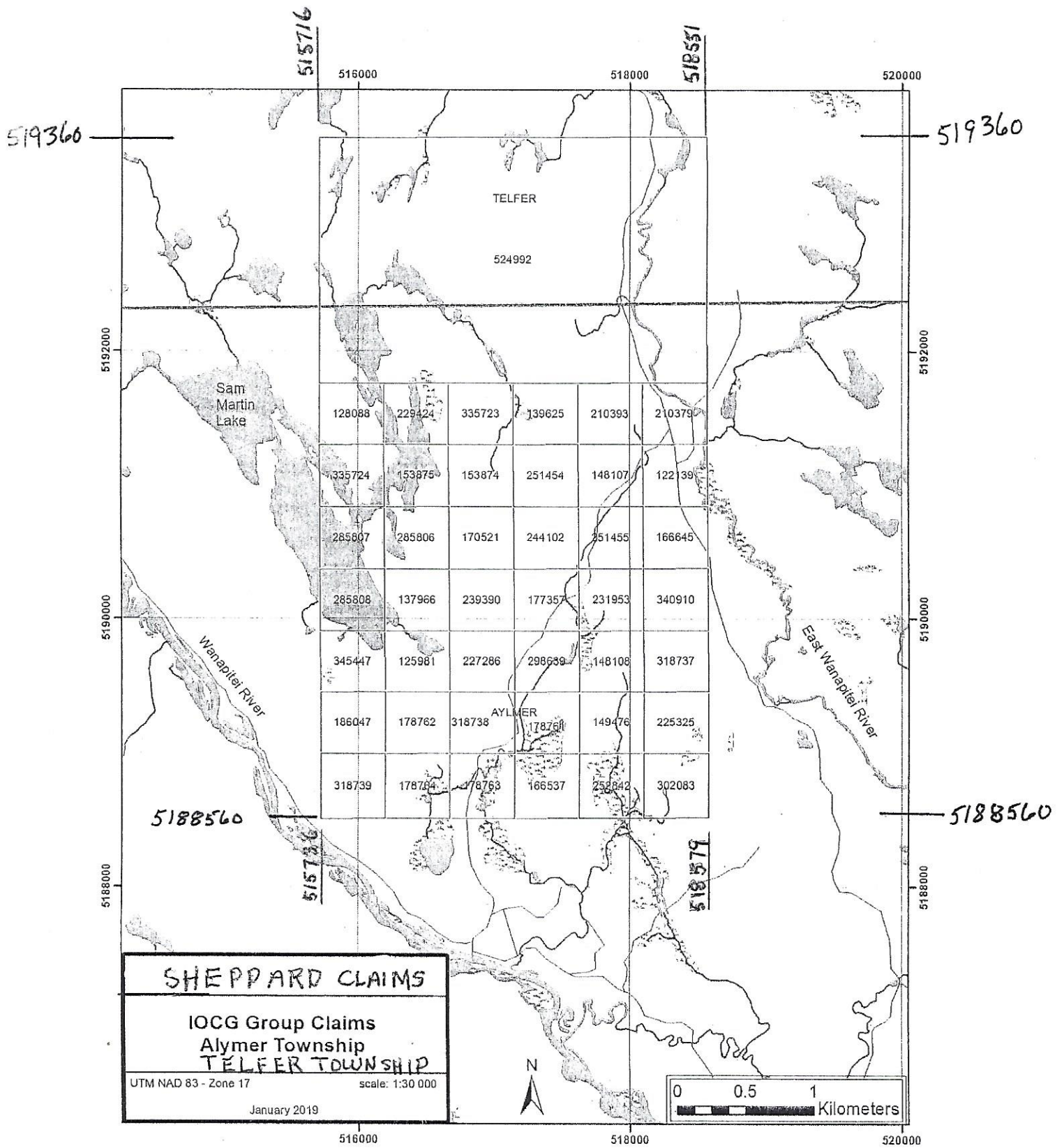

Figure 1: IOCG Joint Venture Group claim map

JOB..... July 15/19

DATE..... Aglmer..... PAGE.....

Picked up Tom in Capreol and we travelled up to the property. We installed our lock on the access gate and removed all the cut and fallen trees across the road. We did this so we can remove more samples from both the new gold showing and the copper showing.

We travelled up to claim 5M992 ~~5M992~~ to check out the major shearing in the mudstone to try and correlate this to our sediments to the west. We also took photos of the potholes in the mudstone.

Battery died on G.P.S.

PARTY CHIEF..... F. DeLabbio

WEATHER..... 22° Sunny

Abstract

Picked up Tom in Capreol and we travelled up to claims in Aylmer Township. For some reason, someone or persons had cut down a large number of trees on our access road to our copper and gold showing. We removed the trees as we were bringing up trenching equipment to take a number of samples (pictures attached are self-explanatory). We then travelled up to the NE corner of the multicell group 524992 to map in some of the structure to get a handle if it has any bearing on our ground to the west. While there, we took pictures of the potholes in the mudstone. The mudstone bedding dips @ 20 degrees to the east and some of the faces shown examples of ancient water ripples.



OVA Lock Placed on GATE



Further up from gate near
Copper Showing downed trees.

(6a)

July 15/19



Looking up from gate at
downed trees



Looking up road from gate at
downed trees

133 CM X 130CM pot hole 36 cm deep

0518248, 5193299



8(a)

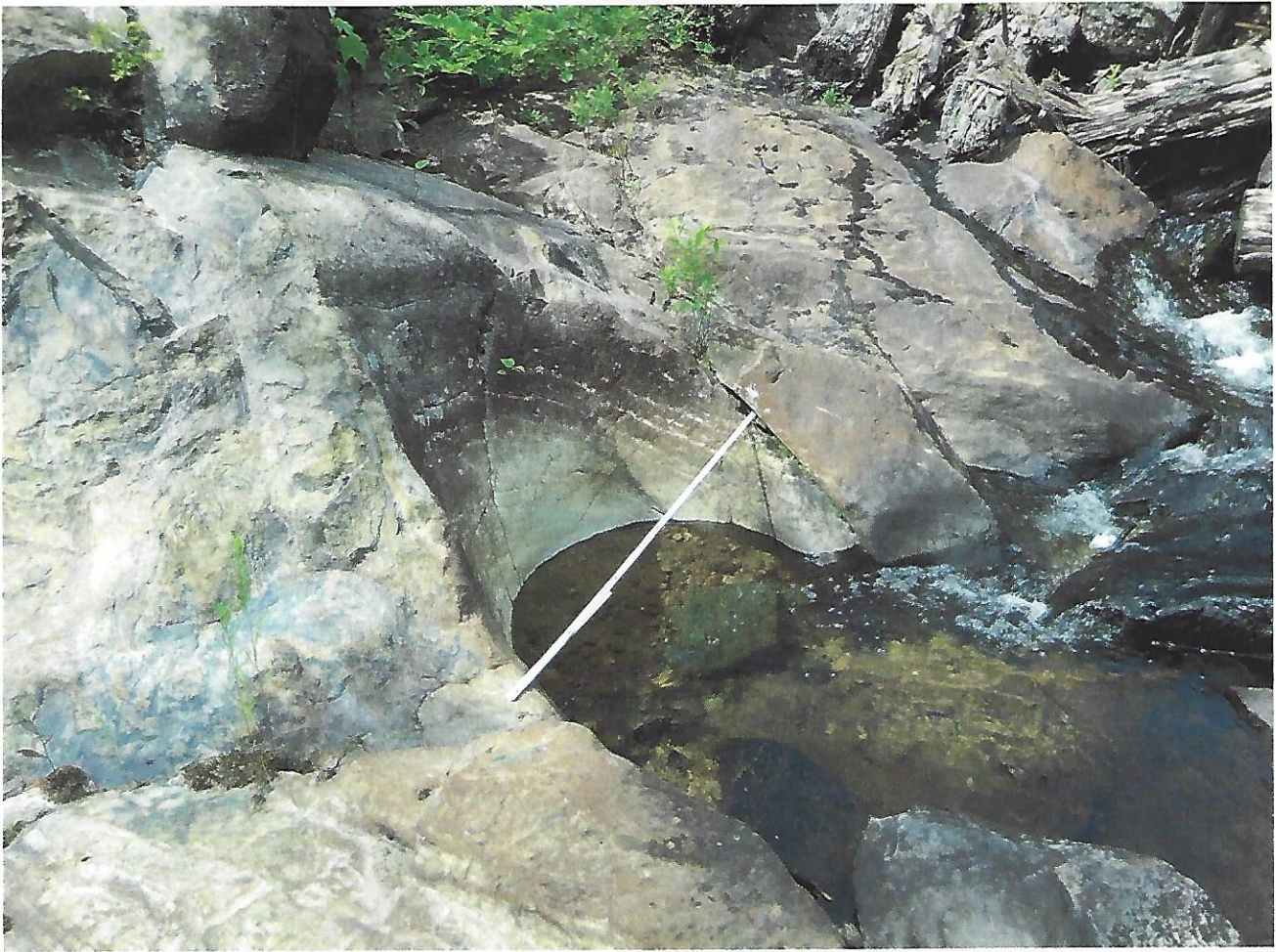

Larger Pothole 140 cm x 127 cm

GPS 0518231
5193269

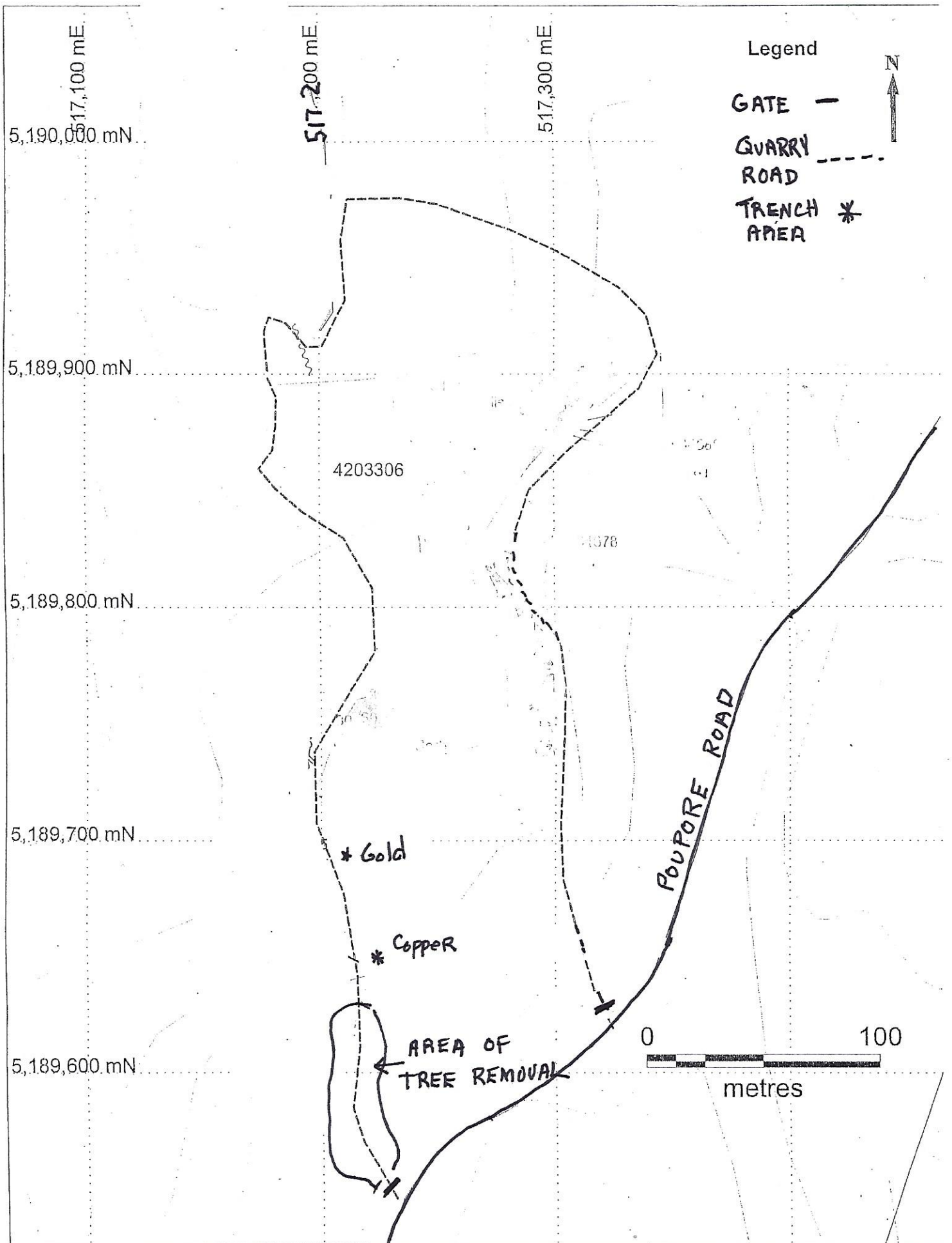

518000E

524992

0510124
5193277 *

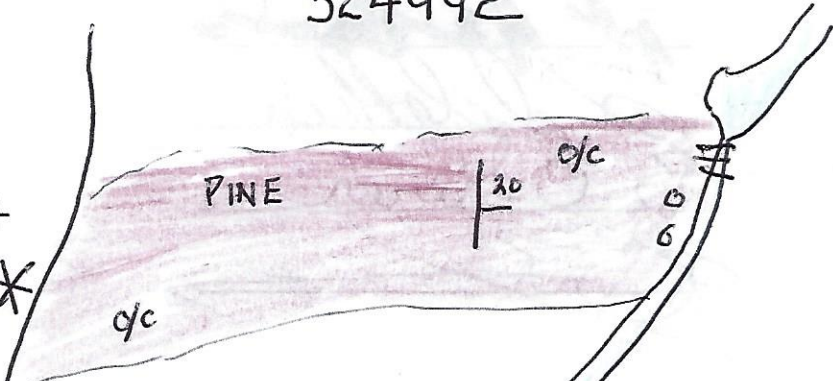

POUPORE ROAD

TELFER
TWP

WANAPITEI RIVER

5193000



LEGEND

- WATER FALLS =
- POT HOLE ○
- DIP
- MUDSTONE
- OUTCROP o/c

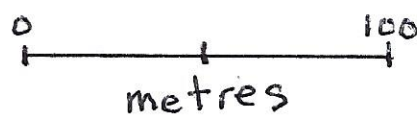

GPS *