

We are committed to providing [accessible customer service](#).

If you need accessible formats or communications supports, please [contact us](#).

Nous tenons à améliorer [l'accessibilité des services à la clientèle](#).

Si vous avez besoin de formats accessibles ou d'aide à la communication, veuillez [nous contacter](#).

**Prospecting on  
Cell 227286 in  
Aylmer Township, Sudbury, Ontario  
Sheppard Claims  
August 20, 2019**

**F. Delabbio, P.Eng.**

## TABLE OF CONTENTS

Location and Access	1
Location Map	2
Claim Map (Cells)	3
Work Log	4
Preamble	5
Prospecting Map	6
Assay Invoice	7
Assay Results	8,a,b,c

## **Preamble**

We have a party interested in the property, but need more information on the gold showing. We brushed in a trail from the quarry road and chipped out about 50 lbs of material but will have to return with pry bars and bigger hammers to get down deeper where the samples are not so weathered. We sent in 2 samples for gold and multi element.

## LOCATION AND ACCESS

Aylmer Township is located north of Lake Wanapitei, Sudbury Mining Division. Access to the mining claims in Aylmer Township is via Highway 545 North of Capreol and onto the Portelance Road. You travel north for 18 km after the turnoff for the Wanapitei First Nation. You then leave the Portelance Road and turn south over the bridge of the Wanapitei River onto the Poupore Road. You travel south on the Poupore Road for 11 km to 13 km to the gravel pit on the edge of the east branch of the Wanapitei River. You turn south towards lake Wanapitei on the North River Park Road for 2 km to the middle of the claim.

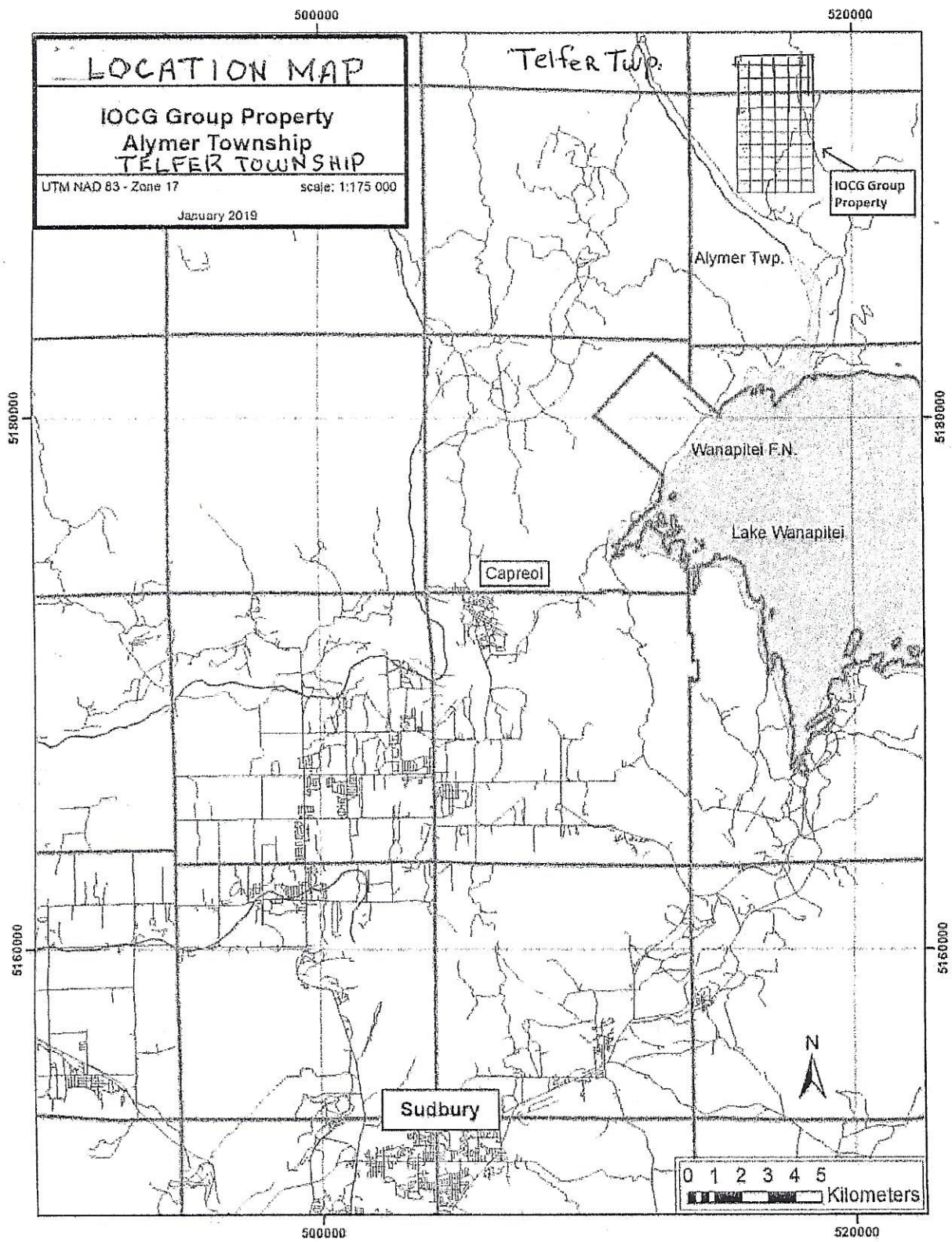

Figure 1: Property location map

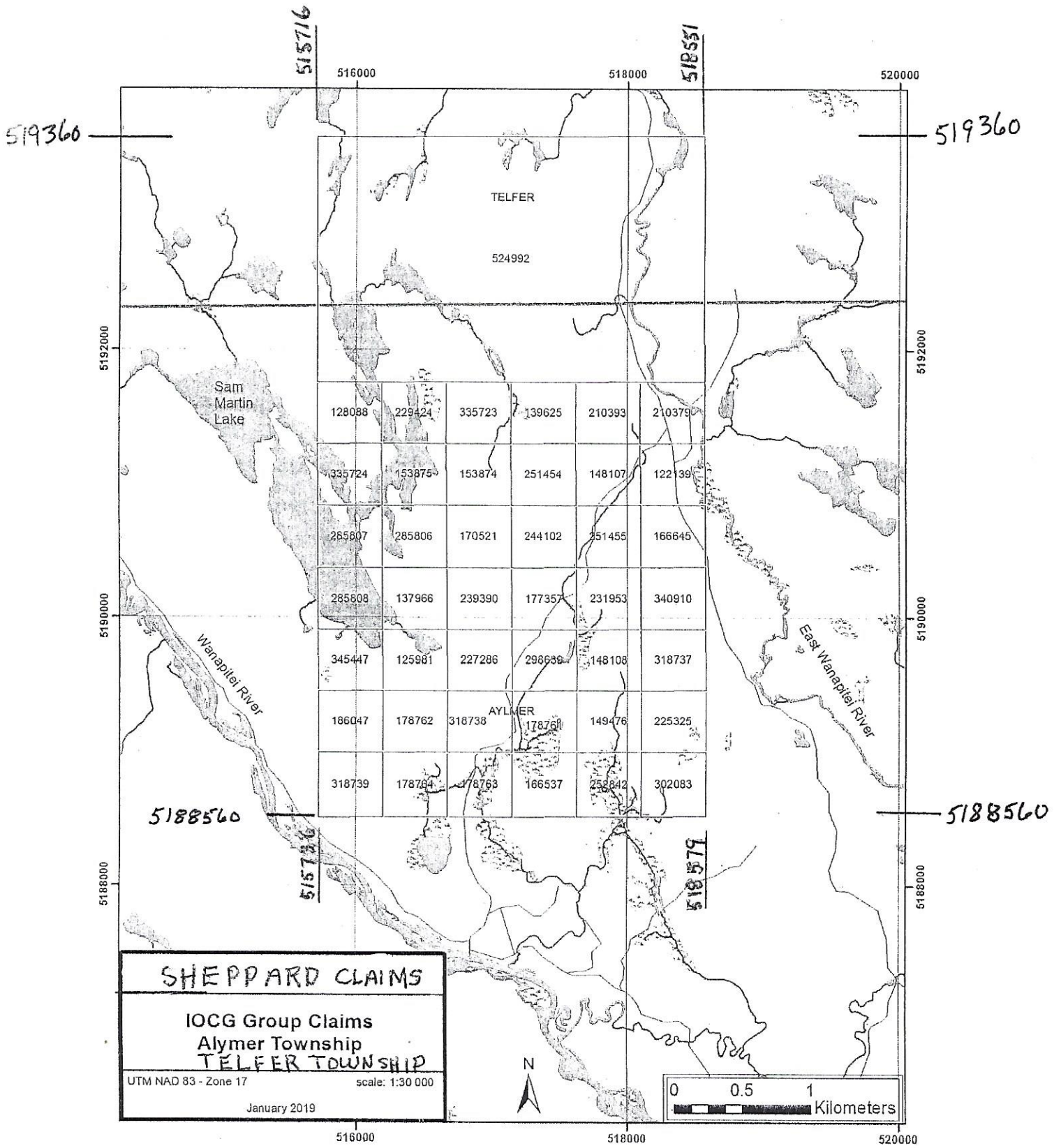

Figure 1: IOCG Joint Venture Group claim map

JOB..... AYMER  
DATE..... AUG 20/19..... PAGE.....

STU WINTER, TOM & GRANT  
from TRANSITION and myself  
picked up Tom Sheppard in  
Carrol and travelled up in  
2 vehicles to work on  
more thorough sampling  
on the showing on  
legacy claim 4203306.

We worked to try and  
get fresher rocky samples  
low the gold showing  
but the material has a  
lot of the sulphides leached  
out.

PARTY CHIEF..... F. De la Brio  
WEATHER..... 125° CLEAR



## Preamble

Stu Winter and I picked up Tom Sheppard in Capreol to go up to the Aylmer Township claims. Tom Hart & Grant Mourecame along with their own vehicle. The purpose was to do more prospecting and sampling of the gold showing. We trenched and got down the best we could, but the pyrite has still leached out. We took one good sample and the Transition Metals people did their own sampling

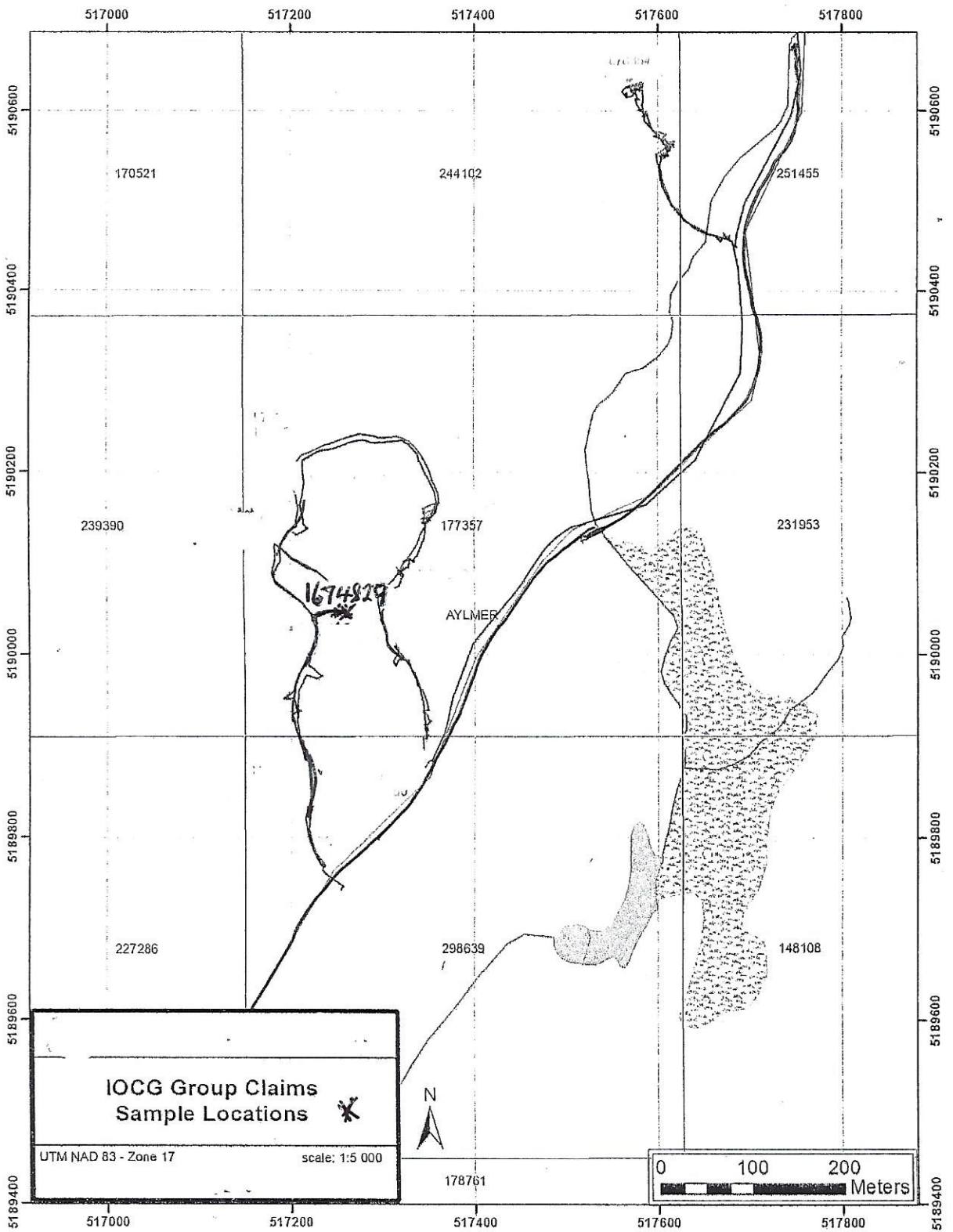



ALS Canada Ltd.  
 2103 Dollarton Hwy  
 North Vancouver BC V7H 0A7  
 Phone: +1 (604) 984 0221 Fax: +1 (604) 984 0218  
 www.alsglobal.com/geochemistry

To: PRECAMBRIAN EQUIPMENT LIMITED  
 2355 LASALLE BLVD.  
 SUDBURY ON P3A 2A9

Page: 2 - A  
 Total # Pages: 2 (A - D)  
 Plus Appendix Pages  
 Finalized Date: 24-SEP-2019  
 Account: PREEQU

**CERTIFICATE OF ANALYSIS SD19227321**

Sample Description	Method Analyte Units LOD	WEI-21 Recvd WL kg	CRU-QC Pass2mm %	PUL-QC Pass75um %	Au-ICP21 Au ppm	ME-MS41 Ag ppm	ME-MS41 Al %	ME-MS41 As ppm	ME-MS41 Au ppm	ME-MS41 B ppm	ME-MS41 Ba ppm	ME-MS41 Be ppm	ME-MS41 Bi ppm	ME-MS41 Ca %	ME-MS41 Cd ppm	ME-MS41 Ce ppm
1674829		2.71	88.3	96.0	0.011	0.03	0.22	139.0	<0.02	<10	10	0.07	0.45	0.41	0.02	8.98

\*\*\*\*\* See Appendix Page for comments regarding this certificate \*\*\*\*\*

8



ALS Canada Ltd.  
 2103 Dollarton Hwy  
 North Vancouver BC V7H 0A7  
 Phone: +1 (604) 984 0221 Fax: +1 (604) 984 0218  
 www.alsglobal.com/geochemistry

To: **PRECAMBRIAN EQUIPMENT LIMITED**  
 2355 LASALLE BLVD.  
 SUDBURY ON P3A 2A9

Page: 2 - B  
 Total # Pages: 2 (A - D)  
 Plus Appendix Pages  
 Finalized Date: 24-SEP-2019  
 Account: PREEQU

**CERTIFICATE OF ANALYSIS SD19227321**

Sample Description	Method Analyte Units LOD	ME-MS41 Co ppm 0.1	ME-MS41 Cr ppm 1	ME-MS41 Cs ppm 0.05	ME-MS41 Cu ppm 0.2	ME-MS41 Fe % 0.01	ME-MS41 Ga ppm 0.05	ME-MS41 Ge ppm 0.05	ME-MS41 Hf ppm 0.02	ME-MS41 Hg ppm 0.01	ME-MS41 In ppm 0.005	ME-MS41 K % 0.01	ME-MS41 La ppm 0.2	ME-MS41 Li ppm 0.1	ME-MS41 Mg % 0.01	ME-MS41 Mn ppm 5
I674829		170.0	20	0.10	12.2	5.76	0.95	0.05	0.52	0.02	<0.005	0.06	4.1	0.3	0.12	100

\*\*\*\*\* See Appendix Page for comments regarding this certificate \*\*\*\*\*

8(a)

Unsubscribe



ALS Canada Ltd.  
 2103 Dollarton Hwy  
 North Vancouver BC V7H 0A7  
 Phone: +1 (604) 984 0221 Fax: +1 (604) 984 0218  
 www.alsglobal.com/geochemistry

To: PRECAMBRIAN EQUIPMENT LIMITED  
 2355 LASALLE BLVD.  
 SUDBURY ON P3A 2A9

Page: 2 - C  
 Total # Pages: 2 (A - D)  
 Plus Appendix Pages  
 Finalized Date: 24-SEP-2019  
 Account: PREEQU

**CERTIFICATE OF ANALYSIS SD19227321**

Sample Description	Method Analyte Units LOD	ME-MS41	ME-MS41	ME-MS41	ME-MS41	ME-MS41	ME-MS41	ME-MS41	ME-MS41	ME-MS41	ME-MS41	ME-MS41	ME-MS41	ME-MS41	ME-MS41	ME-MS41
		Mo ppm	Na %	Nb ppm	Ni ppm	P ppm	Pb ppm	Rb ppm	Re ppm	S %	Sb ppm	Sc ppm	Se ppm	Sn ppm	Sr ppm	Ta ppm
I674829		3.13	0.11	<0.05	57.1	680	3.1	1.3	<0.001	3.08	0.16	6.9	6.4	<0.2	15.1	<0.01

\*\*\*\*\* See Appendix Page for comments regarding this certificate \*\*\*\*\*

8(b)



ALS Canada Ltd.  
 2103 Dollarton Hwy  
 North Vancouver BC V7H 0A7  
 Phone: +1 (604) 984 0221 Fax: +1 (604) 984 0218  
 www.alsglobal.com/geochemistry

To: PRECAMBRIAN EQUIPMENT LIMITED  
 2355 LASALLE BLVD.  
 SUDBURY ON P3A 2A9

Page: 2 - D  
 Total # Pages: 2 (A - D)  
 Plus Appendix Pages  
 Finalized Date: 24-SEP-2019  
 Account: PREEQU

CERTIFICATE OF ANALYSIS SD19227321

Sample Description	Method	Analyte	Units	LOD	ME-MS41	ME-MS41	ME-MS41	ME-MS41	ME-MS41	ME-MS41	ME-MS41	ME-MS41	ME-MS41	
					Te	Th	Ti	Tl	U	V	W	Y	Zn	
					ppm	ppm	%	ppm	ppm	ppm	ppm	ppm	ppm	
					0.01	0.2	0.005	0.02	0.05	1	0.05	0.05	2	
													Zr	
													ppm	
													0.5	
I674829					0.21	3.6	<0.005	<0.02	0.82	16	<0.05	3.69	3	19.1

\*\*\*\*\* See Appendix Page for comments regarding this certificate \*\*\*\*\*

*8(c)*