

We are committed to providing [accessible customer service](#).

If you need accessible formats or communications supports, please [contact us](#).

Nous tenons à améliorer [l'accessibilité des services à la clientèle](#).

Si vous avez besoin de formats accessibles ou d'aide à la communication, veuillez [nous contacter](#).

2018 PROSPECTING REPORT: STUMPY BAY JV PROPERTY

BALDWIN AND SHAKESPEARE TOWNSHIPS
SUDBURY MINING DIVISION, ONTARIO, CANADA

URSA MAJOR MINERALS INC.
45 OAK ST.
DOWLING, ON
P0M 1R0

June 29th, 2018

Prepared By:

JOERG M. KLEINBOECK, P.GEO.

TABLE OF CONTENTS

EXECUTIVE SUMMARY	2
1.0 INTRODUCTION	5
2.0 PROPERTY DETAILS	5
2.1 Location and Access	5
2.2 Topography and Vegetation.....	5
2.3 Claims	6
3.0 PREVIOUS WORK.....	7
4.0 GEOLOGY	9
4.1 Property Geology	9
5.0 2018 PROSPECTING PROGRAM.....	11
5.1 Description of Work.....	11
6.0 CONCLUSIONS & RECOMMENDATIONS.....	13
8.0 REFERENCES	14

LIST OF FIGURES

Figure 1: Location of the Stumpy Bay JV Property	6
Figure 2: Tenure of the Stumpy Bay JV Property	9
Figure 3: Property Geology (after Card & Polonen, 1976).	10

LIST OF TABLES

Table 1: Claim Details of the Blueberry Lake Property (Legacy Claims).	7
Table 2: Sample details and selected results.....	12

LIST OF APPENDICES

Appendix I Statement of Qualifications	
Appendix II Sample Descriptions	
Appendix III Assay Certificate	

Map 1: Sample Locations and Geology	
-------------------------------------	--

EXECUTIVE SUMMARY

JMK Exploration Consulting was requested by Ursa Major Minerals Inc. (“Ursa”) to complete a technical report for assessment purposes on their recently completed prospecting program on the Stumpy Bay JV Property (“Property”).

The Property is situated approximately 70 km west-southwest of Sudbury, Ontario and approximately 9 km north-northeast of the Town of Webbwood, Ontario (Figure 1). The Property is bounded by UTM coordinates 435,550 E to 437,480 E, and 5,131,390 N to 5,133,025 N (NAD83, Z17N), and is covered by National Topographic System (NTS) map sheet 41I/5. The Property consists of 15 unpatented mining claims, covering an area of approximately 247.82 ha (Table 1, Figure 2).

In March of 2003, Ursa entered into an option agreement on legacy mining claims 1231439, 1231440, 1231441, and 1203117. The agreement allowed Ursa to acquire a 100% undivided interest in the claims.

In the spring of 2018, the Ministry of Northern Development and Mines (“MNDM”) through the modernization of the Mining Act, converted the legacy claims to cell-based claims, and this report refers to the new tenure system.

Historical work on the Property dates to the 1920’s, with the most notable work being completed by Noranda Mines Ltd. in the 1950’s that included trenching and diamond drilling (6 drill holes). A plan map by Noranda of the drilling and surface trenching includes averaged chip samples along the trenches including 19 ft of 1.37%, 25 ft of 0.83%, 15.5 ft of 1.05%, 12 ft of 1.36%, and 9 ft of 2.02%. These are only selected chip samples from the map, and there is no reference on the map as to what element is being averaged, and it is assumed that the map is referring to Cu. Broulan Reef Mines Ltd. also held an extensive land package in the area in the late 1960’s, and completed 18 diamond drill holes totaling 13,086.5 ft, of which 5 drill holes targeted the Noranda occurrence. No assays are reported in the drill logs.

In 2005, Ursa completed a single drill hole to a depth of 381.5 m. The drill hole tested a Fugro airborne conductor located on the south shore of Stumpy Bay thought to be related to the Noranda occurrence. The drill hole intersected a 23 m wide zone of highly altered, weakly to moderately mineralized sediments occurring between 335.70 and 358.90 m, in which a 7.5 m section from 343.00 to 350.50 m averaged 0.1% Ni, 0.36% Cu, 0.02% Co, and 36 g/t Ag (Tracanelli, 2006). The conductor was explained by a 0.9 m wide sulphide zone that included two closely spaced 10 cm and 15 cm semi-massive pyrrhotite and chalcopyrite bands with metals values of 0.8% Cu and >300 g/t Ag (Tracanelli, 2006).

From May 22nd to 25th, 2018, the author completed a reconnaissance prospecting program southeast and east of Stumpy Bay. The program focused on locating numerous historical trenches over a strike length of > 500 m. A total of 20 samples were taken from numerous trenches, and all samples are considered highly anomalous regarding Cu or Co content. Cu values ranged from 115 to 16,962 ppm, and Co values ranged from 17 to 2,397 ppm. Anomalous values in Au, As, Pb were also obtained. The apparent stratiform mineralization occurs within a quartzite-hosted narrow (~7.5 m in width) zone orientated at approximately 065 degrees. The quartzite is weakly sheared and occurs within a wider deformational zone related to a splay off of the Hunter Lake Fault with an apparent width of 100 m, possessing both brittle and ductile characteristics (Tracanelli, 2006). Chalcopyrite and pyrrhotite, and to a lesser degree pyrite, occur in the mineralized zone as fine disseminations to blebs, stringers, fracture-fills, and occasionally as semi-massive bands. Quartz veining within the structural zone is evident, often containing appreciable amounts of remobilized sulphides. The lack of Ni content is not supportive of a hydrothermal system that has remobilized sulphides from an underlying magmatic source into a sheared host rock. As there are abundant sulphides within the matrix of the quartzites, not just within the quartz veinlets or within fracture fills, it could be postulated that some sort of sediment-hosted stratiform Cu +/- Co deposit-style of mineralization may be present and overprinted by late stage hydrothermal fluids.

Further work on the Property is recommended. Sediment-hosted stratiform copper deposits are known for their consistent grades and lateral continuity, and may contain significant amounts of cobalt, lead, and silver. According to Brown (1993), “stratiform

copper deposits have recently accounted for 20-25% of the western world's production of copper, 80% of its cobalt, and increasingly greater amounts of silver". A review of the airborne geophysical data is suggested, along with a down-hole pulse EM survey on drill hole U-10-03 to define drill targets along the northeastern and southwestern strike of the mineralization.

1.0 INTRODUCTION

JMK Exploration Consulting was requested by Ursa to complete a technical report for assessment purposes on their recently completed prospecting program on the Stumpy Bay JV Property.

From May 22nd to 25th, 2018, the author completed a reconnaissance prospecting program southeast and east of Stumpy Bay. The program focused on locating numerous historical trenches over a strike length of 500 m. A total of 20 samples were taken from numerous trenches, and all samples are considered highly anomalous regarding Cu or Co content.

2.0 PROPERTY DETAILS

2.1 Location and Access

The Property is situated approximately 70 km west-southwest of Sudbury, Ontario and approximately 9 km north-northeast of the Town of Webbwood, Ontario (Figure 1).

Access for this work was by boat through Agnew Lake. Boat launches are available either at Agnew Lake Lodge or further east at the end of Spring and Hardwood Roads north of the town of McKerrow.

2.2 Topography and Vegetation

The topography of the Property is characterized by a northeast trending ridge with steep edges. Topographic relief is less than 50 metres and outcrop exposure in the higher areas can exceed 20%. Forest cover is a combination of maple, oak, white pine, red pine in the higher areas, with poplar, birch, and cedar more common in the lower areas. Agnew Lake has an abundance water for drilling purposes.

2.3 Claims

The Property is bounded by UTM coordinates 435,550 E to 437,480 E, and 5,131,390 N to 5,133,025 N (NAD83, Z17N), and is covered by National Topographic System (NTS) map sheet 41I/5. The Property consists of 15 unpatented mining claims, covering an area of approximately 247.82 ha (Table 1, Figure 2).

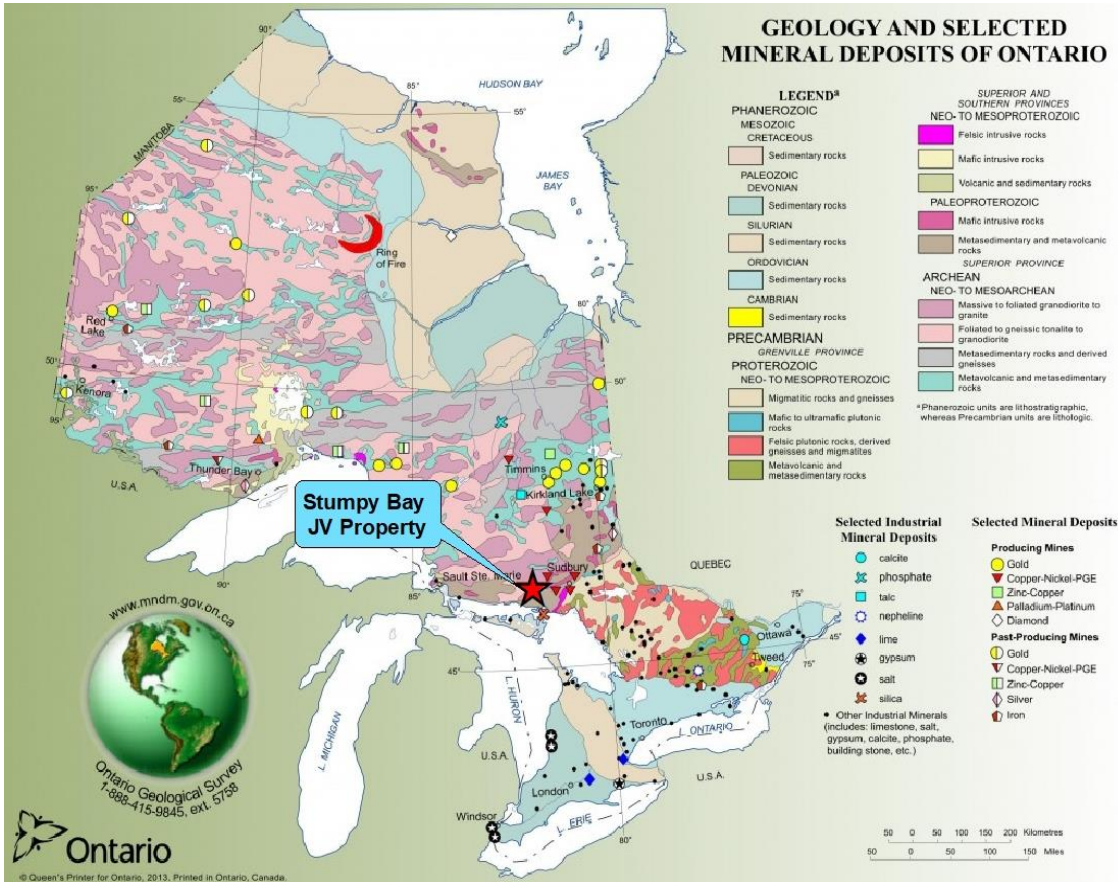

Figure 1: Location of the Stumpy Bay JV Property

Table 1: Claim Details of the Blueberry Lake Property (Legacy Claims).

Township / Area	Tenure ID	Anniversary Date	Tenure Percentage	Work Required	Exploration Reserve
SHAKESPEARE	107981	2021-03-04	100	200	617
SHAKESPEARE	125431	2021-03-04	100	200	0
SHAKESPEARE	136837	2021-03-04	100	200	0
SHAKESPEARE	188822	2021-03-04	100	200	0
SHAKESPEARE	188823	2021-03-04	100	400	0
BALDWIN,SHAKESPEARE	201004	2021-03-04	100	400	0
SHAKESPEARE	218713	2021-03-04	100	400	0
SHAKESPEARE	226027	2021-03-04	100	400	0
SHAKESPEARE	233206	2021-07-04	100	200	0
BALDWIN,SHAKESPEARE	237469	2021-03-04	100	200	0
SHAKESPEARE	237470	2021-03-04	100	200	0
BALDWIN,SHAKESPEARE	237549	2021-03-04	100	200	0
SHAKESPEARE	304826	2021-03-04	100	400	0
SHAKESPEARE	304827	2021-03-04	100	400	0
BALDWIN,SHAKESPEARE	343568	2021-03-04	100	400	0

3.0 PREVIOUS WORK

A brief summary of the past exploration work completed in the area of interest that is described in this report is provided below.

1920's: Sudbury Shakespeare Gold Copper Syndicate discovered the a series of copper showings.

1956: Noranda Mines Ltd. carried out geological, geophysical, trenching, and six diamond drill holes totaling 1000 ft over a strike length of approximately 1,800 ft. A plan map by Noranda of the drilling and surface trenching includes averaged chip samples along the trenches including 19 ft of 1.37%, 25 ft of 0.83%, 15.5 ft of 1.05%, 12 ft of 1.36%, and 9 ft of 2.02%. These are only selected chip samples from the map, and there is no reference on the map as to what element is being averaged, and it is assumed that the map is referring to Cu.

1968: Broulan Reef Mines Ltd. held an extensive land packed in the area in the late 1960's, and completed 18 diamond drill holes totaling 13,086.5 ft, of which 5 drill holes targeted the Noranda occurrence. No assays are reported in the drill logs.

2000-2003: Brunne and Turcotte completed prospecting, and geophysical surveying (magnetometer/VLF)

2005: Ursa completed a single drill hole to a depth of 381.5 m. The drill hole tested a Fugro airborne conductor located on the south shore of Stumpy Bay thought to be related to the Noranda occurrence. The drill hole intersected a 23 m wide zone of highly altered, weakly to moderately mineralized sediments occurring between 335.70 and 358.90 m, in which a 7.5 m section from 343.00 to 350.50 m averaged 0.1% Ni, 0.36% Cu, 0.02% Co, and 36 g/t Ag (Tracanelli, 2006). The conductor was explained by a 0.9 m wide sulphide zone that included two closely spaced 10 cm and 15 cm semi-massive pyrrhotite and chalcopyrite bands with metals values of 0.8% Cu and >300 g/t Ag (Tracanelli, 2006).

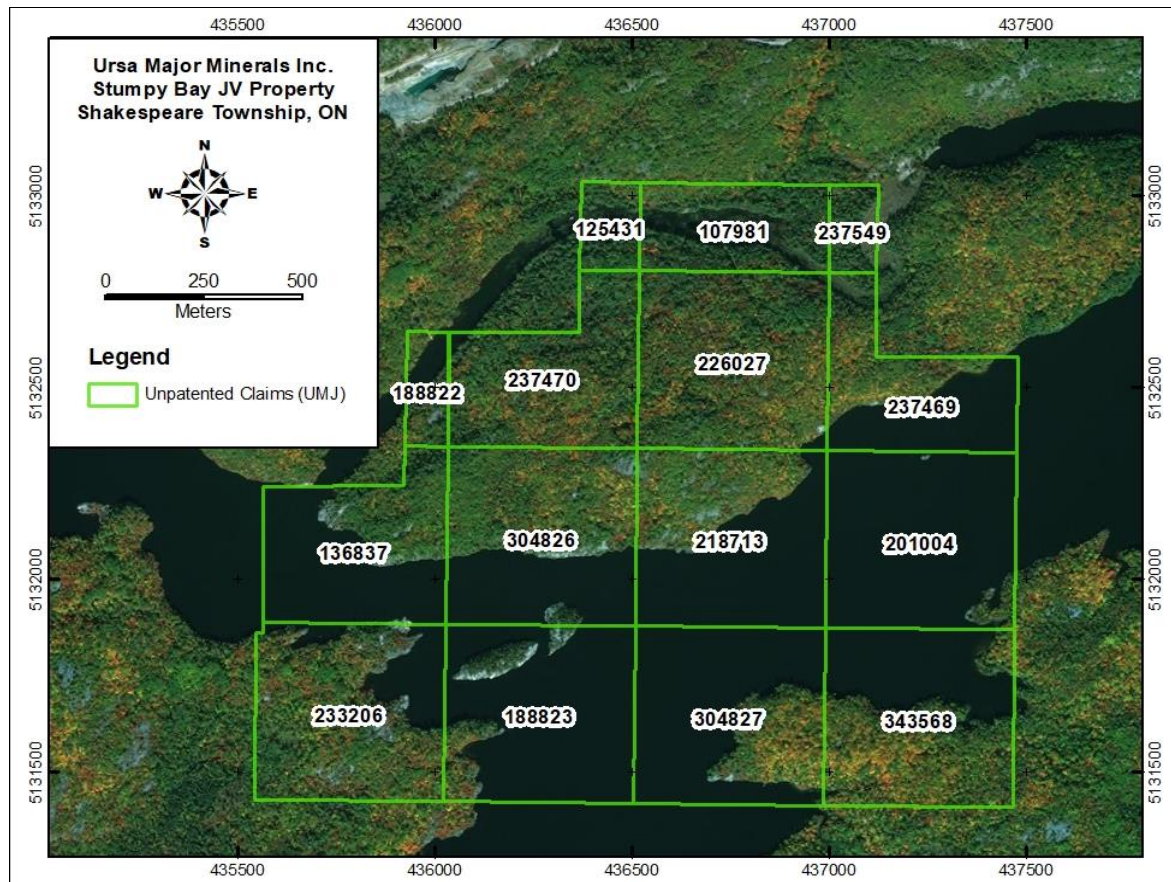

Figure 2: Tenure of the Stumpy Bay JV Property

4.0 GEOLOGY

4.1 Property Geology

The Stumpy Bay JV Property is predominantly underlain by Huronian sedimentary rocks of Proterozoic age that were deposited between 2,220 and 2,500 Ma, and have been intruded by gabbroic dykes and sills dated at 2,219 Ma, commonly referred to as Nipissing Diabase. The sedimentary rocks encountered during the prospecting program include Matinenda Formation quartzites, argillites, and siltstones (Figure 3). Bedding, generally strikes NE and dips sub-vertical. In the area of interest, the rocks are weakly sheared and locally brecciated. Mineralization consisting of chalcopyrite and pyrrhotite, and to a lesser degree pyrite, occur as fine disseminations to blebs, stringers, fracture-

fills, and occasionally semi-massive within the quartzite-hosted narrow (<5m in width) shear zone orientated at approximately 065 degrees. Quartz veining within the structural/shear zone is evident, often containing appreciable amounts of remobilized sulphides.

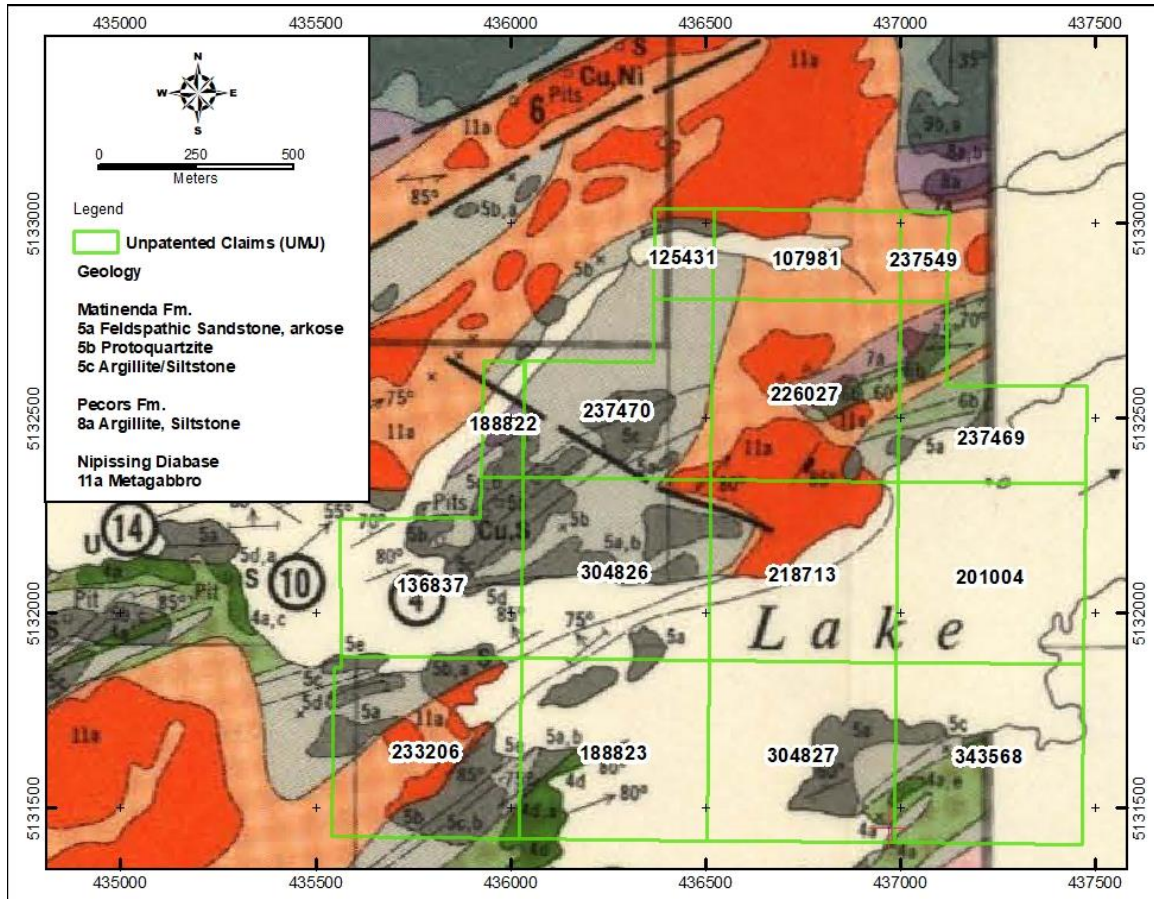

Figure 3: Property Geology (after Card & Polonen, 1976).

5.0 2018 PROSPECTING PROGRAM

5.1 Description of Work

From May 22nd to 25th, 2018, the author completed a reconnaissance prospecting program east of Stumpy Bay. The program focused on locating numerous historical trenches over a strike length of > 500 m. A total of 20 samples were taken from numerous trenches, and all samples are considered highly anomalous regarding Cu or Co content. Cu values ranged from 115 to 16,962 ppm, and Co values ranged from 17 to 2,397 ppm.

Anomalous values in Au, As, Pb were also obtained.

Sample locations and selected results are provided in Table 2. Sample descriptions are provided in Appendix II, and the assay certificate for the samples collected during this program are provided in Appendix III. Map 1, located in the back pocket of this report, displays sample locations and geology of the area.

Table 2: Sample details and selected results.

Sample Number	Au (ppb)	Ag (g/t)	As (ppm)	Co (ppm)	Cu (ppm)	Ni (ppm)	Pb (ppm)	Zn (ppm)
526401	35	<1	125	187	3141	22	<20	29
526402	11	<1	<30	72	1474	21	<20	157
526403	64	2	<30	17	844	20	<20	<10
526404	151	2	768	676	6654	31	29	16
526405	33	3	707	1605	4629	50	679	29
526406	8	<1	202	267	826	18	38	16
526407	96	4	1114	2397	13794	63	906	97
526408	46	2	388	939	5922	37	125	153
526409	57	2	162	225	7418	28	27	81
526410	49	8	967	1413	6805	37	1837	61
526411	95	6	46	2358	11298	78	1038	202
526412	219	5	50	1004	16962	45	318	292
526413	20	<1	45	226	1912	21	<20	25
526414	8	<1	<30	23	822	18	71	36
526415	45	2	<30	98	2778	22	<20	22
526416	14	<1	186	194	1155	26	<20	14
526417	27	<1	<30	17	1705	19	<20	<10
526418	<5	1	<30	61	1194	22	<20	15
526419	<5	1	<30	25	115	20	<20	<10
526420	110	5	1114	1276	13669	30	246	217

6.0 CONCLUSIONS & RECOMMENDATIONS

A total of 20 samples were taken from numerous trenches, and all samples are considered highly anomalous regarding Cu or Co content. The apparent stratiform mineralization occurs within a quartzite-hosted (~7.5m in width) zone orientated at approximately 065 degrees. The quartzite is weakly sheared and occurs within a wider deformational zone related to a splay off of the Hunter Lake Fault with an apparent width of 100 m possessing both brittle and ductile characteristics (Tracanelli, 2006). Chalcopyrite and pyrrhotite, and to a lesser degree pyrite, occur as fine disseminations to blebs, stringers, fracture-fills, and occasionally semi-massive. Quartz veining within the structural zone is evident, often containing appreciable amounts of remobilized sulphides. The lack of Ni content is not supportive of a hydrothermal system that has remobilized sulphides from an underlying magmatic source into a sheared host rock. As there are abundant sulphides within the matrix of the quartzites, not just within the quartz veinlets or within fracture fills, it could be postulated that some sort of sediment-hosted stratiform Cu +/- Co deposit-style of mineralization may be present and overprinted by late stage hydrothermal fluids containing remobilized sulphides.

Further work on the Property is recommended. Sediment-hosted stratiform copper deposits are known for their consistent grades and lateral continuity, and may contain significant amounts of cobalt, lead, and silver. According to Brown (1993), “stratiform copper deposits have recently accounted for 20-25% of the western world’s production of copper, 80% of its cobalt, and increasingly greater amounts of silver”.

A review of the airborne geophysical data is suggested, along with a down-hole pulse EM survey on drill hole U-10-03 to define drill targets along the northeastern and southwestern strike of the mineralization that may contain copper and cobalt mineralization of economic interest.

8.0 REFERENCES

Brown, A. 1993

Sediment-hosted Stratiform Copper Deposits, in Ore Deposit Models, Volume II. Reprint Series 6. Geological Association of Canada.

Card, K.D., Palonen, P.A. 1976

Geology of the Dunlop-Shakespeare Area, District of Sudbury. Geoscience Report 139.

Tracanelli, H. 2006.

Report on the Surface Diamond Drilling Program, U-10. Stumpy Bay Option Property. completed on behalf of Ursa Major Minerals Inc.

Appendix I
Statement of Qualifications

Statement of Qualifications

I, Joerg Martin Kleinboeck of 147 Lakeside Drive, North Bay, Ontario, do hereby certify that:

I am a graduate of Laurentian University, Sudbury, Ontario with a B.Sc. Geology, 2000, and have been practising my profession as a geologist since.

I am a member with the Association of Professional Geoscientists of Ontario (#1411).

I am a member of the Prospectors & Developers Association of Canada (PDAC).

I hold no interests in the securities of Ursa Major Minerals Inc.



The image shows a handwritten signature in cursive script, followed by a circular professional seal. The seal contains the text 'PROFESSIONAL GEOSCIENTIST' around the top edge, 'JOERG M. KLEINBOECK' in the center, 'PRACTISING MEMBER' below the name, and '1411' at the bottom. The word 'ONTARIO' is written along the bottom inner edge of the seal.

Joerg Martin Kleinboeck
JMK Exploration Consulting
June 29th, 2018
North Bay, Ontario

Appendix II

Sample Descriptions

Sample	Easting	Northing	Rock_Type	Texture	Structure	Alteration	Mineralization	Comments
526401	435802	5132191	5a	fg	shrd 078/-87		2% diss + ff cp+po, local vuggy quartz with cp.	sample taken within 10m x 1m long trench orientated at 310 deg.
526402	435858	5132227	5a	fg			6% diss + ff cp+po+py	sample taken at north end of water filled trench. Sample taken from blast rock.
526403	435892	5132217	5a	fg	shrd 250/-84		none visible	rusty weathered outcrop
526404	435902	5132228	5a	fg	shrd/bedding 067/-88		4% diss+ff cp+po+py	rusty weathering, old pit
526405	435922	5132240	5a	fg	shrd 056/-90		10-15% diss, blebby/wispy, and ff po+cp+py	sample taken within 10m x 1m long trench
526406	435931	5132238	5a	fg			3-5% diss+ff po+cp+py	minor malachite staining along fractures
526407	435936	5132240	5a	fg			10% diss, blebby/wispy, and ff po+cp+py	sample taken from east side of 2m x 3m pit, partially infilled with water
526408	436026	5132303	5a	fg			8-10% diss, blebby/wispy, and ff cp+po+py	sample taken within 10m x 1m long trench
526409	436033	5132312	5a	fg			2-3% diss, ff po+cp+py	sample taken within 1m x 1m pit
526410	436096	5132340	5a	fg			5-8% diss, blebby/wispy, and ff po+cp+py	sample taken at south end of 1m x 5m pit
526411	435958	5132241	5a	fg			25% diss, blebby/wispy, ff, and semi massive po+cp+py	sample taken from 1-2m x 15 m long trench. 50% of sample includes semi-massive po+cp+py (pod within shear zone?)
526412	435958	5132241	5a	fg			8% diss, blebby/wispy, and ff po+cp+py	sample taken from 1-2m x 15 m long trench.
526413	436148	5132364	5a	fg		local qv @ 244/88	1-2% diss cp+po+py	sample taken within a 10m long rusty-weathered trench, strongly sheared/mylonitic in places

526414	436149	5132367	5a	fg		local qv @ 244/88	1-2% diss cp+po+py	sample taken within a 10m long rusty-weathered trench, strongly sheared/mylonitic in places
526415	436151	5132366	5a	fg		local qv @ 244/88	3-4% diss+ff cp+po+py	sample taken in eastern trench (previous in western trench). Both trenches ~10m in length
526416	436172	5132372	5a	fg			2% diss+ff cp+po+py	rusty weathered trench, less sulphides than in trenches to west (mineralization may be plunging to the east)
526417	436185	5132390	5a	fg		local qv	2% diss+ff cp+po+py	
526418	436219	5132389	5a	fg		local qv	2% blebby cp, <1% diss/ff po+py	
526419	436250	5132405	5a	fg			<1% diss po, cp	orange coloured fresh surface, old 2m x 2m pit.
526420	435962	5132246	5a	fg			6% diss to wispy cp (3-4m east of samples 526411, 526412)	

Appendix III

Assay Certificate



Certificate of Analysis
Work Order : LK1801208
[Report File No.: 0000015480]

Date: June 15, 2018

To: Jason Jessup
URSA MAJOR MINERALS INCORPORATED
 45 OAK ST
 DOWLING ON P0M 1R0

P.O. No.: -
Project No.: SHAKESPEARE SOUTH
Samples: 40
Received: May 31, 2018
Pages: Page 1 to 11
 (Inclusive of Cover Sheet)

Methods Summary

<u>No. Of Samples</u>	<u>Method Code</u>	<u>Description</u>
40	G_WGH79	Weighing of samples and reporting of weights
37	G_PRP89	Weigh, Dry, to 3kg, Crush 75% -2mm, Split to 250g, Pulverize to 85% -75µm
40	GE_FAA313	@Au, FAS, AAS, 30g-5ml
40	GO_AAS10D	Ag, Cu by AAS after Aqua Regia digest, 1g 50mL 0.5g +/- 0.005g
18	GE_CSA06V	@Exploration grade 0.005 - 30% S & C by IR Combustion
40	GE_ICP90A	ICP-OES after Na2O2 fusion
3	GO_ICP90Q	@ICP-OES after Na2O2 fusion-Ore-Grade Analyses

Storage: Pulp & Reject

PULP STORAGE :
 REJECT STORAGE :

Comments:

Assays not suitable for commercial exchange.
 Detection limit for P increased as indicated due to sample matrix interference
 This Report cancels and supersedes the Report No.0000015479 dated June 15,2018 issued by SGS Lakefield.

Certified By : 
 Brett Pipher
 Project Coordinator

SGS Minerals Services (Lakefield) is accredited by Standards Council of Canada (SCC) and conforms to the requirements of ISO/IEC 17025 for specific tests as indicated on the scope of accreditation to be found at <http://www.scc.ca/en/programs/lab/mineral.shtml>

Report Footer: L.N.R. = Listed not received I.S. = Insufficient Sample
 n.a. = Not applicable -- = No result
 *INF = Composition of this sample makes detection impossible by this method
 M after a result denotes ppb to ppm conversion, % denotes ppm to % conversion
 Methods marked with an asterisk (e.g. *NAA08V) were subcontracted
 Elements marked with the @ symbol (e.g. @Cu) denote assays performed using accredited test methods

This document is issued by the Company under its General Conditions of Service accessible at <http://www.sgs.com/en/Terms-and-Conditions.aspx>. Attention is drawn to the limitation of liability, indemnification and jurisdiction issues defined therein.

WARNING: The sample(s) to which the findings recorded herein (the "Findings") relate was (were) drawn and / or provided by the Client or by a third party acting at the Client's direction. The Findings constitute no warranty of the sample's representativity of the goods and strictly relate to the sample (s). The Company accepts no liability with regard to the origin or source from which the sample(s) is/are said to be extracted. The findings report on the samples provided by the client and are not intended for commercial or contractual settlement purposes. Any unauthorized alteration, forgery or falsification of the content or appearance of this document is unlawful and offenders may be prosecuted to the fullest extent of the law .



Final : LK1801208 Order:
Report File No.: 0000015480

Element Method Det.Lim. Units	WtKg G_WGH79 0.001 kg	@Au GE_FAA313 5 ppb	Ag GO_AAS10D 1 g/t	@S GE_CSA06V 0.005 %	Al GE_ICP90A 0.01 %	As GE_ICP90A 30 ppm	Ba GE_ICP90A 10 ppm	Be GE_ICP90A 5 ppm
156001	3.575	543	27	10.3	0.35	915	42	<5
156002	1.581	1056	24	10.5	0.53	1392	47	<5
156003	2.382	<5	<1	N.A.	7.53	<30	618	<5
156004	2.428	<5	<1	N.A.	7.43	<30	469	<5
156005	2.430	<5	<1	N.A.	7.86	<30	287	<5
156006	2.239	<5	<1	N.A.	7.00	<30	215	<5
156007	3.150	6	<1	N.A.	8.07	<30	339	<5
156008	2.312	<5	<1	N.A.	6.36	<30	2588	<5
156009	2.098	<5	<1	N.A.	5.76	<30	415	<5
156010	2.179	<5	<1	2.19	7.82	<30	738	<5
156011	2.135	88	<1	2.29	0.38	107	17	<5
156012	1.721	49	<1	N.A.	0.47	<30	19	<5
156013	1.254	33	2	N.A.	0.21	42	<10	<5
156014	1.741	23	<1	N.A.	0.18	<30	14	<5
156015	0.849	953	5	10.2	0.04	<30	<10	<5
156016	1.872	632	11	9.53	0.25	<30	<10	<5
156017	0.757	316	18	11.9	0.39	1536	17	<5
156018	0.031	243	5	8.96	5.36	<30	122	<5
526401	1.242	35	<1	0.751	0.90	125	52	<5
526402	2.068	11	<1	N.A.	0.71	<30	70	<5
526403	1.340	64	2	0.147	0.54	<30	45	<5
526404	1.750	151	2	N.A.	0.28	768	28	<5
526405	1.766	33	3	6.13	0.11	707	18	<5
526406	1.153	8	<1	N.A.	1.04	202	42	<5
526407	2.310	96	4	12.6	0.21	1114	25	<5
526408	3.387	46	2	N.A.	0.19	388	18	<5
526409	1.697	57	2	0.866	1.17	162	541	<5
526410	1.575	49	8	N.A.	0.15	967	26	<5
526422	0.034	256	4	8.90	5.32	<30	117	<5
526411	1.728	95	6	N.A.	0.11	46	64	<5
526412	1.267	219	5	8.42	0.13	50	41	<5
526413	0.972	20	<1	N.A.	0.92	45	37	<5
526414	1.726	8	<1	N.A.	1.65	<30	376	<5
526415	1.484	45	2	0.963	1.16	<30	50	<5
*Dup 526415	N.A.	44	2	0.961	1.19	<30	49	<5
526416	1.469	14	<1	N.A.	0.38	186	36	<5
526417	1.242	27	<1	N.A.	1.13	<30	49	<5
526418	1.000	<5	1	0.731	0.41	<30	75	<5
526419	1.380	<5	1	N.A.	2.45	<30	22	<5
526420	1.508	110	5	N.A.	0.09	1114	88	<5

This document is issued by the Company under its General Conditions of Service accessible at <http://www.sgs.com/en/Terms-and-Conditions.aspx>. Attention is drawn to the limitation of liability, indemnification and jurisdiction issues defined therein.

WARNING: The sample(s) to which the findings recorded herein (the "Findings") relate was (were) drawn and / or provided by the Client or by a third party acting at the Client's direction. The Findings constitute no warranty of the sample's representativity of the goods and strictly relate to the sample (s). The Company accepts no liability with regard to the origin or source from which the sample(s) is/are said to be extracted. The findings report on the samples provided by the client and are not intended for commercial or contractual settlement purposes. Any unauthorized alteration, forgery or falsification of the content or appearance of this document is unlawful and offenders may be prosecuted to the fullest extent of the law .



Final : LK1801208 Order:

Page 3 of 11

Report File No.: 0000015480

Element Method Det.Lim. Units	WtKg G_WGH79 0.001 kg	@Au GE_FAA313 5 ppb	Ag GO_AAS10D 1 g/t	@S GE_CSA06V 0.005 %	Al GE_ICP90A 0.01 %	As GE_ICP90A 30 ppm	Ba GE_ICP90A 10 ppm	Be GE_ICP90A 5 ppm
526421	0.038	285	4	8.89	5.30	<30	125	<5
*Rep 526421				8.94				
*Rep 156006		<5						
*Rep 156010					7.79	<30	766	<5
*Rep 156003			<1					

This document is issued by the Company under its General Conditions of Service accessible at <http://www.sgs.com/en/Terms-and-Conditions.aspx>. Attention is drawn to the limitation of liability, indemnification and jurisdiction issues defined therein.

WARNING: The sample(s) to which the findings recorded herein (the "Findings") relate was (were) drawn and / or provided by the Client or by a third party acting at the Client's direction. The Findings constitute no warranty of the sample's representativity of the goods and strictly relate to the sample (s). The Company accepts no liability with regard to the origin or source from which the sample(s) is/are said to be extracted. The findings report on the samples provided by the client and are not intended for commercial or contractual settlement purposes. Any unauthorized alteration, forgery or falsification of the content or appearance of this document is unlawful and offenders may be prosecuted to the fullest extent of the law .

Element Method Det.Lim. Units	Ca	Cd	Co	Cr	Cu	Fe	K	La
	GE_ICP90A 0.1 %	GE_ICP90A 10 ppm	GE_ICP90A 10 ppm	GE_ICP90A 10 ppm	GE_ICP90A 10 ppm	GE_ICP90A 0.01 %	GE_ICP90A 0.1 %	GE_ICP90A 10 ppm
156001	0.1	<10	907	345	>50000	10.9	<0.1	11
156002	<0.1	<10	1392	383	>50000	11.3	<0.1	<10
156003	4.0	<10	40	146	190	7.25	1.7	24
156004	4.5	<10	54	134	490	7.53	1.4	24
156005	0.7	<10	57	90	268	8.63	1.3	21
156006	0.6	<10	63	118	240	8.88	1.1	18
156007	2.7	<10	33	100	351	5.57	1.6	27
156008	1.9	<10	42	188	149	7.66	5.0	19
156009	3.3	<10	67	175	208	7.12	0.9	20
156010	3.6	<10	62	153	258	8.72	2.1	26
156011	<0.1	<10	171	430	16759	2.99	<0.1	<10
156012	<0.1	<10	69	462	26970	4.24	<0.1	<10
156013	<0.1	<10	119	490	22818	3.67	<0.1	<10
156014	<0.1	<10	59	528	17099	2.48	<0.1	<10
156015	<0.1	<10	496	596	17650	8.83	<0.1	<10
156016	0.5	<10	446	481	45972	8.73	<0.1	<10
156017	<0.1	<10	1241	410	>50000	11.4	0.2	<10
156018	3.5	<10	1092	353	16481	18.0	0.3	<10
526401	<0.1	<10	187	441	3141	1.96	0.2	<10
526402	<0.1	<10	72	459	1474	2.01	0.4	<10
526403	<0.1	<10	17	319	844	3.00	0.3	<10
526404	<0.1	<10	676	573	6654	2.17	0.1	<10
526405	<0.1	<10	1605	419	4629	7.76	<0.1	<10
526406	<0.1	<10	267	514	826	2.23	0.1	<10
526407	<0.1	<10	2397	324	13794	17.4	<0.1	<10
526408	<0.1	<10	939	473	5922	4.69	<0.1	<10
526409	<0.1	<10	225	381	7418	3.71	0.7	<10
526410	<0.1	<10	1413	497	6805	6.81	<0.1	<10
526422	3.6	<10	1075	343	16688	17.9	0.3	<10
526411	<0.1	<10	2358	310	11298	23.3	<0.1	<10
526412	<0.1	<10	1004	487	16962	10.4	<0.1	<10
526413	<0.1	<10	226	395	1912	3.14	0.1	<10
526414	<0.1	<10	23	375	822	1.50	0.3	<10
526415	<0.1	<10	98	478	2778	3.44	0.2	<10
*Dup 526415	<0.1	<10	88	477	2453	3.27	0.2	<10
526416	<0.1	<10	194	372	1155	1.04	<0.1	<10
526417	<0.1	<10	17	402	1705	0.79	0.1	<10
526418	<0.1	<10	61	407	1194	1.44	0.1	<10
526419	<0.1	<10	25	354	115	0.62	0.1	<10
526420	<0.1	<10	1276	584	13669	3.31	<0.1	<10

This document is issued by the Company under its General Conditions of Service accessible at <http://www.sgs.com/en/Terms-and-Conditions.aspx>. Attention is drawn to the limitation of liability, indemnification and jurisdiction issues defined therein.

WARNING: The sample(s) to which the findings recorded herein (the "Findings") relate was (were) drawn and / or provided by the Client or by a third party acting at the Client's direction. The Findings constitute no warranty of the sample's representativity of the goods and strictly relate to the sample (s). The Company accepts no liability with regard to the origin or source from which the sample(s) is/are said to be extracted. The findings report on the samples provided by the client and are not intended for commercial or contractual settlement purposes. Any unauthorized alteration, forgery or falsification of the content or appearance of this document is unlawful and offenders may be prosecuted to the fullest extent of the law .

Element	Ca	Cd	Co	Cr	Cu	Fe	K	La
Method	GE_ICP90A	GE_ICP90A	GE_ICP90A	GE_ICP90A	GE_ICP90A	GE_ICP90A	GE_ICP90A	GE_ICP90A
Det.Lim.	0.1	10	10	10	10	0.01	0.1	10
Units	%	ppm	ppm	ppm	ppm	%	%	ppm
526421	3.6	<10	1090	344	16741	18.2	0.3	<10
*Rep 156010	3.5	<10	64	156	256	8.75	2.1	27

This document is issued by the Company under its General Conditions of Service accessible at <http://www.sgs.com/en/Terms-and-Conditions.aspx>. Attention is drawn to the limitation of liability, indemnification and jurisdiction issues defined therein.

WARNING: The sample(s) to which the findings recorded herein (the "Findings") relate was (were) drawn and / or provided by the Client or by a third party acting at the Client's direction. The Findings constitute no warranty of the sample's representativity of the goods and strictly relate to the sample (s). The Company accepts no liability with regard to the origin or source from which the sample(s) is/are said to be extracted. The findings report on the samples provided by the client and are not intended for commercial or contractual settlement purposes. Any unauthorized alteration, forgery or falsification of the content or appearance of this document is unlawful and offenders may be prosecuted to the fullest extent of the law .



Final : LK1801208 Order:
Report File No.: 0000015480

Element Method Det.Lim. Units	Li GE_ICP90A 10 ppm	Mg GE_ICP90A 0.01 %	Mn GE_ICP90A 10 ppm	Mo GE_ICP90A 10 ppm	Ni GE_ICP90A 10 ppm	P GE_ICP90A 0.1 %	Pb GE_ICP90A 20 ppm	Sb GE_ICP90A 50 ppm
156001	<10	0.31	121	<10	135	<0.1	59	<50
156002	<10	0.46	147	<10	138	<0.1	44	<50
156003	20	3.22	1454	<10	60	<0.1	<20	<50
156004	17	3.08	1529	<10	60	<0.1	<20	<50
156005	34	5.72	1348	<10	77	<0.1	<20	<50
156006	35	6.00	1440	<10	72	<0.1	<20	<50
156007	20	3.76	1092	<10	55	<0.1	<20	<50
156008	30	2.33	1328	<10	70	<0.1	362	<50
156009	13	2.71	767	44	71	0.1	<20	<50
156010	23	2.00	786	<10	69	0.1	<20	<50
156011	<10	0.33	60	13	60	<0.1	<20	<50
156012	<10	0.44	46	<10	50	<0.1	<20	<50
156013	<10	0.20	39	14	41	<0.1	<20	<50
156014	<10	0.16	35	<10	31	<0.1	<20	<50
156015	<10	0.03	39	16	91	<0.1	<20	<50
156016	<10	0.26	50	<10	150	0.2	<20	<50
156017	<10	0.04	39	11	355	<0.1	71	<50
156018	11	4.10	1022	<10	45007	<0.1	<20	<50
526401	<10	0.55	76	<10	22	<0.1	<20	<50
526402	<10	0.50	64	13	21	<0.1	<20	<50
526403	<10	0.02	19	<10	20	<0.1	<20	<50
526404	<10	0.03	55	20	31	<0.1	29	<50
526405	<10	0.02	22	<10	50	<0.1	679	<50
526406	<10	0.45	87	19	18	<0.1	38	<50
526407	<10	0.10	17	<10	63	<0.1	906	<50
526408	<10	0.05	35	16	37	<0.1	125	<50
526409	<10	0.57	88	15	28	<0.1	27	<50
526410	<10	<0.01	29	14	37	<0.1	1837	<50
526422	10	4.11	1018	<10	44952	<0.1	<20	<50
526411	<10	0.03	12	<10	78	<0.1	1038	<50
526412	<10	0.02	31	16	45	<0.1	318	<50
526413	<10	0.50	83	<10	21	<0.1	<20	<50
526414	<10	0.12	50	23	18	<0.1	71	<50
526415	<10	0.60	137	<10	22	<0.1	<20	<50
*Dup 526415	<10	0.62	144	12	19	<0.1	<20	<50
526416	<10	0.12	36	<10	26	<0.1	<20	<50
526417	<10	0.04	34	16	19	<0.1	<20	<50
526418	<10	0.11	38	<10	22	<0.1	<20	<50
526419	<10	0.05	28	11	20	<0.1	<20	<50
526420	<10	0.03	41	29	30	<0.1	246	<50

This document is issued by the Company under its General Conditions of Service accessible at <http://www.sgs.com/en/Terms-and-Conditions.aspx>. Attention is drawn to the limitation of liability, indemnification and jurisdiction issues defined therein.

WARNING: The sample(s) to which the findings recorded herein (the "Findings") relate was (were) drawn and / or provided by the Client or by a third party acting at the Client's direction. The Findings constitute no warranty of the sample's representativity of the goods and strictly relate to the sample (s). The Company accepts no liability with regard to the origin or source from which the sample(s) is/are said to be extracted. The findings report on the samples provided by the client and are not intended for commercial or contractual settlement purposes. Any unauthorized alteration, forgery or falsification of the content or appearance of this document is unlawful and offenders may be prosecuted to the fullest extent of the law .

Element	Li	Mg	Mn	Mo	Ni	P	Pb	Sb
Method	GE_ICP90A	GE_ICP90A	GE_ICP90A	GE_ICP90A	GE_ICP90A	GE_ICP90A	GE_ICP90A	GE_ICP90A
Det.Lim.	10	0.01	10	10	10	0.1	20	50
Units	ppm	%	ppm	ppm	ppm	%	ppm	ppm
526421	11	4.15	1034	<10	44316	0.1	<20	<50
*Rep 156010	22	2.01	783	<10	67	<0.1	<20	<50

This document is issued by the Company under its General Conditions of Service accessible at <http://www.sgs.com/en/Terms-and-Conditions.aspx>. Attention is drawn to the limitation of liability, indemnification and jurisdiction issues defined therein.

WARNING: The sample(s) to which the findings recorded herein (the "Findings") relate was (were) drawn and / or provided by the Client or by a third party acting at the Client's direction. The Findings constitute no warranty of the sample's representativity of the goods and strictly relate to the sample (s). The Company accepts no liability with regard to the origin or source from which the sample(s) is/are said to be extracted. The findings report on the samples provided by the client and are not intended for commercial or contractual settlement purposes. Any unauthorized alteration, forgery or falsification of the content or appearance of this document is unlawful and offenders may be prosecuted to the fullest extent of the law .

Element Method Det.Lim. Units	Sc GE_ICP90A 5 ppm	Sn GE_ICP90A 50 ppm	Sr GE_ICP90A 10 ppm	Ti GE_ICP90A 0.01 %	V GE_ICP90A 10 ppm	W GE_ICP90A 50 ppm	Y GE_ICP90A 5 ppm	Zn GE_ICP90A 10 ppm
156001	<5	<50	<10	0.01	<10	<50	<5	443
156002	<5	<50	<10	0.03	11	<50	5	409
156003	28	<50	136	0.44	180	<50	30	90
156004	28	<50	143	0.43	175	<50	32	90
156005	28	<50	37	0.46	172	<50	32	78
156006	29	<50	19	0.38	177	<50	27	79
156007	32	<50	102	0.51	179	<50	35	46
156008	22	<50	49	0.39	166	<50	24	1128
156009	19	<50	69	0.31	140	<50	23	88
156010	29	<50	105	0.48	198	<50	30	84
156011	<5	<50	<10	0.01	<10	<50	<5	31
156012	<5	<50	<10	<0.01	<10	51	<5	36
156013	<5	<50	<10	<0.01	<10	<50	<5	18
156014	<5	<50	<10	<0.01	<10	<50	<5	12
156015	<5	<50	<10	<0.01	<10	<50	<5	22
156016	<5	<50	<10	<0.01	<10	<50	13	97
156017	<5	<50	<10	<0.01	<10	<50	<5	70
156018	8	<50	171	0.53	84	<50	10	145
526401	<5	<50	<10	<0.01	<10	<50	<5	29
526402	<5	<50	<10	<0.01	<10	<50	<5	157
526403	<5	<50	<10	<0.01	<10	<50	<5	<10
526404	<5	<50	<10	<0.01	<10	<50	<5	16
526405	<5	<50	<10	<0.01	<10	<50	<5	29
526406	<5	<50	<10	<0.01	<10	<50	<5	16
526407	<5	<50	<10	<0.01	<10	<50	10	97
526408	<5	<50	<10	<0.01	<10	<50	<5	153
526409	<5	<50	15	0.05	27	<50	<5	81
526410	<5	<50	<10	<0.01	<10	<50	9	61
526422	8	<50	171	0.54	82	<50	10	137
526411	<5	<50	<10	<0.01	<10	<50	<5	202
526412	<5	<50	<10	<0.01	<10	<50	<5	292
526413	<5	<50	<10	0.02	<10	<50	<5	25
526414	14	<50	18	0.11	59	<50	<5	36
526415	<5	<50	<10	0.02	<10	<50	<5	22
*Dup 526415	<5	<50	<10	0.02	<10	<50	<5	26
526416	<5	<50	<10	<0.01	<10	<50	<5	14
526417	<5	<50	11	0.02	<10	<50	<5	<10
526418	<5	<50	<10	0.01	14	<50	<5	15
526419	<5	<50	17	0.03	<10	<50	<5	<10
526420	10	<50	<10	0.06	30	<50	<5	217

This document is issued by the Company under its General Conditions of Service accessible at <http://www.sgs.com/en/Terms-and-Conditions.aspx>. Attention is drawn to the limitation of liability, indemnification and jurisdiction issues defined therein.

WARNING: The sample(s) to which the findings recorded herein (the "Findings") relate was (were) drawn and / or provided by the Client or by a third party acting at the Client's direction. The Findings constitute no warranty of the sample's representativity of the goods and strictly relate to the sample (s). The Company accepts no liability with regard to the origin or source from which the sample(s) is/are said to be extracted. The findings report on the samples provided by the client and are not intended for commercial or contractual settlement purposes. Any unauthorized alteration, forgery or falsification of the content or appearance of this document is unlawful and offenders may be prosecuted to the fullest extent of the law .

Element	Sc	Sn	Sr	Ti	V	W	Y	Zn
Method	GE_ICP90A	GE_ICP90A	GE_ICP90A	GE_ICP90A	GE_ICP90A	GE_ICP90A	GE_ICP90A	GE_ICP90A
Det.Lim.	5	50	10	0.01	10	50	5	10
Units	ppm	ppm	ppm	%	ppm	ppm	ppm	ppm
526421	8	<50	169	0.54	82	<50	10	141
*Rep 156010	29	<50	106	0.48	203	<50	32	87

This document is issued by the Company under its General Conditions of Service accessible at <http://www.sgs.com/en/Terms-and-Conditions.aspx>. Attention is drawn to the limitation of liability, indemnification and jurisdiction issues defined therein.

WARNING: The sample(s) to which the findings recorded herein (the "Findings") relate was (were) drawn and / or provided by the Client or by a third party acting at the Client's direction. The Findings constitute no warranty of the sample's representativity of the goods and strictly relate to the sample (s). The Company accepts no liability with regard to the origin or source from which the sample(s) is/are said to be extracted. The findings report on the samples provided by the client and are not intended for commercial or contractual settlement purposes. Any unauthorized alteration, forgery or falsification of the content or appearance of this document is unlawful and offenders may be prosecuted to the fullest extent of the law .

Element Method	Si GE_ICP90A 0.1 %	@Cu GO_ICP90Q 0.01 %
156001	>30.0	7.97
156002	>30.0	7.36
156003	25.4	N.A.
156004	25.8	N.A.
156005	23.8	N.A.
156006	25.0	N.A.
156007	25.9	N.A.
156008	26.3	N.A.
156009	28.3	N.A.
156010	26.0	N.A.
156011	>30.0	N.A.
156012	>30.0	N.A.
156013	>30.0	N.A.
156014	>30.0	N.A.
156015	>30.0	N.A.
156016	>30.0	N.A.
156017	>30.0	8.27
156018	15.6	N.A.
526401	>30.0	N.A.
526402	>30.0	N.A.
526403	>30.0	N.A.
526404	>30.0	N.A.
526405	>30.0	N.A.
526406	>30.0	N.A.
526407	28.4	N.A.
526408	>30.0	N.A.
526409	>30.0	N.A.
526410	>30.0	N.A.
526422	15.6	N.A.
526411	26.1	N.A.
526412	>30.0	N.A.
526413	>30.0	N.A.
526414	>30.0	N.A.
526415	>30.0	N.A.
*Dup 526415	>30.0	N.A.
526416	>30.0	N.A.
526417	>30.0	N.A.
526418	>30.0	N.A.
526419	>30.0	N.A.
526420	>30.0	N.A.

This document is issued by the Company under its General Conditions of Service accessible at <http://www.sgs.com/en/Terms-and-Conditions.aspx>. Attention is drawn to the limitation of liability, indemnification and jurisdiction issues defined therein.

WARNING: The sample(s) to which the findings recorded herein (the "Findings") relate was (were) drawn and / or provided by the Client or by a third party acting at the Client's direction. The Findings constitute no warranty of the sample's representativity of the goods and strictly relate to the sample (s). The Company accepts no liability with regard to the origin or source from which the sample(s) is/are said to be extracted. The findings report on the samples provided by the client and are not intended for commercial or contractual settlement purposes. Any unauthorized alteration, forgery or falsification of the content or appearance of this document is unlawful and offenders may be prosecuted to the fullest extent of the law .

Final : LK1801208 Order:

Report File No.: 0000015480

Element	Si	@Cu
Method	GE_ICP90A	GO_ICP90Q
Det.Lim.	0.1	0.01
Units	%	%
526421	15.8	N.A.
*Rep 156010	25.2	
*Rep 156002		7.38

This document is issued by the Company under its General Conditions of Service accessible at <http://www.sgs.com/en/Terms-and-Conditions.aspx>. Attention is drawn to the limitation of liability, indemnification and jurisdiction issues defined therein.

WARNING: The sample(s) to which the findings recorded herein (the "Findings") relate was (were) drawn and / or provided by the Client or by a third party acting at the Client's direction. The Findings constitute no warranty of the sample's representativity of the goods and strictly relate to the sample (s). The Company accepts no liability with regard to the origin or source from which the sample(s) is/are said to be extracted. The findings report on the samples provided by the client and are not intended for commercial or contractual settlement purposes. Any unauthorized alteration, forgery or falsification of the content or appearance of this document is unlawful and offenders may be prosecuted to the fullest extent of the law .

