

We are committed to providing [accessible customer service](#).

If you need accessible formats or communications supports, please [contact us](#).

Nous tenons à améliorer [l'accessibilité des services à la clientèle](#).

Si vous avez besoin de formats accessibles ou d'aide à la communication, veuillez [nous contacter](#).

Technical Report: 2019 Mechanical Pitting on Claim 255343 in the township of Cunningham.

Completed on January 13, 2020.

Written by Andy Dziadura (409503) for 1537763 Ontario inc. (411961)

Work performed by 1551970 Ontario inc. and Andy Dziadura, duration 3 days including travel.

## Technical Report

The purpose of the work performed was to explore a claim group in Cunningham township, Porcupine mining division (105297, 125220, 125221, 188690, 255343, 321748) formally legacy claim # 4275506 the claims are contiguous and are located approximately 100km south west of Timmins Ontario in the district of Sudbury. Access to the claim group is from the Dore road that runs north, south between the Sultan road and highway # 101, then west and north on an un named road approximately 9 km, to an old trail/road at utm zone 17 E 378966 N 5289370, then west approximately one half km to the claim group. The commodity explored for was gold (precious metal). One test pit was excavated on boundry claim #255343 that measured approximately 6'-0" x 6'-0" to a depth of 32" where it was terminated due the material removal limit of 3 cubic metres. The pit area had minimal topsoil, depth 1" to 4" followed by silty sand, then fine and coarse grained sand mixed with small stones believed to be sedimentary in nature to a depth of +-24", then some larger round stones 4" to 6" also mixed with coarse grained sand, some of this sand was panned to ascertain gold quantities (results were negligible). A small area of bedrock was encountered in the north west corner of the pit approximately 12" x 12" this was believed to be iron formation (sedimentary) and reddish brown in color. This area could not be well observed due to caving in of the pit walls, however no quartz veining was observed. The area has good potential of having gold and other precious metals deposits, it is recommended that other areas of this claim group be explored that have less overburden.



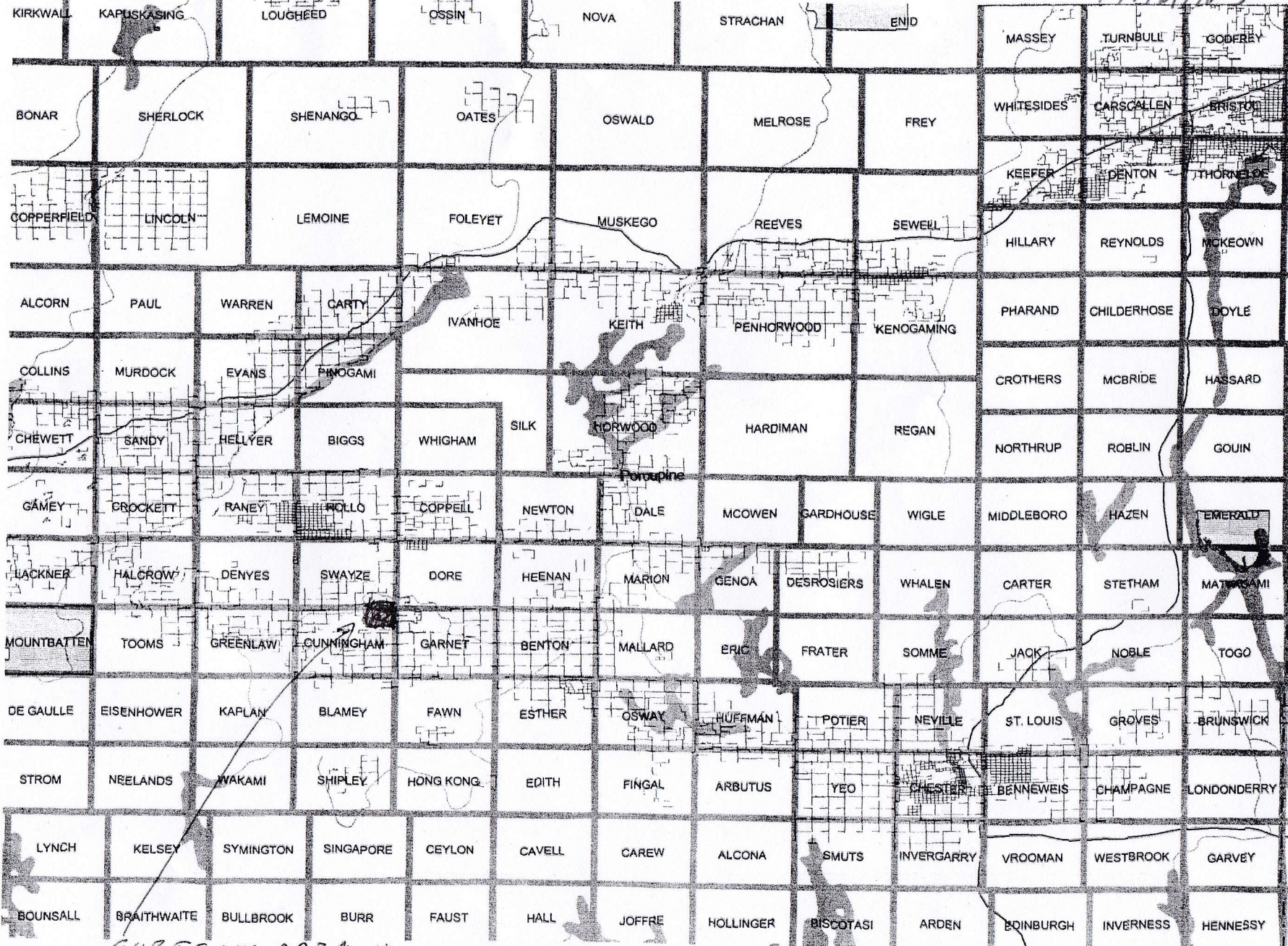

TIMMINS



SUBJECT AREA ± 100 km S/W OF TIMMINS LEGACY CLAIM 4275506  
 CUNNINGHAM TOWNSHIP

BOUNDARY CLAIMS 105297, 125220, 125221, 188690, 255343, 321748

NAD 83  
 5 degree grid



KEY MAP

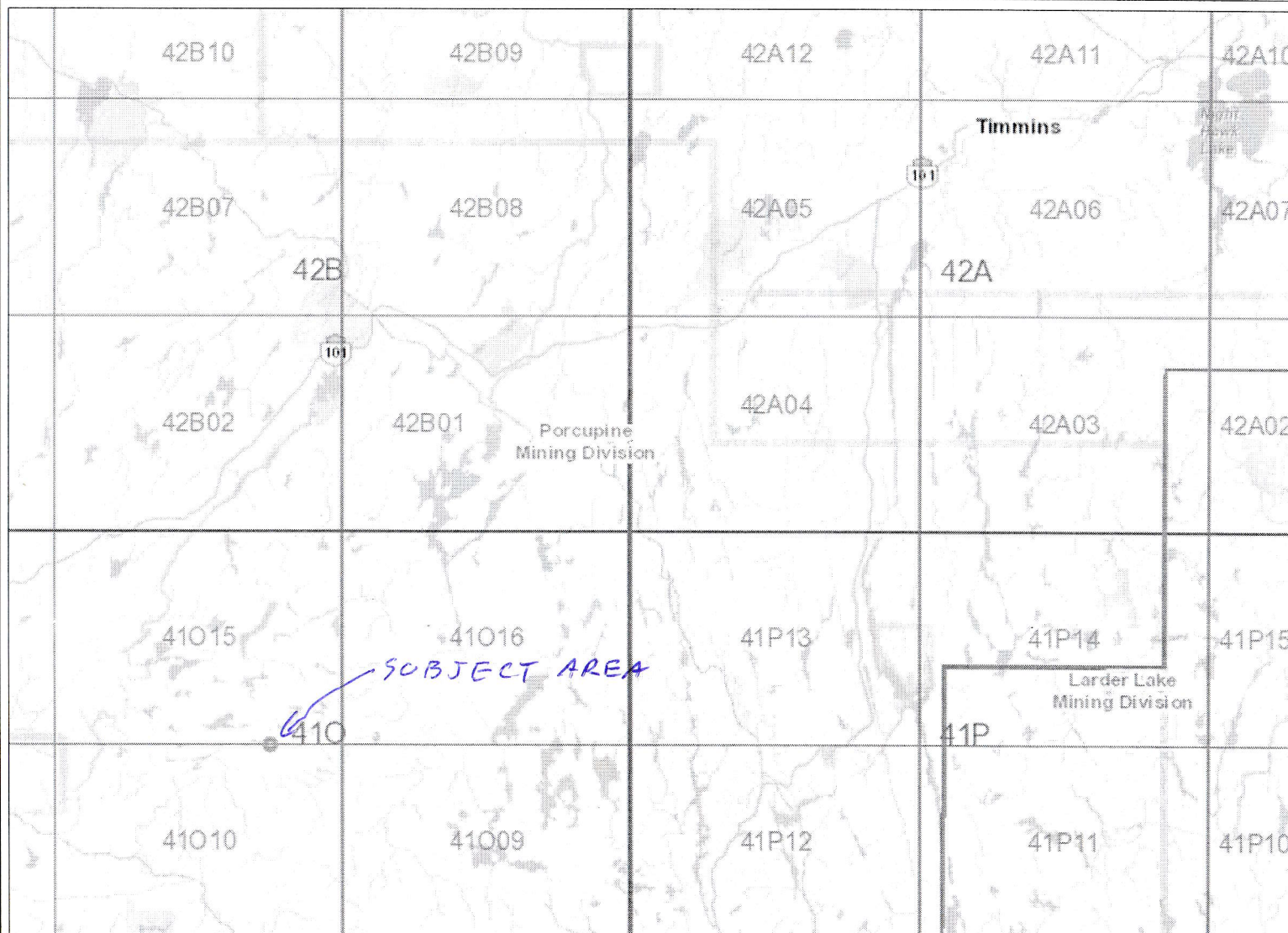

### Legend

- Provincial Grid Cell**
  - Available
  - Pending
  - Unavailable
- Mining Claim**
  - Mining Claim
  - Boundary Claim
- Alienation**
  - Withdrawal
  - Notice
- ENDM Administrative Boundaries**
  - ENDM Townships and Areas
  - Geographic Lot Fabric
  - UTM Grid 1K
  - UTM Grid 10K
  - Mining Division
  - Mineral Exploration and Development Region
  - CLUPA Protected Area - Far North
  - Resident Geologist District
  - Federal Land Other
  - Native Reserves
  - AMIS Sites
  - AMIS Features
  - Drill Hole
  - Mineral Occurrences
- MLAS Mining History**
  - Withdrawal - History
  - Notice - History
  - Mining Claim - History
  - Mining Land Tenure - History
  - Legacy Claim
- Provincial Grid**
  - Provincial Grid 250K
  - Provincial Grid 50K
  - Provincial Grid Group
- Land Tenure**
  - Surface Rights
  - Mining Rights
  - Mining and Surface Rights
  - Order-in-Council



Projection: Web Mercator



The Ontario Ministry of Northern Development and Mines shall not be liable in any way for the use of, or reliance upon, this map or any information on this map. This map should not be used for: navigation, a plan of survey, routes, nor locations.

Imagery Copyright Notices: Ontario Ministry of Natural Resources and Forestry; NASA Landsat Program; First Base Solutions Inc.; Aéro-Photo (1961) Inc.; DigitalGlobe Inc.; U.S. Geological Survey.

© Queen's Printer for Ontario, 2020

± 100 km SOUTHWEST OF TIMMINS LEGACY CLAIM 4275506

BOUNDARY CLAIMS 105297, 125220, 125221, 198690, 255343, 321748  
CUNNINGHAM TOWNSHIP

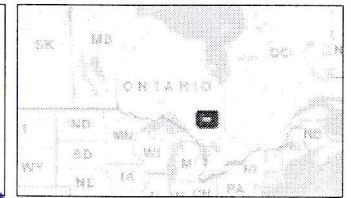



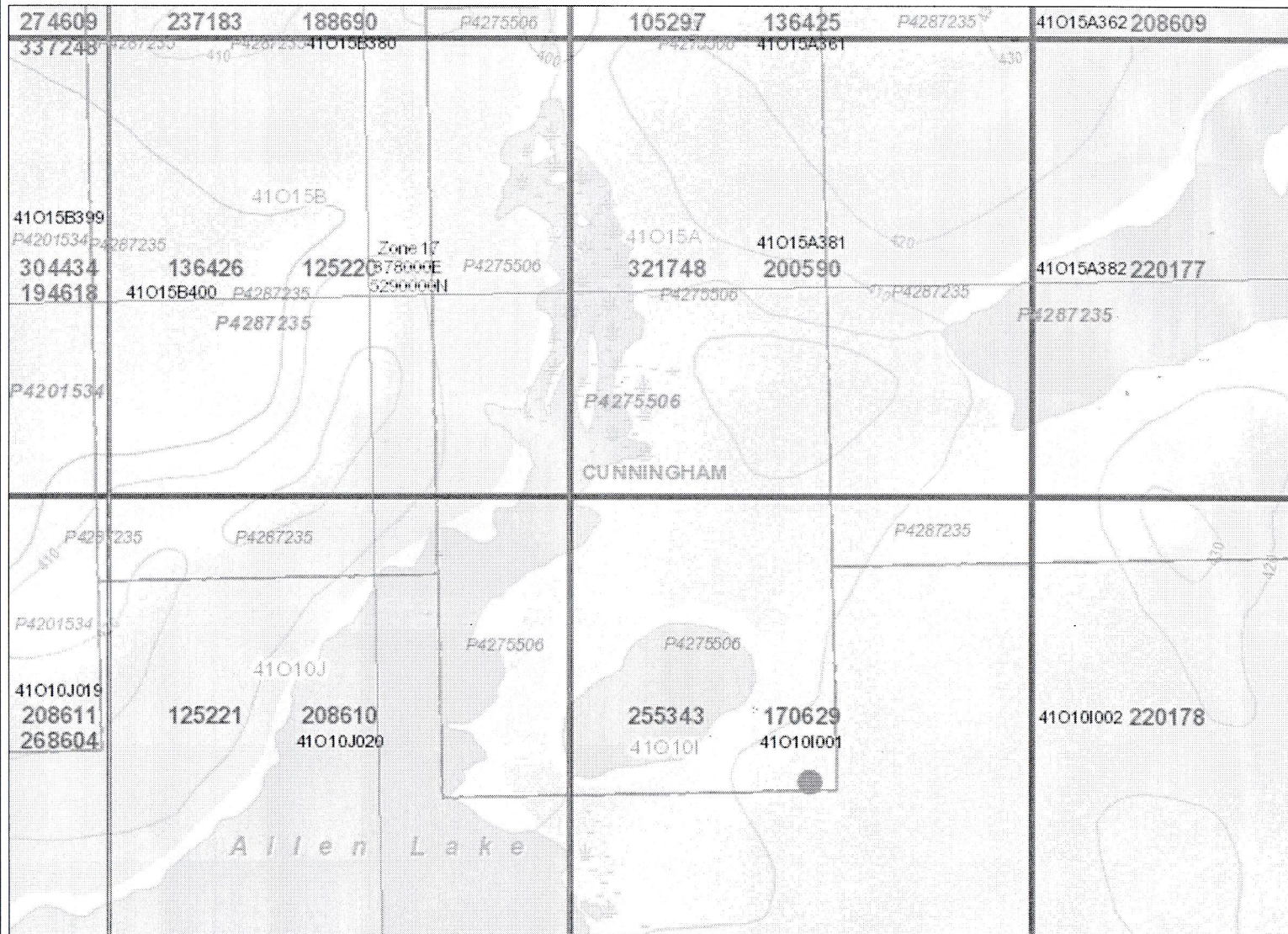

### Legend

- Provincial Grid Cell**
  - Available
  - Pending
  - Unavailable
- Mining Claim**
  - Mining Claim
  - Boundary Claim
- Alienation**
  - Withdrawal
  - Notice
- ENDM Administrative Boundaries**
  - ENDM Townships and Areas
  - Geographic Lot Fabric
  - UTM Grid 1K
  - UTM Grid 10K
  - Mining Division
  - Mineral Exploration and Development Region
  - CLUPA Protected Area - Far North
  - Resident Geologist District
  - Federal Land Other
  - Native Reserves
- AMIS Sites**
  - AMIS Sites
  - AMIS Features
  - Drill Hole
  - Mineral Occurrences
- MLAS Mining History**
  - Withdrawal - History
  - Notice - History
  - Mining Claim - History
  - Mining Land Tenure - History
  - Legacy Claim
- Provincial Grid**
  - Provincial Grid 250K
  - Provincial Grid 50K
  - Provincial Grid Group
- Land Tenure**
  - Surface Rights
  - Mining Rights
  - Mining and Surface Rights
  - Order-in-Council



Projection: Web Mercator



The Ontario Ministry of Northern Development and Mines shall not be liable in any way for the use of, or reliance upon, this map or any information on this map. This map should not be used for: navigation, a plan of survey, routes, nor locations.

Imagery Copyright Notices: Ontario Ministry of Natural Resources and Forestry; NASA Landsat Program; First Base Solutions Inc.; Aéro-Photo (1961) Inc.; DigitalGlobe Inc.; U.S. Geological Survey.

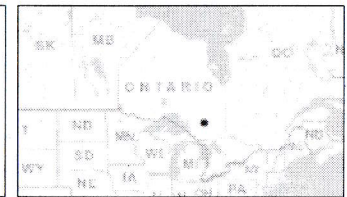

*SITE MAP*



PIT

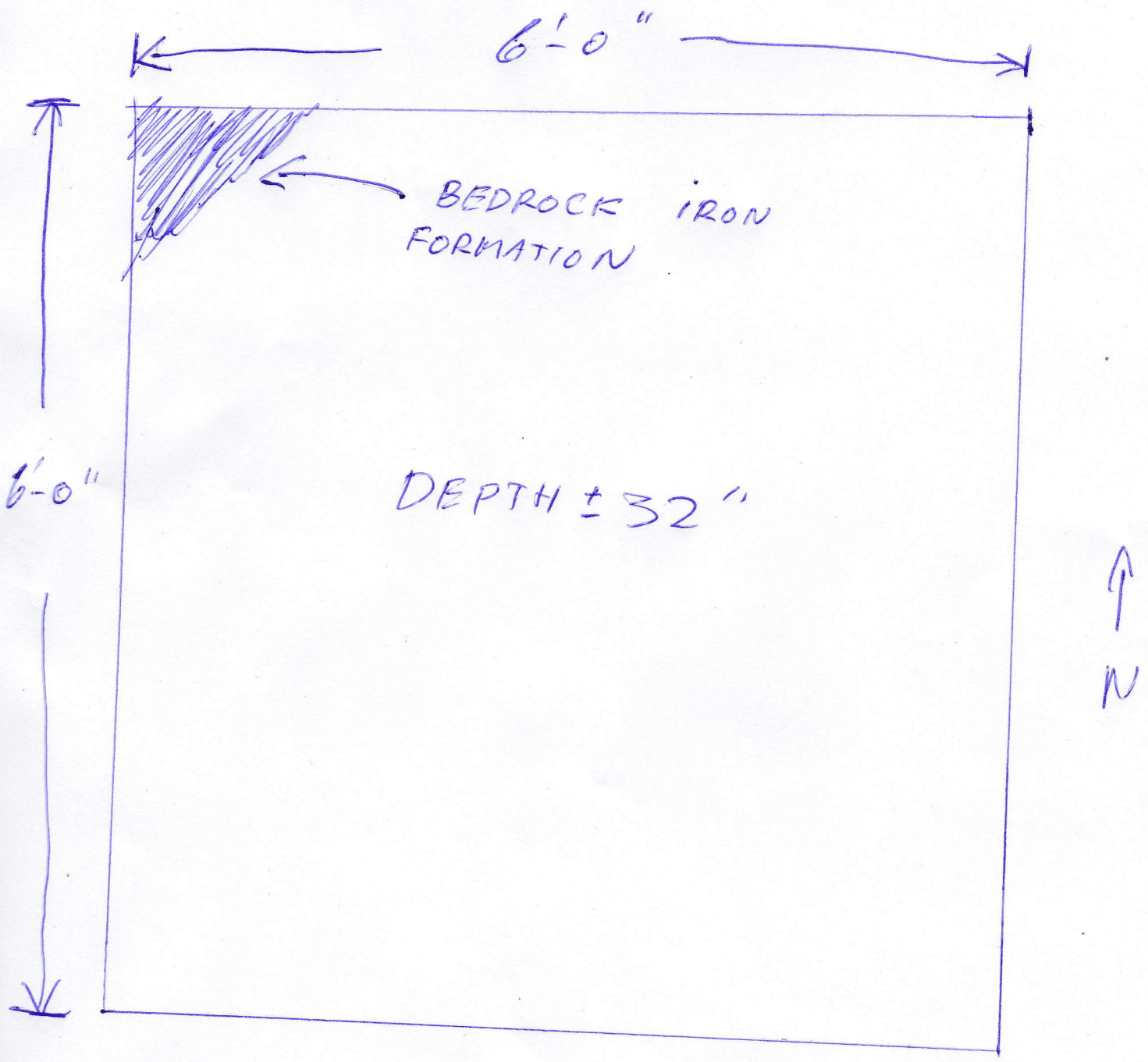







MOB IN OUT  
FIND PAGE  
① MENU  
QUIT ENTER  
GPSmap 62CSx MARK



GARMIN