

We are committed to providing [accessible customer service](#).

If you need accessible formats or communications supports, please [contact us](#).

Nous tenons à améliorer [l'accessibilité des services à la clientèle](#).

Si vous avez besoin de formats accessibles ou d'aide à la communication, veuillez [nous contacter](#).

TITLE PAGE

ASSESSMENT WORK NUMBER
3063

TRANSACTION ID
51158

TECHNICAL REPORT

GRASS ROOTS PROSPECTING

FIRST REPORT FEBRUARY 13, 2020 BY Daniel Crawford
RESPONSE TO NOTICE OF DETERMINATION MAY 1, 2020
BY Daniel Crawford

- PROPERTY NAME DECTOR LAHR CLAIM # 556589
SITE LOCATION UTM 482345 EASTING 561649 NORTHING
- NEW SITE MAP ATTACHED
- ANALYSIS ATTACHED SD19251492 OCT 5/2019

GRASS ROOTS PROSPECTING

DANIEL CRAWFORD

LICENCE # C37488

CLIENT # 294698

Daniel M. Crawford

CLAIM # 556589

LOCATION TWP CAMPING LAKE AREA

2019	DECTOR LAKE	HRS	KM
SEPT 9	PREPARE TRUCK & TRAILOR (LICENSE ACCOMMODATION) + PROSPECTING EQUIPMENT	8	
" 10	ON THE ROAD SUBURB, IRON BRIDGE, WAWA, NEPISIGON	10	
" 11	" " " " IGNACE, DRYDEN EAR FALLS	8	1569
" 13	TRAVEL BUSH RD TO CAMP SITE AND SET UP	8	10
" 15	CUT TRAIL TO DECTOR LAKE CARRY CANOE AND EQUIP	10	
" 16	TRAVEL TO TRAIL WALK TO LAKE PADDOLE TO CLAIM SITE, EXPLORE SITE COLLECT GRAB SAMPLES AT THE SOUTHERN SCOR OF THE WENASAGA BATHOLITH AT THE NORTH SIDE OF DECTOR LAKE LAT 50°42'N LON 93°15'W - A PEG-MATITE GROUP, THIS ROCK OUTCROP IS A GRADUAL SLOPE NORTH INTO SPARSE BUSH ALONG AN OUTLET TO SANDY CREEK. IN THE QUARTZ VEINS, MUSCOVITE GRANITE, BLACK TOURMALINE BLUE-GREEN FLUORAPATITE EXIST.	10	5
SEPT. 25, 26, 27	RETURN HOME	18	1569

EXPENSES: KM TRAVEL @ 3153 @ 20.00 = 1576.50

LABOUR 4 DAYS 36hr @ 20.00 = 720.00

TRAVEL 4 DAYS 36hr @ 20.00 = 720.00

MEALS + GROCERIES = 145.29

SUPPLIES = 109.99

TOTAL 2626.78

TOTAL 72 3153



PAGE 6

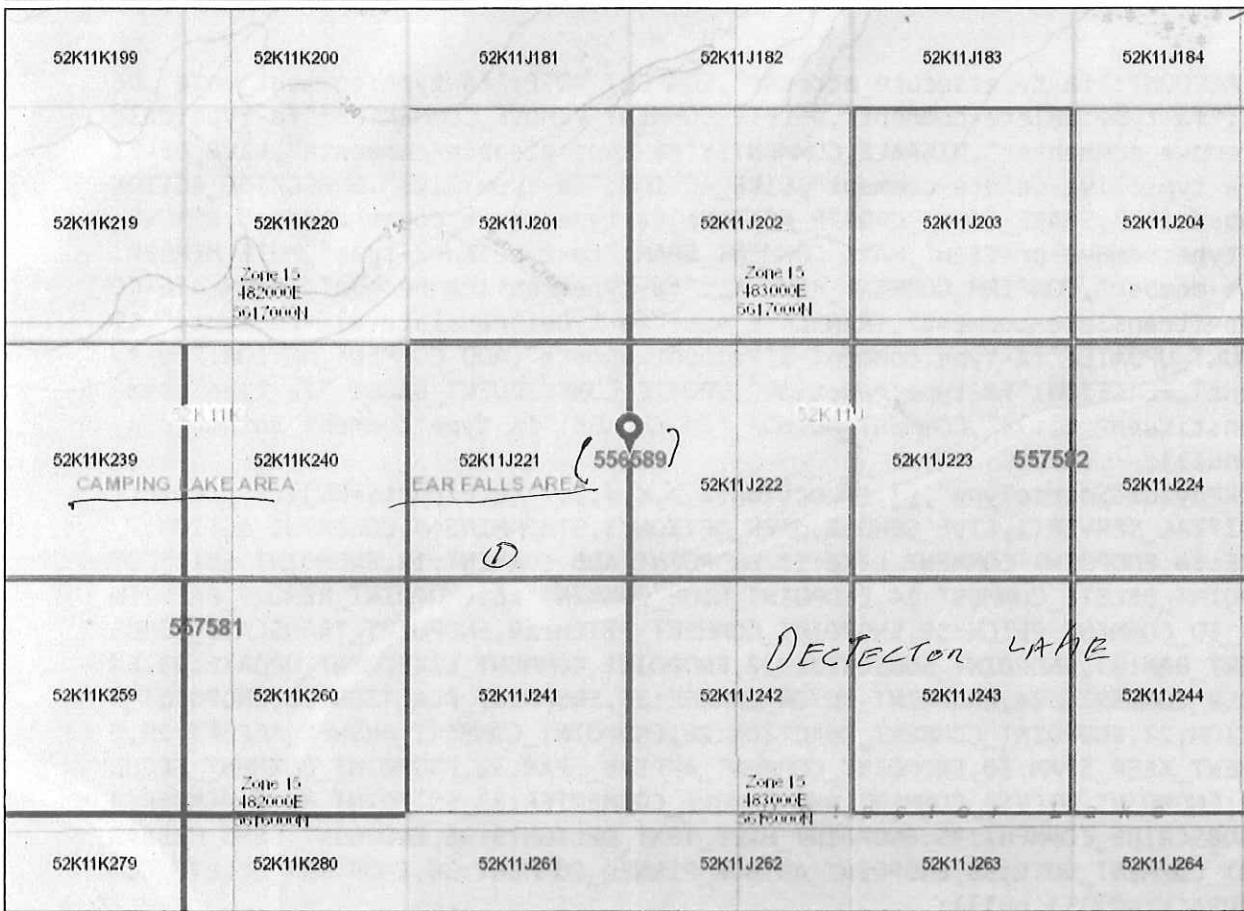

Legend

- Provincial Grid Cell**
 - Available
 - Pending
 - Unavailable
- Mining Claim**
 - Mining Claim
 - Boundary Claim
- Alienation**
 - Withdrawal
 - Notice
- ENDM Administrative Boundaries**
 - ENDM Townships and Areas
 - Geographic Lot Fabric
 - UTM Grid 1K
 - UTM Grid 10K
 - Mining Division
 - Mineral Exploration and Development Region
 - CLUPA Protected Area - Far North
 - Resident Geologist District
 - Federal Land Other
 - Native Reserves
- AMIS Sites**
 - AMIS Sites
 - AMIS Features
 - Drill Hole
- Mineral Occurrences**
- MLAS Mining History**
 - Withdrawal - History
 - Notice - History
 - Mining Claim - History
 - Mining Land Tenure - History
 - Legacy Claim
- Provincial Grid**
 - Provincial Grid 250K
 - Provincial Grid 50K
 - Provincial Grid Group
- Land Tenure**
 - Surface Rights
 - Mining Rights
 - Mining and Surface Rights
 - Order-in-Council



Projection: Web Mercator



The Ontario Ministry of Northern Development and Mines shall not be liable in any way for the use of, or reliance upon, this map or any information on this map. This map should not be used for: navigation, a plan of survey, routes, nor locations.

Imagery Copyright Notices: Ontario Ministry of Natural Resources and Forestry; NASA Landsat Program; First Base Solutions Inc.; Aéro-Photo (1981) Inc.; DigitalGlobe Inc.; U.S. Geological Survey.

© Queen's Printer for Ontario, 2020



① GRAB SAMPLES
LAT 50° 42' N
LONG. 93° 15' W



Navigation Map Information Markup & Printing

NEW SITE MAP MAY 1, 2020 Dmm G

Mining Claim (1) 556589

556589 SITE LOCATION EAR FALLS
 TOWNSHIP
 ACTIVITY START 16. 2019
 ① UTM 482345 EASTING 5616494 NORTHING
 ② GRAB SAMPLES
 ③ LOCATION OF TRAVERSES
 GRADUAL SLOPE NORTH FROM LAKE SHORE
 VALLEY HEADSUL NORTH OUTFLOW SANDY CREEK
 SCATTERED BRUSH ALONG TRAVERSE LINE W/EVER
 FOUND, QUARTZ VEINS, MUSCOVITE, GRAVETE
 BLACK TOURMALINE, BLUE-GREEN
 FLUORAPATITE

I want to...

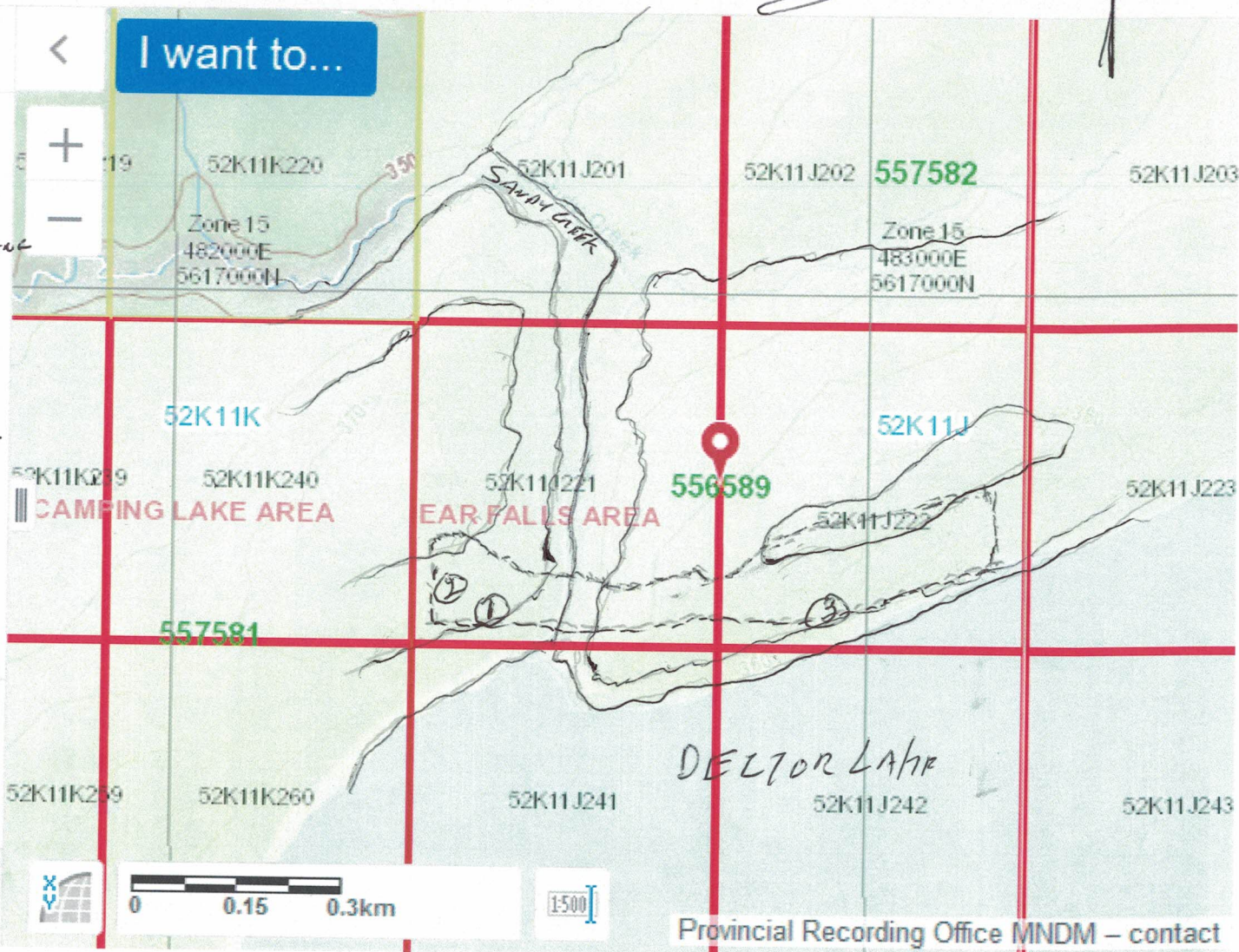

(Total: 1)

1 of 1



Mining Cl...



Search Mi...



0 0.15 0.3km



Provincial Recording Office MNDM – contact



ALS Canada Ltd.

2103 Dollarton Hwy
North Vancouver BC V7H 0A7
Phone: +1 (604) 984 0221 Fax: +1 (604) 984 0218
www.alsglobal.com/geochemistry

To: DANIEL CRAWFORD
603 SUMMERHILL CRES.
SUDBURY ON P3A 4W7

INVOICE NUMBER 4906697

BILLING INFORMATION

Certificate: **SD19251492**
Sample Type: **Rock**
Account: **DNCRAW**
Date: **17-OCT-2019**
Project: **Dector Lake**
P.O. No.:
Quote:
Terms: **Due on Receipt** C2
Comments:

ANALYSED FOR			UNIT	TOTAL
QUANTITY	CODE	DESCRIPTION	PRICE	
1	BAT-01	Administration Fee	37.60	37.60
2	PREP-31	Crush, Split, Pulverize	8.50	17.00
8.34	PREP-31	Weight Charge (kg) - Crush, Split, Pulverize	0.85	7.09
2	ME-MS89L	Super Trace DL Na2O2 by ICP-MS	53.70	107.40

To: **DANIEL CRAWFORD**
ATTN: DANIEL CRAWFORD
603 SUMMERHILL CRES.
SUDBURY ON P3A 4W7

SUBTOTAL (CAD)	\$	169.09
R100938885 GST	\$	8.45
TOTAL PAYABLE (CAD)	\$	177.54

Payment may be made by: Cheque or Bank Transfer

Beneficiary Name:	ALS Canada Ltd.
Bank:	Royal Bank of Canada
SWIFT:	ROYCCAT2
Address:	Vancouver, BC, CAN
Account:	003-00010-1001098

Please send payment info to accounting.canusa@alsglobal.com

Please Remit Payments To :
ALS Canada Ltd.
2103 Dollarton Hwy
North Vancouver BC V7H 0A7

PAID



ALS Canada Ltd.
 2103 Dollarton Hwy
 North Vancouver BC V7H 0A7
 Phone: +1 (604) 984 0221 Fax: +1 (604) 984 0218
 www.alsglobal.com/geochemistry

To: DANIEL CRAWFORD
 603 SUMMERHILL CRES.
 SUDBURY ON P3A 4W7

Page: 1
 Total # Pages: 2 (A - D)
 Plus Appendix Pages
 Finalized Date: 17-OCT-2019
 This copy reported on
 18-OCT-2019
 Account: DNCRAW

CERTIFICATE SD19251492

Project: Dector Lake

This report is for 2 Rock samples submitted to our lab in Sudbury, ON, Canada on 7-OCT-2019.

The following have access to data associated with this certificate:

DANIEL CRAWFORD

SAMPLE PREPARATION

ALS CODE	DESCRIPTION
WEI-21	Received Sample Weight
LOG-22	Sample login - Rcd w/o BarCode
CRU-31	Fine crushing - 70% <2mm
SPL-21	Split sample - riffle splitter
PUL-31	Pulverize up to 250g 85% <75 um
CRU-QC	Crushing QC Test
PUL-QC	Pulverizing QC Test

ANALYTICAL PROCEDURES

ALS CODE	DESCRIPTION
ME-MS89L	Super Trace DL Na2O2 by ICP-MS

This is the Final Report and supersedes any preliminary report with this certificate number. Results apply to samples as submitted. All pages of this report have been checked and approved for release.

***** See Appendix Page for comments regarding this certificate *****

Signature:

 Saa Traxler, General Manager, North Vancouver



ALS Canada Ltd.
2103 Dollarton Hwy
North Vancouver BC V7H 0A7
Phone: +1 (604) 984 0221 Fax: +1 (604) 984 0218
www.alsglobal.com/geochemistry

To: DANIEL CRAWFORD
603 SUMMERHILL CRES.
SUDBURY ON P3A 4W7

Page: Appendix 1
Total # Appendix Pages: 1
Finalized Date: 17-OCT-2019
Account: DNCRAW

Project: Dector Lake

CERTIFICATE OF ANALYSIS SD19251492

CERTIFICATE COMMENTS

LABORATORY ADDRESSES

Applies to Method:	Processed at ALS Sudbury located at 1351-B Kelly Lake Road, Unit #1, Sudbury, ON, Canada.	
	CRU-31	CRU-QC
	PUL-QC	LOG-22
		WEI-21
		PUL-31
Applies to Method:	Processed at ALS Vancouver located at 2103 Dollarton Hwy, North Vancouver, BC, Canada.	
	ME-MS89L	



ALS Canada Ltd.
 2103 Dollarton Hwy
 North Vancouver BC V7H 0A7
 Phone: +1 (604) 984 0221 Fax: +1 (604) 984 0218
 www.alsglobal.com/geochemistry

To: DANIEL CRAWFORD
 603 SUMMERHILL CRES.
 SUDBURY ON P3A 4W7

Page: 2 A
 Total # Pages: 2 (A - D)
 Plus Appendix Page
 Finalized Date: 17-OCT-2019
 Account: DNCRAI

Project: Dector Lake

CERTIFICATE OF ANALYSIS SD19251492

Sample Description	Method Analyte Units LOD	WEI-21	CRU-QC	PUL-QC	ME-MS89L	ME-MS89L	ME-MS89L	ME-MS89L	ME-MS89L	ME-MS89L	ME-MS89L	ME-MS89L	ME-MS89L	ME-MS89L	ME-MS89L	ME-MS89L
		Recvd Wt. kg	Pass2mm %	Pass75um %	Ag ppm	As ppm	Ba ppm	Be ppm	Bi ppm	Ca %	Cd ppm	Ce ppm	Co ppm	Cs ppm	Cu ppm	Dy ppm
Crawford - Oct. 5/19		4.40	84.5	88.3	7	<4	15	<0.4	0.2	<0.1	1.2	27.6	0.9	<0.1	<20	1.28
Crawford - Oct. 10/19		3.84		88.5	5	<4	205	1.2	2.3	1.1	<0.6	20.4	7.0	8.0	20	2.85

***** See Appendix Page for comments regarding this certificate *****



ALS Canada Ltd.
 2103 Dollarton Hwy
 North Vancouver BC V7H 0A7
 Phone: +1 (604) 984 0221 Fax: +1 (604) 984 0218
 www.alsglobal.com/geochemistry

To: DANIEL CRAWFORD
 603 SUMMERHILL CRES.
 SUDBURY ON P3A 4W7

Page: 2 of 2
 Total # Pages: 2 (A - D)
 Plus Appendix Page
 Finalized Date: 17-OCT-2019
 Account: DNCRA

Project: Dector Lake

CERTIFICATE OF ANALYSIS SD19251492

Sample Description	Method Analyte Units LOD	ME-MS89L	ME-MS89L	ME-MS89L	ME-MS89L	ME-MS89L	ME-MS89L	ME-MS89L	ME-MS89L	ME-MS89L	ME-MS89L	ME-MS89L	ME-MS89L	ME-MS89L	ME-MS89L	ME-MS89L
		Er ppm	Eu ppm	Fe %	Ca ppm	Gd ppm	Ge ppm	Ho ppm	In ppm	K %	La ppm	Li ppm	Lu ppm	Mn ppm	Mo ppm	Nb ppm
Crawford - Oct. 5/19		0.78	0.34	1.11	2.1	1.39	<0.5	0.28	<0.3	0.07	12.30	11	<0.05	30	4	3.7
Crawford - Oct. 10/19		1.62	0.66	2.31	18.8	2.77	<0.5	0.50	<0.3	2.30	12.69	48	<0.05	208	3	0.7

***** See Appendix Page for comments regarding this certificate *****



ALS Canada Ltd.
 2103 Dollarton Hwy
 North Vancouver BC V7H 0A7
 Phone: +1 (604) 984 0221 Fax: +1 (604) 984 0218
 www.alsglobal.com/geochemistry

To: DANIEL CRAWFORD
 603 SUMMERHILL CRES.
 SUDBURY ON P3A 4W7

Page: 2
 Total # Pages: 2 (A - D)
 Plus Appendix Page
 Finalized Date: 17-OCT-2017
 Account: DNCRA

Project: Dector Lake

CERTIFICATE OF ANALYSIS SD19251492

Sample Description	Method Analyte Units LOD	ME-MS89L	ME-MS89L	ME-MS89L	ME-MS89L	ME-MS89L	ME-MS89L	ME-MS89L	ME-MS89L	ME-MS89L	ME-MS89L	ME-MS89L	ME-MS89L	ME-MS89L	ME-MS89L	ME-MS89L
		Nd ppm	Ni ppm	Pb ppm	Pr ppm	Rb ppm	Re ppm	Sb ppm	Se ppm	Sm ppm	Sn ppm	Sr ppm	Ta ppm	Tb ppm	Te ppm	Th ppm
Crawford - Oct. 5/19		10.70	10	0.5	2.92	0.9	<0.01	<0.3	8	1.64	<3	<20	0.26	0.20	<0.6	4.2
Crawford - Oct. 10/19		10.95	10	20.8	2.85	117.9	<0.01	<0.3	9	2.62	4	180	1.84	0.44	<0.6	0.8

***** See Appendix Page for comments regarding this certificate *****



ALS Canada Ltd.
 2103 Dollarton Hwy
 North Vancouver BC V7H 0A7
 Phone: +1 (604) 984 0221 Fax: +1 (604) 984 0218
 www.alsglobal.com/geochemistry

To: DANIEL CRAWFORD
 603 SUMMERHILL CRES.
 SUDBURY ON P3A 4W7

Page: 2 - D
 Total # Pages: 2 (A - D)
 Plus Appendix Pages
 Finalized Date: 17-OCT-2019
 Account: DNCRAW

Project: Dector Lake

CERTIFICATE OF ANALYSIS SD19251492

Sample Description	Method Analyte Units LOD	ME-MS89L	ME-MS89L	ME-MS89L	ME-MS89L	ME-MS89L	ME-MS89L	ME-MS89L	ME-MS89L	
		Ti %	Ti ppm	Tm ppm	U ppm	V ppm	W ppm	Y ppm	Yb ppm	Zn ppm
Crawford - Oct. 5/19		0.071	<0.02	0.14	0.5	5	<0.3	7.9	0.69	<10
Crawford - Oct. 10/19		0.071	0.02	0.14	0.5	5	<0.3	7.9	0.69	<10

**** See Appendix Page for comments regarding this certificate ****