

We are committed to providing [accessible customer service](#).

If you need accessible formats or communications supports, please [contact us](#).

Nous tenons à améliorer [l'accessibilité des services à la clientèle](#).

Si vous avez besoin de formats accessibles ou d'aide à la communication, veuillez [nous contacter](#).

Cover

Technical report : 2019 Mechanical stripping and pitting program, townships of Cunningham and Garnet.
Claim numbers: 521234, 521232, 521237

Completed May 11, 2020.

Written by Andy Dziadura (409503) for 1537763 Ontario inc. (411961)

Work performed by 1551970 Ontario inc. and Andy Dziadura Two occasions October 6 and 7, 2019 and October 19, 2019. Duration 7 days including travel. Mobilization performed by JL Henderson ltd through 1551970 Ontario inc.

Cover

Technical report : 2019 Mechanical stripping and pitting program, townships of Cunningham and Garnet.

Completed May 11, 2020.

Written by Andy Dziadura (409503) for 1537763 Ontario inc. (411961)

Work performed by 1551970 Ontario inc. and Andy Dziadura Two occasions October 6 and 7, 2019 and October 19, 2019. Duration 7 days including travel. Mobilization performed by JL Henderson ltd through 1551970 Ontario inc.

Report: The purpose of the work performed was to explore a claim group consisting of 10 claims located in the mining division of porcupine, Sudbury district, townships of Cunningham and Garnet. Claim numbers as follows 521232, 521238, 521240, 521241, 521239, 521236, 521233, 521235, 521234, 521237. The claims are contiguous and located approximately 100km southwest of Timmins Ontario in the district of Sudbury. The claim group is accessed from the Dore road that runs north south between highway 101 and the Sultan industrial road and turning west at approximately mile 48 (as marked) on an unnamed road, traveling first west than north for approximately 8km then turning east for a distance one half of 1 km to the western boundary of the claim group at claim #521232. The commodity explored for on the claim group was gold (precious metal). An area of approximately 4'-0" x 6'-0" was stripped at UTM zone 17 E 0379656 N 5289021, what was believed to be Iron formation was encountered at +- 10" depth (sedimentary rock) what was believed to be embedded pyrite was observed at approximately 1% to 2%. Access to this claim was gained through unpatented claim # 141883. On claim # 521234 a test pit was excavated approximately 5'-0" x 5'-0" x 18" to 24" deep at UTM zone 17 E 0381442 N 5289070. What was believed to be Swayze greenstone (Basalt rock type) was encountered with some quartz veining present, however gold was not observed in these veins, access to this claim was gained through patented claim #11060. Further work was performed on claim # 521237 12 days later October 19, 2019 on claim # 521237 at the far east side of the claim group (UTM zone 17 E 0381480 N 5289021), where an area was stripped approximately 6'-0" x 6'-0" x 16" where both what was believed to be Iron formation and some Swayze greenstone were observed, (sedimentary and Basalt rock types) very little quartz veining or pyrite were observed, access was gained through claim #11060. The stripped area on claim 521237 and the pitted area on claim 521234 had <3 cubic metres of material removed in total from both sites as per exploration plan PL-19-000123 and Katrina. It is recommended that further work in other areas of this large claim group be carried out, due to the present findings and history of the area.

KEY MAP

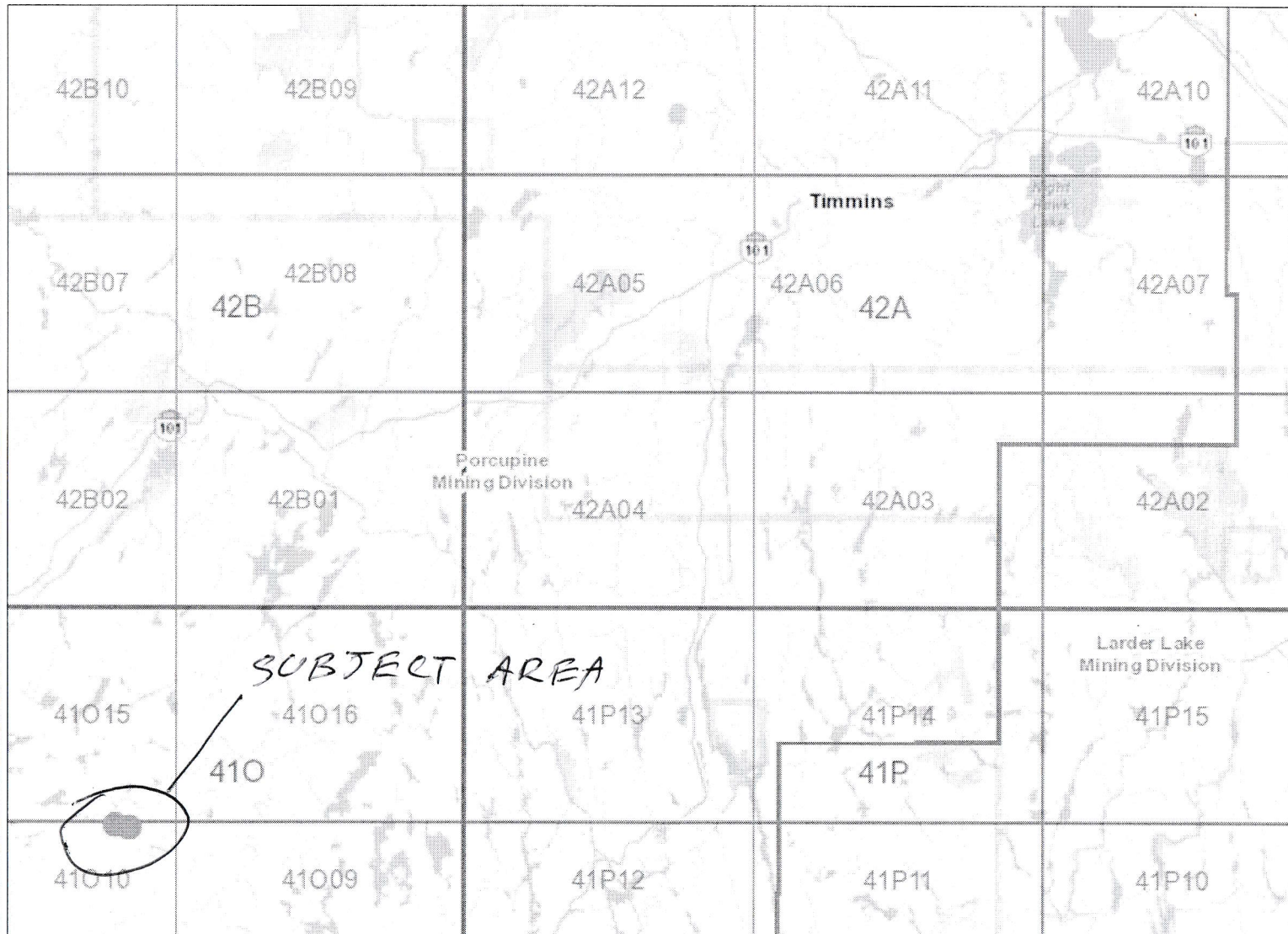

Legend

- Provincial Grid Cell**
 - Available
 - Pending
 - Unavailable
- Mining Claim**
 - Mining Claim
 - Boundary Claim
- Alienation**
 - Withdrawal
 - Notice
- ENDM Administrative Boundaries**
 - ENDM Townships and Areas
 - Geographic Lot Fabric
 - UTM Grid 1K
 - UTM Grid 10K
 - Mining Division
 - Mineral Exploration and Development Region
 - CLUPA Protected Area - Far North
 - Resident Geologist District
 - Federal Land Other
 - Native Reserves
 - AMIS Sites
 - AMIS Features
 - Drill Hole
 - Mineral Occurrences
- MLAS Mining History**
 - Withdrawal - History
 - Notice - History
 - Mining Claim - History
 - Mining Land Tenure - History
 - Legacy Claim
- Provincial Grid**
 - Provincial Grid 250K
 - Provincial Grid 50K
 - Provincial Grid Group
- Land Tenure**
 - Surface Rights
 - Mining Rights
 - Mining and Surface Rights
 - Order-in-Council



Projection: Web Mercator



The Ontario Ministry of Northern Development and Mines shall not be liable in any way for the use of, or reliance upon, this map or any information on this map. This map should not be used for: navigation, a plan of survey, routes, nor locations.

Imagery Copyright Notices: Ontario Ministry of Natural Resources and Forestry; NASA Landsat Program; First Base Solutions Inc.; Aéro-Photo (1961) Inc.; DigitalGlobe Inc.; U.S. Geological Survey.

© Queen's Printer for Ontario, 2020

±100 km SOUTHWEST OF TIMMINS

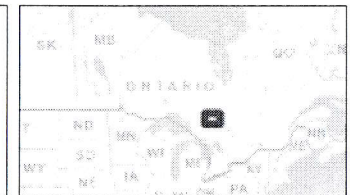

CUNNINGHAM AND GARNET TOWNSHIPS CLAIMS: S21232, S21238, S21240, S21241
S21239, S21236, S21233, S21235, S21234, S21237

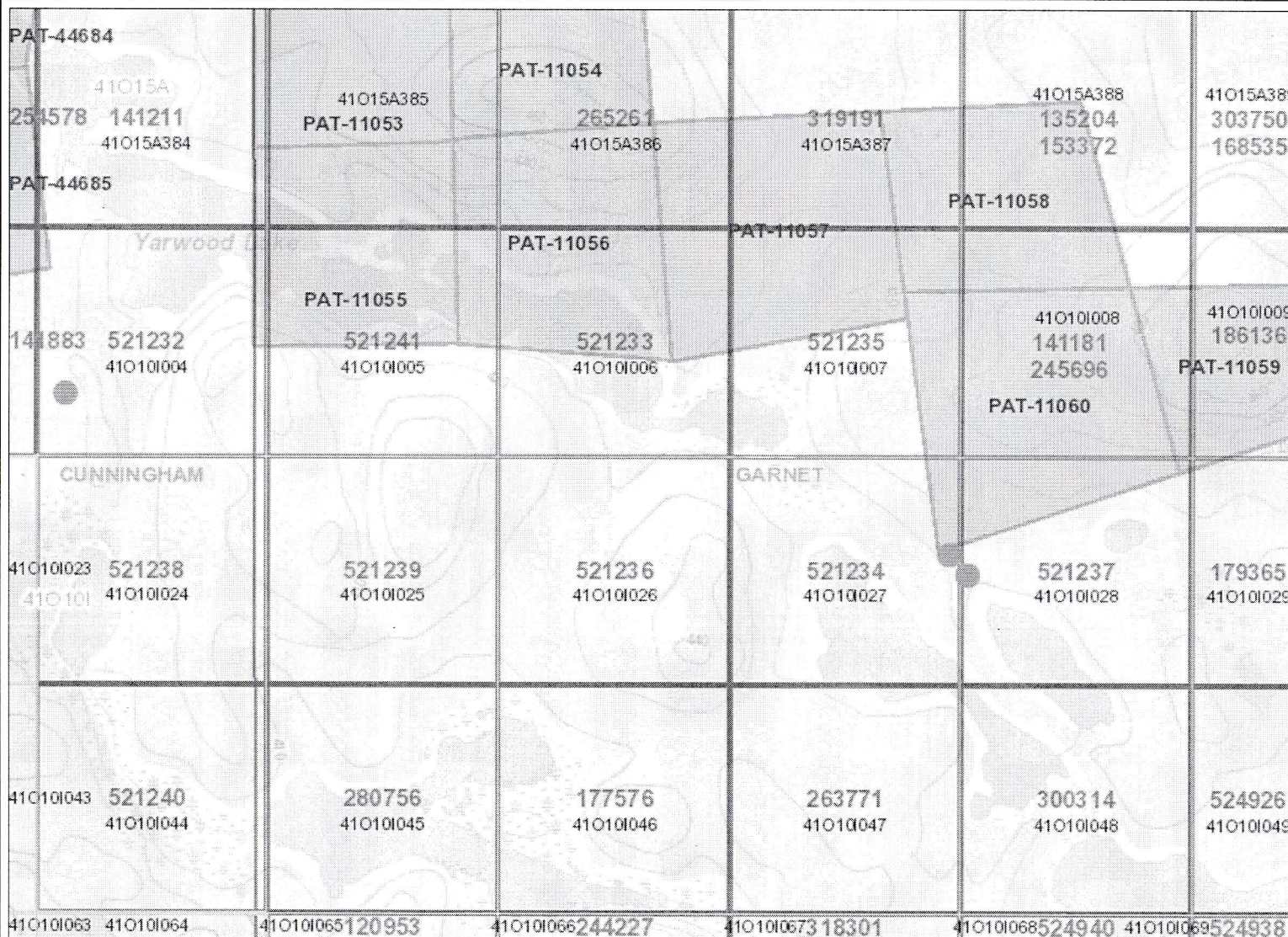

Legend

- Provincial Grid Cell**
 - Available
 - Pending
 - Unavailable
- Mining Claim**
 - Mining Claim
 - Boundary Claim
- Alienation**
 - Withdrawal
 - Notice
- ENDM Administrative Boundaries**
 - ENDM Townships and Areas
 - Geographic Lot Fabric
 - UTM Grid 1K
 - UTM Grid 10K
 - Mining Division
 - Mineral Exploration and Development Region
 - CLUPA Protected Area - Far North
 - Resident Geologist District
 - Federal Land Other
 - Native Reserves
 - AMIS Sites
 - AMIS Features
 - Drill Hole
 - Mineral Occurrences
- MLAS Mining History**
 - Withdrawal - History
 - Notice - History
 - Mining Claim - History
 - Mining Land Tenure - History
 - Legacy Claim
- Provincial Grid**
 - Provincial Grid 250K
 - Provincial Grid 50K
 - Provincial Grid Group
- Land Tenure**
 - Surface Rights
 - Mining Rights
 - Mining and Surface Rights
 - Order-in-Council



Projection: Web Mercator



The Ontario Ministry of Northern Development and Mines shall not be liable in any way for the use of, or reliance upon, this map or any information on this map. This map should not be used for: navigation, a plan of survey, routes, nor locations.

Imagery Copyright Notices: Ontario Ministry of Natural Resources and Forestry; NASA Landsat Program; First Base Solutions Inc.; Aéro-Photo (1961) Inc.; DigitalGlobe Inc.; U.S. Geological Survey.

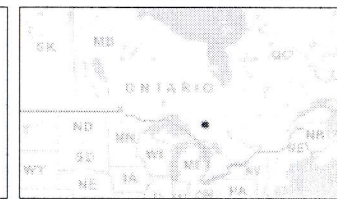

SITE MAP

STRIPPED AREA
CLAIM #S21237

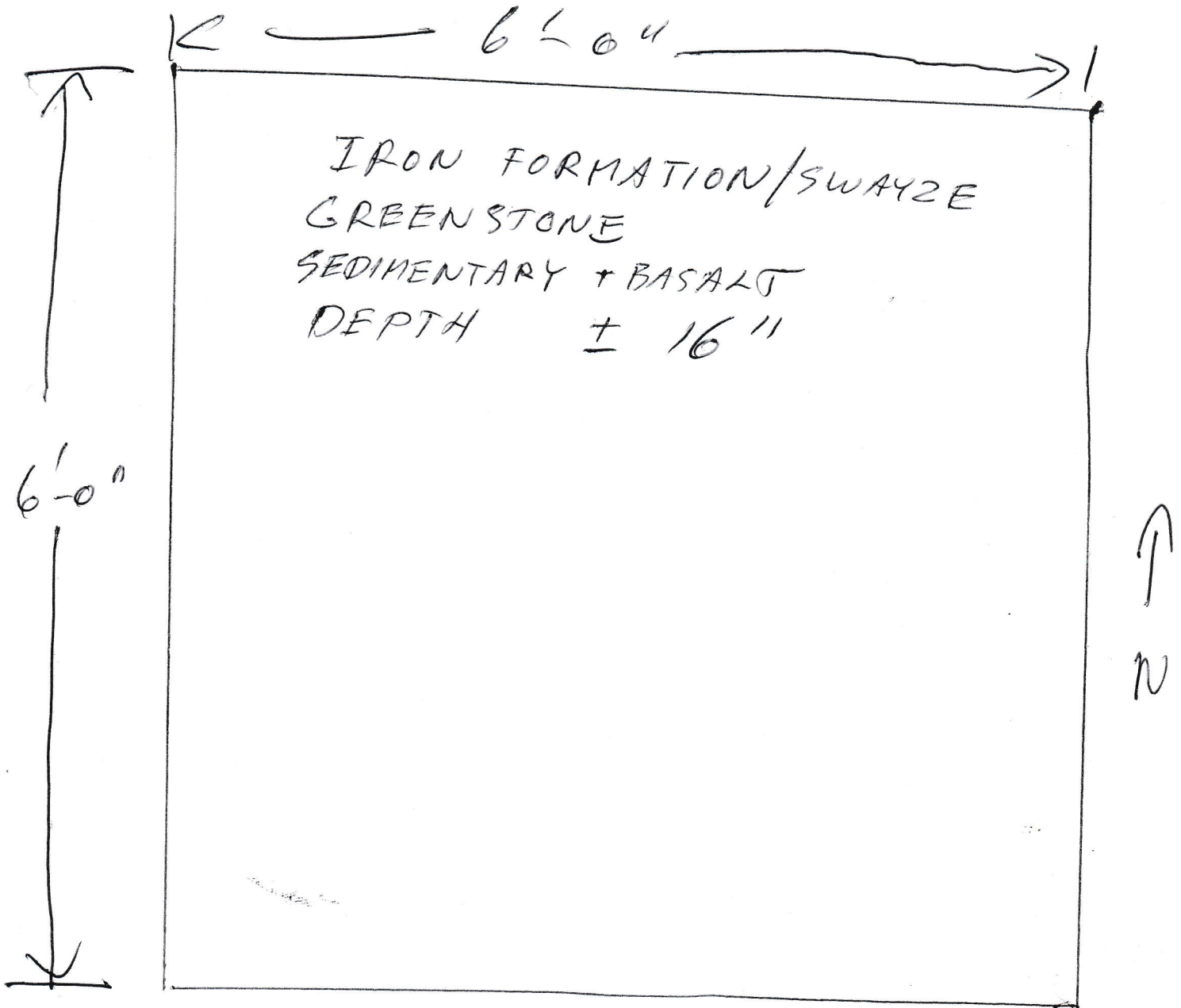

PIT CLAIM # 521234
± 5'-0" x 5'-0"

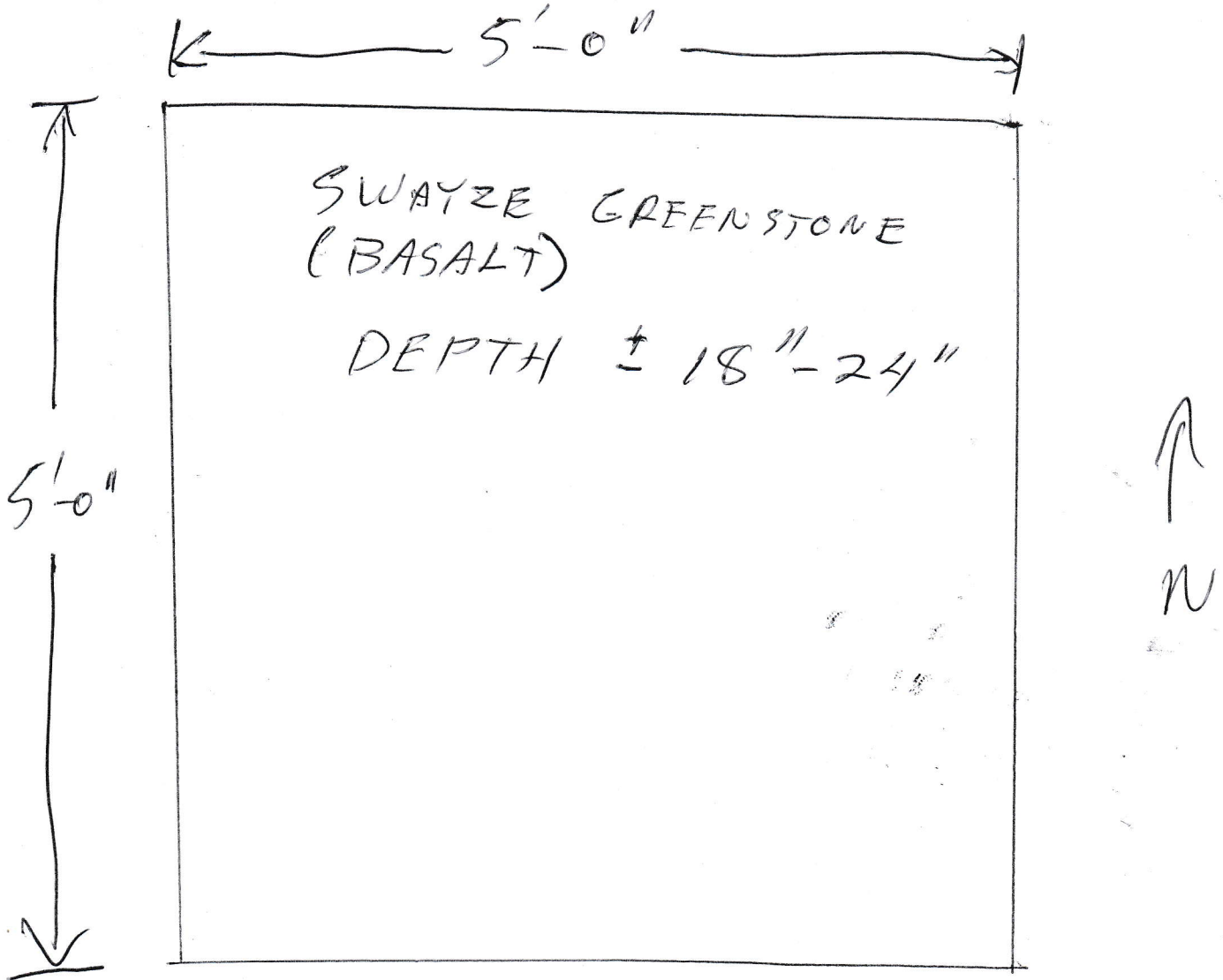

STRIPPED AREA \pm 4'-0" x 6'-0"
CHAIN #521232

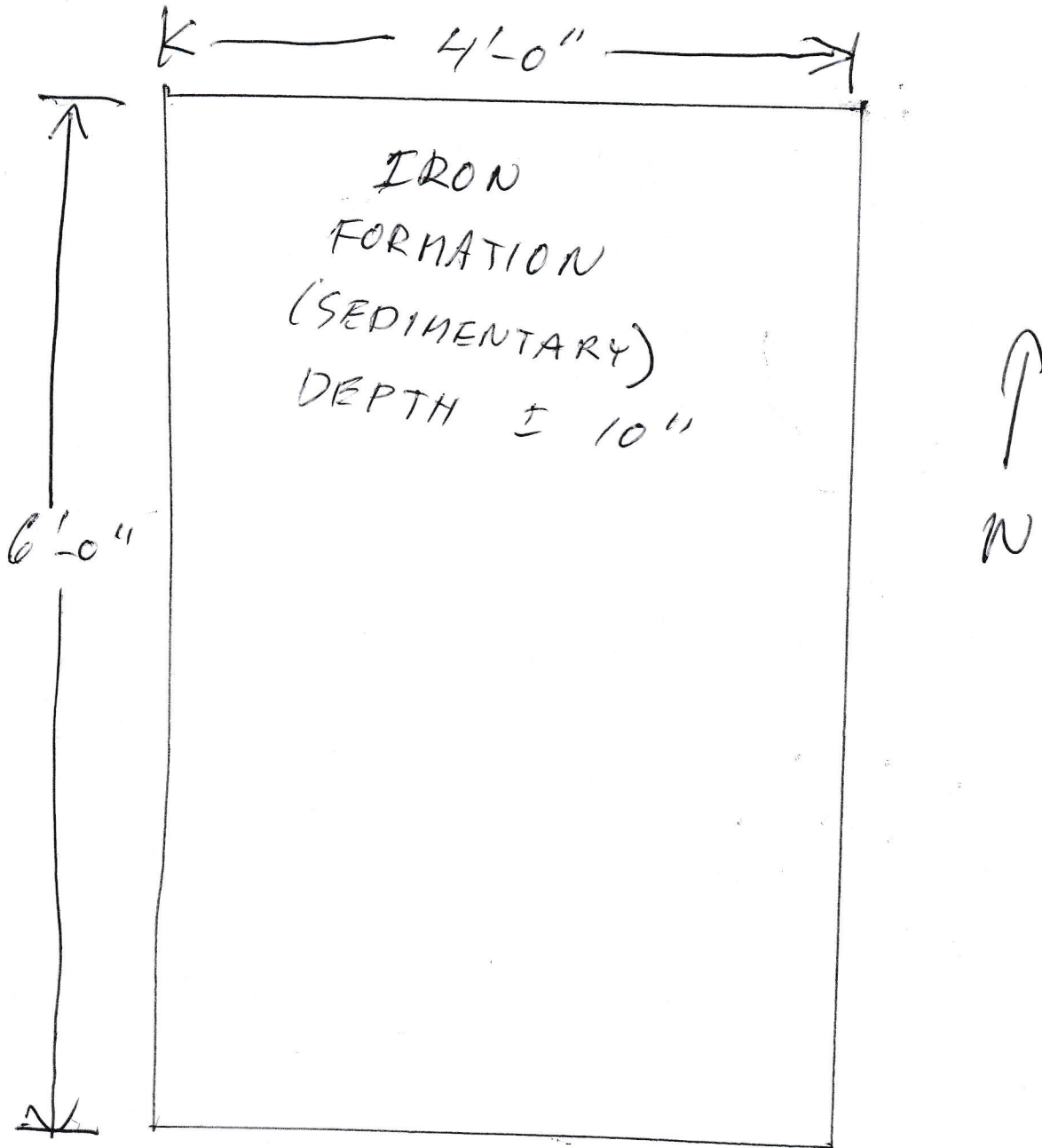











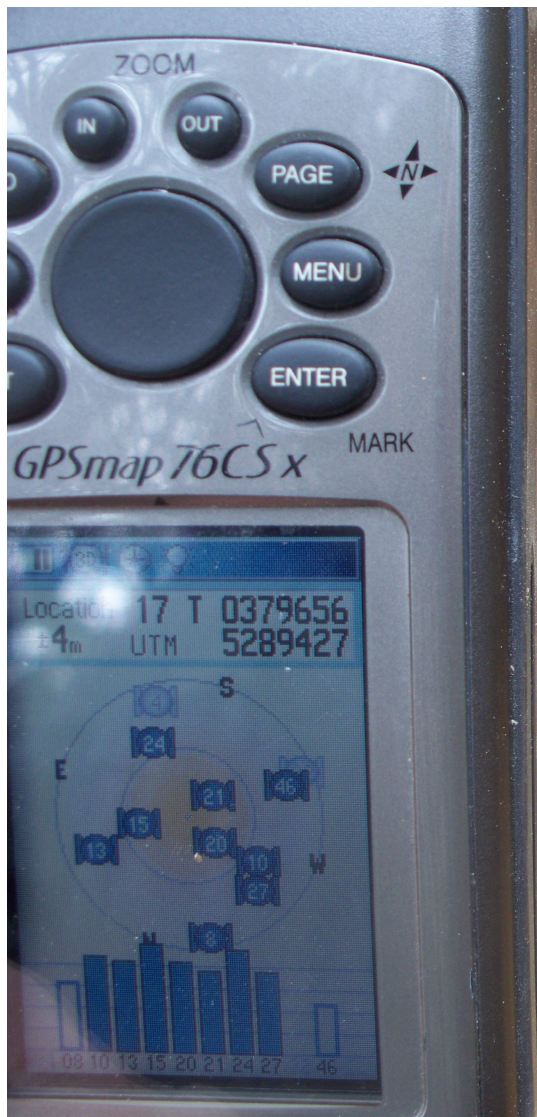





Location 17 T 0381444
±3m UTM 5289065

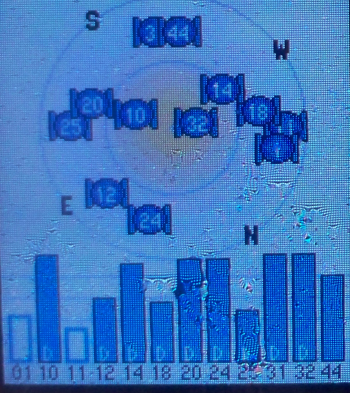

GARMIN

