

We are committed to providing [accessible customer service](#).

If you need accessible formats or communications supports, please [contact us](#).

Nous tenons à améliorer [l'accessibilité des services à la clientèle](#).

Si vous avez besoin de formats accessibles ou d'aide à la communication, veuillez [nous contacter](#).

Grass Roots Prospecting Technical Report

Property Name;

- LETT Township
- Provincial Grid Cell: 42D13L121, 52A16I140
- Mining Claim: 517231, 520189

Completed: Apr 13, 2020

Author: Gordon Jones (MLAS client # 10002236)

ii) Claim worked by

- Gordon Jones
- Ken Haskell
- Tammy Jones

iii) Property Location

LETT Township

Mining Claims:

- 517231 (Provincial Grid Cell: 42D13L121)
- 520189 (Provincial Grid Cell: 52A16I140)

Leased land on site is registered to Tammy Jones

iv) Means of Access

The claims are accessed by driving 25 km east of Nipigon, ON on Hwy 17 to an access road just before the Jackpine river, on the right.

v) Key Map

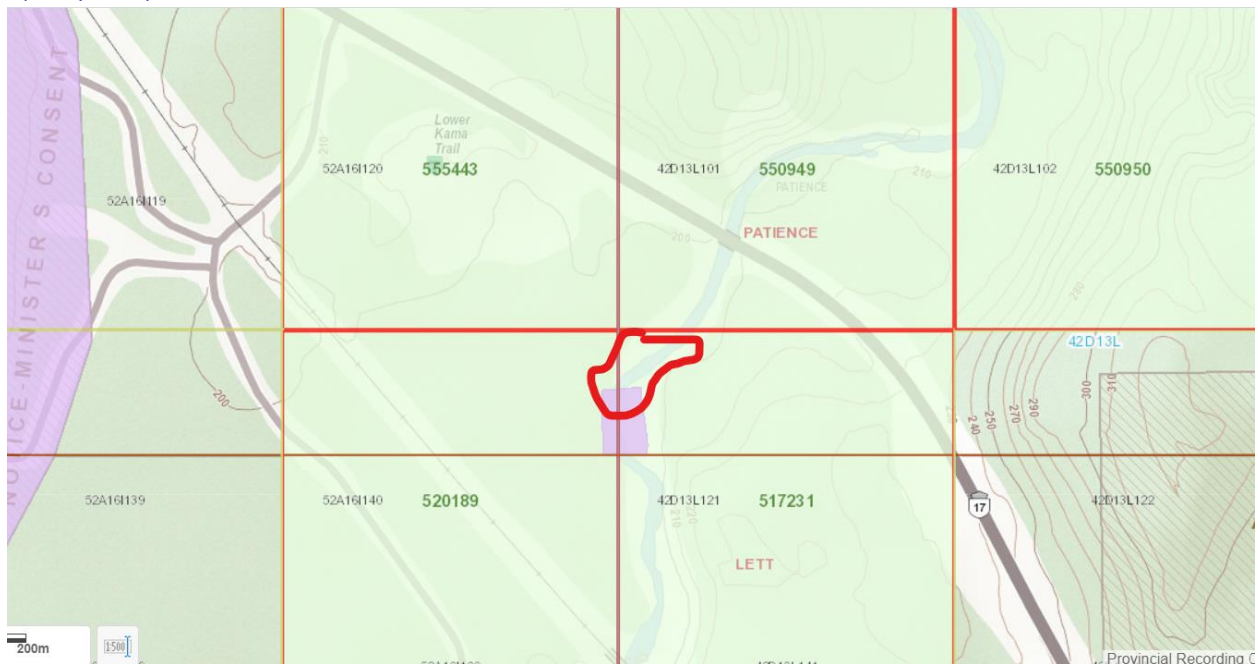

vi) Samples

No samples were collected or analyzed. Only onsite gold panning was done.

vii) Exploration Permits

None taken.

viii) Daily Log

2019;

July 1 Ken Haskell promises to transfer claims to Gord.

July 6 spent 3 hours general prospecting plus travel. Gord and Tammy on behalf of Ken.
= 6 hours

Location 'A' (see map below)

Panning did reveal some magnetite but no Gold.

July 13 spent 3 hours general prospecting plus travel. Gord and Tammy on behalf of Ken..
= 6 hours

Location 'A' (see map below)

Panning did reveal some magnetite but no Gold.

July 20 spent 3 hours general prospecting plus travel. Gord and Tammy on behalf of Ken..
= 6 hours

Location 'B' (see map below)

Panning did reveal some magnetite but no Gold.

Aug 9 – apply for prospectors' licence

Aug 10 spent 3 hours general prospecting plus travel. Gord & Ken on behalf of Ken.
= 6 hours

Location 'C' (see map below)

Panning did reveal some magnetite but no Gold.

Aug 17 spent 3 hours general prospecting plus travel. Gord & Ken on behalf of Ken.
= 6 hours

Location 'D' (see map below)

Panning did reveal some magnetite but no Gold.

Sept 18 – go to Mining office to show sample to Rob Cundari. Spoke for about 1 hour about the claims. He also emailed me maps for Ken's Jellico claims.

Sept 21 – transfer camp claims from Ken to Gord.

Sept 22 – 3 hours on general prospecting plus travel. Gord & Ken.
= 6 hours

Location 'E' (see map below)

Panning did reveal some magnetite but no Gold.

Nov 9 – research how to submit “Work Report” etc. 2 hours.

Jan & Feb 2020 – write technical report. 3 hours.

TOTAL 36 hours of working claims. (Does travel time count towards “working hours”?)

Travel

It's 1.5 hours each way (128 km). I'll enter the km as an expense.

- 6 days of travel = $6 \times (1.5 \times 2) = 18$ hours
- At 128 km each way = $6 \times (128 \times 2) = 1,536$ km. at $\$0.50/\text{km} = \768.00

Apply 50% to each claim

- 18 Hrs each
- \$384 travel expense.

ix) GP location of samples

no samples taken

X) Assay results

None.

xi) Grassroots details

All general prospecting was done on and in the Jackpine river and its shores. The area in and around the leased land was inspected during low water running in the river. This allowed for sampling and panning directly in the river bed. Shore beaches were dug and panned too.

Results – no gold found.

xii) legend

none

xiii) Map

Red circle indicates searching area. Yellow lines indicate areas panned for gold.

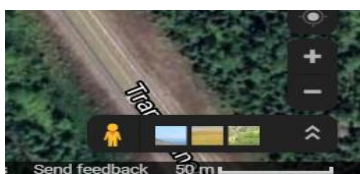

SCALE: 50m

Blue circle indicates searching area. Yellow lines indicate areas panned for gold.

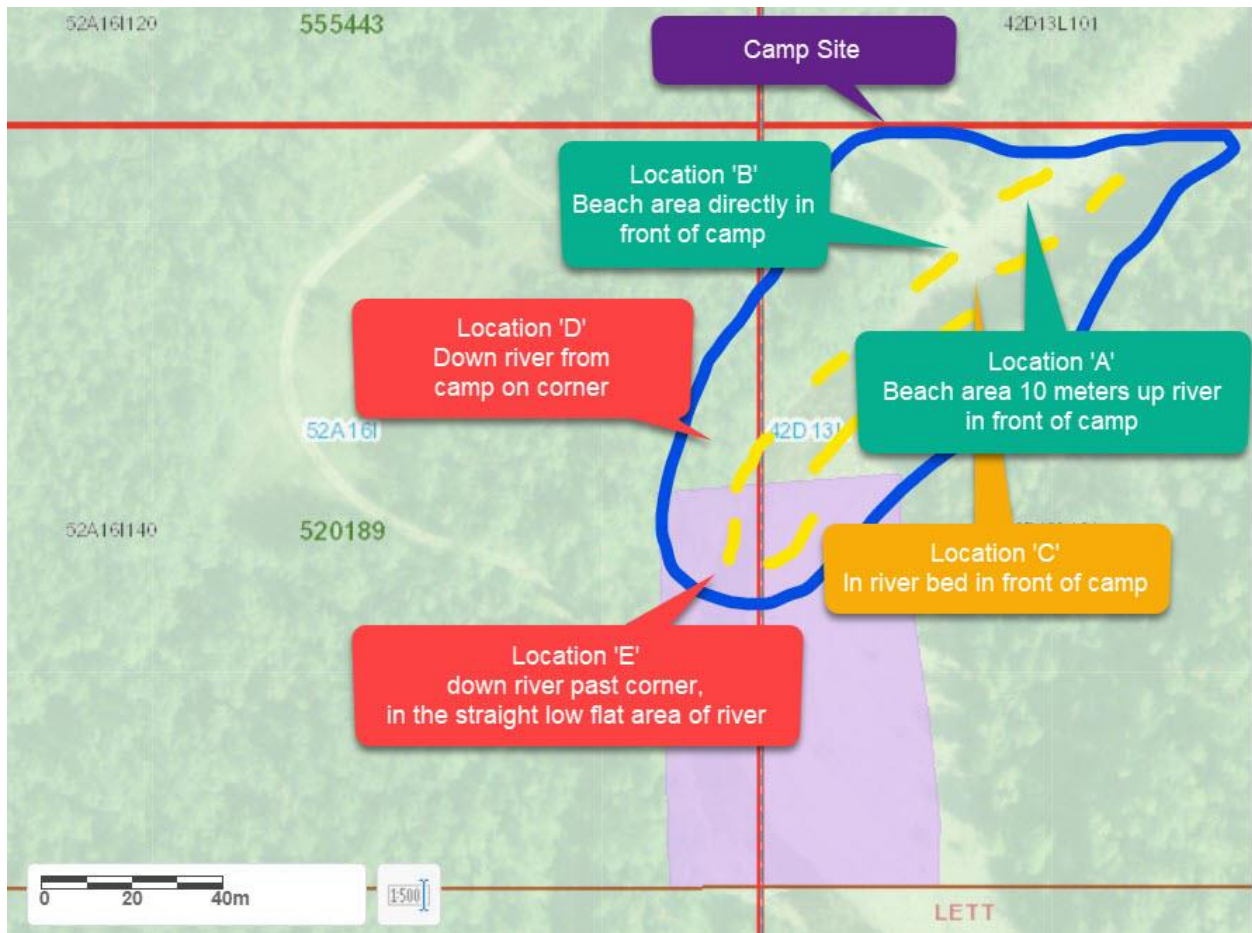

Location pictures

Location 'A' & 'B' (water is high in this picture, was lower later in the summer)

Beach and shore upriver.



Location 'B'

In front of camp.

