

We are committed to providing [accessible customer service](#).

If you need accessible formats or communications supports, please [contact us](#).

Nous tenons à améliorer [l'accessibilité des services à la clientèle](#).

Si vous avez besoin de formats accessibles ou d'aide à la communication, veuillez [nous contacter](#).

## Gould Property Report June 6<sup>th</sup> 2018

Access to Gould Claim (#189080) can be done by following the below instructions:

Travel east of Sault Ste. Marie on Highway 17 all the way to Thessalon (89Km) , in Thessalon there will be a street on your left hand side indicating River Street which you will turn on as it turns into Highway 129 North and will continue to drive on set highway approximately 35 kilometers north. You will then see a sign for driveway #8953 and turn left and there you will park your truck and proceed on ATV inward about 700m and on the south side of the road is where we prospected. The road inward is broken up and rough so extra caution is needed when on ATV.

The main objective of this prospect into this claim is to find Nipissing Diabase to assay for Cobalt.

We proceeded on the set route as detailed above and collected samples

Gould Township Claim

#189080

Jim Ralph

Access to Gould Township is 170 km from Sault Ste. Marie

- a. Take highway 17 east to Thessalon, then north highway 129 to Gould Township.
- b. Park off highway at driveway number 8953
- c. Take four wheeler into claim number 189080 and prospect area
- d. Total Truck km is 170 km
- e. Prospecting and sampling done by Jim Ralph and George Lucuik (Lic #: 161280)



**Sample MN-1 associated with this claim**

# GOULD TWP. (SURVEYED TWP)

NOTE!

CLAIM IS EASILY PROSPECTED.  
IT IS A OLD COPPER PROSPECT.  
LOOKING FOR COBALT IN THE  
NIPPISSING DIABASE IS NEW.

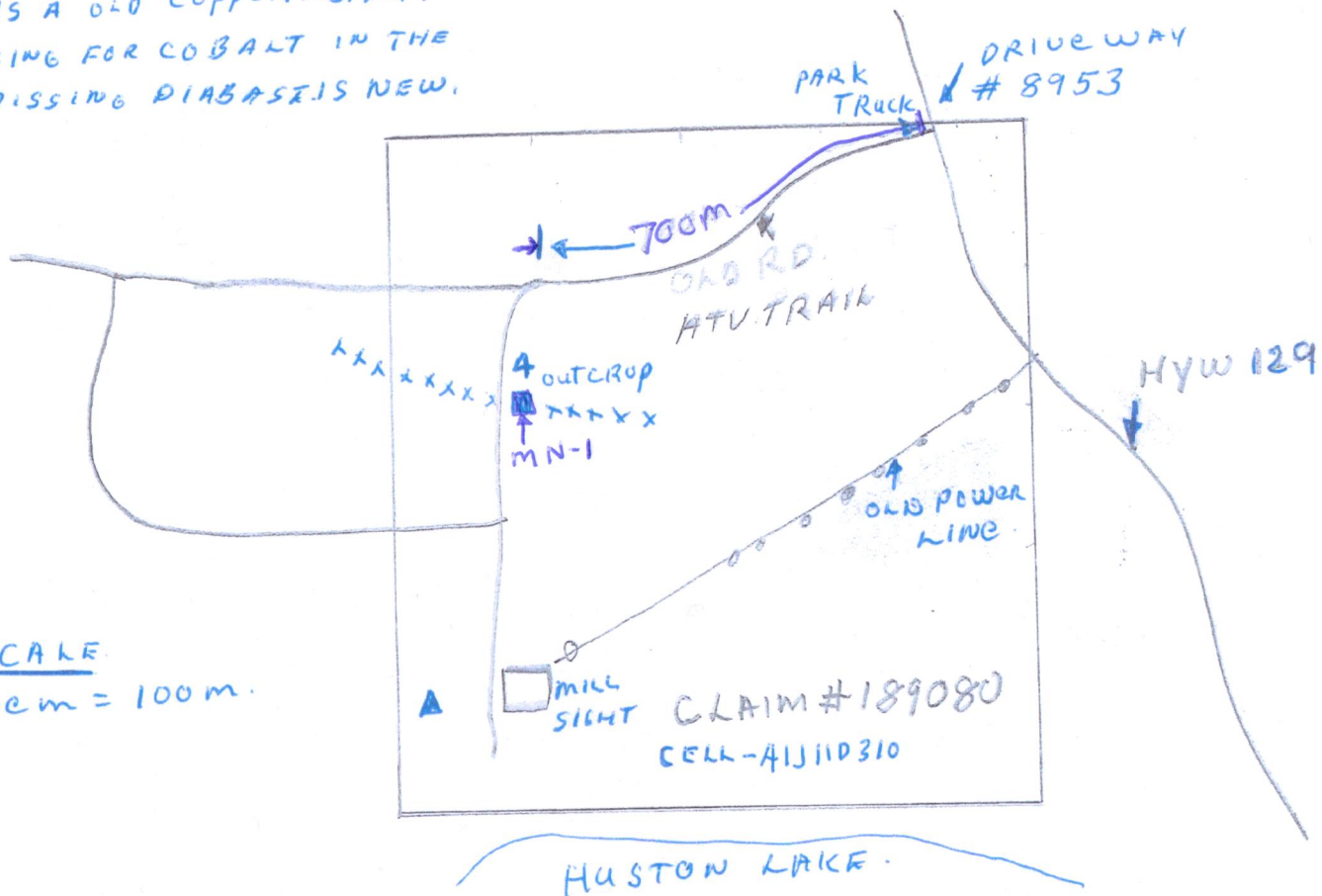

SCALE  
2-cm = 100m.



LEGEND	
<span style="display: inline-block; width: 10px; height: 10px; background-color: black; border: 1px solid black;"></span>	- SAMPLE LOCATION
<span style="display: inline-block; width: 10px; height: 10px; border: 1px solid black; background-color: white;"></span>	- OLD BODIT
<span style="display: inline-block; width: 10px; border-bottom: 1px solid black;"></span>	- ROAD
<span style="display: inline-block; width: 10px; border-bottom: 1px dashed black;"></span>	- POWER LINE
<span style="display: inline-block; width: 10px; height: 10px; border: 1px solid black; background-color: white;"></span>	- NIPPISSING DIABASE
<span style="display: inline-block; width: 10px; height: 10px; border: 1px solid black; background-color: white;"></span>	- TREND OF VIEW

SAMPLE NUMBER AND LOCATION	
MN-1	
UTM	313111.46 E 5154687.12 N

MAGNETIC DECLINATION  
USED: NIL

JAMES RALPH  
APRIL 4/2019



**Date Submitted:** 22-Jun-18  
**Invoice No.:** A18-08073  
**Invoice Date:** 12-Jul-18  
**Your Reference:**

**GEORGE LUCUIK  
30 CARLBERT ST  
SAULT STE MARIE ON P6A 5S5  
Canada**

**ATTN: GEORGE LUCUIK**

## CERTIFICATE OF ANALYSIS

2 Rock samples were submitted for analysis.

The following analytical package(s) were requested:

Code UT-1-0.5g Aqua Regia ICP/MS

Code UT-1M Aqua Regia ICP/MS

REPORT **A18-08073**

This report may be reproduced without our consent. If only selected portions of the report are reproduced, permission must be obtained. If no instructions were given at time of sample submittal regarding excess material, it will be discarded within 90 days of this report. Our liability is limited solely to the analytical cost of these analyses. Test results are representative only of material submitted for analysis.

Notes:

Assays are recommended for values above the upper limit. The Au from AR-MS is only semi-quantitative. For accurate Au data, fire assay is recommended.

Note: Au by this package is not reliable and you should have Au by Fire Assay done if you need accurate Au values.

CERTIFIED BY:

A handwritten signature in black ink, appearing to be "Emmanuel Esemé". The signature is stylized and somewhat cursive.

Emmanuel Esemé, Ph.D.  
Quality Control

**ACTIVATION LABORATORIES LTD.**  
41 Bittern Street, Ancaster, Ontario, Canada, L9G 4V5  
TELEPHONE +905 648-9611 or +1.888.228.5227 FAX +1.905.648.9613  
E-MAIL Ancaster@actlabs.com ACTLABS GROUP WEBSITE www.actlabs.com

Analyte Symbol	Ti	S	P	Li	Be	B	Na	Mg	Al	K	Bi	Ca	Sc	V	Cr	Mn	Fe	Co	Ni	Cu	Zn	Ga	Ge
Package Code	UT-1-0.5g	UT-1-0.5g	UT-1-0.5g	UT-1-0.5g	UT-1-0.5g	UT-1-0.5g	UT-1-0.5g	UT-1-0.5g	UT-1-0.5g	UT-1-0.5g	UT-1-0.5g	UT-1-0.5g	UT-1-0.5g	UT-1-0.5g	UT-1-0.5g	UT-1-0.5g	UT-1-0.5g	UT-1-0.5g	UT-1-0.5g	UT-1-0.5g	UT-1-0.5g	UT-1-0.5g	UT-1-0.5g
Detection limit	0.001	1	0.001	0.1	0.1	1	0.001	0.01	0.01	0.01	0.02	0.01	0.1	1	1	1	0.01	0.1	0.1	0.2	0.1	0.02	0.1
Unit Symbol	%	%	%	ppm	ppm	ppm	%	%	%	%	ppm	%	ppm	ppm	ppm	ppm	%	ppm	ppm	ppm	ppm	ppm	ppm
Analysis Method	AR-MS	AR-MS	AR-MS	AR-MS	AR-MS	AR-MS	AR-MS	AR-MS	AR-MS	AR-MS	AR-MS	AR-MS	AR-MS	AR-MS	AR-MS	AR-MS	AR-MS	AR-MS	AR-MS	AR-MS	AR-MS	AR-MS	AR-MS
MN-1	0.002	< 1	0.022	17.5	0.4	2	0.016	0.57	1.20	0.25	0.24	8.73	3.2	30	42	585	1.67	25.1	9.7	19.4	76.4	6.51	< 0.1
Bob 1																							

**Results**

**Activation Laboratories Ltd.**

**Report: A18-08073**

Analyte Symbol	As	Rb	Sr	Y	Zr	Nb	Mo	Ag	In	Sn	Sb	Te	Cs	Ba	La	Ce	Cd	Pr	Nd	Sm	Se	Eu	Gd
Package Code	UT-1-0.5g	UT-1-0.5g	UT-1-0.5g	UT-1-0.5g	UT-1-0.5g	UT-1-0.5g	UT-1-0.5g	UT-1-0.5g	UT-1-0.5g	UT-1-0.5g	UT-1-0.5g	UT-1-0.5g	UT-1-0.5g	UT-1-0.5g	UT-1-0.5g	UT-1-0.5g	UT-1-0.5g	UT-1-0.5g	UT-1-0.5g	UT-1-0.5g	UT-1-0.5g	UT-1-0.5g	UT-1-0.5g
Detection limit	0.1	0.1	0.5	0.01	0.1	0.1	0.01	0.002	0.02	0.05	0.02	0.02	0.02	0.5	0.5	0.01	0.01	0.1	0.02	0.1	0.1	0.1	0.1
Unit Symbol	ppm	ppm	ppm	ppm	ppm	ppm	ppm	ppm	ppm	ppm	ppm	ppm	ppm	ppm	ppm	ppm	ppm	ppm	ppm	ppm	ppm	ppm	ppm
Analysis Method	AR-MS	AR-MS	AR-MS	AR-MS	AR-MS	AR-MS	AR-MS	AR-MS	AR-MS	AR-MS	AR-MS	AR-MS	AR-MS	AR-MS	AR-MS	AR-MS	AR-MS	AR-MS	AR-MS	AR-MS	AR-MS	AR-MS	AR-MS
MN-1	0.6	16.8	43.1	5.57	4.4	< 0.1	0.22	0.030	< 0.02	0.35	< 0.02	< 0.02	2.12	24.9	14.5	27.2	0.14	2.6	10.3	1.3	< 0.1	0.5	1.5
Bob 1																							

Results

Activation Laboratories Ltd.

Report: A18-08073

Analyte Symbol	Tb	Dy	Ho	Er	Tm	Yb	Lu	Hf	Ta	W	Re	Au	Tl	Pb	Th	U	Hg	Ag	Al	As	Au	B	Ba
Package Code	UT-1-0.5g	UT-1-0.5g	UT-1-0.5g	UT-1-0.5g	UT-1-0.5g	UT-1-0.5g	UT-1-0.5g	UT-1-0.5g	UT-1-0.5g	UT-1-0.5g	UT-1-0.5g	UT-1-0.5g	UT-1-0.5g	UT-1-0.5g	UT-1-0.5g	UT-1-0.5g	UT-1-0.5g	UT-1M	UT-1M	UT-1M	UT-1M	UT-1M	UT-1M
Detection limit	0.1	0.1	0.1	0.1	0.1	0.1	0.1	0.1	0.05	0.1	0.001	0.5	0.02	0.1	0.1	0.1	10	0.1	0.01	0.5	0.5	20	0.5
Unit Symbol	ppm	ppm	ppm	ppm	ppm	ppm	ppm	ppm	ppm	ppm	ppm	ppb	ppm	ppm	ppm	ppm	ppb	ppm	%	ppm	ppb	ppm	ppm
Analysis Method	AR-MS	AR-MS	AR-MS	AR-MS	AR-MS	AR-MS	AR-MS	AR-MS	AR-MS	AR-MS	AR-MS	AR-MS	AR-MS	AR-MS	AR-MS	AR-MS	AR-MS	AR-MS	AR-MS	AR-MS	AR-MS	AR-MS	AR-MS
MN-1	0.2	1.0	0.2	0.5	< 0.1	0.5	< 0.1	< 0.1	< 0.05	< 0.1	< 0.001	8.3	< 0.02	2.1	1.7	0.5	100						
Bob 1																		< 0.1	2.17	5.7	5.9	< 20	33.1



**Results**

**Activation Laboratories Ltd.**

**Report: A18-08073**

Analyte Symbol	Bi	Ca	Cd	Co	Cr	Cu	Fe	Ga	Hg	K	La	Mg	Mn	Mo	Na	Ni	P	Pb	S	Sb	Sc	Se	Sr
Package Code	UT-1M	UT-1M	UT-1M	UT-1M	UT-1M	UT-1M	UT-1M	UT-1M	UT-1M	UT-1M	UT-1M	UT-1M	UT-1M	UT-1M	UT-1M	UT-1M	UT-1M	UT-1M	UT-1M	UT-1M	UT-1M	UT-1M	UT-1M
Detection limit	0.1	0.01	0.1	0.1	1	0.2	0.01	1	0.01	0.01	1	0.01	1	0.1	0.001	0.1	0.001	0.1	1	0.1	0.1	0.5	1
Unit Symbol	ppm	%	ppm	ppm	ppm	ppm	%	ppm	ppm	%	ppm	%	ppm	ppm	%	ppm	%	ppm	%	ppm	ppm	ppm	ppm
Analysis Method	AR-MS	AR-MS	AR-MS	AR-MS	AR-MS	AR-MS	AR-MS	AR-MS	AR-MS	AR-MS	AR-MS	AR-MS	AR-MS	AR-MS	AR-MS	AR-MS	AR-MS	AR-MS	AR-MS	AR-MS	AR-MS	AR-MS	AR-MS
MN-1																							
Bob 1	0.1	1.86	< 0.1	24.2	19	129	3.46	7	0.07	0.19	4	1.12	445	1.1	0.285	39.2	0.027	9.6	< 1	< 0.1	3.9	< 0.5	37

**Results****Activation Laboratories Ltd.****Report: A18-08073**

Analyte Symbol	Te	Th	Ti	Tl	V	W	Zn
Package Code	UT-1M	UT-1M	UT-1M	UT-1M	UT-1M	UT-1M	UT-1M
Detection limit	0.2	0.1	0.001	0.1	2	0.1	1
Unit Symbol	ppm	ppm	%	ppm	ppm	ppm	ppm
Analysis Method	AR-MS	AR-MS	AR-MS	AR-MS	AR-MS	AR-MS	AR-MS
MN-1							
Bob 1	< 0.2	1.4	0.236	< 0.1	97	0.2	59

Analyte Symbol	Ti	S	P	Li	Be	B	Na	Mg	Al	K	Bi	Ca	Sc	V	Cr	Mn	Fe	Co	Ni	Cu	Zn	Ga	Ge
Package Code	UT-1-0.5g	UT-1-0.5g	UT-1-0.5g	UT-1-0.5g	UT-1-0.5g	UT-1-0.5g	UT-1-0.5g	UT-1-0.5g	UT-1-0.5g	UT-1-0.5g	UT-1-0.5g	UT-1-0.5g	UT-1-0.5g	UT-1-0.5g	UT-1-0.5g	UT-1-0.5g	UT-1-0.5g	UT-1-0.5g	UT-1-0.5g	UT-1-0.5g	UT-1-0.5g	UT-1-0.5g	UT-1-0.5g
Detection limit	0.001	1	0.001	0.1	0.1	1	0.001	0.01	0.01	0.01	0.02	0.01	0.1	1	1	1	0.01	0.1	0.1	0.2	0.1	0.02	0.1
Unit Symbol	%	%	%	ppm	ppm	ppm	%	%	%	%	ppm	%	ppm	ppm	ppm	ppm	%	ppm	ppm	ppm	ppm	ppm	ppm
Analysis Method	AR-MS	AR-MS	AR-MS	AR-MS	AR-MS	AR-MS	AR-MS	AR-MS	AR-MS	AR-MS	AR-MS	AR-MS	AR-MS	AR-MS	AR-MS	AR-MS	AR-MS	AR-MS	AR-MS	AR-MS	AR-MS	AR-MS	AR-MS
GXR-4 Meas			0.125	8.6	1.4	< 1		1.58		1.97	20.4	0.84	7.0	74	60		3.14	15.3		6640	73.5	10.6	
GXR-4 Cert			0.120	11.1	1.90	4.50		1.66		4.01	19.0	1.01	7.70	87.0	64.0		3.09	14.6		6520	73.0	20.0	
GXR-4 Meas	0.134	2					0.134		3.02							149			40.4				
GXR-4 Cert	0.29	1.77					0.564		7.20							155			42.0				
OREAS 45d (Aqua Regia) Meas			0.032	14.6				0.17		0.14	0.24	0.08	50.4	185	518		14.1	27.8		352	36.1	17.2	
OREAS 45d (Aqua Regia) Cert			0.035	11.9				0.144		0.097	0.30	0.09	41.50	201.0	467		13.650	26.2		345.0	30.6	17.9	
OREAS 45d (Aqua Regia) Meas		< 1					0.042		6.05							428			219				
OREAS 45d (Aqua Regia) Cert		0.045					0.031		4.860							400.000			176.0				
Bob 1 Orig	0.232	< 1					0.282		2.13							439			38.6				
Bob 1 Dup	0.240	< 1					0.289		2.22							451			39.7				
Method Blank			0.002	< 0.1	< 0.1	< 1		< 0.01		< 0.01	0.19	< 0.01	< 0.1	< 1	< 1		< 0.01	< 0.1		< 0.2	< 0.1	< 0.02	0.1
Method Blank	< 0.001	< 1					0.012		< 0.01							< 1			< 0.1				

Analyte Symbol	As	Rb	Sr	Y	Zr	Nb	Mo	Ag	In	Sn	Sb	Te	Cs	Ba	La	Ce	Cd	Pr	Nd	Sm	Se	Eu	Gd
Package Code	UT-1-0.5g	UT-1-0.5g	UT-1-0.5g	UT-1-0.5g	UT-1-0.5g	UT-1-0.5g	UT-1-0.5g	UT-1-0.5g	UT-1-0.5g	UT-1-0.5g	UT-1-0.5g	UT-1-0.5g	UT-1-0.5g	UT-1-0.5g	UT-1-0.5g	UT-1-0.5g	UT-1-0.5g	UT-1-0.5g	UT-1-0.5g	UT-1-0.5g	UT-1-0.5g	UT-1-0.5g	UT-1-0.5g
Detection limit	0.1	0.1	0.5	0.01	0.1	0.1	0.01	0.002	0.02	0.05	0.02	0.02	0.02	0.5	0.5	0.01	0.01	0.1	0.02	0.1	0.1	0.1	0.1
Unit Symbol	ppm	ppm	ppm	ppm	ppm	ppm	ppm	ppm	ppm	ppm	ppm	ppm	ppm	ppm	ppm	ppm	ppm	ppm	ppm	ppm	ppm	ppm	ppm
Analysis Method	AR-MS	AR-MS	AR-MS	AR-MS	AR-MS	AR-MS	AR-MS	AR-MS	AR-MS	AR-MS	AR-MS	AR-MS	AR-MS	AR-MS	AR-MS	AR-MS	AR-MS	AR-MS	AR-MS	AR-MS	AR-MS	AR-MS	AR-MS
GXR-4 Meas	98.3	103	79.2	11.4	10.6	0.2	342	3.56	0.19	5.46	3.30	0.79	2.43		48.6	96.4	0.06		38.1	5.5	4.9	1.2	4.1
GXR-4 Cert	98.0	160	221	14.0	186	10.0	310	4.00	0.270	5.60	4.80	0.970	2.80		64.5	102	0.860		45.0	6.60	5.60	1.63	5.25
GXR-4 Meas														27.0									
GXR-4 Cert														1640									
OREAS 45d (Aqua Regia) Meas	4.5	26.9	13.8	4.49					0.07	1.82					11.1	25.2							
OREAS 45d (Aqua Regia) Cert	6.50	20.9	11.0	5.08					0.085	1.950					9.960	24.8							
OREAS 45d (Aqua Regia) Meas														89.8									
OREAS 45d (Aqua Regia) Cert														80									
Bob 1 Orig														32.4									
Bob 1 Dup														33.8									
Method Blank	0.1	< 0.1	< 0.5	< 0.01	0.4	< 0.1	0.09	< 0.002	< 0.02	< 0.05	< 0.02	< 0.02	< 0.02		< 0.5	< 0.01	< 0.01	< 0.1	< 0.02	< 0.1	< 0.1	< 0.1	< 0.1
Method Blank														7.3									

Analyte Symbol	Tb	Dy	Ho	Er	Tm	Yb	Lu	Hf	Ta	W	Re	Au	Tl	Pb	Th	U	Hg	Ag	Al	As	Au	B	Ba
Package Code	UT-1-0.5g	UT-1-0.5g	UT-1-0.5g	UT-1-0.5g	UT-1-0.5g	UT-1-0.5g	UT-1-0.5g	UT-1-0.5g	UT-1-0.5g	UT-1-0.5g	UT-1-0.5g	UT-1-0.5g	UT-1-0.5g	UT-1-0.5g	UT-1-0.5g	UT-1-0.5g	UT-1-0.5g	UT-1M	UT-1M	UT-1M	UT-1M	UT-1M	UT-1M
Detection limit	0.1	0.1	0.1	0.1	0.1	0.1	0.1	0.1	0.05	0.1	0.001	0.5	0.02	0.1	0.1	0.1	10	0.1	0.01	0.5	0.5	20	0.5
Unit Symbol	ppm	ppm	ppm	ppm	ppm	ppm	ppm	ppm	ppm	ppm	ppm	ppb	ppm	ppm	ppm	ppm	ppb	ppm	%	ppm	ppb	ppm	ppm
Analysis Method	AR-MS	AR-MS	AR-MS	AR-MS	AR-MS	AR-MS	AR-MS	AR-MS	AR-MS	AR-MS	AR-MS	AR-MS	AR-MS	AR-MS	AR-MS	AR-MS	AR-MS	AR-MS	AR-MS	AR-MS	AR-MS	AR-MS	AR-MS
GXR-4 Meas	0.4	2.4			0.1	0.8	0.1	0.3	< 0.05			627	2.51	45.8	18.2	4.8	80	3.6		98.3	627	< 20	
GXR-4 Cert	0.360	2.60			0.210	1.60	0.170	6.30	0.790			470	3.20	52.0	22.5	6.20	110	4.0		98.0	470	4.50	
GXR-4 Meas										13.3									3.02				27.0
GXR-4 Cert										30.8									7.20				1640
OREAS 45d (Aqua Regia) Meas												20.3		16.8	10.7	1.5				4.5	20.3		
OREAS 45d (Aqua Regia) Cert												21		17.00	11.3	1.64				6.50	21		
OREAS 45d (Aqua Regia) Meas																			6.05				89.8
OREAS 45d (Aqua Regia) Cert																			4.860				80
Bob 1 Orig										0.2								< 0.1	2.13	5.9	10.0	< 20	32.4
Bob 1 Dup										0.2								< 0.1	2.22	5.5	1.9	< 20	33.8
Method Blank	< 0.1	< 0.1	< 0.1	< 0.1	< 0.1	< 0.1	< 0.1	< 0.1	< 0.05		< 0.001	< 0.5	< 0.02	< 0.1	< 0.1	< 0.1	30	< 0.1		< 0.5	< 0.5	< 20	
Method Blank										< 0.1									< 0.01				7.3

Analyte Symbol	Bi	Ca	Cd	Co	Cr	Cu	Fe	Ga	Hg	K	La	Mg	Mn	Mo	Na	Ni	P	Pb	S	Sb	Sc	Se	Sr
Package Code	UT-1M	UT-1M	UT-1M	UT-1M	UT-1M	UT-1M	UT-1M	UT-1M	UT-1M	UT-1M	UT-1M	UT-1M	UT-1M	UT-1M	UT-1M	UT-1M	UT-1M	UT-1M	UT-1M	UT-1M	UT-1M	UT-1M	UT-1M
Detection limit	0.1	0.01	0.1	0.1	1	0.2	0.01	1	0.01	0.01	1	0.01	1	0.1	0.001	0.1	0.001	0.1	1	0.1	0.1	0.5	1
Unit Symbol	ppm	%	ppm	ppm	ppm	ppm	%	ppm	ppm	%	ppm	%	ppm	ppm	%	ppm	%	ppm	%	ppm	ppm	ppm	ppm
Analysis Method	AR-MS	AR-MS	AR-MS	AR-MS	AR-MS	AR-MS	AR-MS	AR-MS	AR-MS	AR-MS	AR-MS	AR-MS	AR-MS	AR-MS	AR-MS	AR-MS	AR-MS	AR-MS	AR-MS	AR-MS	AR-MS	AR-MS	AR-MS
GXR-4 Meas	20.4	0.84	< 0.1	15.3	60	6640	3.14	11	0.08	1.97	49	1.58		342			0.125	45.8		3.3	7.0	4.9	79
GXR-4 Cert	19.0	1.01	0.860	14.6	64.0	6520	3.09	20.0	0.110	4.01	64.5	1.66		310			0.120	52.0		4.80	7.70	5.60	221
GXR-4 Meas													149		0.134	40.4			2				
GXR-4 Cert													155		0.564	42.0			1.77				
OREAS 45d (Aqua Regia) Meas	0.2	0.08		27.8	518	352	14.1	17		0.14	11	0.17					0.032	16.8			50.4		14
OREAS 45d (Aqua Regia) Cert	0.30	0.09		26.2	467	345.0	13.650	17.9		0.097	9.960	0.144					0.035	17.00			41.50		11.0
OREAS 45d (Aqua Regia) Meas													428		0.042	219			< 1				
OREAS 45d (Aqua Regia) Cert													400.000		0.031	176.0			0.045				
Bob 1 Orig	0.1	1.84	< 0.1	24.3	19	130	3.46	7	0.08	0.19	4	1.09	439	1.0	0.282	38.6	0.027	9.7	< 1	< 0.1	3.9	< 0.5	37
Bob 1 Dup	0.1	1.87	< 0.1	24.1	19	128	3.45	7	0.07	0.20	4	1.15	451	1.1	0.289	39.7	0.027	9.6	< 1	< 0.1	4.0	< 0.5	36
Method Blank	0.2	< 0.01	< 0.1	< 0.1	< 1	< 0.2	< 0.01	< 1	0.03	< 0.01	< 1	< 0.01		< 0.1			0.002	< 0.1		< 0.1	< 0.1	< 0.5	< 1
Method Blank													< 1		0.012	< 0.1			< 1				

Analyte Symbol	Te	Th	Ti	Tl	V	W	Zn
Package Code	UT-1M	UT-1M	UT-1M	UT-1M	UT-1M	UT-1M	UT-1M
Detection limit	0.2	0.1	0.001	0.1	2	0.1	1
Unit Symbol	ppm	ppm	%	ppm	ppm	ppm	ppm
Analysis Method	AR-MS	AR-MS	AR-MS	AR-MS	AR-MS	AR-MS	AR-MS
GXR-4 Meas	0.8	18.2		2.5	74		73
GXR-4 Cert	0.970	22.5		3.20	87.0		73.0
GXR-4 Meas			0.134			13.3	
GXR-4 Cert			0.29			30.8	
OREAS 45d (Aqua Regia) Meas		10.7			185		36
OREAS 45d (Aqua Regia) Cert		11.3			201.0		30.6
OREAS 45d (Aqua Regia) Meas							
OREAS 45d (Aqua Regia) Cert							
Bob 1 Orig	< 0.2	1.4	0.232	< 0.1	96	0.2	57
Bob 1 Dup	< 0.2	1.4	0.240	< 0.1	97	0.2	62
Method Blank	< 0.2	< 0.1		< 0.1	< 2		< 1
Method Blank			< 0.001			< 0.1	

**Final Report**  
**Activation Laboratories**

Report Number: A18-08073

Report Date: 12/7/2018

Analyte Symbol	Ti	S	P	Li	Be
Package Code	UT-1-0.5g	UT-1-0.5g	UT-1-0.5g	UT-1-0.5g	UT-1-0.5g
Detection limit	0.001	1	0.001	0.1	0.1
Unit Symbol	%	%	%	ppm	ppm
Analysis Method	AR-MS	AR-MS	AR-MS	AR-MS	AR-MS
MN-1	0.002	< 1	0.022	17.5	0.4
Bob 1					



**Final Report**  
**Activation Laboratories**

Report Number: A18-08073

Report Date: 12/7/2018

Analyte Symbol	B	Na	Mg	Al	K
Package Code	UT-1-0.5g	UT-1-0.5g	UT-1-0.5g	UT-1-0.5g	UT-1-0.5g
Detection limit	1	0.001	0.01	0.01	0.01
Unit Symbol	ppm	%	%	%	%
Analysis Method	AR-MS	AR-MS	AR-MS	AR-MS	AR-MS
MN-1	2	0.016	0.57	1.2	0.25
Bob 1					

**Final Report**  
**Activation Laboratories**

Report Number: A18-08073

Report Date: 12/7/2018

Analyte Symbol	Bi	Ca	Sc	V	Cr
Package Code	UT-1-0.5g	UT-1-0.5g	UT-1-0.5g	UT-1-0.5g	UT-1-0.5g
Detection limit	0.02	0.01	0.1	1	1
Unit Symbol	ppm	%	ppm	ppm	ppm
Analysis Method	AR-MS	AR-MS	AR-MS	AR-MS	AR-MS
MN-1	0.24	8.73	3.2	30	42
Bob 1					

**Final Report**  
**Activation Laboratories**

Report Number: A18-08073

Report Date: 12/7/2018

Analyte Symbol	Mn	Fe	Co	Ni	Cu
Package Code	UT-1-0.5g	UT-1-0.5g	UT-1-0.5g	UT-1-0.5g	UT-1-0.5g
Detection limit	1	0.01	0.1	0.1	0.2
Unit Symbol	ppm	%	ppm	ppm	ppm
Analysis Method	AR-MS	AR-MS	AR-MS	AR-MS	AR-MS
MN-1	585	1.67	25.1	9.7	19.4
Bob 1					

**Final Report**  
**Activation Laboratories**

Report Number: A18-08073

Report Date: 12/7/2018

Analyte Symbol	Zn	Ga	Ge	As	Rb
Package Code	UT-1-0.5g	UT-1-0.5g	UT-1-0.5g	UT-1-0.5g	UT-1-0.5g
Detection limit	0.1	0.02	0.1	0.1	0.1
Unit Symbol	ppm	ppm	ppm	ppm	ppm
Analysis Method	AR-MS	AR-MS	AR-MS	AR-MS	AR-MS
MN-1	76.4	6.51	< 0.1	0.6	16.8
Bob 1					

**Final Report**  
**Activation Laboratories**

Report Number: A18-08073

Report Date: 12/7/2018

Analyte Symbol	Sr	Y	Zr	Nb	Mo
Package Code	UT-1-0.5g	UT-1-0.5g	UT-1-0.5g	UT-1-0.5g	UT-1-0.5g
Detection limit	0.5	0.01	0.1	0.1	0.01
Unit Symbol	ppm	ppm	ppm	ppm	ppm
Analysis Method	AR-MS	AR-MS	AR-MS	AR-MS	AR-MS
MN-1	43.1	5.57	4.4	< 0.1	0.22
Bob 1					

**Final Report**  
**Activation Laboratories**

Report Number: A18-08073

Report Date: 12/7/2018

Analyte Symbol	Ag	In	Sn	Sb	Te
Package Code	UT-1-0.5g	UT-1-0.5g	UT-1-0.5g	UT-1-0.5g	UT-1-0.5g
Detection limit	0.002	0.02	0.05	0.02	0.02
Unit Symbol	ppm	ppm	ppm	ppm	ppm
Analysis Method	AR-MS	AR-MS	AR-MS	AR-MS	AR-MS
MN-1	0.03	< 0.02	0.35	< 0.02	< 0.02
Bob 1					

**Final Report**  
**Activation Laboratories**

Report Number: A18-08073

Report Date: 12/7/2018

Analyte Symbol	Cs	Ba	La	Ce	Cd
Package Code	UT-1-0.5g	UT-1-0.5g	UT-1-0.5g	UT-1-0.5g	UT-1-0.5g
Detection limit	0.02	0.5	0.5	0.01	0.01
Unit Symbol	ppm	ppm	ppm	ppm	ppm
Analysis Method	AR-MS	AR-MS	AR-MS	AR-MS	AR-MS
MN-1	2.12	24.9	14.5	27.2	0.14
Bob 1					

**Final Report**  
**Activation Laboratories**

Report Number: A18-08073

Report Date: 12/7/2018

Analyte Symbol	Pr	Nd	Sm	Se	Eu
Package Code	UT-1-0.5g	UT-1-0.5g	UT-1-0.5g	UT-1-0.5g	UT-1-0.5g
Detection limit	0.1	0.02	0.1	0.1	0.1
Unit Symbol	ppm	ppm	ppm	ppm	ppm
Analysis Method	AR-MS	AR-MS	AR-MS	AR-MS	AR-MS
MN-1	2.6	10.3	1.3	< 0.1	0.5
Bob 1					



**Final Report**  
**Activation Laboratories**

Report Number: A18-08073

Report Date: 12/7/2018

Analyte Symbol	Gd	Tb	Dy	Ho	Er
Package Code	UT-1-0.5g	UT-1-0.5g	UT-1-0.5g	UT-1-0.5g	UT-1-0.5g
Detection limit	0.1	0.1	0.1	0.1	0.1
Unit Symbol	ppm	ppm	ppm	ppm	ppm
Analysis Method	AR-MS	AR-MS	AR-MS	AR-MS	AR-MS
MN-1	1.5	0.2	1	0.2	0.5
Bob 1					

**Final Report**  
**Activation Laboratories**

Report Number: A18-08073

Report Date: 12/7/2018

Analyte Symbol	Tm	Yb	Lu	Hf	Ta
Package Code	UT-1-0.5g	UT-1-0.5g	UT-1-0.5g	UT-1-0.5g	UT-1-0.5g
Detection limit	0.1	0.1	0.1	0.1	0.05
Unit Symbol	ppm	ppm	ppm	ppm	ppm
Analysis Method	AR-MS	AR-MS	AR-MS	AR-MS	AR-MS
MN-1	< 0.1	0.5	< 0.1	< 0.1	< 0.05
Bob 1					

**Final Report**  
**Activation Laboratories**

Report Number: A18-08073

Report Date: 12/7/2018

Analyte Symbol	W	Re	Au	Tl	Pb
Package Code	UT-1-0.5g	UT-1-0.5g	UT-1-0.5g	UT-1-0.5g	UT-1-0.5g
Detection limit	0.1	0.001	0.5	0.02	0.1
Unit Symbol	ppm	ppm	ppb	ppm	ppm
Analysis Method	AR-MS	AR-MS	AR-MS	AR-MS	AR-MS
MN-1	< 0.1	< 0.001	8.3	< 0.02	2.1
Bob 1					

**Final Report**  
**Activation Laboratories**

Report Number: A18-08073

Report Date: 12/7/2018

Analyte Symbol	Th	U	Hg	Ag	Al
Package Code	UT-1-0.5g	UT-1-0.5g	UT-1-0.5g	UT-1M	UT-1M
Detection limit	0.1	0.1	10	0.1	0.01
Unit Symbol	ppm	ppm	ppb	ppm	%
Analysis Method	AR-MS	AR-MS	AR-MS	AR-MS	AR-MS
MN-1	1.7	0.5	100		
Bob 1				< 0.1	2.17

**Final Report**  
**Activation Laboratories**

Report Number: A18-08073

Report Date: 12/7/2018

Analyte Symbol	As	Au	B	Ba	Bi
Package Code	UT-1M	UT-1M	UT-1M	UT-1M	UT-1M
Detection limit	0.5	0.5	20	0.5	0.1
Unit Symbol	ppm	ppb	ppm	ppm	ppm
Analysis Method	AR-MS	AR-MS	AR-MS	AR-MS	AR-MS
MN-1					
Bob 1	5.7	5.9	< 20	33.1	0.1

**Final Report**  
**Activation Laboratories**

Report Number: A18-08073

Report Date: 12/7/2018

Analyte Symbol	Ca	Cd	Co	Cr	Cu
Package Code	UT-1M	UT-1M	UT-1M	UT-1M	UT-1M
Detection limit	0.01	0.1	0.1	1	0.2
Unit Symbol	%	ppm	ppm	ppm	ppm
Analysis Method	AR-MS	AR-MS	AR-MS	AR-MS	AR-MS
MN-1					
Bob 1	1.86	< 0.1	24.2	19	129

**Final Report**  
**Activation Laboratories**

Report Number: A18-08073

Report Date: 12/7/2018

Analyte Symbol	Fe	Ga	Hg	K	La
Package Code	UT-1M	UT-1M	UT-1M	UT-1M	UT-1M
Detection limit	0.01	1	0.01	0.01	1
Unit Symbol	%	ppm	ppm	%	ppm
Analysis Method	AR-MS	AR-MS	AR-MS	AR-MS	AR-MS
MN-1					
Bob 1	3.46	7	0.07	0.19	4

**Final Report**  
**Activation Laboratories**

Report Number: A18-08073

Report Date: 12/7/2018

Analyte Symbol	Mg	Mn	Mo	Na	Ni
Package Code	UT-1M	UT-1M	UT-1M	UT-1M	UT-1M
Detection limit	0.01	1	0.1	0.001	0.1
Unit Symbol	%	ppm	ppm	%	ppm
Analysis Method	AR-MS	AR-MS	AR-MS	AR-MS	AR-MS
MN-1					
Bob 1	1.12	445	1.1	0.285	39.2



**Final Report**  
**Activation Laboratories**

Report Number: A18-08073

Report Date: 12/7/2018

Analyte Symbol	P	Pb	S	Sb	Sc
Package Code	UT-1M	UT-1M	UT-1M	UT-1M	UT-1M
Detection limit	0.001	0.1	1	0.1	0.1
Unit Symbol	%	ppm	%	ppm	ppm
Analysis Method	AR-MS	AR-MS	AR-MS	AR-MS	AR-MS
MN-1					
Bob 1	0.027	9.6	< 1	< 0.1	3.9

**Final Report**  
**Activation Laboratories**

Report Number: A18-08073

Report Date: 12/7/2018

Analyte Symbol	Se	Sr	Te	Th	Ti
Package Code	UT-1M	UT-1M	UT-1M	UT-1M	UT-1M
Detection limit	0.5	1	0.2	0.1	0.001
Unit Symbol	ppm	ppm	ppm	ppm	%
Analysis Method	AR-MS	AR-MS	AR-MS	AR-MS	AR-MS
MN-1					
Bob 1	< 0.5	37	< 0.2	1.4	0.236

**Final Report**  
**Activation Laboratories**

Report Number: A18-08073

Report Date: 12/7/2018

Analyte Symbol	Tl	V	W	Zn
Package Code	UT-1M	UT-1M	UT-1M	UT-1M
Detection limit	0.1	2	0.1	1
Unit Symbol	ppm	ppm	ppm	ppm
Analysis Method	AR-MS	AR-MS	AR-MS	AR-MS
MN-1				
Bob 1	< 0.1	97	0.2	59