

We are committed to providing [accessible customer service](#).

If you need accessible formats or communications supports, please [contact us](#).

Nous tenons à améliorer [l'accessibilité des services à la clientèle](#).

Si vous avez besoin de formats accessibles ou d'aide à la communication, veuillez [nous contacter](#).

Assessment Report

Peter Pomialowski

February 16, 2021

Grass Roots Prospecting

Red Lake Mining Division

Township of Ear Falls

Camping Lake Area

Mining Claims:

Claim ID : 555469

52K11K185

52K11K186

Prepared By: Peter Pomialowski B. Comm. and Dave Feeney

Ontario Prospector's Number: 2000297

Expiry Date: 2023-10-19

Client Number: 10001149

Location and Access:

The mining claims 52K11K185 and 52K11K186 in Northwestern Ontario are addressed from Winnipeg, Manitoba using Trans-Canada Highway 1 and 17 to the town of Vermillion Bay, and then north on Highway 105 to the town of Ear Falls. The claims are approximately 11 kilometers northwest of Ear Falls, Ontario.

The majority of the property is covered by second growth forest. New vegetation is dominated by pine, spruce, and fir with lesser amounts of birch, poplar, and alder. Low regions are saturated forming spruce bogs and swamps. East of Highway 105 are hydro powerlines and west is a natural gas pipeline.

The mining claims were accessed via Highway 105. A Garmin GPSMAP 64 was used to locate the coordinates on Highway 105 that runs through claims 52K11K185 and 52K11K186. Coordinates of each corner of the claims were also input into the Garmin GPS.

Grassroots Prospecting:

Start at first coordinate R05 on Highway 105 and proceed east to coordinate D11 and marked the southeast corner of claim 52K11K186.

There were a number of rock boulders that were exposed off Highway 105 on the cleared pathway of the hydro powerline. It appears that there is bedrock beneath the boulders and this will be examined on the next trip.





Next, we drove northwest on Highway 105 to coordinate R07. We then walked west across the hydro powerline pathway to D22 and marked the northeast corner of claim 52K11K185. The area was covered by heavy bush and undergrowth. The next trip we will follow the natural gas pipeline pathway that runs through claim 52K11K185.



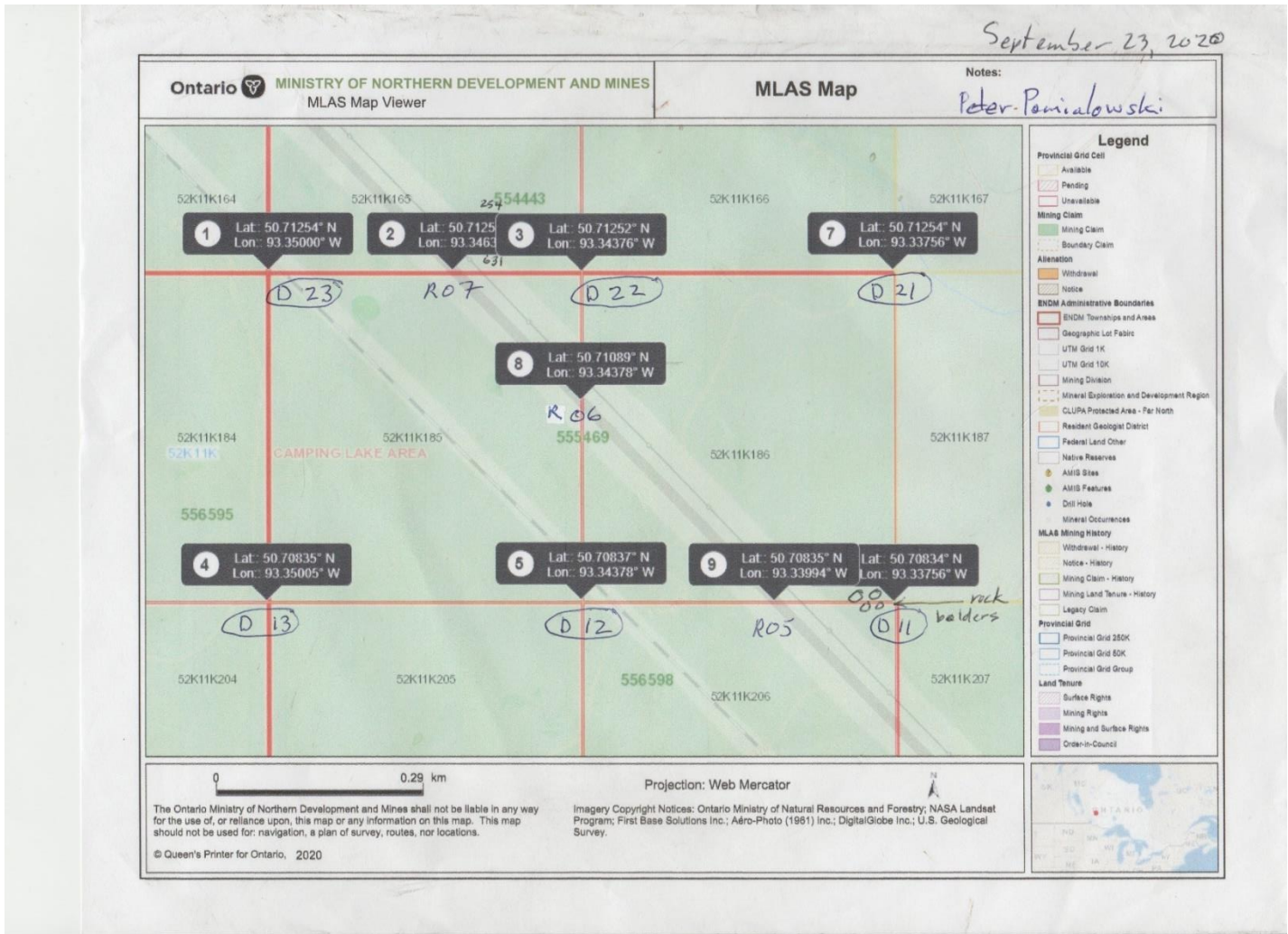

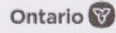

MINISTRY OF ENERGY, NORTHERN DEVELOPMENT AND MINES
MLAS Map Viewer

MLAS Map

Notes: Peter Pomialowski
September 23, 2020
Grassroot Prospecting Route → → →

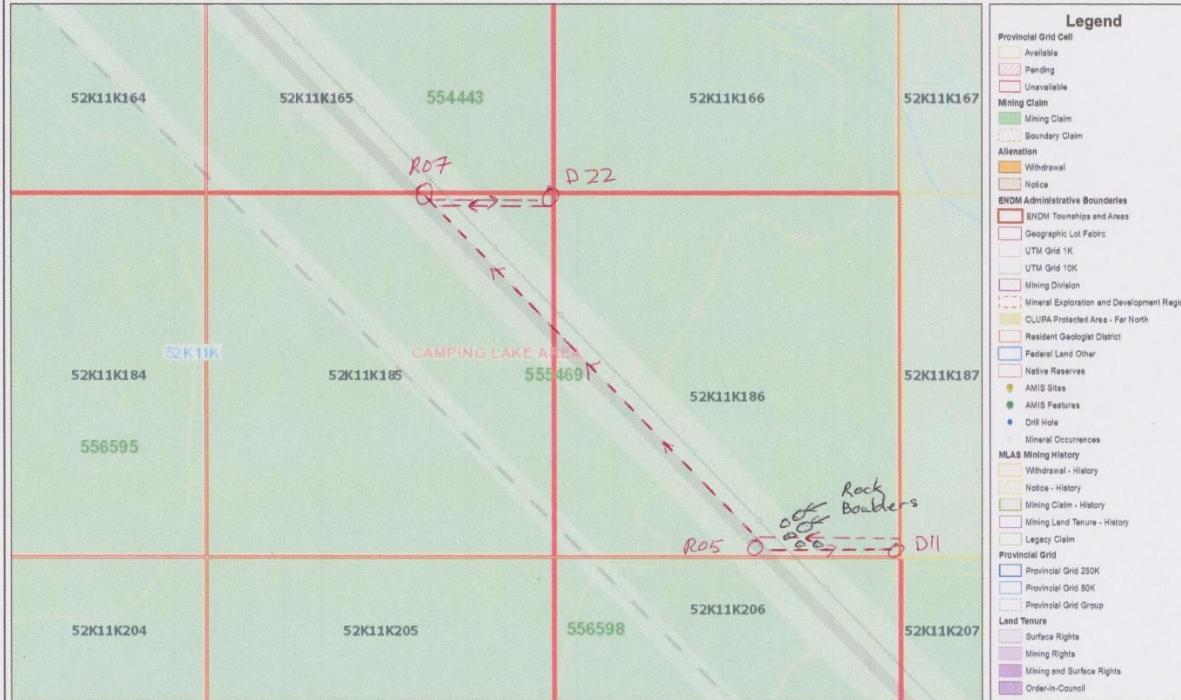

Those wishing to register mining claims should consult with the Provincial Mining Recorders' Office of the Ministry of Energy, Northern Development and Mines for additional information on the status of the lands shown hereon. This map is not intended for navigational, survey, or land title determination purposes as the information shown on this map is compiled from various sources. Completeness and accuracy are not guaranteed. Additional information may also be obtained through the local Land Titles or Registry Office, or the Ministry of Natural Resources and Forestry. The information shown is derived from digital data available in the Provincial Mining Recorders' Office at the time of downloading from the Ministry of Energy, Northern Development and Mines web site.

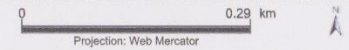

Projection: Web Mercator
Imagery Copyright Notices: Ontario Ministry of Natural Resources and Forestry;
NASA Landsat Program; First Base Solutions Inc.; Aéro-Photo (1961) Inc.;
DigitalGlobe Inc.; U.S. Geological Survey.
© Queen's Printer for Ontario, 2021



Grassroots Prospecting Route:

Daily Log for Grassroots Prospecting:

Conclusion:

The 2 claims 52K11K185 and 52K11K186 are covered by heavy overburden with the exception of the cleared pathway for the hydro powerline to the east and the pathway for the natural gas pipeline to the west. On the southern edge of claim 52K11K186 are large rock boulders on the exposed pathway of the hydro powerline.

On the next trip we will obtain rock samples of the boulders and investigate if there is bedrock below the boulders. A geologist may come with us on our next prospecting trip.

Towards the west of the mining claims and west of Highway 105, a natural gas pipeline runs through both claims and should provide more accessibility for exploration and this is to be followed up on our next trip.

From the southeast corner of claim 52K11K186 where the rock boulders are located and travelling in a southeast direction along Highway 105 and the cleared hydro powerline, a mineral occurrence was noted on the MLAS Map. This occurrence is 2.64 kilometers from claim 52K11K186 and the proximity of this occurrence justifies further exploration on this property. We will also research the previous Laurentian Goldfields Ltd. Report of July 2013 to further assess the possibility of mineral occurrences in this location.

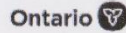

Legend

- Provincial Grid Cell**
 - Available
 - Pending
 - Unavailable
- Mining Claim**
 - Mining Claim
 - Boundary Claim
- Alienation**
 - Withdrawal
 - Notice
- BNDM Administrative Boundaries**
 - BNDM Townships and Areas
 - Geographic Lot Fabric
 - UTM Grid 1K
 - UTM Grid 10K
 - Mining Division
 - Mineral Exploration and Development Region
 - CLUPA Protected Area - Far North
 - Resident Geological District
 - Federal Land Other
 - Native Reserves
 - AMIS Sites
 - AMIS Features
 - Drill Hole
 - Mineral Occurrences
- MLAS Mining History**
 - Withdrawal - History
 - Notice - History
 - Mining Claim - History
 - Mining Land Tenure - History
 - Legacy Claim
- Provincial Grid**
 - Provincial Grid 250K
 - Provincial Grid 50K
 - Provincial Grid Group
- Land Tenure**
 - Surface Rights
 - Mining Rights
 - Mining and Surface Rights
 - Order-in-Council

Those wishing to register mining claims should consult with the Provincial Mining Recorders' Office of the Ministry of Energy, Northern Development and Mines for additional information on the status of the lands shown hereon. This map is not intended for navigational, survey, or land title determination purposes as the information shown on this map is compiled from various sources. Completeness and accuracy are not guaranteed. Additional information may also be obtained through the local Land Titles or Registry Office, or the Ministry of Natural Resources and Forestry. The information shown is derived from digital data available in the Provincial Mining Recorders' Office at the time of downloading from the Ministry of Energy, Northern Development and Mines web site.

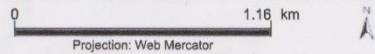

Imagery Copyright Notices: Ontario Ministry of Natural Resources and Forestry; NASA Landsat Program; First Base Solutions Inc.; Aéro-Photo (1961) Inc.; DigitalGlobe Inc.; U.S. Geological Survey.
© Queen's Printer for Ontario, 2021



Cost for Assessment:

Date	Sweat Equity	Time	Amount	Description
2020-09-13	\$350.00	1 day/1 person	\$350.00	Download maps, input map coordinates into Garmin GPSMAP 64, Set location alarms
2020-09-22	\$350.00	1 day/2 people	\$700.00	Travel time from Ontario border to Ear Fall ON for Peter Pomialowski and Dave Feeney.
2020-09-22			\$41.99	Food
2020-09-22			\$79.10	Lodging
2020-09-23			\$9.65	Food
2019-09-23	\$350.00	1 day/2 people	\$700.00	Grassroots prospecting for Peter Pomialowski and Dave Feeney.
2020-09-25	\$350.00	1 day/2 people	\$700.00	Travel time from Ear Falls ON to Manitoba border for Peter Pomialowski and Dave Feeney.
2020-09-25			\$102.83	Fuel cost
2020-09-25			\$9.99	Food
2021-01-22	\$350.00	4	<u>\$350.00</u>	Compile data and complete report
Total			\$3,043.56	