

We are committed to providing [accessible customer service](#).

If you need accessible formats or communications supports, please [contact us](#).

Nous tenons à améliorer [l'accessibilité des services à la clientèle](#).

Si vous avez besoin de formats accessibles ou d'aide à la communication, veuillez [nous contacter](#).

PROSPECTING REPORT
on
GEOLOGICAL MAPPING AND LITHOGEOCHEMICAL
SAMPLING

LITTLE PIC RIVER PROPERTY

THUNDER BAY MINING DIVISION

DISTRICT OF THUNDER BAY, ONTARIO

NTS 42D/15SW



Marathon, Ontario
December 12, 2018

Rudolf Wahl, Prospector
Marathon, Ontario

Table of Contents

	Page
1.0 INTRODUCTION	1
2.0 LOCATION AND ACCESS	1
Property Description	1
Prospecting Dates - Breakdown	2
Key Location map	3
Claim Location map	4
3.0 REGIONAL GEOLOGY	5-6
4.0 PROSPECTING / GEOLOGICAL MAPPING	7
5.0 WORK CONDUCTED ON THE PROPERTY	7
5.1 WORK COMPLETED	7
6.0 RESULTS AND CONCLUSION	8
6.1 RECOMMENDATIONS	8

Appendices

Appendix I	Sample locations / UTM NAD 83
Appendix II	Rock sample Description
Appendix III	Assay Results
Appendix IV	Little Pic River Cost & Receipts

Map 1 - Geology - Travers - Sample location, scale 1:5000

Map 2 - Claim map

1.0 Introduction

From July 02, 2018 to July 18, 2018 general prospecting, hand stripping, geological mapping and rock sampling was conducted on the Little PIC River property. We prospected the Little PIC River property to find and outline mineralization with emphasis on prospecting in order to locate Kimberlite - Lamproite and Gold minerals on the property.

2.0 LOCATION AND ACCESS

The Little PIC River property consist of 50 contiguous unpatented mining cell claim blocks, located approximately 30 kilometers west of Marathon and 2 km north of Hwy. 17. The property is readily accessible from Trans- Canada Highway 17. A trail/road cut part of the Property in the western and north western section of the property. The terrain on the cell claim blocks is very rugged with steep hills. Some areas are only accessible by Helicopter.

2.1 PROPERTY DESCRIPTION

The PIC River property consists of 50 unpatented contiguous mining cell claim blocks recorded in good standing in Thunder Bay Mining Division within the Grain Twp. G-0628 .

Cell Claim Numbers:

112147, 125355, 305392, 174350, 319459, 293259, 285151, 134774, 302776, 198976, 239277, 150734, 290632, 150735, 122765, 335981, 169851, 137336, 321886, 256006, 293261, 159865, 219188, 305393, 341014, 179989, 137338, 193876, 193877, 241039, 179988, 215979, 290633, 277747, 153244, 277749, 125356, 125357, 277748, 112148, 134775, 186768, 125354, 285150, 137337, 249095, 174351, 293260, 159864, 122764

Prospecting dates Work Breakdown:

July 02, 2018 to July 06, 2018 prospecting on cell claims 186768, 302776, 179989

We used our 4wheelers into the property from hwy. 17 on old 4wheeler trails (old logging roads). We prospected, hand stripped and geological mapped along traverse line to locate rock outcrop within the area. Most of the area is covered by sand and glacial till what makes prospecting very difficult and time consuming since we done a lot of hand digging in the overburden to locate bedrock to take rock samples with mineralization in regards to the gold and kimberlite potential on the property.

July 09, 2018 to July 13, 2018 prospecting on cell claims 290633, 150735, 319459

We used our 4wheelers into the property from hwy. 17 on old 4wheeler trails (old logging roads). We prospected, hand stripped and geological mapped along traverse line to locate rock outcrop within the area. Most of the area is covered by sand and glacial till what makes prospecting very difficult and time consuming since we done a lot of hand digging in the overburden to locate bedrock to take rock samples with mineralization in regards to the gold and kimberlite potential on the property.

July 16, 2018 to July 18, 2018 prospecting on cell claims 290633, 150735, 293260

We used our 4wheelers into the property from hwy. 17 on old 4wheeler trails. Cell claim 293260 is not accessible by 4wheeler or by foot, so we used a helicopter to fly us into that cell claim area, the helicopter picked us up from cell claim area 290633. We prospected, hand stripped and geological mapped along traverse line to locate rock outcrop within the area. Most of the area is covered by sand and glacial till what makes prospecting very difficult and time consuming since we done a lot of hand digging in the overburden to locate bedrock to take rock samples with mineralization in regards to the gold and kimberlite potential on the property. We found an area with brecciated material that looks like lamproite – lamprophyre, we took one 37.39 kg rock sample rock sample and send out for diamond fusion to Micolithics Laboratories Inc in Thunder Bay.

Little PIC River Property Key Location Map



Little Pic River Property
Claim Map
Grain Twp. G-0628

Prospecting Area 2018

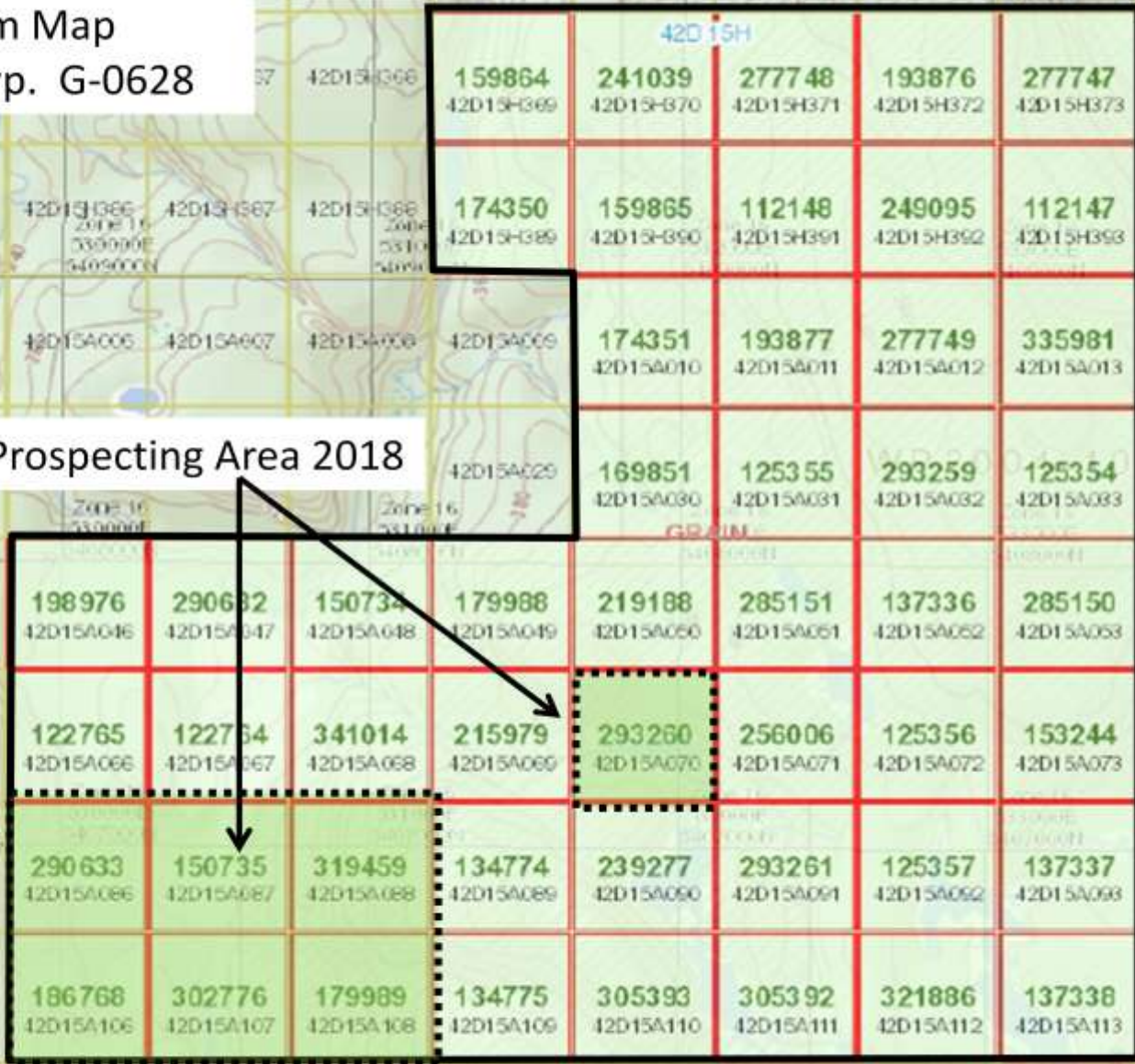

The mineral potential of the Marathon area is considered high, based on the increased global demand for mineral resources together with extensive exploration activity within the Proterozoic Coldwell Alkaline Complex (Coldwell Complex) and surrounding Archean Hemlo/Schreiber greenstone belts.

Most of the recent mineral exploration in the Coldwell Complex has focused on Cu-PGM+/-Au deposits hosted in the peripheral gabbro ring of the Coldwell Complex. Gabbroic rocks occur continuously for over 20 km along the eastern and northern margins of the Coldwell Complex. Additionally, smaller portions of gabbro occur within the central Coldwell Complex and discontinuously along the southwestern margin (Good and Crocket 1994). Occurrences of rare metal (Nb, U, Zr, Th, and rare earth elements), building stone, industrial minerals and semigemstones occur within the syenitic rocks throughout the Coldwell Complex (Walker et al. 1993). Marathon PGM Corporation (Marathon PGM) and Benton Resources Corporation (Benton) have significant mineral exploration projects along the eastern and northeastern margin of the Coldwell Complex. Exploration companies actively exploring the Archean metavolcanic rocks immediately surrounding the Coldwell Complex include: (i) Pelangio Mines Incorporated; (ii) Benton Resources Incorporated; (iii) Phoenix Matachewan Mines Limited; and (iv) MetalCORP Limited. Additionally, local prospectors have key properties for option within the Coldwell Complex and in the surrounding greenstone belts.

Marathon PGM has the most advanced Cu-PGM+Au project within the Coldwell Complex. Mineralization occurs in the Two Duck Lake Gabbro, located on the eastern margin of the Coldwell Complex. In 2007, the company completed a drill program consisting of 180 holes for a total of 40,000 m (News Release, Marathon PGM Corporation, October 24, 2007). New results from a fence of drill holes (M-07-403, 405, 406, 410, & 417) collared outside the western margin of the existing resource intersected wide intervals of mineralization, up to 120 m, grading 0.97 g/t PGM+Au & 0.35% Cu (ibid). Marathon PGM is moving forward with a feasibility study and expects the results from the 2007 drilling will significantly increase the current mineral resource. An updated resource estimate is expected in November 2007. The current reported measured and indicated resource estimates, completed in early 2007, by P&E Mining Consultants Incorporated reported a Measured Resource of 39.2 million tonnes containing 1.6 million ounces of PGM+Au and 285 million pounds of copper and Indicated Resource of 28.9 million tonnes containing 1.1 million ounces of PGM+Au and 178 million pounds of copper (NI 43-101compliant). Benton's Bermuda property is situated on the northwest strike extension of the Marathon PGM deposit. To date, Benton has completed 66 diamond drill holes, covering a strike length of 15 km. Benton's 2007 exploration activity of 11 diamond drill holes totalling approximately 6000 m out of a 10 000 m diamond drill program have been completed. Highlights from recent drilling in the Bamooos Lake area, approximately 100 m north of the Marathon PGM project, returned assays from drill holes BO-07-48 and BO-07-54 grading up 1.91 g/t PGM, 0.31% Cu over 33 m and 2.19 g/t PGM, 0.31% Cu over 23.5m respectively (News Release, Benton Resources Corporation, September 10, 2007). Benton is anticipating an additional 10 000 m of diamond drilling for the Sally Lake and Area 41 targets, situated 14 km north west of the Bamooos Zone. In the central portion of the Coldwell

Complex, the Geordie Lake palladium-copper property currently owned by L.E.H. Ventures Incorporated (LEH) reported a resource from four mineralized zones within the Geordie Lake gabbro. Independent consultants for LEH; Giroux and Stanley (2002) estimated an indicated resource of 24.4 million tonnes averaging 0.326% Cu, 0.537 g Pd/t, 0.007% Co, 0.011% Ni, 0.030 g Pt/t, 2.52 g Ag/t and 0.04 g Au/t and an additional 5.4 million tonnes of Inferred material at an average grade of 0.36% Cu, 0.626 g Pd/t, 0.007% Co, 0.012% Ni, 0.04 g Pt/t, 3.04 g Ag/t and 0.05 g Au/t (NI 43-101 compliant). E.C. Walker et al (1993) in an Open File Report 5868, *Precambrian Geology of the Coldwell Alkalic Complex*, reported several other Cu-PGE occurrences hosted by gabbro occur in the central and western portion of the Coldwell Complex. The Willie Lake occurrence located in the northern central portion of the Coldwell Complex returned grades up to 1.42% Cu over 6 m, reported from 1962-63 drilling by Head of the Lakes Iron Mine Ltd. (p.3). Along the western margin of the **Coldwell** Complex, grab samples collected by Walker's field crew returned copper grades up to 0.70% (1993, p.4). Additionally, Walker reported four types of rare metal (Nb, U, Zr, Th, and rare earth elements) occurrences are found in pegmatite's associated with amphibole syenite. Building stone (syenite) has been sporadically extracted for over 100 years. Nepheline, an industrial mineral, has been explored during the 1950s to 1970s in three locations within the Coldwell Complex: Red Sucker Cove, Port Coldwell and Pic Island. Other notable rare metal and rare earth element occurrences are the Dead Horse Creek and McKellar Diatremes, located within the western metamorphic-contact-aureole of the Coldwell Complex (Sage, 1982, 1991, 1995). Smyk et al. 1993 reported assays ranging up to 11.6% Zr, 0.6% Be, 2.5% Th, 250 ppm Sc, 1850 ppm Y, 300 ppm Nb, 903 to 1004 ppm HREE and 4600ppm U (ibid).

REFERENCES

Benton Resources Corporation - News Release, September 10, 2007

http://www.bentonresources.ca/s/NewsReleases.asp?ReportID=207546&_Type=News-Releases&_Title=BENTON-INTERCEPTS-WIDE-ZONES-OF-PGMs-AND-COPPER-ON-BERMUDA-PROPERTY-NORTH-O...

Giroux G. H., Stanley A.D. 2002. A Resource Estimate on the Geordie Lake Palladium-Copper Property in Northern Ontario, 108p. L.E.H. Ventures Incorporated (LEH)

<http://www.lehventures.com/i/pdf/GirouxGeordieRptFeb22-02.pdf>

Good D.J., Crocket J.H. 1994. Genesis of the Marathon Cu-Platinum-Group Element Deposit, Port Coldwell Alkalic Complex, Ontario: A Midcontinent rift-related magmata sulfide deposit, Volume 89, p131-149.

Marathon PGM Corporation - News Release, October 24, 2007

<http://www.marathonpgm.com/pdf/241007.pdf>

Sage R.P., Watkinson D.H. 1995. Alkalic Rocks of the Midcontinent Rift, Institute on Lake Superior Geology, 41st Annual Meeting, May 13-18, 1995, Marathon, Ontario; Proceedings Volume 41: Part 2a Field Trip guidebook, 74p.

Walker, E.C., Sutcliffe R.H., Shaw C.S.J., Shore G.T., and Penzk R.S. 1993. Precambrian Geology of the Coldwell Alkalic Complex, Ontario Geological Survey, Open File Report 5868, 30p.

4.0 Prospecting / Geological Mapping

Most of the Little PIC River property where geologically mapped and prospected / sampled with emphasis on prospecting in order to locate significant mineralization - Kimberlite – Lamproite and Gold minerals on the property.

5.0 Work conducted on the Little PIC River property.

The Little PIC River property consists of 50 unpatented contiguous mining cell claim blocks recorded in good standing in Thunder Bay Mining Division within the Grain Twp. G-0628 .

Cell Claim Numbers

112147, 125355, 305392, 174350, 319459, 293259, 285151, 134774, 302776, 198976, 239277, 150734, 290632, 150735, 122765, 335981, 169851, 137336, 321886, 256006, 293261, 159865, 219188, 305393, 341014, 179989, 137338, 193876, 193877, 241039, 179988, 215979, 290633, 277747, 153244, 277749, 125356, 125357, 277748, 112148, 134775, 186768, 125354, 285150, 137337, 249095, 174351, 293260, 159864, 122764

Work was conducted on claim Numbers:

290633, 150735, 319459, 186768, 302776, 179989, 293260

TOTAL 7 units

5.1 Work completed

- a. Geological mapping on traverse lines.
- b. Rock sampling over mineralized out crops along traverse lines.
- c. Rock sample where collected by UTM: ZONE 16 NAD 83 locations.
- d. All sample where taking with a Geo tool.
- e. A total of 16 rock sample where obtained and 15 rock samples were sent out for Au assay.

- One 37.39 kg rock sample rock sample taken and send out for diamond fusion
- f. Topographic features (trail, lakes, creeks) were also used to control mapping and prospecting.

6.0 Results and Conclusion

15 Rock samples sample were collected from the Little PIC River property for Au assay. No significant results were obtained from the rock samples in regards to Au potential.

The Terrain on the cell claim blocks 290633, 150735, 319459, 186768,302776, 179989, is very rugged which makes prospecting very difficult and time consuming. We had to use a Helicopter to access the cell claim block 293260 to check some of potential kimberlite targets.

Part of the PIC River Property was covered by a high resolution helicopter airborne magnetic and electromagnetic geophysical survey as part of the Ontario Geological Survey, Treasure Hunt program. This survey outlined a number of circular anomalies which look similar to the signature of kimberlite pipes. We investigated some of the circular anomalies and found an area with brecciated material what looks like lamproite – lamprophyre, we took one 37.39 kg rock sample RW-016 and send it out for diamond fusion to Micolithics Laboratories Inc in Thunder Bay, the sample didn't return any diamonds.

6.1 RECOMMENDATIONS

Further prospecting is warranted within the property, because of the favorable stratigraphy on the property in regards to the Kimberlite – Lamproite potential. We located an unusual diamondiferous lamprophyre dyke with over 60 macro and 8 commercial sized diamonds about 5 km north of the Little PIC River property in 2008.

In December 2011 we discovered a Para-Lamproite on the Prairie Lake property that had micro diamonds - G10, G9, G3 garnets, the Prairie Lake property is about 18 km to the northwest of the Little PIC River property. It is recommended to conduct a kimberlite indicator mineral till sample program over the property to better define kimberlite targets on the property.

**Marathon, Ontario
December 12, 2018**

Respectfully submitted



**Rudolf Wahl
Prospector**

Appendix I

Little Pic River Property
 Sample Location Map
 x = sample location
 - - Travers Lines
 Grain Twp. G-0628

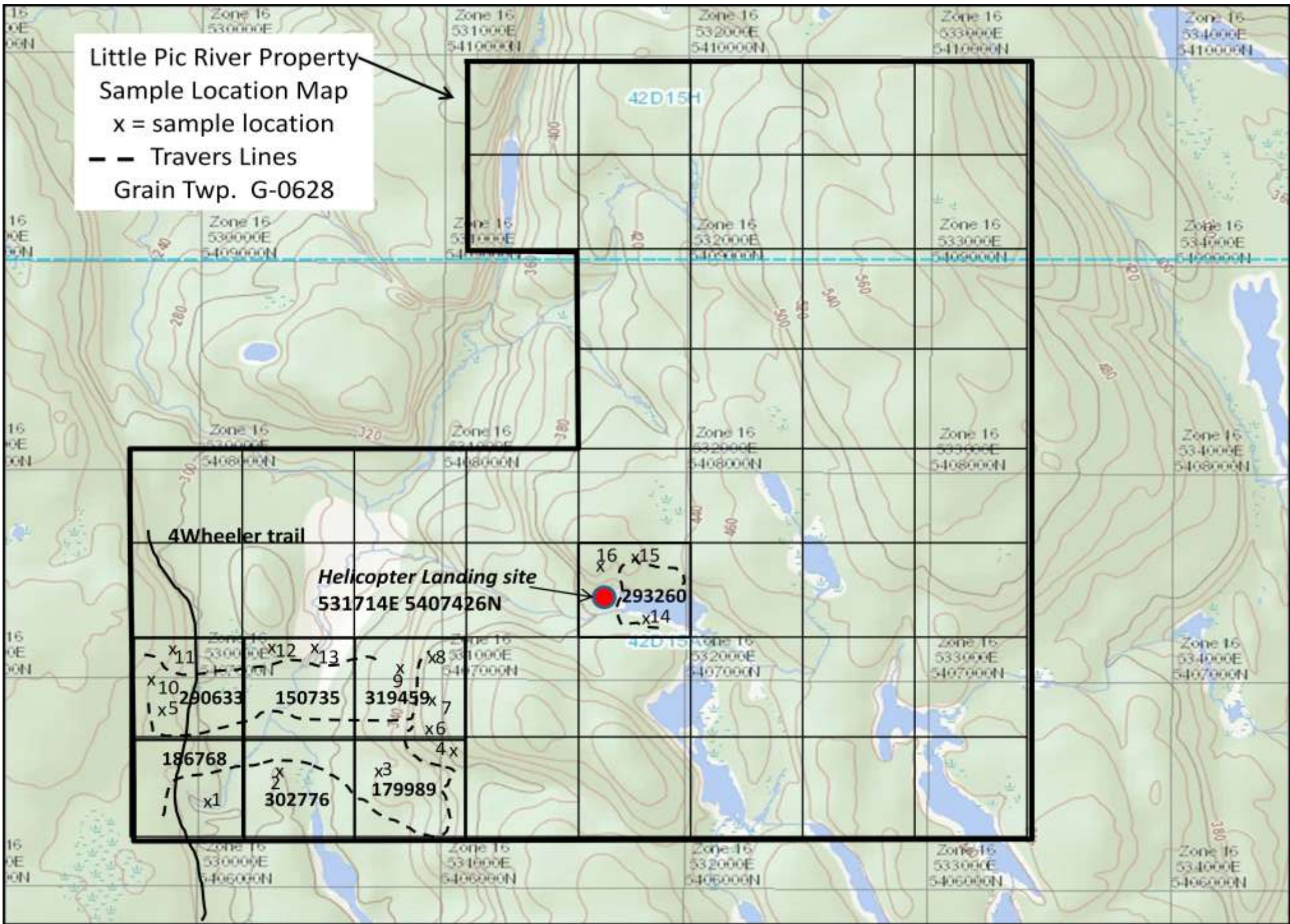

Little PIC River Property Sample Location, UTM 16 NAD 83

<i>Sample Location #</i>	<i>Sample #</i>	<i>Easting</i>	<i>Northing</i>
1	582087	530036	5406380
2	582088	530331	5406538
3	582089	530735	5406468
4	582090	531027	5406674
5	582091	529964	5406822
6	582092	530957	5406746
7	582093	530966	5406884
8	582094	530791	5407056
9	582095	530736	5406908
10	582096	529932	5406976
11	582097	529947	5407136
12	582098	530306	5407160
13	582099	540457	5407111
14	582100	531906	5407263
15	582101	531816	5407536
16	RW-016	531756	5407495

Appendix II

DESCRIPTION OF ROCK SAMPLES
(See Geological map for sample location)

<i>Sample Location #</i>	<i>Sample #</i>	<i>Rock Sample Description</i>
1	582087	quartz veining in syenite 1.5 % sulphide, light carbon staining
2	582088	quartz veining in syenite 0.5% sulphide
3	582089	quartz vein ½ m in width in syenite, light carbon staining, 2% sulphide
4	582090	syenite quartz breccia, light carbon, 1% sulphide
5	582091	nepheline syenite, light carbon, 1% sulphide
6	582092	nepheline syenite, 1 m quartz vein, 1% sulphide
7	582093	tight quartz veining in nepheline syenite, 2% sulphide
8	582094	rusty quartz veining in syenite unit, 1% sulphide
9	582095	fine grained syenite with quartz veining ½ % sulphide
10	582096	rusty quartz veining in synite, 1% sulphide,
11	582097	syenite, light magnetic, small quartz veining 1 % sulphide
12	582098	syenite unit with small quartz veining, 1% sulphide
13	582099	syenite , light carbon, 1% sulphide
14	582100	quartz veining in syenite 1.5 % sulphide, light carbon staining
15	582101	quartz vein ½ m in width in syenite, light carbon staining, 2% sulphide
16	RW-016	lamproite – lamprophyre dyke ?

Appendix III



Date Submitted: 20-Jul-18
Invoice No.: A18-09456
Invoice Date: 07-Aug-18
Your Reference:

Wahls Prospecting
Box 1022
Marathon ON P072E0
Canada

ATTN: Rudy Wahl

CERTIFICATE OF ANALYSIS

51 Rock samples were submitted for analysis.

The following analytical package(s) were requested: Code 1A2-Tbay Au - Fire Assay AA (QOP Fire Assay Tbay)

REPORT A18-09456

This report may be reproduced without our consent. If only selected portions of the report are reproduced, permission must be obtained. If no instructions were given at time of sample submittal regarding excess material, it will be discarded within 90 days of this report. Our liability is limited solely to the analytical cost of these analyses. Test results are representative only of material submitted for analysis.

Notes:

If value exceeds upper limit we recommend reassay by fire assay gravimetric-Code 1A3

CERTIFIED BY:

A handwritten signature in black ink, appearing to be "Emmanuel Esemé". The signature is written in a cursive style with some loops and flourishes.

Emmanuel Esemé, Ph.D.
Quality Control

ACTIVATION LABORATORIES LTD.
1201 Walsh Street West, Thunder Bay, Ontario, Canada, P7E 4X6
TELEPHONE +907 622-6707 or +1.888.228.5227 FAX +1.905.648.9613
E-MAIL Tbay@actlabs.com ACTLABS GROUP WEBSITE www.actlabs.com

Analyte Symbol	Au
Unit Symbol	ppb
Lower Limit	5
Method Code	FA-AA
582051	
582052	
582053	
582054	
582055	
582056	
582057	
582058	
582059	
582060	
582061	
582062	
582063	
582064	
582065	
582066	
582067	
582068	
582069	
582070	
582071	
582072	
582073	
582074	
582075	
582076	
582077	
582078	
582079	
582080	
582081	
582082	
582083	
582084	
582085	
582086	
582087	< 5
582088	< 5
582089	< 5
582090	< 5
582091	< 5
582092	< 5

Analyte Symbol	Au
Unit Symbol	ppb
Lower Limit	5
Method Code	FA-AA
582093	< 5
582094	6
582095	< 5
582096	< 5
582097	< 5
582098	< 5
582099	< 5
582100	< 5
582101	6

Microlithics Laboratories Inc.

18-RW-CF001



827 Harold Cres
Thunder Bay, Ontario
P7C 5H8

(807) 623-3383

SOLD TO:
Rudy Wahl

INVOICE NUMBER	18-RW-CF001
INVOICE DATE	August 21, 2018
TERMS	Net 30 days

QUANTITY	DESCRIPTION		UNIT PRICE	AMOUNT
LITTLE PIC RIVER SAMPLE NUMBER RW-016				
6	Initial	Initial Burn - Kiln Charge	325.00	\$ 1,950.00
127.5	Initial	Initial Burn - NaOH (kg)	3.71	\$ 473.03
382.5	Initial	Initial Burn - Acid (kg)	1.42	\$ 543.15
39.7	Initial	Initial Burn - Nitrate (kg)	4.76	\$ 188.97
1.0	Reburn	Reburn - Kiln Charge	325.00	\$ 325.00
3.0	Reburn	Reburn - NaOH (kg)	3.71	\$ 11.13
9.0	Reburn	Reburn - Acid (kg)	1.42	\$ 12.78
1.0	Micro	Microfusion charge	80.00	\$ 80.00
2.0	Peroxide	Peroxide charge	80.00	\$ 160.00
69.2	Peroxide	Peroxide - Sodium Peroxide (g)	2.45	\$ 169.54
0.0	Shipment	Shipping Fee	115.00	\$ -
4.0	Observation	Hours observing concentrate	60.00	\$ 240.00
1 Sample - 37.385 kg Total				
LITTLE PIC RIVER SAMPLE NUMBER RW-016 37.39 kg wet material / \$111.09 per kg 60 Synthetics Spikes Inserted and Recovered (30 * 0.150 to 0.212 mm, 30 * 0.300 to 0.355 mm) No diamonds recovered from sample.				
			SUBTOTAL	4,153.60
G.S.T. Registered Number 89236 8804			TAX H.S.T	539.97
See Attached Statements/Receipts for Shipping details			FREIGHT	
Freight G.S.T.			Freight H.S.T.	

DIRECT ALL INQUIRIES TO:
Jeff Barrett
Chris Berner
(807) 623-3383
info@microlithics.com

Please Make Cheques Payable to:
Microlithics Laboratories Inc.
827 Harold Cres
Thunder Bay, ON P7C 5H8

\$4,693.56 Please Pay this AMOUNT
--





**APPENDIX IV: TABULATED PROGRAM COSTS – LITTLE PIC RIVER 2018
PROSPECTING PROGRAM**

<u>Description or Cost/Unit</u>	<u>Cost (CDN\$)</u>	
<u>Geochemistry</u>		
Activation Laboratories	15 samples	\$ 338.00
Microolithics Lab Diamond fusion	1 sample	\$4,693.00
<u>Personnel</u>		
Rudolf Wahl CLN 206079		
Prospecting July02 to July 18, 2018	13 days @ \$500/day	\$6,500.00
Two 4wheeler rental	13 days @ \$140/day	\$1,820.00
Mileage	13 days @ 70km/day/\$0.50/km	\$ 455.00
Helicopter transport	1 hour @ \$2,350/hour	\$2,350.00
Meals	13 days @\$30.00/day	\$ 390.00
Michael Wesley CLN 1013690		
Prospecting July02 to July 18, 2018	13 days @ \$500/day	\$6,500.00
Meals	13 days @\$30.00/day	\$ 390.00
TOTAL		\$23,436.00

DISTRIBUTION OF EXPENDITURES BY CLAIM

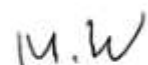
Mining Claim Number	Number of Claim Units	Amount of Work Performed on this Claim (\$)
290633	1	2,537.60
150735	1	2,515.08
179989	1	2,515.08
186768	1	1,257.54
293260	1	8,323.00
302776	1	2,492.54
319459	1	3,795.16
Total	7	\$23,436.00

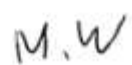
Little Pic River Property Assessment Work Breakdown

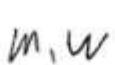
<u>Type of Work</u>	<u>Name & Address</u>	<u>Dates Worked</u>	<u>Days = 8 to 10 hours</u>	<u>Signature</u>
Prospecting , Geological mapping along Travers line. Rock sampling, Hand stripping to bedrock	Rudolf Wahl Box 1022 Marathon, Ontario POT 2E0 <u>CLN # 206079</u>	July 02, 2018 To July 06, 2018	5	
Prospecting , Geological mapping along Travers line. Rock sampling, Hand stripping to bedrock	Michael Wesley Box 1887 Marathon, Ontario POT 2E0 <u>CLN#1013690</u>	July 02, 2018 To July 06, 2018, 2018	5	
Prospecting , Geological mapping along Travers line. Rock sampling, Hand stripping to bedrock	Rudolf Wahl Box 1022 Marathon, Ontario POT 2E0 <u>CLN # 206079</u>	July 09, 2018 To July 13, 2018,	5	
Prospecting , Geological mapping along Travers line. Rock sampling, Hand stripping to bedrock	Michael Wesley Box 1887 Marathon, Ontario POT 2E0 <u>CLN#1013690</u>	July 09, 2018 To July 13, 2018,	5	
Prospecting , Geological mapping along Travers line. Rock sampling, Hand stripping to bedrock	Rudolf Wahl Box 1022 Marathon, Ontario POT 2E0 <u>CLN # 206079</u>	July 16, 2018 To July 18, 2018,	3	
Prospecting , Geological mapping along Travers line. Rock sampling, Hand stripping to bedrock	Michael Wesley Box 1887 Marathon, Ontario POT 2E0 <u>CLN#1013690</u>	July 16, 2018 To July 18, 2018,	3	
Total Days Page 1			26	

A total of 26 days in between July 02, 2018 and July18, 2018 where used for prospecting - geological mapping and rock sampling on the Little Pic River property.

Dated Sept 12 2018, Marathon, Ont.

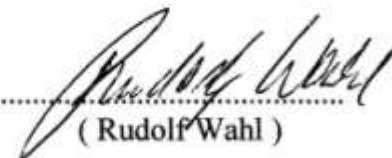
Signed 
(Rudolf Wahl)

Dated Sept 11 2018, Marathon, Ont.

Signed 
(Michael Wesley)

Prospecting dates Work Breakdown:

July 02, 2018 to July 06, 2018 prospecting on cell claims 186768, 302776, 179989

We used our 4wheelers into the property from hwy. 17 on old 4wheeler trails (old logging roads). We prospected, hand stripped and geological mapped along traverse line to locate rock outcrop within the area. Most of the area is covered by sand and glacial till what makes prospecting very difficult and time consuming since we done a lot of hand digging in the overburden to locate bedrock to take rock samples with mineralization in regards to the gold and kimberlite potential on the property.

July 09, 2018 to July 13, 2018 prospecting on cell claims 290633, 150735, 319459

We used our 4wheelers into the property from hwy. 17 on old 4wheeler trails (old logging roads). We prospected, hand stripped and geological mapped along traverse line to locate rock outcrop within the area. Most of the area is covered by sand and glacial till what makes prospecting very difficult and time consuming since we done a lot of hand digging in the overburden to locate bedrock to take rock samples with mineralization in regards to the gold and kimberlite potential on the property.

July 16, 2018 to July 18, 2018 prospecting on cell claims 290633, 150735, 293260

We used our 4wheelers into the property from hwy. 17 on old 4wheeler trails. Cell claim 293260 is not accessible by 4wheeler or by foot, so we used a helicopter to fly us into that cell claim area, the helicopter picked us up from cell claim area 290633. We prospected, hand stripped and geological mapped along traverse line to locate rock outcrop within the area. Most of the area is covered by sand and glacial till what makes prospecting very difficult and time consuming since we done a lot of hand digging in the overburden to locate bedrock to take rock samples with mineralization in regards to the gold and kimberlite potential on the property. We found an area with brecciated material that looks like lamproite – lamprophyre, we took One 37.39 kg rock sample rock sample and send out for diamond fusion to Micolithics Laboratories Inc in Thunder Bay

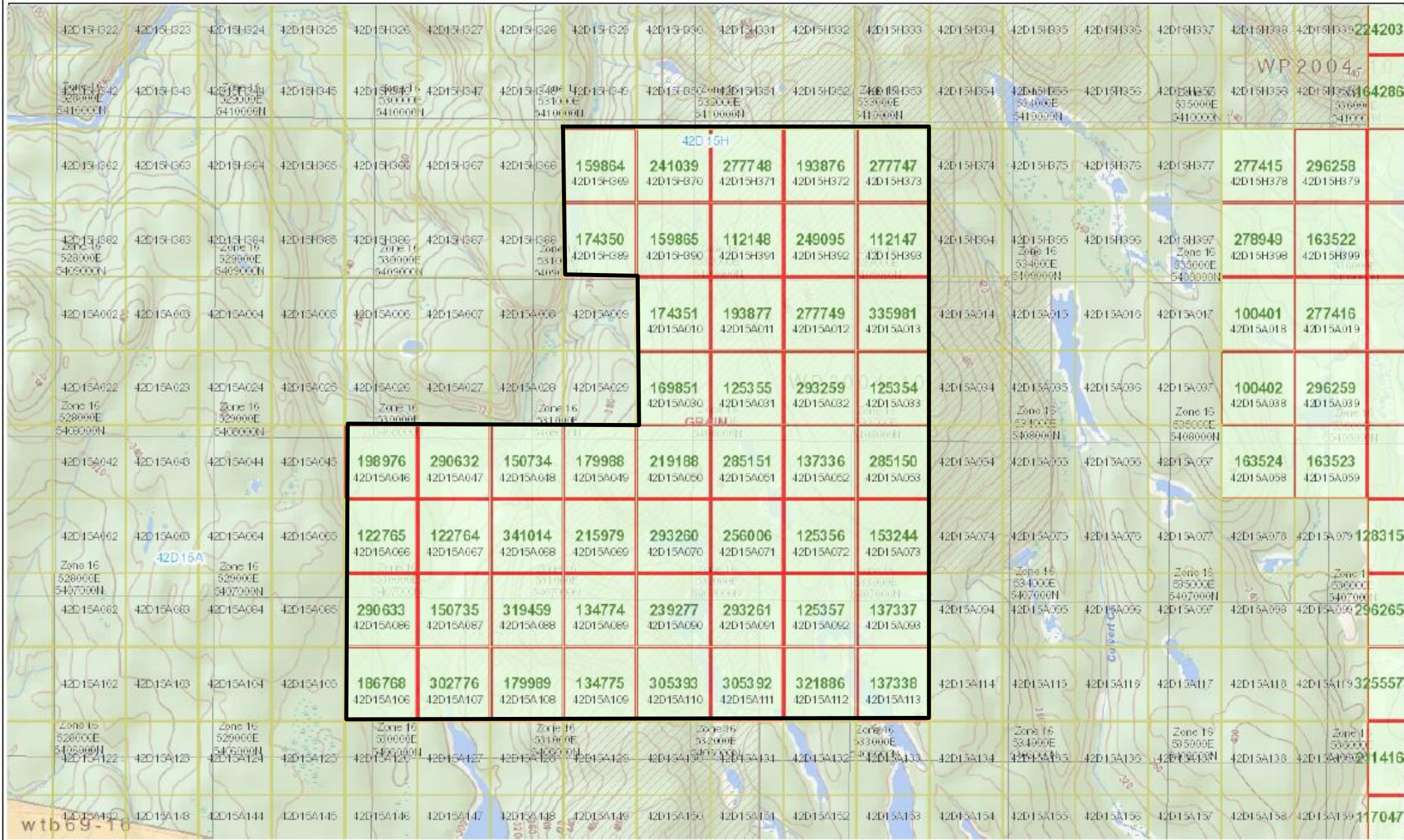

Legend

Provincial Grid Cell

- Available
- Pending
- Unavailable

Mining Claim

Mining Lease

- Surface Rights Only
- Mining Rights Only
- Surface and Mining Rights

Mining Licence of Occupation

- Surface Rights Only
- Mining Rights Only
- Surface and Mining Rights

Mining Patent

- Surface Rights Only
- Mining Rights Only
- Surface and Mining Rights

Mining Division

MNDM Townships and Areas

Provincial Grid Group

Non-Mining Land Tenure

- Patent, Surface Rights Only
- Patent, Mining Rights Only
- Patent, Surface and Mining Rights
- Lease, Surface Rights Only
- Lease, Mining Rights Only
- Lease, Surface and Mining Rights
- Water Power Lease Agreement
- Licence of Occupation, Surface Rights Only
- Licence of Occupation, Surface and Mining Rights
- Order-in-Council

Alienation

- Withdrawal
- Notice

UTM Grid Labels 1K

- UTM Grid 1K
- Indian Reserve
- Federal Land Other
- CLUPA Protected Area - Far North



Projection: Web Mercator

The Ontario Ministry of Northern Development and Mines shall not be liable in any way for the use of, or reliance upon, this map or any information on this map. This map should not be used for: navigation, a plan of survey, routes, nor locations.
© Queen's Printer for Ontario, 2019

Imagery Copyright Notices: Ontario Ministry of Natural Resources and Forestry; NASA Landsat Program; First Base Solutions Inc.; Aéro-Photo (1961) Inc.; DigitalGlobe Inc.; U.S. Geological Survey.



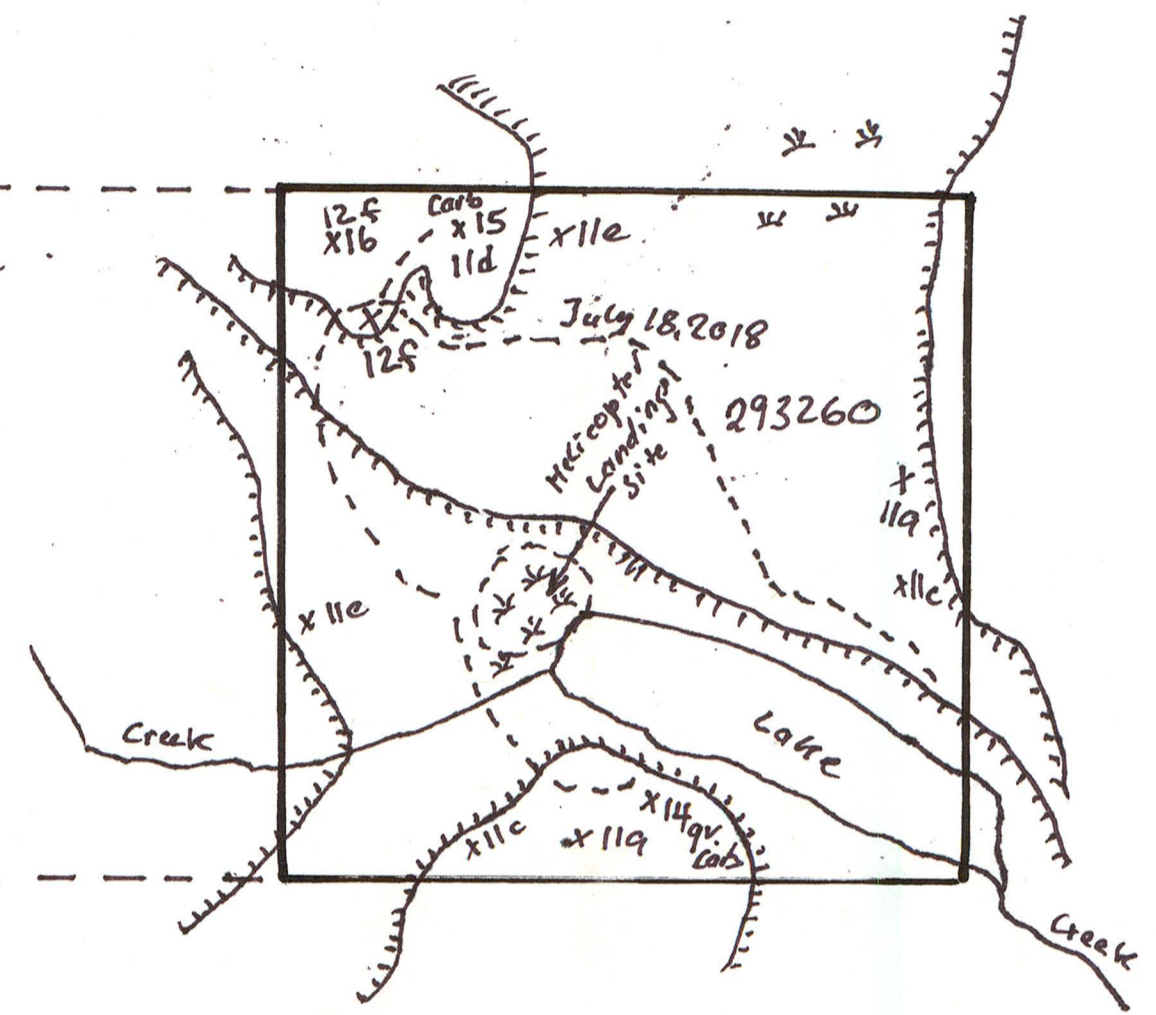
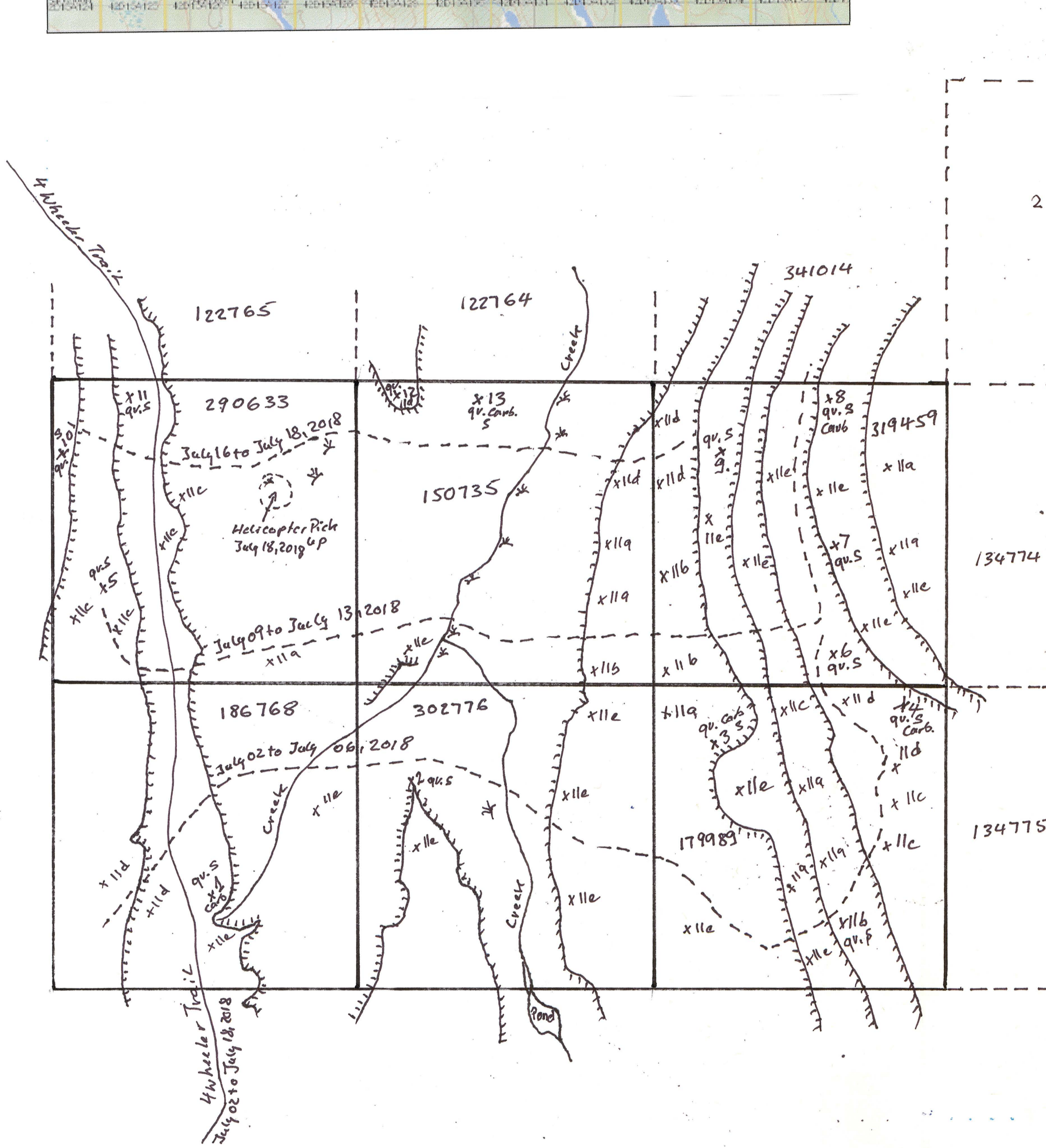
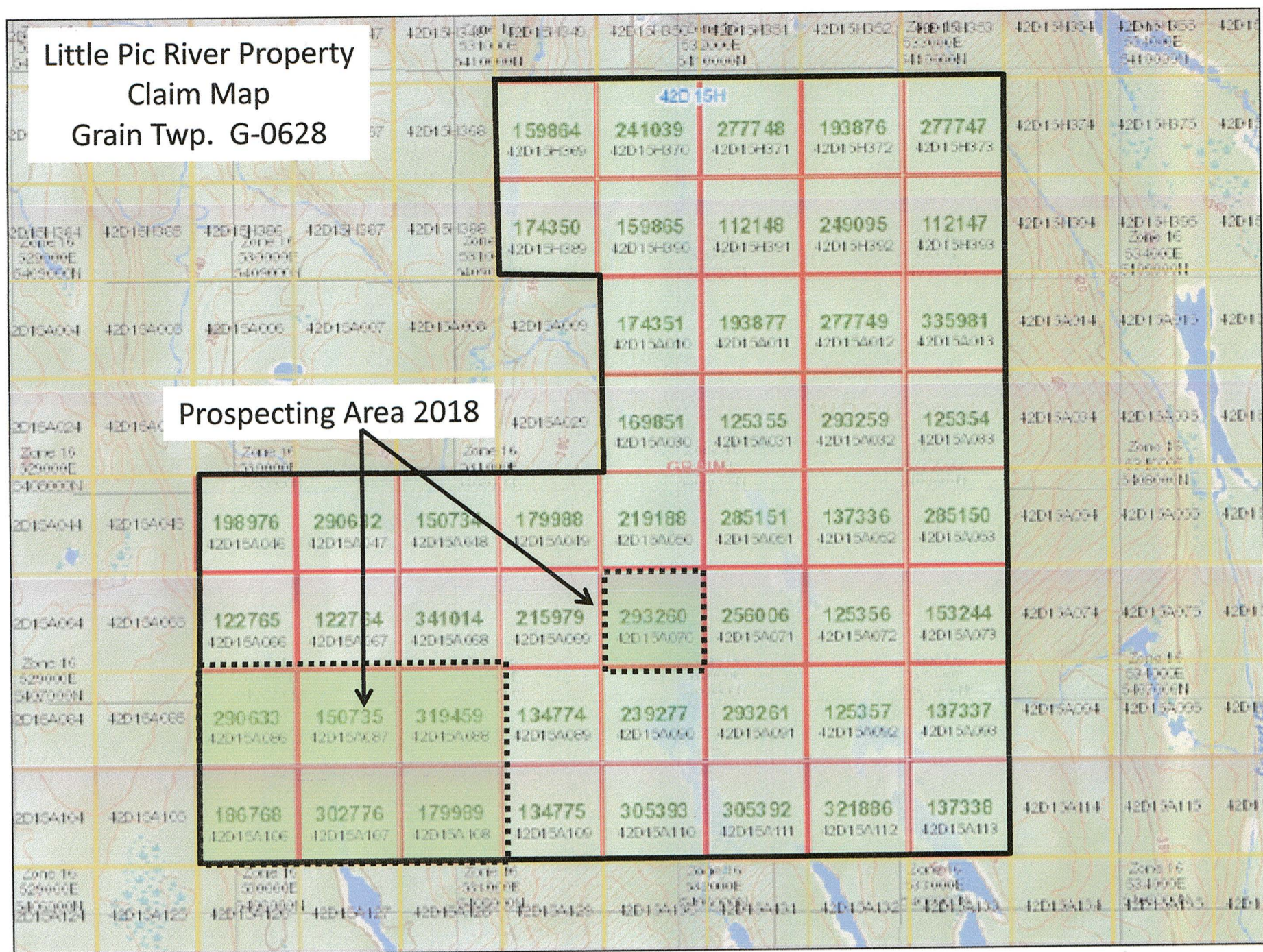

Little PIC River Property Sample Location, UTM 16 NAD 83

Sample Location #	Sample #	Easting	Northing
1	582087	530036	5406380
2	582088	530331	5406538
3	582089	530735	5406468
4	582090	531027	5406674
5	582091	529964	5406822
6	582092	530957	5406746
7	582093	530966	5406884
8	582094	530791	5407056
9	582095	530736	5406908
10	582096	529932	5406976
11	582097	529947	5407136
12	582098	530306	5407160
13	582099	540457	5407111
14	582100	531906	5407263
15	582101	531816	5407536
16	RW-016	531756	5407495

LEGEND

- PRECAMBRIAN
- LATE PRECAMBRIAN
- KEWEENAWAN
- CARBONATITE - ALKALIC
- 11a Aegirine-nepheline syenite, coarse-grained, trachitoid
- 11b Hastingsite-nepheline syenite, coarse-grained, trachitoid
- 11c Xenolithic aegirine-nepheline syenite (gabbroic xenoliths)
- 11d Xenolithic aegirine-nepheline syenite (migmatitic xenoliths)
- 11e syenite
- 12f Lamproite - Lamprophyre ?

SYMBOLS

- Down slope
- Bedrock
- Muskeg or swamp
- Cell Claim Block
- Traverse Line
- 4 Wheeler Trail
- X 1 to 16 Rock sample location - sample number

ABBREVIATIONS

- S - Sulphides
- Carb - Carbonate
- qv - Quartz vein

Wahl Prospecting

Little PIC River Property
Grain Township, G-0628
Thunder Bay M.D. Ontario
Geology and Rock Sample Locations

Prep. by Rudolf Wahl	September 2018	Dwg.#
Drawn by Rudolf Wahl	Scale 1 : 5000	1

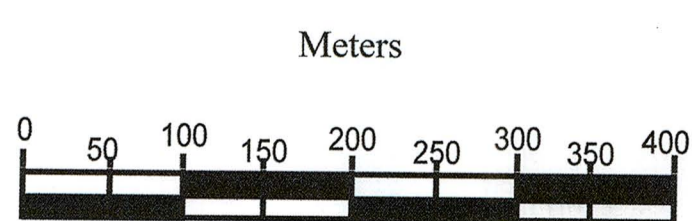

Scale 1cm = 50 meters