

We are committed to providing [accessible customer service](#).

If you need accessible formats or communications supports, please [contact us](#).

Nous tenons à améliorer [l'accessibilité des services à la clientèle](#).

Si vous avez besoin de formats accessibles ou d'aide à la communication, veuillez [nous contacter](#).

2021 Work Assessment Report

“Cleaver Property”

Claim 670368

(Cell I.D. 42A02E067)

**Cleaver Township
Larder Lake Mining Division
District of Temiskaming, Ontario**

(Prov. Grid Group 42A02E)

Prepared By:

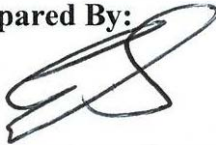

**Ed Shynkorenko
Prospector License M-25405
MAAP No. 5932**

September 21st 2021

Forward:

The field work detailed in this document, being hand sampling and mapping, was undertaken as an initial recognizance of the area by the author and prospector Peter Hermeston. This occurred on July 24th 2021, and at the time the land was not staked. The claim 670368 was later staked on July 25th 2021. Given the ongoing Covid 19 situation both men accessed the property using separate vehicles. However, given the advanced age of both, along with ongoing existing health conditions, they worked as a two man team maintaining social distancing while on the property.

The “Cleaver Property”, herein referred to as the subject property, being mining claim 670368 is located within the southeastern quadrant of Cleaver Township, District of Temiskaming Ontario, Larder Lake Mining Division. It is part of a block of 10 additional contiguous claims. The subject property is co-held by the author, Edward Shynkorenko (Lic. M25405 / MAAP No. 5932), prospector Peter Hermeston (Lic.1003623 / MAAP No. 5931), Jason Jury nec (Client No. 413435) and Margaret Sigouin (Client No. 300236).

Ed Shynkorenko is the assigned claim manager with all appropriate permissions granted for the subject property and adjoining contiguous claims.

This report addresses the 2021 initial effort to ascertain the mineral potential of the subject property.

All required illustrations, tables, maps, sample location photographs, assay results and required receipts are contained separately within the Appendices of this document, or submitted separately in pdf format.

Expenditure rates for work, transportation, labour, etc. were derived from existing government standards.

Note: As requested by staff of the Geo-Assessment Unit, gas receipts for proof of travel have been included in this submission. However, only expenditures based on the accepted rate of \$0.50 per kilometre are being claimed.

Table of Contents

Introduction & History:	Page (i)
List of Illustrations:	Page (i)
Location & Ownership:	Page (i)
Access:	Page (ii)
Regional & Property Geology:	Page (ii)
Work Program:	Page (ii)
Rationale:	Page (ii)
Daily Log:	Page (ii)
Conclusion:	Page (iii)
Recommendations:	Page (iii)
Author's Qualifications:	Page (iii)
Communications (Direct/Indirect):	Page (iv)
References:	Page (iv)

List of Appendices

Appendix A	"Location / Key Map"
Appendix B	"Claim Map & Abstracts"
Appendix C	"Access Map"
Appendix D	"Regional-Property Geology Map" *
Appendix E	"Work Compilation Plan"
Appendix F	"Assay Results and Sample Location Photographs"
Appendix G	"Required Receipts & Expenditure Rates Rationale"

** The "Regional-Property Geology Map" used in Appendix D of this report, being Ontario Geological Survey Map P. 3527 "Geological Compilation of the Matachewan Area, Abitibi Greenstone Belt" is presented in expandable pdf format. It is common to other assessment report submissions by the author, and as such also displays other properties being worked.*

Introduction & History:

The subject property, being staked mining claim 670368, is located in Cleaver Township, District of Temiskaming Ontario, Larder Lake Mining Division. In brief, mineral exploration in Cleaver Township is believed to have commenced circa 1920, with modest discoveries of gold, zinc and copper showings. Since that time numerous claims were staked, abandoned, re-staked and worked within the township.

With the focus of this particular document being on the southeastern quadrant of Cleaver township, it is known that by the 1970's exploration activities were being conducted in this locale with the emphasis placed on the magnesium rich basalts and the iron rich basalt assemblages noted in close vicinity of the subject property.

Of particular interest was the "Boissoneault-Rousseau Property", being an original block of four staked claims (as configured in 1975) located just west of the subject property. By 1986 numerous electromagnetic anomalies had been charted, five trenches developed with induced polarization surveys also undertaken. This effort identified pyritic, gold bearing quartz veins within carbonized mafic metavolcanic rocks producing gold assays as high as 2.73 grams per tonne. A subsequent sample of iron rich basalt produced a gold assay of 1.51 grams per tonne. Assay results from a follow up 1988 drill program were not published.

From November 1999 to January 2000 the Ontario Geological Survey (OGS) conducted airborne magnetic and electromagnetic surveys over Cleaver Township during a program named "Operation Treasure Hunt", publishing Map 82-049 which charted numerous anomalous zones within the township.

On July 24th 2021 the subject property of this report was prospected by Shynkorenko and Hermeston with several soil samples being collected. The subject property was then formally claimed on July 25th 2021.

List of Illustrations:

All required illustrations, tables, maps, sample location photographs, assay results and required receipts are contained separately within the Appendices of this document or submitted separately in pdf format.

Location & Ownership:

The subject property is located approximately 43 air kilometres southeast of Timmins Ontario.

Ownership of the claim is as follows: Edward Shynkorenko (17%), Peter Hermeston (33%) Jason Jury nec (33%), and Margaret W. Sigouin (17%). (*see Appendix A "Location / Key Map" and Appendix B "Claim Map and Abstracts"*).

Access:

Access to the property is best gained by following Tisdale Street (community of South Porcupine Ontario) south until it merges into the Langmuir Road. Continuing southward along this road system for approximately 48 kilometres provides vehicle access to within the confines of the subject property (*see Appendix C "Access Map"*).

Regional & Property Geology:

The regional and property geology is accurately described within a 1989 report authored by Henry P. Hutteri, H. B.Sc Geologist., as being "*...within the Abitibi Greenstone Belt of the Superior Province of the Canadian Shield. Locally the area is underlain by Archean-age mafic and felsic volcanic rocks and younger, possibly down faulted Cobalt Group sediments*".

Exposed basalt or carbonized mafic metavolcanic outcrops that specifically displayed possible mineral hosting potential were not detected within the subject property during the field effort of July 24th 2021 mainly due to an overburden presence. For the most part this overburden layer consists mainly of coarse bronze coloured sand.

The subject property has an elevation of approximately 300 to 330 metres above sea level.

The subject area is situated within a traditional Boreal Forest and Great Lakes St. Lawrence Forest transitional zone setting. Forest cover includes cedar, black spruce, white spruce, white pine, jack pine, balsam fir, white birch, and trembling aspen.

The subject property is drained by several intermittent draw systems that eventually drain into the East Nighthawk River system (*see Appendix D "Regional-Property Geology Map"*).

Work Program:*Rationale:*

The July 24th 2021 effort was to conduct an initial inspection of the land in an attempt to locate outcrops of basalt and/or carbonized mafic metavolcanics displaying vein networks hosting mineral potential.

Daily Log:

On July 24th 2021 (the day prior to claim 670368 being formally recorded), the subject property was prospected by Ed Shynkorenko and Peter Hermeston (both licensed prospectors and MAAP verified). Given the ongoing Covid 19 situation, along with the advanced age of the prospectors, access to the property was done in separate vehicles and work efforts were undertaken as a two man team maintaining social distancing. The property was traversed with 1.2 kilometres accumulated.

Work Program continued:

No outcrops of basalt or carbonized mafic metavolcanics that specifically displayed veining were located partially due to thick overburden; therefore no outcrops were mapped and only soil samples taken.

A total of 4 soil samples were taken from the “B” horizon at each sample site. All samples collected visually displayed a consistency of being bronzed coloured coarse sand.

One sample (CLE01) was submitted for assaying, the remaining 3 samples may be assayed at a later date. The assayed sample location was recorded in NAD 83 using a handheld GPS unit (Garmin E-Trex 10 model) and photographed using a digital camera with date coding (Fuji XP 140 model). Routes traversed, and locations of the samples taken are indicated on the separately submitted work compilation plan (*see Appendix E “Work Compilation Plan”*).

The assayed results of sample CLE01, along with a date coded photograph of the actual sample location are enclosed (*see Appendix F “Assay Results and Sample Location Photographs”*).

Vehicle and labour rates along with required receipts are provided (*see Appendix G “Required Receipts & Expenditure Rates Rationale”*).

Conclusions:

Soil sample CLE01 produced a modest anomalous nickel value of 29 ppm, with zinc and lead at 11 ppm and 10 ppm respectively. These results appear to be reflective of previous sampling efforts conducted by others on nearby properties explored over the decades.

Recommendations:

As a “hint” of a nickel and zinc presence has been detected on the subject property further grass roots exploration work should be undertaken.

Author Qualifications:

The author is an honour graduate of the Sault College of Applied Arts and Technology forestry program (1980, Sault Ste. Marie, Ontario), and is now a retiree of the Ministry of Natural Resources. Throughout the past 4 decades he has been exposed to numerous mining projects (Hemlo, Detour Lake, and Agrium). A reader of accredited material, the author is in the ongoing process of expanding his knowledge base in order to augment his prospecting efforts.

Prospecting remains his life-long hobby.

Communications (Direct & Indirect):

Peter Hermeston, fellow prospector, North Bay, Ontario.

Heather Martin, Natural Resources Canada.

Eric Marion, fellow prospector, Kirkland Lake, Ontario.

References:

“Geological Mapping Report on the Cleaver Gold Property” (Henry P. Hutteri, H. BSc. 1989), MNDE file No. 2.12916.

Ontario Geological Survey 2000. Airborne magnetic and electromagnetic surveys, residual magnetic field and electromagnetic anomalies, Kirkland Lake area; Ontario Geological Survey Map 82 049.

Numerous online searches of Geology Ontario and Historical Claim Map files.

APPENDICES

Appendix A

“Location / Key Map”

APPENDIX A

Location / Key Map

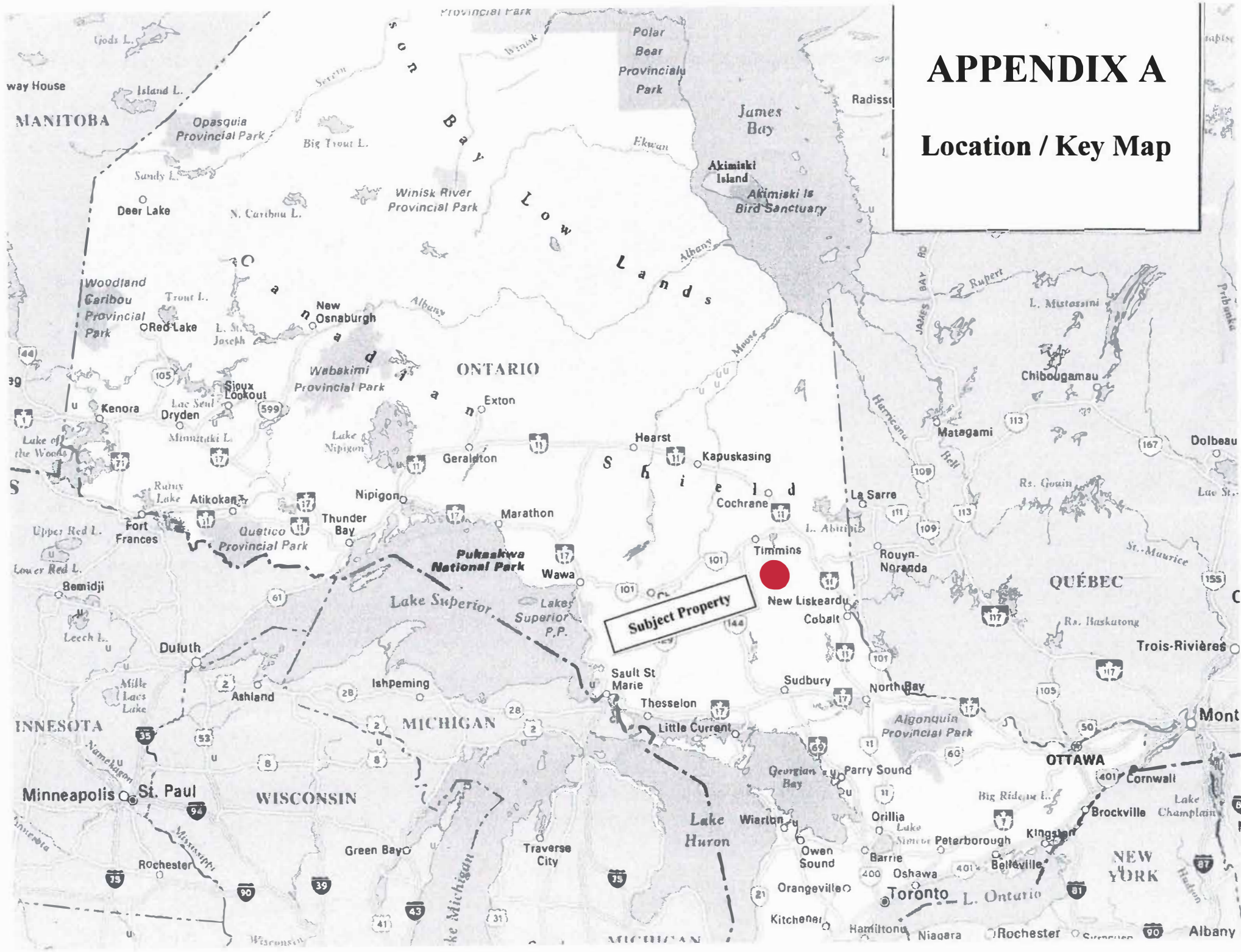

Appendix B

“Claim Map & Abstracts”

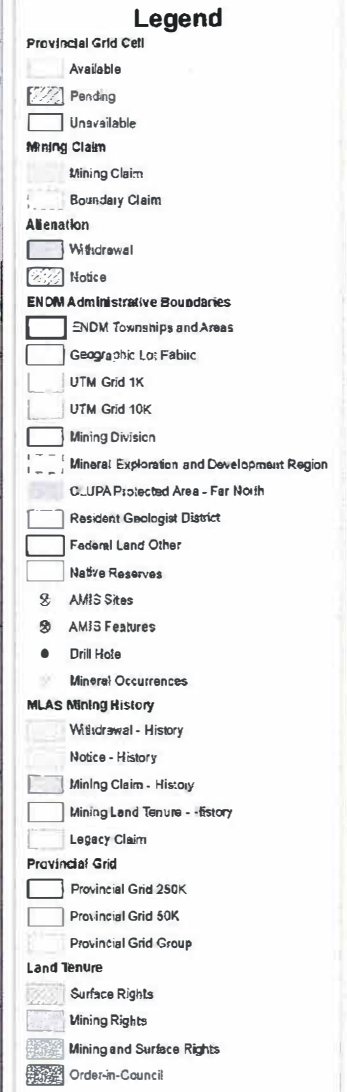
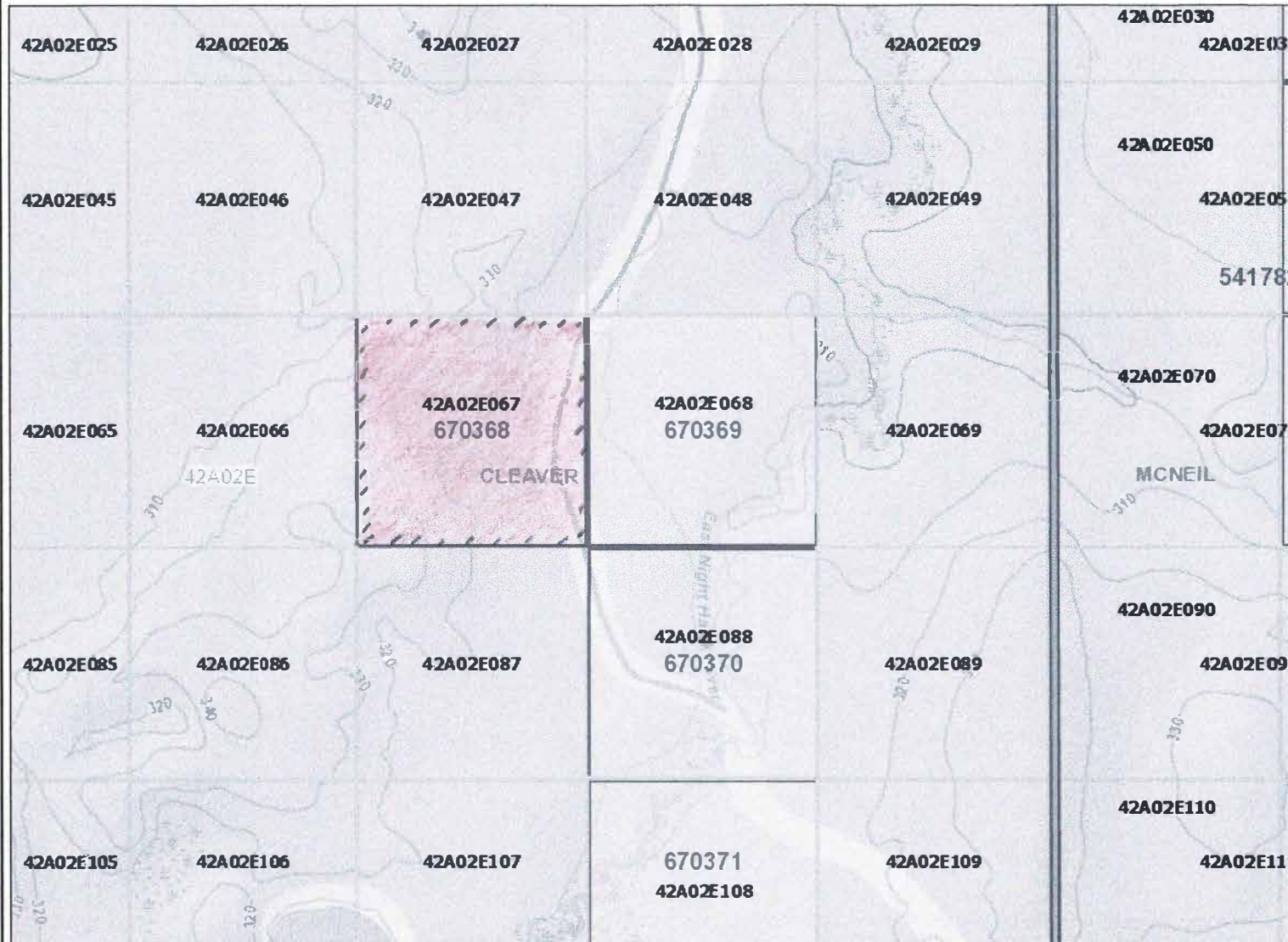

Those wishing to register mining claims should consult with the Provincial Mining Recorders' Office of the Ministry of Energy, Northern Development and Mines for additional information on the status of the lands shown hereon. This map is not intended for navigational, survey, or land title determination purposes as the information shown on this map is compiled from various sources. Completeness and accuracy are not guaranteed. Additional information may also be obtained through the local Land Titles or Registry Office, or the Ministry of Natural Resources and Forestry. The information shown is derived from digital data available in the Provincial Mining Recorders' Office at the time of downloading from the Ministry of Energy, Northern Development and Mines web site.



Imagery Copyright Notices: Ontario Ministry of Natural Resources and Forestry; NASA Landsat Program; First Base Solutions Inc.; Aéro-Photo (1961) Inc.; DigitalGlobe Inc.; U.S. Geological Survey.
© Queen's Printer for Ontario, 2021



**Claim Abstract
670368**

Status: Active

Cell Claim Type: Single Cell	Due Date: 25-Jul-2023	Total Reserve: 0
Special Status: N	Total Work: 0	Assessment Assmnt: 50000
Number of Cells: 1	Work Required: 400	Consultation Reserve: 0
Registration Date: 25-Jul-2021	Total Payment In Place: 0	Exploration Reserve: 0
Anniversary Date: 25-Jul-2023	Last Paid in Place Date:	
UTM Zone: 17	Mining Division: Larder Lake	
MNR District: Timmins	Township Name: CLEAVER	

Cell ID(s)	42A02E067
------------	-----------

Client Number	Recorded Holder(s)	Percent
194158	EDWARD SHYNKORENKO	17
300236	MARGARET SIGOUIN	17
403428	PETER HERMESTON	33
413435	JASON JURYNEC	33

Claim Abstract

670368

Status: Active

Event #	Recorded By	Event Description	Abstract Wording	Event Date
1233028	MARGARET SIGOUIN	Complete Transfer of Mining Claim(s)	EDWARD SHYNKORENKO (194158) Transfers 50% to MARGARET SIGOUIN (300236)	27-Jul-2021
1233001	PETER HERMESTON	Complete Transfer of Mining Claim(s)	EDWARD SHYNKORENKO (194158) Transfers 50% to PETER HERMESTON (403428)	27-Jul-2021
1232998	JASON JURYNEC	Complete Transfer of Mining Claim(s)	EDWARD SHYNKORENKO (194158) Transfers 33% to JASON JURYNEC (413435)	27-Jul-2021
1232800	MLAS System internal	Mining claim acquisition notification handling	Confirmation of Registration Not Required	25-Jul-2021
1232798	EDWARD SHYNKOREN	Register a Mining Claim	Registered By EDWARD SHYNKORENKO (194158)	25-Jul-2021

Reservations under the Mining Act may apply

Note: Status of Claim is based on information currently on record.

Appendix C

“Access Map”

APPENDIX C

Access Map

Scale 1:250000

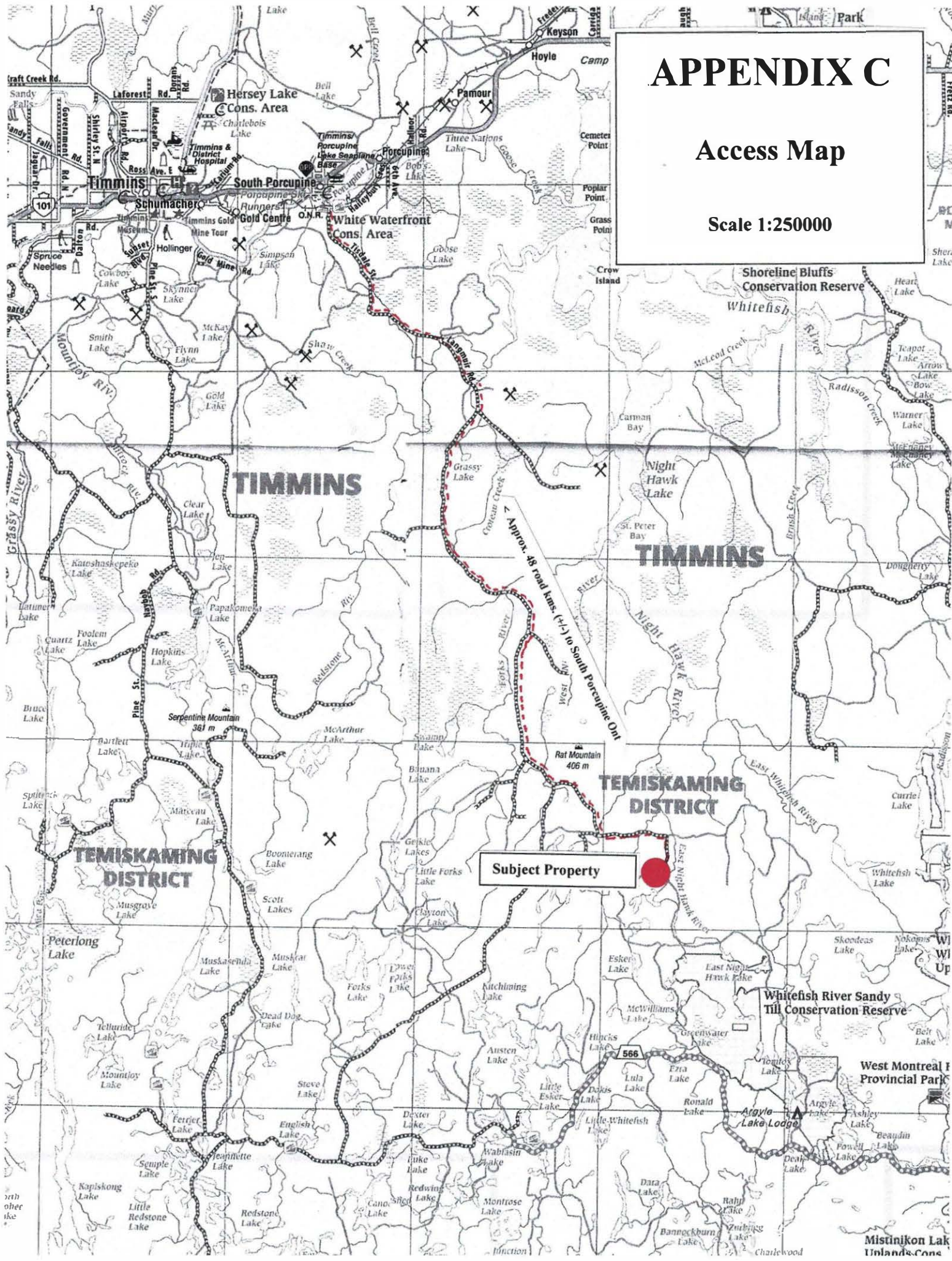

Appendix D

“Regional-Property Geology Map”

Appendix D of this report, being Ontario Geological Survey Map P. 3527 “Geological Compilation of the Matachewan Area, Abitibi Greenstone Belt” is submitted to the Ontario Geo-Assessment Office separately in expandable pdf format. This particular map is common to other assessment report submissions and also displays other properties currently held by the author.

Appendix E

“Work Compilation Plan”

Note: Appendix E was submitted to the Geo-Assessment Office as a separate pdf file.

Appendix F

“Assay Results and Sample Location Photographs”



Sample I.D. "CLE01"
Location 0503180E x 5333122N
July 24, 2021



Established 1928

Swastika Laboratories Ltd

Assaying - Consulting - Representation

Page 1 of 1

Assay Certificate

Certificate Number: 21-3265

Company: **Ed Shynkorenko**

Project: _____ Report Date: 10-Aug-21

Attn: Ed Shynkorenko

We hereby certify the following Assay of 1 soil samples
submitted 03-Aug-21 by Ed Shynkorenko

Sample Number	Au FA-MP ppb	Au Chk FA-MP ppb	Ag AR-AAS ppm	Cu AR-AAS ppm	Pb AR-AAS ppm	Zn AR-AAS ppm	Co AR-AAS ppm	Ni AR-AAS ppm
Blank Value	< 2							
OREAS 253	1250							
PTC-1b					801			
CLE01	< 2	< 2	< 0.2	3	10	11	< 1.0	29

Certified by _____

Valid Abu Ammar

Appendix G

“Required Receipts & Expenditure Rates Rationale”

(Note: some expenditure items and rates listed below have also been submitted electronically Also, and as requested by Geo Assessment Unit staff, copies of the actual gas receipts were included in the electronic submission as proof of travel only. These receipted amounts were not claimed as expenditures as the \$0.50 per kilometre method was used.

Vehicle Expenses

Based upon a rate previously accept by the MEND&M vehicle expenses are based on \$0.50 per kilometre (kms.). Therefore:

Vehicle Hermeston, July 24/21 North Bay Ont. to property and return 820 kms. x \$0.50	\$410.00
Vehicle Shynkorenko, July 24/21, Cochrane Ont. (rural) to property and rtn. 340 kms. x \$0.50	\$170.00
	\$580.00

Labour (field)

Based upon a rate previously accept by the MEND&M labour expenditures are based upon \$240 per man-day (8 hours). Therefore:

One field day, two prospectors each at \$240 per day equates to \$240.00 x 2	\$480.00
--	-----------------

Report Preparation

Based upon a rate previously accept by the MEND&M labour expenditures are based upon \$240 per man-day (8 hours). Therefore:

Accumulative 5.5 man-days to research, prepare & scan work rpt. / map (s) equates to	\$1320.00
--	------------------

Assaying

Assaying costs and shipping	\$ 111.52
-----------------------------	------------------

Total \$2491.52

(rounded to \$2,492.00)