

We are committed to providing [accessible customer service](#).

If you need accessible formats or communications supports, please [contact us](#).

Nous tenons à améliorer [l'accessibilité des services à la clientèle](#).

Si vous avez besoin de formats accessibles ou d'aide à la communication, veuillez [nous contacter](#).

ASSESSMENT WORK PERFORMED

FOR

DRIVE-BY EXPLORATION

CLIENT #407432

STRATHCONA TOWNSHIP

SUDBURY MINING DIVISION

PREPARED BY PAUL CENTIS

JANUARY 6, 2022

SAMPLING

The samples were collected by pick and shovel, placed in sample bags and sealed and tagged accordingly. The sampled areas located on Crown land were accessed by boat launch from Herridge Lake off Highway 11. Accompanied 1:5000 drawings detail boat travel to each sample area. Sample areas are marked via recorded GPS co-ordinates.

INTRODUCTION & SUMMARY

The following report pertains to assessment work performed for Drive-By Exploration on claims # 534402, #534403 and #556237. Four samples were taken from these claims and are the subject of this report. Sample # and location in relation to claim number is listed below. The 4 samples were collected on May 7,2020 by myself and David Lowenstein.

<u>SAMPLE #</u>	<u>CLAIM #</u>	<u>CO-ORDINATES</u>
052019	534402	589582E, 5204336N
052018	534402	589667E, 5204411N
052020	534402	589550E, 5204347N
052076	556237	589218E,5203636N

Sample 052019 taken from lake. Gravelly with many diverse pebbles.

Sample 052018 taken from land. Gravelly mixed with till

Sample 052020 taken from land. Gravelly till and pebbly. White calcrete noted on many pebbles.

Sample 052076 taken on land. Gravelly till

BREAKDOWN OF EXPENSES

Samples were shipped to Overburden Drilling for processing.
The samples were processed for kimberlite indicator minerals.

Overburden Drilling Laboratory Services

\$4761.15 for 9 samples=\$529.02 per sample

4 samples this report x \$529.02 \$2116.08

Sample collection 2 men (4 samples @ \$250.00 \$1000.00

Gas (400km @\$0.50) \$ 200.00

Total expenses \$3316.08



MINISTRY OF ENERGY, NORTHERN
DEVELOPMENT AND MINES
MLAS Map Viewer

MLAS Map

Notes:

○ - Sample location for #052076 on claim 556237
 ---> Boat access route

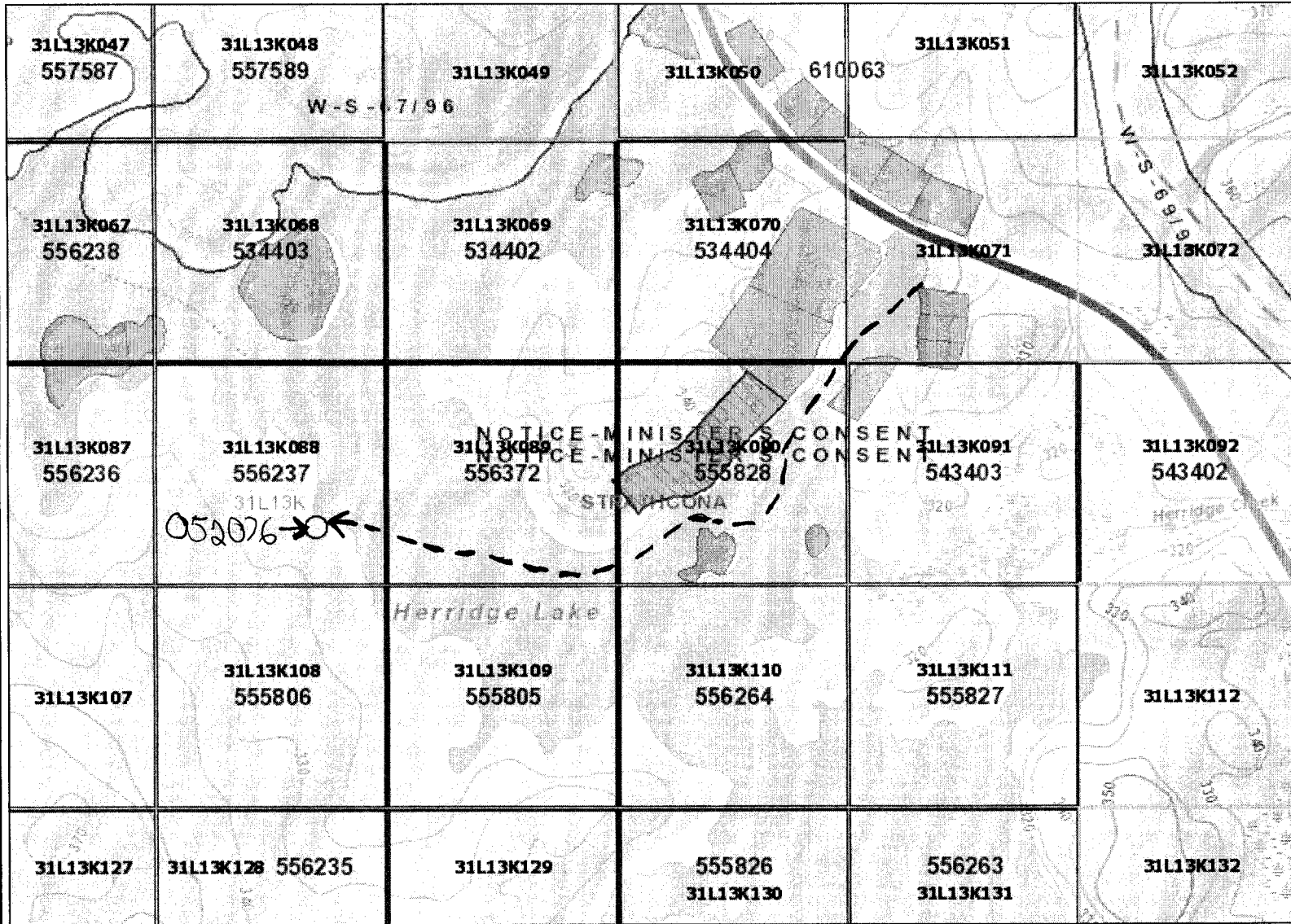

Legend

- Provincial Grid Cell**
 - Available
 - Pending
 - Unavailable
- Mining Claim**
 - Mining Claim
 - Boundary Claim
- Alienation**
 - Withdrawal
 - Notice
- ENDM Administrative Boundaries**
 - ENDM Townships and Areas
 - Geographic Lot Fabric
 - UTM Grid 1K
 - UTM Grid 10K
 - Mining Division
 - Mineral Exploration and Development Region
 - CLUPA Protected Area - Far North
 - Resident Geologist District
 - Federal Land Other
 - Native Reserves
- MLAS Mining History**
 - AMIS Sites
 - AMIS Features
 - Drill Hole
 - Mineral Occurrences
 - Withdrawal - History
 - Notice - History
 - Mining Claim - History
 - Mining Land Tenure - History
 - Legacy Claim
- Provincial Grid**
 - Provincial Grid 250K
 - Provincial Grid 50K
 - Provincial Grid Group
- Land Tenure**
 - Surface Rights
 - Mining Rights
 - Mining and Surface Rights
 - Order-in-Council

Those wishing to register mining claims should consult with the Provincial Mining Recorders' Office of the Ministry of Energy, Northern Development and Mines for additional information on the status of the lands shown hereon. This map is not intended for navigational, survey, or land title determination purposes as the information shown on this map is compiled from various sources. Completeness and accuracy are not guaranteed. Additional information may also be obtained through the local Land Titles or Registry Office, or the Ministry of Natural Resources and Forestry. The information shown is derived from digital data available in the Provincial Mining Recorders' Office at the time of downloading from the Ministry of Energy, Northern Development and Mines web site.

0 0.63 km

Projection: Web Mercator



Imagery Copyright Notices: Ontario Ministry of Natural Resources and Forestry; NASA Landsat Program; First Base Solutions Inc.; Aéro-Photo (1961) Inc.; DigitalGlobe Inc.; U.S. Geological Survey.

© Queen's Printer for Ontario, 2022

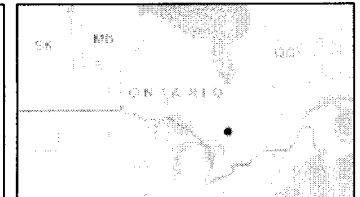



MLAS Map

Notes:

● Location of Sample 052020 on claim 534402

---> Boat access route

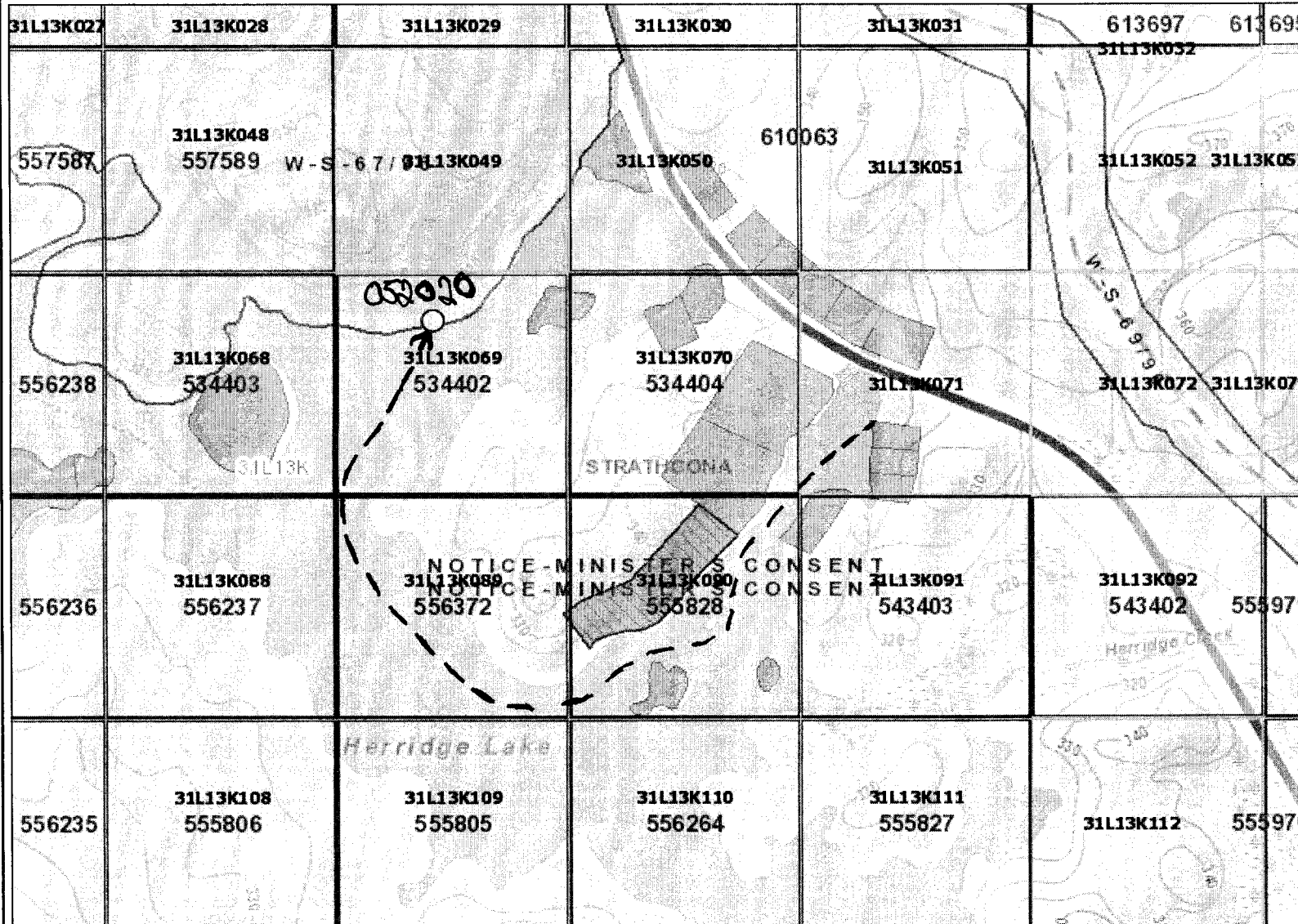

Those wishing to register mining claims should consult with the Provincial Mining Recorders' Office of the Ministry of Energy, Northern Development and Mines for additional information on the status of the lands shown hereon. This map is not intended for navigational, survey, or land title determination purposes as the information shown on this map is compiled from various sources. Completeness and accuracy are not guaranteed. Additional information may also be obtained through the local Land Titles or Registry Office, or the Ministry of Natural Resources and Forestry. The information shown is derived from digital data available in the Provincial Mining Recorders' Office at the time of downloading from the Ministry of Energy, Northern Development and Mines web site.

0 0.63 km

Projection: Web Mercator



Imagery Copyright Notices: Ontario Ministry of Natural Resources and Forestry; NASA Landsat Program; First Base Solutions Inc.; Aéro-Photo (1961) Inc.; DigitalGlobe Inc.; U.S. Geological Survey.

© Queen's Printer for Ontario, 2022

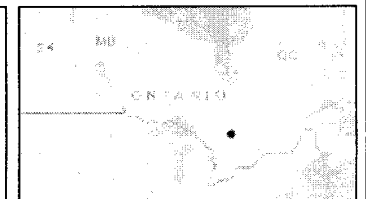

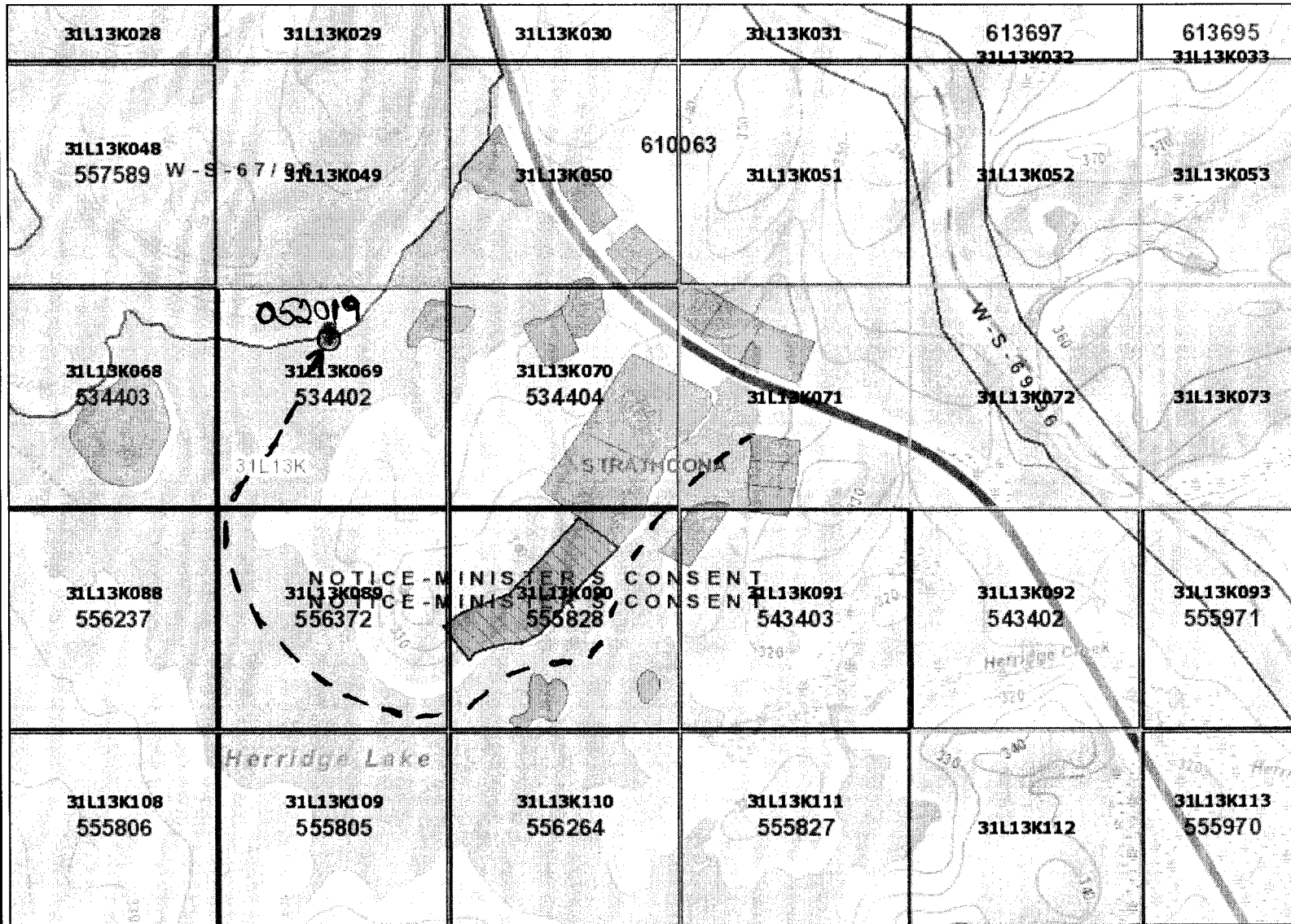

Legend

- Provincial Grid Cell**
 - Available
 - Pending
 - Unavailable
- Mining Claim**
 - Mining Claim
 - Boundary Claim
- Alienation**
 - Withdrawal
 - Notice
- ENDM Administrative Boundaries**
 - ENDM Townships and Areas
 - Geographic Lot Fabric
 - UTM Grid 1K
 - UTM Grid 10K
 - Mining Division
 - Mineral Exploration and Development Region
 - CLUPA Protected Area - Far North
 - Resident Geologist District
 - Federal Land Other
 - Native Reserves
 - AMIS Sites
 - AMIS Features
 - Drill Hole
 - Mineral Occurrences
- MLAS Mining History**
 - Withdrawal - History
 - Notice - History
 - Mining Claim - History
 - Mining Land Tenure - History
 - Legacy Claim
- Provincial Grid**
 - Provincial Grid 250K
 - Provincial Grid 50K
 - Provincial Grid Group
- Land Tenure**
 - Surface Rights
 - Mining Rights
 - Mining and Surface Rights
 - Order-in-Council

Those wishing to register mining claims should consult with the Provincial Mining Recorders' Office of the Ministry of Energy, Northern Development and Mines for additional information on the status of the lands shown hereon. This map is not intended for navigational, survey, or land title determination purposes as the information shown on this map is compiled from various sources. Completeness and accuracy are not guaranteed. Additional information may also be obtained through the local Land Titles or Registry Office, or the Ministry of Natural Resources and Forestry. The information shown is derived from digital data available in the Provincial Mining Recorders' Office at the time of downloading from the Ministry of Energy, Northern Development and Mines web site.

0 0.63 km

Projection: Web Mercator



Imagery Copyright Notices: Ontario Ministry of Natural Resources and Forestry; NASA Landsat Program; First Base Solutions Inc.; Aéro-Photo (1961) Inc.; DigitalGlobe Inc.; U.S. Geological Survey.

© Queen's Printer for Ontario, 2022

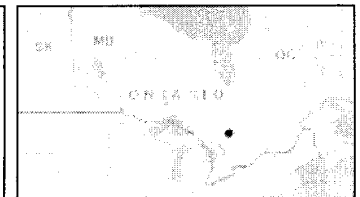

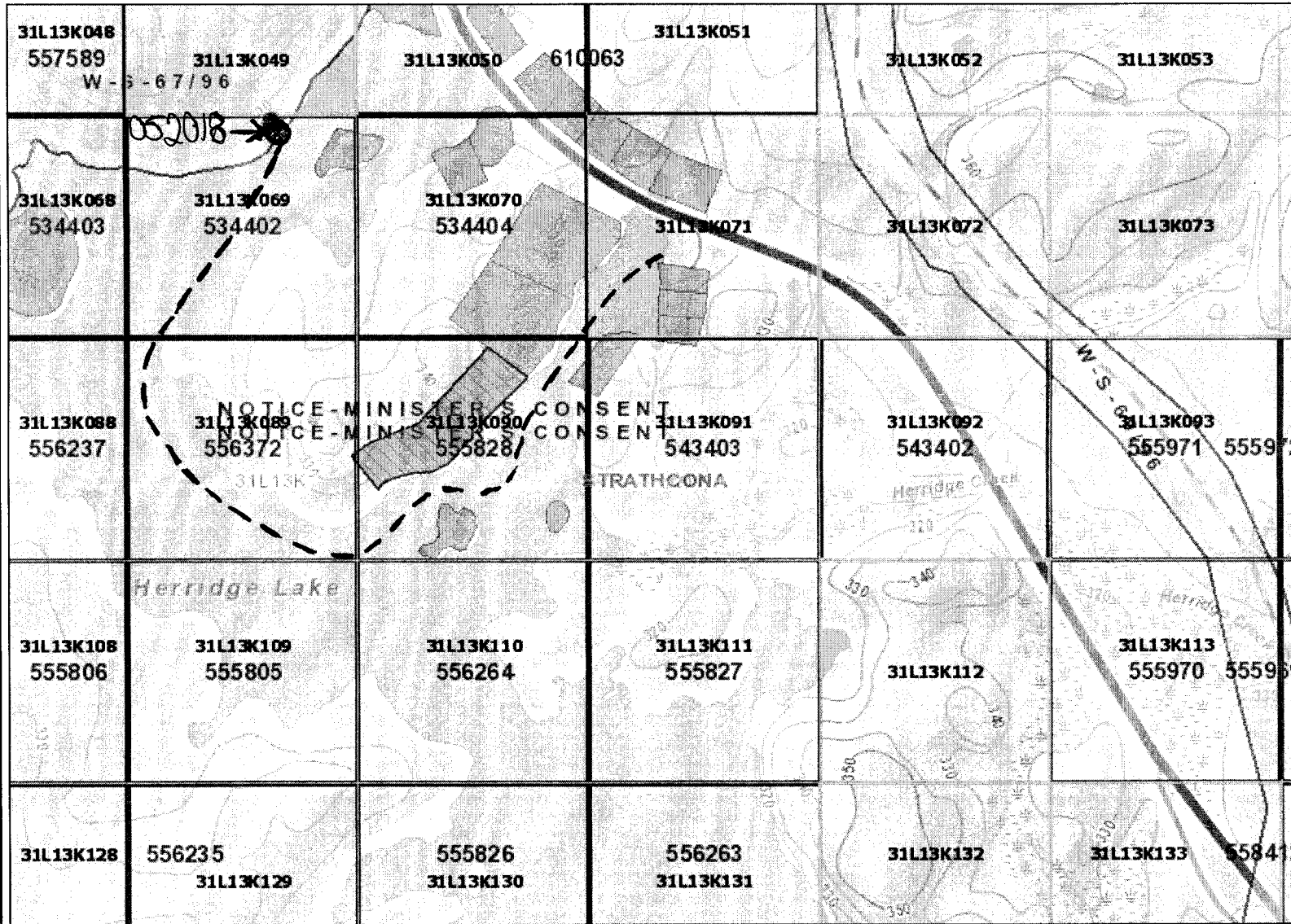
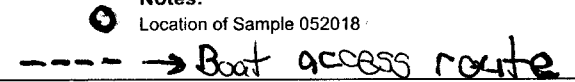

Legend

- Provincial Grid Cell**
 - Available
 - Pending
 - Unavailable
- Mining Claim**
 - Mining Claim
 - Boundary Claim
- Alienation**
 - Withdrawal
 - Notice
- ENDM Administrative Boundaries**
 - ENDM Townships and Areas
 - Geographic Lot Fabric
 - UTM Grid 1K
 - UTM Grid 10K
 - Mining Division
 - Mineral Exploration and Development Region
 - CLUPA Protected Area - Far North
 - Resident Geologist District
 - Federal Land Other
 - Native Reserves
 - AMIS Sites
 - AMIS Features
 - Drill Hole
 - Mineral Occurrences
- MLAS Mining History**
 - Withdrawal - History
 - Notice - History
 - Mining Claim - History
 - Mining Land Tenure - History
 - Legacy Claim
- Provincial Grid**
 - Provincial Grid 250K
 - Provincial Grid 50K
 - Provincial Grid Group
- Land Tenure**
 - Surface Rights
 - Mining Rights
 - Mining and Surface Rights
 - Order-in-Council

Those wishing to register mining claims should consult with the Provincial Mining Recorders' Office of the Ministry of Energy, Northern Development and Mines for additional information on the status of the lands shown hereon. This map is not intended for navigational, survey, or land title determination purposes as the information shown on this map is compiled from various sources. Completeness and accuracy are not guaranteed. Additional information may also be obtained through the local Land Titles or Registry Office, or the Ministry of Natural Resources and Forestry. The information shown is derived from digital data available in the Provincial Mining Recorders' Office at the time of downloading from the Ministry of Energy, Northern Development and Mines web site.

0 0.63 km

Projection: Web Mercator



Imagery Copyright Notices: Ontario Ministry of Natural Resources and Forestry; NASA Landsat Program; First Base Solutions Inc.; Aéro-Photo (1961) Inc.; DigitalGlobe Inc.; U.S. Geological Survey.

© Queen's Printer for Ontario, 2022

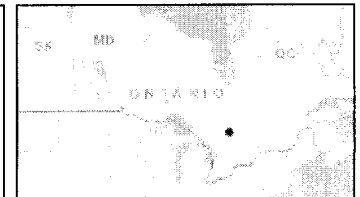



Overburden Drilling Management Limited
Unit 107, 15 Capella Court
Nepean, Ontario, Canada, K2E 7X1
Tel: (613) 226-1771 Fax: (613) 226-8753
odm@storm.ca www.odm.ca

Laboratory Data Report

Client Information

North-Tech Stone and Ceramic
1260 Kelley Lake Road
Sudbury, ON
P3E 5P4

pcentis@yahoo.com

Attention:

Data-File Information

Date: July 24, 2020
Project name:

ODM batch number: 8336
Sample numbers: 052019-C, 052019-R, 052019-O, 052018, 052020, 052046, 052049,
052076, 052080, 052095 and 052306
Data file: 20208336 - North Tech - Centis - (KIMs) - May 2020

Number of samples in this report: 9
Number of samples processed to date: 9
Total number of samples in project: 9

Preliminary data:
Final data:
Revised data:

Samples Processed For: Gold, KIMs

Processing Specifications:

1. Submitted by client: Glacial till and sand samples, pre-concentrated by client.
2. Concentrate, reject and oversize fractions processed individually, for sample 052019 only.
3. All sample fractions panned for gold, PGMs and fine-grained metallic indicator minerals.
4. Heavy liquid separation at specific gravity 3.20.
5. 0.25-2.0 mm nonferromagnetic heavy mineral fractions picked for kimberlite indicator minerals.

Notes

Mike Crawford
Laboratory Manager

Primary Sample Processing Weights and Descriptions

Client: North-Tech Stone and Ceramic
 File Name: 20208336 - North Tech - Centis - (KIMs) - May 2020
 Total Number of Samples in this Report: 9
 ODM Batch Number(s): 8336

Sample Number	Weight (kg wet)					Screening and Shaking Table Sample Descriptions												Class				
	Bulk Rec'd	Archived Split	Table Split	+2.0 mm Clasts	-2.0 mm Table Feed	Clasts (+2.0 mm)				Matrix (-2.0 mm)					Colour							
						Size	Percentage			S/U	SD	ST	CY	ORG	SD	CY						
							V/S	GR	LS								OT					
052019-C			NA																		NA	
052019-R	10.3	0.0	10.3	0.0	10.3						No Clasts	U	+	Y	-	N	GB	GB				TILL
052019-O	10.2	0.0	10.2	8.2	2.0	P	100	TR	0	0	U	+	-	-	N	N	GB	N				TILL
052018	13.8	0.0	13.8	6.8	7.0	P	80	20	0	0	U	+	-	-	-	N	LOC	LOC				TILL
052020	20.3	0.0	20.3	8.0	12.3	P	90	10	0	0	U	+	-	-	-	N	GY	GB				TILL
052046	13.7	0.0	13.7	0.0	13.7						No Clasts	S	MC	-	-	N	GY	NA				SAND
052049	6.1	0.0	6.1	0.4	5.7	G	95	5	0	0	S	MC	-	-	-	N	GY	GB				SAND
052076	13.4	0.0	13.4	6.3	7.1	P	95	5	0	0	U	+	Y	-	-	N	OC	OC				TILL
052080	11.6	0.0	11.6	2.0	9.6	P	95	5	0	0	U	+	Y	-	-	N	OC	OC				TILL
052095	5.1	0.0	5.1	0.2	4.9	G	90	10	0	0	S	MC	Y	-	-	N	GY	NA				SAND
052306	8.3	0.0	8.3	1.3	7.0	P	90	10	0	0	U	+	Y	-	-	N	GY	GY				TILL

Gold Grain Summary

Client: North-Tech Stone and Ceramic

File Name: 20208336 - North Tech - Centis - (KIMs) - May 2020

Total Number of Samples in this Report: 9

ODM Batch Number(s): 8336

Sample Number	Number of Visible Gold Grains				Nonmag HMC Weight (g)	Calculated PPB Visible Gold in HMC			
	Total	Reshaped	Modified	Pristine		Total	Reshaped	Modified	Pristine
052019-C	0	0	0	0	3.5	0	0	0	0
052019-R	0	0	0	0	27.0	0	0	0	0
052019-O	0	0	0	0	1.9	0	0	0	0
052018	3	1	1	1	21.8	34	29	3	1
052020	7	1	3	3	53.7	35	26	6	3
052046	0	0	0	0	8.8	0	0	0	0
052049	3	2	0	1	8.5	14	11	0	3
052076	2	1	1	0	6.6	15	4	11	0
052080	1	1	0	0	2.1	35	35	0	0
052095	2	2	0	0	3.7	59	59	0	0
052306	0	0	0	0	13.9	0	0	0	0

Detailed Gold Grain Data

Client: North-Tech Stone and Ceramic
 File Name: 20208336 - North Tech - Centis - (KIMs) - May 2020
 Total Number of Samples in this Report: 9
 ODM Batch Number(s): 8336

Sample Number	Dimensions (µm)			Number of Visible Gold Grains				Nonmag HMC Weight (g)	Calculated V.G. Assay in HMC (ppb)	Metallic Minerals in Pan Concentrate
	Thickness	Width	Length	Reshaped	Modified	Pristine	Total			
052019-C	No Visible Gold									Tr (2 grains) pyrite (25-50 µm).
052019-R	No Visible Gold									Tr (4 grains) pyrite (50-100 µm).
052019-O	No Visible Gold									Tr (~10 grains) pyrite (25-125 µm).
052018	5	C	25	25			1	1	1	Tr (3 grains) pyrite (50-100 µm).
	8	C	25	50			1	1	3	
	15	C	75	75	1		1	1	29	
							3	21.8	34	
052020	5	C	25	25			1	1	2	Tr (~20 grains) pyrite (25-150 µm).
	8	C	25	50			2	2	3	
	10	C	25	75		2	2	2	5	
	20	C	75	125	1		1	1	26	
							7	53.7	35	
052046	No Visible Gold									Tr (~10 grains) pyrite (25-100 µm).
052049	5	C	25	25	1			1	2	Tr (~10 grains) pyrite (25-100 µm).
	8	C	25	50	1			1	6	
							3	8.5	14	
052076	5	C	25	25	1			1	4	Tr (~20 grains) pyrite (25-100 µm).
	8	C	25	50		1		1	11	
							2	6.6	15	
052080	8	C	25	50	1			1	35	Tr (~20 grains) pyrite (25-150 µm).
							1	2.1	35	
052095	5	C	25	25	1			1	7	Tr (~10 grains) pyrite (25-100 µm).
	10	C	50	50	1			1	52	
							2	3.7	59	
052306	No Visible Gold									Tr (~10 grains) pyrite (25-150 µm).

Heavy Mineral Concentrate Processing Weights

Client: North-Tech Stone and Ceramic
 File Name: 20208336 - North Tech - Centis - (KIMs) - May 2020
 Total Number of Samples in this Report: 9
 ODM Batch Number(s): 8336

Sample Number	Weight of -2.0 mm Table Concentrate (g)												
	0.25 to 2.0 mm Heavy Liquid Separation at S.G. 3.20												
	HMC S.G.>3.20												
	Nonferromagnetic HMC												
	Processed Split												
Total	-0.25 mm	Total	Lights S.G. <3.2	Total	-0.25 mm (wash)	Mag	Total	Total		0.25 to 0.5 mm	0.5 to 1.0 mm	1.0 to 2.0 mm	
								%	Weight				
052019-C*	47.3	10.3	37.0	33.0	4.0	0.2	0.3	3.5	100	3.5	1.5	1.2	0.8
052019-R	1308.7	782.8	525.9	492.5	33.4	5.8	0.6	27.0	100	27.0	20.2	4.9	1.9
052019-O	557.4	1.9	555.5	553.5	2.0	0.04	0.06	1.9	100	1.9	0.2	0.2	1.5
052018	742.1	496.1	246.0	211.8	34.2	8.7	3.7	21.8	100	21.8	15.0	5.3	1.5
052020	1101.9	615.1	486.8	392.3	94.5	9.9	30.9	53.7	100	53.7	28.2	19.4	6.1
052046	1322.4	819.6	502.8	489.4	13.4	3.4	1.2	8.8	100	8.8	6.1	2.0	0.7
052049	833.0	528.5	304.5	290.6	13.9	2.1	3.3	8.5	100	8.5	5.6	2.3	0.6
052076	921.4	576.6	344.8	332.2	12.6	3.4	2.6	6.6	100	6.6	4.5	1.6	0.5
052080	1108.2	722.5	385.7	381.4	4.3	1.6	0.6	2.1	100	2.1	1.6	0.4	0.1
052095	566.9	416.8	150.1	145.5	4.6	0.8	0.1	3.7	100	3.7	2.8	0.8	0.1
052306	946.5	555.7	390.8	371.1	19.7	1.8	4.0	13.9	100	13.9	8.4	4.4	1.1

* Concentrate fraction refined by direct heavy liquid separation.

Kimberlite Indicator Mineral Counts

Client: North-Tech Stone and Ceramic
 File Name: 20208336 - North Tech - Centis - (KIMs) - May 2020
 Total Number of Samples in this Report: 9
 ODM Batch Number(s): 8336

Sample Number	Number of Grains																																				Total (KIMs)																			
	Selected MMSIMs												KIMs																								Total (KIMs)																			
	1.0 to 2.0 mm						0.5 to 1.0 mm						0.25 to 0.5 mm						1.0 to 2.0 mm												0.5 to 1.0 mm												Total (KIMs)													
	Low-Cr diopside		Cpy		Gh		Low-Cr diopside		Cpy		Gh		Low-Cr diopside		Cpy		Gh		GP	GO	DC	IM	CR	FO	GP	GO	DC	IM	CR	FO	GP	GO	DC	IM	CR	FO	T	P																		
052019-C	0	0	0	0	0	0	0	0	0	0	0	0	0	0	0	0	0	0	0	0	0	0	0	0	2	2	0	0	0	0	2	2	4	4	0	0	44	44	1	1	0	0	8	8	4	4	1	1	80	30	18	18	0	0	164	114
052019-R	0	0	0	0	0	0	0	0	0	0	0	0	8	8	0	0	0	0	0	0	0	0	0	0	0	0	0	0	0	0	7	7	9	9	0	0	5	5	0	0	0	0	100	60	40	20	0	0	80	20	2	2	0	0	243	123
052019-O	0	0	0	0	0	0	0	0	0	0	0	0	0	0	0	0	0	0	0	0	0	0	0	0	0	0	0	0	0	0	0	0	0	0	0	0	0	0	0	0	0	0	0	0	0	0	0	0	0	0	0	0	0	0	0	0
052018	0	0	0	0	0	0	0	0	0	0	0	0	3	3	0	0	0	0	1	1	0	0	0	0	1	1	0	0	0	0	4	4	2	2	0	0	21	21	0	0	4	4	38	38	16	16	2	2	80	60	2	2	5	5	177	157
052020	0	0	0	0	0	0	0	0	0	0	0	0	3	3	11	11	0	0	0	0	0	0	0	0	1	1	0	0	0	0	7	7	1	1	0	0	11	11	0	0	1	1	40	20	5	5	1	1	30	10	0	0	2	2	99	59
052046	0	0	0	0	0	0	0	0	0	0	0	0	1	1	0	0	0	0	0	0	0	0	0	0	0	0	0	0	0	0	1	1	0	0	0	0	1	1	0	0	0	0	30	20	0	0	2	2	8	8	0	0	0	0	42	32
052049	0	0	0	0	0	0	0	0	0	0	0	0	2	2	0	0	0	0	0	0	0	0	0	0	0	0	0	0	0	0	4	4	4	4	0	0	13	13	1	1	2	2	39	39	18	18	3	3	50	20	2	2	4	4	144	114
052076	0	0	0	0	0	0	0	0	0	0	0	0	0	0	1	1	0	0	0	0	0	0	0	0	0	0	0	0	0	0	7	7	2	2	0	0	40	20	2	2	1	1	40	20	3	3	3	3	80	20	6	6	1	1	196	96
052080	0	0	0	0	0	0	0	0	0	0	0	0	1	1	0	0	0	0	0	0	0	0	0	0	0	0	0	0	0	0	1	1	0	0	0	0	10	10	0	0	0	0	22	22	2	2	1	1	30	20	1	1	0	0	67	57
052095	0	0	0	0	0	0	0	0	0	0	0	0	1	1	0	0	0	0	0	0	0	0	0	0	0	0	0	0	0	0	1	1	0	0	0	0	1	1	1	1	0	0	13	13	1	1	1	1	12	12	2	2	0	0	32	32
052306	0	0	0	0	0	0	0	0	2	2	0	0	2	2	8	8	0	0	0	0	0	0	0	0	0	0	0	0	0	0	1	1	1	1	0	0	0	0	0	0	5	5	0	0	1	1	2	2	0	0	0	0	0	0	11	11

T = Total number of grains in sample. Total is estimated if number is greater than number of picked grains.
 P = Number of picked grains in sample.

Kimberlite Indicator Mineral Remarks

Client: North-Tech Stone and Ceramic

File Name: 20208336 - North Tech - Centis - (KIMs) - May 2020

Total Number of Samples in this Report: 9

ODM Batch Number(s): 8336

Sample Number	Remarks
052019-C	Ilmenite-almandine/epidote assemblage. SEM checks from 0.5-1.0 mm fraction: 3 GO candidates = 3 GO (1 Cr-poor-pyrope and 2 pyrope almandine). SEM checks from 0.25-0.5 mm fraction: 2 GO versus grossular candidates = 1 GO (pyrope almandine) and 1 grossular; and 2 FO versus epidote candidates = 2 epidote. Also picked 1 bornite from 0.5-1.0 mm fraction. Both IM from 1.0-2.0 mm fraction; 1 GP, 2 GO and 33 IM from 0.5 to 1.0 mm fraction; and 3 GP, 2 GO and 80% IM from 0.25-0.5 mm fraction have partial alteration mantles.
052019-R	Augite/epidote-diopside assemblage. SEM checks from 0.5-1.0 mm fraction: 1 GP (with attached kelyphite mantle) versus almandine candidate = 1 GP; 10 GO versus grossular candidates = 9 GO (1 Cr-poor-pyrope and 8 pyrope almandine) and 1 grossular. SEM checks from 0.25-.5 mm fraction: 1 colourless diamond candidate = 1 zoisite; and 10 FO versus diopside candidates = 10 epidote. 3 GP, 4 GO and 4 IM from 0.5-1.0 mm; and 15% GP, 15% GO, and 80% IM from 0.25-0.5 mm fraction have partial alteration mantles.
052019-O	Undersized concentrate, therefore not electromagnetically separated and mineral assemblage not listed. Main mineral is augite
052018	Augite/epidote-diopside assemblage. 10 IM from 0.5-1.0 mm; 12 GP, 6 GO and 40% IM from 0.25-0.5 mm fractions have partial alteration mantles.
052020	Augite/epidote-diopside assemblage. Sole IM from 1.0-2.0 mm; 4 GP and 2 IM from 0.5-1.0 mm; and 5% GP and 5% IM from 0.25-0.5 mm fractions have partial alteration mantles.
052046	Augite-hornblende-almandine/epidote-diopside assemblage. Sole IM from 0.5-1.0 mm and 1 IM from 0.25-0.5 mm fractions have partial alteration mantles.
052049	Augite-fayalite/epidote assemblage. SEM checks from 0.5-1.0 mm fraction: 1 GP versus almandine candidate = 1 GP and 3 GO versus almandine candidates = 3 GO (Cr-poor pyrope). 3 IM from 1.0-2.0 mm; 9 IM from 0.5-1.0 mm; 9 GP, 5 GO and 50% IM from 0.25-0.5 mm fractions have partial alteration mantles.
052076	Augite-almandine-hornblende/epidote assemblage. 9 IM from 1.0-2.0 mm, 3 GP and 20% IM from 0.5-1.0 mm; and 20% GP and 20% IM from 0.25-0.5 mm fractions have partial alteration mantles.
052080	Augite-almandine-hornblende/epidote-diopside assemblage. 5 IM from 0.5-1.0 mm; 3 GP and 8 IM from 0.25-0.5 mm fractions have partial alteration mantles.
052095	Augite/epidote-diopside assemblage. Sole IM from 0.5-1.0 mm and 6 IM from 0.25-0.5 mm fractions have partial alteration mantles.
052306	Augite-hornblende/epidote-diopside assemblage.