

We are committed to providing [accessible customer service](#).

If you need accessible formats or communications supports, please [contact us](#).

Nous tenons à améliorer [l'accessibilité des services à la clientèle](#).

Si vous avez besoin de formats accessibles ou d'aide à la communication, veuillez [nous contacter](#).



# **Technical Report for MNDM Assessment Purposes, Fall 2021 Drone Magnetometer Survey**

## **Turnbull Property**

Turnbull Township, Porcupine Mining Division  
Ontario, Canada

Prepared For:

**Michael Thompson**

Prepared By:  
Jordan Quinn



<b>1</b>	<b>Introduction and Summary .....</b>	<b>4</b>
<b>2</b>	<b>Terms of Reference .....</b>	<b>4</b>
<b>3</b>	<b>Disclaimer .....</b>	<b>4</b>
<b>4</b>	<b>Property Description and Location .....</b>	<b>5</b>
<b>5</b>	<b>Access, Local Resources, and Infrastructure .....</b>	<b>8</b>
<b>6</b>	<b>Climate and Physiography .....</b>	<b>8</b>
<b>7</b>	<b>Geological Setting .....</b>	<b>8</b>
	7.1 Regional Geology .....	8
	7.1.1 Superior Province .....	8
	7.1.2 Abitibi Subprovince .....	9
	7.2 Local Geology – Turnbull Property .....	12
<b>8</b>	<b>History of Exploration on the Property .....</b>	<b>12</b>
<b>9</b>	<b>Current Program .....</b>	<b>13</b>
	9.1 Personnel .....	14
<b>10</b>	<b>Data Filtering and Processing .....</b>	<b>15</b>
<b>11</b>	<b>Results .....</b>	<b>16</b>
<b>12</b>	<b>Conclusion and Recommendations .....</b>	<b>18</b>
<b>13</b>	<b>References .....</b>	<b>18</b>
<b>14</b>	<b>Statement of Qualification .....</b>	<b>20</b>
	<b>Appendix I – Instrument Specifications .....</b>	<b>21</b>
	<b>Appendix II – Maps .....</b>	<b>26</b>
	<b>Appendix III – Program Expenditures and Cost per Claim .....</b>	<b>29</b>
	 Figure 1 - Turnbull Property .....	 6
	Figure 2 - Turnbull Claim Map .....	7
	Figure 3 - Regional Geology of Northwestern Ontario .....	11
	Figure 4- Turnbull Property Geology .....	12
	Figure 5 – Map of Turnbull Drone Survey .....	13
	Figure 6 – Map of Total Field Magnetics .....	16
	Figure 7 – 1 <sup>st</sup> Vertical Derivative Map .....	17



Figure 8 – 2 <sup>nd</sup> Vertical Derivative Map .....	17
Table 1 – Turnbull Claims .....	8
Table 2 – Distribution of Work by Mining Claims .....	13
Table 3 - Personnel Log .....	14
Table 4 – Raw Geophysical Drone Data .....	15



## 1 Introduction and Summary

The Turnbull Property consists of 4 mining claims within the Turnbull Township in the Porcupine Mining Division. The property is fully owned by Michael Thompson and located approximately 20 km west of Timmins, Ontario along Highway 101.

Michael Thompson contracted Fladgate Exploration Consulting Corporation (“**Fladgate**”) to conduct an unmanned aerial geophysical survey on the Turnbull property from November 5-6 2021. Fladgate provided all the required geological, geotechnical, and sub-contractor services on the program described herein. The program consisted of 21 flight lines and 3 perpendicular tie lines totaling 6.5 flown line kilometers. The survey was performed in order to map the magnetic signature of the underlying geology.

The results of the survey indicate the presence of multiple northeast-southwest trending anomalies. These anomalies are attributed to underlying geologic features such as mafic dikes which are common to the area. Subsequent and more detailed geophysical surveys are recommended to enhance the boundaries and locations of magnetic anomalies on the property.

## 2 Terms of Reference

This report was prepared at the request of Michael Thompson for the use of filing assessment as required under the Ontario Mining Act. Unless otherwise noted, Universal Transverse Mercator (“UTM”) coordinates are provided in the datum of NAD83 Zone 17 North.

## 3 Disclaimer

The author disclaims responsibility for portions of the current report that rely on information from historic assessment files and government maps and reports which may not have been prepared in compliance with current standards.



## 4 Property Description and Location

The Turnbull property is located in the Turnbull Township within the Porcupine Mining Division in Northwestern Ontario, approximately 20 km west of Timmins (**Figure 1**). The property is centered on UTM coordinates 454,500 mE, 5,371,950 mN (NAD83 Zone 17N) and is accessed from Timmins by traveling 33 kilometers along HWY 101 and local logging roads. It consists of 4 unpatented mining claims. (**Figure 2**). A list of all claims can be found in **Table 1**.

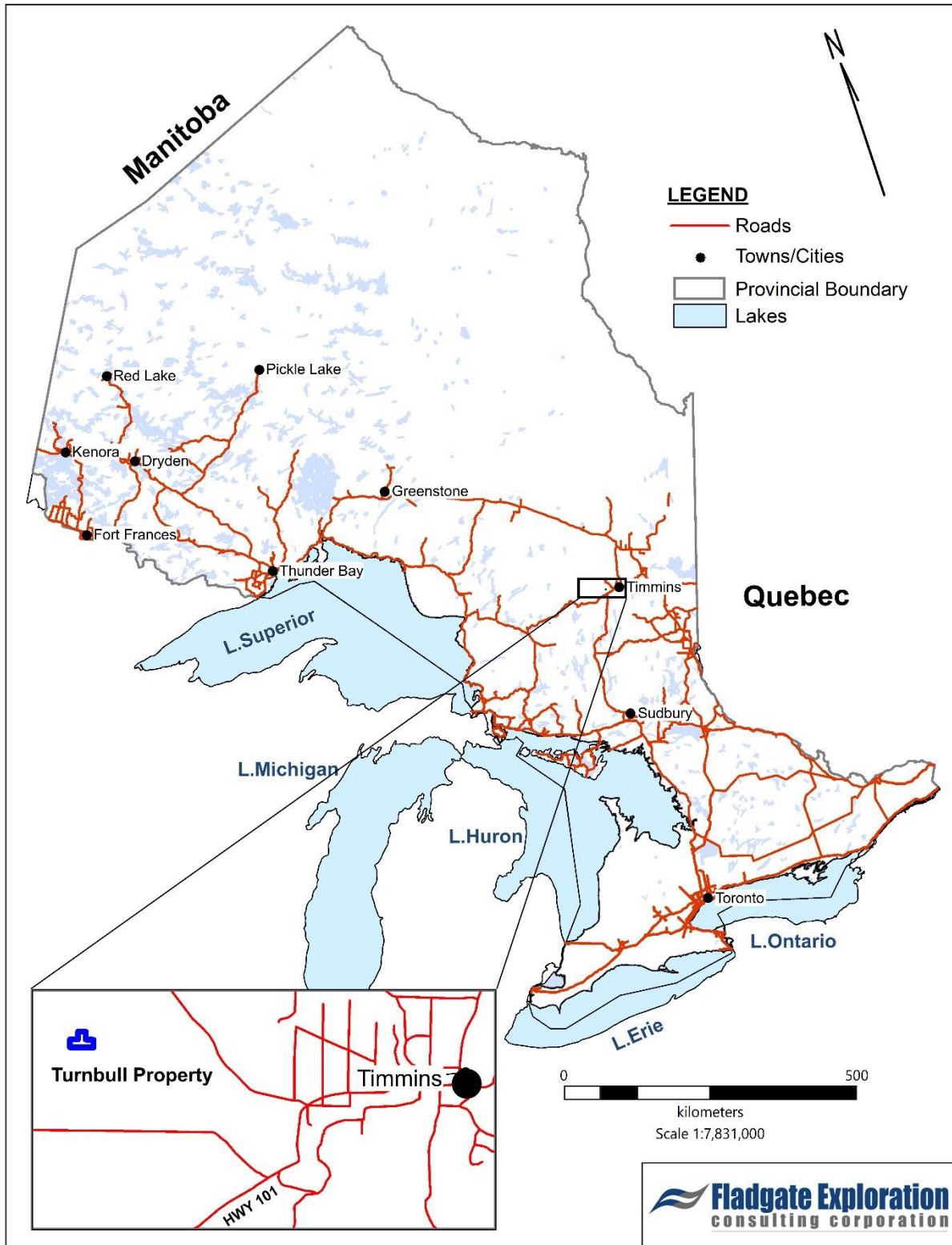

Figure 1 - Turnbull Property

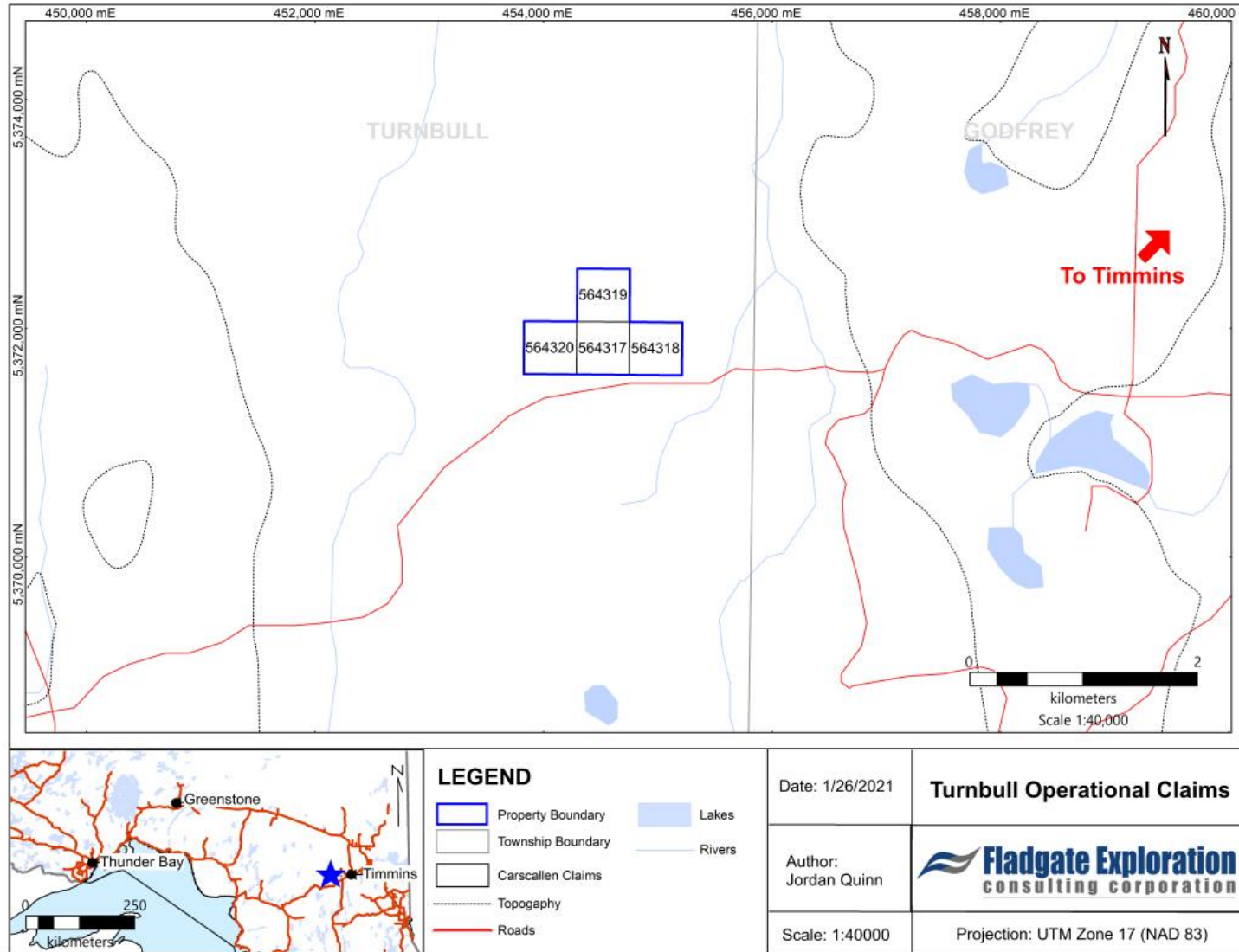

Figure 2 - Turnbull Claim Map



**Table 1 – Turnbull Claims**

Claim Number	Township	Units	Ha	Claim Due Date	% Option	Ownership
564317	TURNBULL	1	16	2021-11-17	100%	Michael Thompson
564318	TURNBULL	1	16	2021-11-17	100%	Michael Thompson
564319	TURNBULL	1	16	2021-11-17	100%	Michael Thompson
564320	TURNBULL	1	16	2021-11-17	100%	Michael Thompson

## 5 Access, Local Resources, and Infrastructure

The property is accessible year-round, as it is located 20 km west of HWY 101, which is a major east-west route connecting Timmins to Wawa (**Figure 1**). After driving 17 km west of Timmins on Hwy 101, access to the property is gained by traveling 14km along Malette Lumber Road and turning north on a smaller logging road. (**Figure 2**).

Timmins is ~37 km to the east and is the nearest large regional population centre in Ontario, with many services and amenities for industrial, educational, and leisure activities. Local experienced labour is readily available, as well as the regional offices of the Ministry of Northern Development and Mines (MNMD).

The property is located near major rail and hydroelectric infrastructure. There are no permanent structures on the property currently.

## 6 Climate and Physiography

The Turnbull Property is located within the Canadian Shield, which is a major physiographic division of Canada. The property is situated in an area of swamps, rivers, and small lakes.

Climate in the area is typical of Northern Ontario, with cold winters and warm summers. Average January temperatures range from -11°C to -23°C, and average July temperatures are between 11°C and 24°C. Work can be done (subject to snow and freezing) for most of the year.

Rock exposures are sparse on the property due to the flat lying topography and abundance of swamp coverage.

## 7 Geological Setting

### 7.1 Regional Geology

The Turnbull Property lies within the central portion of Ontario's Superior Province, in the Abitibi Subprovince, consisting of metavolcanic and metasedimentary rocks interpreted to have developed in an ensimatic basin (Ayer et al. 2001). The Superior Province and the Abitibi Subprovince are described in detail in the literature (e.g., Ayer et al. 2001, Card, 1990). The regional geology is illustrated in Figure 3.

#### 7.1.1 Superior Province



The Superior Province is a major geological province comprised of Archean age rocks. It forms the core of the North American continent. In Ontario, the Superior Province makes up roughly 70% of the Canadian Shield bedrock and is surrounded by younger Grenville and Southern Provinces to the south and southeast, which comprise the remaining 30%. The Superior Province consists of alternating granite-greenstone and metasedimentary belts in the central portion, and has been subdivided into smaller subprovinces (or terranes) based on rock type: granite-greenstone plutonic and metavolcanic rocks (Uchi, Wawa, and Abitibi subprovinces), metasedimentary rocks (English River and Quetico subprovinces), plutonic granitic rocks (Winnipeg River subprovince), and high-grade greenstone rocks to the north (Kapusksing Zone). Subprovinces are commonly fault-bounded and display contrasting lithological assemblages, metamorphic and structural styles, geophysical characteristics, and ages.

The Superior Province has been tectonically stable since ~2.5 Ga. Proterozoic and younger geological activity is limited to rifting of the margins, emplacement of several mafic dyke swarms, compressional reactivation, and large-scale rotation at ~1.9 Ga, as well as failed rifting at ~1.1 Ga. With the exception of the northwestern Superior margin that was pervasively deformed and metamorphosed at ~1.8 Ga, the craton has otherwise escaped late ductile deformation. It formed as a collage of smaller continental and oceanic plates (Card, 1990; Williams et al., 1992; Stott, 1997; Percival et al., 2004, 2006), that were stitched together between ~2.72 and 2.68 Ga. Sedimentary rocks as old as ~2.48 Ga uncomfortably overlie Superior Province granites, indicating that most erosion had occurred prior to ~2.5 Ga.

The southern portion of the Superior Province (to latitude 52°N) is a major source of mineral wealth, hosting active gold and base metal mining camps associated with metavolcanics of the granite-greenstone belts. Owing to its potential for these and other commodities, the Superior Province continues to attract both grassroots and advanced mineral exploration.

### **7.1.2 Abitibi Subprovince**

The Abitibi Subprovince of the Superior Province comprises a stratigraphically continuous succession of Neo- to Mesoproterozoic (2.5 to 2.9 Ga) metavolcanic and metasedimentary rocks interpreted to have developed in an ensimatic basin (Ayer et al. 2001). These supracrustal rocks are intruded by multiple generations of felsic to ultramafic igneous rocks. This intrusive activity extended from the Neoproterozoic into the late Proterozoic.

Three volcanic and two sedimentary assemblages are exposed in the Timmins region (Ayer et al. 1997, 1999, 2002). The Deloro assemblage is the oldest (2730-2724 Ma, Ayer et al. 2002) and consists of mafic to felsic, calc-alkalic metavolcanic rocks and associated iron formation (Ayer et al. 1999, 2002). The Kidd-Munro assemblage ranges in age from 2719 Ma to 2710 Ma (Ayer et al. 2002) and unconformably overlies the Deloro assemblage (Ayer et al. 1999, 2002). The Kidd-Munro assemblage consists of a suite of tholeiitic and komatiitic metavolcanic rocks locally interlayered with rhyolite and a suite of calc-alkalic felsic to intermediate metavolcanic rocks (Ayer et al. 1999). The Tisdale assemblage overlies the Kidd-Munro assemblage and ranges in age from 2710 Ma to 2703 Ma. The base of the Tisdale assemblage consists of tholeiitic mafic to komatiitic metavolcanic rocks locally associated with high-silica rhyolite. Felsic to intermediate, calc-alkalic pyroclastic metavolcanic rocks and local thick accumulations of iron formation form the upper, younger parts of the Tisdale assemblage (Ayer et al. 1999). The Porcupine assemblage is the oldest (2696-2692 Ma, Ayer et al. 2002), lowermost sedimentary package in the area and consists dominantly of turbiditic metasedimentary rocks. The Porcupine assemblage unconformably



overlies the metavolcanic assemblages (Ayer et al. 1999). The Timiskaming assemblage unconformably overlies the Porcupine assemblage and consists of coarse clastic metasedimentary rocks (Ayer et al. 1999, 2002).

The Kamiskotia Gabbroic Complex is interpreted to be coeval with the Tisdale assemblage and intrudes the Deloro and Kidd-Munro assemblages (Barrie 1990, 1992, 2000). Several plutons of felsic to intermediate compositions are considered to be comagmatic with the Kamiskotia Gabbroic Complex based on similar geochemical characteristics, overlap in U/Pb zircon ages, contact relationships, and textural similarities (Barrie 1990, 1992, 2000). Archean, post-volcanic, felsic plutons and associated dikes intrude all of the assemblages (Pyke 1982). Proterozoic mafic dikes (Matachewan, Abitibi swarms) intrude Archean rocks (Pyke 1982).

The rocks of the Abitibi Subprovince have experienced variable degrees of deformation and metamorphism. Of particular significance in the Timmins region, due to its relationship with gold mineralization (Berger 2001), is the Porcupine-Destor Fault Zone (PDFZ). The fault zone is a major structural feature that strikes east-northeast and has been traced along strike for over 450 km across the Abitibi Subprovince (Berger 2001). The PDFZ is offset by numerous north-northwest-striking faults that partition the Abitibi greenstone belt into distinct blocks that display different styles of alteration associated with gold mineralization, deformation and metamorphism (Berger 2001). Early Proterozoic (2454 Ma; Heaman 1988) Matachewan dikes are also offset by the north-northwest-striking faults (Brisbin 1997).

Phanerozoic bedrock is not exposed in the Timmins area, therefore, there is no record of the geological history post-dating the late faulting and/or intrusion of the Abitibi dike swarm. Unconsolidated Quaternary glacial deposits and recent terrestrial sedimentary and regolithic deposits cover most of the Precambrian bedrock in the Timmins region.

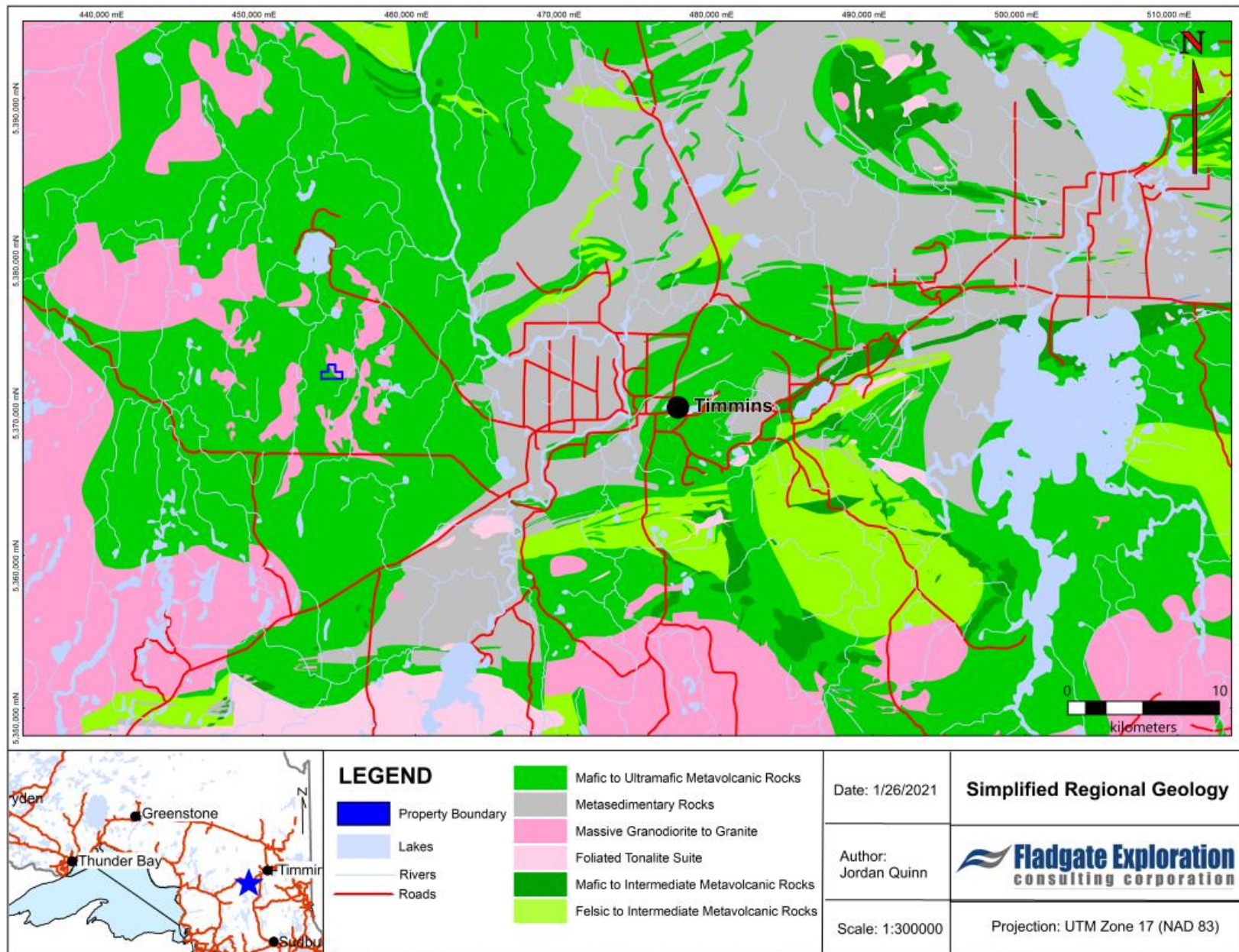

Figure 3 - Regional Geology of Northwestern Ontario



## 7.2 Local Geology – Turnbull Property

The following description of the local geological setting is modified from (Beaudry and Schwartzmann, 2015). A detailed property geology map can be found in Figure 4.

Volcanic rocks of two distinct assemblages are thought to be present on the property. Age dating of rocks in the area confirm the presence of the Kidd-Munro (2,719 – 2,710 Ma) and Blake River (2,701 – 2,697 Ma) assemblages. Both these units are known to contain gold, zinc and copper deposits and occurrences. Dating is not currently sufficient to locate the boundary between these two units. The Kidd-Munro Assemblage is composed of felsic rhyolites which are overlain by massive pillow basalt. The Blake River Assemblage rocks overlie the Kidd-Munro Assemblage. project area. Barrie (1992) highlights that the Blake River Assemblage rocks are assigned to the Kamiskotia Gabbroic Complex (KGC) and the Kamiskotia Volcanic Complex (KVC), including both mafic and felsic intrusive.

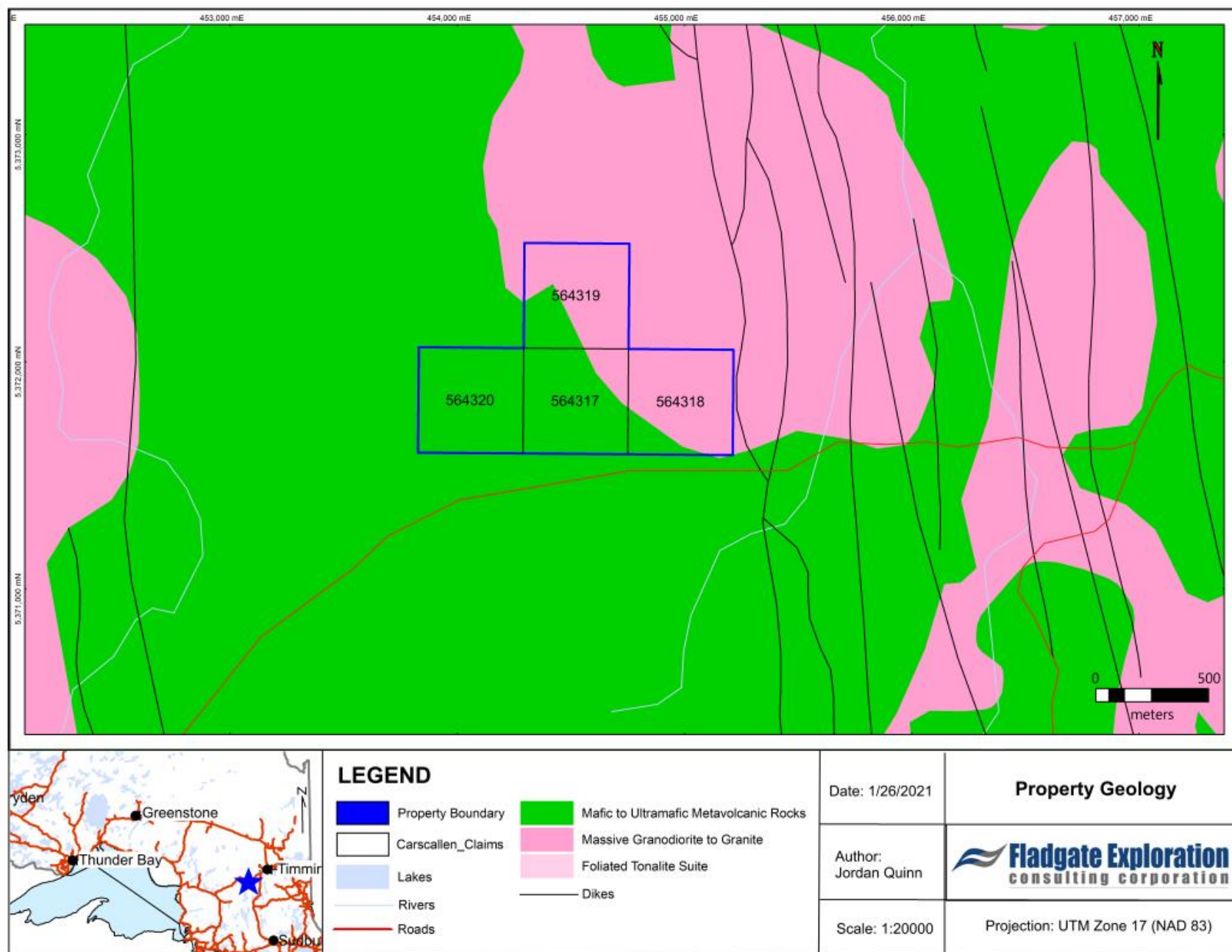

Figure 4- Turnbull Property Geology

## 8 History of Exploration on the Property

The history of exploration on the Turnbull Property is as follows:

- 1926: Geology mapping of Carscallen, Bristol and Ogden townships (Hawley)
- 1944: Geology of the Robb-Jamieson Area (Berry)
- 1962-1964: AlsofMines Limited Sampling and geology (Middleton)
- 1979: Conwest Exploration conducted airborne and ground geophysics
- 1983-1985: Chevron conducted ground geophysics
- 1987: MNM conducted an airborne magnetic and electromagnetic survey
- 1988: Granges conducted geophysics and diamond drilling
- 1995: Cambior Mines conducted geophysical, litho geophysical surveys and diamond drilling
- 2003: Lithochemical data for the Timmins West area: Carscallen, Denton, Bristol, Ogden and Deloro townships (Vaillancourt)
- 2005: Geological Setting of Volcanogenic Massive Sulphide Mineralization in the Kamiskotia Area: Discover Abitibi Initiative (Hathway)
- 2007: Explorers Alliance Corporation drilled one hole (ETC-00-1/2/3/4, ETC07-04/05, ETW-09-1/2/3)
- 2015: Lithochemical Compilation Program in the West Timmins District (Beaudry)



## 9 Current Program

On November 5, 2021 a drone magnetic survey was carried out on the Turnbull property. The survey consisted of 21 Northeast-Southwest flight lines spaced at 25m and 3 Northwest-Southeast tie lines spaced at 200m (Figure 5). The height of the survey was 50m and the total line kilometres flown were 6.5km. Table 2 summarizes the total line kilometers flown per claim on the Turnbull property. The goal of the survey was to map the magnetic signature of the underlying geology.

**Table 2 – Distribution of Work by Mining Claims**

Claim #	Line Kilometers Flown
564317	3.6
564318	2.9
564319	0
564320	0
<b>TOTAL</b>	<b>6.5</b>

Universal Ground Control Software (UgCS) was used in planning the drone survey. Flight lines were planned as perpendicular as possible to the known underlying geology and at a flight speed of 5.0 m/s.

The principle geophysical sensor used was a Gem Systems Canada GSMP-35U potassium vapor sensor mounted on a UAV platform. A GSM-19 Overhauser Magnetometer base station was used in conjunction with the UAV magnetometer. General specifications of both magnetometers can be found in Appendix 1 of this report: Instrument Specifications.

Fladgate used the DJI Matrice 600 Pro UAV to complete this survey. Specifications of the UAV used can also be found in Appendix 1 of this report.

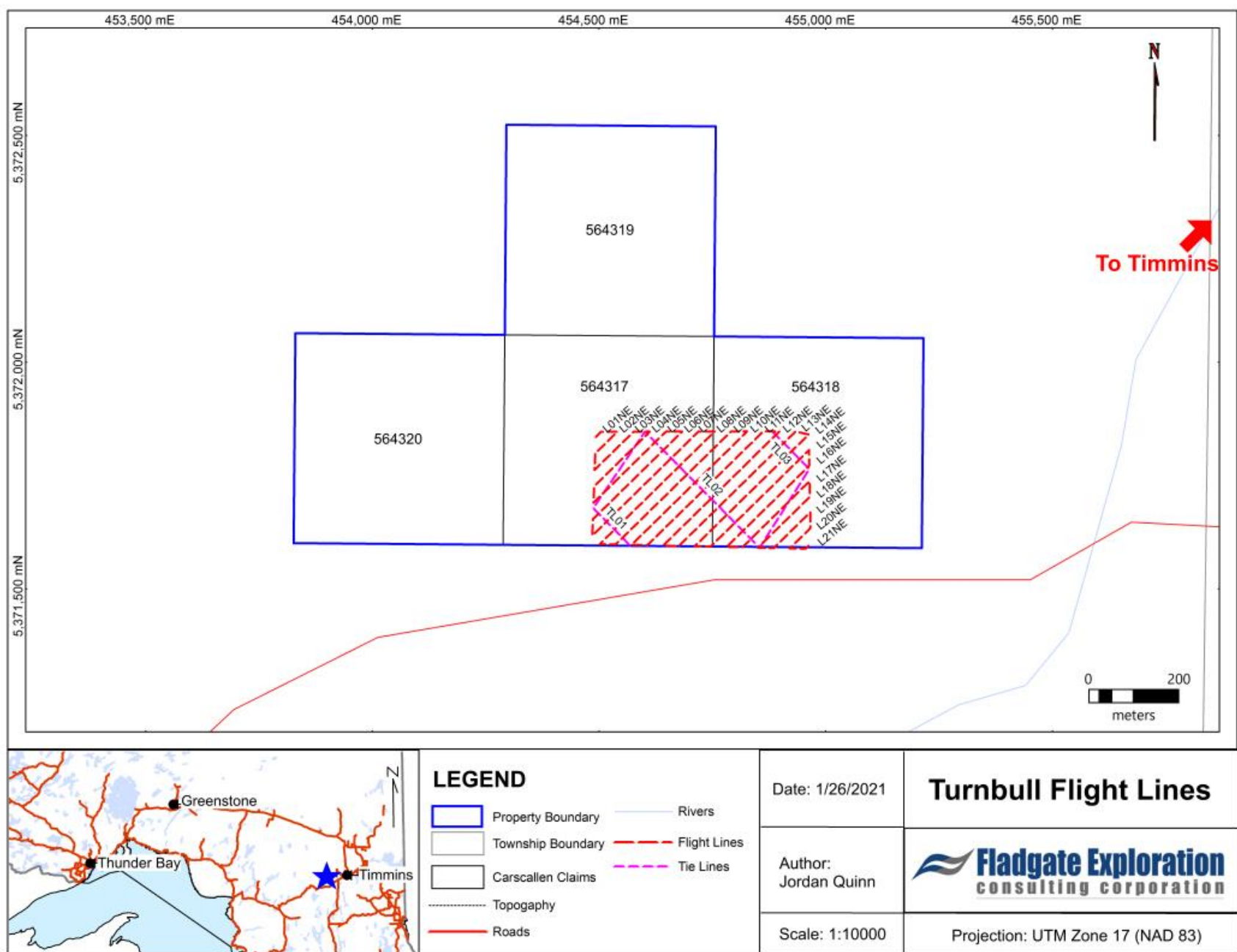

**Figure 5 – Map of Turnbull Drone Survey**



## 9.1 Personnel

Field operations were supervised and all technical staff was provided by Fladgate and began with logistics and flight planning on November 4, 2021.

**Table 3 - Personnel Log**

Name	Working Title	Responsibilities	Dates on Project
Jordan Quinn	Project Geologist	Mobilization, Pilot, Drone route planning, Processing Geophysics/Map creation, Report writing, Demobilization	November 4-6, 2021; January 26, 2021; February 11, 2022
Alex Wytiahlowsky	Geologist	Mobilization, Assist in flight setup and operations, Demobilization	November 4-6, 2021



## 10 Data Filtering and Processing

Raw aerial magnetometer data was collected at a rate of 10 Hz while base station data was collected at a rate of 0.5 Hz. Total field and GPS UTC time was recorded with each data point which enabled diurnal corrections to be applied during subsequent data processing. An example of the raw data required to carry out the filtering and processing steps is given in **Table 4**.

**Table 4 – Raw Geophysical Drone Data**

UTC Time	Total Field Mag (nT)	Lock Status	Signal Strength	UTM Easting	UTM Northing	GPS Altitude (m)	Laser Altimeter (m)
144803.7	55377.1	1	309	454931.73	5366619.93	333	8.66
144803.9	55424.3	1	143	454931.71	5366619.89	333	9.24
144804	55441.3	1	504	454931.7	5366619.86	334	9.48
144804.1	55454.9	1	233	454931.7	5366619.87	334	9.79
144804.2	55465.0	1	152	454931.7	5366619.86	334	10.26
144804.3	55471.9	1	208	454931.7	5366619.85	335	10.58

The raw data was then imported into Oasis Montaj Software to be further processed. The steps involved in filtering the data are as follows:

1. A filter was applied to the data based on the lock parameter of the magnetometer. All values that were recorded that did not have a lock value of 1 were removed. The datapoints which remained after this filter were correctly oriented with the Earth's magnetic field.
2. The second filtering step was based on the geometry of the survey area. Data outside the defined survey area were removed. This included data that was gathered while the UAV was in flight to and from the takeoff/landing site and data that was gathered as the UAV takes corners at the end of survey lines. This step reduced edge effects and insured that sampling points were evenly distributed throughout the survey area.
3. A filter was applied that removed any data that was not collected at the programmed survey elevation. This step removes any data that was collected while the UAV was on the ground in between surveys or while the UAV was rising to the programmed survey elevation.

After the data was filtered, the data was processed for interpretation through the following steps:

1. The Earth's magnetic field was subtracted from the total magnetic field reading of the magnetometer. The resulting residual magnetic field data represents the component of the field that is caused by the subsurface.
2. The second processing step involved the subtracting of the observed diurnal variations from the residual magnetic field data. This was achieved by analyzing the change of the magnetic field in the base station measurements with time and correcting for this change.





- The residual magnetic data was then leveled and a reduction to pole calculation was performed. The resulting data was then used for various interpolations using Oasis Montaj's gridding and mapping functions.

## 11 Results

The results of the magnetic survey are presented as contoured total field, 1<sup>st</sup>, and 2<sup>nd</sup> vertical derivative maps. The results from the magnetic survey indicate a relatively quiet magnetic background with the overall magnetic field is disrupted by at least three northeast-southwest trending, linear anomalies. These anomalies (A1, A2, and A3), can be seen in the maps below.

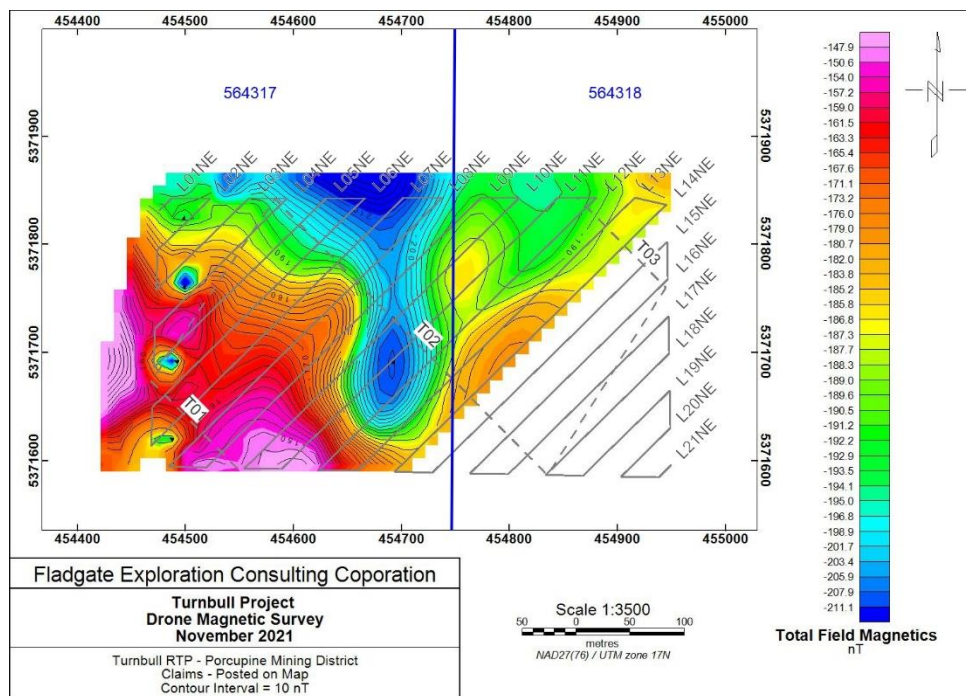

**Figure 6 – Map of Total Field Magnetics**

The 1<sup>st</sup> and 2<sup>nd</sup> vertical derivative maps clearly reveal the magnetic anomalies in the survey area. Mafic dikes are thought to be the cause of these magnetic highs as they are very common to the area. These anomalies are speculative due to inconsistencies in the data and would require a follow up detailed ground mag survey to confirm these anomalies.

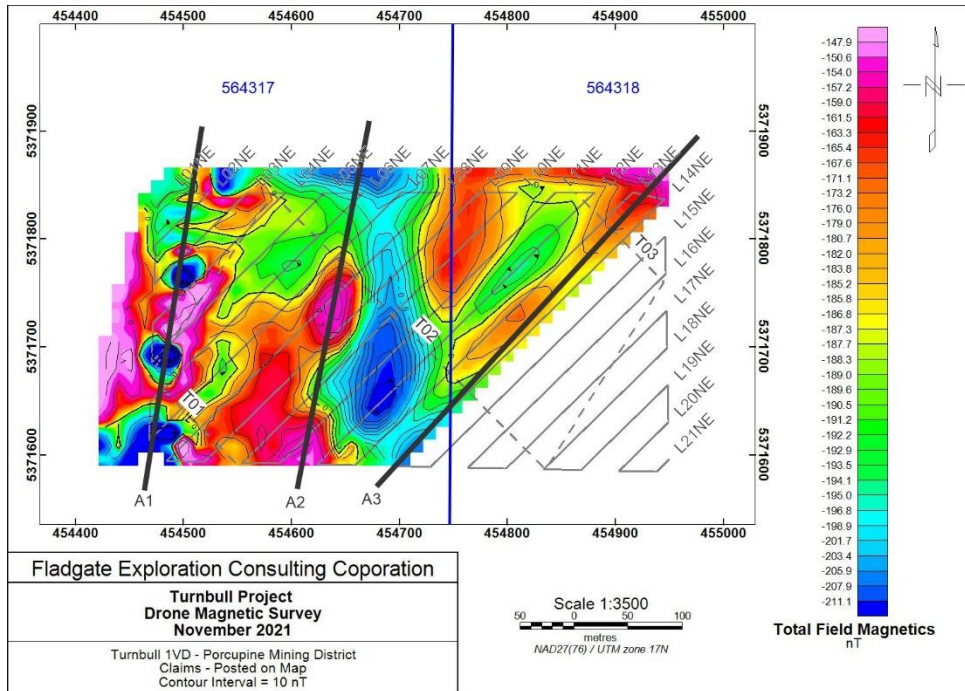

Figure 7 – 1<sup>st</sup> Vertical Derivative Map

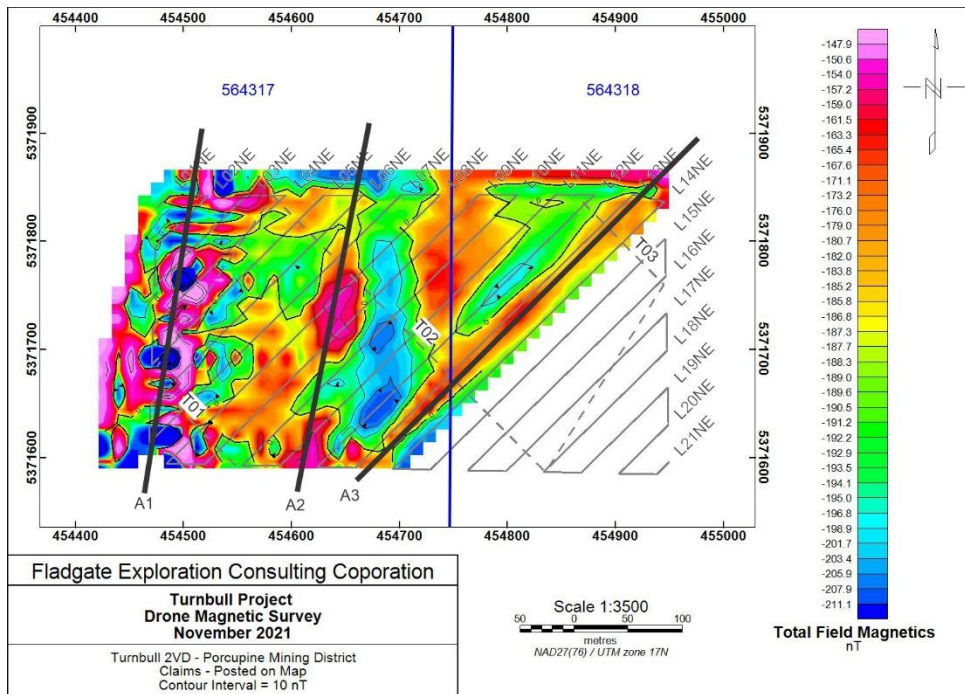

Figure 8 – 2<sup>nd</sup> Vertical Derivative Map



## 12 Conclusion and Recommendations

The magnetic survey completed over the Turnbull property was successful in mapping magnetic anomalies and underlying geological trends. The contoured total magnetic field map of the property hints at the presence of magnetic anomalies with a clear magnetic low displayed near the center of the survey area. Once the data is processed further with 1<sup>st</sup> and 2<sup>nd</sup> derivative maps being created; thin magnetic high anomalies become visible. These magnetic high anomalies trend generally north-south to northeast-southwest and are attributed to mafic dikes which are common to the area.

It is recommended that another mag survey be flown at a lower elevation in conjunction with a detailed ground mag survey to more confidently confirm the location of these anomalies.

## 13 References

- Ayer, J.A., Trowell, N.F., Madon, Z. and Corfu. (1997) Geological compilation of the Abitibi greenstone belt in Ontario: the correlation of metallogenic potential with stratigraphy; in Summary of Field Work and Other Activities 1997, Ontario Geological Survey, Miscellaneous Paper 168, p.3-9.
- Ayer, J.A., Trowell, N.F., Madon, Z., Kamo, S., Kwok, Y.Y. and Amelin, Y. (1999) Compilation of the Abitibi greenstone belt in the Timmins-Kirkland Lake area: Revisions to stratigraphy and new geochronological results; in Summary of Field Work and Other Activities 1998, Ontario Geological Survey, Open File Report 6000, p.4.1 to 4.14.
- Ayer, J.A. and Trowell, N.F (2001) The Abitibi Greenstone Belt: a program update; in Summary of Field Work and Other Activities 2001, Ontario Geological Survey, Open File Report 6070, p.4.1 to 4.9.
- Ayre, J.A., Amelin, Y., Corfu, F., Kamo, S., Ketchum, J., Kwok, K and Trowell, N. (2002) Evolution of the Abitibi greenstone belt based on U-Pb geochronology and Nb isotopes: early interaction between plume and subduction volcanism followed by sedimentation, folding and plutonism; Precambrian Research.
- Barrie, C.T. (1990) The geology of the Kamiskotia area; Ontario Geological Survey, Preliminary Map 3396, scale 1:50 000.
- Barrie, C.T. (1992) The geology of the Kamiskotia area; Ontario Geological Survey, Open File Report 5829, p.180.
- Barrie, C.T. (2000) The geology of the Kamiskotia area; Ontario Geological Survey, Study 59, p.79.
- Beaudry, C. and Schwartzmann, A. (2015) Mapping, Litho-geochemical Sampling and Exploration Targeting of Gold and VMS Deposits on the Turnbull Property, Timmins, Ontario, Canada.
- Berger, B. (2001) Variation in styles of gold mineralization along the Porcupine-Destor Deformation Zone in Ontario: an exploration guide. In: Summary of Field Work and Other Activities. Ontario Geological Survey; Open File Report 6070, pages 9.1 -9.13.
- Brisbin, D.I. (1997) Geological Setting of Gold Deposits in the Porcupine Gold Camp Timmins, Ontario; unpublished PhD thesis, Queen's University, Kingston, Ontario, 523p.



- Card, K. D. (1990) A review of the Superior Province of the Canadian Shield, a product of Archean accretion. *Precambrian Research*, v. 48. p. 99-156.
- Percival, J. A., Bleeker, W., Cook, F. A., Rivers, T., Ross, G., and van Staal, C.R. (2004) Panlithoprobe Workshop IV: Intra-orogen correlations and comparative orogenic anatomy. *Geoscience Canada*, v. 31, p. 23-39.
- Percival, J. A., Sanborn-Barrie, M., Skulski, T., Stott, G. M., Helmstaedt, H. and White, D. J. (2006) Tectonic evolution of the western Superior Province from NATMAP and LITHOPROBE studies. *Canadian Journal of Earth Sciences*, v. 43, p. 1085-1117.
- Pyke, D. R. (1982) *Geology of the Timmins Area, District of Cochrane*; Ontario Geological Survey, Report 219, 141p.
- Stott, G. M. (1997) The Superior Province, Canada. *In: Greenstone Belts, Oxford Monograph on Geology and Geophysics 35*, Oxford Clarendon, p. 480-507.
- Williams, H. R., Stott, G. M., Thurston, P. C., Sutcliffe, R. H., Bennett, G., Easton, R. M., and Armstrong, D. K. (1992) Tectonic evolution of Ontario: Summary and synthesis. *In: Geology of Ontario, Ontario Geological Survey, Special Volume 4, Part 1*, p. 1255-1332.



## 14 Statement of Qualification

### **Jordan Quinn, B.Sc., P.Geo.**

Fladgate Exploration Consulting Corporation  
278 Bay St, Suite 101  
Thunder Bay, Ontario  
Canada  
Telephone: (807) 345.5380  
Email: jordan.quinn@fladgateexploration.com

### **CERTIFICATE OF THE AUTHOR**

I, **Jordan Quinn**, do hereby certify that:

1. I am an employee of Fladgate Exploration Consulting Corporation, the geological consulting firm tasked with this report.
2. I am a member in good standing of the Association of Professional Geoscientists of Ontario (APGO #3151).
3. I am a graduate of Lakehead University (Hons. B.Sc., 2014).
4. I have practiced geology for 7 years in a variety of settings, mostly in Northwestern Ontario, Canada. I have specific experience in Archean lode gold deposits in Ontario, mostly working as both a production and exploration geologist at various gold mines throughout Ontario.
5. I have no previous involvement with the property that forms the subject of this Technical Report.
6. I am not aware of any material fact or material change with respect to the subject matter of the Technical Report that is not reflected in the Technical Report, the omission to disclose which makes the Technical Report misleading.
7. I consent to the filing of this Technical Report with any stock exchange and other regulatory authority and any publication by them, including electronic publication in the public company files on their website accessible by the public.

Effective Date: February 15, 2022

Date of signing: February 15, 2022

---

Jordan Quinn, H.B.Sc., P.Geo. (APGO #3151)



## Appendix I – Instrument Specifications

### GEM GSMP-35UA: Ultra-Light-Weight Potassium Magnetometer

#### Magnetometer Specifications

Sensitivity: 0.0002 nT @ 1 Hz

Resolution: 0.0001 nT

Absolute Accuracy: +/- 0.1 nT

Heading Error: + / – 0.05 nT

Dynamic Range: 15,000 to 120,000 nT

Gradient Tolerance: 50,000 nT/m

Sampling Intervals: 1, 2, 5, 10, 20 Hz

Operating Temperature: -40°C to +55°C

#### Orientation

Sensor Angle: optimum angle 35° between sensor head axis & field vector.

Proper Orientation: 10° to 80° & 100° to 170

Heading Error: +/- 0.05 nT between 10° to 80° and 360° full rotation about axis.

#### Environmental

Operating Temperature: -40°C to +55°C

Storage Temperature: -70°C to +55°C

Humidity: 0 to 100%, splashproof

#### Dimensions & Weight

Sensor: 161mm x 64mm (external dial) with 2m cabling; 0.43 kg

Electronics Box: 236mm x 56mm x 39mm; 0.46 kg

Option 1 cabling; .125kg

Option 3 light weight battery; .250kg

#### Power

Power Supply: 18 to 32 V DC

Power Requirements: approx. 50 W at start up, dropping to 12 W after warm-up

Power Consumption: 12 W typical at 20°C Warm-up Time: <15 minutes at -40°C

#### Outputs

20 Hz RS-232 output with comprehensive Windows Personal Computer (PC) software for data acquisition and display.



Outputs UTC time, magnetic field, lock indication, heater, field reversal, GPS position (latitude, longitude altitude, number of satellites)

**Components**

Sensor, pre-amplifier box, 2m sensor /pre-amplifier cable (optional cable 3-5m), manual & shipping case



## **GSM-19 Overhauser Magnetometer**

### **Performance**

Sensitivity: Standard

GSM-19 0.022 nT @ 1 Hz

GSM-19PRO 0.015 nT @ 1 Hz

Resolution: 0.01 nT

Absolute Accuracy: 0.1 nT

Dynamic Range: 20,000 to 120,000 nT

Gradient Tolerance: up to 10,000 nT/m

Samples at: 60+, 5, 3, 2, 1, 0.5, 0.2 sec

Operating Temperature: -40°C to +50°C

### **Operating Modes**

Manual: Coordinates, time, date and reading stored automatically at up to 0.2 sec.

Base Station: Time, date and reading stored at 1 to 60 second intervals.

Remote Control: Optional remote control using RS-232 interface.

Input/Output: RS-232 using 6-pin weatherproof connector with USB adapter.

### **Memory - (# of Readings in millions)**

Mobile: 1.4M

Base Station: 5.3M

Gradiometer: 1.2M

Walking Mag: 2.6M

### **Dimensions**

Console: 223mm x 69mm x 240 mm(8.7x2.7x9.5in)

Sensor: 175mm x 75mm diameter cylinder (6.8in long by 3 in diameter)

### **Weights**

Console with Belt: 2.1 kg Sensor and Staff Assembly: 1.0 kg





## Matrice 600

### Structure

Diagonal Wheelbase: 1133 mm

Aircraft Dimensions: 1668 mm x 1518 mm x 759 mm (Propellers, frame arms and GPS mount unfolded)

640 mm x 582 mm x 623 mm (Frame arms and GPS mount folded)

Package Dimensions: 620 mm x 320 mm x 505 mm

Intelligent Flight Battery Quantity: 6

Weight (with six TB47S batteries): 9.1 kg

Weight (with six TB48S batteries): 9.6 kg

Max Takeoff Weight: 15.1 kg

### Performance

Hovering Accuracy (P-Mode, with GPS) Vertical:  $\pm 0.5$  m, Horizontal:  $\pm 1.5$  m

Max Angular Velocity: Pitch:  $300^\circ/\text{s}$ , Yaw:  $150^\circ/\text{s}$

Max Pitch Angle:  $25^\circ$

Max Speed of Ascent: 5 m/s

Max Speed of Descent: 3 m/s

Max Wind Resistance: 8 m/s

Max Flight Altitude above Sea Level: 2500 m

Max Speed: 18 m/s (No wind)

Hovering Time (with six TB47S batteries)\* No payload: 35 min, 6 kg payload: 16 min

Hovering Time (with six TB48S batteries)\* No payload: 40 min, 5.5 kg payload: 18 min

\* The hovering time is based on flying at 10 m above sea level in a no-wind environment and landing with 10% battery level.

### Remote Controller

Operating Frequency:

- 920.6 MHz to 928 MHz (Japan)
- 5.725 GHz to 5.825 GHz
- 2.400 GHz to 2.483 GHz

Max Transmission Distance (unobstructed, free of interference):

- FCC Compliant: 3.1 miles (5 km)
- CE Compliant: 2.1 miles (3.5 km)

EIRP:

- 10 dBm @ 900 M/li>
- 13 dBm @ 5.8 G
- 20 dBm @ 2.4 G

Video Output Port: HDMI, SDI, USB



Dual Users Capability: Master-and-Slave control  
Mobile Device Holder: Supports smartphones and tablets  
Output Power: 9 W  
Operating Temperature: 14° to 104° F (-10° to 40° C)  
Storage Temperature:  
Less than 3 months: -4° to 113° F (-20° to 45° C)  
More than 3 months: 72° to 82° F (22° to 28° C)

Charge Temperature: 32° to 104° F (0° to 40° C)  
Built-in Battery: 6000 mAh, 2S LiP  
Max Tablet Width: 170 mm

### **Propulsion System**

Motor Model: DJI 6010  
Propeller Model: DJI 2170

### **Battery**

Model: TB48S  
Capacity: 5700 mAh  
Voltage: 22.8 V  
Type: LiPo 6S  
Energy: 129.96 Wh  
Net Weight: 680 g  
Operating Temperature: 14° to 104° F (-10° to 40° C)  
Storage Temperature: Less than 3 months: -4° to 113° F (-20° to 45° C) More than 3 months: 72° to 82° F (22° to 28° C)  
Charge Temperature: 41° to 104° F (5° to 40° C)  
Max Charging Power: 180 W

### **Charger**

Model: MC6S600  
Voltage: Output 26.1 V  
Power Rating: 100 W



# Appendix II – Maps

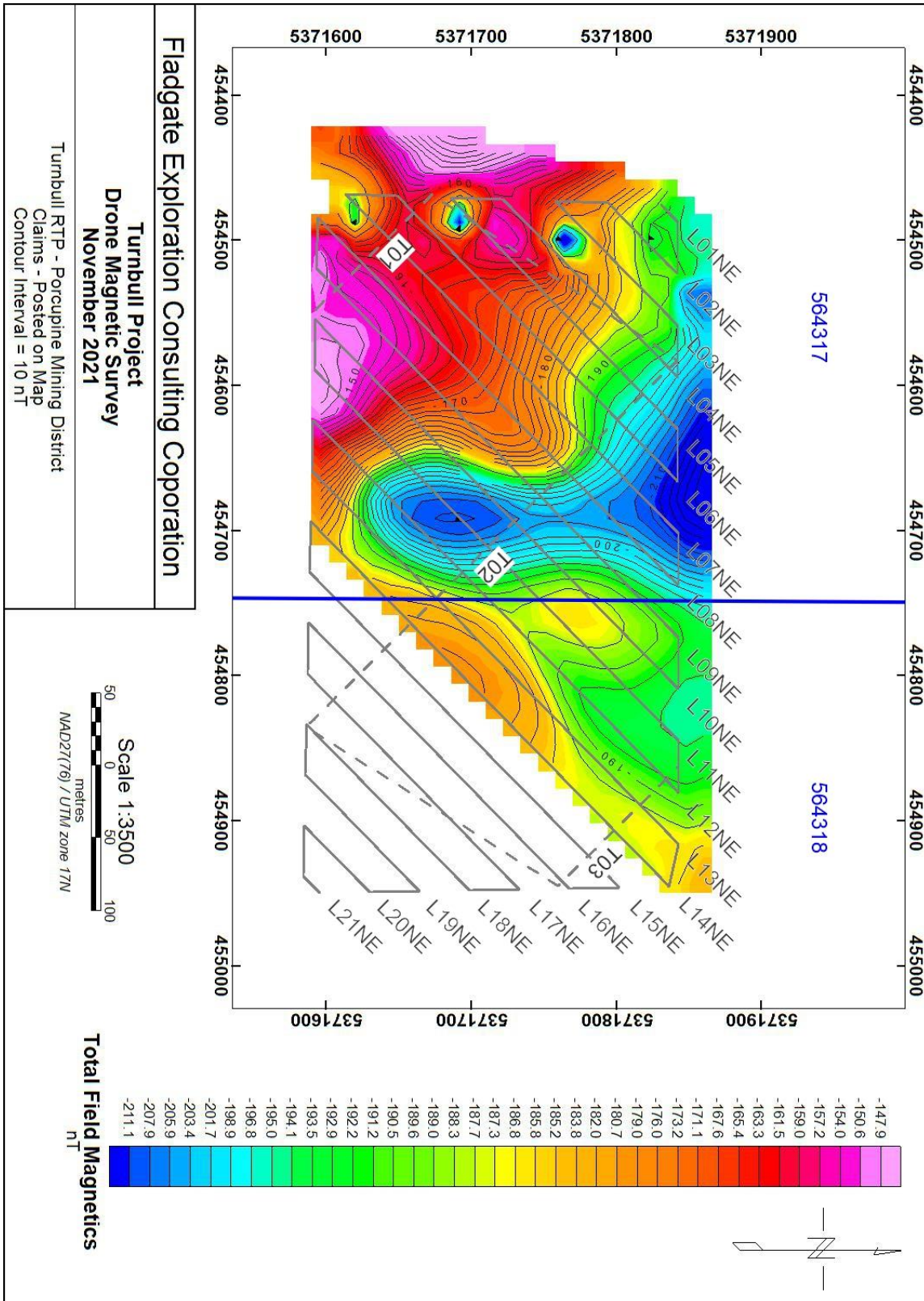

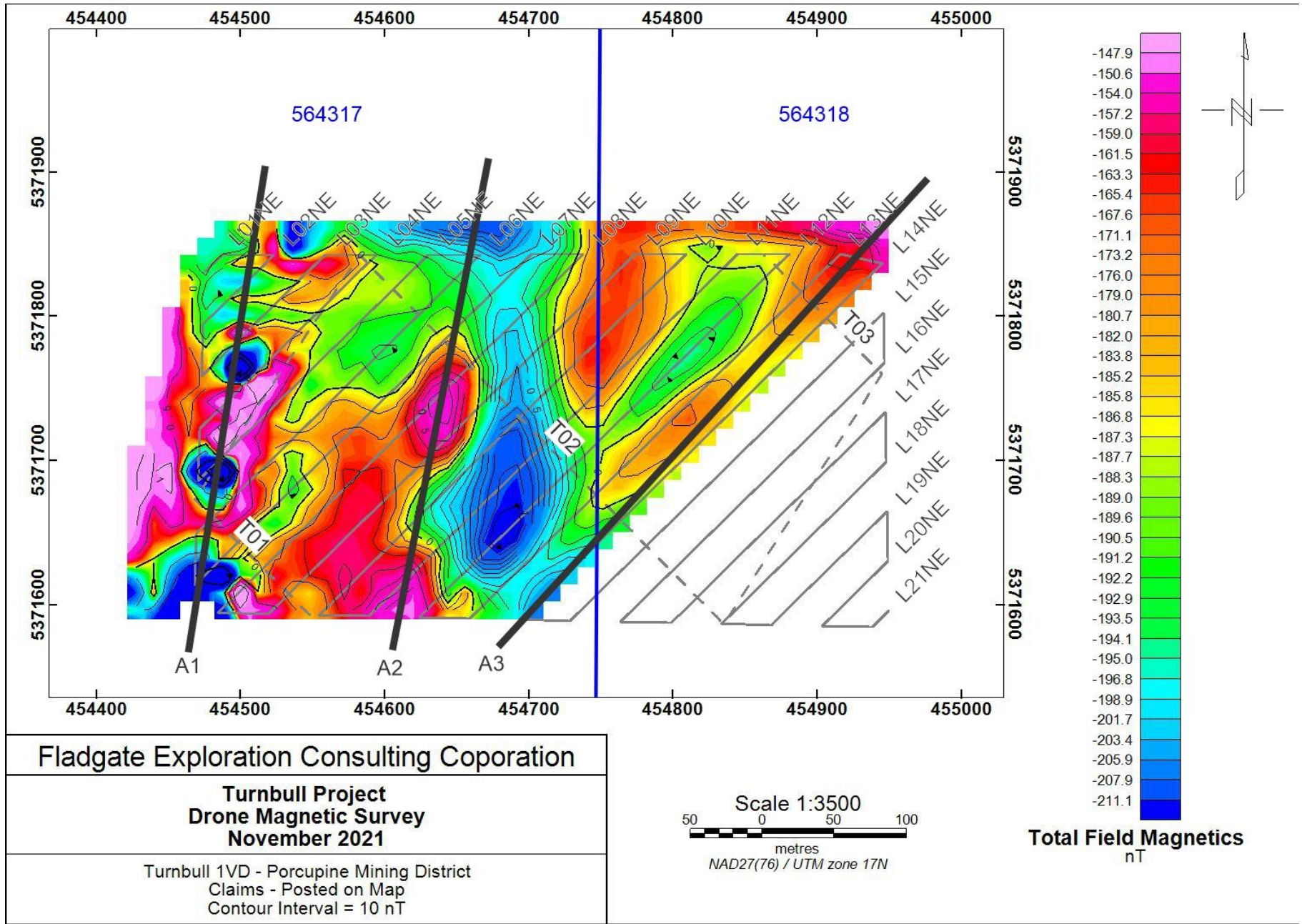

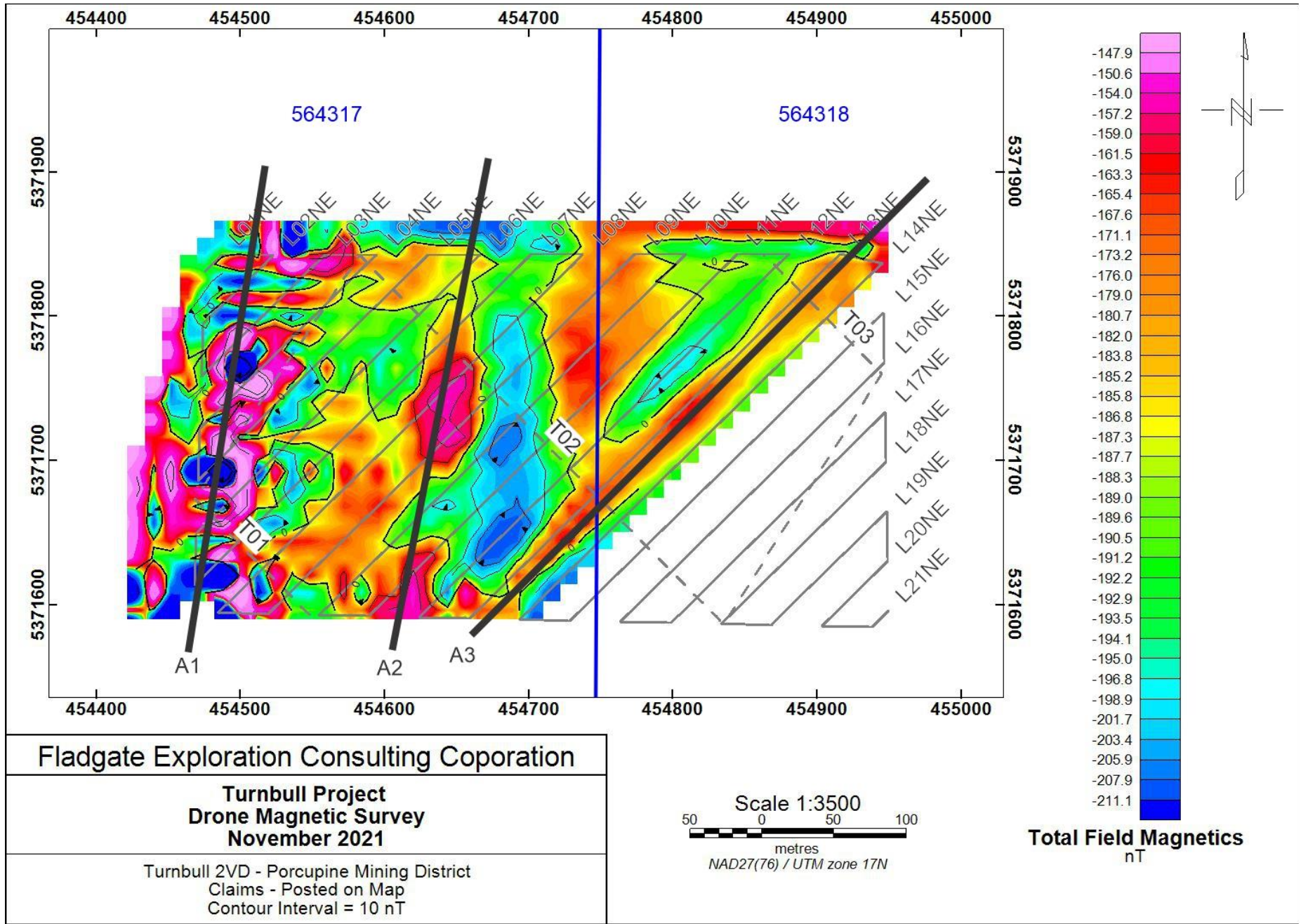

Fladgate Exploration Consulting Corporation

Turnbull Project  
Drone Magnetic Survey  
November 2021

Turnbull 2VD - Porcupine Mining District  
Claims - Posted on Map  
Contour Interval = 10 nT

Scale 1:3500  
50 0 50 100  
metres  
NAD27(76) / UTM zone 17N

Total Field Magnetics  
nT



## Appendix III – Program Expenditures and Cost per Claim

~~See attached document(s).~~

**Program Expenditures**

Company: Michael Thompson      Turnbull

Expenditure Item	Date From	Date To	No of Units	Unit cost	Total Item Cost (incl. HST/GST)	HST/GST	Net Item Cost NO HST/GST	Supplier	Invoice #
<b>Labour</b>									
Project Manager	04-Nov	06-Nov	3.00	600	\$ 2,034.00	\$ 234.00	1,800.00	Fladgate Exploration Consulting Corporation	21INV2004
Geological Assistant	04-Nov	06-Nov	3.00	400	\$ 1,356.00	\$ 156.00	1,200.00	Fladgate Exploration Consulting Corporation	21INV2004
Line KMs	04-Nov	06-Nov	7.00	200	\$ 1,582.00	\$ 182.00	1,400.00	Fladgate Exploration Consulting Corporation	21INV2004
Data Processing	Januray 2022	01-Feb	2.00	700	\$ 1,582.00	\$ 182.00	1,400.00	Fladgate Exploration Consulting Corporation	22INV2007
<b>Subtotal</b>					<b>6,554.00</b>	<b>754.00</b>	<b>5,800.00</b>		
<b>Rental (equipment/trucks)</b>									
Truck Rental	04-Nov	06-Nov	3	100	\$ 339.00	\$ 39.00	300.00	Fladgate Exploration Consulting Corporation	21INV2004
Truck KMs	04-Nov	06-Nov	1735	0.70029	\$ 1,372.95	\$ 157.95	1,215.00	Fladgate Exploration Consulting Corporation	21INV2004
<b>Subtotal</b>					<b>\$ 1,711.95</b>	<b>\$ 196.95</b>	<b>\$ 1,515.00</b>		
<b>Maps/Reports</b>									
Technical Report	01-Jan	01-Feb	2	700	\$ 1,582.00	\$ 182.00	1,400.00	Fladgate Exploration Consulting Corporation	22INV2007
Assessment Report	01-Jan	01-Feb	2	700	\$ 1,582.00	\$ 182.00	1,400.00	Fladgate Exploration Consulting Corporation	22INV2007
							2,800.00		
<b>Program Total</b>					<b>\$ 8,265.95</b>	<b>\$ 950.95</b>	<b>\$ 10,115.00</b>		